

INSIGNIA™

USER GUIDE

Stainless Steel 8-Bottle Wine Cooler

NS-WC08SS1



Before using your new product, please read these instructions to prevent any damage.

Contents

IMPORTANT SAFETY INSTRUCTIONS	3
Grounding requirement	5
Features	5
Package contents	5
Components	5
Setting up your wine cooler	6
Before using your wine cooler	6
Finding a suitable location	6
Leveling your wine cooler	6
Providing correct ventilation	6
Providing the correct power supply	6
Using your wine cooler	7
Control panel	7
Setting the thermostat	8
Arranging your wine	8
Serving and storage tips	8
Maintaining your wine cooler	9
Cleaning the interior of your wine cooler	9
Storing your wine cooler	9
Moving your wine cooler	9
Tips on saving energy	9
Troubleshooting	10
Specifications	12
ONE-YEAR LIMITED WARRANTY	13

IMPORTANT SAFETY INSTRUCTIONS



This symbol indicates that dangerous voltage constituting a risk of electric shock is present within your wine cooler.



This symbol indicates that there are important operating and maintenance instructions in the literature accompanying your wine cooler.

WARNING

- 1 Read these instructions.
- 2 Keep these instructions.
- 3 Heed all warnings.
- 4 Follow all instructions.
- 5 Do not use this appliance near water.
- 6 Clean only with a damp cloth.
- 7 Do not block any ventilation openings. Install in accordance with the manufacturer's instructions.
- 8 Do not install near any heat sources such as radiators, heat registers, stoves, or other apparatus (including amplifiers) that produce heat.
- 9 Do not defeat the safety purpose of the polarized or grounding-type plug. A polarized plug has two blades with one wider than the other. A grounding type plug has two blades and a third grounding prong. The wide blade or the third prong are provided for your safety. If the provided plug does not fit into your outlet, consult an electrician for replacement of the obsolete outlet.
- 10 Protect the power cord from being walked on or pinched particularly at plugs, convenience receptacles, and the point where they exit from the appliance.
- 11 Do not attempt to modify or extend the power cord of this appliance.
- 12 Unplug this appliance during lightning storms or when it will not be used for long periods of time.
- 13 Make sure that the available AC power matches the voltage requirements of this appliance.
- 14 Do not handle the plug with wet hands. This could result in an electric shock.
- 15 Unplug the power cord by holding the plug, never by pulling the cord.

- 16 Do not turn the appliance on or off by plugging or unplugging the power cord.
- 17 Turn off the appliance before unplugging it.
- 18 Refer all servicing to qualified service personnel. Servicing is required when the appliance has been damaged in any way, such as the power-supply cord or plug is damaged, liquid has been spilled or objects have fallen into the appliance, the appliance has been exposed to rain or moisture, does not operate normally, or has been dropped.
- 19 To reduce the risk of fire or electric shock, do not expose this appliance to rain, moisture, dripping, or splashing, and no objects filled with liquids should be placed on top of it.



WARNING

Electric Shock Hazard

Failure to follow these instructions can result in electric shock, fire, or death.

- 1 **WARNING**—Keep ventilation openings in the wine cooler clear of obstruction.
- 2 **WARNING**—Do not use electrical appliances inside the storage compartment of the wine cooler, unless they are of the type recommended by the manufacturer.
- 3 **WARNING—DANGER**—Never allow children to play with, operate, or crawl inside the wine cooler.
Risk of child entrapment. Before you throw away your old wine cooler:
 - 1) Take off the door
 - 2) Leave the shelves in place so that children may not easily climb inside
- 4 Unplug the wine cooler before carrying out user maintenance on it.
- 5 This wine cooler can be used by children age 8 years and older and persons with reduced physical or mental capabilities or lack of experience and knowledge if they are given supervision or instruction concerning the use of the wine cooler in a safe way and understand the hazards involved. Children should not play with the wine cooler. Cleaning and maintenance should not be performed by children without supervision.
- 6 If a component part is damaged, it must be replaced by the manufacturer, its service agent, or similar qualified persons in order to avoid a hazard.
- 7 Follow local regulations regarding disposal of the wine cooler due to flammable refrigerant and gas. All refrigeration products contain refrigerants, which under the guidelines of federal law must be removed before disposal. It is the consumer's responsibility to comply with federal and local regulations when disposing of this product.
- 8 This wine cooler is intended to be used in household and similar environments.
- 9 Do not store or use gasoline or any flammable liquids inside or in the vicinity of this wine cooler.
- 10 Do not use an extension cord with this wine cooler. If the power cord is too short, have a qualified electrician install an outlet near the wine cooler. Use of an extension cord can negatively affect the wine cooler's performance.

Grounding requirement

Your wine cooler must be grounded. Your wine cooler is equipped with a cord having a grounding wire with a grounding plug. The plug must be inserted into an outlet that is correctly installed and grounded.

Incorrect use of the grounding plug can result in a risk of electric shock. Consult a qualified electrician or service person if the grounding instructions aren't completely understood, or if doubt exists as to whether the wine cooler is correctly grounded.

Features

- 8-bottle capacity stores your favorites without taking up too much space
- Digital controls help keep wine at your chosen temperature between 46–65° F (8–18° C)
- Stainless steel finish and curved glass door for a sleek, modern look that's easy to clean
- Adjustable leveling feet, interior lighting, and a quiet motor give you a variety of flexible placement options

Package contents

- 8-bottle wine cooler
- Removable shelves (3)
- *User Guide*

Components

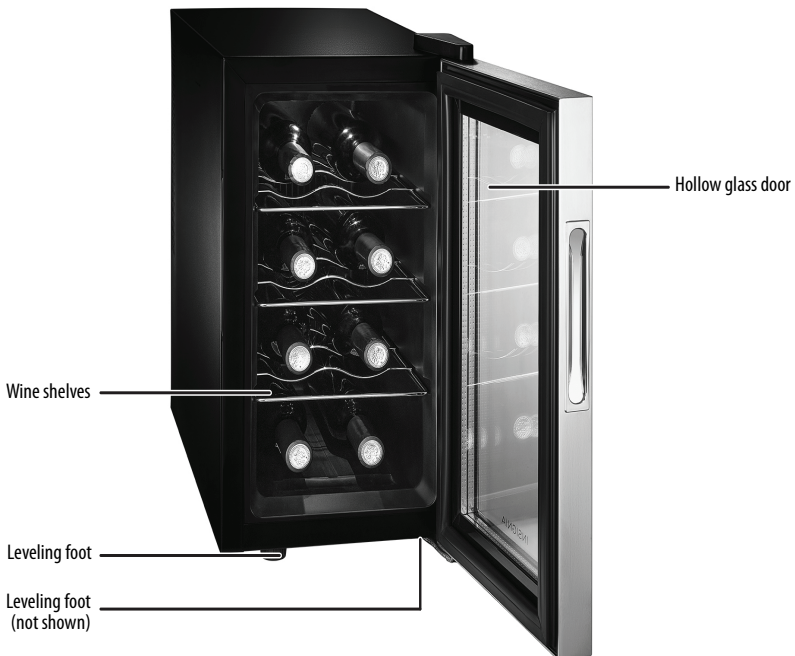

Setting up your wine cooler

Before using your wine cooler

- Remove the exterior and interior packing.
- Clean the interior surface using a soft cloth and lukewarm water.

Finding a suitable location

- Your wine cooler is designed to be free standing only, and shouldn't be recessed or built-in.
- Place your wine cooler on a floor, countertop, or cabinet that is strong enough to support your wine cooler when it is fully loaded.
- Allow five inches of space between the back and sides of your wine cooler and any surrounding walls. This allows the correct air ventilation. Adjust the feet to keep your wine cooler level.
- Locate your wine cooler away from direct sunlight and sources of heat (stove, heater, radiator, and so on). Direct sunlight may affect the acrylic coating and heat sources may increase electrical consumption. Ambient temperature below 59° F (15° C) or above 77° F (25° C) hinders the performance of your wine cooler. Your wine cooler isn't designed for use in a garage or any other outside installation.
- Avoid locating your wine cooler in moist areas.

Leveling your wine cooler

- Your wine cooler must be level in order to function correctly. If your wine cooler isn't leveled during installation, the door may not close or seal correctly, causing cooling, frost, or moisture problems.
- To level your wine cooler, turn the leveling foot clockwise to raise that side of your wine cooler or turn it counter-clockwise to lower that side.

Providing correct ventilation

Place your wine cooler at least five inches from the wall to ensure correct airflow to the compressor. Don't place your wine cooler near any heat sources, such as a heater or stove, because this may put a strain on the compressor.

Providing the correct power supply

Check your local power source. Your wine cooler requires a 110-120 V, 60 Hz power supply.

Use a receptacle that accepts the grounding prong. The power cord is equipped with a 3-prong (grounding) plug which mates with a standard 3-prong (grounding) wall outlet to minimize the possibility of electric shock hazard from your wine cooler.

Using a 3-prong plug and outlet

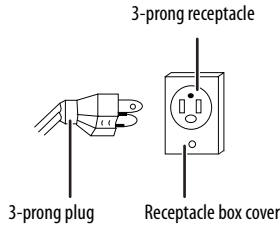

Notes:

- Your wine cooler should always be plugged into its own individual electrical outlet which has a voltage rating that matches the rating plate.
- Never unplug your wine cooler by pulling on the power cord. Always grip the plug firmly and pull it straight out from the outlet.

Using your wine cooler

Control panel

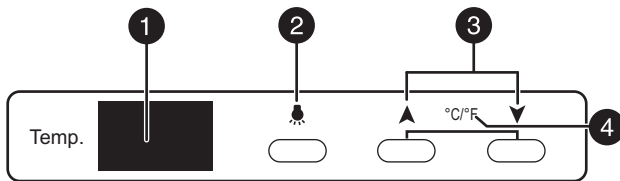

#	ITEM	DESCRIPTION
1	Temperature	Displays your cooler's current temperature.
2	Light switch	Press to turn on the interior light.
3	▲ (increase)/▼ (decrease)	Press to increase or decrease the temperature.
4	°F/°C button	Press the ▲ and ▼ buttons at the same time for three seconds. The temperature display format switches between Celsius and Fahrenheit.

Setting the thermostat

- 1 Plug in your wine cooler.
- 2 Adjust the thermostat to the temperature you want.

Notes

- If your wine cooler is unplugged or loses power, you must wait three to five minutes before restarting it. If you attempt to restart before this time delay, your cooler doesn't start.
- Large amounts of wine lowers the cooling efficiency of your cooler.
- Adjust the thermostat setting by one increment at a time. Wait several hours for the temperature to stabilize between adjustments.

Arranging your wine

In order to maintain good air circulation in your cooler, don't let the bottles touch the back of your cooler.

Store different types of wine within your cooler:

- Strong red wine (top)
- Pink and mild red wine (middle)
- White wine (bottom)

Serving and storage tips

We suggest that you pour wine at a temperature below the ideal serving temperature. Wine warms up quickly after it's been poured into a glass.

WINE TYPE	IDEAL SERVING TEMP
Red Bordeaux	64.4° F (18° C)
Côtes du Rhône Red, Barolo Louis Family Dry Red Wine, Barolo	62.6° F (17° C)
Burgundy Red	60.8° F (16° C)
Port	59° F (15° C)
Young Burgundy Red	57.2° F (14° C)
Young Red Wine	53.6° F (12° C)
Young Beaujolais, All White Wines (low sugar)	51.8° F (11° C)
Old White Wines, Chardonnay	50° F (10° C)
Sherry	48.2° F (9° C)
Young White Wines (late vintage)	46.4° F (8° C)
White Wines Loire, Entre-deux-Mers	44.6° F (7° C)

Don't store bottled wine by box or case in your cooler.

Moisten a cork from an old bottle before returning the cork to the bottle.

Let red wine breathe (oxygenate) before drinking. We suggest that you put pink or rose type wines onto the table two to five hours before drinking and red wine four to five hours before drinking. This also lets them reach suitable serving temperatures. On the other hand, you can serve white wine right away.

Keep champagne in your cooler and take it out immediately before drinking.

Maintaining your wine cooler

Your wine cooler is designed for year-round use with only minimal cleaning and maintenance.

When you first receive your cooler, wipe the case with a mild detergent and warm water, then wipe dry with a dry cloth. Do this periodically to keep your wine cooler looking new.

CAUTION: To prevent damage to the finish, don't use:

- Gasoline, benzine, thinner, or other similar solvents
- Abrasive cleaners

Cleaning the interior of your wine cooler

- 1 Unplug your wine cooler from the wall outlet.
- 2 Remove all wines.
- 3 Wash the inside with a damp warm cloth soaked in a solution of one quart of lukewarm water to two tablespoons of baking soda solution.
- 4 Make sure that you keep the door gasket (seal) clean to keep your cooler running efficiently.
- 5 Dry the interior and exterior with a soft cloth.

Storing your wine cooler

- 1 Unplug your wine cooler from the wall outlet.
- 2 Remove all wines.
- 3 Clean your wine cooler.
- 4 Leave the door open slightly to avoid possible formation of condensation, mold, or odor.

CAUTION: Use extreme caution with children. Your wine cooler shouldn't be accessible to child's play.

Moving your wine cooler

- 1 Unplug your wine cooler from the wall outlet.
- 2 Remove all wines.
- 3 Securely tape down all loose items inside your wine cooler.
- 4 Tape the door shut.
- 5 Make sure that your wine cooler stays in the upright position during transportation.

Tips on saving energy

- Locate your wine cooler in the coolest area of the room, away from heat producing appliances or heating ducts and out of the direct sunlight.
- Overloading your wine cooler forces the compressor to run longer.
- Don't open the door too often, especially if the weather is hot. Close the door as soon as possible to prevent cool air from escaping.
- Make sure that your cooler is sufficiently ventilated, with adequate air circulation behind it.

Troubleshooting

CAUTION: Don't try to repair your wine cooler yourself. Doing so invalidates the warranty.

PROBLEM	POSSIBLE CAUSE	POSSIBLE SOLUTION
My wine cooler doesn't operate	Your wine cooler is unplugged.	Make sure that your wine cooler is plugged in and that the plug is pushed completely into the outlet.
	The fuse on the circuit is blown or the circuit breaker is tripped.	Check the house fuse or circuit breaker box and replace the fuse or reset the circuit breaker.
	Power failure.	If a power failure occurs, your wine cooler turns off. Wait until the power is restored, then turn it on again.
The cooler door doesn't close completely	The shelf is out of position.	Adjust the shelf correctly.
	The door gaskets are dirty.	Clean the door gaskets.
	Your cooler isn't level.	Level your cooler with the leveling feet.
My cooler isn't cold enough	The door has been opened too often or wasn't closed correctly.	Make sure that the door is closed correctly.
	You have just added a large amount of warm beverage to your cooler.	Allow time for the new beverage to cool, then check again.
	The temperature control is set too warm.	Set the control to a colder setting.
My wine cooler makes unusual noises or vibrates	Your cooler isn't level.	Level your wine cooler with the leveling feet.
	The body of your wine cooler is touching a wall.	Move your wine cooler out from the wall.
	Some noises are normal.	<ul style="list-style-type: none"> • The flow of refrigerant in your wine cooler may cause a rattling noise. • As each cooling cycle ends, you may hear gurgling sounds. • Contraction and expansion of the inside walls may cause popping or crackling noises.

PROBLEM	POSSIBLE CAUSE	POSSIBLE SOLUTION
Moisture is building up in the interior of my cooler	The door has been opened too often or wasn't closed correctly.	Make sure that the door is closed correctly.
	Your cooler is in a location that is too humid.	Move your cooler to a dryer location.
My cooler turns on and off frequently	The room temperature is hotter than normal.	Cool the room or move your wine cooler to a cooler place.
	The door has been opened too often or wasn't closed correctly.	Make sure that the door is closed correctly.
	The door gaskets don't seal correctly.	Clean the door gaskets.
	The temperature control is set too warm.	Set the control to a colder setting.
The humidity level in my cooler is too low	The door has been opened too often or wasn't closed correctly.	Make sure that the door is closed correctly.
	Your cooler is in a location that is too hot.	Move your cooler to a cooler location.
	Relative humidity is too low.	Place a cup of water inside your cooler to raise the humidity.

Specifications

Dimensions (H × W × D)	18.5 × 10.2 × 20.1 in. (47 × 26 × 51 cm)
Weight	21.6 lbs. (9.8 kg)
Power requirements	115 V ~ 60 Hz
Current	0.95 A

ONE-YEAR LIMITED WARRANTY

Definitions:

The Distributor* of Insignia branded products warrants to you, the original purchaser of this new Insignia-branded product ("Product"), that the Product shall be free of defects in the original manufacturer of the material or workmanship for a period of one (1) year from the date of your purchase of the Product ("Warranty Period").

For this warranty to apply, your Product must be purchased in the United States or Canada from a Best Buy branded retail store or online at www.bestbuy.com or www.bestbuy.ca and is packaged with this warranty statement.

How long does the coverage last?

The Warranty Period lasts for 1 year (365 days) from the date you purchased the Product. Your purchase date is printed on the receipt you received with the Product.

What does this warranty cover?

During the Warranty Period, if the original manufacture of the material or workmanship of the Product is determined to be defective by an authorized Insignia repair center or store personnel, Insignia will (at its sole option): (1) repair the Product with new or rebuilt parts; or (2) replace the Product at no charge with new or rebuilt comparable products or parts. Products and parts replaced under this warranty become the property of Insignia and are not returned to you. If service of Products or parts are required after the Warranty Period expires, you must pay all labor and parts charges. This warranty lasts as long as you own your Insignia Product during the Warranty Period. Warranty coverage terminates if you sell or otherwise transfer the Product.

How to obtain warranty service?

If you purchased the Product at a Best Buy retail store location or from a Best Buy online website (www.bestbuy.com or www.bestbuy.ca), please take your original receipt and the Product to any Best Buy store. Make sure that you place the Product in its original packaging or packaging that provides the same amount of protection as the original packaging.

To obtain warranty service, in the United States and Canada call 1-877-467-4289. Call agents may diagnose and correct the issue over the phone.

Where is the warranty valid?

This warranty is valid only in the United States and Canada at Best Buy branded retail stores or websites to the original purchaser of the product in the country where the original purchase was made.

What does the warranty not cover?

This warranty does not cover:

- Customer instruction/education
- Installation
- Set up adjustments
- Cosmetic damage
- Damage due to weather, lightning, and other acts of God, such as power surges
- Accidental damage
- Misuse
- Abuse
- Negligence
- Commercial purposes/use, including but not limited to use in a place of business or in communal areas of a multiple dwelling condominium or apartment complex, or otherwise used in a place of other than a private home.
- Modification of any part of the Product, including the antenna
- Display panel damaged by static (non-moving) images applied for lengthy periods (burn-in).

- Damage due to incorrect operation or maintenance
- Connection to an incorrect voltage or power supply
- Attempted repair by any person not authorized by Insignia to service the Product
- Products sold "as is" or "with all faults"
- Consumables, including but not limited to batteries (i.e. AA, AAA, C etc.)
- Products where the factory applied serial number has been altered or removed
- Loss or Theft of this product or any part of the product
- Display panels containing up to three (3) pixel failures (dots that are dark or incorrectly illuminated) grouped in an area smaller than one tenth (1/10) of the display size or up to five (5) pixel failures throughout the display. (Pixel based displays may contain a limited number of pixels that may not function normally.)
- Failures or Damage caused by any contact including but not limited to liquids, gels or pastes.

REPAIR REPLACEMENT AS PROVIDED UNDER THIS WARRANTY IS YOUR EXCLUSIVE REMEDY FOR BREACH OF WARRANTY. INSIGNIA SHALL NOT BE LIABLE FOR ANY INCIDENTAL OR CONSEQUENTIAL DAMAGES FOR THE BREACH OF ANY EXPRESS OR IMPLIED WARRANTY ON THIS PRODUCT, INCLUDING, BUT NOT LIMITED TO, LOST DATA, LOSS OF USE OF YOUR PRODUCT, LOST BUSINESS OR LOST PROFITS. INSIGNIA PRODUCTS MAKES NO OTHER EXPRESS WARRANTIES WITH RESPECT TO THE PRODUCT, ALL EXPRESS AND IMPLIED WARRANTIES FOR THE PRODUCT, INCLUDING BUT NOT LIMITED TO ANY IMPLIED WARRANTIES OF AND CONDITIONS OF MERCHANTABILITY AND FITNESS FOR A PARTICULAR PURPOSE, ARE LIMITED IN DURATION TO THE WARRANTY PERIOD SET FORTH ABOVE AND NO WARRANTIES, WHETHER EXPRESS OR IMPLIED, WILL APPLY AFTER THE WARRANTY PERIOD. SOME STATES, PROVINCES AND JURISDICTIONS DO NOT ALLOW LIMITATIONS ON HOW LONG AN IMPLIED WARRANTY LASTS, SO THE ABOVE LIMITATION MAY NOT APPLY TO YOU. THIS WARRANTY GIVES YOU SPECIFIC LEGAL RIGHTS, AND YOU MAY ALSO HAVE OTHER RIGHTS, WHICH VARY FROM STATE TO STATE OR PROVINCE TO PROVINCE.

Contact Insignia:

1-877-467-4289

www.insigniaproducts.com

INSIGNIA is a trademark of Best Buy and its affiliated companies.

*Distributed by Best Buy Purchasing, LLC

7601 Penn Ave South, Richfield, MN 55423 U.S.A.

©2020 Best Buy. All rights reserved.

INSIGNIA™

www.insigniaproducts.com
1-877-467-4289 (U.S. and Canada) or 01-800-926-3000 (Mexico)

INSIGNIA is a trademark of Best Buy and its affiliated companies.
Distributed by Best Buy Purchasing, LLC
©2020 Best Buy. All rights reserved.

V1 ENGLISH
20-0246