

DEHUMIDIFIER

USER MANUAL



Thank you for choosing our dehumidifier. All products offer one year warranty and please feel free to contact us via the shipping platform you bought for any questions. Please read this user manual before using this innovative dehumidifier and keep it safe for future reference.

CONTENTS

1. SAFETY INSTRUCTIONS	2
2. UNIT SPECIFICATIONS AND FEATURES.....	4
3. OPERATION INSTRUCTIONS	5
4. INSTALLATION INSTRUCTIONS	8
5. CARE AND CLEANING.....	8
6. TROUBLESHOOTING	10
7. DISPOSAL AND SERVICE.....	10

Read This Manual

Inside you will find many helpful hints on how to use and maintain your air conditioner properly. Just a little preventive care on your part can save you a great deal of time and money over the life of your air conditioner. You'll find many answers to common problems in the troubleshooting tips - you should be able to fix most of them quickly before calling service. These instructions may not cover every possible condition of use, so common sense and care for safety is required when installing, operating and maintaining this product.

CAUTION

- Contact the authorized service technician for repair or maintenance of this unit.
- The unit is not designed to be used by young children or people with reduced physical, sensory or mental capabilities without supervision.
- Young children should be supervised to ensure that they do not play with the unit.
- If the power cord needs to be replaced, please contact our consumer service and look for an authorized technician.
- Electrical installation, if needed, must be performed in accordance to national regulation standards by qualified personnel only.

1. SAFETY INSTRUCTIONS

To prevent injury to the user or other people and property damage, the instructions shown here must be followed. Incorrect operation due to ignoring of instructions may cause harm or damage. The level of risk is shown by the following indications.

WARNINGS

- Plug in power plug properly. Otherwise, it may cause electric shock or fire due to excess heat generation.
- Do not modify power cord length or share the outlet with other appliances. It may cause electric shock or fire due to overheat.
- Always ensure effective grounding. Incorrect grounding may cause electric shock.
- Unplug the unit if strange sounds, smell, or smoke comes from it. A damaged product may cause fire and electric shock.
- Ventilate room before operating the unit if there is a gas leak from other appliances.
- Do not operate or stop the unit by inserting or pulling out the power plug. It may cause electric shock.
- Do not allow water to touch electric parts. It may cause failure or electric shock.
- Do not use the socket if it is loose or damaged. It may cause fire and electric shock.
- Do not use or keep the power cord close to heating appliances or heat sources such as fireplaces. It may cause fire and electric shock.
- Do not disassemble or modify unit. It may cause failure and electric shock.
- Do not damage or use an unspecified power cord. It may cause fire and electric shock.
- If the power cord is damaged, it must be replaced by the manufacturer or an authorized service center or a similarly qualified person in order to avoid electrical risk.
- Do not use the unit near flammable gas or combustibles, such as gasoline, benzene, thinner, etc.
- Before cleaning, turn off the power and unplug the unit.
- Do not take the water bucket out during operation, the bucket full protection may be activated and risk electric shock.

CAUTION

- Do not use the unit in small spaces. Lack of ventilation can cause overheating and fire.
- Do not use in places where water may splash onto the unit. Water may enter the unit and degrade the insulation. It may cause an electric shock or fire.
- Place the unit on a level, sturdy section of the floor. If the unit falls over, it may cause water to spill and damage belongings, or cause electrical shock or fire.
- Never insert your finger or other foreign objects into grills or openings. Take special

care to warn children of these dangers. It may cause failure or electric shock.

- Do not climb up on or sit on the unit. You may be injured if you fall or if the unit falls over.
- Always insert the filters securely, and take caution to avoid injuries to hand and fingers. Clean filter once every two weeks.
- If water enters the unit, turn the unit off and disconnect the power, contact a qualified service technician.
- Do not place flower vases or other water container on top of the unit. Water may spill inside the unit, causing insulation failure and electrical shock or fire.
- If the unit is knocked over during use, turn off the unit and unplug it from the main power supply immediately. Visually inspect the unit to ensure there is no damage. If you suspect the unit has been damaged, contact a customer service or a qualified technician.
- In a thunderstorm, the power must be cut off to avoid damage to the unit due to lightning.
- Do not run cord under carpeting. Do not cover cord with throw rugs, runners, or similar coverings. Do not route cord under furniture or appliances. Arrange cord away from traffic area and where it will not be tripped over.

WARNING - Electrical Information

- Be sure the unit is properly grounded. To minimize shock and fire hazards, proper grounding is important. The power cord is equipped with a three-prong grounding plug for protection against shock hazards.
- Your unit must be used in a properly grounded wall receptacle. If the wall receptacle you intend to use is not adequately grounded or protected by a time delay fuse or circuit breaker, have a qualified electrician install the proper receptacle.
- Ensure the receptacle is accessible after the unit installation.
- Do not use extension cords or an adapter plugs with this unit. However, if it is necessary to use an extension cord, use an approved "dehumidifier" extension cord only (available at most local hardware stores).
- To avoid the possibility of personal injury, always disconnect the the unit from power supply, before installing and/or servicing.

WARNING - For your safety

- Do not store or use gasoline or other flammable vapors and liquids in the vicinity of this or any other appliance.
- Avoid fire hazard or electric shock. Do not use an extension cord or an adaptor plug. Do not remove any prong from the power cord.

2. UNIT SPECIFICATIONS AND FEATURES

PRODUCT OVERVIEW

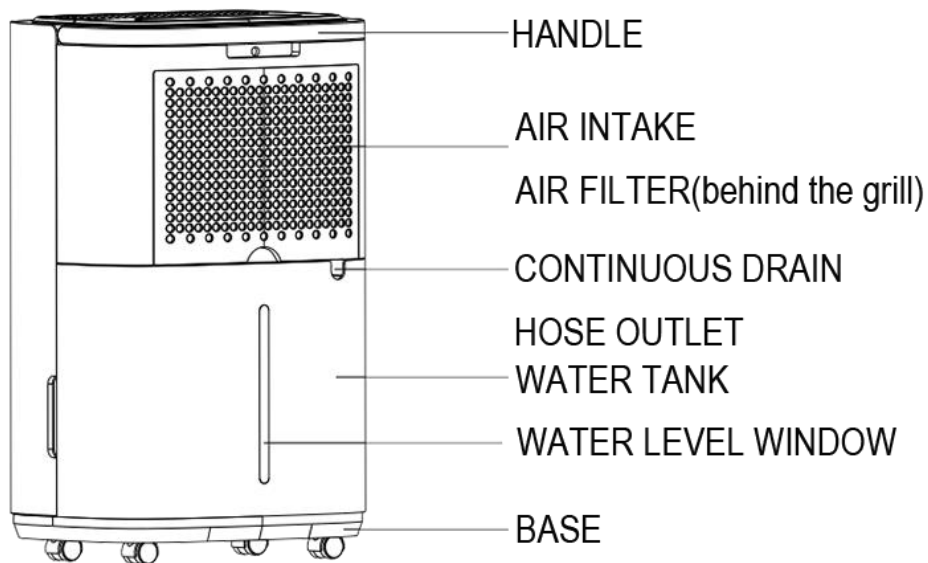
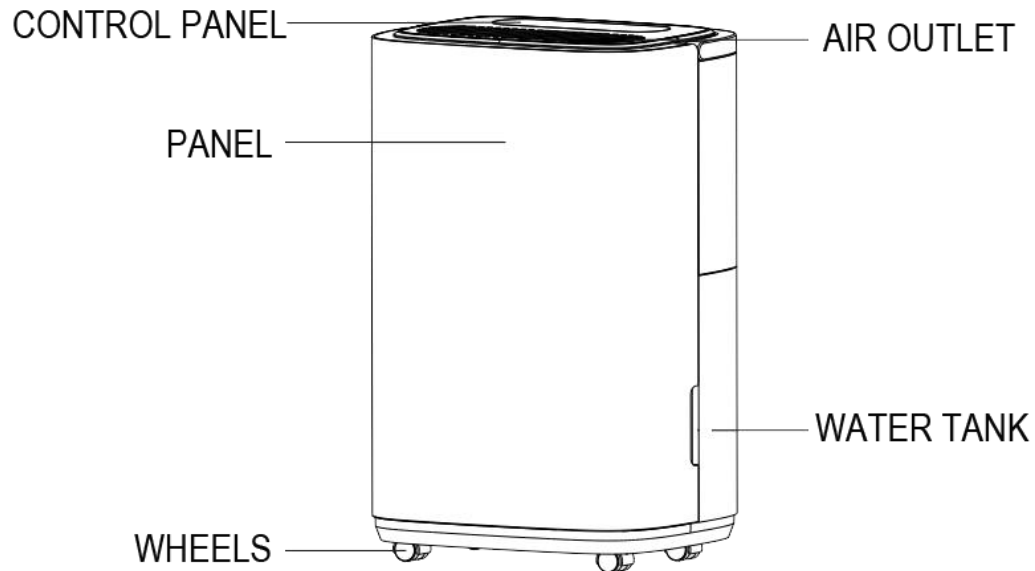

SPECIFICATIONS

MODEL			C10A1	C20A1
POWER SUPPLY		V-Hz	110V-60Hz	110V-60Hz
PERFORMANCE	Moisture Removal	35°C/90%	20-34pint/day	40-55pint/day
	Rated Input	W	243.7	457.6
	Rated Current	A	2.3	4.8

FAN SPEED			2	2
ON/OFF TIMER		H	24	24
SYSTEM	Refrigerant Type	R290	1.69oz	1.94oz
	Water Tank	L	2.2	6
	Noise Level	dB(A)	53	53
APPLICATION	Set RH Range		30%-80%RH	30%-80%RH
	Ambient Temp	°C	5-35	5-35
		°F	41-95	41-95
DIMENSIONS	Product	in	10.0x8.7x18.1	13.4x9.4x22.2
	Package	in	12.2x10.6x20.6	15.5x11.4x25.4
NET/GROSS WEIHGT		lb	20/24	30/35

3. OPERATION INSTRUCTIONS

CAUTION

- Clean your unit occasionally to keep it looking new. Be sure to unplug the unit before cleaning to prevent chock or fire hazards.
- The machine should be placed upright since there is inside compressor parts. All the machines will be inspected before shipment so it's a normal phenomenon that there is some water inside the hose or water tank. Please don't worry about it. All the machines are brand new.

KEY PAD FEATURES

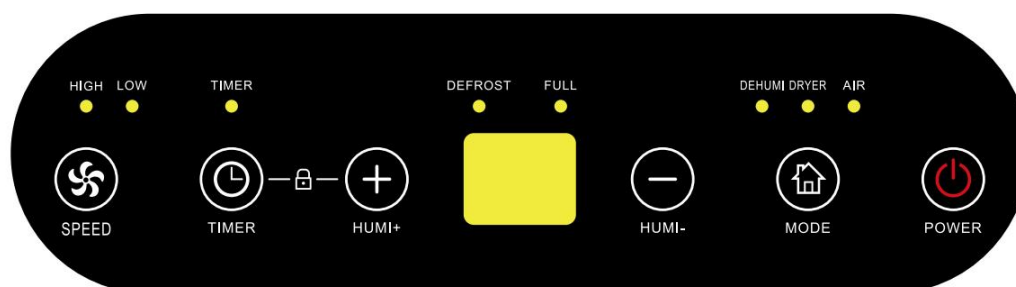

NOTE

- The control panel of the unit you purchased may be slightly different according to the models.
- When you push the button to change operation modes, the unit will make a beep sound to indicate that it is changing modes.

CONTROL PADS

1. (POWER) Button

Press to turn the dehumidifier on and off. Dehumidification mode is default. It will show room temp when it's off. Full light is on when the water tank is full.

2. (MODE) Button

Select the function of the unit between DEHUMI, DRYER and AIR modes. The LED will show which mode is selected. It takes 5s to switch the mode.

DEHUMIDIFYING MODE: The unit will default to DEHUMI mode for the first time it is switched on and remains in this mode until another program is chosen.

DRYER MODE: When it is turned on, set humidity is automatic and cannot be changed manually.

AIR MODE: The unit will run in fan mode and will not extract water for air circulation.

3. (TIMER) Button

Starts the Timer ON and Timer OFF function setting for 0-24 hours.

4. (+/-) Buttons

• Humidity Set Control Buttons

The humidity level can be set within a range of 30% RH (Relative Humidity) to 80% RH (Relative Humidity) .

For drier air, press the button and set to a lower value (%).

For damper air, press the button and set a higher value (%).

• TIMER Set Control Buttons

Use the and key buttons to set the Timer ON or Timer OFF from 0 to 24 hours.

5. (SPEED) Button

Speed choice can only be switched in DEHUMI and AIR mode.

6. LED Display

- Shows the set % humidity level from 30% to 80% or auto start/stop time (0 ~ 24) while setting, then shows the actual room % humidity level in a range of 20% RH (Relative Humidity) to 90% RH (Relative Humidity).

- When room humidity $\leq 20\%$, it shows "L0"; when $\geq 90\%$, it shows "H0".

7. (FULL) Indicator

When the water tank is full for 3s, the indicator will be on for reminder.

8. LOCK FUNCTION

Press "+" and "TIMER" together for 3s, the panel will be locked. It will display "Lc" for every 5s. Press again to unlock.

REMOVING COLLECTED WATER

There are 2 ways to remove collected water:

a. Use the bucket

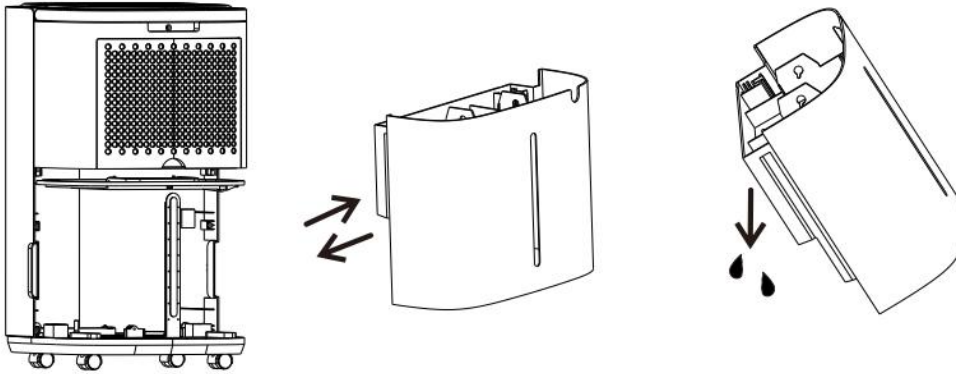

- When the unit is off, if the bucket is full, the Full indicator light will light.
- When the unit is on, if the bucket is full, the compressor and the fan turn off, and the Full indicator light will light.
- Slowly pull out the bucket. Grip the left and right handles securely, and carefully pull out straight so water does not spill.
- Throw away the water and reposition the bucket.
- The unit will restart operation when the bucket back it out from the unit.

NOTES:

- When you remove the bucket, do not touch any parts inside the unit. Doing so may damage the product.
- **Be sure to push the bucket gently all the way into the unit or the machine will stop working.**

b. Continuous draining

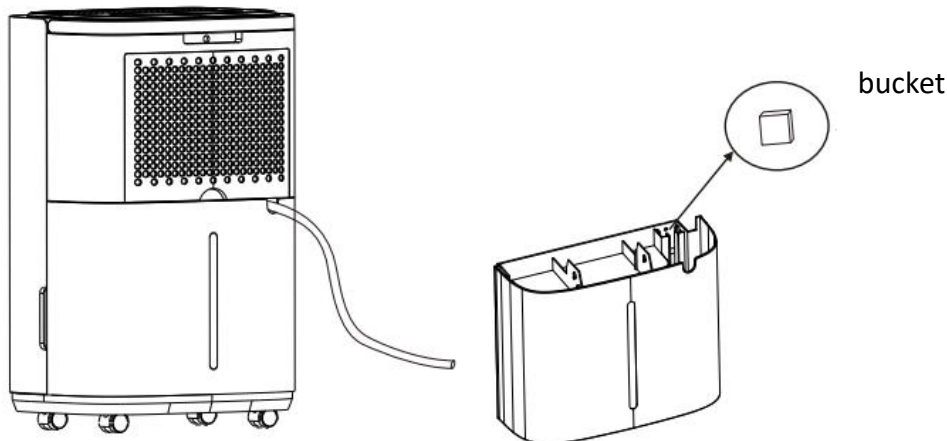

- Water can be automatically emptied into a floor drain by attaching the unit with a

water hose.

- Remove the plastic cover from the back drain outlet of the unit and set aside, then insert the drain hose through the drain outlet of the unit and lead the drain hose to the floor drain or a suitable drainage facility.
- When you remove the plastic cover, if there is some water in the back drain outlet of the unit you must dry it. Make sure the hose is secure so there are no leaks and the end of the hose is level or down to let the water flow.
- Direct the hose toward the drain, making sure that there are no kinks that will stop the water flowing.

4. INSTALLATION INSTRUCTIONS

POSITIONING THE UNIT

A dehumidifier operating in a basement will have little or no effect in drying an adjacent enclosed storage area, such as a closet, unless there is adequate circulation of air in and out of the area.

- Do not use outdoors.
- This dehumidifier is intended for indoor residential applications only. This dehumidifier should not be used for commercial or industrial applications.
- Place the dehumidifier on a smooth, level floor strong enough to support the unit with a full bucket of water.



- Allow at least 8 inches of air space on all sides of the unit for air circulation (at least 16 inches for air outlet).
- Place the unit in an area where the temperature will not fall below 41°F (5°C). The coils can become covered with frost at lower temperatures, which may reduce performance.
- Place the unit away from any clothes dryer, heater or radiator.
- Close all doors, windows and other outside openings to the room.

5. CARE AND CLEANING

Turn the dehumidifier off and disconnect the plug from the wall before cleaning.

a. Clean the Grill and Case

- Use water and a mild detergent. Do not use bleach or abrasives.
- Do not splash water directly onto the unit. Doing so may cause an electrical shock, cause the insulation to deteriorate, or cause the unit to rust.
- The air intake and outlet may get dirty during operation, use a vacuum cleaner or

brush to clean.

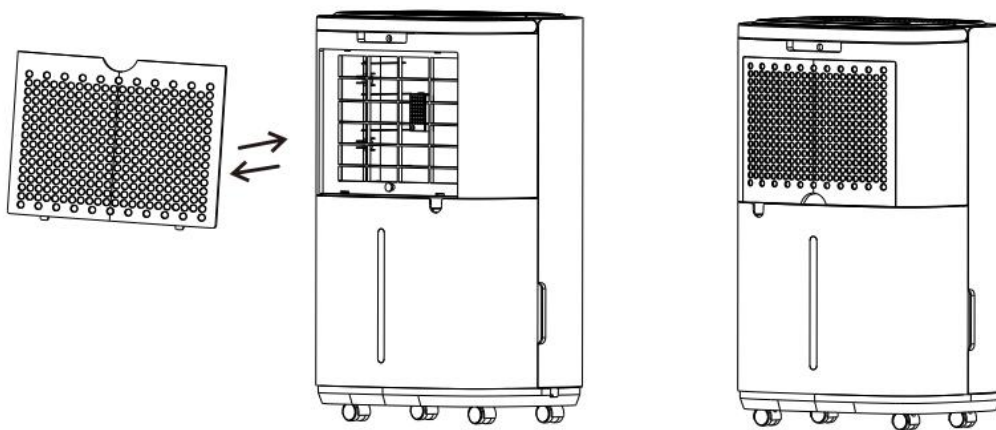

b. Clean the bucket

Every few weeks, clean the bucket thoroughly to prevent growth of mold, mildew and bacteria. Partially fill the bucket with clean water and mild detergent.

NOTE: Do not use a dishwasher to clean the bucket.

c. Clean the air filter

To remove the filter, pull filter outwards. Wash the filter with clean water then dry. Re-install the filter, replace bucket.

CAUTION: DO NOT operate the dehumidifier without a filter to avoid loss of performance and damage to the unit.

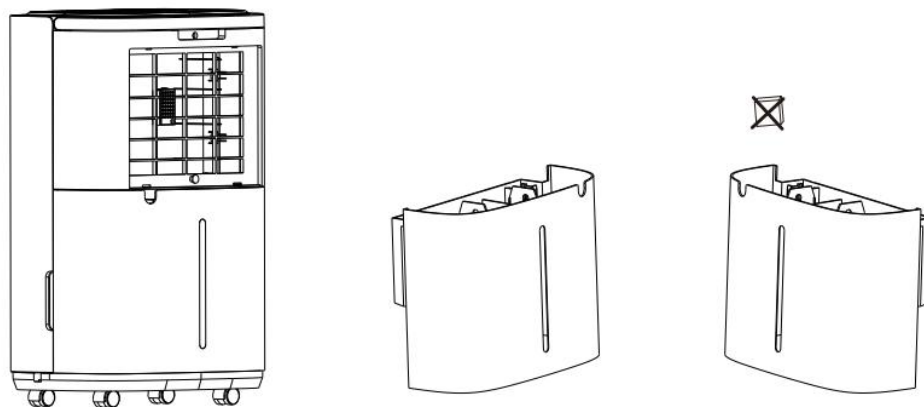

d. When not using the unit for long time periods

- Before storing the unit, let it rest for one full day so that the system can dry out naturally.
- Clean the unit, water bucket and air filter.
- Wrap the cord with the power cord buckle.
- Cover the unit with a plastic bag.
- Store the unit upright in a dry, well-ventilated place.

6. TROUBLESHOOTING

Before calling for service, review this list. It may save you time and money. This list includes common occurrences that are not the result of defective workmanship or materials in this appliance.

Unit does not start	Make sure the dehumidifiers plug is connected firmly into the wall outlet.
	Check the house fuse/circuit breaker box.
	Dehumidifier has reached its preset level or bucket is full.
	Water bucket is not in the proper position.
Dehumidifier does not dry the air as it should	Not enough time to remove the moisture.
	Make sure there are no curtains, blinds or furniture blocking the front or back of the dehumidifier.
	The humidity control may not be set low enough.
	Check that all doors, windows and other openings are securely closed.
	Room temperature is too low, below 5°C(41°F).
The unit makes loud noise when operating	There is a water vapor source in the room.
	Air filter may be dirty. Clean filter. Refer to Care and Cleaning section.
	The unit is tilted instead of upright as it should be.
Water on floor	The floor surface is not level.
	Hose to connector or hose connection may be loose.
Frost appears on the coils	Intend to use the bucket to collect water, but the back drain plug is removed.
	This is normal. The dehumidifier has Auto defrost feature.
E1 error	Humiture sensor is damaged.
CL error	$RT \leq 41^{\circ}\text{F}$, will work normally when room temp goes up.
CH error	$RT \geq 100^{\circ}\text{F}$, will work normally when room temp goes down.
L0 error	$RH \leq 20\%$, will work normally when room humidity goes up.
H0 error	$RH \geq 90\%$, will work normally when room humidity goes down.

7. DISPOSAL AND SERVICE

Disposal

Do not dispose this product as unsorted waste. Collection of such waste must be handled separately as special treatment is necessary.

Recycling facilities are now available for all customers at which you can deposit your old electrical products. Customers will be able to take any old electrical equipment to participating sites run by their local councils. Please remember that this equipment will be further handled during the recycling process, so please be considerate when depositing your equipment. Please contact the local council for details of your local household waste recycling



AFTERSALE SERVICE

Thank you for choosing our dehumidifier. All products offer one year warranty and please feel free to contact us via the shipping platform you bought for any questions and we will reply in 24 hours.

Please do share your shopping experience on the platform if you're satisfied with our products and service. Thanks again for choosing us.