

## Nice to Meet You

In the days to come,  
oneisall pet feeder would help you feed your lovely  
pets well. Just set it and forget it.

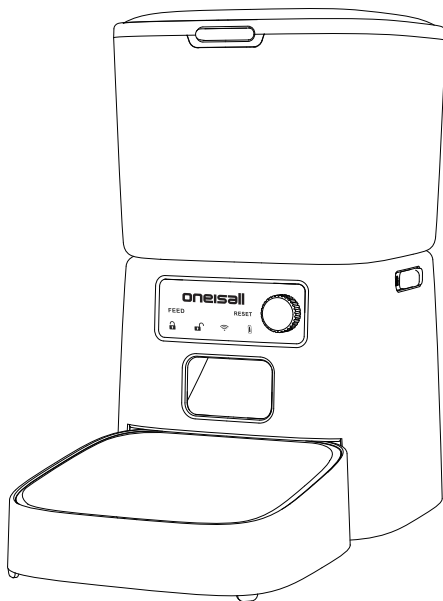

# LED Display Introduction

---

FEED: Manual feed

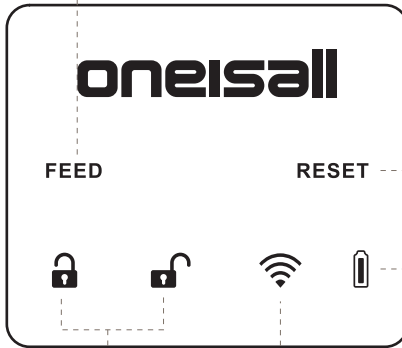

FEED

RESET

RESET: Clean all settings

Battery icon

Locked/Unlock

WIFI indicator

1. The feeder would lock itself if you don't operate it and wait for 30 seconds.
2. Press and hold the dial for 3 seconds to unlock the feeder.
3. The display will turn off after 30 seconds no operation, you can rotate the dial to reactivate the screen.

# Connect to APP

---

1. Download and install the Smart Life app.



Smart Life

**Note:**

To proceed with the installation and sign-up process, please grant the necessary authorization. Upon entering your email address, you will receive a verification code. It is essential to enter this code before proceeding to set your account password.

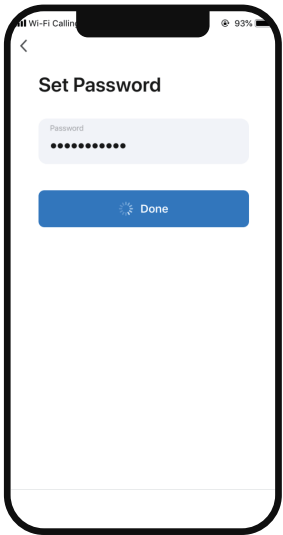
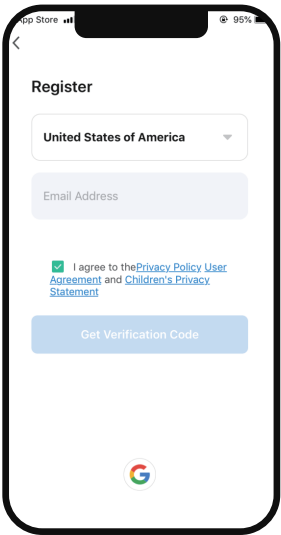

2. Turn on the Bluetooth feature on your mobile phone is turned on. Next, connect your phone to a Wi-Fi network and enable GPS location services. Only supports 2.4G Hz WiFi network, not support 5G HZ and 2.4G/5G dual-band WiFi network.  
Support system is IOS10.0 or later, Android 5.0 or later.



3. To activate the feeder, first, turn it on. Press and hold the dial button for approximately 3 seconds to unlock it. Then, rotate the dial to the RESET icon and hold it for 5 seconds. You will notice that the WIFI icon will turn red and start flashing.

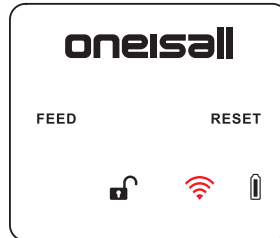
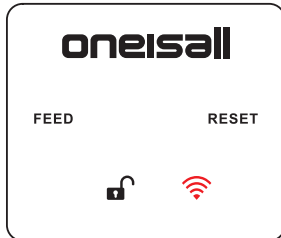

**Note:**

If you are using batteries as the sole power supply for the feeder, a battery icon will be displayed on the device.

4. On the app, locate the "+" symbol on the right side and click on it to add a new feeder to your account.

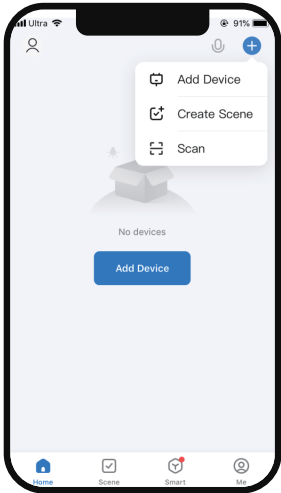

5. Within the app, utilize the “Add Device” feature to detect the device as depicted in the provided image.  
The model name of the device should be PFD-001Pro. Once the device is identified, click on the "Add" button to proceed.

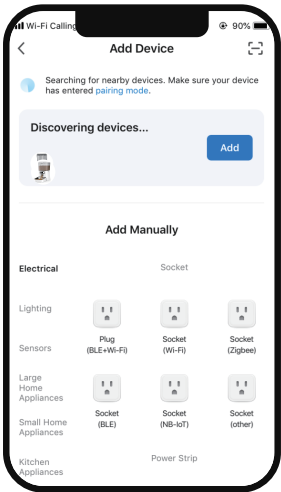

6. When connecting the feeder for the first time or switching to a new Wi-Fi network, the system will prompt you to enter the Wi-Fi password. Please select the 2.4GHz Wi-Fi network and enter the password. If your Wi-Fi is 5GHz, please set it to 2.4GHz first. (Common router setting methods)

7. Please wait patiently for the connection to be established and succeed. This may take a few moments.

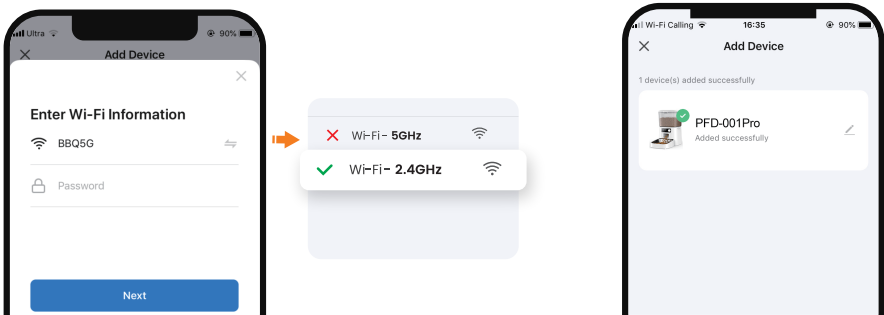

8. Once the connection is successfully established, click on the "Done" button to finalize the setup. You will notice that the WIFI icon on the device will turn white and stop blinking.

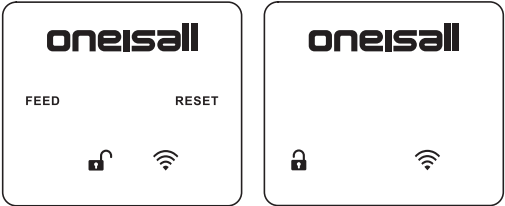

**Note:**

- When connecting the feeder to the power outlet, please note that the middle menu bar on the device will disappear automatically after 5 seconds of no user interaction.
- When using batteries as the sole power supply, it's important to be aware that the entire screen will turn black after 30 seconds of inactivity. To reactivate the screen, simply turn the dial as desired, and it will light up again.

# Manual Feeding Setting

---

1. Once the connection process is completed, the mobile phone will automatically open the settings menu.
2. Choose the desired number of portions by selecting the appropriate value, and then click on the "Manual" option. In accordance with the provided image, the feeder will dispense 5 portions.

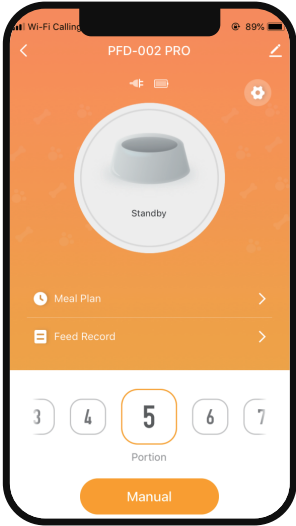
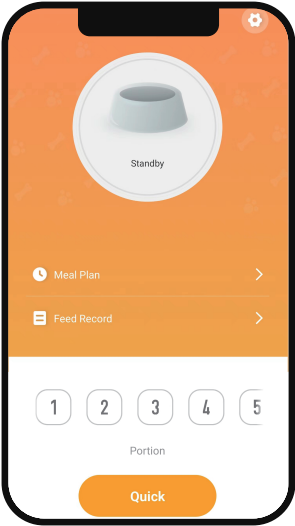

# Feeding Schedule Settings

1. Click on the "Meal Plan" option to access the feeding plan setting interface. Tap on "Add" option to set feeding schedule.

2. Select the desired number of days of the week for feeding. Then, choose the feeding time and specify the number of portions for each feeding.

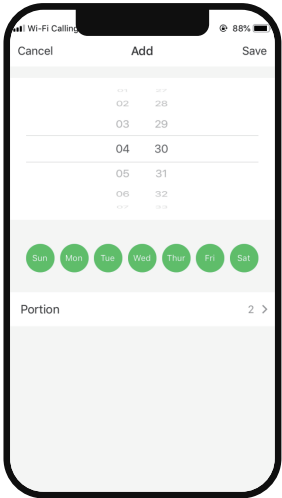
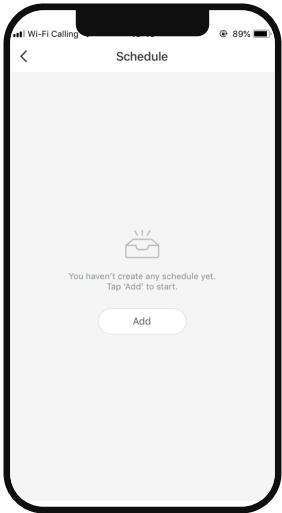



Once the settings are properly configured, you will obtain a schedule as illustrated below:

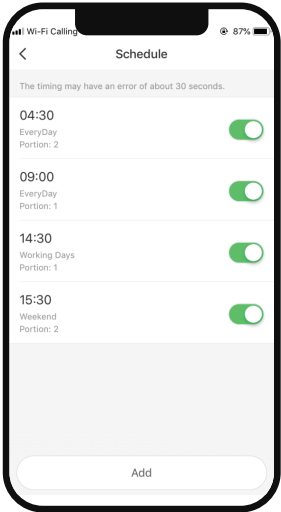

You have the flexibility to set up to 10 meals in total, with a maximum of 36 portions per meal.

# Daily Feeding Recommendation

---

Daily Food Amount	1/8 cup	1/4 cup	1/3 cup	1/2 cup	1 cup
Recommended Portions	2	3	4	6	12
Grams	15	29	38	57	114

We recommend feeding your pet 3-6 meals per day.  
For example, DaMeng needs 1/2 cup a day. The daily amount should be 6 portions in total. We feed him 3 meals a day, the portion should be 2 per meal.

**Note:**  
The PORTION number means the amount for one bowl.