

INSIGNIA™

## QUICK SETUP GUIDE

# New 3DS™ Charge Station

NS-GN3DSCS101 / NS-GN3DSCS101-C /  
NS-GN3DSCS101-C2

## PACKAGE CONTENTS

- New 3DS XL charge station
- AC power adapter
- Quick Setup Guide

## FEATURES

- Designed to charge the New Nintendo 3DS™ XL system
- Increases the playing time of the New Nintendo 3DS™ XL systems

Before using your new product, please read these instructions to prevent any damage.

## SETTING UP THE CHARGE STATION

- 1 Insert one end of the AC adapter into the charge station, then connect the other end to a wall outlet.

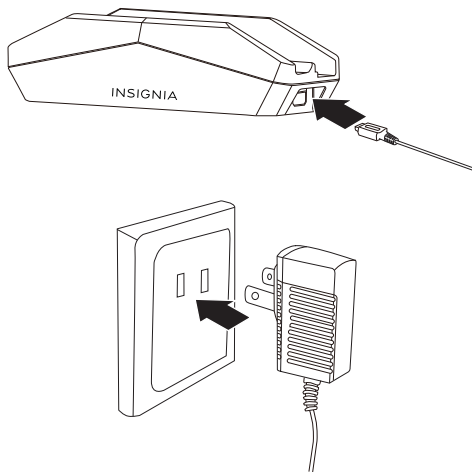

- 2 Place the New 3DS XL into the charging port on the station.

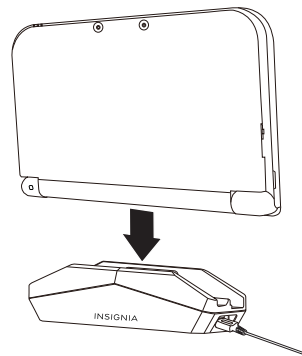

The recharge LED on the console lights orange during charging and turns off when the battery is fully charged.

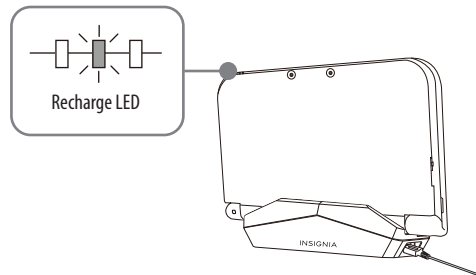

## SPECIFICATIONS

AC adapter: input: AC110V ~ 240V

AC adapter: output: DC 5V 1A

Charge station input: DC 5V 1A

Charge station output: DC 5V 1A

## SAFETY INFORMATION/CAUTION

- You must use the included AC power adapter to power the charge station.
- Do not disassemble any of the components. Refer all services to qualified personnel only.
- Do not place or store the product in a humid area and do not expose it to water or rain.
- Use the product only as instructed. Read all instructions before operating the product.
- Failure to follow these directions may void the warranty.

## LEGAL NOTICES

### FCC Information

This device complies with part 15 of the FCC Rules. Operation is subject to the following two conditions: (1) This device may not cause harmful interference, and (2) this device must accept any interference received, including interference that may cause undesired operation.

**Warning:** Changes or modifications to this unit not expressly approved by the party responsible for compliance could void the user's authority to operate the equipment.

**Note:** This equipment has been tested and found to comply with the limits for a Class B digital device, pursuant to Part 15 of the FCC Rules. These limits are designed to provide reasonable protection against harmful interference in a residential installation. This equipment generates, uses and can radiate radio frequency energy and, if not installed and used in accordance with the instructions, may cause harmful interference to radio communications. However, there is no guarantee that interference will not occur in a particular installation. If this equipment does cause harmful interference to radio or television reception, which can be determined by turning the equipment off and on, the user is encouraged to try to correct the interference by one or more of the following measures:

- Reorient or relocate the receiving antenna.
- Increase the separation between the equipment and receiver.
- Connect the equipment into an outlet on a circuit different from that to which the receiver is connected.
- Consult the dealer or an experienced radio/TV technician for help.

### ICES-003 statement

This Class B digital apparatus complies with Canadian ICES-003.

Cet appareil numérique de la classe B est conforme à la norme NMB-003 du Canada.

## ONE-YEAR LIMITED WARRANTY

Visit [www.insigniaproducts.com](http://www.insigniaproducts.com) for details.

## CONTACT INSIGNIA:

For customer service, call 1-877-467-4289 (U.S. and Canada) or 01-800-926-3000 (Mexico)

[www.insigniaproducts.com](http://www.insigniaproducts.com)

Other parties' marks are the property of their respective owners.

INSIGNIA is a trademark of Best Buy and its affiliated companies.

Distributed by Best Buy Purchasing, LLC

©2016 Best Buy. All rights reserved.

**Made in China**