

KENWOOD

DPX793BH

DPX593BT

DPX540BT

DPX523BT

DPX503BT

DUAL DIN SIZED CD RECEIVER

INSTRUCTION MANUAL

RECEPTEUR CD FORMAT DUAL DIN

MODE D'EMPLOI

RECEPTOR DUAL DE CD TAMAÑO DIN

MANUAL DE INSTRUCCIONES

JVCKENWOOD Corporation

DPX303MBT

DUAL DIN SIZED DIGITAL MEDIA RECEIVER

INSTRUCTION MANUAL

AUTORADIO MULTIMÉDIA NUMÉRIQUE DEUX DIN

MODE D'EMPLOI

RECEPTOR DE MEDIOS DIGITALES TAMAÑO DOBLE DIN

MANUAL DE INSTRUCCIONES

For your records

Record the serial number, found on the back of the unit, in the spaces designated on the warranty card, and in the space provided below.

Refer to the model and serial numbers whenever you call upon your Kenwood dealer for information or service on the product.

Model DPX793BH/DPX593BT/DPX540BT/DPX523BT/DPX503BT/DPX303MBT

Serial number _____

US Residents Only

Register Online

Register your Kenwood product at <http://www.kenwood.com/usa/>

For **DPX793BH** / **DPX593BT** / **DPX540BT** / **DPX523BT** / **DPX503BT** :

CAUTION

Use of controls or adjustments or performance of procedures other than those specified herein may result in hazardous radiation exposure.
In compliance with Federal Regulations, following are reproductions of labels on, or inside the product relating to laser product safety.

JVC KENWOOD Corporation
2967-3, ISHIKAWA-MACHI,
HACHIOJI-SHI, TOKYO, JAPAN

THIS PRODUCT COMPLIES WITH DHHS RULES 21CFR
SUBCHAPTER J IN EFFECT AT DATE OF MANUFACTURE.

Location : Top Plate

FCC WARNING

This equipment may generate or use radio frequency energy. Changes or modifications to this equipment may cause harmful interference unless the modifications are expressly approved in the instruction manual. The user could lose the authority to operate this equipment if an unauthorized change or modification is made.

FCC NOTE

This equipment has been tested and found to comply with the limits for a Class B digital device, pursuant to Part 15 of the FCC Rules. These limits are designed to provide reasonable protection against harmful interference in a residential installation. This equipment may cause harmful interference to radio communications, if it is not installed and used in accordance with the instructions. However, there is no guarantee that interference will not occur in a particular installation. If this equipment does cause harmful interference to radio or television reception, which can be determined by turning the equipment off and on, the user is encouraged to try to correct the interference by one or more of the following measures:

- Reorient or relocate the receiving antenna.
- Increase the separation between the equipment and receiver.
- Connect the equipment into an outlet on a circuit different from that to which the receiver is connected.
- Consult the dealer or an experienced radio/TV technician for help.

CALIFORNIA, USA ONLY

This product contains a CR Coin Cell Lithium Battery which contains Perchlorate Material—special handling may apply. See www.dtsc.ca.gov/hazardouswaste/perchlorate

Información acerca de la eliminación de equipos eléctricos y electrónicos al final de la vida útil (aplicable a los países que hayan adoptado sistemas independientes de recogida de residuos)



Los productos con el símbolo de un contenedor con ruedas tachado no podrán ser desechados como residuos domésticos. Los equipos eléctricos y electrónicos al final de la vida útil, deberán ser reciclados en instalaciones que puedan dar el tratamiento adecuado a estos productos y a sus subproductos residuales correspondientes. Póngase en contacto con su administración local para obtener información sobre el punto de recogida más cercano. Un tratamiento correcto del reciclaje y la eliminación de residuos ayuda a conservar los recursos y evita al mismo tiempo efectos perjudiciales en la salud y el medio ambiente.

Informação sobre a eliminação de pilhas

Este produto não deve ser eliminado como lixo doméstico geral. Devolva a pilha usada ao revendedor ou entidade autorizada para que a mesma seja devolvida ao fabricante ou importador. A reciclagem e a eliminação de lixo de maneira apropriada ajudarão a conservar os recursos naturais ao mesmo tempo que prevenirão os efeitos prejudiciais à nossa saúde e ao meio ambiente.

libFLAC

Copyright (C) 2000-2009 Josh Coalson

Copyright (C) 2011-2013 Xiph.Org Foundation

Redistribution and use in source and binary forms, with or without modification, are permitted provided that the following conditions are met:

- Redistributions of source code must retain the above copyright notice, this list of conditions and the following disclaimer.
- Redistributions in binary form must reproduce the above copyright notice, this list of conditions and the following disclaimer in the documentation and/or other materials provided with the distribution.
- Neither the name of the Xiph.org Foundation nor the names of its contributors may be used to endorse or promote products derived from this software without specific prior written permission.

THIS SOFTWARE IS PROVIDED BY THE COPYRIGHT HOLDERS AND CONTRIBUTORS "AS IS" AND ANY EXPRESS OR IMPLIED WARRANTIES, INCLUDING, BUT NOT LIMITED TO, THE IMPLIED WARRANTIES OF MERCHANTABILITY AND FITNESS FOR A PARTICULAR PURPOSE ARE DISCLAIMED. IN NO EVENT SHALL THE FOUNDATION OR CONTRIBUTORS BE LIABLE FOR ANY DIRECT, INDIRECT, INCIDENTAL, SPECIAL, EXEMPLARY, OR CONSEQUENTIAL DAMAGES (INCLUDING, BUT NOT LIMITED TO, PROCUREMENT OF SUBSTITUTE GOODS OR SERVICES; LOSS OF USE, DATA, OR PROFITS; OR BUSINESS INTERRUPTION) HOWEVER CAUSED AND ON ANY THEORY OF LIABILITY, WHETHER IN CONTRACT, STRICT LIABILITY, OR TORT (INCLUDING NEGLIGENCE OR OTHERWISE) ARISING IN ANY WAY OUT OF THE USE OF THIS SOFTWARE, EVEN IF ADVISED OF THE POSSIBILITY OF SUCH DAMAGE.

IC (Industry Canada) Notice

This device complies with Industry Canada's licence-exempt RSSs.

Operation is subject to the following two conditions:

- (1) This device may not cause interference; and
- (2) This device must accept any interference, including interference that may cause undesired operation of the device.

Note de IC (Industrie Canada)

Le présent appareil est conforme aux CNR d'Industrie Canada applicables aux appareils radio exempts de licence.

L'exploitation est autorisée aux deux conditions suivantes:

- (1) l'appareil ne doit pas produire de brouillage;
- (2) l'utilisateur de l'appareil doit accepter tout brouillage radioélectrique subi, même si le brouillage est susceptible d'en compromettre le fonctionnement.

(For **DPX793BH**)

Contains Bluetooth Module	FCC ID:	ZWY8350X
	IC ID:	12033A-8350X

(For **DPX593BT** / **DPX540BT** / **DPX523BT** / **DPX503BT** / **DPX303MBT**)

Contains Bluetooth Module	FCC ID:	ZWY8811X
	IC ID:	12033A-8811X

This transmitter must not be co-located or operated in conjunction with any other antenna or transmitter.

CAUTION

This equipment complies with FCC/IC radiation exposure limits set forth for an uncontrolled environment and meets the FCC radio frequency (RF) Exposure Guidelines and RSS-102 of the IC radio frequency (RF) Exposure rules. This equipment has very low levels of RF energy that is deemed to comply without maximum permissive exposure evaluation (MPE). But it is desirable that it should be installed and operated keeping the radiator at least 20cm or more away from person's body.

ATTENTION

Cet équipement est conforme aux limites d'exposition aux rayonnements énoncées pour un environnement non contrôlé et respecte les règles les radioélectriques (RF) de la FCC lignes directrices d'exposition et d'exposition aux fréquences radioélectriques (RF) CNR-102 de l'IC. Cet équipement émet une énergie RF très faible qui est considérée comme conforme sans évaluation de l'exposition maximale autorisée (MPE). Cependant, il est souhaitable qu'il devrait être installé et utilisé en gardant une distance de 20 cm ou plus entre le radiateur et le corps humain.

Para cumplimiento de la IFT:

"La operación de este equipo está sujeta a las siguientes dos condiciones:

- (1) es posible que este equipo o dispositivo no cause interferencia perjudicial y
- (2) este equipo o dispositivo debe aceptar cualquier interferencia, incluyendo la que pueda causar su operación no deseada"

SOFTWARE LICENSE AGREEMENT

The software embedded in the Product (hereinafter the "Licensed Software") provided by Licensor is copyrighted to or sublicensable by the Licensor, and this Agreement provides for the terms and conditions which Users shall follow in order to use the Licensed Software.

The User shall use the Licensed Software by agreeing with the terms of this Software License Agreement. This Agreement shall be deemed completed at the time the User (hereinafter the "User") initially used the Product in which the "Licensed Software" is embedded.

The Licensed Software may include the software which has been licensed to the Licensor directly or indirectly from any third party. In such case, some third parties require the Users to follow their conditions for use separately from this Software License Agreement. Such software shall not be subject to this Agreement, and the Users are urged to read the "Important Notice concerning the Software" to be provided separately below.

Article 1 General Provision

The Licensor shall grant to the User a non-exclusive and non-transferable (other than the exceptional case referred to in Article 3, Paragraph 1) licensed to use the Licensed Software within the country of the User. (the country where the User bought the Product(hereinafter the "Country"))

Article 2 License

1. The license granted under this Agreement shall be the right to use the Licensed Software in the Product.
2. The User shall not duplicate, copy, modify, add, translate or otherwise alter, or lease the Licensed Software and any related documents, whether in whole or in part.
3. The use of the Licensed Software shall be limited to personal purpose, and the Licensed Software shall not be distributed, licensed or sub-licensed whether it is for commercial purpose or not.
4. The User shall use the Licensed Software according to the directions described in the operation manual or help file, and is prohibited to use or duplicate any data in a manner violating the Copyright Law or any other laws and regulations by applying whole or a part of the Licensed Software.

Article 3 Conditions for Grant of License

1. When the User transfers the Product, it may also transfer the license to use the Licensed Software embedded in the Product (including any related materials, updates and upgrades) on condition that no original, copies or related materials continue in the possession of the User, and that the User shall cause the transferee to comply with this Software License Agreement.
2. The User shall not carry out reverse engineering, disassembling, decompiling or any other code analysis works in connection with the Licensed Software.

Article 4 Right pertaining to the Licensed Software

Any and all copyrights and other rights pertaining to the Licensed Software and related documents shall belong to the Licensor or the original holder of the right who granted to the Licensor the license or sublicense for the Licensed Software (hereinafter the "Original Rightholder"), and the User shall not be entitled to any right other than the license granted hereunder, in respect of the Licensed Software and any related documents.

Article 5 Indemnification of Licensor

1. Neither the Licensor nor the Original Rightholder shall be liable for any damage incurred by the User or any third party due to the exercise of the license granted to the User under this Agreement, unless otherwise restricted by law.
2. The Licensor will offer no guarantee for the merchantability, convertibility and consistency with certain objective of the Licensed Software.

Article 6 Liability to Third Party

If any dispute has arisen with any third party due to an infringement upon a copyright, patent or any other intellectual property right that was caused by the User's use of the Licensed Software, the User shall settle such dispute at its own cost and hold the Licensor and the Original Rightholder harmless from any inconvenience it may cause.

Article 7 Confidentiality

The User shall keep the confidentiality of such portion of the Licensed Software, related documents thereof or any other information to be granted under this Agreement, as well as the conditions of this Agreement as has not yet entered the public domain, and shall not disclose or divulge the same to any third party without approval of the Licensor.

Article 8 Termination

In case the User falls under any of the events described in the following items, the Licensor may immediately terminate this Agreement or claim that the User compensates for the damage incurred by the Licensor due to such event:

- (1) when the User violated any provision of this Agreement; or
- (2) when a petition has been filed against the User for an attachment, provisional attachment, provisional disposition or any other compulsory execution.

Article 9 Destruction of the Licensed Software

If this Agreement is terminated pursuant to the provision of Article 8, the User shall destroy the Licensed Software, any related documents and copies thereof within two (2) weeks from such date of termination.

Article 10 Protection of Copyright

1. The copyright and all the other intellectual property rights relating to the Licensed Software shall belong to the Licensor and the Original Rightholder, and in no event shall they be under the ownership of the User.
2. The User shall, whenever it uses the Licensed Software, comply with any laws relating to the copyright and other intellectual property rights.

Article 11 Export Restriction

1. It is prohibited to export the Licensed Software and any related documents outside the country of the User (including transmission thereof outside the country of the User via Internet or other communication tools).
2. The User shall understand that the Licensed Software shall be subject to the export restrictions adopted by the country of User and any other countries.
3. The User shall agree that the software will be subject to any and all applicable international and domestic laws (including the export control regulation of the country of User and any other countries, and any restrictions concerning the end-users, the use by end-users and importing countries to be provided by the country of User and any other countries, and any other governmental authorities).

Article 12 Miscellaneous

1. In the event any part of this Agreement is invalidated by operation of law, the residual provisions shall continue in force.
2. Matters not stipulated in this Agreement or any ambiguity or question raised in the construction of this Agreement shall be provided or settled upon good-faith consultation between the Licensor and the User.
3. The Licensor and the User hereby agree that this Agreement is governed by the laws of Japan, and any dispute arising from, and relating to the rights and obligations under, this Agreement shall be submitted to the exclusive jurisdiction of the Tokyo District Court for its first instance.

Important Notice concerning the Software

-jansson

Copyright (c) 2009-2012 Petri Lehtinen <petri@digip.org>

Permission is hereby granted, free of charge, to any person obtaining a copy of this software and associated documentation files (the "Software"), to deal in the Software without restriction, including without limitation the rights to use, copy, modify, merge, publish, distribute, sublicense, and/or sell copies of the Software, and to permit persons to whom the Software is furnished to do so, subject to the following conditions:

The above copyright notice and this permission notice shall be included in all copies or substantial portions of the Software.

THE SOFTWARE IS PROVIDED "AS IS", WITHOUT WARRANTY OF ANY KIND, EXPRESS OR IMPLIED, INCLUDING BUT NOT LIMITED TO THE WARRANTIES OF MERCHANTABILITY, FITNESS FOR A PARTICULAR PURPOSE AND NONINFRINGEMENT. IN NO EVENT SHALL THE AUTHORS OR COPYRIGHT HOLDERS BE LIABLE FOR ANY CLAIM, DAMAGES OR OTHER LIABILITY, WHETHER IN AN ACTION OF CONTRACT, TORT OR OTHERWISE, ARISING FROM, OUT OF OR IN CONNECTION WITH THE SOFTWARE OR THE USE OR OTHER DEALINGS IN THE SOFTWARE.

CONTENTS

BEFORE USE	2
BASICS	3
GETTING STARTED	4
1 Select the display language and cancel the demonstration	
2 Set the clock and date	
3 Set the initial settings	
HD Radio™ tuner	6
RADIO	8
CD/USB/iPod/ANDROID	10
AUX	13
Pandora®	13
iHeartRadio®	15
Spotify	16
SiriusXM® Radio	17
BLUETOOTH®	20
AUDIO SETTINGS	29
DISPLAY SETTINGS	32
LEARNING STEERING REMOTE CONTROL	33
REFERENCES	34
Maintenance	
More information	
INSTALLATION/ CONNECTION	37
TROUBLESHOOTING	41
SPECIFICATIONS	44

BEFORE USE

IMPORTANT

- To ensure proper use, please read through this manual before using this product. It is especially important that you read and observe Warning and Caution in this manual.
- Please keep the manual in a safe and accessible place for future reference.

⚠ WARNING

- **Do not operate any function that takes your attention away from safe driving.**
- **Do not ingest the battery, Chemical Burn Hazard**

The remote control supplied with this product contains a coin/button cell battery.

If the coin/button cell battery is swallowed, it can cause severe internal burns in just 2 hours and can lead to death.

Keep new and used batteries away from children.

If the battery compartment does not close securely, stop using the product and keep it away from children.

If you think batteries might have been swallowed or placed inside any part of the body, seek immediate medical attention.

⚠ Caution

Volume setting:

- Adjust the volume so that you can hear sounds outside the car to prevent accidents.
- Lower the volume before playing digital sources to avoid damaging the speakers by the sudden increase of the output level.

General:

- Avoid using the external device if it might hinder safe driving.
- Make sure all important data has been backed up. We shall bear no responsibility for any loss of recorded data.
- Never put or leave any metallic objects (such as coins or metal tools) inside the unit to prevent a short circuit.
- Except **[DPX303MBT]** : If a disc error occurs due to condensation on the laser lens, eject the disc and wait for the moisture to evaporate.
- Depending on the types of cars, the antenna will automatically extend when you turn on the unit with the antenna control wire connected (➔ 39). Turn off the unit or change the source to STANDBY when parking at a low ceiling area.

Remote control (RC-406):

- Do not leave the remote control in hot places such as on the dashboard.
- The Lithium battery is in danger of explosion if replaced incorrectly. Replace it only with the same or equivalent type.
- The battery pack or batteries shall not be exposed to excessive heat such as sunshine, fire or the like.

How to read this manual

- Operations are explained mainly using buttons on the faceplate of **[DPX793BH]**.
- English indications are used for the purpose of explanation. You can select the display language from the **[FUNCTION]** menu. (➔ 6)
- **[XX]** indicates the selected items.
- (➔ **XX**) indicates references are available on the stated page.

BASICS

Faceplate

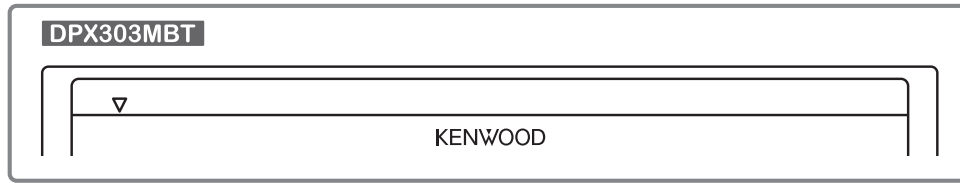

Eject button and loading slot

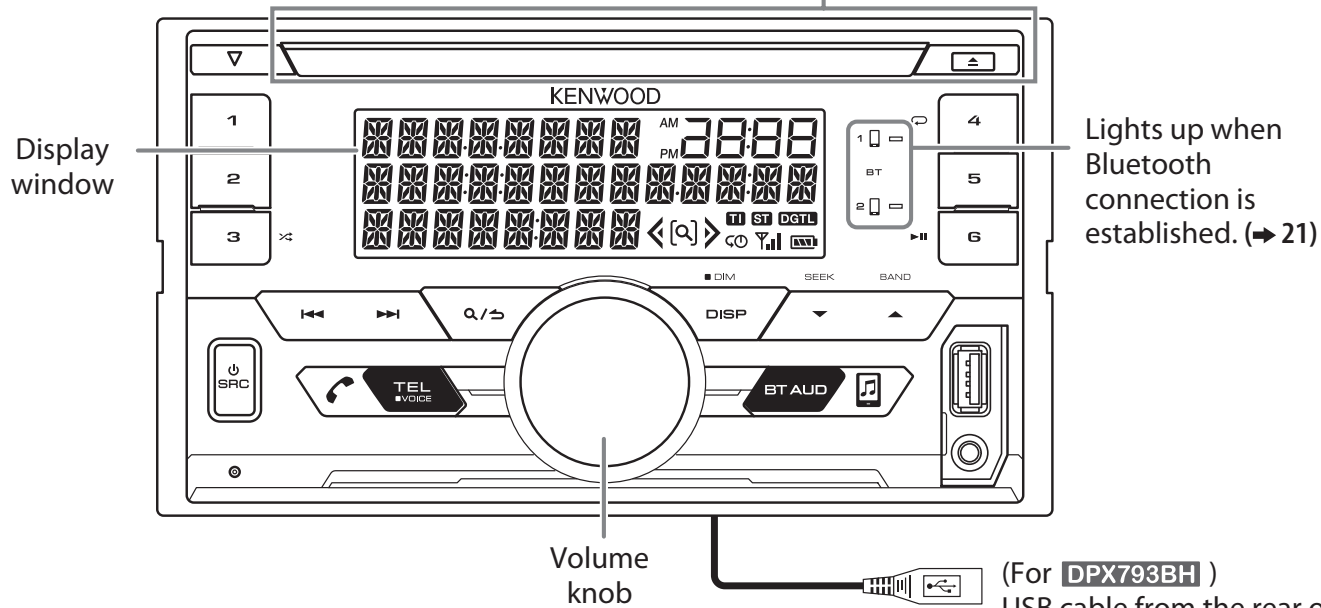

Display window

Volume knob

(For **DPX793BH**)
USB cable from the rear of the unit.

Lights up when Bluetooth connection is established. (→ 21)

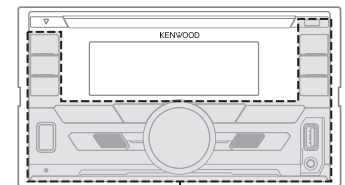
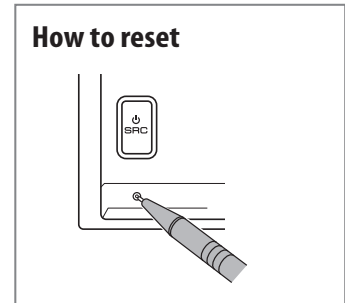

Flashes when the unit enters searching status.

To	On the faceplate
Turn on the power	Press SRC . • Press and hold to turn off the power.
Adjust the volume	Turn the volume knob.
Select a source	Press SRC repeatedly.
Change the display information*	Press DISP repeatedly. (→ 36)

* For **DPX523BT** : You can also turn off the display information by pressing **DISP** repeatedly.

BASICS

Remote control (RC-406) (supplied for **DPX523BT**)

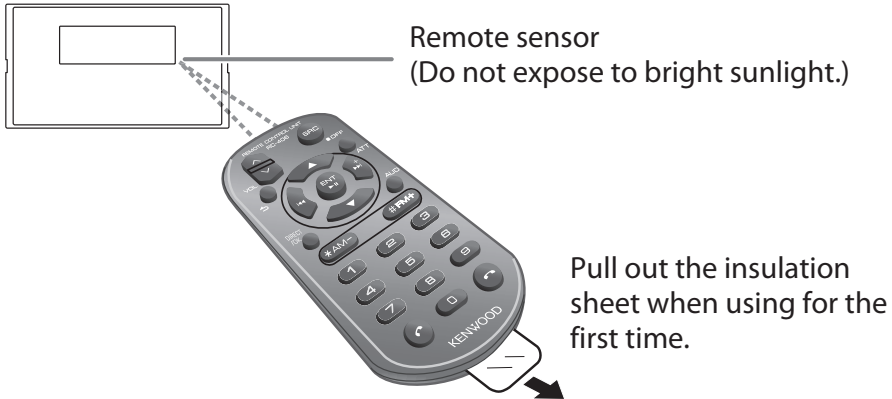

DPX793BH / DPX593BT / DPX540BT / DPX503BT / DPX303MBT :
Can be remotely controlled with an optionally purchased remote control.

How to replace the battery

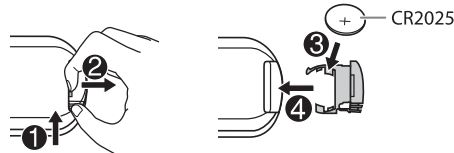

To	On the remote control
Turn on the power	Press and hold SRC to turn off the power. (Pressing SRC does not turn on the power.)
Adjust the volume	Press VOL \wedge or VOL \vee . • Press and hold VOL \wedge to continuously increase the volume to 15. Press ATT during playback to attenuate the sound. • Press again to cancel.
Select a source	Press SRC repeatedly.

GETTING STARTED

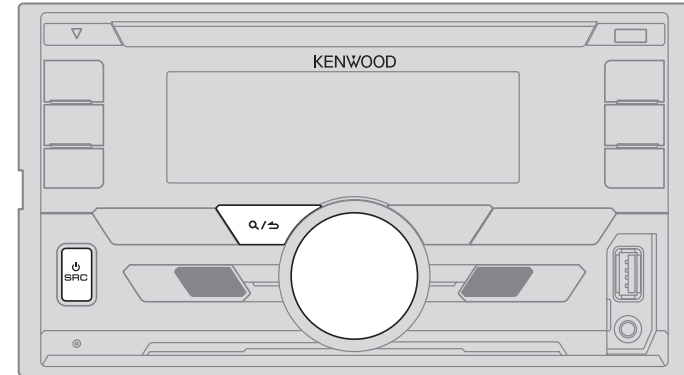

1 Select the display language and cancel the demonstration

When you turn on the power for the first time (or [FACTORY RESET] is set to [YES], \rightarrow 6), the display shows: "SEL LANGUAGE" \rightarrow "PRESS" \rightarrow "VOLUME KNOB"

- 1 Turn the volume knob to select [ENG] (English) or [SPA] (Spanish), then press the knob.
[ENG] is selected for the initial setup.
Then, the display shows: "CANCEL DEMO" \rightarrow "PRESS" \rightarrow "VOLUME KNOB".
- 2 Press the volume knob.
[YES] is selected for the initial setup.
- 3 Press the volume knob again.
"DEMO OFF" appears.

GETTING STARTED

2

Set the clock and date

- 1 Press the volume knob to enter [FUNCTION].
- 2 Turn the volume knob to select [CLOCK], then press the knob.

To adjust the clock

- 3 Turn the volume knob to select [CLOCK ADJUST], then press the knob.
- 4 Turn the volume knob to make the settings, then press the knob.
Hour → Minute
- 5 Turn the volume knob to select [CLOCK FORMAT], then press the knob.
- 6 Turn the volume knob to select [12H] or [24H], then press the knob.

To set the date

- 7 Turn the volume knob to select [DATE FORMAT], then press the knob.
- 8 Turn the volume knob to select [DD/MM/YY] or [MM/DD/YY], then press the knob.
- 9 Turn the volume knob to select [DATE SET], then press the knob.
- 10 Turn the volume knob to make the settings, then press the knob.
Day → Month → Year or Month → Day → Year
- 11 Press and hold **Q**/**↵** to exit.

To return to the previous setting item, press **Q**/**↵**.

3

Set the initial settings

- 1 Press **⏻** **SRC** repeatedly to enter STANDBY.
- 2 Press the volume knob to enter [FUNCTION].
- 3 Turn the volume knob to select an item (see the following table), then press the knob.
- 4 Repeat step 3 until the desired item is selected or activated.
- 5 Press and hold **Q**/**↵** to exit.

To return to the previous setting item, press **Q**/**↵**.

Default: **XX**

DISPLAY

- EASY MENU** When entering [FUNCTION]...
ON: LCD DISPLAY zone illumination changes to white color. ;
OFF: LCD DISPLAY zone illumination remains as [COLOR SELECT] color.
(→ 32)
- KEY zone illumination changes to light blue color when you enter [FUNCTION], irregardless of the [EASY MENU] setting.
 - Refer to the illustration on page 32 for zone identification.

TUNER SETTING

- PRESET TYPE** **NORMAL:** Memorizes one station for each preset button in each band (FM1/FM2/FM3/AM). ; **MIX:** Memorizes one station or SiriusXM channel for each preset button, regardless of the selected band or SiriusXM channel.

SYSTEM

- KEY BEEP** **ON:** Activates the keypress tone. ; **OFF:** Deactivates.

SOURCE SELECT

- PANDORA SRC** (Except for **DPX523BT**)
ON: Enables PANDORA FRONT/PANDORA REAR/PANDORA in source selection. ; **OFF:** Disables. (→ 13)
- IHEART SRC** (Except for **DPX523BT**)
ON: Enables IHEARTRADIO-F/IHEARTRADIO-R/IHEARTRADIO in source selection. ; **OFF:** Disables. (→ 15)
- SPOTIFY SRC** **ON:** Enables SPOTIFY FRONT/SPOTIFY REAR/SPOTIFY in source selection. ; **OFF:** Disables. (→ 16)
- BUILT-IN AUX** **ON:** Enables AUX in source selection. ; **OFF:** Disables. (→ 13)

GETTING STARTED

CD READ	(Except for DPX303MBT) 1: Automatically distinguishes between audio file disc and music CD. ; 2: Forces to play as a music CD. No sound can be heard if an audio file disc is played.
USER S.REMO	(For DPX523BT) See page 33 for details.
F/W UPDATE	
UPDATE SYSTEM/UPDATE HD (for DPX793BH)	
F/W UP xxxx/ F/W UP Vxx	YES: Starts upgrading the firmware. ; NO: Cancels (upgrading is not activated). For details on how to update the firmware, visit < www.kenwood.com/cs/ce/ >.
FACTORY RESET	YES: Resets the settings to default (except the stored station). ; NO: Cancels.
CLOCK	
CLOCK DISPLAY	ON: The clock time is shown on the display even when the unit is turned off. ; OFF: Cancels.
ENGLISH	Select the display language for [FUNCTION] menu and music information if applicable.
ESPAÑOL	By default, [ENGLISH] is selected.

HD Radio™ tuner (for **DPX793BH**)

You can tune in to both conventional and HD Radio broadcasts.
• To find HD Radio stations in your area, visit <<http://www.hdradio.com>>.

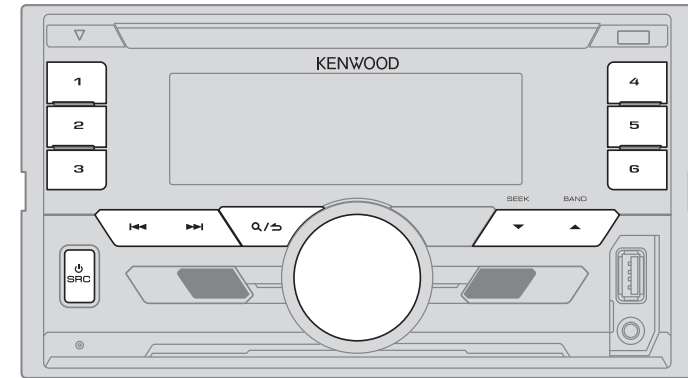

Search for a station

- 1 Press **⏻ SRC** repeatedly to select **HD RADIO**.
 - 2 Press **▲ BAND** repeatedly (or press **#FM+ / *AM-** on the remote control) to select **FM1/FM2/FM3/AM**.
 - 3 Press **◀◀ / ▶▶** (or press **◀◀ / ▶▶ (+)** on the remote control) to search for a station or channel.
- To change the searching method for **◀◀ / ▶▶**: Press **▼ SEEK** repeatedly.
 - AUTO1** : Automatically search for a station or channel.
 - AUTO2** : Search for a preset station or channel.
 - MANUAL** : Manually search for a station or channel.
 - To store a station or channel: Press and hold one of the number buttons (**1** to **6**).
 - To select a stored station or channel: Press one of the number buttons (**1** to **6**) (or press one of the number buttons (**1** to **6**) on the remote control).

HD Radio™ tuner (for DPX793BH)

Direct Access Tuning (using the remote control)

- 1 Press **DIRECT** to enter Direct Access Tuning.
- 2 Press the number buttons to enter a frequency.
- 3 Press **ENT** ► **||** to search for a station or channel.

- To cancel, press **↶** or **DIRECT**.
- If no operation is done for 10 seconds after step 2, Direct Access Tuning is automatically canceled.

Select an HD Radio multicast channel

Many HD Radio stations offer more than one channel programming. This service is called multicasting. While receiving HD Radio multicast channels....

Press **◀◀ / ▶▶** to select your desired channel (HD1 to HD8).
"LINKING" appears while linking to a multicast channel.

Receive an Emergency Alert message

You can receive an emergency alert message while listening to another source or while in STANDBY, via HD Radio Broadcast.

■ Activate emergency alert message reception

- 1 Press the volume knob to enter [FUNCTION].
- 2 Turn the volume knob to select [TUNER SETTING], then press the knob.
- 3 Turn the volume knob to select [EA], then press the knob.
- 4 Turn the volume knob to select [ON], then press the knob.
- 5 Press and hold **Q/↶** to exit.

- To deactivate emergency alert message reception, select [OFF] in step 4.
- To return to the previous setting item, press **Q/↶**.

■ Receive an emergency alert message

When an emergency alert message is received, it appears and remains on the display until the user performs the "Ignore" function.

- Press **⏻ SRC** (or press **SRC** on the remote control) to ignore the alert message.
The same emergency alert message will not interrupt again for 12 hours.

■ Display received emergency alert messages

The received emergency alert messages are stored in the Alert Message List, and you can check them later. While listening to the HD RADIO source...

- 1 Press **Q/↶** to display the Alert Message List.
- 2 Turn the volume knob to select a message.
- 3 Press the volume knob to display the information related to the message.
- 4 Press **Q/↶** again to exit.

- "NO LIST" appears when the list is empty.
- This feature can store up to four messages in the list.
- To clear the message list, set [FACTORY RESET] to [YES]. (→ 6)

Other settings

- 1 Press the volume knob to enter [FUNCTION].
- 2 Turn the volume knob to select an item (→ 8), then press the knob.
- 3 Repeat step 2 until the desired item is selected or activated.
- 4 Press and hold **Q/↶** to exit.

To return to the previous setting item, press **Q/↶**.

HD Radio™ tuner (for DPX793BH)

Default: **XX**

TUNER SETTING	
IF BAND	AUTO: Increases the tuner selectivity to reduce interference noises from adjacent FM stations. (Stereo effect may be lost.) ; WIDE: Subjects to interference noises from adjacent FM stations, but sound quality will not be degraded and the stereo effect will remain.
AUTO MEMORY	YES: Automatically starts memorizing 6 stations with good reception. ; NO: Cancels. <ul style="list-style-type: none">• Selectable only if [NORMAL] is selected for [PRESET TYPE]. (➔ 5)
RECEIVE MODE	Sets the receive mode of the HD Radio receiver. AUTO: Automatically tunes to analog broadcast when there is no digital broadcast. ; DIGITAL: Tunes in to digital broadcast only. ; ANALOG: Tunes in to analog broadcast only.
CLOCK	
TIME SYNC	ON: Synchronizes the unit's time to the Radio Broadcast Data System station time. ; OFF: Cancels.

RADIO (for DPX593BT / DPX540BT / DPX523BT / DPX503BT / DPX303MBT)

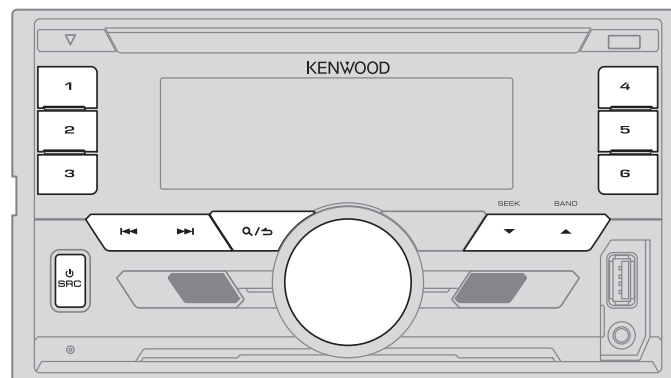

Search for a station

- 1 Press **SRC** repeatedly to select **RADIO**.
 - 2 Press **BAND** repeatedly (or press **#FM+** / ***AM-** on the remote control) to select **FM1/FM2/FM3/AM**.
 - 3 Press **◀◀ / ▶▶** (or press **◀◀ / ▶▶ (+)** on the remote control) to search for a station.
- To change the searching method for **◀◀ / ▶▶**: Press **▼ SEEK** repeatedly.
AUTO1 : Automatically search for a station.
AUTO2 : Search for a preset station.
MANUAL : Manually search for a station.
 - To store a station: Press and hold one of the number buttons (**1** to **6**).
 - To select a stored station: Press one of the number buttons (**1** to **6**) (or press one of the number buttons (**1** to **6**) on the remote control).

Direct Access Tuning (using the remote control)

- 1 Press **DIRECT** to enter Direct Access Tuning.
 - 2 Press the number buttons to enter a frequency.
 - 3 Press **ENT ▶▶** to search for a station.
- To cancel, press **↶** or **DIRECT**.
 - If no operation is done for 10 seconds after step **2**, Direct Access Tuning is automatically canceled.

RADIO (for **DPX593BT** / **DPX540BT** / **DPX523BT** / **DPX503BT** / **DPX303MBT**)

Other settings

- 1 Press the volume knob to enter [FUNCTION].
- 2 Turn the volume knob to select an item (see the following table), then press the knob.
- 3 Repeat step 2 until the desired item is selected or activated.
- 4 Press and hold **Q** / **↵** to exit.

To return to the previous setting item, press **Q** / **↵**.

Default: **XX**

TUNER SETTING

AUTO MEMORY	YES: Automatically starts memorizing 6 stations with good reception. ; NO: Cancels. • Selectable only if [NORMAL] is selected for [PRESET TYPE]. (⇒ 5)
MONO SET	ON: Improves the FM reception, but the stereo effect may be lost. ; OFF: Cancels.
NEWS SET	(For DPX523BT) ON: The unit will temporarily switch to News Programme if available. ; OFF: Cancels.
REGIONAL	(For DPX523BT) ON: Switches to another station only in the specific region using the "AF" control. ; OFF: Cancels.
AF SET	(For DPX523BT) ON: Automatically searches for another station broadcasting the same program in the same Radio Data System network with better reception when the current reception is poor. ; OFF: Cancels.
TI	ON: Allows the unit to temporarily switch to Traffic Information if available ("TI" lights up). ; OFF: Cancels.

PTY SEARCH (For **DPX593BT** / **DPX540BT** / **DPX503BT** / **DPX303MBT**)
Select the available Program Type (see the following), then press **◀◀** / **▶▶** to start.

(For **DPX523BT**)

- 1 Turn the volume knob to select the available Program Type, then press the knob.
- 2 Turn the volume knob to select the PTY language (**ENGLISH/FRENCH/GERMAN**), then press the knob.
- 3 Press **◀◀** / **▶▶** to start searching.

CLOCK

TIME SYNC **ON:** Synchronizes the unit's time to the Radio Broadcast Data System/Radio Data System station time. ; **OFF:** Cancels.

Available Program Type for [PTY SEARCH]

(For **DPX593BT** / **DPX540BT** / **DPX503BT** / **DPX303MBT**)

SPEECH : **NEWS, INFORM** (information), **SPORTS, TALK, LANGUAGE, REL TALK** (religious talk), **PERSNLTY** (personality), **PUBLIC, COLLEGE, HABL ESP** (spanish talk), **WEATHER**

MUSIC : **ROCK, CLS ROCK** (classic rock), **ADLT HIT** (adult hits), **SOFT RCK** (softrock), **TOP 40, COUNTRY, OLDIES, SOFT, NOSTALGA** (nostalgia), **JAZZ, CLASSICL** (classical), **R & B** (rhythm and blues), **SOFT R&B** (soft rhythm and blues), **REL MUSC** (religious music), **MUSC ESP** (spanish music), **HIP HOP**

(For **DPX523BT**)

SPEECH : **NEWS, AFFAIRS, INFO** (information), **SPORT, EDUCATE, DRAMA, CULTURE, SCIENCE, VARIED, WEATHER, FINANCE, CHILDREN, SOCIAL, RELIGION, PHONE IN, TRAVEL, LEISURE, DOCUMENT**

MUSIC : **POP M** (music), **ROCK M** (music), **EASY M** (music), **LIGHT M** (music), **CLASSICS, OTHER M** (music), **JAZZ, COUNTRY, NATION M** (music), **OLDIES, FOLK M** (music)

The unit will search for the Program Type categorized under [**SPEECH**] or [**MUSIC**] if selected.

- [**MONO SET**]/[**NEWS SET**]/[**REGIONAL**]/[**AF SET**]/[**TI**]/[**PTY SEARCH**] is selectable only when the band is FM1/FM2/FM3.
- If the volume is adjusted during reception of traffic information or news bulletin, the adjusted volume is memorized automatically. It will be applied the next time traffic information or news bulletin is turned on.

CD/USB/iPod/ANDROID

Start playback

The source changes automatically and playback starts.

CD

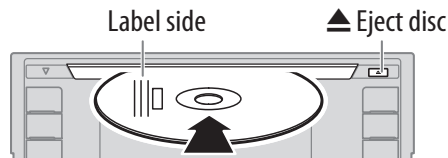

USB input terminal

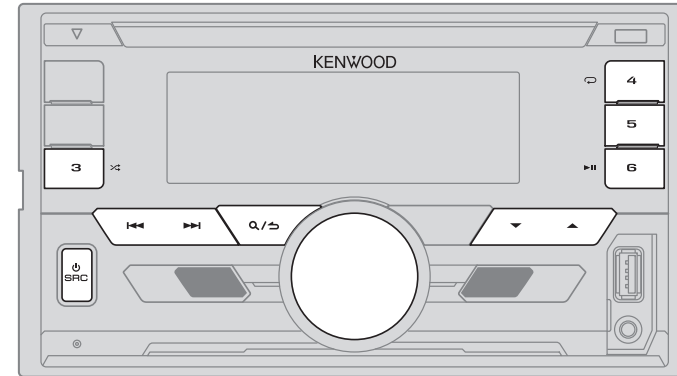
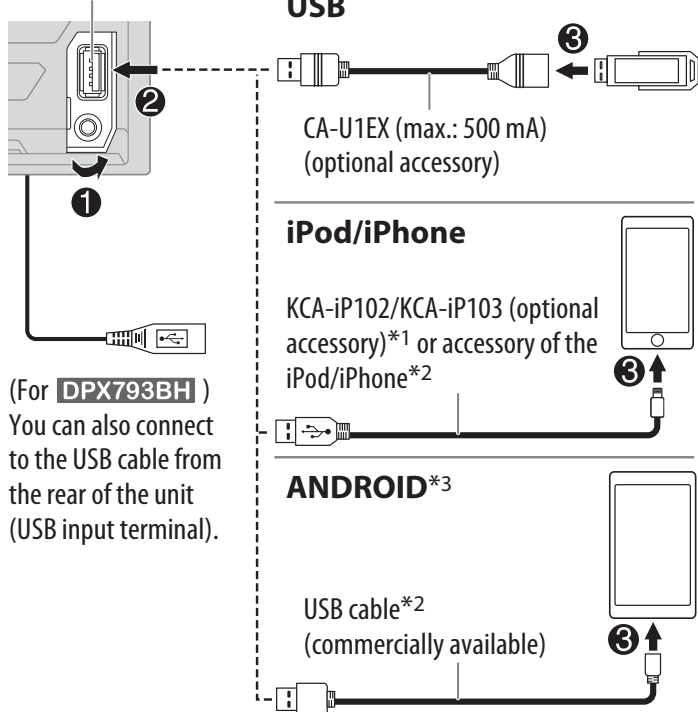

Selectable source:

- **DPX793BH** : CD/USB FRONT/USB REAR/iPod FRONT/iPod REAR/ANDROID FRONT/ANDROID REAR
- **DPX593BT / DPX540BT / DPX523BT / DPX503BT** : CD/USB/iPod USB/ANDROID
- **DPX303MBT** : USB/iPod USB/ANDROID

To	On the faceplate	On the remote control
Playback/pause	Press ▶ 6 .	Press ENT ▶ .
Reverse/Fast-forward*4	Press and hold ◀◀ / ▶▶ .	Press and hold ◀◀ / ▶▶ (+) .
Select a track/file	Press ◀◀ / ▶▶ .	Press ◀◀ / ▶▶ (+) .
Select a folder*5	Press ▲ / ▼ .	Press #FM+ / *AM- .
Repeat play*6	Press ↻4 repeatedly. TRACK REPEAT/ALL REPEAT : Audio CD FILE REPEAT/FOLDER REPEAT/ALL REPEAT : MP3/WMA/AAC/WAV/FLAC file FILE REPEAT/FOLDER REPEAT/REPEAT OFF : iPod or ANDROID	

*1 KCA-iP102 : 30-pin type, KCA-iP103 : Lightning type

*2 Do not leave the cable inside the car when not using.

*3 When connecting an Android device, "Press [VIEW] to install KENWOOD MUSIC PLAY APP" is shown. Follow the instructions to install the application. You can also install the latest version of KENWOOD MUSIC PLAY application on your Android device before connecting. For more information, visit <www.kenwood.com/cs/ce/>.

*4, *5, *6 : (➔ 11)

CD/USB/iPod/ANDROID

To	On the faceplate
Random play* ⁶	Press 3 ↻ repeatedly. DISC RANDOM/RANDOM OFF : Audio CD FOLDER RANDOM/RANDOM OFF : MP3/WMA/AAC/WAV/ FLAC file, iPod or ANDROID
	Press and hold 3 ↻ to select ALL RANDOM.* ⁷

*⁴ For ANDROID: Applicable only when [BROWSE MODE] is selected.

*⁵ For CD: Only for MP3/WMA/AAC files. This does not work for iPod/ANDROID.

*⁶ For iPod/ANDROID: Applicable only when [MODE OFF]/[BROWSE MODE] is selected.

*⁷ For CD: Only for MP3/WMA/AAC files.

Select control mode

While in iPod FRONT/iPod REAR/iPod USB source, press **5** repeatedly.

MODE ON : Control iPod using the iPod itself. However, you can still play/pause, file skip, fast-forward or reverse from this unit.

MODE OFF : Control iPod from this unit.

While in ANDROID FRONT/ANDROID REAR/ANDROID source, press **5** repeatedly.

BROWSE MODE: Control Android device from this unit via KENWOOD MUSIC PLAY application installed in the Android device.

HAND MODE : Control Android device using the Android device itself via other media player applications installed in the Android device. However, you can still play/pause and file skip from this unit.

Select music drive

While in USB FRONT/USB REAR/USB source, press **5** repeatedly.

Stored songs in the following drive will be played back.

- Selected internal or external memory of a smartphone (Mass Storage Class).
- Selected drive of a multiple drives device.

Select a file from a folder/list

For iPod/ANDROID, applicable only when [MODE OFF]/[BROWSE MODE] is selected.

- 1 Press **Q** / ↵.
- 2 Turn the volume knob to select a folder/list, then press the knob.
- 3 Turn the volume knob to select a file, then press the knob.

Quick Search (applicable only for CD, USB FRONT, USB REAR, USB, ANDROID FRONT, ANDROID REAR and ANDROID source)

If you have many files, you can search through them quickly.

Turn the volume knob quickly to browse through the list quickly.

Skip Search (applicable only for iPod FRONT, iPod REAR, iPod USB, ANDROID FRONT, ANDROID REAR and ANDROID source)

Press **◀◀ / ▶▶** to search at a preset skip search ratio.

(⇒ 12, [SKIP SEARCH])

- Pressing and holding **◀◀ / ▶▶** searches at a 10% ratio.

Alphabet search (applicable only for iPod FRONT, iPod REAR, iPod USB, ANDROID FRONT, ANDROID REAR and ANDROID source)

You can search for a file according to the first character.

For iPod FRONT/iPod REAR/iPod USB source

- 1 Turn the volume knob quickly to enter character search.
- 2 Turn the volume knob to select the character.
 - Select "*" to search for a character other than A to Z, 0 to 9.
- 3 Press **◀◀ / ▶▶** to move to the entry position.
 - You can enter up to 3 characters.
- 4 Press the volume knob to start searching.

CD/USB/iPod/ANDROID

For ANDROID FRONT/ANDROID REAR/ANDROID source

- 1 Press ▲ / ▼ to enter character search.
- 2 Turn the volume knob to select the character.
 - ^A^: Upper case letters (A to Z)
 - _A_: Lower case letters (a to z)
 - 0-: Numbers (0 to 9)
 - ***: Character other than A to Z, 0 to 9
- 3 Press the volume knob to start searching.

- To return to the root folder/first file/top menu, press **5**. (Not applicable for BT AUDIO source.)
- To return to the previous setting item, press **Q/↵**.
- To cancel, press and hold **Q/↵**.

Direct Music Search (using the remote control)

- 1 Press **DIRECT**.
 - 2 Press the number buttons to enter a track/file number.
 - 3 Press **ENT ▶||** to search for music.
- To cancel, press **↵** or **DIRECT**.
 - Not available if Random Play is selected.
 - Not applicable for iPod FRONT, iPod REAR, iPod USB, ANDROID FRONT, ANDROID REAR and ANDROID source.

Listen to TuneIn Radio/TuneIn Radio Pro

While listening to TuneIn Radio or TuneIn Radio Pro, connect the iPod/iPhone to the USB input terminal of the unit.

- The unit will output the sound from these applications.

Settings to use KENWOOD Remote application

KENWOOD Remote application is designed to control the KENWOOD car receiver's operations from the iPhone/iPod (via USB input terminal).

Preparation:

Install the latest version of KENWOOD Remote application on your device before connecting. For more information, visit www.kenwood.com/cs/ce/.

You can make the settings in the same way as connection via Bluetooth. (→ 27)

Other settings

- 1 Press the volume knob to enter [FUNCTION].
- 2 Turn the volume knob to select an item (see the following table), then press the knob.
- 3 Repeat step 2 until the desired item is selected or activated.
- 4 Press and hold **Q/↵** to exit.

To return to the previous setting item, press **Q/↵**.

Default: **XX**

USB	
MUSIC DRIVE	DRIVE CHANGE: The next drive ([DRIVE 1] to [DRIVE 4]) is selected automatically and playback starts. Repeat steps 1 to 3 to select the following drives.
SKIP SEARCH	0.5%/1%/5%/10%: While listening to iPod FRONT, iPod REAR, iPod USB, ANDROID FRONT, ANDROID REAR or ANDROID source, selects the skip search ratio over the total files.

AUX

Preparation:

Select [ON] for [BUILT-IN AUX] for [SOURCE SELECT]. (→ 5)

Start listening

- 1 Connect a portable audio player (commercially available).

Auxiliary input jack

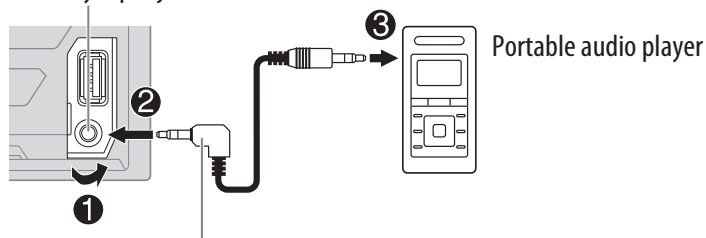

3.5 mm (1/8") stereo mini plug with "L" shaped connector (commercially available)

- 2 Press **SRC** repeatedly to select AUX.
- 3 Turn on the portable audio player and start playback.

Set the AUX name

While listening to a portable audio player connected to the unit...

- 1 Press the volume knob to enter [FUNCTION].
- 2 Turn the volume knob to select [SYSTEM], then press the knob.
- 3 Turn the volume knob to select [AUX NAME SET], then press the knob.
- 4 Turn the volume knob to select an item, then press the knob.
AUX (default)/DVD/PORTABLE/GAME/VIDEO/TV
- 5 Press and hold **Q/↵** to exit.

To return to the previous setting item, press **Q/↵**.

Pandora® (except for **DPX523BT**)

Preparation:

Install the latest version of the Pandora application on your device (iPhone/iPod touch), then create an account and log in to Pandora.

- Select [ON] for [PANDORA SRC] in [SOURCE SELECT]. (→ 5)

Start listening

- 1 Open the Pandora application on your device.
- 2 Connect your device to the USB input terminal.

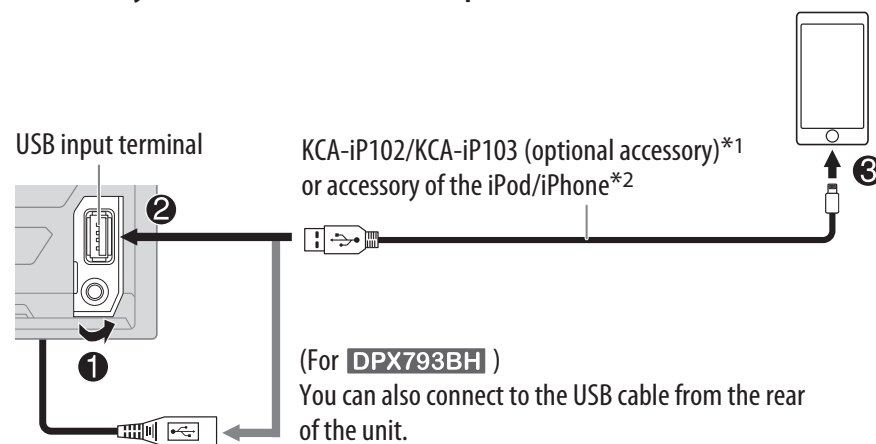

- 3 Press **SRC** repeatedly to select PANDORA FRONT/PANDORA REAR/PANDORA.
Broadcast starts automatically.

*1 KCA-iP102 : 30-pin type, KCA-iP103 : Lightning type

*2 Do not leave the cable inside the car when not using.

Pandora® (except for **DPX523BT**)

To	On the faceplate	On the remote control
Playback/pause	Press ▶ 6 .	Press ENT ▶ .
Skip a track	Press ▶▶1 .	Press ▶▶1 (+) .
Thumbs up or thumbs down*	Press ▲ / ▼ .	Press #FM+ / *AM- .

* If thumbs down is selected, the current track is skipped.

Create and save a new station

- 1 Press **Q/↵**.
- 2 Turn the volume knob to select [NEW STATION], then press the knob.
- 3 Turn the volume knob to select [FROM ARTIST] or [FROM TRACK], then press the knob.
A new station is created based on the artist or current song.
- 4 Press and hold one of the number buttons (1 to 5) to store.

To select a stored station: Press one of the number buttons (1 to 5).

Search for a registered station

- 1 Press **Q/↵**.
- 2 Turn the volume knob to select an item, then press the knob.
[SORT BY DATE]: According to the registered date
[SORT BY A-Z]: By alphabetical order
- 3 Turn the volume knob (or press **▲ / ▼** on the remote control) to select the desired station.
- 4 Press the volume knob (or press **ENT ▶||** on the remote control) to confirm.

To cancel, press and hold **Q/↵**.

Bookmark current song information

Press and hold the volume knob.

"BOOKMARKED" appears and the information is stored to your device.

- The bookmark is available on your Pandora account but not on this unit.

Delete a station

While listening to PANDORA...

- 1 Press **Q/↵**.
- 2 Turn the volume knob to select [STATION DEL], then press the knob.
- 3 Turn the volume knob to select [SORT BY DATE] or [SORT BY A-Z], then press the knob.
- 4 Turn the volume knob to select the desired station to delete, then press the knob.
- 5 Turn the volume knob to select [YES], then press the knob.
- 6 Press and hold **Q/↵** to exit.

To return to the previous setting item, press **Q/↵**.

iHeartRadio® (except for DPX523BT)

Preparation:

Install the latest version of iHeartAuto application on your device (iPhone/iPod touch), then create an account and log in to iHeartRadio.

- Select [ON] for [IHEART SRC] in [SOURCE SELECT]. (→ 5)

Start listening

- 1 Open the iHeartAuto application on your device.
- 2 Connect your device to the USB input terminal.

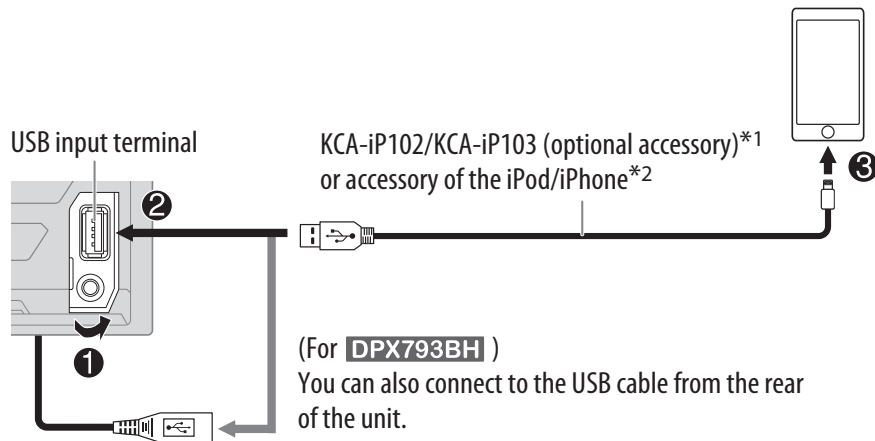

- 3 Press **⏻ SRC** repeatedly to select IHEARTRADIO-F/IHEARTRADIO-R/IHEARTRADIO.
Broadcast starts automatically.

*1 KCA-iP102 : 30-pin type, KCA-iP103 : Lightning type

*2 Do not leave the cable inside the car when not using.

To	On the faceplate	On the remote control
Playback/pause	Press ▶ 6.	Press ENT ▶ .
Skip a track for custom station	Press ▶▶1.	Press ▶▶1 (+).
Thumbs up or thumbs down	Press ▲ / ▼.	(Not available)
Create a new/custom station	Press 1.	(Not available)
Scan for live station	<ol style="list-style-type: none"> 1 Press 2 to start scanning. 2 Press 2 again to listen to the station. 	(Not available)

Search and store a station

- 1 Press **Q/↵.**
- 2 Turn the volume knob to select a category, then press the knob.
- 3 Turn the volume knob (or press **▲ / ▼** on the remote control) to select the desired station.
- 4 Press the volume knob (or press **ENT ▶||** on the remote control) to confirm.
When a city list appears, you can search cities in alphabetical order by turning the volume knob quickly.

To cancel, press and hold **Q/↵.**

To store a station: Press and hold one of the number buttons (**3, 4** or **5**).

To select a stored station: Press one of the number buttons (**3, 4** or **5**).

Spotify

Preparation:

Install the latest version of the Spotify application on your device (iPhone/iPod touch), then create an account and log in to Spotify.

- Select [ON] for [SPOTIFY SRC] in [SOURCE SELECT]. (→ 5)

Start listening

- 1 Open the Spotify application on your device.
- 2 Connect your device to the USB input terminal.

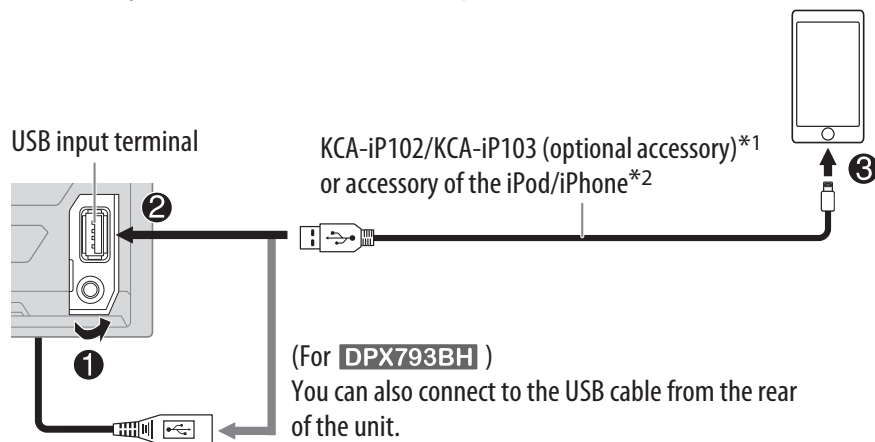

- 3 Press **SRC** repeatedly to select SPOTIFY FRONT/SPOTIFY REAR/SPOTIFY.
Broadcast starts automatically.

*1 KCA-iP102 : 30-pin type, KCA-iP103 : Lightning type

*2 Do not leave the cable inside the car when not using.

To	On the faceplate	On the remote control
Playback/pause	Press ▶ 6.	Press ENT ▶ .
Skip a track	Press ◀◀*3/▶▶.	Press ◀◀*3/▶▶(+).
Thumbs up or thumbs down*4	Press ▲/▼.	Press #FM+ / *AM-.
Start radio	Press and hold 5.	(Not available)
Repeat play*5	Press ↺4 repeatedly. REPEAT ALL/REPEAT ONE*3/ REPEAT OFF	(Not available)
Random play*5	Press 3↻ repeatedly.*3 SHUFFLE ON/SHUFFLE OFF	(Not available)

*3 Available for premium account users only.

*4 This feature is available for tracks in Radio only. If thumbs down is selected, the current track is skipped.

*5 Available for tracks in Playlists only.

Save favorite song information

While listening to the Radio on Spotify...

Press and hold the volume knob.

"SAVED" appears and the information is stored to "Your Music" or "Your Library" on your Spotify account.

To unsave, repeat the same procedure.

"REMOVED" appears and the information is removed from "Your Music" or "Your Library" on your Spotify account.

Spotify

Search for a song or station

- 1 Press **Q** / **↵**.
- 2 Turn the volume knob to select a list type, then press the knob.
The list types displayed differ depending on the information sent from Spotify.
- 3 Turn the volume knob (or press **▲** / **▼** on the remote control) to select the desired song or station.
- 4 Press the volume knob (or press **ENT** **▶** **||** on the remote control) to confirm.
You can browse through the list quickly by turning the volume knob quickly.

To cancel, press and hold **Q** / **↵**.

SiriusXM® Radio (for **DPX793BH** / **DPX593BT** / **DPX503BT** / **DPX303MBT**)

Only SiriusXM® brings you more of what you love to listen to, all in one place. Get over 140 channels, including commercial-free music plus the best sports, news, talk, comedy and entertainment. Welcome to the world of satellite radio. A SiriusXM Vehicle Tuner and Subscription are required. For more information, visit www.siriusxm.com.

Preparation:

- 1 Connect the optional SiriusXM Vehicle Tuner (commercially available).

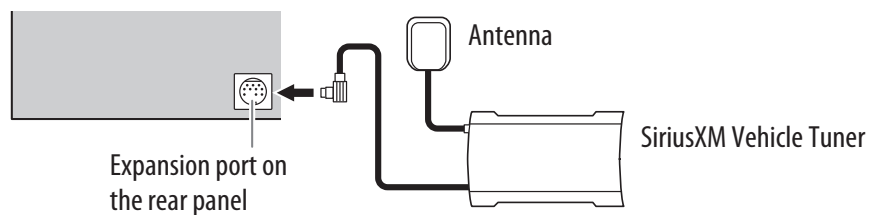

- 2 Check your Radio ID for activation.

The SiriusXM Radio ID is required for activation and can be found by tuning to Channel 0 as well as on the label found on the SiriusXM Connect tuner and its packaging.

The Radio ID does not include the letters I, O, S or F.

- 3 Activate the subscription.

For users in the U.S.A.:

Online: Go to www.siriusxm.com

Phone: Call 1-866-635-2349

For users in Canada:

Online: Go to www.siriusxm.ca/activatexm

Phone: Call 1-877-438-9677

- 4 Press **⏻ SRC** repeatedly to select SIRIUS XM to start updating.

SiriusXM® Radio (for **DPX793BH** / **DPX593BT** / **DPX503BT** / **DPX303MBT**)

Start listening

- 1 Press **SRC** repeatedly to select SIRIUS XM.
- 2 Press **BAND** repeatedly to select a band.
- 3 Press **Q/↵**.
“[Q]” lights up.
- 4 Turn the volume knob to select a category, then press the knob.
If “ALL CHANNELS” is selected, all the available channels will be shown.
- 5 Turn the volume knob to select a channel, then press the knob.
(or)
Press **◀◀ / ▶▶** to search for a channel manually.
 - Pressing and holding **◀◀ / ▶▶** changes the channel rapidly.

If a locked channel or a mature channel is selected, a pass code input screen appears. Enter the pass code to receive the channel. (➔ 19)

To change the tuning method for **◀◀ / ▶▶**: Press **▼ SEEK**. Each time you press **▼ SEEK**, the tuning method switches between “CHANNEL” (manually search for a channel) and “PRESET” (searches for a preset channel of the selected band).

Direct Access Tuning (using the remote control)

- 1 Press **DIRECT** to enter Direct Access Tuning.
- 2 Press the number buttons to enter a channel number.
- 3 Press **ENT ▶||** to start searching.
 - To cancel, press **↵** or **DIRECT**.
 - If no operation is done for 10 seconds after step 2, Direct Access Tuning is automatically canceled.

SiriusXM Keymode

Press and hold **▼ SEEK** to change the keymode (channel or replay).
(Default: Channel keymode)
“☞” lights up when replay keymode is selected.

When channel keymode is selected...

To	On the faceplate	On the remote control
Select a channel	Press ◀◀ / ▶▶ .	Press ◀◀ / ▶▶ (+) .
Change a channel rapidly	Press and hold ◀◀ / ▶▶ .	Press and hold ◀◀ / ▶▶ (+) .
Store a channel of the current band	Press and hold one of the number buttons (1 to 6).	(Not available)
Select a stored channel of the current band	Press one of the number buttons (1 to 6).	

When replay keymode is selected...

To	On the faceplate	On the remote control
Playback/pause	Press ▶ 6 .	Press ENT ▶ .
Skip backward/forward	Press ◀◀ / ▶▶ .	Press ◀◀ / ▶▶ (+) .
Rewind/Fast-forward	Press and hold ◀◀ / ▶▶ .	Press and hold ◀◀ / ▶▶ (+) .
Go to Live	Press 1 .	

SiriusXM® Radio (for **DPX793BH** / **DPX593BT** / **DPX503BT** / **DPX303MBT**)

SmartFavorites and TuneStart™

User stored channels are recognized as SmartFavorite channels*. The SiriusXM Vehicle Tuner automatically buffers the broadcast content in the background.

- SmartFavorites feature is available with SXV200 or later SiriusXM Vehicle Tuner.

* SXV300 (and later) SiriusXM Vehicle Tuner can use all 18 stored channels as SmartFavorites. The SXV200 SiriusXM Vehicle Tuner can use 6 stored channels from the current band as SmartFavorites.

When you select a SmartFavorite channel, you can rewind and replay up to 30 minutes of any of the missed news, talk, sports or music content.

- Playback starts from the beginning of the song if [TUNE START] is set to [ON] (➔ 20) for most music channels stored as a SmartFavorite.

Press one of the number buttons (1 to 6) to select a stored channel.

TuneScan™

You can get a short preview of the songs that you have missed on each of your SmartFavorite music channels or currently tuned music channel.

Press and hold ▲ **BAND** to start scanning the first 6 seconds of the recorded music contents.

- To listen to the current song, press the volume knob to stop scanning. The unit continues playing the current song.
- To select the previous/next song, press |◀◀ / ▶▶|.
- To cancel scanning, press and hold the volume knob. Playback returns to the channel before you entered TuneScan.

SiriusXM settings

- 1 Press the volume knob to enter [FUNCTION].
- 2 Turn the volume knob to select an item (see the following table), then press the knob.
- 3 Repeat step 2 until the desired item is selected/activated or follow the instructions stated on the selected item.
- 4 Press and hold **Q/↵** to exit.

To return to the previous setting item, press **Q/↵**.

Default: **XX**

SIRIUS XM

CHANNEL LOCK

To unlock settings:

- 1 Turn the volume knob to select a number.
- 2 Press |◀◀ / ▶▶| to move to the entry position.
- 3 Repeat steps 1 and 2 to enter the current pass code. (Initial pass code is 0000.)
- 4 Press the volume knob to confirm.

CODE SET

- 1 Turn the volume knob to select a number.
 - 2 Press |◀◀ / ▶▶| to move to the entry position.
 - 3 Repeat steps 1 and 2 to enter a new 4-digit pass code.
 - 4 Press the volume knob to confirm.
 - 5 Repeat steps 1 to 4 to reconfirm the pass code.
- Make a note of the new pass code to enter channel lock settings for next time.

LOCK SETTING

MATURE CH: Selects the SiriusXM-defined lock setting. ;
USER DEFINED: Selects the individual channels the user wants to lock. ; **OFF**: Cancels.

SiriusXM® Radio (for **DPX793BH** / **DPX593BT** / **DPX503BT** / **DPX303MBT**)

CHANNEL EDIT*1	<ol style="list-style-type: none"> 1 Turn the volume knob to select a category, then press the knob. 2 Turn the volume knob to select a channel you want to lock, then press the knob. “L” appears in front of the channel number. 3 Press and hold Q / ↵ to exit.
CHANNEL CLEAR*1	YES: Clears all the locked channels. ; NO: Cancels.
TUNE START*2	ON: All qualified music channels in the SmartFavorite will start playback from the beginning of the song. ; OFF: Cancels.
SIGNAL LEVEL	Shows the strength (NO SIGNAL/WEAK/GOOD/STRONG) of the current received signal.
BUFFER USAGE	Shows the memory usage (0% to 100%) for Replay buffer.
SXM RESET	YES: Resets stored channel and lock setting to default. ; NO: Cancels.

*1 Displayed only when [USER DEFINED] is selected.

*2 Available only if the connected SiriusXM Vehicle Tuner is SXV200 or later that supports SmartFavorites.

BLUETOOTH®

BLUETOOTH — Connection

Supported Bluetooth profiles

- Hands-Free Profile (HFP)
- Advanced Audio Distribution Profile (A2DP)
- Audio/Video Remote Control Profile (AVRCP)
- Serial Port Profile (SPP)
- Phonebook Access Profile (PBAP)

Supported Bluetooth codecs

- Sub Band Codec (SBC)
- Advanced Audio Coding (AAC)
- aptX codec (Qualcomm® aptX™) (for **DPX793BH**)

Connect the microphone

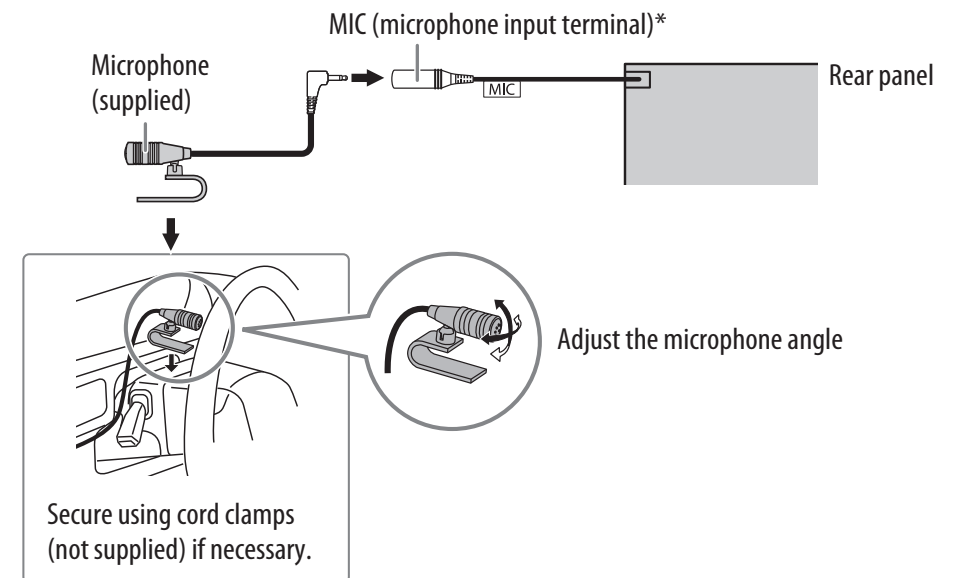

* For the location of the microphone input terminal/microphone input jack, refer to page 40.

BLUETOOTH®

Pair and connect a Bluetooth device for the first time

- 1 Press **⏻ SRC** to turn on the unit.
- 2 Search and select this unit model name (DPX7**/DPX59*/DPX54*/DPX52*/DPX50*/DPX3***) on the Bluetooth device.
"PAIRING" → "PASS XXXXXX" → Device name → "PRESS" → "VOLUME KNOB" appears on the display.
 - For some Bluetooth devices, you may need to enter the Personal Identification Number (PIN) code immediately after searching.
- 3 Press the volume knob to start pairing.
"PAIRING OK" appears when pairing is completed.

Once pairing is completed, Bluetooth connection is established automatically.

- "BT1" and/or "BT2" indicator on the faceplate lights up.
- This unit supports Secure Simple Pairing (SSP).
- Up to five devices can be registered (paired) in total.
- Once the pairing is completed, the Bluetooth device will remain registered in the unit even if you reset the unit. To delete the paired device, → 25, [DEVICE DELETE].
- A maximum of two Bluetooth phones and one Bluetooth audio device can be connected at any time.
However, while in BT AUDIO source, you can connect to five Bluetooth audio devices and switch between these five devices. (→ 26)
- Some Bluetooth devices may not automatically connect to the unit after pairing. Connect the device to the unit manually.
- Refer to the instruction manual of the Bluetooth device for more information.

Auto Pairing

When you connect iPhone/iPod touch/Android device to the USB input terminal, pairing request (via Bluetooth) is automatically activated.

Press the volume knob to pair once you have confirmed the device name.

Automatic pairing request is activated only if:

- Bluetooth function of the connected device is turned on.
- [AUTO PAIRING] is set to [ON]. (→ 25)
- KENWOOD MUSIC PLAY application is installed on the Android device (→ 10) and [BROWSE MODE] is selected. (→ 11)

BLUETOOTH®

BLUETOOTH — Mobile phone

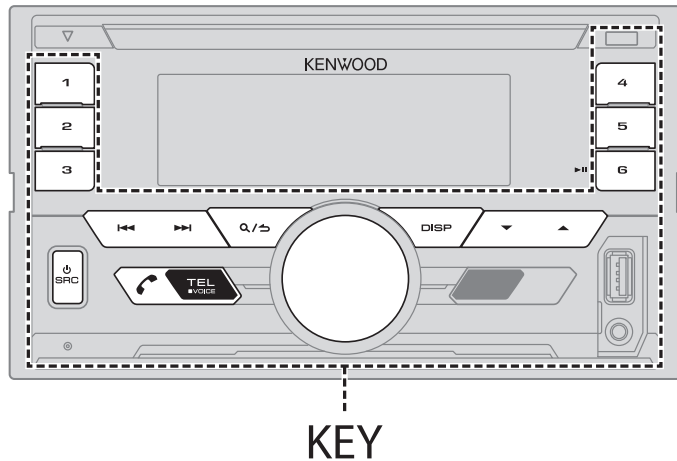

Receive a call

When there is an incoming call:

- The KEY zone illuminates in green color and flashes.
- The unit answers the call automatically if [AUTO ANSWER] is set to a selected time. (➔ 23)

During a call:

- The LCD DISPLAY zone illuminates according to the settings made for [DISPLAY] (➔ 32) and the KEY zone illuminates in green color.
- If you turn off the unit, the Bluetooth connection is disconnected.

The following operations may differ or not available depending on the connected phone.

To	On the faceplate	On the remote control
First incoming call...		
Answer a call	Press TEL or the volume knob or one of the number buttons (1 to 6).	Press .
Reject a call	Press .	Press .
End a call	Press .	Press .
While talking on the first incoming call...		
Answer another incoming call and hold the current call	Press TEL.	Press .
Reject another incoming call	Press .	Press .
While having two active calls...		
End current call and activate held call	Press .	Press .
Swap between the current call and held call	Press TEL.	Press .
Adjust the phone volume [00] to [35] (Default: [15])	Turn the volume knob during a call.	Press VOL or VOL .
	• This adjustment will not affect the volume of the other sources.	
Switch between hands-free and private talk modes	Press 6 during a call.	(Not available)
	• Operations may vary according to the connected Bluetooth device.	

BLUETOOTH®

■ Improve the voice quality

While talking on the phone...

- 1 Press the volume knob to enter [FUNCTION].
- 2 Turn the volume knob to select an item (see the following table), then press the knob.
- 3 Repeat step 2 until the desired item is selected or activated.
- 4 Press and hold **Q/↵** to exit.

To return to the previous setting item, press **Q/↵**.

Default: **XX**

MIC GAIN	LEVEL -10 to LEVEL +10 (LEVEL -4): The sensitivity of the microphone increases as the number increased.
NR LEVEL	LEVEL -5 to LEVEL +5 (LEVEL 0): Adjust the noise reduction level until the least noise is being heard during a phone conversation.
ECHO CANCEL	LEVEL -5 to LEVEL +5 (LEVEL 0): Adjust the echo cancellation delay time until the least echo is being heard during a phone conversation.

■ Make the settings for receiving a call

- 1 Press **TEL** to enter Bluetooth mode.
- 2 Turn the volume knob to select an item (see the following table), then press the knob.
- 3 Repeat step 2 until the desired item is selected or activated.
- 4 Press and hold **Q/↵** to exit.

To return to the previous setting item, press **Q/↵**.

Default: **XX**

SETTINGS

AUTO ANSWER	1 to 30: The unit answers incoming call automatically in the selected time (in seconds). ; OFF : Cancels.
BATT/SIGNAL*	AUTO : Shows the strength of the battery and signal when the unit detects a Bluetooth device and the Bluetooth device is connected. ; OFF : Cancels.

* Functionality depends on the type of the phone used.

Make a call

You can make a call from the call history, phonebook, or dialing the number. Call by voice is also possible if your mobile phone has the feature.

- 1 Press **TEL** to enter Bluetooth mode.
“(First device name)” appears.
 - If two Bluetooth phones are connected, press **TEL** again to switch to another phone.
“(Second device name)” appears.
- 2 Turn the volume knob to select an item (→ 24), then press the knob.
- 3 Repeat step 2 until the desired item is selected/activated or follow the instructions stated on the selected item.
- 4 Press and hold **Q/↵** to exit.

To return to the previous setting item, press **Q/↵**.

BLUETOOTH®

CALL HISTORY

(Applicable only if the phone supports PBAP.)

- 1 Press the volume knob to select a name or a phone number.
 - “INCOMING”, “OUTGOING”, or “MISSED” is shown on the lower part of the display to indicate the previous call status.
 - Press **DISP** to change the display category (NUMBER or NAME).
 - “NO DATA” appears if there is no recorded call history.
- 2 Press the volume knob to call.

PHONE BOOK

(Applicable only if the phone supports PBAP.)

- 1 Turn the volume knob quickly to enter alphabet search mode (if the phonebook contains many contacts).
The first menu (ABCDEFGHIJK) appears.
 - To go to the other menu (LMNOPQRSTUVWXYZ or WXYZ1*), press ▲/▼.
 - To select the desired first letter, turn the volume knob or press ◀◀/▶▶, then press the knob.
Select “1” to search with numbers and select “*” to search with symbols.
- 2 Turn the volume knob to select a name, then press the knob.
- 3 Turn the volume knob to select a phone number, then press the knob to call.
 - The phonebook of the connected phone is automatically transferred to the unit when pairing.
 - Contacts are categorized as: HOME, OFFICE, MOBILE, OTHER, GENERAL.
 - This unit can display only non-accent letters. (Accent letters such as “Ú” is shown as “U”.)

NUMBER DIAL

- 1 Turn the volume knob to select a number (0 to 9) or character (*, #, +).
- 2 Press ◀◀/▶▶ to move the entry position.
Repeat steps 1 and 2 until you finish entering the phone number.
- 3 Press the volume knob to call.
(or using the remote control)
 - 1 Press the number buttons (0 to 9) to enter the phone number.
 - 2 Press  to call.

VOICE

Speak the name of the contact you want to call or the voice command to control the phone functions. (→ **Make a call using voice recognition**)

BATT LOW/MID/FULL*: Shows the strength of the battery.

NO SIGNAL/LOW/MID/MAX*: Shows the strength of the current received signal.

* Functionality depends on the type of the phone used.

Make a call using voice recognition

- 1 Press and hold  **VOICE** to activate the voice recognition of the connected phone.
- 2 Speak the name of the contact you want to call or the voice command to control the phone functions.

- Supported Voice Recognition features vary for each phone. Refer to the instruction manual of the connected phone for details.
- This unit also supports the intelligent personal assistant function of iPhone.

Settings in memory

Store a contact in memory

You can store up to 6 contacts into the number buttons (1 to 6).

- 1 Press  **TEL** to enter Bluetooth mode.
- 2 Turn the volume knob to select [CALL HISTORY], [PHONE BOOK], or [NUMBER DIAL], then press the knob.
- 3 Turn the volume knob to select a contact or enter a phone number.
If a contact is selected, press the volume knob to show the phone number.
- 4 Press and hold one of the number buttons (1 to 6).
“STORED” appears when the contact is stored.

To erase a contact from the preset memory, select [NUMBER DIAL] in step 2 and store a blank number.

BLUETOOTH®

Make a call from memory

- 1 Press **TEL** to enter Bluetooth mode.
- 2 Press one of the number buttons (1 to 6).
- 3 Press the volume knob to call.
"NO MEMORY" appears if there is no contacts stored.

Other settings

- 1 Press the volume knob to enter [FUNCTION].
- 2 Turn the volume knob to select an item (see the following table), then press the knob.
- 3 Repeat step 2 until the desired item is selected/activated or follow the instructions stated on the selected item.
- 4 Press and hold **Q/↵** to exit.

To return to the previous setting item, press **Q/↵**.

Default: **XX**

BT MODE	
PHONE SELECT	Selects the phone or audio device to connect or disconnect. "*" appears in front of the device name when connected. "▷" appears in front of the current playback audio device.
AUDIO SELECT	<ul style="list-style-type: none"> • You can only connect a maximum of two Bluetooth phones and one Bluetooth audio device at any time.
DEVICE DELETE	<ol style="list-style-type: none"> 1 Turn the volume knob to select a device to delete, then press the knob. 2 Turn the volume knob to select [YES] or [NO], then press the knob.
PIN CODE EDIT (0000)	<p>Changes the PIN code (up to 6 digits).</p> <ol style="list-style-type: none"> 1 Turn the volume knob to select a number. 2 Press ◀/▶ to move the entry position. Repeat steps 1 and 2 until you finish entering the PIN code. 3 Press the volume knob to confirm.

RECONNECT	ON: The unit automatically reconnect when the last connected Bluetooth device is within range. ; OFF: Cancels.
AUTO PAIRING	ON: The unit automatically pair supported Bluetooth device (iPhone/iPod touch/Android device) when it is connected through USB input terminal. Depending on the operating system of the connected device, this function may not work. ; OFF: Cancels.
INITIALIZE	YES: Initializes all the Bluetooth settings (including stored pairing, phonebook, and etc.). ; NO: Cancels.

Bluetooth test mode

You can check the connectivity of the supported profile between the Bluetooth device and the unit.

- Make sure there is no Bluetooth device paired.

- 1 Press and hold **TEL**.
"PLEASE PAIR YOUR PHONE PIN 0000" appears.
- 2 Search and select this unit model name (DPX7**/DPX59*/DPX54*/DPX52*/DPX50*/DPX3****) on the Bluetooth device.
- 3 Operate the Bluetooth device to confirm pairing.
"TESTING" flashes on the display.

The connectivity result (OK or NG) appears after the test.

PAIRING:	Pairing status
HF CNT:	Hands-Free Profile (HFP) compatibility
AUD CNT:	Advanced Audio Distribution Profile (A2DP) compatibility
PB DL:	Phonebook Access profile (PBAP) compatibility

To cancel test mode, press and hold **SRC** to turn off the unit.

BLUETOOTH®

BLUETOOTH — Audio

While in BT AUDIO source, you can connect to five Bluetooth audio devices and switch between these five devices.

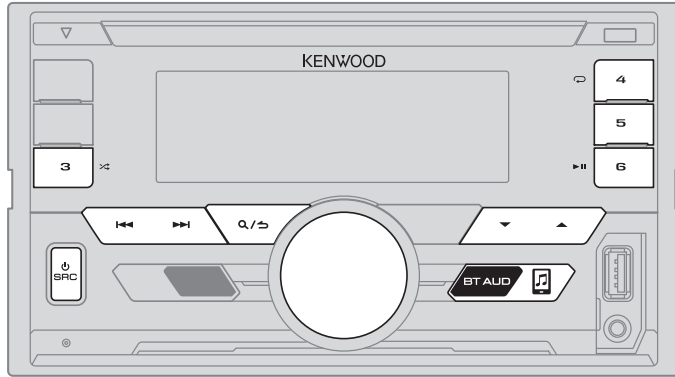

Audio player via Bluetooth

- 1 Press **BT AUDIO** (or press **SRC** repeatedly on the remote control) to select BT AUDIO.
- 2 Operate the Bluetooth audio player to start playback.

To	On the faceplate	On the remote control
Playback/pause	Press ▶ 6 .	Press ENT ▶ .
Select group or folder	Press ▲/▼ .	Press #FM+ / *AM- .
Reverse/ Forward skip	Press ◀◀ / ▶▶ .	Press ◀◀ / ▶▶ (+) .
Reverse/ Fast-forward	Press and hold ◀◀ / ▶▶ .	Press and hold ◀◀ / ▶▶ (+) .

To	On the faceplate	On the remote control
Repeat play	Press ↻4 repeatedly. ALL REPEAT, FILE REPEAT, REPEAT OFF	(Not available)
Random play	Press and hold 3↻ to select ALL RANDOM . • Press 3↻ to select RANDOM OFF .	(Not available)
Select a file from a folder/list	Refer to "Select a file from a folder/list" on page 11.	(Not available)
Switch between connected Bluetooth audio devices	Press 5 .*	(Not available)

* Pressing the "Play" key on the connected device itself also causes switching of sound output from the device.

Operations and display indications may differ according to their availability on the connected device.

BLUETOOTH®

Settings to use KENWOOD Remote application

KENWOOD Remote application is designed to control the KENWOOD car receiver's operations from the iPhone/iPod (via Bluetooth or via USB input terminal) or Android smartphone (via Bluetooth).

Preparation:

Install the latest version of KENWOOD Remote application on your device before connecting. For more information, visit <www.kenwood.com/cs/ce/>.

- 1 Press the volume knob to enter [FUNCTION].
- 2 Turn the volume knob to select an item (see the following table), then press the knob.
- 3 Repeat step 2 until the desired item is selected or activated.
- 4 Press and hold **Q**/**↵** to exit.

To return to the previous setting item, press **Q**/**↵**.

Default: **XX**

REMOTE APP	
SELECT	Select the device (IOS or ANDROID) to use the application.
IOS	YES: Selects iPhone/iPod to use the application via Bluetooth or connected via USB input terminal. ; NO: Cancels. If IOS is selected, select iPod BT source (or iPod FRONT/iPod REAR/iPod USB if your iPhone/iPod is connected via USB input terminal) to activate the application. <ul style="list-style-type: none">• The connectivity of the application will be interrupted or disconnected if:<ul style="list-style-type: none">– You change from iPod BT source to any playback source connected via the USB input terminal.– You change from iPod FRONT/iPod REAR/iPod USB source to iPod BT source.
ANDROID	YES: Selects Android smartphone to use the application via Bluetooth. ; NO: Cancels.
ANDROID LIST*	Selects the Android smartphone to use from the list.

* Displayed only when [ANDROID] of [SELECT] is set to [YES].

STATUS

Shows the status of the selected device.

IOS CONNECTED: You are able to use the application using the iPhone/iPod connected via Bluetooth or USB input terminal.

IOS NOT CONNECTED: No IOS device is connected to use the application.

ANDROID CONNECTED: You are able to use the application using the Android smartphone connected via Bluetooth.

ANDROID NOT CONNECTED: No Android device is connected to use the application.

Listen to iPhone/iPod via Bluetooth

You can listen to the songs on the iPhone/iPod via Bluetooth on this unit.

Press **⏻ SRC** repeatedly to select iPod BT.

- You can operate the iPod/iPhone in the same way as iPod/iPhone via USB input terminal. (➔ 10)
- If you plug in an iPhone/iPod to the USB input terminal while listening to iPod BT source, the source automatically change to iPod FRONT/iPod REAR/iPod USB. Press **⏻ SRC** to select iPod BT if the device is still connected via Bluetooth.

BLUETOOTH®

Internet radio via Bluetooth

You can listen to internet radio (Pandora, iHeartRadio and Spotify) on the iPhone/iPod/Android device via Bluetooth on this unit.

- Make sure the USB input terminal is not connected to any device.

Listen to Pandora (except for `DPX523BT`)

Preparation:

Select [ON] for [PANDORA SRC] in [SOURCE SELECT]. (→ 5)

- 1 Open the Pandora application on your device.
- 2 Connect your device via Bluetooth connection. (→ 21)
- 3 Press **⏻ SRC** repeatedly to select PANDORA (for iPhone/iPod) or PANDORA BT (for Android device).
The source switches and broadcast starts automatically.

- You can operate Pandora in the same way as Pandora via USB input terminal. (→ 13)

Listen to iHeartRadio (except for `DPX523BT`)

Preparation:

Select [ON] for [IHEART SRC] in [SOURCE SELECT]. (→ 5)

- 1 Open the iHeartAuto application on your device.
- 2 Connect your device via Bluetooth connection. (→ 21)
- 3 Press **⏻ SRC** repeatedly to select IHEARTRADIO.
The source switches and broadcast starts automatically.

- You can operate iHeartRadio in the same way as iHeartRadio via USB input terminal. (→ 15)

Listen to Spotify

Preparation:

Select [ON] for [SPOTIFY SRC] in [SOURCE SELECT]. (→ 5)

- 1 Open the Spotify application on your device.
- 2 Connect your device via Bluetooth connection. (→ 21)
- 3 Press **⏻ SRC** repeatedly to select SPOTIFY (for iPhone/iPod) or SPOTIFY BT (for Android device).
The source switches and broadcast starts automatically.

- You can operate Spotify in the same way as Spotify via USB input terminal. (→ 16)

AUDIO SETTINGS

While listening to any source...

- 1 Press the volume knob to enter [FUNCTION].
- 2 Turn the volume knob to select an item (see the following table), then press the knob.
- 3 Repeat step 2 until the desired item is selected or activated.
- 4 Press and hold **Q**/**↵** to exit.

(or using the remote control)

- 1 Press **AUD** to enter [AUDIO CONTROL].
- 2 Press **▲**/**▼** to select an item, then press **ENT ▶ II**.

To return to the previous setting item, press **Q**/**↵**.

Default: **XX**

AUDIO CONTROL							
SUB-W LEVEL	LEVEL -50 to LEVEL +10 (LEVEL 0) : Adjusts the subwoofer output level.						
MANUAL EQ	The sound elements (frequency level, tone level, Q factor) are preset into each selection.						
62.5HZ	<table border="1"> <thead> <tr> <th>LEVEL</th> <th>LEVEL -9 to LEVEL +9 (LEVEL 0)</th> </tr> </thead> <tbody> <tr> <td></td> <td>Adjusts the level to memorize for each source. (Before making an adjustment, select the source you want to adjust.)</td> </tr> <tr> <td>BASS EXTEND</td> <td>ON: Turns on the extended bass. ; OFF: Cancels.</td> </tr> </tbody> </table>	LEVEL	LEVEL -9 to LEVEL +9 (LEVEL 0)		Adjusts the level to memorize for each source. (Before making an adjustment, select the source you want to adjust.)	BASS EXTEND	ON : Turns on the extended bass. ; OFF : Cancels.
LEVEL	LEVEL -9 to LEVEL +9 (LEVEL 0)						
	Adjusts the level to memorize for each source. (Before making an adjustment, select the source you want to adjust.)						
BASS EXTEND	ON : Turns on the extended bass. ; OFF : Cancels.						
100HZ/160HZ/250HZ/400HZ/630HZ/1KHZ/1.6KHZ/2.5KHZ/4KHZ/6.3KHZ/10KHZ/16KHZ	LEVEL -9 to LEVEL +9 (LEVEL 0) : Adjusts the level to memorize for each source. (Before making an adjustment, select the source you want to adjust.)						
Q FACTOR	1.35/1.50/2.00 : Adjust the quality factor.						

PRESET EQ	NATURAL/ROCK/POPS/EASY/TOP40/JAZZ/POWERFUL/USER : Selects a preset equalizer suitable to the music genre. (Select [USER] to use the settings made in [MANUAL EQ].)
BASS BOOST	LEVEL1/LEVEL2/LEVEL3/LEVEL4/LEVEL5 : Selects your preferred bass boost level. ; OFF : Cancels.
LOUDNESS	LEVEL1/LEVEL2 : Selects your preferred low and high frequencies boost to produce a well-balanced sound at a low volume level. ; OFF : Cancels.
SUBWOOFER SET	ON : Turns on the subwoofer output. ; OFF : Cancels.
FADER	R15 to F15 (0) : Adjusts the rear and front speaker output balance.
BALANCE	L15 to R15 (0) : Adjusts the left and right speaker output balance.
VOLUME OFFSET	-15 to +6 (0) : Preset the initial volume level of each source. (Before adjustment, select the source you want to adjust.)
SOUND EFFECT	
SOUND RECNRSTR (Sound reconstruction)	(Not applicable for RADIO source, AUX source and SIRIUS XM source.) ON : Creates realistic sound by compensating the high-frequency components and restoring the rise-time of the waveform that are lost in audio data compression. ; OFF : Cancels.
SPACE ENHANCE	(Not applicable for RADIO source.) SMALL/MEDIUM/LARGE : Virtually enhances the sound space. ; OFF : Cancels.
SND REALIZER	LEVEL1/LEVEL2/LEVEL3 : Virtually makes the sound more realistic. ; OFF : Cancels.
STAGE EQ	LOW/MIDDLE/HIGH : Virtually adjust the sound position heard from the speakers. ; OFF : Cancels.
DRIVE EQ	ON : Boosts the frequency to reduce the noise heard from outside the car or running noise of the tyres. ; OFF : Cancels.

AUDIO SETTINGS

SPEAKER SIZE	The frequency and slope settings are automatically set for the crossover of the selected speaker.	
FRONT	SIZE	3.5"/4"/4.75"/5"/6.5"/6.75"/7"/4×6/5×7/6×8/6×9/7×10: Selects according to the connected speaker size for optimum performance.
	TWEETER	SMALL/MIDDLE/LARGE : Selects according to the size range of the connected tweeter for optimum performance. ; NONE : Not connected.
REAR	3.5"/4"/4.75"/5"/6.5"/6.75"/7"/4×6/5×7/6×8/6×9/7×10: Selects according to the connected speaker size for optimum performance. ; NONE : Not connected.	
SUBWOOFER	6.5"/8"/10"/12"/15" OVER : Selects according to the connected speaker size for optimum performance. ; NONE : Not connected.	
X' OVER		
TWEETER	FRQ	1KHZ/1.6KHZ/2.5KHZ/4KHZ/5KHZ/6.3KHZ/8KHZ/10KHZ/12.5KHZ: Adjusts the crossover frequency for the tweeter speaker.
	GAIN LEFT	–8 to 0: Adjusts the output volume of the left tweeter.
	GAIN RIGHT	–8 to 0: Adjusts the output volume of the right tweeter.
FRONT HPF	F - HPF FRQ	30HZ/40HZ/50HZ/60HZ/70HZ/80HZ/90HZ/100HZ/120HZ/150HZ/180HZ/220HZ/250HZ: Adjusts the crossover frequency for the selected speakers (high pass filter). ; THROUGH : All signals are sent to the selected speakers.
	F - HPF SLOPE	–6DB/–12DB/–18DB/–24DB: Adjusts the crossover slope. (Selectable only if a setting other than [THROUGH] is selected for [F - HPF FRQ] .)
	F - HPF GAIN	–8 to 0: Adjusts the output volume of the selected speaker.

REAR HPF	R - HPF FRQ	
	R - HPF SLOPE	(Refer FRONT HPF settings.)
	R - HPF GAIN	
SUBWOOFER LPF	SW LPF FRQ	30HZ/40HZ/50HZ/60HZ/70HZ/80HZ/90HZ/100HZ/120HZ/150HZ/180HZ/220HZ/250HZ: Adjusts the crossover frequency for the subwoofer (low pass filter). ; THROUGH : All signals are sent to the subwoofer.
	SW LPF SLOPE	–6DB/–12DB/–18DB/–24DB: Adjusts the crossover slope. (Selectable only if a setting other than [THROUGH] is selected for [SW LPF FRQ] .)
	SW LPF PHASE	REVERSE (180°)/ NORMAL (0°): Selects the phase of the subwoofer output to be in line with the speaker output for optimum performance.
	SW LPF GAIN	–8 to 0: Adjusts the output volume of the subwoofer.

DTA SETTINGS

For settings, ➔ 31, Digital Time Alignment settings.

CAR SETTINGS

- The following item is selectable only if **[SUBWOOFER SET]** is set to **[ON]** (➔ 29):
 - **[SUB-W LEVEL]**
 - **[SUBWOOFER]** of **[SPEAKER SIZE]**
 - **[SUBWOOFER LPF]** of **[X' OVER]**
 - **[SUBWOOFER]** of **[DISTANCE]** and **[GAIN]** in **[DTA SETTINGS]**
- The following item is selectable only if a setting other than **[NONE]** is selected for **[TWEETER]**, **[REAR]** and **[SUBWOOFER]** of **[SPEAKER SIZE]**:
 - **[TWEETER]**, **[REAR HPF]**, **[SUBWOOFER LPF]** of **[X' OVER]**

AUDIO SETTINGS

Digital Time Alignment settings

Digital Time Alignment sets the delay time of the speaker output to create a more suitable environment for your vehicle.

- For more information, → **Determining the value for [DISTANCE] and [GAIN] of [DTA SETTINGS].**

Default: **XX**

DTA SETTINGS	
POSITION	Selects your listening position (reference point). ALL: Not compensating ; FRONT RIGHT: Front right seat ; FRONT LEFT: Front left seat ; FRONT ALL: Front seat
DISTANCE	0FT to 20.01FT: Fine adjust the distance to compensate. (Before making an adjustment, select the speaker you want to adjust.)
GAIN	-8DB to 0DB: Fine adjust the output volume of the selected speaker. (Before making an adjustment, select the speaker you want to adjust.)
DTA RESET	YES: Resets the settings ([DISTANCE] and [GAIN]) of the selected [POSITION] to default. ; NO: Cancels.
CAR SETTINGS	
Identify your car type and rear speaker location in order to make the adjustment for [DTA SETTINGS].	
CAR TYPE	COMPACT/FULL SIZE CAR/WAGON/MINIVAN/SUV/MINIVAN(LONG): Selects the type of vehicle. ; OFF: Not compensating.
R - SP LOCATION	Selects the location of the rear speakers in your vehicle to calculate the furthest distance from the listening position selected (reference point). <ul style="list-style-type: none"> DOOR/REAR DECK: Selectable only when [CAR TYPE] is selected as [OFF], [COMPACT], [FULL SIZE CAR], [WAGON] or [SUV]. 2ND ROW/3RD ROW: Selectable only when [CAR TYPE] is selected as [MINIVAN] or [MINIVAN(LONG)].

- Before making an adjustment for [**DISTANCE**] and [**GAIN**] of [**DTA SETTINGS**], select the speaker you want to adjust:
FRONT LEFT/FRONT RIGHT/REAR LEFT/REAR RIGHT/SUBWOOFER:
You can only select [**REAR LEFT**], [**REAR RIGHT**] and [**SUBWOOFER**] if a setting other than [**NONE**] is selected for [**REAR**] and [**SUBWOOFER**] of [**SPEAKER SIZE**]. (→ 30)
- [**R - SP LOCATION**] of [**CAR SETTINGS**] is selectable only if a setting other than [**NONE**] is selected for [**REAR**] of [**SPEAKER SIZE**]. (→ 30)

Determining the value for [DISTANCE] and [GAIN] of [DTA SETTINGS]

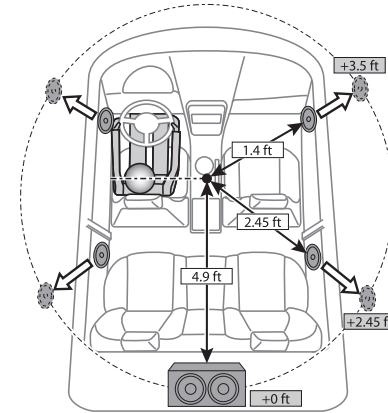

If you specify the distance from the center of the currently set listening position to every speaker, the delay time will be automatically computed and set.

- Determine the center of the currently set listening position as the reference point.
- Measure the distances from the reference point to the speakers.
- Calculate the differences between the distance of the furthest speaker (rear speaker) and other speakers.
- Set the [**DISTANCE**] calculated in step 3 for individual speakers.
- Adjust [**GAIN**] for individual speakers.

Example: When [**FRONT ALL**] is selected as the listening position

DISPLAY SETTINGS

Zone identification for color and brightness settings

Default: **XX**

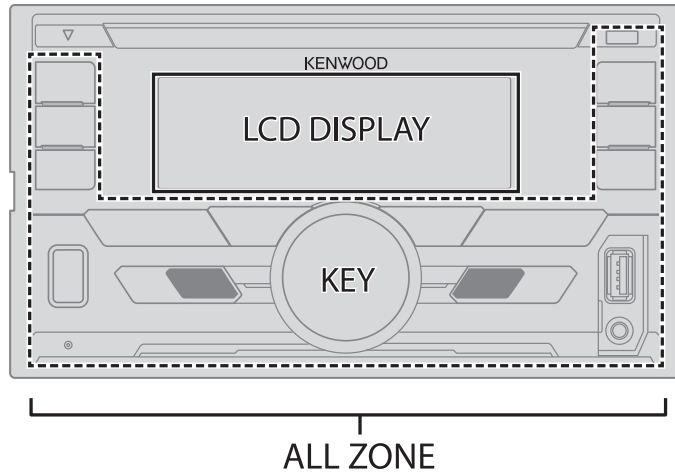

Set the dimmer

Press and hold **DISP (DIM)** to turn on or off the dimmer.

- If you have set [DIMMER TIME], it will be canceled once you press and hold this button.

Other settings

- 1 Press the volume knob to enter [FUNCTION].
- 2 Turn the volume knob to select an item (see the following table), then press the knob.
- 3 Repeat step 2 until the desired item is selected/activated or follow the instructions stated on the selected item.
- 4 Press and hold **Q/↵** to exit.

To return to the previous setting item, press **Q/↵**.

DISPLAY

COLOR SELECT

Select color for **ALL ZONE**, **LCD DISPLAY** and **KEY** separately.

- 1 Select a zone. (See the illustration on the left column.)
- 2 Select a color for the selected zone.
INITIAL COLOR/VARIABLE SCAN/CUSTOM R/G/B/preset colors*

To make your own color, select [CUSTOM R/G/B]. The color you have made will be stored in [CUSTOM R/G/B].

- 1 Press the volume knob to enter the detailed color adjustment.
- 2 Press **◀◀ / ▶▶** to select the color (R/G/B) to adjust.
- 3 Turn the volume knob to adjust the level (0 to 9), then press the knob.

DIMMER

Dim the illumination.

ON: Dimmer is turned on. ; **OFF**: Cancels.

DIMMER TIME: Set the dimmer on and off time.

- 1 Turn the volume knob to adjust the [ON] time, then press the knob.
- 2 Turn the volume knob to adjust the [OFF] time, then press the knob.
(Default: [ON]: **PM6:00**; [OFF]: **AM6:00**)

BRIGHTNESS

- 1 Select a zone. (See the illustration on the left column.)
- 2 **0 to 31**: Select your preferred brightness level for the selected zone.

TEXT SCROLL

AUTO/ONCE: Select whether to scroll the display information automatically, or scroll only once. ; **OFF**: Cancels.

* Preset colors: **RED1/RED2/RED3/PURPLE1/PURPLE2/PURPLE3/PURPLE4/BLUE1/BLUE2/BLUE3/SKYBLUE1/SKYBLUE2/LIGHTBLUE/AQUA1/AQUA2/GREEN1/GREEN2/GREEN3/YELLOWGREEN1/YELLOWGREEN2/YELLOW/ORANGE1/ORANGE2/ORANGERED**

LEARNING STEERING REMOTE CONTROL (for DPX523BT)

You can control the unit with the steering remote control keys on your vehicle. After connection, you can configure the control keys according to your preference.

- You can only make this configuration if your vehicle is equipped with the electrical steering remote control.
- If the steering remote control in your car is not compatible, configuration may not be completed and an error message may appear. (→ 41)

Make the connection

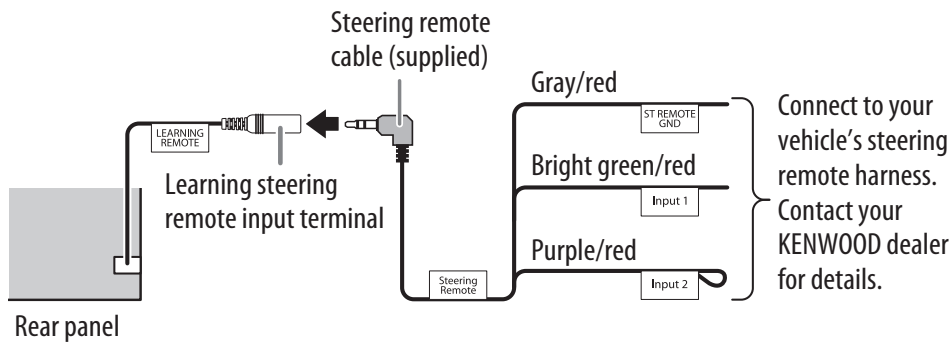

Configure the control keys

- 1 Press **⏻ SRC** repeatedly to enter **STANDBY**.
- 2 Press the volume knob to enter **[FUNCTION]**.
- 3 Turn the volume knob to select **[SYSTEM]**, then press the knob.
- 4 Turn the volume knob to select **[USER S.REM0]**, then press the knob.
- 5 Turn the volume knob to select **[SET KEY]**, then press the knob.
A key list of 16 assignable keys appears.
 - **K## NONE**: No function has been assigned.
- 6 Turn the volume knob to select any key from the key list to assign the function, then press the knob.
"PRESS KEY TO ASSIGN K##" appears.

- 7 Press and hold any control keys on your steering remote control which you want to assign.
A list of key functions will appear on the display.
NONE (default)/**ATT/SEEK UP/SEEK DOWN/VOL UP/VOL DOWN/MODE/ON HOOK/OFF HOOK/VOICE/ENTER**
- 8 Turn the volume knob to select a function to assign, then press the knob.
The selected key function is assigned to the steering remote control key you have selected in step 7.
The display returns to the key list as on step 5.
 - **K## (Function)**: When certain function has been assigned to a key.
- 9 Repeat steps 6, 7 and 8 to assign other control keys.
- 10 Press and hold **Q/↵** to exit.

To reassign the control keys

- 1 Press **⏻ SRC** repeatedly to enter **STANDBY**.
- 2 Press the volume knob to enter **[FUNCTION]**.
- 3 Turn the volume knob to select **[SYSTEM]**, then press the knob.
- 4 Turn the volume knob to select **[USER S.REM0]**, then press the knob.
- 5 Turn the volume knob to select **[RESET KEY]**, then press the knob.
- 6 Turn the volume knob to select **[YES]**, then press the knob.
All the control keys will be reset.
Selecting **[NO]** will cancel the operation.

When **[FACTORY RESET]** is set to **[YES]** (→ 6), it will also reset the learning steering remote control.

To return to the previous setting item, press **Q/↵**.

REFERENCES

■ Maintenance

Cleaning the unit

Wipe off dirt on the faceplate with a dry silicone or soft cloth.

Handling discs

- Do not touch the recording surface of the disc.
- Do not stick tape etc. on the disc, or use a disc with tape stuck on it.
- Do not use any accessories for the disc.
- Clean from the center of the disc and move outward.
- Clean the disc with a dry silicone or soft cloth. Do not use any solvents.
- When removing discs from this unit, pull them out horizontally.
- Remove burrs from the center hole and disc edge before inserting a disc.

■ More information

For: – Latest firmware updates and latest compatible item list
– KENWOOD original application
– Any other latest information

Visit <www.kenwood.com/cs/ce/>.

General

- This unit can only play the following CDs:



- For detailed information and notes about the playable audio files, visit <www.kenwood.com/cs/ce/audiofile/>.

Playable files

- Playable audio file:
For disc: MP3 (.mp3), WMA (.wma), AAC (.aac)
For USB mass storage class device: MP3 (.mp3), WMA (.wma), AAC (.aac), AAC (.m4a), WAV (.wav), FLAC (.flac)
- Playable disc media: CD-R/CD-RW/CD-ROM
- Playable disc file format: ISO 9660 Level 1/2, Joliet, Long file name.
- Playable USB device file system: FAT12, FAT16, FAT32
Even when audio files comply with the standards listed above, playback may be impossible depending on the types or conditions of media or device.
The AAC (.m4a) file in a CD encoded by iTunes cannot be played on this unit.

Unplayable discs

- Discs that are not round.
- Discs with coloring on the recording surface or discs that are dirty.
- Recordable/ReWritable discs that have not been finalized.
- 8 cm CD. Attempting to insert using an adapter may cause malfunction.

About USB devices

- You cannot connect a USB device via a USB hub.
- Connecting a cable whose total length is longer than 5 m may result in abnormal playback.
- This unit cannot recognize a USB device whose rating is other than 5 V and exceeds 1.5 A.

About iPod/iPhone

- Via USB:
Made for
 - iPod touch (5th and 6th generation)
 - iPod nano (7th generation)
 - iPhone 4S, 5, 5S, 5C, 6, 6 Plus, 6S, 6S Plus, SE, 7, 7 Plus
- Via Bluetooth:
Made for
 - iPod touch (5th and 6th generation)
 - iPhone 4S, 5, 5S, 5C, 6, 6 Plus, 6S, 6S Plus, SE, 7, 7 Plus
- You cannot operate iPod if “KENWOOD” or “✓” is displayed on iPod.
- Depending on the version of the operating system of the iPod/iPhone, some functions may not operate on this unit.

REFERENCES

About Android device

- This unit supports Android OS 4.1 and above.
- Some Android devices (with OS 4.1 and above) may not fully support Android Open Accessory (AOA) 2.0.
- If the Android device supports both mass storage class device and AOA 2.0, this unit always playback via AOA 2.0 as priority.

About Pandora

- Pandora is only available in certain countries.
For more information, visit <<http://www.pandora.com/legal>>.
- Because Pandora is a third-party service, the specifications are subject to change without prior notice. Accordingly, compatibility may be impaired, or some or all of the services may become unavailable.
- Some functions of Pandora cannot be operated from this unit.
- For issues using the application, please contact Pandora at pandora-support@pandora.com.

About iHeartRadio

- iHeartRadio® is a third-party service, therefore the specifications are subject to change without prior notice. Accordingly, compatibility may be impaired or some or all of the services may become unavailable.
- Some iHeartRadio® functionality cannot be operated from this unit.

About Spotify

- Spotify application supports:
 - iPhone 4S, 5, 5S, 5C, 6, 6 Plus, 6S, 6S Plus, SE, 7, 7 Plus (iOS 8 or above)
 - iPod touch (5th and 6th generation)
 - Android OS 4.0.3 or above
- Spotify is a third-party service, therefore the specifications are subject to change without prior notice. Accordingly, compatibility may be impaired or some or all of the services may become unavailable.
- Some functions of Spotify cannot be operated from this unit.
- For issues using the application, please contact Spotify at <www.spotify.com>.

About Bluetooth

- Depending on the Bluetooth version of the device, some Bluetooth devices may not be able to connect to this unit.
- This unit may not work with some Bluetooth devices.
- Signal conditions vary, depending on the surroundings.

About HD Radio™ Technology

HD2/HD3

- Adjacent to traditional main stations are extra local FM channels. These HD2/HD3 Channels provide new, original music as well as deep cuts into traditional genre.

Digital Sound

- Digital, CD-quality sound. HD Radio Technology enables local radio stations to broadcast a clean digital signal. AM sounds like today's FM and FM sounds like a CD.

Program Info

- Program Info provides song name, artist, station ID, and other relevant data to enrich the listening experience.

Emergency Alerts

- Emergency Alert delivers critical and life-saving messages to the public during emergency situations.

REFERENCES

Change the display information

Each time you press **DISP**, the display information changes.

- If the information is unavailable or not recorded, "NO TEXT", "NO INFO", or other information (eg. station name, playing time) appears.

Source name	Display information
STANDBY	Source name (Date)* ¹
HD RADIO	(For DPX793BH) (For digital stations only) Station name (Date)* ¹ → Song title (Artist) → Song title (Album title) → Song title (Date)* ¹ → Frequency (Date)* ¹ → (back to the beginning) (For FM Radio Broadcast Data System stations only) Station name (Date)* ¹ → Radio text+ (R.TEXT+ / Artist) → Radio text+ (R.TEXT+ / Album title) → Song title (Date)* ¹ → Frequency (Date)* ¹ → (back to the beginning)
RADIO	(For DPX593BT / DPX540BT / DPX523BT / DPX503BT / DPX303MBT) Frequency (Date)* ¹ → (* ²) → (back to the beginning) (For FM Radio Broadcast Data System/Radio Data System stations only) Station name (Date)* ¹ → (* ²) → Radio text (Date)* ¹ → Radio text+ (R.TEXT+) → Song title (Artist) → Song title (Date)* ¹ → Frequency (Date)* ¹ → (back to the beginning)
CD or USB FRONT/ USB REAR/USB	(For CD-DA) Track title (Artist) → (* ²) → Track title (Disc name) → Track title (Date)* ¹ → Playing time (Date)* ¹ → (back to the beginning) (For MP3/WMA/AAC/WAV/FLAC files) Song title (Artist) → (* ²) → Song title (Album title) → Song title (Date)* ¹ → File name (Folder name) → File name (Date)* ¹ → Playing time (Date)* ¹ → (back to the beginning)

Source name	Display information
iPod FRONT/iPod REAR/ iPod USB/iPod BT or ANDROID FRONT/ ANDROID REAR/ ANDROID	When [MODE OFF]/[BROWSE MODE] is selected (→ 11): Song title (Artist) → (* ²) → Song title (Album name) → Song title (Date)* ¹ → Playing time (Date)* ¹ → (back to the beginning)
PANDORA FRONT/ PANDORA REAR/ PANDORA/PANDORA BT	Station name (Date)* ¹ → Shared/Radio station (Date)* ¹ → Song title (Artist) → Song title (Album title) → Song title (Date)* ¹ → Playing time (Date)* ¹ → (back to the beginning)
IHEARTRADIO-F/ IHEARTRADIO-R/ IHEARTRADIO	Station name (Date)* ¹ → Song title (Artist) → Song title (Date)* ¹ → (back to the beginning)
SPOTIFY FRONT/ SPOTIFY REAR/SPOTIFY/ SPOTIFY BT	Context title (Date)* ¹ → (* ²) → Song title (Artist) → Song title (Album name) → Song title (Date)* ¹ → Playing time (Date)* ¹ → (back to the beginning)
SIRIUS XM	Channel number (Status) → Channel name (Status) → Artist name (Status) → Song title (Status) → Content information (Status) → Category name (Status) → Date (Status) → (back to the beginning)
BT AUDIO	Song title (Artist) → (* ²) → Song title (Album name) → Song title (Date)* ¹ → Playing time (Date)* ¹ → (back to the beginning)
AUX	Source name (Date)* ¹ → (* ²) → (back to the beginning)

*¹ Battery and signal strength of the Bluetooth device will be shown if **[BATT/SIGNAL]** is set to **[AUTO]**. (→ **23**)

*² Only for **DPX523BT** : Turn off the display information.

INSTALLATION/CONNECTION

⚠ Warning

- The unit can only be used with a 12 V DC power supply, negative ground.
- Disconnect the battery's negative terminal before wiring and mounting.
- Do not connect Battery wire (yellow) and Ignition wire (red) to the car chassis or Ground wire (black) to prevent a short circuit.
- To prevent short-circuit:
 - Insulate unconnected wires with vinyl tape.
 - Be sure to ground this unit to the car's chassis again after installation.
 - Secure the wires with cable clamps and wrap vinyl tape around the wires that come into contact with metal parts to protect the wires.

⚠ Caution

- For safety's sake, leave wiring and mounting to professionals. Consult the car audio dealer.
- Install this unit in the console of your vehicle. Do not touch the metal parts of this unit during and shortly after use of the unit. Metal parts such as the heat sink and enclosure become hot.
- Do not connect the ⊖ wires of speakers to the car chassis or Ground wire (black), or connect them in parallel.
- Mount the unit at an angle of less than 30°.
- If your vehicle wiring harness does not have the ignition terminal, connect Ignition wire (red) to the terminal on the vehicle's fuse box which provides 12 V DC power supply and is turned on and off by the ignition key.
- Keep all cables away from heat dissipate metal parts.
- After the unit is installed, check whether the brake lamps, blinkers, wipers, etc. on the car are working properly.
- If the fuse blows, first make sure the wires are not touching car's chassis, then replace the old fuse with one that has the same rating.

Basic procedure

- 1 Remove the key from the ignition switch, then disconnect the ⊖ terminal of the car battery.
- 2 Connect the wires properly.
See Wiring connection. (➔ 39)
- 3 Install the unit to your car.
See Installing the unit (in-dash mounting). (➔ 38)
- 4 Connect the ⊖ terminal of the car battery.
- 5 Press **SRC** to turn on the power.
- 6 Reset the unit. (➔ 3)

Part list for installation

(Parts supplied for **DPX793BH** / **DPX593BT** / **DPX523BT**)

(A) Mounting sleeve

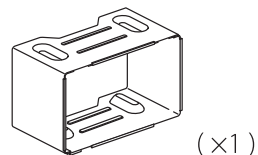

(B) Trim plate

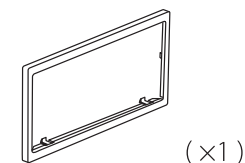

(C) Trim plate (only for Toyota car)

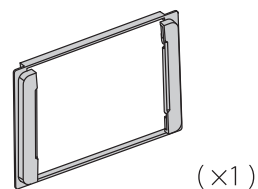

(D) Extraction key

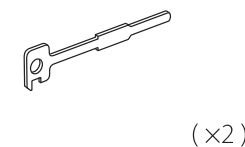

(Parts supplied for all models)

(E) Wiring harness

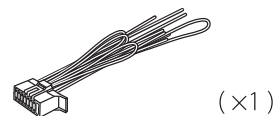

(F) Round head screws (M5 × 8 mm)



(G) Flat head screws (M5 × 8 mm)



INSTALLATION/CONNECTION

(For **DPX793BH** / **DPX593BT** / **DPX523BT**)

Installing the unit (in-dash mounting)

Do the required wiring.
(→ 39)

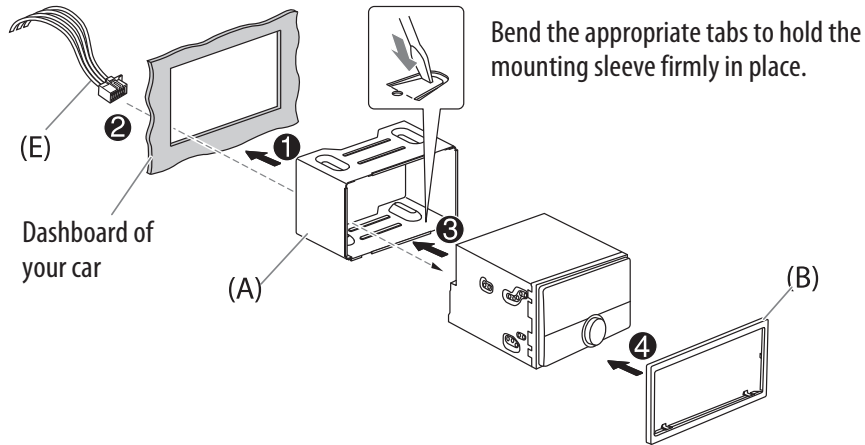

Installing in Toyota cars

Install onto the car brackets using screws **(F)** or **(G)** (supplied). Use the mounting holes **(X)** or **(Y)** that fit the car brackets. Then, install the supplied trim plate **(C)**.

Do the required wiring.
(→ 39)

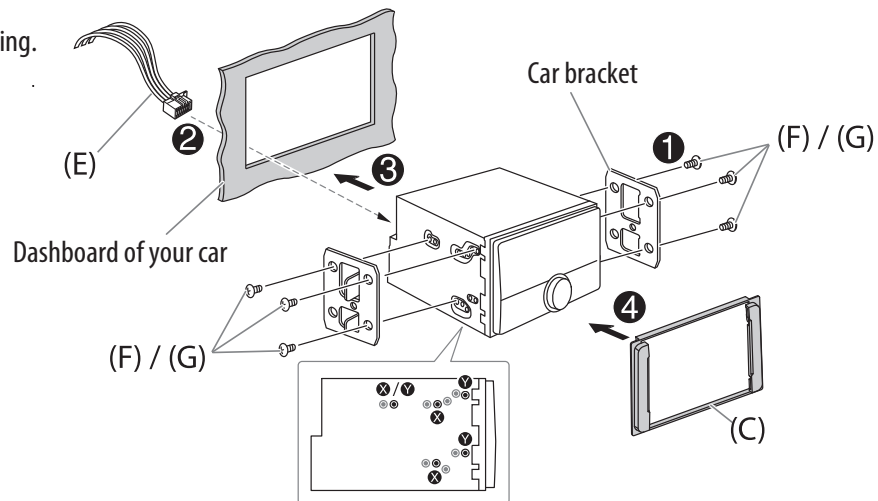

When installing without the mounting sleeve

Align the holes in the unit (on both sides) with the vehicle mounting bracket and secure the unit with screws (supplied).

* For **DPX793BH** / **DPX593BT** / **DPX523BT** :
Remove the mounting sleeve and trim plate from the unit before installing.

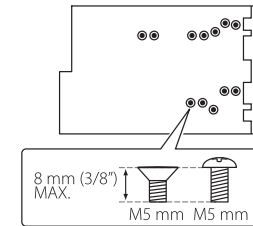

▲ Use only the specified screws. Using wrong screws might damage the unit.

(For **DPX793BH** / **DPX593BT** / **DPX523BT**)

How to remove the unit

- 1 Fit the catch pin on the extraction keys into the holes on both sides of the trim plate, then pull it out.
- 2 Insert the extraction keys deeply into the slots on each side, then follow the arrows as shown on the illustration.

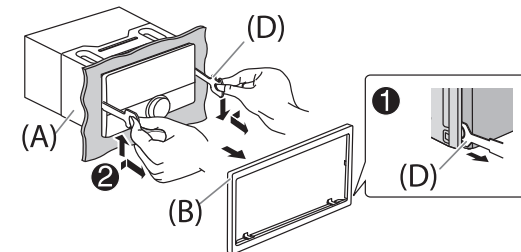

INSTALLATION/CONNECTION

Wiring connection

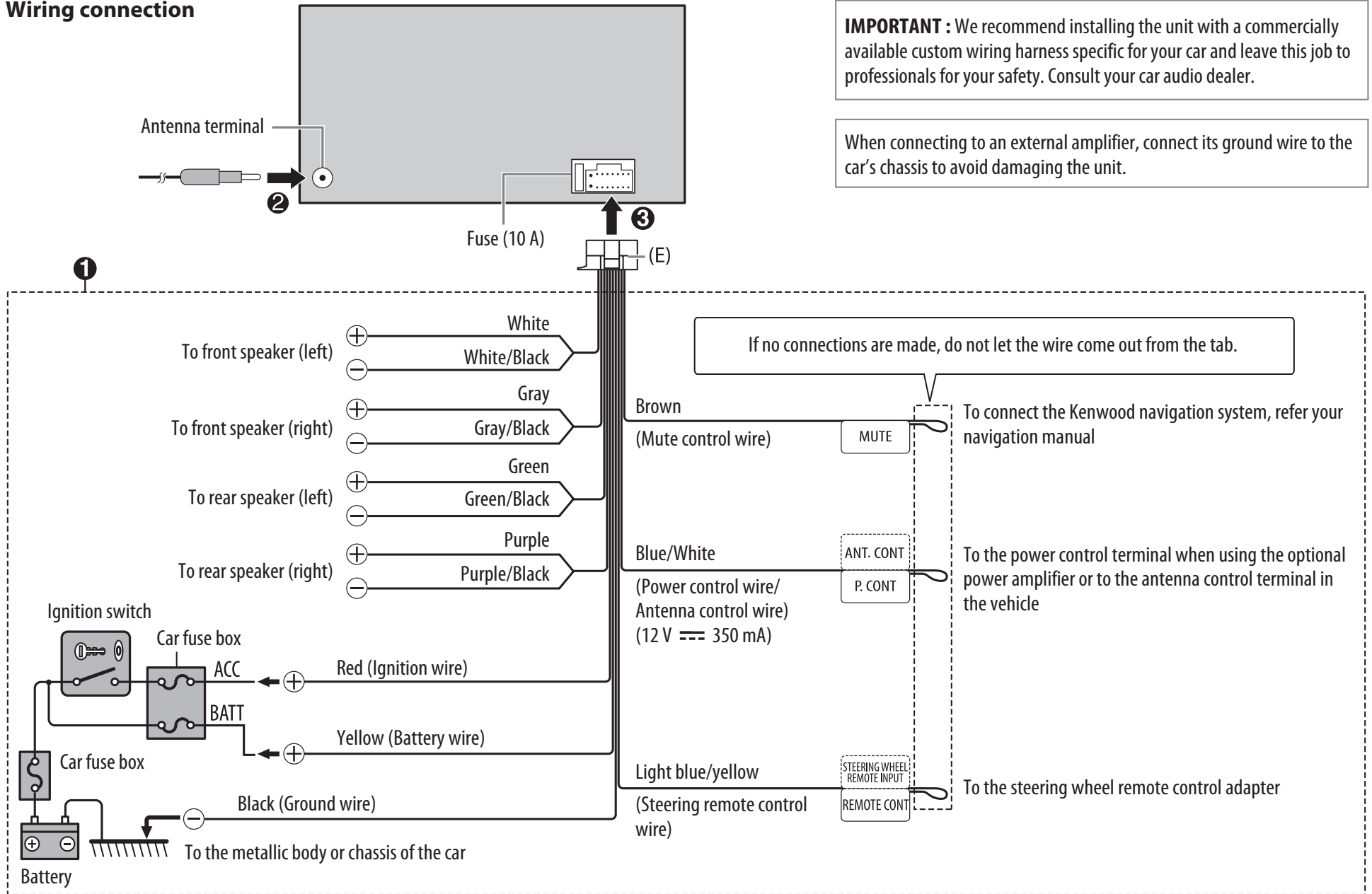

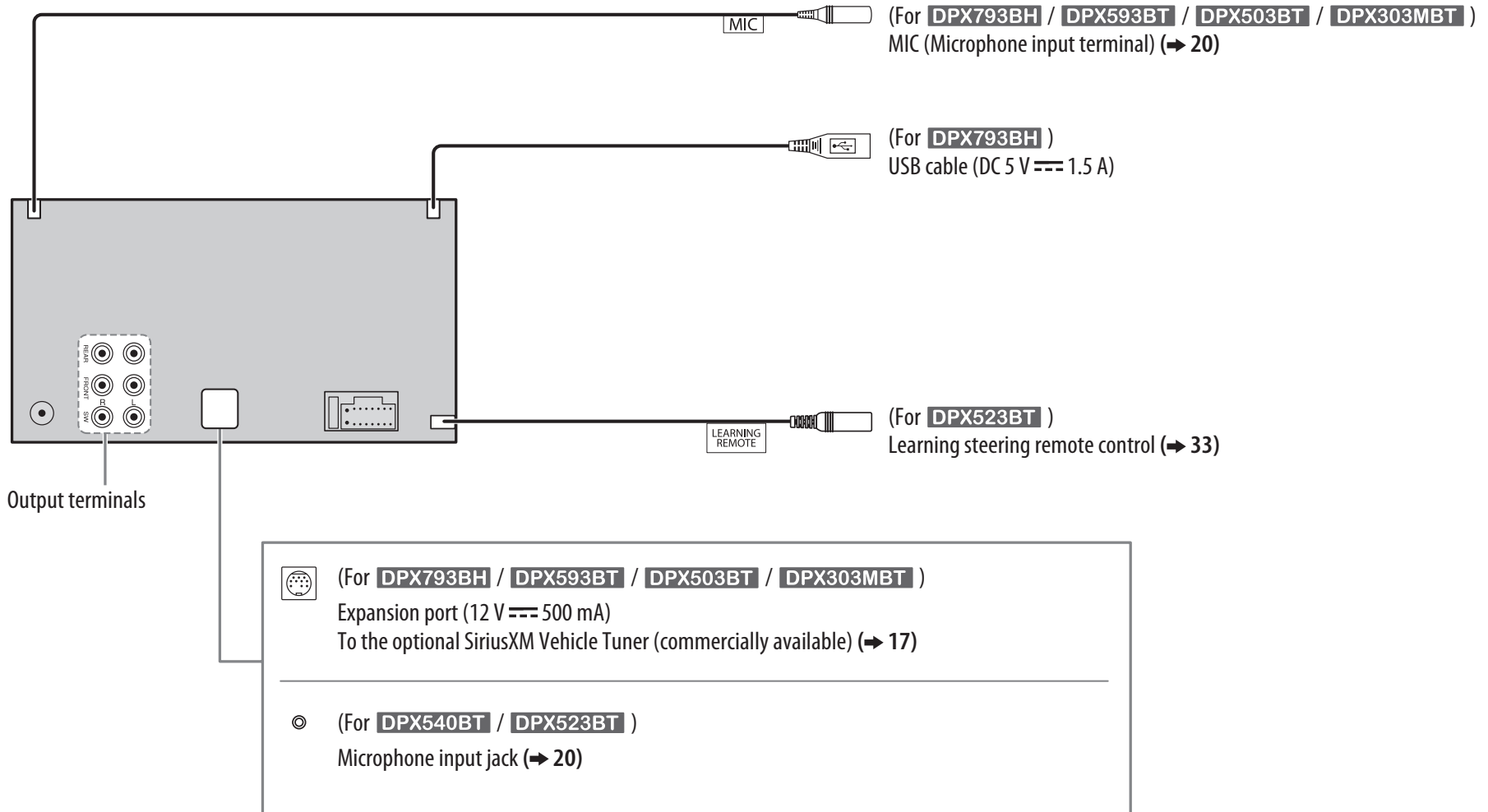

INSTALLATION/CONNECTION

Connecting external components



TROUBLESHOOTING

	Symptom	Remedy
General	Sound cannot be heard.	<ul style="list-style-type: none"> Adjust the volume to the optimum level. Check the cords and connections.
	"MISWIRING CHECK WIRING THEN PWR ON" appears.	Turn the power off, then check to be sure the terminals of the speaker wires are insulated properly. Turn the power on again.
	"PROTECTING SEND SERVICE" appears.	Send the unit to the nearest service center.
	The unit does not work at all.	Reset the unit. (➔ 3)
	(For DPX523BT) "ERROR"/"FAIL"	Your steering remote controller is not compatible, learning may not be completed. Consult your car audio dealer for details.
HD Radio tuner/ Radio	<ul style="list-style-type: none"> Radio reception is poor. Static noise while listening to the radio. 	Connect the antenna firmly.
CD/USB/iPod	Disc cannot be ejected.	Press and hold  to forcibly eject the disc. Be careful not to drop the disc when it is ejected. If this does not solve the problem, reset the unit. (➔ 3)
	Noise is generated.	Skip to another track or change the disc.
	Tracks do not play back as you intended them to play.	Playback order is determined when files are recorded.
	"READING" keeps flashing.	Do not use too many hierarchical levels or folders.
	Elapsed playing time is not correct.	This is caused by how the tracks are recorded.

	Symptom	Remedy
CD/USB/iPod	"LOADING" appears when you enter search mode by pressing  /  .	This unit is still preparing the iPod/iPhone music list. It may take some time to load, try again later.
	Correct characters are not displayed (e.g. album name).	<ul style="list-style-type: none"> This unit can only display uppercase letters, numbers, and a limited number of symbols. Depending on the display language you have selected (➔ 6), some characters may not be displayed correctly.
	"NA FILE"	Make sure the media contains supported audio files. (➔ 34)
	"NO DISC"	Insert a playable disc into the loading slot.
	"TOC ERROR"	Make sure the disc is clean and inserted properly.
	"PLEASE EJECT"	Reset the unit. If this does not solve the problem, consult your nearest service centre.
	"NO DEVICE"	Connect a USB device, and change the source to USB again.
	"COPY PRO"	A copy-protected file is played.
	"UNSUPPORTED DEVICE"	<ul style="list-style-type: none"> Check whether the connected device is compatible with this unit and ensure the file systems are in supported formats. (➔ 34) Reattach the device.
	"UNRESPONSIVE DEVICE"	Make sure the device is not malfunction and reattach the device.
"USB HUB IS NOT SUPPORTED"	This unit cannot support a USB device connected via a USB hub.	

TROUBLESHOOTING

	Symptom	Remedy
CD/USB/iPod	<ul style="list-style-type: none"> The source does not change to "USB" when you connect a USB device while listening to another source. "USB ERROR" appears. 	<p>The USB port is drawing more power than the design limit. Turn the power off and unplug the USB device. Then, turn on the power and reattach the USB device. If this does not solve the problem, turn the power off and on (or reset the unit) before replacing with another USB device.</p>
	"NO MUSIC"	Connect a USB device that contains playable audio files.
	"iPod ERROR"	<ul style="list-style-type: none"> Reconnect the iPod. Reset the iPod.
ANDROID	<ul style="list-style-type: none"> Sound cannot be heard during playback. Sound output only from the Android device. 	<ul style="list-style-type: none"> Reconnect the Android device. If in [HAND MODE], launch any media player application on the Android device and start playback. If in [HAND MODE], relaunch the current media player application or use another media player application. Restart the Android device. If this does not solve the problem, the connected Android device is unable to route the audio signal to unit. (➔ 35)
	Cannot playback at [BROWSE MODE] .	<ul style="list-style-type: none"> Make sure KENWOOD MUSIC PLAY APP is installed on the Android device. (➔ 10) Reconnect the Android device and select the appropriate control mode. If this does not solve the problem, the connected Android device does not support [BROWSE MODE]. (➔ 35)

	Symptom	Remedy
ANDROID	"NO DEVICE" or "READING" keeps flashing.	<ul style="list-style-type: none"> Switch off the developer options on the Android device. Reconnect the Android device. If this does not solve the problem, the connected Android device does not support [BROWSE MODE]. (➔ 35)
	Playback is intermittent or sound skips.	Turn off the power saving mode on the Android device.
	"ANDROID ERROR"/ "NA DEVICE"	<ul style="list-style-type: none"> Reconnect the Android device. Restart the Android device.
Pandora	"ADD ERROR"	New station creation is unsuccessful.
	"CHECK DEVICE"	Check the Pandora application on your device.
	"NO SKIPS"	The skip limit has been reached.
	"NO STATIONS"	No stations are found.
	"STATION LIMIT"	The number of registered stations has reached its limit. Retry after deleting unnecessary stations from your device.
	"CONNECT ERROR"	Communication is unstable.
	"RATING ERROR"	Registration of thumbs up/thumbs down has failed due to insufficient network connectivity.
iHeartRadio	"THUMBS N/A"	Registration of thumbs up/thumbs down is not allowed.
	"LICENSE ERROR"	You try to access from a country which Pandora is not deliverable.
	iHeartRadio station cannot be selected.	If "Explicit Content" in [Account Settings] is checked in the web version of iHeartRADIO, custom stations become unavailable.
	"NOT CONNECTED"	Link to the application is impossible.

TROUBLESHOOTING

	Symptom	Remedy
Spotify	"DISCONNECTED"	USB is disconnected from the head unit. Please make sure the device is connected properly through USB.
	"CONNECTING"	<ul style="list-style-type: none"> Connected via USB input terminal: The device is connecting to the head unit. Please wait. Connected via Bluetooth: The Bluetooth is disconnected. Please check Bluetooth connection and make sure both the device and the unit are paired and connected.
	"CHECK APP"	The Spotify application is not connected properly, or user is not login. End the Spotify application and restart, then login to your Spotify account.
SiriusXM® Radio	"CH LOCKED LOCK CODE?"	The selected channel is locked. Enter the correct pass code to unlock. (➔ 19)
	"CHAN UNSUB"	The selected channel is unsubscribed. Call 1-866-635-2349 in the U.S.A. or 1-877-438-9677 in Canada to subscribe. (➔ 17)
	"CH UNAVAIL"	The selected channel is unavailable. Visit www.siriusxm.com for more information about the SiriusXM channel lineup.
	"CHECK ANTENNA"	Check that the antenna and its connection are in good condition.
	"CHECK TUNER"	Make sure the SiriusXM Vehicle Tuner is connected to the unit.
	"NO SIGNAL"	Make sure the antenna is mounted outside the vehicle.
	"SUBSCRIPTION UPDATED – PRESS ENTER TO CONTINUE."	Your subscription is updated. Press the volume knob to continue.
	"CODE ERROR"	Make sure you have entered the correct pass code. (➔ 19)
	"NO CONTENT"	There is insufficient content to start TuneScan.
"SCAN CANCEL"	TuneScan has been aborted.	

	Symptom	Remedy
Bluetooth®	No Bluetooth device is detected.	<ul style="list-style-type: none"> Search from the Bluetooth device again. Reset the unit. (➔ 3)
	Bluetooth pairing cannot be made.	<ul style="list-style-type: none"> Make sure you have entered the same PIN code to both the unit and Bluetooth device. Delete pairing information from both the unit and the Bluetooth device, then perform pairing again. (➔ 21)
	Echo or noise is heard during a phone conversation.	<ul style="list-style-type: none"> Adjust the microphone unit's position. (➔ 20) Check the [ECHO CANCEL] setting. (➔ 23)
	Phone sound quality is poor.	<ul style="list-style-type: none"> Reduce the distance between the unit and the Bluetooth device. Move the car to a place where you can get a better signal reception.
	Voice calling method is not successful.	<ul style="list-style-type: none"> Use voice calling method in a more quiet environment. Reduce the distance from the microphone when you speak the name. Make sure the same voice as the registered voice tag is used.
	Sound is being interrupted or skipped during playback of a Bluetooth audio player.	<ul style="list-style-type: none"> Reduce the distance between the unit and the Bluetooth audio player. Turn off, then turn on the unit and try to connect again. Other Bluetooth devices might be trying to connect to the unit.
	The connected Bluetooth audio player cannot be controlled.	<ul style="list-style-type: none"> Check whether the connected Bluetooth audio player supports Audio/Video Remote Control Profile (AVRCP). (Refer to the instructions of your audio player.) Disconnect and connect the Bluetooth player again.

TROUBLESHOOTING

Symptom	Remedy
"DEVICE FULL"	The number of registered devices has reached its limit. Retry after deleting an unnecessary device. (→ 25, DEVICE DELETE)
"N/A VOICE TAG"	Make sure the same voice as the registered voice tag is used.
"NOT SUPPORT"	The connected phone does not support Voice Recognition feature or phonebook transfer.
"NO ENTRY"/"NO PAIR"	There is no registered device connected/found via Bluetooth.
"ERROR"	Try the operation again. If "ERROR" appears again, check if the device supports the function you have tried.
"NO INFO"/"NO DATA"	Bluetooth device cannot get the contact information.
"HF ERROR XX"/ "BT ERROR"	Reset the unit and try the operation again. If this does not solve the problem, consult your nearest service center.
"SWITCHING NG"	The connected phones might not support phone switching feature.

SPECIFICATIONS

		DPX793BH / DPX593BT / DPX540BT / DPX503BT / DPX303MBT :	
Tuner	FM	Frequency Range	87.9 MHz — 107.9 MHz (200 kHz space) DPX523BT : 87.5 MHz — 108.0 MHz (50 kHz space)
		Usable Sensitivity (S/N = 30 dB, Dev 22.5 kHz)	8.2 dBf (0.71 μV/75 Ω)
	Quieting Sensitivity (S/N = 46 dB, Dev 40 kHz)	17.2 dBf (2.0 μV/75 Ω)	
	Frequency Response (±3 dB)	HD Radio Broadcast: 20 Hz — 20 kHz Conventional Broadcast: 30 Hz — 15 kHz	
	Signal-to-Noise Ratio	HD Radio Broadcast: 75 dB (STEREO) Conventional Broadcast: 64 dB (MONO)	
	Stereo Separation (1 kHz)	40 dB	
	AM	Frequency Range	530 kHz — 1 700 kHz (10 kHz space)
		Usable Sensitivity (S/N = 20 dB)	29 dBμ (28.2 μV)
		Frequency Response (±3 dB)	HD Radio Broadcast: 40 Hz — 15 kHz
		Signal-to-Noise Ratio	HD Radio Broadcast: 70 dB (STEREO)

SPECIFICATIONS

For DPX793BH / DPX593BT / DPX540BT / DPX523BT / DPX503BT :		
CD player	Laser Diode	GaAlAs
	Digital Filter (D/A)	8 times over sampling
	Spindle Speed	500 rpm — 200 rpm (CLV)
	Wow & Flutter	Below measurable limit
	Frequency Response (± 1 dB)	20 Hz — 20 kHz
	Total Harmonic Distortion (1 kHz)	0.01 %
	Signal-to-Noise Ratio (1 kHz)	DPX793BH / DPX593BT : 110 dB DPX540BT / DPX523BT / DPX503BT : 105 dB
	Dynamic Range	90 dB
	Channel Separation	85 dB
	MP3 Decode	Compliant with MPEG-1/2 Audio Layer-3
	WMA Decode	Compliant with Windows Media Audio
	AAC Decode	AAC-LC “.aac” files

For DPX793BH / DPX593BT / DPX540BT / DPX523BT / DPX503BT :		
USB	USB Standard	USB 1.1/USB 2.0 Full Speed
	File System	FAT12/16/32
	Maximum Supply Current	DC 5 V \equiv 1.5 A
	MP3 Decode	Compliant with MPEG-1/2 Audio Layer-3
	WMA Decode	Compliant with Windows Media Audio
	AAC Decode	AAC-LC “.aac”, “.m4a” files
	WAV Decode	Linear-PCM
	FLAC Decode	FLAC file (Up to 96 kHz/24 bit)

For DPX303MBT :		
USB	USB Standard	USB 1.1/USB 2.0 Full Speed
	File System	FAT12/16/32
	Maximum Supply Current	DC 5 V \equiv 1.5 A
	Frequency Response (± 1 dB)	20 Hz — 20 kHz
	Signal-to-Noise Ratio (1 kHz)	105 dB
	Dynamic Range	90 dB
	Channel Separation	85 dB
	MP3 Decode	Compliant with MPEG-1/2 Audio Layer-3
	WMA Decode	Compliant with Windows Media Audio
	AAC Decode	AAC-LC “.aac”, “.m4a” files
	WAV Decode	Linear-PCM
	FLAC Decode	FLAC file (Up to 96 kHz/24 bit)

SPECIFICATIONS

Bluetooth	Version	Bluetooth 3.0		
	Frequency Range	2.402 GHz — 2.480 GHz		
	Output Power	+4 dBm (MAX), 0 dBm (AVE) Power Class 2		
	Maximum Communication Range	Line of sight approx. 10 m (32.8 ft)		
	Profile	HFP 1.6 (Hands-Free Profile) A2DP (Advanced Audio Distribution Profile) AVRCP 1.5 (Audio/Video Remote Control Profile) SPP (Serial Port Profile) PBAP (Phonebook Access Profile)		
Auxiliary	Frequency Response (± 3 dB)	20 Hz — 20 kHz		
	Input Maximum Voltage	1 000 mV		
	Input Impedance	30 k Ω		
Audio	Maximum Output Power	50 W \times 4		
	Full Bandwidth Power	22 W \times 4 (at less than 1 % THD)		
	Speaker Impedance	4 Ω — 8 Ω		
	Tone Action	Band 1:	62.5 Hz ± 9 dB	
		Band 2:	100 Hz ± 9 dB	
		Band 3:	160 Hz ± 9 dB	
		Band 4:	250 Hz ± 9 dB	
Band 5:		400 Hz ± 9 dB		
Band 6:		630 Hz ± 9 dB		
Band 7:		1 kHz ± 9 dB		
Band 8:		1.6 kHz ± 9 dB		
Band 9:		2.5 kHz ± 9 dB		
Band 10:		4 kHz ± 9 dB		
Band 11:	6.3 kHz ± 9 dB			
Band 12:	10 kHz ± 9 dB			
Band 13:	16 kHz ± 9 dB			

Audio	Preout Level/Load	CD	DPX793BH / DPX593BT : 5 000 mV/10 k Ω	
			DPX540BT / DPX523BT / DPX503BT : 2 500 mV/10 k Ω	
		USB	DPX303MBT : 2 500 mV/10 k Ω	
	Preout Impedance		$\leq 600 \Omega$	
General	Operating Voltage	14.4 V (10.5 V — 16 V allowable)		
	Maximum Current Consumption	10 A		
	Operational Temperature Range	-10°C — +60°C		
	Installation Size (W \times H \times D)	DPX793BH / DPX593BT / DPX523BT :	182 mm \times 111 mm \times 158 mm (7-3/16" \times 4-3/8" \times 6-1/4")	
		DPX540BT / DPX503BT / DPX303MBT :	180 mm \times 100 mm \times 158 mm (7-1/8" \times 4" \times 6-1/4")	
Net Weight (includes Trimplate, Mounting Sleeve)	DPX793BH / DPX593BT / DPX523BT :	1.6 kg (3.6 lbs)		
	DPX540BT / DPX503BT :	1.3 kg (2.9 lbs)		
	DPX303MBT :	0.9 kg (2 lbs)		

Subject to change without notice.



HD Radio®
This HD Radio receiver enables:

- HD2/HD3)
- Digital Sound)
- Program Info)
- Emergency Alerts)

- Microsoft and Windows Media are either registered trademarks or trademarks of Microsoft Corporation in the United States and/or other countries.
- HD Radio Technology manufactured under license from iBiquity Digital Corporation. U.S. and Foreign Patents. For patents see <http://dts.com/patents>. HD Radio™ and the HD, HD Radio, and “ARC” logos are registered trademarks or trademarks of iBiquity Digital Corporation in the United States and/or other countries.
- “Made for iPod,” and “Made for iPhone” mean that an electronic accessory has been designed to connect specifically to iPod, or iPhone, respectively, and has been certified by the developer to meet Apple performance standards. Apple is not responsible for the operation of this device or its compliance with safety and regulatory standards. Please note that the use of this accessory with iPod or iPhone may affect wireless performance.
- iPhone, iPod, iPod classic, iPod nano, and iPod touch are trademarks of Apple Inc., registered in the U.S. and other countries.
- Lightning is a trademark of Apple Inc.
- Pandora, the Pandora logo, and the Pandora trade dress are trademarks or registered trademarks of Pandora Media, Inc., used with permission.
- iHeartRadio® and iHeartAuto™ are trademarks owned by iHeartMedia, Inc. All uses are authorized under license.
- SPOTIFY and the Spotify logo are among the registered trademarks of Spotify AB.
- Sirius, XM and all related marks and logos are trademarks of Sirius XM Radio Inc. All rights reserved.
- The “AAC” logo is a trademark of Dolby Laboratories.
- Android is trademark of Google Inc.
- The Bluetooth® word mark and logos are registered trademarks owned by Bluetooth SIG, Inc. and any use of such marks by JVC KENWOOD Corporation is under license. Other trademarks and trade names are those of their respective owners.
- Qualcomm aptX is a product of Qualcomm Technologies International, Ltd. Qualcomm is a trademark of Qualcomm Incorporated, registered in the United States and other countries, used with permission. aptX is a trademark of Qualcomm Technologies International, Ltd., registered in the United States and other countries, used with permission.

MILITARY

Units purchased through the U.S.A. military exchange service overseas may be serviced under warranty in the continental U.S.A., subject to the following conditions.

- 1) The original warranty is in effect.
- 2) Proof of purchase is provided to the servicer.

WARRANTY FOR MILITARY MARKET

Kenwood corporation is proud of the quality and workmanship of its audio equipment. This unit has been properly designed, tested and inspected before it was shipped to you. If properly installed and operated in accordance with instructions furnished, it should give you an optimum reliable performance.

WARRANTY PERIOD

This product is warranted for a period of (1) year from the date of the original purchase.

SCOPE OF WARRANTY

Except as specified below, this warranty covers all defects in materials and workmanship of the Kenwood brand products.

During the warranty period, any authorized Kenwood Service Center in the military market listed in the back of this warranty card will provide you free-of-charge both parts and labor required to correct any defect in materials or workmanship.

The following are not covered by this warranty.

1. Voltage conversions.
2. Periodic check-ups which do not disclose any defect covered by the warranty.
3. Cabinets, grilles, other exterior finishes, belts, tape heads, and other non-durable parts and accessories.
4. Units on which the serial number has been effaced, modified or removed.
5. Installation and/or removal charges.
6. Damaged magnetic tapes.
7. House call charges for any repairs.
8. Shipping or delivery charges to or from an authorized Kenwood Service Center.
9. This warranty will not cover any failure that is due to any of the following conditions in accordance with the visual inspection of the authorized Kenwood Service Center:

* Improper maintenance or repair, including the installation of parts or accessories that do not conform to the quality and specifications of the original parts.

* Misuse, abuse, neglect, unauthorized product modification or failure to follow instructions contained in the Owner's Manual.

* Accidental or intentional damages.

* Repairs or attempted repairs by an unauthorized agency. (All repairs must be performed at an authorized Kenwood Service Center.)

* Damages or deteriorations caused during shipment (Claims must be presented to the carrier).

* Damages or deteriorations resulting from removal and/or replacement.

PURCHASER'S RESPONSIBILITIES

As the purchaser of a new Kenwood brand product, you are requested to do the following in order to obtain Kenwood warranty service.

1. Retain your sales slip or other evidence of purchase for proving your eligibility for requesting Kenwood warranty service.
2. Make your unit available to an authorized Kenwood Service Center in the military market for inspection and approved warranty service, or ship your unit in its original carton box or equivalent, fully insured and shipping charges prepaid, to the authorized Kenwood Service Center.

LIMITATION OF IMPLIED WARRANTIES

Any and all implied warranties, including warranties of merchantability and fitness for a particular purpose, shall be limited in duration to the length of this warranty.

EXCLUSION OF CERTAIN DAMAGES

KENWOOD's liability for any defective product is limited to the repair or replacement of said product, at our option, and shall not include damages of any kind, whether incidental, consequential or otherwise, except to the extent prohibited by applicable law.

KENWOOD AUTHORIZED SERVICE CENTERS IN MILITARY MARKET

JAPAN:

Yokota

Kenwood Rep.,; c/o
Yokota BX, JAAX AAFES-PAC,
APO San Francisco 96328

Zama

Kenwood Rep.,; c/o
Zama PX, JAAX AAFES-PAC,
APO San Francisco 96343

Misawa

Kenwood Rep.,; c/o
Misawa BX, JAAX AAFES-PAC,
APO San Francisco 96519

Yokosuka

Kenwood Rep.,; c/o
A-33, Yokosuka NEX No. 260-010
FPO Seattle 98760

Atsugi

Kenwood Rep.,; c/o
Atsugi NEX No. 260-020 FPO Seattle
98767

Iwakuni

Kenwood Rep.,; c/o
Marine Corps Exchange, Marine Corps
Air Station,
FPO Seattle 98764

Sasebo

Sasebo NEX;
Navy Exchange 260-040
F.A. Box 115 FPO Seattle 98766

Okinawa

Kenwood Rep.,; c/o
OWAX, AAFES-PAC, APO San Francisco
96230

KOREA:

Kenwood Rep.,; c/o
KOAX Repair Shop, AAFES-PAC
DD-Camp Market, APO San Francisco
96488

GUAM:

Kenwood Rep.,; c/o
Guam NEX No. 230-010,
FPO San Francisco 96630
Kenwood Rep.,; c/o
GUAX, AAFES-PAC, APO San Francisco
96334

U.S.A.:

In The Continental U.S.A.
For Nearest Authorized Service Center;
Tel: 1-800-536-9663
www.us.jvckenwood.com

EUROPE:

Please inquire at the military resale outlets where you bought your Kenwood products, or
JVCKENWOOD DEUTSCHLAND GMBH:
Konrad-Adenauer Allee 1-11, 61118 Bad
Vilbel, Germany

KENWOOD

Warranty Card

Identification du produit
Modelo do aparelho e numero de série
Model number & serial number

Revendeur & cachet
Nome da loja e carimbo
Dealer & stamp

Date d'achat
Data da compra
Purchase date

Nom & adresse du client
Nome e endereço do cliente
Name & address of customer

Attention:

This card and receipt (or invoice) are necessary to purchase a new panel in case of theft or damage.

Attention:

Vous aurez besoin de cette carte et du reçu (ou de la facture) pour acheter un nouveau panneau en cas de vol ou d'endommagement.

Atenção:

Em caso de dano ou perda do painel frontal, este Certificado de Garantia e a Nota Fiscal de compra serão requisitados para a aquisição de um novo painel.

© B46-0824-00/03 (K) (15/03)

Dear Customer,

Thank you for purchasing this Kenwood product. As mentioned in the pages of this booklet, our warranty is only valid in the countries listed. If your country is not listed please contact your retailer for information on warranty procedure, or write to:

JVC KENWOOD Customer Information Center

3-12, Moriyacho, Kanagawa-ku, Yokohama-shi, Kanagawa 221-0022, Japan

U.S.A.	JVCKENWOOD USA Corporation
This warranty will be honored only in the U.S.A.	
<p>KENWOOD LIMITED WARRANTY FOR CAR STEREO COMPONENTS</p>	<p>WHO IS PROTECTED This warranty is enforceable only by the original purchaser.</p>
<p>HOW LONG IS THE WARRANTY Kenwood U.S.A. Corporation ("Kenwood") warrants this product for a period of one (1) year from the date of original purchase.</p>	<p>EXCLUSION OF DAMAGES KENWOOD'S LIABILITY FOR ANY DEFECTIVE PRODUCT IS LIMITED TO THE REPAIR OR REPLACEMENT OF THE PRODUCT AT OUR OPTION. KENWOOD SHALL NOT BE LIABLE FOR: 1. INSTALLATION OR REMOVAL CHARGES, DAMAGE TO OTHER PROPERTY CAUSED BY ANY DEFECTS IN KENWOOD CAR STEREO COMPONENTS, DAMAGES BASED UPON INCONVENIENCE, LOSS OF USE OF THE PRODUCT; OR 2. ANY OTHER DAMAGES, WHETHER INCIDENTAL, CONSEQUENTIAL OR OTHERWISE. SOME STATES DO NOT ALLOW LIMITATIONS ON HOW LONG AN IMPLIED WARRANTY LASTS AND/OR DO NOT ALLOW THE EXCLUSION OR LIMITATION OF INCIDENTAL OR CONSEQUENTIAL DAMAGES. SO THE ABOVE LIMITATIONS AND EXCLUSIONS MAY NOT APPLY TO YOU.</p>
<p>WHAT IS COVERED AND WHAT IS NOT COVERED Except as specified below, this warranty covers all defects in material and workmanship in Kenwood car stereo components. The following are not covered by the warranty: 1. Any product which is not distributed in the U.S.A. by Kenwood or which is not purchased in the U.S.A. from an authorized Kenwood car stereo dealer or an automobile dealer, unless the product is purchased through the U.S.A. Military Exchange Service. 2. Any product on which the serial number has been defaced, modified or removed. 3. Damage, deterioration or malfunction resulting from: a. Any shipment of the product (claims must be presented to the carrier). b. Installation or removal of the product. c. Accident, acts of nature, misuse, abuse, neglect, unauthorized product modification or failure to follow instructions supplied with the product. d. Repair or attempted repair by anyone not authorized by Kenwood. e. Any other cause which does not relate to a product defect.</p>	<p>WHAT WE WILL PAY FOR We will pay for all labor and material expenses for covered items. Payment of shipping charges is discussed in the next section of this warranty.</p>
	<p>HOW TO OBTAIN WARRANTY SERVICE If your KENWOOD product ever needs service: 1. Take or ship it to any KENWOOD Authorized Service Center in the U.S.A. along with & complete description of the problem. (If you are uncertain as to whether a Service Center is authorized, please call 1-800-KENWOOD for the nearest Service Center. 1-800-536-9663). 2. Although you must pay any shipping charges if it is necessary to ship the product for warranty service, we will pay the return shipping charges if the repairs are covered by the warranty within the United States. 3. Whenever your units are taken or sent for warranty service, you must include a copy of the original dated sales receipt as proof of warranty coverage.</p>
	<p>LIMITATION OF IMPLIED WARRANTIES ALL IMPLIED WARRANTIES, INCLUDING WARRANTIES OF MERCHANTABILITY AND FITNESS FOR A PARTICULAR PURPOSE, ARE LIMITED IN DURATION TO THE LENGTH OF THIS WARRANTY.</p> <p>JVCKENWOOD USA Corporation PO Box 22745, 2201 E. Dominguez St. Long Beach, CA 90810-5745 Tel.: (800) 536-9663 www.us.jvckenwood.com</p> <p>This warranty gives you specific legal rights, and you may also have other rights which vary from state to state.</p> <p>If a problem develops during or after the Limited Warranty Period, or if you have any questions regarding the operation of the product, you should contact your KENWOOD Authorized Dealer or Authorized Service Center. If the problem or your question is not handled to your satisfaction, please contact our Customer Relations Department at the address listed below:</p>

BRASIL	JVC KENWOOD DO BRASIL COMÉRCIO DE ELETRÔNICOS LTDA
<p>O fabricante garante o produto identificado na Nota Fiscal de venda ao consumidor contra qualquer defeito de fabricação ou de matéria-prima durante o período de garantia. Esta garantia é válida no território brasileiro desde que o produto tenha sido adquirido no Brasil e distribuído pela JVC KENWOOD do Brasil Comércio de Eletrônicos Ltda.</p>	<p>CONCERTO EM GARANTIA É indispensável a apresentação deste Certificado de Garantia devidamente preenchido, acompanhado da respectiva Nota Fiscal de compra do produto, desde que não apresente rasuras ou modificações. O consumidor somente terá direito a estes benefícios, quando o produto for entregue diretamente no balcão de um Serviço Autorizado da JVC KENWOOD.</p>
<p>PERÍODO DE GARANTIA Este produto é garantido pelo prazo de 01 (um) ano, incluindo o período estabelecido por lei, a partir da data de aquisição, comprovada mediante a apresentação da respectiva Nota Fiscal de venda ao consumidor final. Eventuais reparos realizados no produto durante o período de garantia não implicam na dilatação do seu prazo.</p>	<p>O QUE NÃO É COBERTO PELA GARANTIA Instalação e remoção do produto, despesas de frete, seguro e embalagem são de responsabilidade do proprietário.</p>
<p>EXCLUSÃO DA GARANTIA (a) Produtos com o número de série ou certificado de garantia rasurados, adulterados ou ilegíveis; (b) Defeitos resultantes de acidentes (quedas, batidas e etc.) uso em desacordo com o manual de instruções, má utilização, ligação à fonte de tensão diferente da especificada no Manual de Instruções, modificações não autorizadas; (c) Danos causados por agentes da natureza (Ex: chuvas, raios, marés, enchentes e etc.); (d) Defeitos ou danos em decorrência de concertos realizados por pessoas não autorizadas; (e) Defeitos ou danos resultantes do uso de peças ou dispositivos não conformes às especificações da JVC KENWOOD;</p>	<p>IMPORTANTE: Para qualquer informação sobre seu equipamento JVC KENWOOD, ou para obter o endereço do Serviço Autorizado mais próximo, acesse o site www.kenwood.com.br, ou ligue para a Central de Atendimento JVC KENWOOD – Tel.: +55 (11) 3777-6771 com os dados abaixo preenchidos.</p>
<p>(f) Danos ou deteriorações aos acabamentos externos, partes cosméticas, cabos, chicotes, parafusos de fixação, luvas, alças, bolsos, estojos, adaptadores, antenas, fitas, cabeças gravadoras, CDs ou danos causados por pilhas defeituosas ou com vazamento; (g) Defeitos ou danos devido ao transporte (reclamações devem ser feitas junto à empresa transportadora); (h) Qualquer outra causa que não esteja relacionada a defeitos de matéria-prima e de fabricação; (i) Danos causados por tentativa de roubo ou furto; (j) Danos causados por uso de CDs de má qualidade; (k) Danos decorrentes do desgaste natural do produto; (l) Danos causados por mau uso (derramamento de líquidos e/ou alimentos, corrosão, oxidação, exposição à umidade ou situações climáticas extremas, riscos ou quedas).</p>	<p>JVC KENWOOD DO BRASIL COMÉRCIO DE ELETRÔNICOS LTDA Tel.: (11) 3777-6771 www.kenwood.com.br</p> <p>Nome do consumidor: _____</p> <p>Endereço: _____ CEP: _____</p> <p>Cidade: _____ Estado: _____</p> <p>Telefone: _____</p> <p>Data da compra: ____/____/____ Nota Fiscal: _____</p>

CANADA	JVCKENWOOD CANADA INC.
<p>KENWOOD WARRANTY KENWOOD ELECTRONICS CANADA INC. (hereinafter called "KENWOOD"), gives the following written warranty to the original customer of each new Kenwood product distributed in Canada by KENWOOD and purchased from a dealer authorized by KENWOOD.</p>	<p>ENTIRE WARRANTY This warranty constitutes the entire written warranty given by KENWOOD. No person, party, dealer or service centre or their agents or employees are authorized to extend or enlarge this warranty on behalf of KENWOOD by any written or verbal statement or advertisement or promotion, including any extended warranty program or plan that may be offered by the dealer or service centre, unless approved in writing by KENWOOD.</p>
<p>KENWOOD warrants that each new Kenwood product, under normal use, is free from any defects, subject to the terms and conditions set forth below. If a defect should occur within the warranty period, repairs will be made free of charge for parts and labour when such defects are determined by KENWOOD or its* authorized service centres to be attributable to faulty materials or workmanship at time of manufacture. Please contact KENWOOD to confirm if a dealer or service centre is authorized by KENWOOD.</p>	<p>(e) Defects resulting from disaster, accident, abuse, misuse, lightning, power surges, neglect or lack of periodic maintenance, unauthorized modification or failure to follow instructions in the owner's manual. (f) Defects or damage as a result of repairs performed by a person or party not authorized by KENWOOD. (g) Defects resulting from the use of parts or devices that do not conform to KENWOOD specifications. (h) Damage or deterioration occurring to any exterior finishes, cosmetic parts, tape heads, adaptors, antennas, cables, tapes, discs or faults or damage caused by defective or leaking batteries. (i) Defects or damage occurring during shipping (claims should be presented to the shipping company). (j) Product voltage and /or line frequency conversions. (k) Product installation or removal charges.</p>
<p>WARRANTY PERIOD This Kenwood product is warranted for parts and labour for a period of one (1) year from the date of original purchase, lease or rental, except for products which are used in a professional or commercial application, which are warranted for a period of ninety (90) days for parts and labour and are subject to the terms and conditions of the warranty.</p>	<p>TO OBTAIN WARRANTY SERVICE Should your Kenwood product require warranty service, deliver it to any authorized KENWOOD service centre and present the original copy of your bill of sale and this warranty card as proof of warranty, or send your product fully insured and freight prepaid to the nearest authorized KENWOOD service centre. To avoid possible shipping damage, make sure the product is properly packed. Include a copy of your original bill of sale and this warranty card as proof of warranty along with your name, home and /or work telephone number(s), a complete return address and a detailed description of the fault(s). Products repaired within warranty will be returned freight prepaid to destinations within Canada. The customer is responsible for all freight and related costs for the return of product(s) to destinations outside Canada.</p>
<p>WARRANTY EXCLUSIONS This warranty excludes: (a) Products purchased in a foreign country or purchased in Canada and taken to a foreign country. (b) Products purchased from a dealer not authorized by KENWOOD. (c) Products with the serial number defaced, altered or missing. (d) Periodic check-ups which do not disclose any defects covered by this warranty.</p>	<p>DISCLAIMER KENWOOD disclaims any responsibility for loss of time or use of the product or any other indirect, incidental or consequential damage to other products or goods, inconvenience or commercial loss.</p> <p>NOTICE TO CONSUMER The provisions contained in this written warranty are not intended to limit, modify, take away, disclaim or exclude any warranties or rights you may have which are set forth in any applicable provincial or federal laws or legislation.</p> <p>IMPORTANT This warranty card by itself is not considered by KENWOOD as a valid proof of purchase. When applying for warranty repairs, you must present the original copy of your bill of sale and this warranty card as proof of warranty, so we recommend that they be kept in a safe place, should they be required in the future.</p> <p>JVCKENWOOD CANADA INC. 6070 Kestrel Road, Mississauga, Ontario, Canada L5T 1S8 Tel.: (905) 670-7211 Fax: (905) 670-7248</p>

CANADA	JVCKENWOOD CANADA INC.
<p>GARANTIE KENWOOD KENWOOD ELECTRONICS CANADA INC. (ci-après appelée "KENWOOD"), donne par écrit la garantie suivante à l'acheteur original de chaque nouveau produit Kenwood distribué au Canada par KENWOOD et acheté à un concessionnaire autorisé par KENWOOD.</p>	<p>L'ENTIERE GARANTIE Cette garantie représente l'entière garantie donnée par écrit par KENWOOD. KENWOOD ne se tient aucunement responsable de toutes extensions ni de toutes augmentations de cette garantie faites ou entreprises par toutes personnes, parties, concessionnaires ou centres de service ou par leurs agents ou employés au nom de KENWOOD au moyen d'affirmations verbales ou écrites, d'annonces ou de promotions, y inclus tous programmes ou plans de garantie étendue que puissent offrir les concessionnaires ou les centres de service, à moins que KENWOOD n'y ait consenti par écrit d'avance.</p>
<p>KENWOOD garantit, sous réserve des termes et des conditions énoncés ci-dessous, que chaque nouveau produit Kenwood, dans des conditions d'emploi normales, est exempt de tous défauts. Si l'un d'eux se produit pendant la période de garantie, KENWOOD s'engage à assumer le coût des pièces défectueuses et de la main-d'œuvre nécessaires pour effectuer les réparations pourvu que de tels défauts sont attribuables à des pièces défectueuses employées lors de la fabrication du produit Kenwood ou à la main-d'œuvre tel qu'établi par KENWOOD ou par l'un de ses centres de service autorisés. Appelez KENWOOD pour vérifier si un concessionnaire ou un centre de service est autorisé par KENWOOD.</p>	<p>(e) les défauts causés par les désastres, les accidents, les abus, les emplois incorrects, les éclairs, les surtensions de courant, les manques de soins ou d'entretiens périodiques, les modifications non autorisées ou les manques de respect du mode d'emploi; (f) les défauts ou les dommages causés lors de réparations effectuées par une personne ou par une partie non autorisée par KENWOOD; (g) les défauts causés par l'emploi de pièces ou de dispositifs qui ne se conforment pas aux exigences de KENWOOD; (h) les finitions extérieures, les pièces cosmétiques, les têtes de bandes, les adaptateurs, les antennes, les câbles, les bandes, les disques endommagés ou déperis, ni les défauts ou dommages causés par des piles défectueuses ou qui fuient; (i) les défauts ou dommages qui se produisent pendant l'expédition des produits Kenwood (On devrait déposer de telles réclamations auprès des compagnies de transport); (j) les conversions de tension et/ou de fréquence du produit; (k) les frais d'installation ou d'enlèvement du produit.</p>
<p>PÉRIODE DE GARANTIE Les pièces et la main-d'œuvre nécessaires pour la réparation des produits Kenwood sont garanties pendant la période d'un (1) an à compter de la date d'achat, de bail ou de location originale, sauf dans les cas où les produits Kenwood sont employés dans un but professionnel ou commercial, où la garantie des pièces et de la main-d'œuvre demeure en vigueur pendant une période de quatre-vingt-dix (90) jours sous réserve des termes et des conditions de la garantie.</p>	<p>RENONCIATION KENWOOD renonce à toutes responsabilités de perte de temps, d'emploi du produit, de tous dommages indirects ou accessoires causés à d'autres produits ou biens, de tous inconvénients ou de toutes pertes commerciales.</p> <p>AVIS AUX CONSOMMATEURS Les stipulations contenues dans la présente garantie écrite n'ont pas pour but de limiter, de modifier, de diminuer, de rejeter ni d'exclure d'autres garanties ni droits énoncés dans n'importe quelles lois ou législations provinciales ou fédérales.</p>
<p>EXCLUSIONS DE GARANTIE Cette garantie ne couvre pas: (a) les produits achetés à l'étranger ou achetés au Canada et transportés à l'étranger; (b) les produits achetés à un concessionnaire non autorisé par KENWOOD; (c) les produits dont le numéro de série manque, a été effacé ou modifié; (d) les services d'entretien périodiques qui n'indiquent aucun défaut couvert par cette garantie.</p>	<p>COMMENT OBTENIR DU SERVICE SOUS GARANTIE Au cas où un service sous garantie de votre produit Kenwood s'avère nécessaire, veuillez livrer le produit à n'importe quel centre de service KENWOOD et présenter la copie originale du contrat de vente et cette carte de garantie en tant que preuve de garantie ou veuillez faire parvenir votre produit assuré et port payé au centre de service KENWOOD autorisé le plus proche. Pour éviter toutes possibilités de dommages pendant le transport, veuillez bien emballer le produit. Veuillez inclure une copie du contrat de vente original et cette carte de garantie en tant que preuve de garantie aussi bien que votre nom, numéros de téléphone au poste de travail et/ou au domicile, votre adresse et une description détaillée des défauts. Les produits sous garantie réparés seront retournés port payé aux destinations à l'intérieur du Canada. Le consommateur sera responsable de tous frais de transport et d'autres frais qui s'y rapportent pour faire expédier les produits à destinations à l'extérieur du Canada.</p> <p>IMPORTANT KENWOOD ne considère pas cette garantie toute seule comme étant une preuve d'achat valide. Lorsqu'on demande du service sous garantie, il faudra présenter la copie originale du contrat de vente aussi bien que cette carte de garantie en tant que preuve de garantie. On recommande de les conserver dans un lieu sûr au cas où elles s'avèreraient nécessaires à l'avenir.</p> <p>JVCKENWOOD CANADA INC. 6070 Kestrel Road, Mississauga, Ontario, Canada L5T 1S8 Téléphone: (905) 670-7211 Télécopieur: (905) 670-7248</p>