



INSTALLATION GUIDE

STREAMLINE STORAGE

ENGLISH (U.S.)

COPYRIGHT © 2020 GYM RAX INTERNATIONAL, INC. All rights reserved.

Revision 21A



FOREWORD

FOREWORD

This guide provides information intended for use by persons and professionals to install this equipment.

If further information is required, please contact:

GYM RAX International, Inc.
Attn: Customer Success
1730 Berkeley St.
Santa Monica, CA 90404
Phone (888)-895-0547
Fax (310)-559-9953
info@gymrax.com
www.gymrax.com

We welcome your comments concerning this manual. Although every effort has been made to keep it free of errors, some may occur. When reporting a specific problem, please describe it briefly and include the manual part number, the paragraph/figure/table number, and the page number. Send your comments to:

GYM RAX International, Inc.
Attn: Customer Success
1730 Berkeley St.
Santa Monica, CA 90404
Phone (888)-895-0547
Fax (310)-559-9953
info@gymrax.com
www.gymrax.com



DOCUMENT REVISION HISTORY

DOCUMENT REVISION HISTORY

REV	DATE	DETAIL
21A	12/14/2020	STREAMLINE R2 INSTALLATION INSTRUCTIONS RELEASED

The information and data in the most recent revision of this document will supersede all previously published Gym Rax documents and manuals. Please verify your copy is the latest available by referring to the digital version online available from Gym Rax.



CONTENTS

CONTENTS

FOREWORD 1

DOCUMENT REVISION HISTORY 2

CONTENTS 3

PLANNING ASSEMBLY 4

 ESTIMATED ASSEMBLY TIME 5

 REQUIRED TOOLS AND SUPPLIES 5

 REQUIREMENTS 5

PARTS DIAGRAM – STREAMLINE KITS 6

INSTALL PROCEDURE..... 7

 STEP 1A – POST/ANCHOR PLATE ASSEMBLY 7

 STEP 1B – ASSEMBLE REMAINING POSTS 8

 STEP 2A –CROSSMEMBER ATTACHMENT..... 9

 STEP 2B –CROSSMEMBER ATTACHMENT ADD-ON BAYS 10

 STEP 2C – FINAL PLACEMENT AND CHECKS..... 12

 STEP 3A – ADD STORAGE ATTACHMENTS - RAX..... 13

 STEP 3B – ADD STORAGE ATTACHMENTS - PEGS 14

CUSTOMER SUCCESS CONTACT 15



PLANNING ASSEMBLY

PLANNING ASSEMBLY

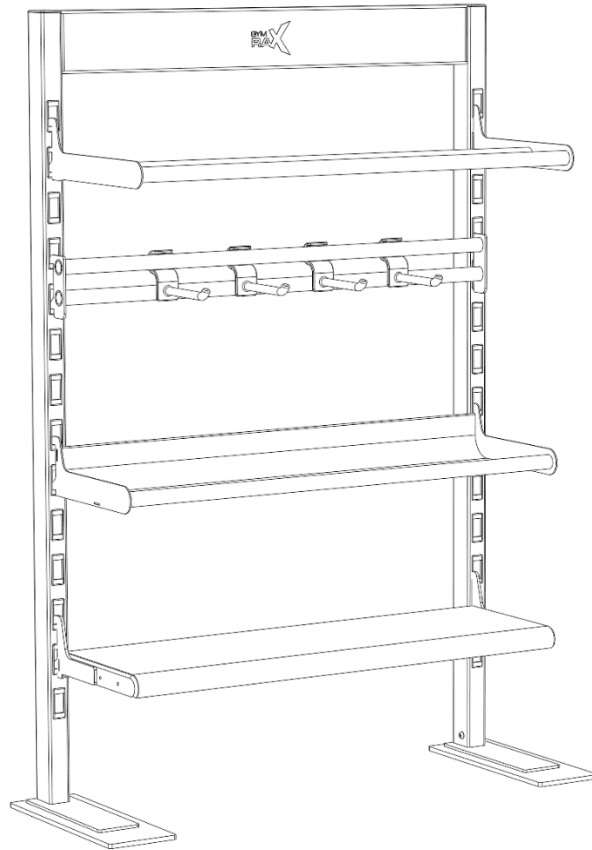

PLANNING AHEAD

- Following the GYM RAX® Storage systems installation sequence is critical to the performance of the structures and safety of the users.
- Read all instructions before proceeding.
- Review all supplied drawings & packing lists before starting any work.
- Identify any installation uncertainties and contact a GYM RAX customer success representative for clarification.
- Consider the number of persons required to safely install GYM RAX.
- Plan for the method of installation and tools required.
- Take precautions to avoid damaging finishes.
- Do not over-torque fasteners as walls of posts and tubes may crush.
- Never leave unsecured or unstable GYM RAX structures unattended.



PLANNING ASSEMBLY



ESTIMATED ASSEMBLY TIME

15-20 minutes per bay



REQUIRED TOOLS AND SUPPLIES

6mm Allen key

17mm wrench

Tape measure



REQUIREMENTS

Flooring surface for Streamline Storage should be flat, level, and reasonably firm. Carpet with a high pile or cushion may not be suitable. Rubber gym floorings are ok.

Place Streamline Storage against a wall

Torque fasteners to 20-25 ft-lb

Do not the exceed maximum overall storage capacity of 550 lb per Streamline bay

Do not the exceed maximum capacity of Rax storage components. The Free Weight, Trough, and Universal Bar maximum capacity on Streamline Storage is 300 lb each. The Universal Rax is 200 lb.

Do not use a Streamline Storage structure as an anchor for training with bands, straps, ropes, etc.



STREAMLINE STORAGE KIT CONTENTS

PARTS DIAGRAM – STREAMLINE KITS

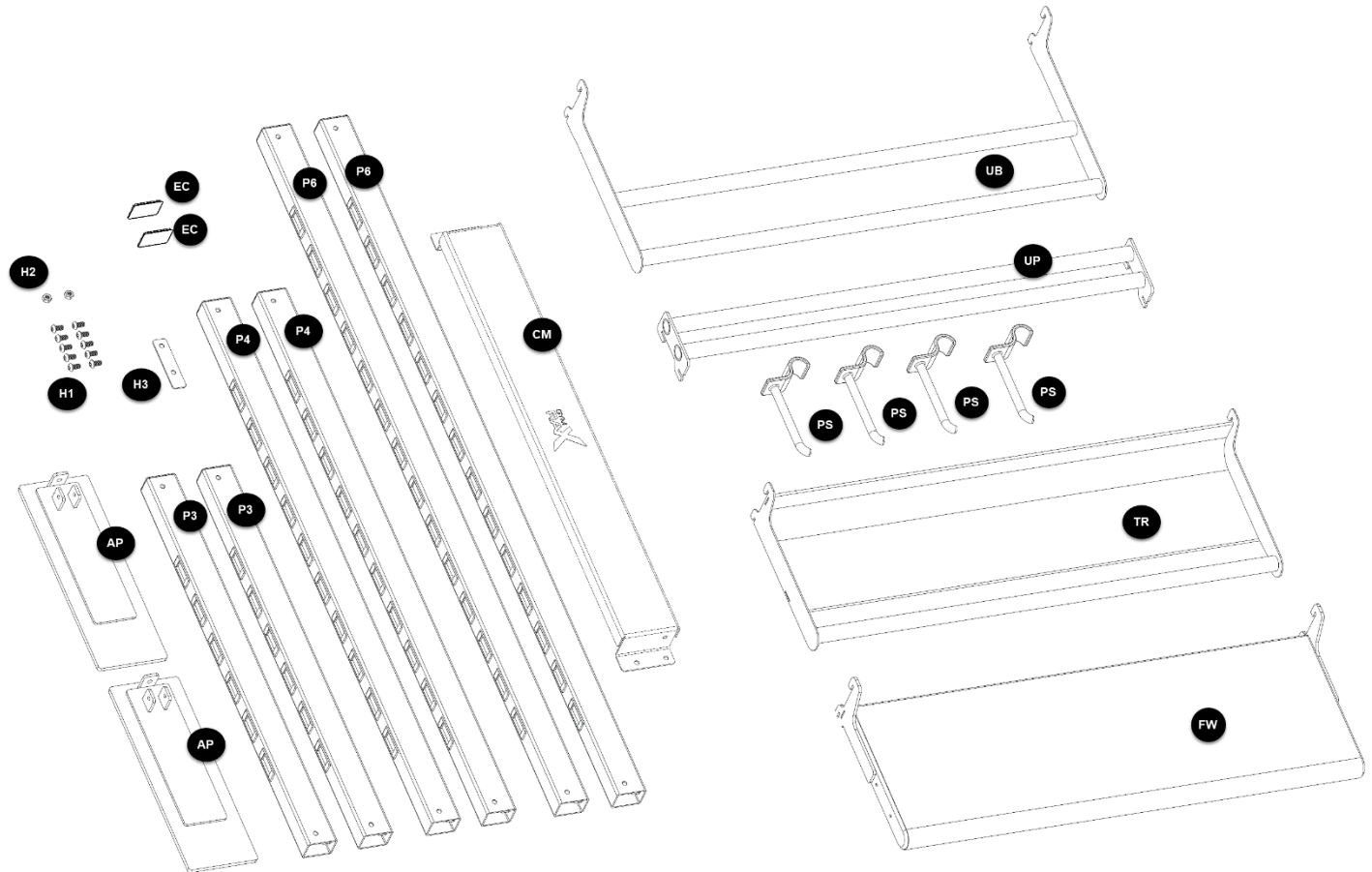

STRUCTURE

HARDWARE

STORAGE

AP	ANCHOR PLATE	H1	M10x20 HEX HEAD SCREWS	UB	UNIVERSAL RAX(balls)
P3	POST 3 FT	H2	M10 HEX NUTS	UP	UNIVERSAL BAR(pegs)
P4	POST 4 FT	H3	CROSSMEMBER SPACER	PS	UNIVERSAL PEG(short)
P6	POST 6 FT			TR	TROUGH RAX
CM	CROSSMEMBER			FW	FREE WEIGHT RAX
EC	END CAP				

*All Streamline Storage-related parts shown, not all kits include all parts shown.



POST ASSEMBLY

INSTALL PROCEDURE

STEP 1A – POST/ANCHOR PLATE ASSEMBLY

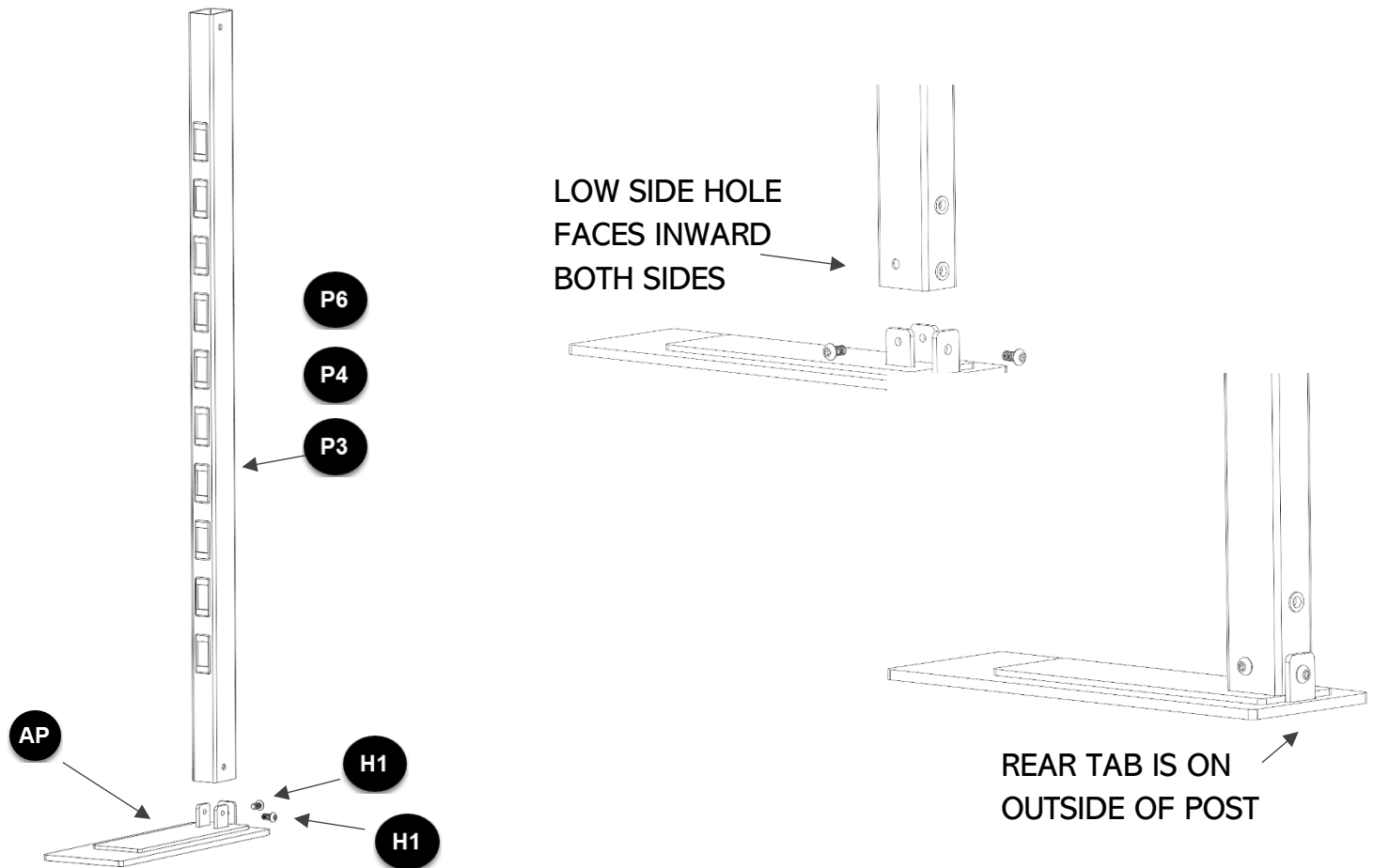

- A)** Set the Anchor Plates **AP** on the ground near the position where the storage bay will rest. Set plates apart 44 1/8" on centers. Keep enough space off the wall to fasten the rear screw. It will be possible to slide the storage bay before adding Rax and items.
- B)** Lift a Post **P3 P4 P6** to vertical. Position the Post with Rax slots facing forward and the low side hole facing inward. If the low side hole is facing outward, flip the post end over end and the low side hole will be facing inward.
- C)** Lower the Post over the tabs protruding from the Anchor Plate until the Post is resting on the plate and the holes line up. The rear tab will be on the outside of the Post while the other tabs will be on the inside of the post.
- D)** Using two M10 Hex Head Screws **H1**, lightly tighten a screw through the side hole and then another screw into the rear hole. Fully tighten both screws with a 6mm Allen key.

STEP 1B – ASSEMBLE REMAINING POSTS

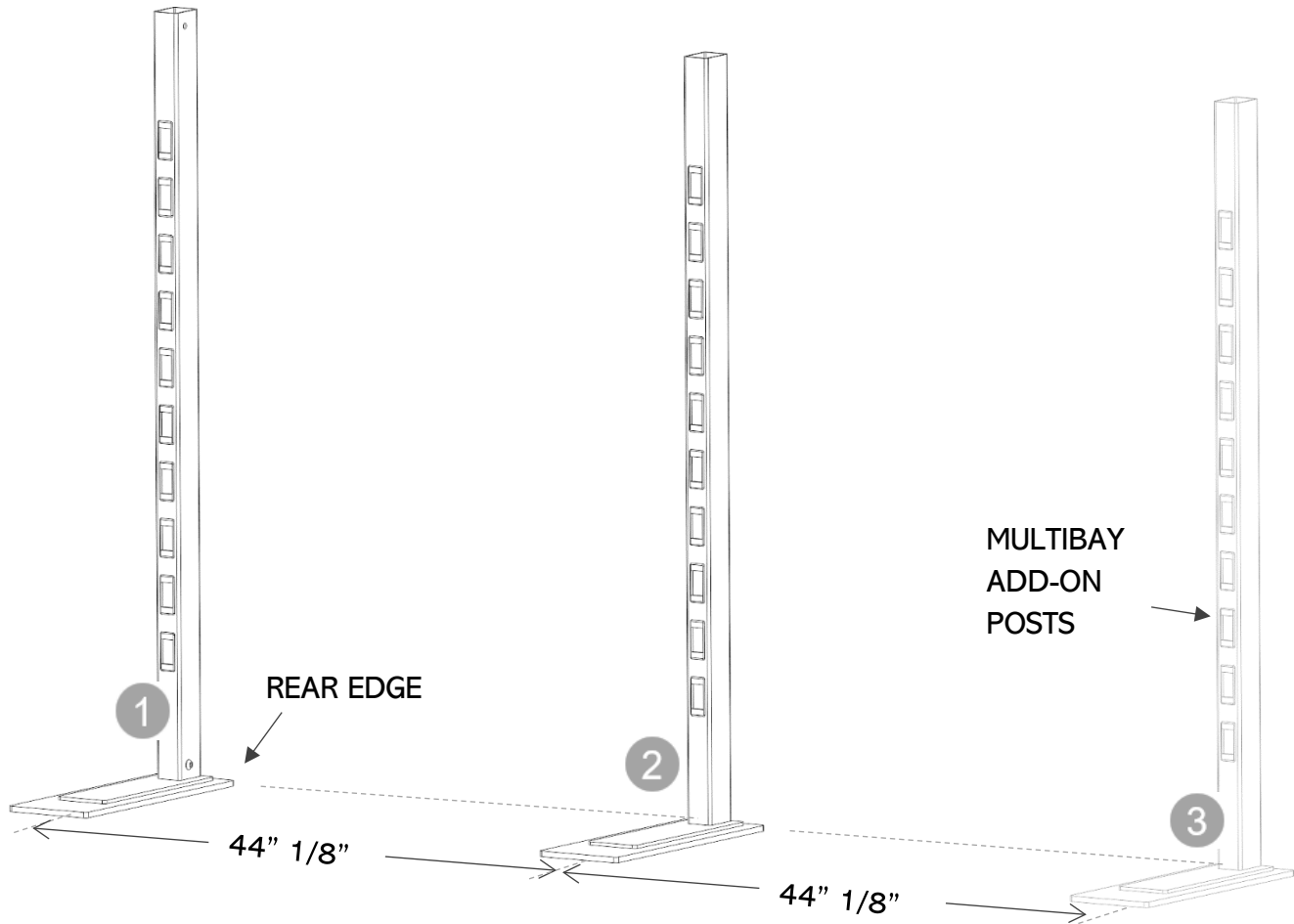

- A)** Assemble remaining Posts to Anchor Plates using the procedure in Step 1A.
- B)** Add-on additional 48" 1/8" apart on centers.
- C)** Line up the rear edge as shown.
- D)** Anchor Plates require a firm, flat and level ground surface. The Posts should be stable and not teeter fore-aft or side to side. Check the ground surface and ensure no debris is under the plate and the ground surface is flat and level.

STEP 2A –CROSSMEMBER ATTACHMENT

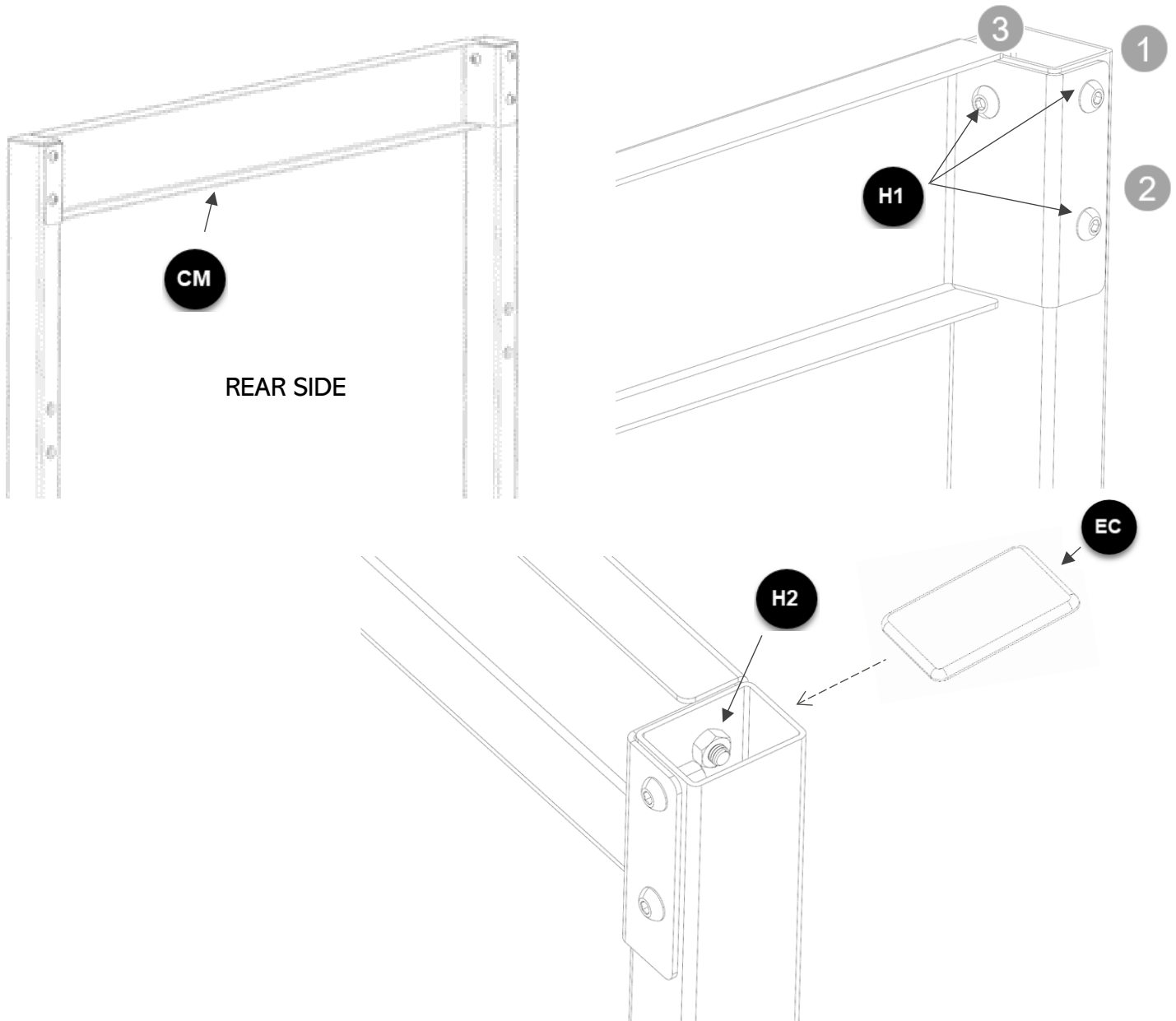

- A)** Connect two Posts with the Crossmember **CM** using 6 M10 screws **H1** and 2 M10 Nuts **H2**.
- B)** Start by placing a screw in position 1 on each post and lightly tighten. Next, add a screw in position 2 on each post and lightly tighten.
- C)** Add a screw in position 3 with a nut on the inside of the post.
NOTE: The screw at position 3 is only used on the base bay and not on add-on bays.
- D)** Fully tighten all screws on Crossmember using a 6 mm Allen key and 17 mm wrench.
- E)** Insert the End Cap **EC** at the top of each post.



CROSSMEMBER ATTACHMENT

STEP 2B –CROSSMEMBER ATTACHMENT ADD-ON BAYS

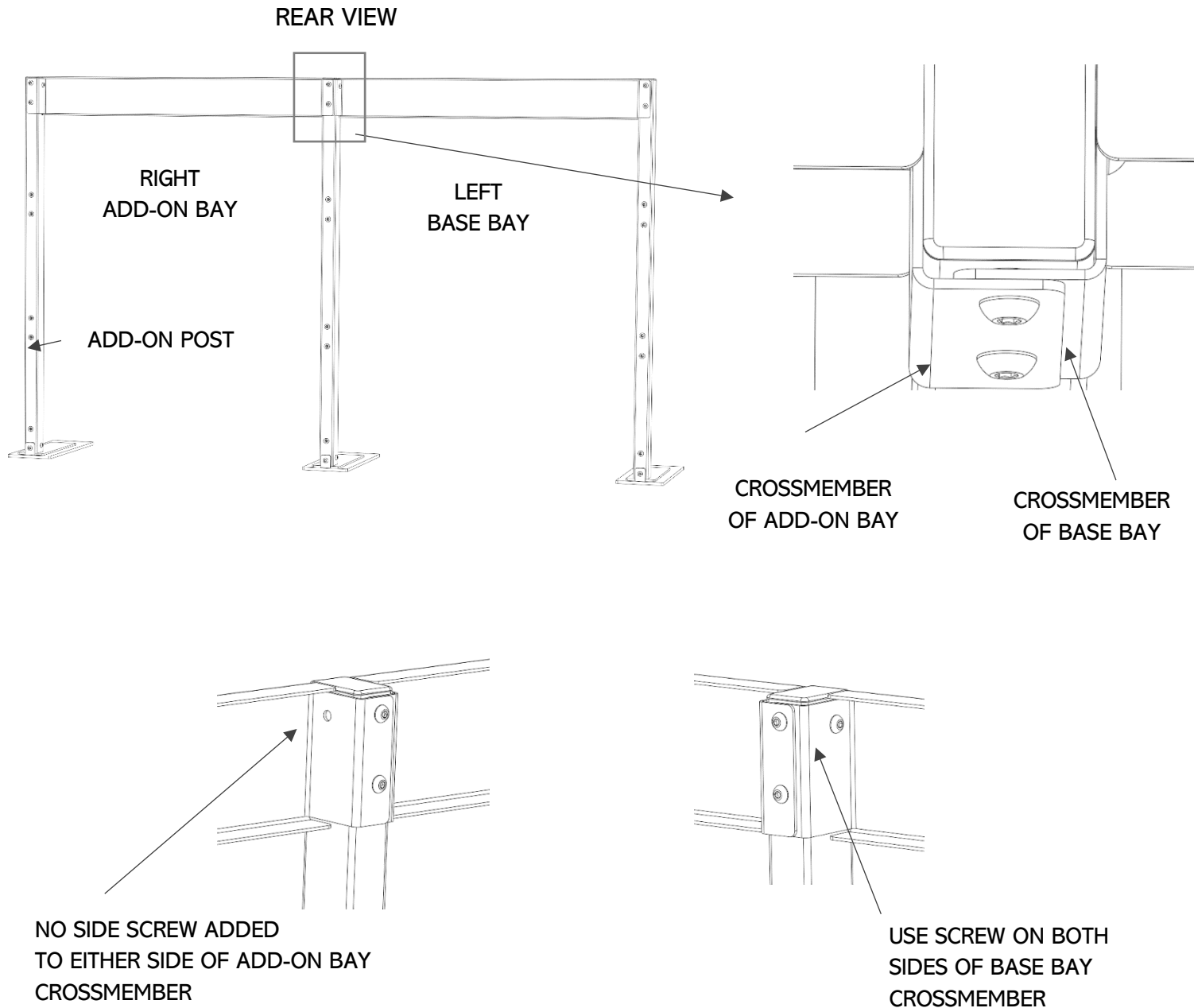

CROSSMEMBER OVERLAP ON SHARED POST

INNER SIDE SCREW NOT ADDON ON CROSSMEMBER OF ADD-ON BAY

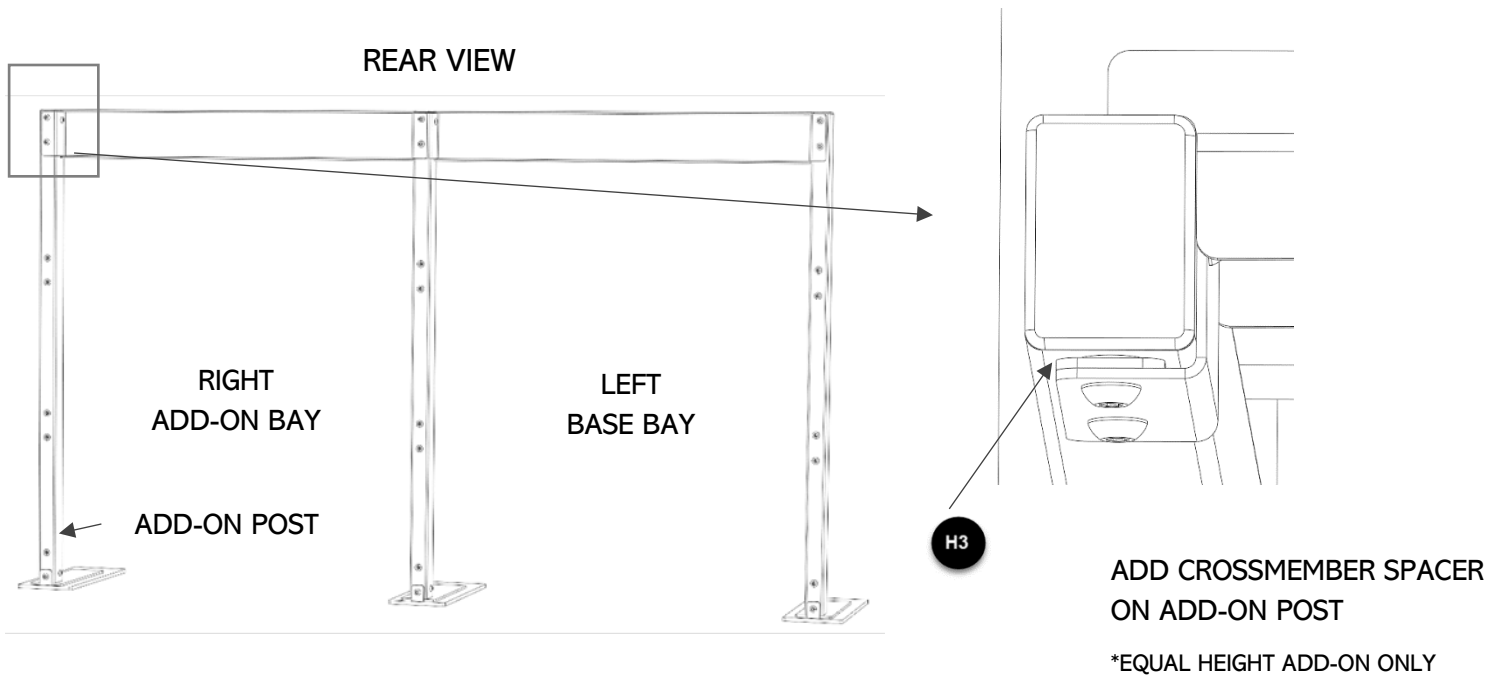

ADD CROSSMEMBER SPACER TO ADD-ON POST OF EQUAL HEIGHT

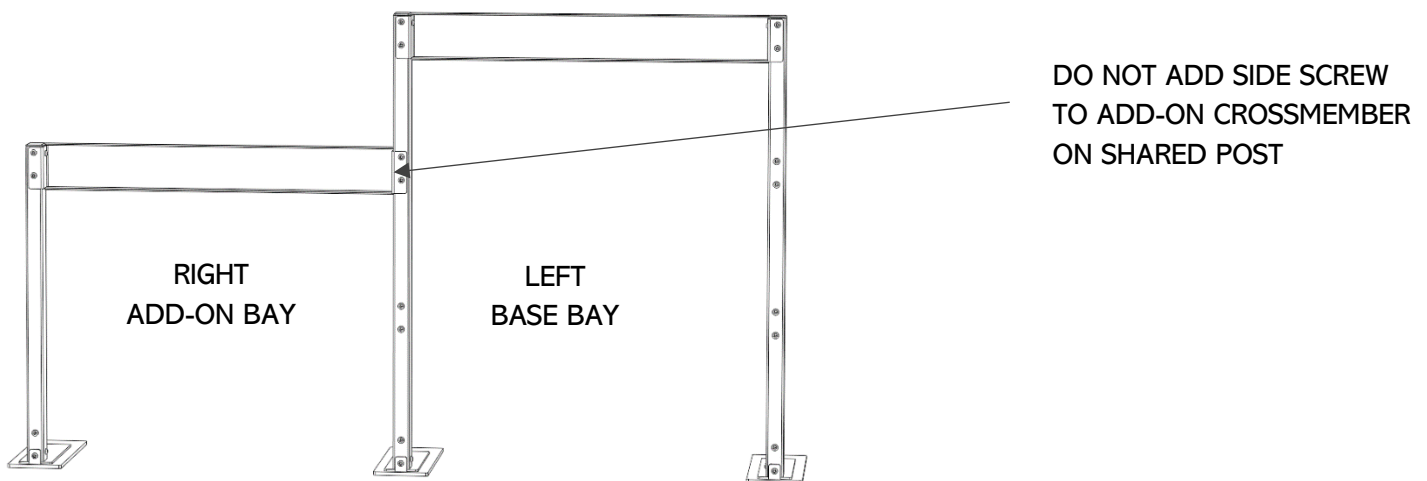

ADD CROSSMEMBER SPACER TO ADD-ON POST OF NON-EQUAL HEIGHT

- A) The Crossmember **CM** of the add-on bay overlaps the Crossmember of the base bay on the rear of the shared Post
- B) The Crossmember Spacer **H3** is required on the attachment of the Crossmember to the add-on post when the add-on bay is of equal height to the base bay.
- C) The Crossmember side screw will not be used on the Crossmember of the add-on bay at the shared Post.



CROSSMEMBER ATTACHMENT

STEP 2C – FINAL PLACEMENT AND CHECKS

- A)** Carefully slide the assembled Post-Crossmember structure into the desired placement. The rear Anchor Plates should be 0.5"-2.0" from the wall. Move each post a small amount at a time.
- B)** Square the structure by adjusting the Anchor Plates so they are parallel and perpendicular to the wall.
- C)** Check to make sure the Anchor Plates are firmly set on the ground and are not teetering. Adjust as necessary.
- D)** The stability of the structure will increase with the addition of Rax Attachment and load on the system.

STEP 3A – ADD STORAGE ATTACHMENTS - RAX

The Rax Free Weight is shown as an example, the same method applies to all Rax Storage.

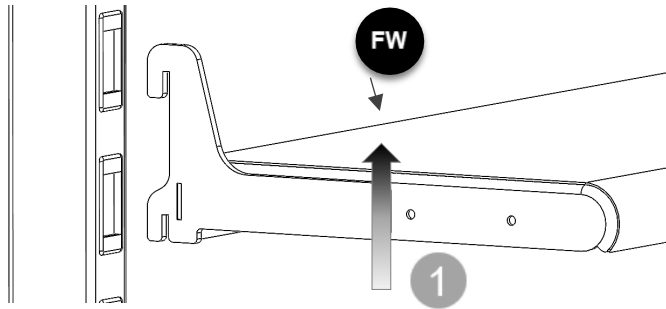

LIFT RAX INTO POSITION

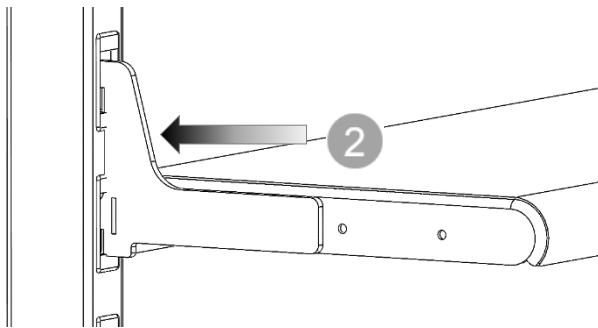

PUSH RAX REWARD ONTO SLOT

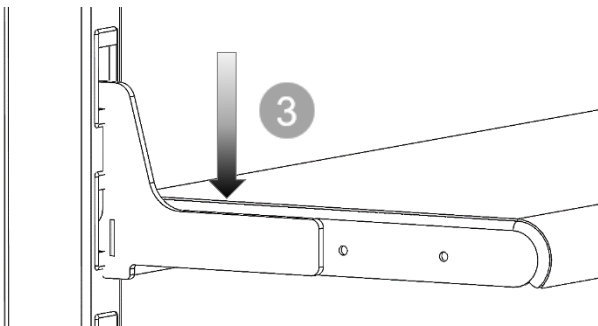

LOWER RAX UNTIL HOOK IS SEATED

A variety of RAX Storage products are available depending on the intended product storage. All RAX Storage employs the same hook design to attach to the RAX Slots.

- A)** Lift the RAX Storage component into position aligning the rear hooks to the RAX Slots.
- B)** Push RAX Storage fully rearward into Rax Slots.
- C)** Lower RAX Storage until the upper and lower hooks seat with the RAX Slot. The RAX Storage is now secure.
- D)** The RAX Storage may be removed and/or repositioned by following these steps in reverse

STEP 3B – ADD STORAGE ATTACHMENTS - PEGS

A variety of PEG Storage products are available depending on the intended product storage. All PEG Storage employs the same hook design to attach to the RAX Universal Bar.

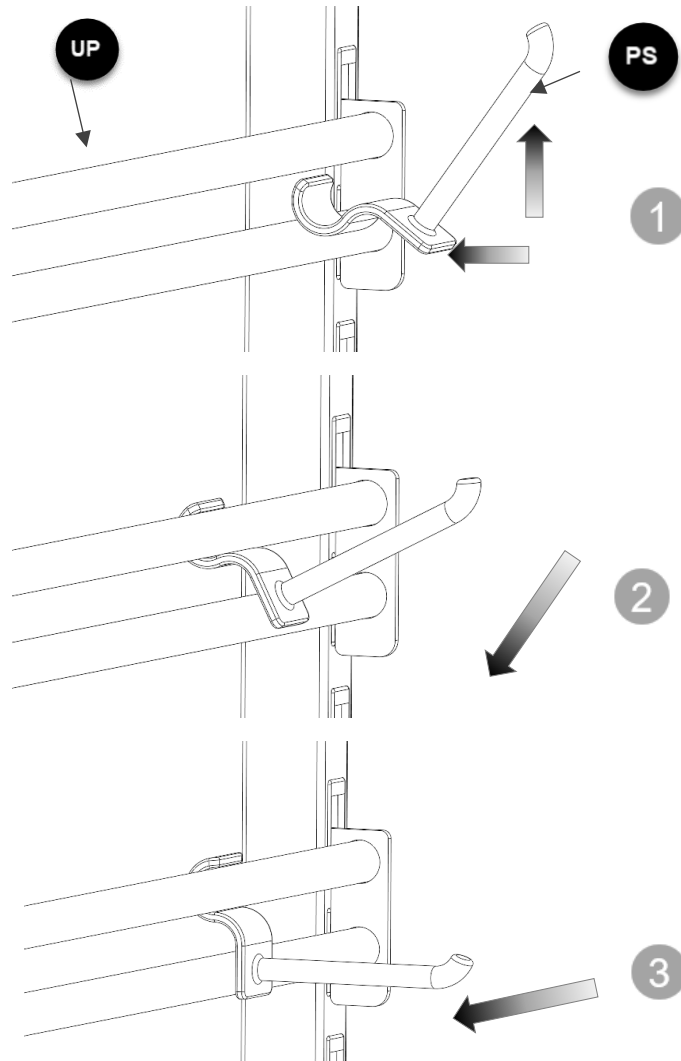

TILT PEG UPWARD AND INSERT
ROUNDED HOOK BETWEEN BARS

LIFT THE ROUNDED HOOK INTO
THE UPPER BAR AND ROTATE
THE PEG DOWNWARD

CONTINUE ROTATING UNTIL PEG
IS AT REST AGAINST LOWER BAR

- A)** Tilt the Peg upward and insert the rounded hook of the Peg between the bars of the Universal Bar.
- B)** Lift the rounded end of the Peg hook to mate with the upper bar. Continue to hold the Peg against the bar and rotate the Peg downward until at rest against the lower bar.
- C)** The Peg will now be securely mounted to the Universal Bar. Adjust the position as necessary so the Peg is level, well seated, and positioning appropriately across the bar.



CUSTOMER SUCCESS CONTACT

CUSTOMER SUCCESS CONTACT

CONGRATULATIONS, YOUR NEW STREAMLINE STORAGE SYSTEM IS NOW COMPLETE!

QUESTIONS?

Contact GYM RAX Customer Success

(888)-895-0547

info@gymrax.com

www.gymrax.com