

# RPK4-CH4102

## User Manual

### Kit Layout

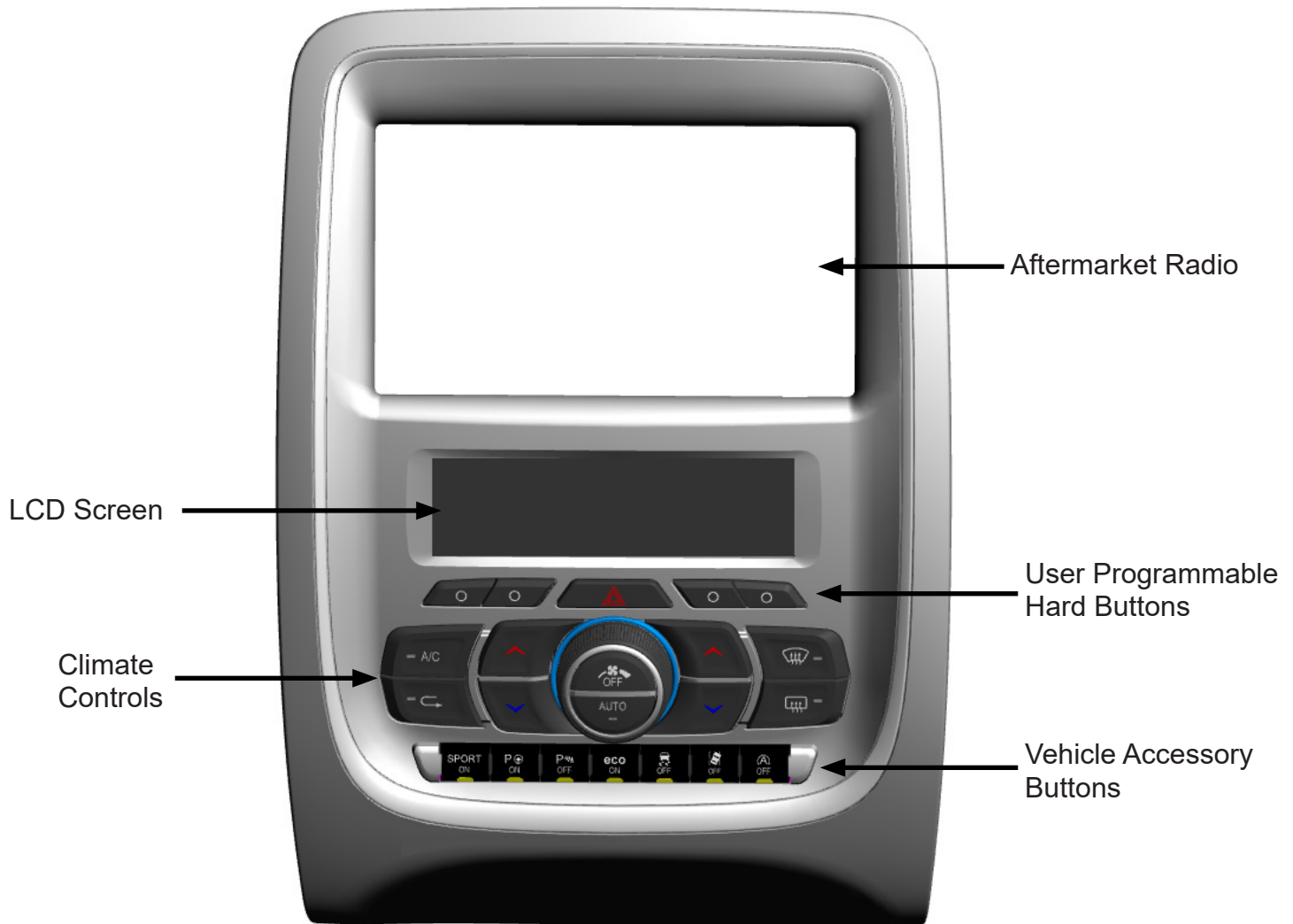

## Vehicle Feature Checklist

- |  |  |
|--|--|
| <input checked="" type="checkbox"/> Vehicle Settings | <input type="checkbox"/> Heated / Cooled Seats |
| <input type="checkbox"/> Factory Amplifier           | <input type="checkbox"/> Rear Climate Control  |
| <input type="checkbox"/> Dual Zone Climate Controls  | <input type="checkbox"/> Front Camera          |
| <input type="checkbox"/> Heated Steering Wheel       | <input type="checkbox"/> Rear Park Sensors     |

\*Additional features may be available depending on your vehicle.



# RPK4-CH4102

## User Manual

### Operating the Display

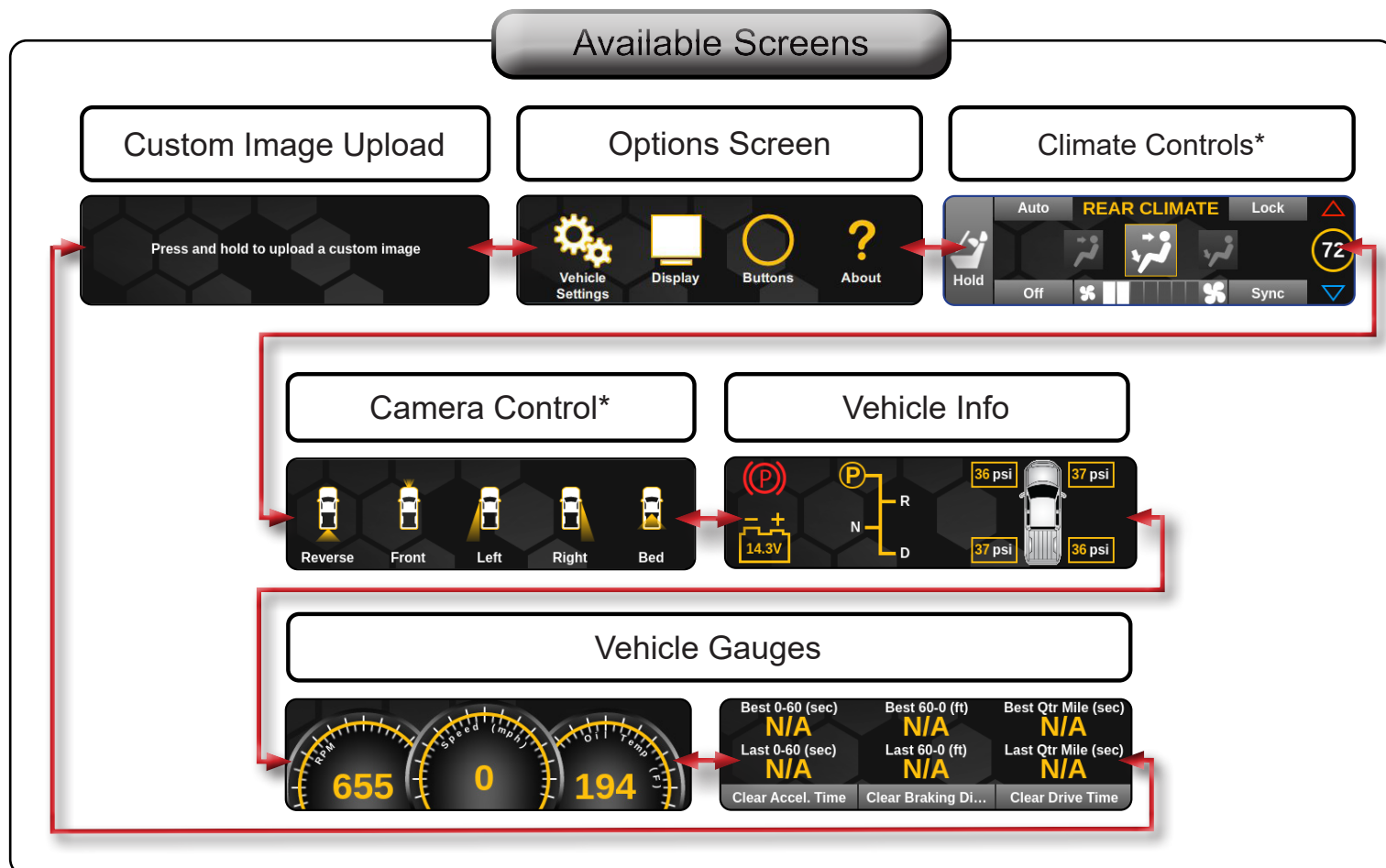

\*Available Camera Icons and Climate Control screen layout will vary based on number of cameras installed / configuration, and available vehicle features.

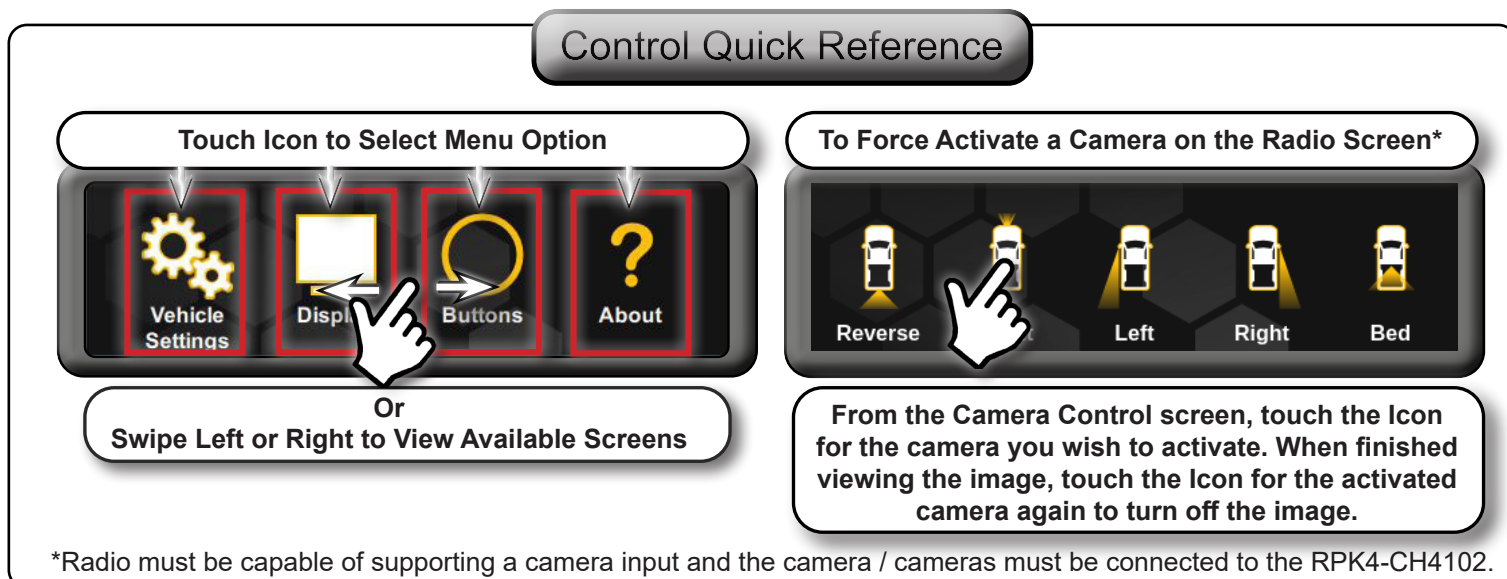

\*Radio must be capable of supporting a camera input and the camera / cameras must be connected to the RPK4-CH4102.



### Accessing Common Settings

#### Operating Heating / Cooling Options

1. Touch the icon for the desired function on the HVAC screen

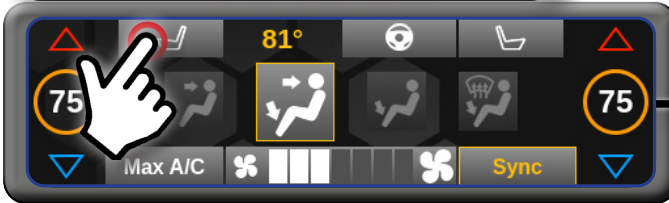

2. Select the desired function to activate



#### Accessing Vehicle Settings

1. Touch the "Vehicle Settings" icon on the Options screen



2. Select and adjust the desired vehicle setting

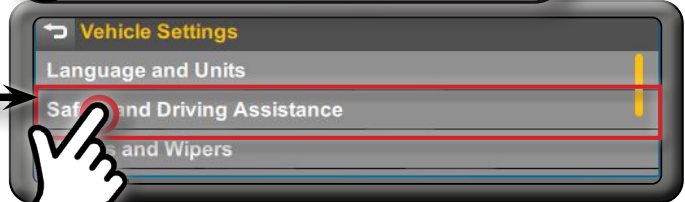

#### Adjusting Display Settings

1. Touch the "Display" icon on the Options screen



2. Allows Adjustment of LCD Background and Button Color

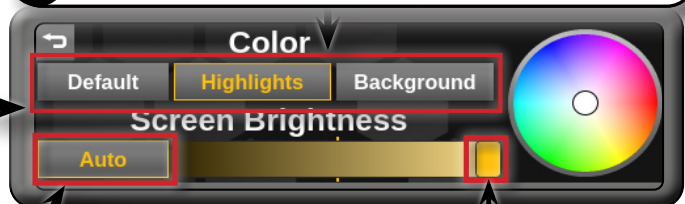

3. Turns Auto Dimming Off / On

4. Up / Down Slider to Adjust LCD Brightness

5. Touch "Highlights" Icon to Change Color

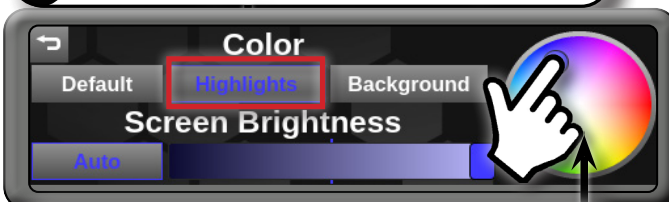

6. Touch Desired Color on Color Wheel

7. Touch "Background" Icon to Change Color



8. Touch Desired Color on Color Wheel

# RPK4-CH4102

## User Manual

### Accessing Common Settings

#### Hard Buttons

The four hard buttons located below the RPK4-CH4102 display, give you the ability to assign a single preset to each button to control a specific Climate Control function, force activate a specific camera to display on the radio, or to control select screen settings. Once the buttons have been assigned a function, a descriptive tag above each button showing what function that button performs will be present (this function can be toggled on / off).

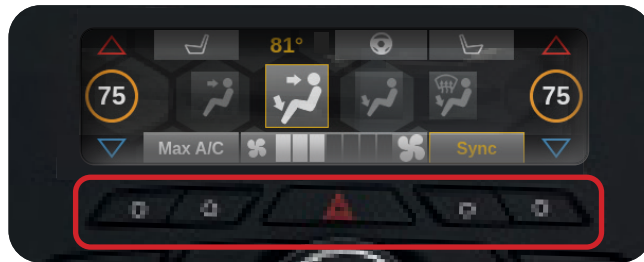

**If popups are turned on in the menu:** The proximity sensor, within the dash bezel, will display the descriptive tabs when your hand is near the buttons. When your hand is removed, the tabs will disappear.

Options that are able to be preset to the hard buttons include:

#### Climate Control Functions\*

- Max A/C
- Fan Mode
- Sync
- Rear Climate
- Heated Wheel

#### Camera Functions\*\*

- Camera 1
- Camera 2
- Camera 3
- Camera 4
- Camera 5

#### Screen Shortcut Functions\*

- Climate
- Camera
- Gauges

\* Climate Control Functions will vary for Single Zone, Dual Zone and Rear applications.

\*\* The number of available cameras will vary based on how many cameras are installed and activated.

Additional Hard Button options coming soon!

### Assigning function to the Hard Buttons

#### Step 1

Press the Buttons icon in the settings menu.

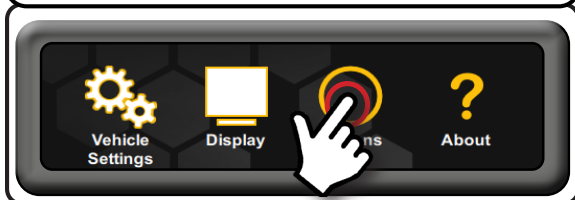

#### Step 3

Click on the device (Unassigned, Climate Controls, Cameras) operation you wish to program. In the example, we want to use the first hard button to force activate the cargo camera, so we select the Camera option.

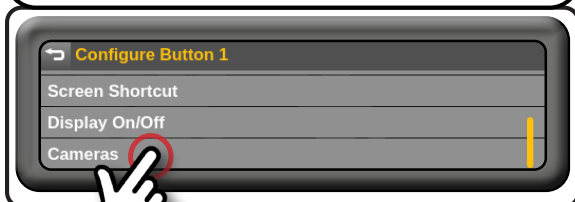

#### Step 2

Touch the tab that corresponds to the hard button that you wish assign a function to.



#### Step 4

In the example, because Camera 5 is the cargo camera, we select the Camera 5 option. Repeat steps 3 through 4 for each hard button you wish to program.

