

#### EN

With your inspiring rating, COSTWAY will be more consistent to offer you EASY SHOPPING EXPERIENCE, GOOD PRODUCTS and EFFICIENT SERVICE!

#### DE

Mit Ihrer inspirierenden Bewertung wird COSTWAY konsistenter sein, um Ihnen EIN SCHÖNES EINKAUFSERLEBNIS, GUTE PRODUKTE und EFFIZIENTEN SERVICE zu bieten!

#### FR

Avec votre évaluation inspirante, COSTWAY continuera à fournir une EXPÉRIENCE D'ACHAT PRATIQUE, des PRODUITS DE QUALITÉ et un SERVICE EFFICACE !

#### ES

Con su calificación inspiradora, COSTWAY será más consistente para ofrecerle EXPERIENCIA DE COMPRA FÁCIL, BUENOS PRODUCTOS y SERVICIO EFICIENTE.

#### IT

Con la tua valutazione incoraggiante, COSTWAY sarà più coerente per offrirti ESPERIENZA DI ACQUISTO FACILE, BUONI PRODOTTI e SERVIZIO EFFICIENTE!

#### PL

Dzięki twojej opinii COSTWAY będzie mógł oferować jeszcze WYGODNIEJSZE ZAKUPY, LEPSZE PRODUKTY i SPRAWNIEJSZĄ OBSŁUGĘ KLIENTA.

**US** office: Fontana

**UK** office: Ipswich

**AU** office: Truganina

**DE** office: Hamburg

**FR** office: Saint Vigor d'Ymonville

**PL** office: Gdańsk

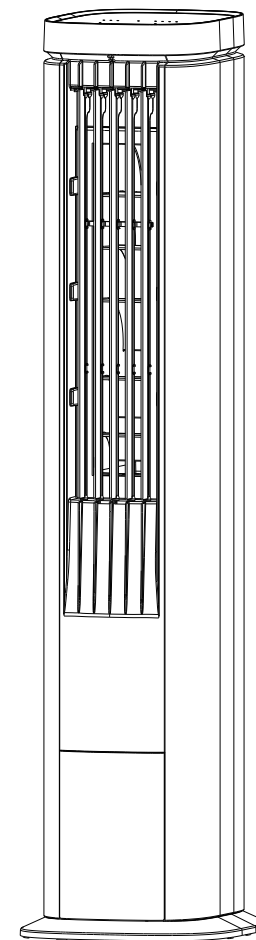

## USER'S MANUAL

### Portable Air Cooler ES10101US

**PLEASE READ THIS MANUAL CAREFULLY BEFORE OPERATING THIS APPLIANCE AND RETAIN IT FOR FUTURE REFERENCE**  
**IMPORTANT SAFEGUARD**

When using an electrical appliance, basic safety precautions should always be observed, including the following:

**READ ALL INSTRUCTIONS BEFORE USING**

**WARNING:** To reduce the risk of fire, electric shock, or injury to person:

1. Read all instructions before using. The product is for household use only.
2. Before first use, please check that the voltage you use is in accordance with the product nameplate requirements.
3. Always turn the product to the OFF position and unplug it from the electrical outlet when not in use.
4. Extreme caution is necessary when the appliance is used by or near children, invalids or elderly person.
5. Don't put the cord under the carpet, and don't cover the cord on the blanket, carpet, or the like. Place the cord away from walking areas and where they will not be tripped.
6. Please check the power cord and plug for breakage before using it.
7. Do not operate the appliance with a damaged cord or plug, or after the unit malfunctions, has been dropped, or damaged in any manner.
8. If the supply cord is damaged, it must be replaced by the qualified technician to avoid a hazard.
9. Use the appliance in a well-ventilated area. While using, distance of no less than 8" (20cm) should be kept away from wall or corner to ensure the air intakes or exhaust openings should not be blocked unexpectedly. The unit must not be located directly below or besides a curtain or the likes.
10. Use the appliance on flat, dry floor only.
11. Do not use in high temperature, humidity, dusty or volatile places such as acid-base oil.
12. Do not twist or pull the power cord to avoid bad contact.
13. Do not place heavy objects on the machine to prevent pressure breakdown from causing trouble.
14. Make sure the appliance is disconnected from the power supply when the power is cut off or moving.
15. Do not place machine directly under the power outlet.
16. When the whole machine is running, blocking duct and rear shell intake are not allowed. Don't use wire to plug into the passageway to prevent electric shock.
17. During the automatic oscillation process, do not change the orientation with the hand to avoid damaging the shaking structure.

18. Turn off the power supply before pulling out the plug. Do not pull the power cord. Pull out the power plug, otherwise it will lead to short circuit, fire and electric shock.

19. Do not use wet hand to pull out the power plug, there is a danger of electric shock and induction.

20. When leaving the room for a long time, please turn off the machine and unplug the plug.

21. Do not use in places where curtains are easy to suck in. Avoid obstacles and unstable places around you.

22. This appliance is not intended for use by persons (including children) with reduced physical, sensory or mental capabilities, or lack of experience and knowledge, unless they have been given supervision or instruction concerning use of the appliance by a person responsible for their safety.

**TECHNICAL SPECIFICATIONS**

Model No	ES10101US
Voltage	120V AC
Frequency	60Hz
Rated Power	90W
Water Tank Capacity	1.3 Gallon
Water Consumption	0.08 Gallon/h

**PRODUCT OVERVIEW**

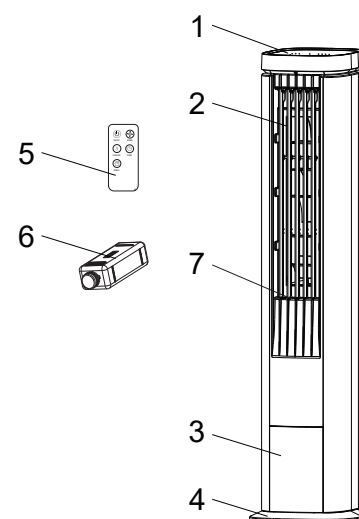

1	Control Panel
2	Air Outlet
3	Water tank
4	Base
5	Remote
6	Ice box* 4

## INSTRUCTION OF CONTROL PANEL



1. "ON/OFF" button Press the "ON/OFF" button to start or stop the fan.

2. "SPEED" button Press the "SPEED" button to set the desired fan speed. There are four speeds 1.2.3.4

3. "TIMER" button Set the desired shutdown time by pressing the "TIMER" button. It allows you to set an automatic switch on time. The options are 1-7 hours.

4. "SWING" button Press the "SWING" button to slide the fan blade from side to side. Press the "SWING" button again to stop the process.

5. "COOLING" button Press the button of "COOLING", the wind will be cooled if you have added water or water with the ice box. Press the "COOLING" button again to stop the cooling function.

**Note:** The fan will be turned off after 5 minutes of high-speed delay operation to dry the wet curtain, when in cooling function mode.

**Caution:** Do not start the cooling function if there is no water in the water tank as this will damage the water pump. DO NOT add water when the power is on.

## Remote control:

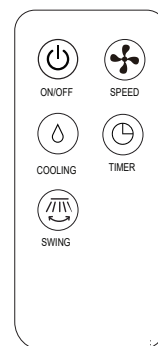

The above functions can be controlled using the remote control by pressing the corresponding function buttons.

## A . How to Add Water

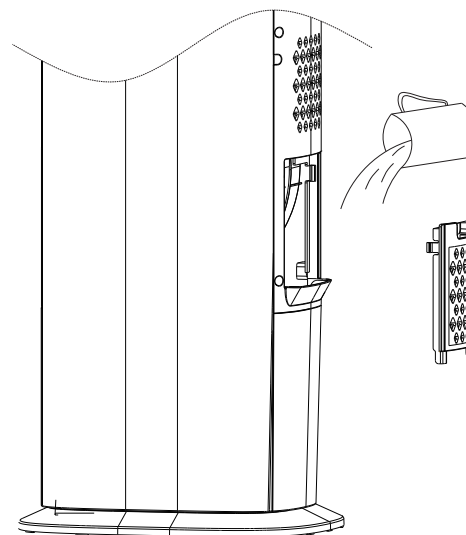

Pull out the back cover, then add clean water to the water tank.

**warning:**

- Unplug the power cord before adding water.
- when adding water, the water level in the water tank must not exceed the "MAX" mark, nor can it be lower than the "MIN" mark.
- If you need to enhance the cooling effect, you can add a frozen ice box to the water tank. (Warning: The water level in the water tank must not exceed the "MAX" mark after adding ice box)

## B . How to Use Ice Box

If you want to use an ice box (4 sealed ice boxes are included ) Place it in your freezer and leave it for 1 to 2 hours. Then put the frozen ice box into the water tank.

Caution: Do not place the ice box into the water tank when the water tank is full. The ice box is permanently sealed. Do not open the ice box or try to put the cooling gel directly into the water tank. This can cause damage to the water pump.

The ice box has unique cold storage and heat preservation characteristics, which can slowly absorb the heat in the water, making the water temperature in the water tank lower than the ambient temperature, and making the wind blown by the cooling fan cooler.

### Instructions:

- Put the ice box directly into the freezer compartment of the refrigerator until the ice box is completely frozen.
- Open the water filling plate on the back of the body, and put the frozen ice box into the water tank.

## C. How to Replace Ice Box ?

- Open the back cover of the water tank.
- Press firmly on the plastic sheets on both sides of the back cover to ensure that the cover can be taken out smoothly.
- Take out the ice box and put the additional frozen ice box into the water tank.
- After the ice box is replaced, pour clean water into it to ensure that the back cover of the water tank is tightly buckled.

### Battery installation:

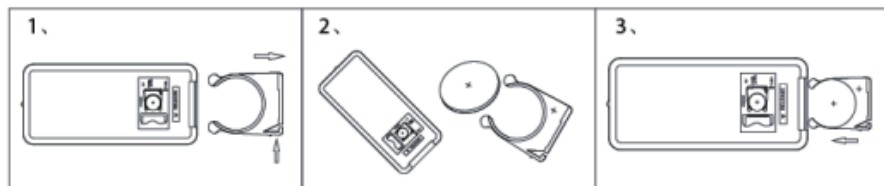

- Pull out the remote control battery holder according to the assembly drawing on the back of the remote control.
- Put the battery into the battery holder, pay attention to the positive and negative poles of the battery.
- Reinstall the battery holder with the battery in the remote control.

## TROUBLESHOOTING

TIROUBLE	POSSIBLE CAUSE	CORRECTIVE ACTION
Fan fails to operate	1. Unplugged or poorly contacted power cord. 2. Failure to press the switch. 3. Machine damaged.	1. Plug in the power cord. 2. Press the switch. 3. Ask qualified technician for help.
Unable to shutdown	Machine damaged.	Ask qualified technician for help.
Abnormal sound	1.Wind wheel loosening. 2. Motor breakdown.	1.Ask qualified technician for help. 2.Ask qualified technician for help.
Can not change the direction of the wind	Breakdown of wind guide synchronous motor.	Ask qualified technician for help.

## MAINTENANCE AND STORAGE

Cut off the power supply before maintenance

- When the body has oil pollution, it must be cleaned up to avoid discoloration and damage.
- After maintenance and cleaning, the parts should be packed into packing boxes according to the original packing and placed in a dry place for proper storage.
- This product only needs general external cleaning and maintenance.
- Use neutral detergent to wipe, and then clean with a clean and soft cloth.
- Do not rinse directly with water.
- Do not wipe with diluent, toluene, acid lotion, oil, etc. to avoid discoloration or deterioration.