

DLEX9900S/ DLGX9901S

LG Signature 9.0 cu ft. Mega Capacity Smart Front Load Dryer

LG SIGNATURE

KEY FEATURES

9.0 cu.ft. Capacity
Full Touch LCD Screen
AI Sensor Dry
25 Drying Programs
TurboSteam®

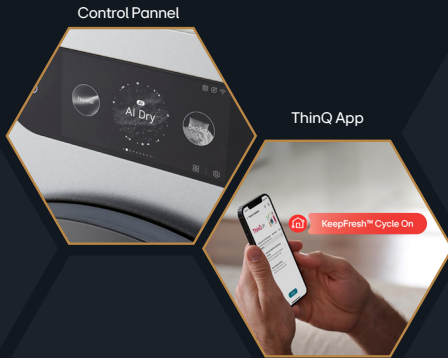

LG ThinQ®



PRODUCT FEATURES

SUMMARY

Capacity (cu.ft.)	9.0 cu.ft.
Matching Washer	WM9900HSA
Color	Brushed Platinum Steel

ENERGY

ENERGY STAR® Certified	Yes
CEF	Electric: 3.94 Gas: 3.49

APPEARANCE

Control & Display	Full Touch LCD Screen
Touch Buttons	Yes

DRYER PROGRAM

Number of Programs	25 Normal, AI Dry, Bedding, Delicates, Towels, Quick Dry, Timed Dry, Antibacterial, Perm. Press, SteamFresh™, Heavy Duty, Air Dry, SteamSanitary™, Super Dry, Activewear, Jeans, Blanket Refresh, Low Temp Dry, Easy Ironing, Small Load, Large Load, XL Load, Anti-Wrinkle, Overnight Dry, Rack Dry
--------------------	---

DRYER OPTIONS

Number of Options	15 Wi-Fi, Remote Start, Drum Light, Control Lock, Cycle List Edit, Signal, Brightness, Cycle Optimization, Smart Diagnosis, Factory Reset, TurboSteam®, Wrinkle Care, Damp Signal, Energy Saver, Low Static
-------------------	--

DRYER DETAILS

No. of Temps	5 High, Med.High, Medium, Med. Low, Low
Manual Dry Times	10-100 min. (each 5min), Dry Time

FABRIC CARE FEATURES

AI Sensor Dry	Yes
Sensor Dry	Yes
Precise Temperature Control with Variable Heater	Yes
Steam	TurboSteam®

CONVENIENCE FEATURES

3 Minute Installation Check	Yes
End of Cycle Signal	Yes
Drum Light (door open)	Yes
Reversible Door	Yes
FlowSense® Duct Clogging Indicator	Yes
Wrinkle Care Option	Yes
Control Lock	Yes
Venting Option	Electric: 4 Ways Venting Gas: 3 Ways Venting
Leveling Legs	4 Adjustable Legs
Remaining Time Display/ Status Indicator(s)	Yes

THINQ® TECHNOLOGY

Smart Diagnosis (v3.0)	Yes
Wi-Fi	Yes
ThinQ Care (Remote Start/Cycle Monitor)	Yes
Energy Monitoring	Yes (WiFi)

MATERIALS AND FINISHES

NeveRust® Stainless Steel Drum	Yes
Cabinet	VCM
Door	Tempered Glass Door
All Available Color	Brushed Platinum Steel

POWER SOURCE

Ratings	CSA Listed
Electrical Requirements	240V 26 Amps (Electric) 120V, 13 Amps (Gas)
Type	Electric / Gas
BTU Rating	Electric: N/A, Gas: 20,000

OPTIONS / ACCESSORIES

LP Conversion Kit	383EEL3002D // LPK1
Side Venting Kit	383EEL9001L
Drying Rack	AHB73109002
Pedestal	WDP8S 29 x 13 5/8" x 29 1/2"
Pedestal (WxHxD)	(45 9/16" D with door open)

DIMENSIONS

Product (WxHxD)	29" x 40 7/8" x 31 1/2"
Depth with Door Open	53 3/8"
Carton (WxHxD)	30 15/16" x 44 11/16" x 33 3/16"
Weight (Product/Carton)	145.3 / 157 lbs.

LIMITED WARRANTY

Parts and Labor	1 Year
Drum	3 Years

UPC CODE

DLEX9900S	195174071410
DLGX9901S	195174071427

DLEX9900S / DLGX9901S
LG SIGNATURE Front Load Dryer

IMPORTANT

QUICK INSTALL & CLEARANCES

For full installation directions/clearances please refer to the corresponding User Manual and Installation Guide.

DIMENSIONS

A Upper Ventilation Opening	≥ 48 sq. in. (310 cm2)
B Lower Ventilation Opening	≥ 24 sq. in. (155 cm2)
C Distance to Ventilation Opening	≥ 3"
D Overhead Cabinet Depth	≤ 14"
E Distance to the Overhead Cabinet/Shelf	≥ 18"
F Front Clearance	1"
G Depth	31 1/2"
H Back Clearance	≥ 5"
I Side Clearance	≥ 1"
J Width	29"
K Height of Cabinet Opening	40 7/8"
Carton Dimentions (in) (W x H x D)	30 15/16" x 44 11/16" x 33 3/16"

ENERGY

ENERGY STAR® Certified	Yes
CEF	3.94

POWER SOURCE

Ratings	CSA Listed
Electrical Requirements	240V 26 Amps (Electric) 120V, 13 Amps (Gas)

CONNECTING THE GAS SUPPLY

- Installation and service must be performed by a qualified installer, service agency, or the gas supplier.
- Use only a new stainless steel flexible connector and a new AGA-certified connector.
- A gas shutoff valve must be installed within 6 ft. (1.8 m) of the dryer.
- The dryer is configured for natural gas when shipped from the factory. Make sure that the dryer is equipped with the correct burner nozzle for the type of gas being used (natural gas or propane gas).
- If necessary, the correct nozzle (for the LP nozzle kit, order part number 383EEL3002D) should be installed by a qualified technician and the change should be noted on the dryer.
- All connections must be in accordance with local codes and regulations. Gas dryers MUST exhaust to the outdoors.

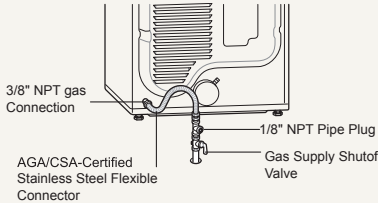

CONNECTING THE ELECTRIC SUPPLY

- A 4-wire connection is required for all mobile and manufactured home installations, as well as all new construction after January 1, 1996.
- A 3-wire connection is NOT permitted on new construction after January 1, 1996.
- A UL-listed strain relief is required.
- Use a 30-amp, 240-volt, 4-wire, UL-listed power cord with #10 AWG-minimum copper conductor and closed loop or forked terminals with upturned ends.

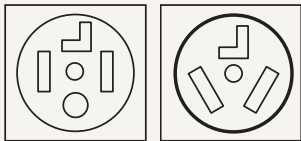

PRODUCT DIMENSIONS

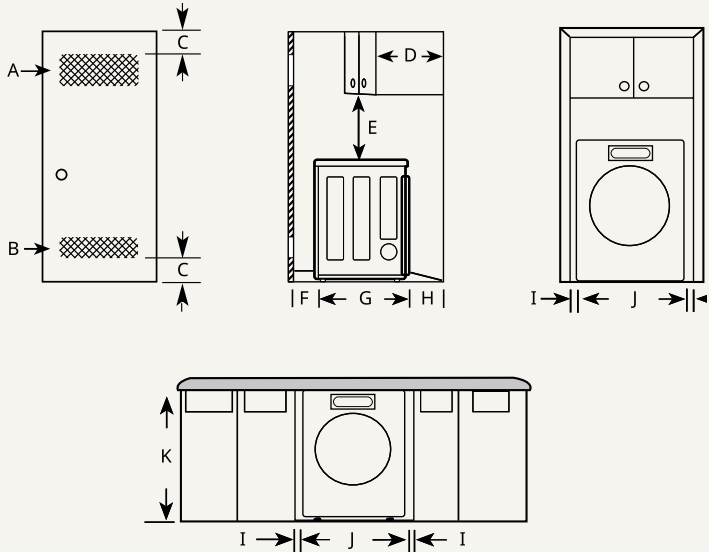

VENTING THE DRYER

Follow the guidelines below to maximize drying performance and reduce lint buildup and condensation in the ductwork. Ductwork and fittings are NOT included and must be purchased separately.

- Use 4-inch (10.2 cm) diameter rigid, semi-rigid or flexible metal ductwork.
- The exhaust duct run should be as short as possible.
- Use as few elbow joints as possible.
- The male end of each section of exhaust duct must point away from the dryer.
- Use duct tape on all duct joints.
- Insulate ductwork that runs through unheated areas in order to reduce condensation and lint buildup on duct surfaces.
- Incorrect or inadequate exhaust systems are not covered by the dryer warranty. Dryer failures or service required because of such exhaust systems will not be covered by the dryer warranty.

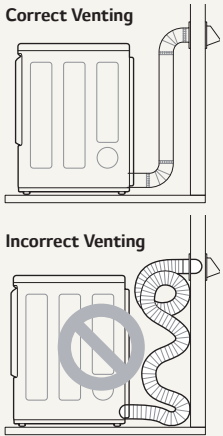

- Ductwork is not provided with the dryer. You should obtain the necessary ductwork locally. The vent hood should have hinged dampers to prevent backdraft when the dryer is not in use.
- The total length of flexible metal duct must not exceed 8 ft. (2.4 m).
- Deduct 6 ft. (1.8 m) for each additional elbow. Do not use more than four 90° elbows.

Wall Cap Type	Number of 90° Elbows	Maximum length of 4-inch diameter rigid metal duct
Recommended	0	65 ft.(19.8 m)
	1	55 ft.(16.8 m)
	2	47 ft.(14.3 m)
	3	36 ft.(11.0 m)
Use only for short run installations	4	28 ft.(8.5 m)
	0	55 ft.(16.8 m)
	1	47 ft.(14.3 m)
	2	41 ft.(12.5 m)
a: 4" (10.2 cm)	3	30 ft.(9.1 m)
	4	22 ft.(6.7 m)
b: 2.5" (6.35 cm)	0	55 ft.(16.8 m)
	1	47 ft.(14.3 m)
	2	41 ft.(12.5 m)
	3	30 ft.(9.1 m)
	4	22 ft.(6.7 m)