

10.26 Inch Smart Screen DVR

User Manual



Directory

1.Product overview.....	3
2.Product composition list.....	4
3.Product description.....	5
4. SD card specifications.....	7
5. Wiring instructions.....	8
6.Camera installation.....	9
7. Interface specification.....	10
A. Apple Carplay.....	11
B.Android Auto.....	13
C. Bluetooth Music.....	15
D. DVR.....	16
E.Playback.....	17
F. Audio output.....	18
G.Setting.....	22

1. Product overview

10.26 inch Smart Screen DVR uses two wide-angle cameras installed inside and outside the vehicle to capture images of the surrounding area and transmit them to the integrated device in real time. With the help of this system, the driver can see the obstacles and pedestrians around the vehicle intuitively, and effectively reduce the occurrence of scraping, collision, collapse and other accidents. This product can record all driving pictures to avoid accident fraud.



- 1. Display
- 2. Driving Vehicle Recorder
- 3. Driving Vehicle Recorder
- 4. AUX port
- 5. TF card slot
- 6. AV IN (For Optional Back Up Camera)
- 7. DC-5V power port
- 8. Base
- 9. 12V cigarette lighter wire



2. Product composition list

Smart Screen DVR		1
Monitor base		1
power line		1
Base adhesive		1
AUX line		1
Rear-view camera		1
Suction cup base		1

3. Product description

Project	Function introduction	Performance indicators
System	Language	Simplified Chinese /Traditional Chinese /English / Russian/Spanish /French /German /Japanese/ Korean / Arabic/
	Operation interface	Graphical menu operation
	Mode of operation	Touch
Video input	Video input	2 channels FHD video input
	Video mode	Default boot recording, no missing seconds
	Video format	2K H.264 video, 2 channels of video saved separately
Video display	Real-time display	10.26-inch HIGH-DEFINITION IPS screen,1600 x 600F
	Playback	Local play, anytime to view
	Screen saver	Screen savers can be set to: off / 1minute / 2 minutes / 3 minutes
Reverse display	Reverse display	Automatically switch to the rear-view camera
	Reverse line calibration	Adjust the reversing line for various models

Product description

Smart connected	Wi-Fi	Supports CarPlay and Android Auto
	Bluetooth	Support Bluetooth music
	FM	FM Transmitter support, connected to the car radio
Storage	SD card	CLASS 10.U3:256GB maximum
Audio	Microphone	Support microphone recording, menu can be set to turn off
	Voice control	Support voice control, siri
Power	Input Power	The cigarette charger supports 12-24V wide voltage and has power protection circuits such as vehicle specification level surge protection and anti-reverse connection protection.
Power consumption	Two-way video	Less than 10W(screen display,2-channel camera recording)
Other	Working temperature	-4~149°F
	Video time	Video recording duration can be set
	Camera mirroring	The camera supports mirror display, and the menu can be set

4.SD card specifications

The quality of SD card has a great impact on the stability of video recording. To record video continuously and safely, use SD cards from major brands such as San Disk,Kingston, Toshiba, and Samsung. Speed certification must be at least Class10.

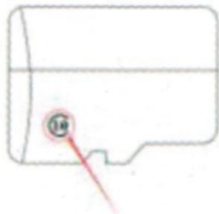

5.Wiring instructions



The details are as follows:

Port	Instructions
Type C interface	Monitor power supply interface
Cigarette charger	<p>The cigarette lighter takes power directly</p> <p>Note: The product comes with a cigarette charger as standard. Please use the provided cigarette charger otherwise it is easy to be damaged the Smart Screen DVR or cause other damages due to insufficient voltage and heat. Moreover, FM Transmitter cannot work normally.</p>

6.Camera installation

Locate the drilling hole, find the appropriate installation position in the license plate as below, mark it with a pen and then drill the appropriate size of the screw hole. Fix the rear-view camera at the back of the car with screws, the reversing trigger wire (red wire) needs to be connected to the positive pole of the reversing light, and finally use the camera extension cable to connect to the monitor.

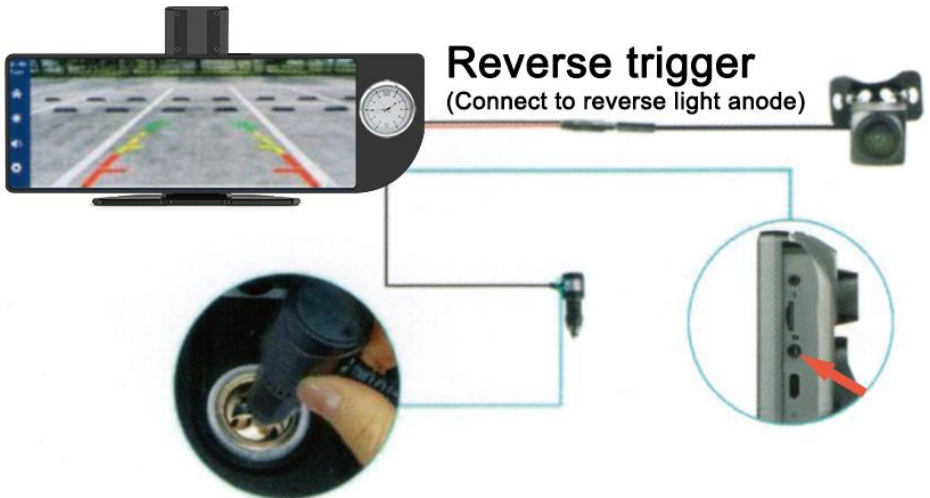

Note: Rear-view camera is optional and please ignore if the Smart Screen DVR doesn't have rear-view camera.

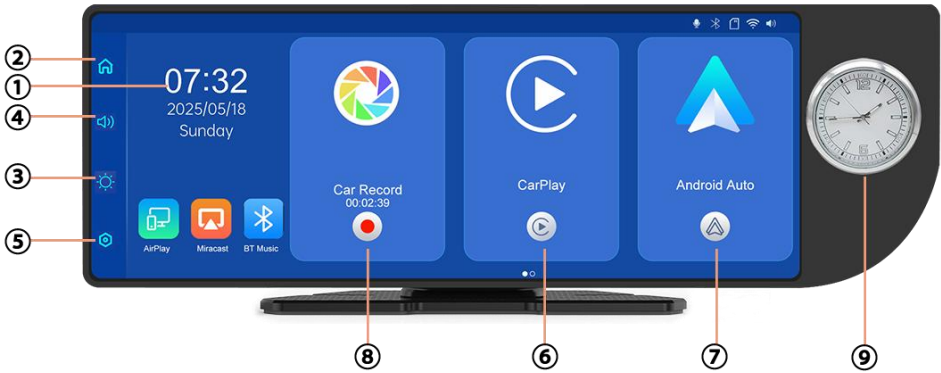

7.Interface specification



- ① **Time and date:** display the current time and date
- ② **Home button:** click to return to home page
- ③ **Brightness button:** click to adjust the screen brightness
- ④ **Volume button:** click to adjust the volume
- ⑤ **Setting button:** click to jump to the setting interface

 (DVR)  (Mobile Internet)  (Return)

- ⑥ **Apple CarPlay:** Special connection for iPhone
- ⑦ **Android Auto:** Special connection for Android mobile phone
- ⑧ **DVR:** Click to enter the video recording interface
- ⑨ **Clock:** Time display

Wireless CarPlay connection

Click the home screen to enter Carplay.

1. Go to "Settings" on your iPhone and turn on "Bluetooth" and "Wi-Fi"
2. Enter the "Bluetooth" menu and select the Bluetooth device starting with "Car BT" from the "Other Devices" Bluetooth device list.
3. Wait for about 20-30 seconds, and the phone will pop up a prompt of "Bluetooth pairing request". Select "Pairing" to successfully pair.
4. Then, the phone will pop up a prompt of "Use CarPlay to connect CarBT". Select "Use CarPlay"
5. Please wait for a moment and you will enter CarPlay mode.



Note

1. Different versions of ios may display differ- ently, please refer to the actual situation.
2. The first connection may take a longer time, please be patient.
- 3 . If you want to switch to Android Auto or Airplay, you need to turn off Bluetooth and wi-Fi on your phone to disconnect the Apple carplay connection mode.

10.Wired CarPlay connection

- 1.Please use an Apple original/certified cable to connect your iPhone to a USB port.
- 2.Wireless Android Auto Connection
- 3.First, please pairing your mobile phone's BT with the device's.
- 4.Then you can confirm to use Android Auto, and it will automatic connection next time.
- 5.If you want to disconnect it, you can turn off the wifi of the car stereo.
- 6.Wired Android Auto Connection
- 7.Connect the phone and USB port with android original/certified cable.

NOTE: You can click the "Car Home" if you want to turn back to the homepage of the unit.

A. Carplay connection UI interface

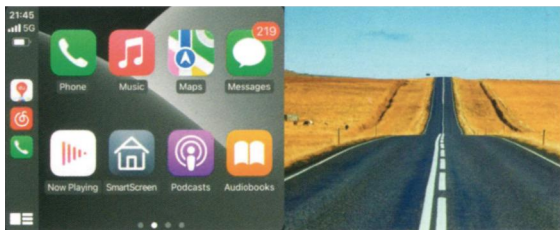

Split screen mode

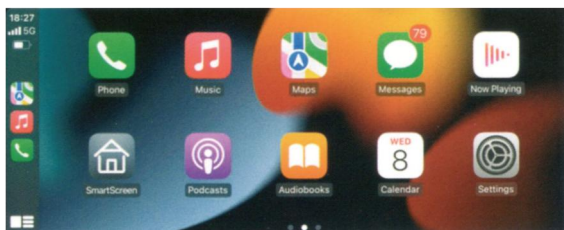

Full Screen

Carplay connection steps:

21:55 Thursday

CarPlay Android Auto AirPlay Miracast BT Music WIFI Video

Setting

Bluetooth On >

Bluetooth Bluetooth On

XXX-XXXXXX Connect

Use CarPlay with "SmartScreen"?

CarPlay automatically connects your iPhone to your car's built-in display and unlocks your phone while it's locked.

Not Now Use CarPlay

BT Manage

Turn on Bluetooth on your iPhone and select to connect the device: F800_D514781C

Wireless Android Auto:

1. Go to Settings on your phone, turn on "Bluetooth" and "Wi-Fi"
2. Click on "Bluetooth" to enter the Bluetooth search page.
3. After entering the "Bluetooth" menu, click "Pair new devices" to search for new Bluetooth devices.
4. Select the Bluetooth device starting with " Car BT" from the list of "Other DEVICES" Bluetooth devices.
5. Wait for about 20 seconds, a prompt box will pop up on the phone with "Pair with Car BT", click "Pair" (as shown below), and wait for the Bluetooth pairing to complete.

After the Android Auto connection is completed, it will automatically enter the Android Auto mode.

B.Android Auto connection UI interface

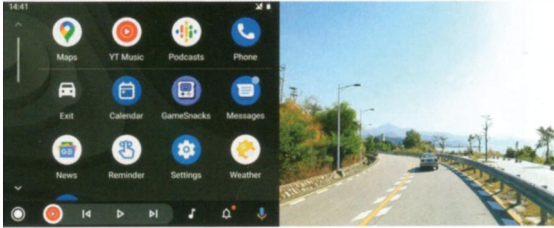

Split screen mode

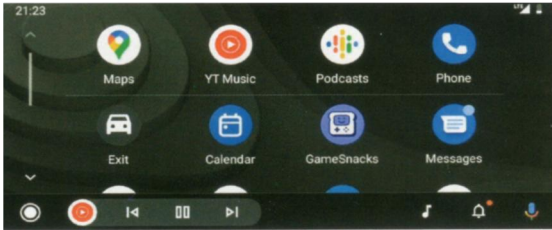

Full Screen

Android Auto connection steps:

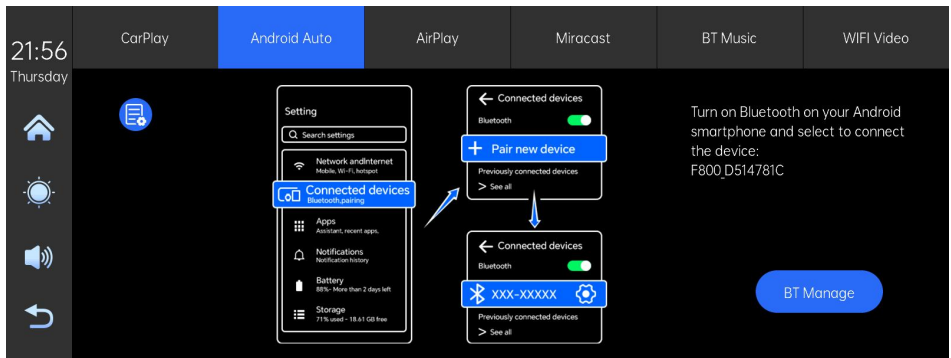

C. Bluetooth Music

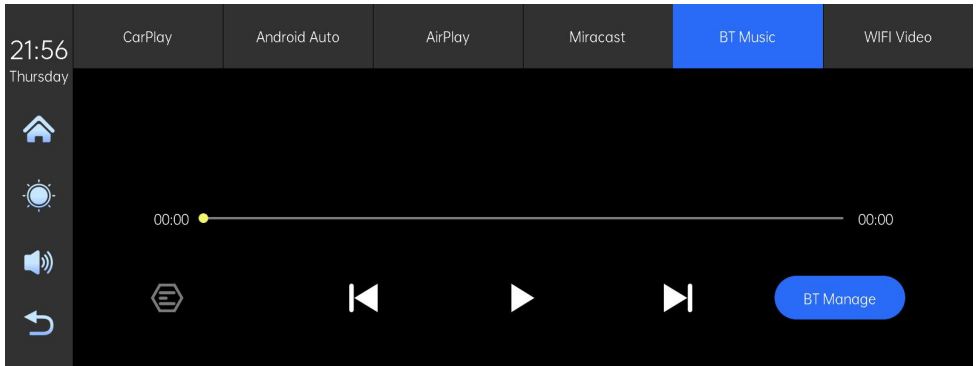

You can find Bluetooth music by clicking Apple CarPlay or Android Auto button. First turn on Bluetooth from the phone, and then select the [Bluetooth Music] option. The Bluetooth will automatically turn on. The Bluetooth name is T86-XXXXX. Connect Bluetooth to your phone and start playing music.

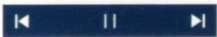

The buttons correspond to "Previous" , "Play/ Pause" and "Next" respectively.

Click on the Lyrics button  to display the lyrics.

Click the  button to go to DVR mode.





Note: Some music player APPS can not support display lyrics.

D. DVR



As shown in the picture, the screen will not display the camera image automatically, you need to click DVR button to view the camera image. When a card is inserted, the system automatically enters the video mode with camera image, and when recording, the small red dot in the [Driving Monitoring] button will flash.

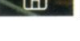

	Start recording and click again to pause recording.
	Lock the video for a few minutes and the data will not be deleted.
	Click to take a photo.
	View playback video.
	Turn recording sound on or off.
	Click to switch the camera display mode.

E. Playback

As shown in the picture, click [Playback] button to enter the playback mode.

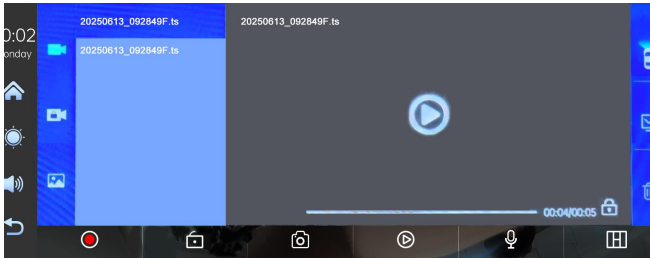

You can click any video and photo to play on the left.

F. Audio output

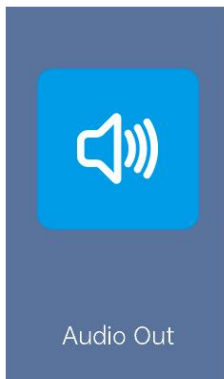

As shown in the picture, click [Audio Output] button to enter the audio output interface.

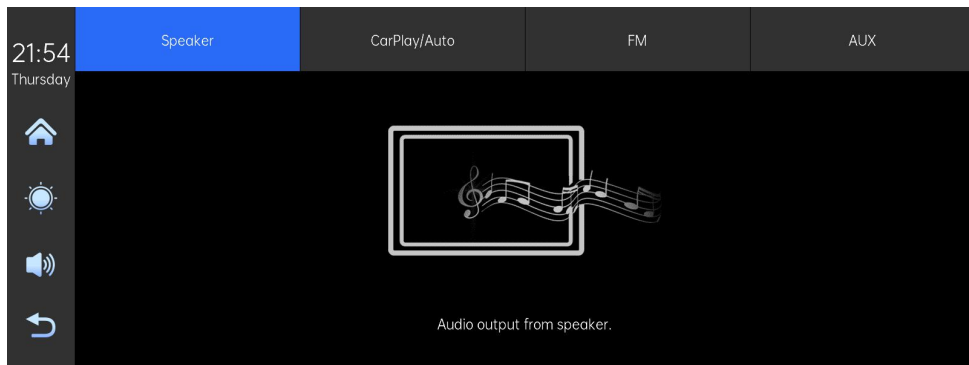

① **[Speaker]:** The sound will be played from the speaker of the Smart Screen DVR.

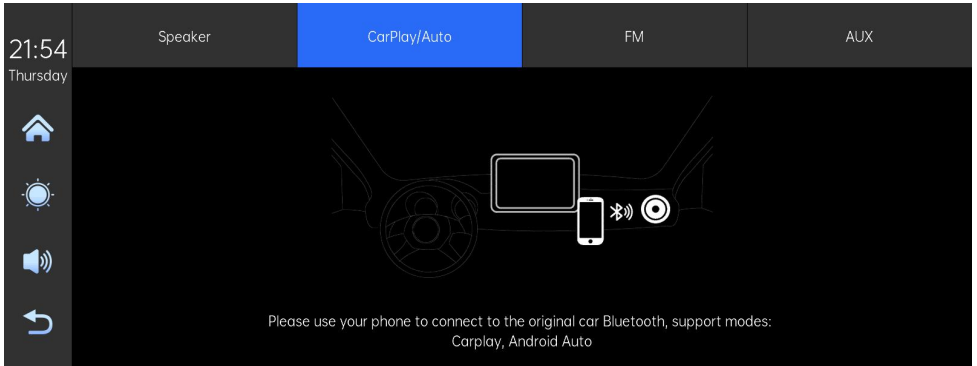

② [Carplay/Auto]: Go to this mode and connect Apple CarPlay or Android Auto mode with your phone firstly. Then connect the Bluetooth of the original car audio with your mobile phone. After finishing all above steps, the audio or call data can be played from the original car stereo.

Advantages of Carplay/Auto:

In this mode, the users don't need to set the audio output channel on the mobile phone to the original car Bluetooth device every time. The sound is directly sent from the mobile phone to the original car audio, and you can enjoy the good sound quality of the original car audio.

Other instructions:

After completing the above steps on an Android phone, if the sound is still playing from the phone, you need to open the drop-down menu of the phone and switch the audio output channel to the car Bluetooth, as shown in Picture 1 and Picture 2.

Alternatively, in the Bluetooth settings of the phone, locate the Bluetooth device that was previously connected to Android Auto: T86-XXXXXX (not the original car Bluetooth device), click the settings button on the right side of the Bluetooth, and close [Media Audio] button, as shown in picture 3 and picture 4:

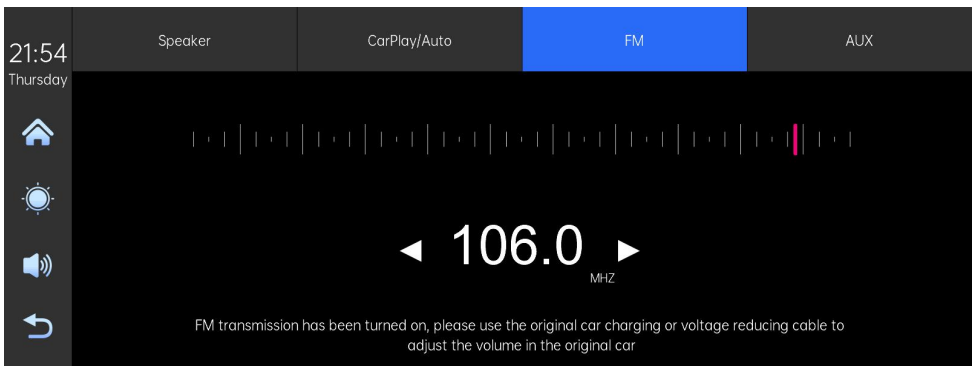
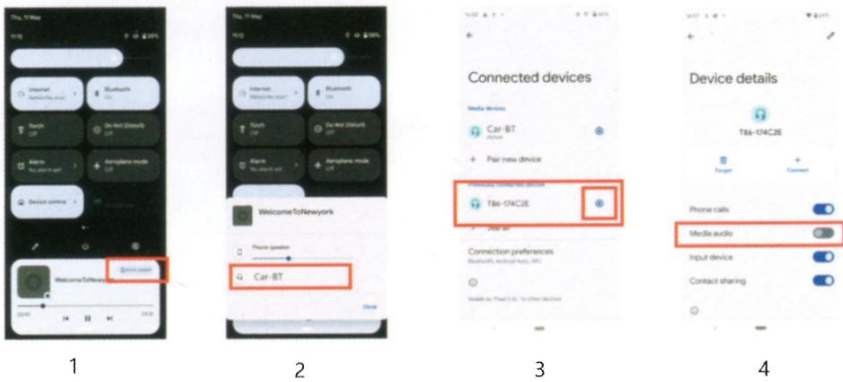

③ [FM]: After selecting this mode, FM transmission mode will be turned on by default. For example, if the FM transmitting frequency band of the Smart Screen DVR is adjusted to FM 106.0 MHz (any unoccupied channel can be used), the car radio will also adjust the receiving frequency band to the same FM 106.0 MHz. After successful connection, all sounds of the equipment will be transmitted to the original vehicle horn through FM transmission.

After selecting this mode, the volume icon will change to FM emission icon  and the volume cannot be adjusted on this device, so it must be adjusted on the original vehicle.

Note: Not using the provided cigarette charger will cause FM Transmitter signal to deteriorate or not work.

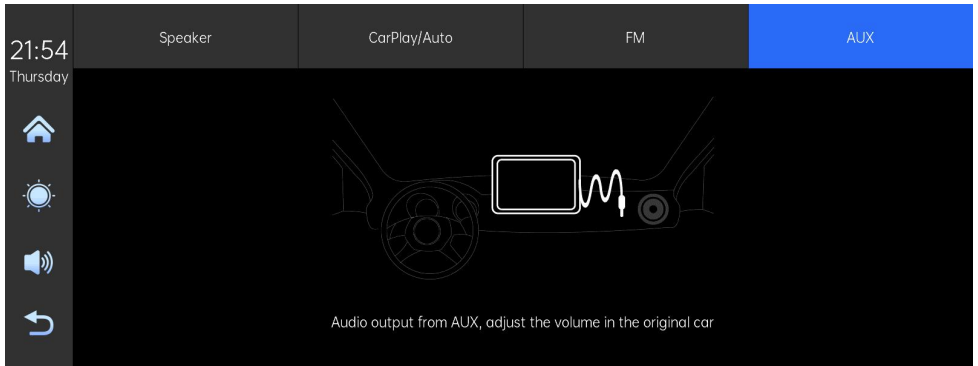

[AUX]: After selecting this mode, the AUX output mode will be turned on by default. Connect the equipment to the original vehicle with an AUX sound source cable. After the connection is successful, all the sounds of the equipment will be transmitted to the original vehicle speakers through the AUX sound source cable for playback.





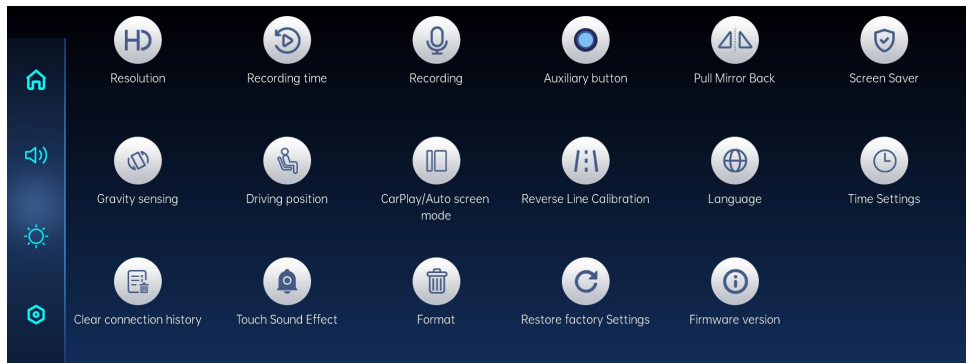

After selecting this mode, the volume icon will change to AUX output icon  , and the volume cannot be adjusted on this device, so it must be adjusted on the original vehicle.

AUX only works when connecting the Smart Screen DVR with AUX cable. It is optional.

G. Setting

As shown in the picture, click the  button in the left bottom to enter the setting interface.



Icon	specification
 <p>Resolution</p>	<p>Click to go to [Record resolution] options: 1080P+2K+4K</p>
 <p>Recording time</p>	<p>Click [Recording time] to enter the setting of the Video segmentation time is optional: 1 minutes / 3 minutes / 5 minutes. The system defaults to 1 minutes.</p>
 <p>Recording</p>	<p>Click [Recording] to enter the settings: You can choose to turn on or off.</p>
 <p>Auxiliary button</p>	<p>Click[Auxiliary button]to enter the settings: You can choose to turn on or off.</p>
 <p>Pull Mirror Back</p>	<p>Click [Pull Mirror Back] to enter the settings: You can choose to turn on or off. This option makes it easier for customers to install the camera flexibly.</p>
 <p>Screen Saver</p>	<p>Click [Screen Saver] to enter the setting optional: off/1 minutes / 2 minutes / 3 minutes. The system default off. Set 1 or 3 minutes, the system will run without corresponding time, and the screen will automatically turn off. After entering the screen saver, the</p>

screen can be lit up by touching any position on the screen.

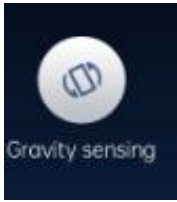

Click [Gravity sensing] to enter the settings:
You can choose to low middle high or off.



Click [Driving position] to enter the settings:
You can select left rudder or right rudder.





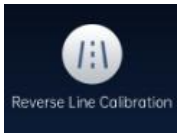



Click [CarPlay/Auto screen mode] to enter the setting:
You can select Full screen mode or half screen mode



See the instructions of Reverse line calibration below.



Click [Language] to enter the settings:
Language can be set up: Simplified Chinese /
Traditional
Chinese / English / Russian / Spanish / French /
German /
Japanese / Korean

 <p>Time Settings</p>	<p>Click [Time Settings] to enter the settings: Set up separately: year / month / day / time / minute / second / 12H system/24H system</p>
 <p>Clear connection history</p>	<p>Click[Clear connection history]to enter the settings: You can clear the records of your phone connections.</p>
 <p>Touch Sound Effect</p>	<p>Click[Touch Sound Effect] to enter the settings: You can choose to turn on or off.</p>
 <p>Format</p>	<p>Click [Format] to enter the settings: It will delete all data in the micro SD card. It is recommended to manually format the micro SD card before the first use to ensure sufficient card capacity. Note: It is recommended that users manually format the SD card regularly.</p>
 <p>Restore factory Settings</p>	<p>Click [Factory reset) to enter the Settings: Restore the factory settings, and you restore all the settings to the factory version.</p>
 <p>Firmware version</p>	<p>Click [Firmware version] to enter the menu: To check the current software version.</p>

H. Reverse Line Calibration

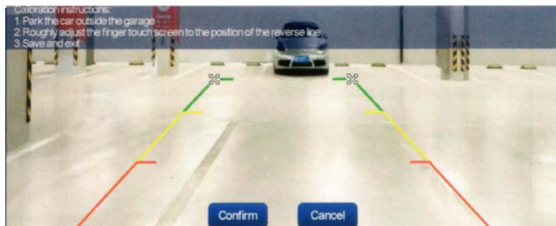

Park the car in the middle of the parking space, manually drag  adjust the position of the reversing auxiliary line up, down, left and right, so that the reversing auxiliary line and the parking line are level with the ground.

After adjusting the reversing line, click [confirm] to confirm.