

INSIGNIA™

QUICK SETUP GUIDE

Pre-Filter

NS-APPF168

PACKAGE CONTENTS

- Pre-Filter
- Quick Setup Guide



UNDERSTANDING THE FILTER INDICATOR

FILTER INDICATOR	MEANING
Green LED	Normal operation.
Blue LED flash	Check and replace the pre-filter.
Red LED flash	Check and replace the HEPA filter.
Blue/red LED flash	Check and replace both filters.

Note: There is a sticker on your air purifier to remind you what each color indicates.

REPLACING THE PRE-FILTER

The filter indicator flashes blue after 1500 hours of use to remind you to replace the used filter with a new Insignia pre-filter (NS-APPF168).

- 1 Turn off your air purifier, then unplug it.
- 2 Remove the air inlet grill by pulling it out (A), then remove the used pre-filter from the air inlet grill (B).
- 3 Install a new Insignia pre-filter (NS-APPF168) on the air inlet grill (C), then reattach the grill (D).

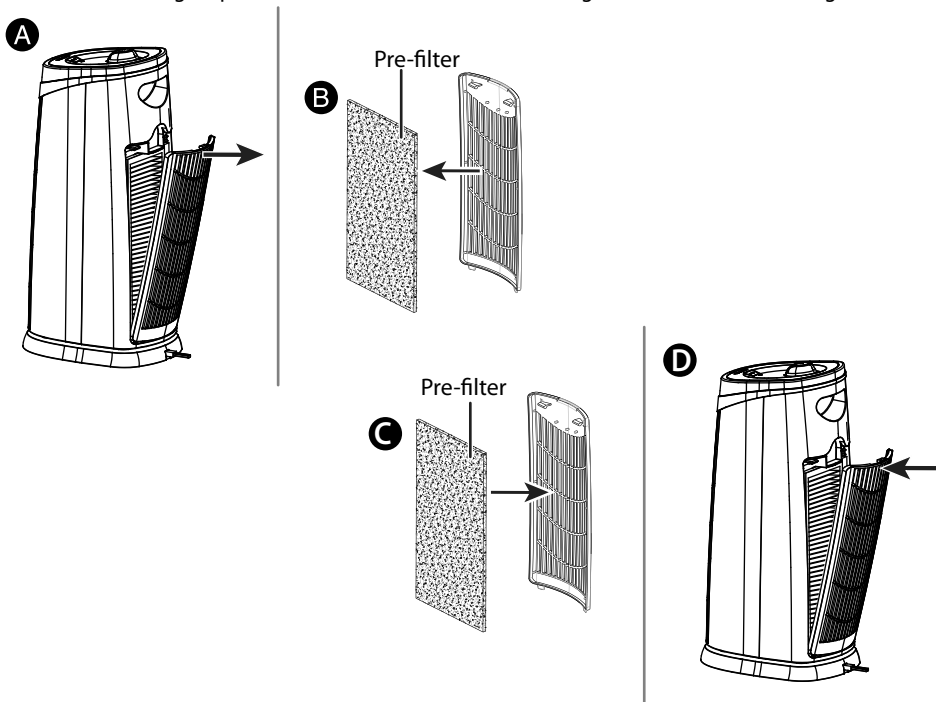

TROUBLESHOOTING

PROBLEM	SOLUTION
My air purifier does not work.	<ul style="list-style-type: none">• Make sure that your air purifier is plugged in.• Make sure that the power outlet is working.• Make sure that your air purifier is turned on.• If your air purifier is plugged into a surge protector, make sure that it is turned on.
My air purifier has poor air flow or is loud.	<ul style="list-style-type: none">• Make sure that nothing is blocking the air inlet and filtered air outlet. Position your air purifier at least one foot (.3 meters) away from walls or large objects.• Check the condition of the filters. Replace them if they are dirty.• Remove the plastic bag from the HEPA filter.• Make sure the filters are seated properly.
My pre-filter does not last the full 1500 hours.	<ul style="list-style-type: none">• Excessive amounts of pet dander, dust, or smoke may decrease the life expectancy of the filter.
My filter indicator is flashing blue and/or red.	<ul style="list-style-type: none">• When the filter indicator LED flashes blue, you need to check and replace your pre-filter.• When the filter indicator LED flashes red, you need to check and replace your HEPA filter.• When the filter indicator LED flashes blue and red, you need to check and replace both filters.

SPECIFICATIONS

Pre-filter dimensions (H×W×D)	10.3 × 5.1 × .2 in. (26.2 × 13.0 × .5 cm)
Operating temperature	40~110°F (4~43°C)
Coverage area	108.0 sq. ft. (10.0 m ²)
Pre-filter lifetime	1500 hours
Pre-filter technology	Activated carbon mesh

ONE-YEAR LIMITED WARRANTY

Visit www.insigniaproducts.com for details.

CONTACT INSIGNIA:

For customer service, call 877-467-4289 (U.S. and Canada) or 01-800-926-3000 (Mexico)
www.insigniaproducts.com

INSIGNIA is a trademark of Best Buy and its affiliated companies.
Registered in some countries.
Distributed by Best Buy Purchasing, LLC
7601 Penn Ave South, Richfield, MN 55423 U.S.A.
©2017 Best Buy. All rights reserved.
Made in China