

QUICK REFERENCE GUIDE

Cuisinart®

Coffee Center® BARISTABAR



INITIAL SETUP

- 1.** Fully immerse and soak the 2 charcoal water filters in cold tap water for 15 minutes (see instruction booklet, page 9). Remove water filter holders from both 12-Cup Coffeemaker and Single-Serve reservoirs.



- 2.** Press down and pull forward on filter compartments to open, and place filters in holders. Snap to close, run under water for 10 seconds, and drain completely.

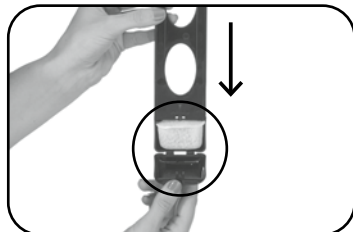

- 3.** Slide filter holders back into channels in reservoirs. If you haven't already, plug the power cord into an independent outlet.



BEFORE FIRST USE

Before using your Coffee Center® BaristaBar for the first time:

12-Cup Coffeemaker: Follow steps 1, 2, and 3 under 12-CUP CARAFE: BREWING, using only water to thoroughly rinse the coffeemaker.

Single-Serve Coffeemaker: Follow steps 1–4 under SINGLE-SERVE: BREWING and MAKING ESPRESSO without a pod or espresso capsule to thoroughly rinse the coffeemaker. Your unit is now ready to use.

IMPORTANT: Complete initial cleaning before first use.

12-CUP CARAFE: BREWING

- 1.** Pour your desired amount of water into the water reservoir. A water level indicator is located on the side of the unit.



- 2.** Insert #4 filter or permanent filter into filter basket, and add 1 level scoop of ground coffee per cup. Do not exceed 15 tablespoons. Press BOLD button if you prefer bolder taste.



- 3.** Turn Function knob to BREW; the BREW indicator will appear. Press ON/OFF to start brewing or stop brewing. Five beeps will sound when brew cycle is finished.



SINGLE SERVE: BREWING

- 1.** Add water to the 72-ounce water reservoir.



- 2.** Place mug on tray, open the brew head, and insert capsule. **NOTE:** The drip tray can be removed to accommodate travel mugs or placed as an adjustable shelf for shorter mugs.



- 3.** Turn the START/STOP knob clockwise to enter POD mode and then choose your desired brew POD size of 6, 8, or 10 oz.



- 4.** Press the START/STOP knob on selected POD size. The ON indicator will illuminate and brewing will begin. Once fully dispensed, one short beep will sound.



USING THE HOMEBARISTA® REUSABLE FILTER CUP

The Single-Serve Coffeemaker can be used with a reusable coffee capsule (not included), which allows you to use your own ground coffee.

Try the Cuisinart® HomeBarista® Reusable Filter Cup for your favorite coffee or tea. Available in stores.

- 1.** Fill the filter basket inside the reusable capsule with your ground coffee. **Max fill is 15 grams (2½ scoops).**



- 2.** Remove the pod capsule chamber from the brew head chamber, and insert reusable filter cup. Follow steps 3 and 4 of the SINGLE SERVE: BREWING directions.

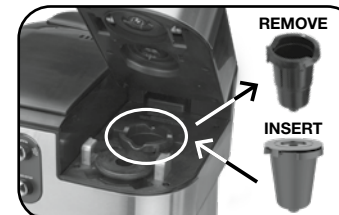

- 3.** After brewing, replace the capsule holder, ensuring arrow on capsule rim aligns with arrow on brewing chamber. Gently push down to snap into place.



MAKING ESPRESSO

This machine is compatible with Nespresso® OriginalLine style capsules.

1. Add water to the 72-ounce water reservoir if ADD WATER indicator is on.



2. Move drip tray to adjustable tray position to avoid any splashing and more accurate dispensing of espresso. Place espresso cup on drip tray.



3. Remove the espresso capsule holder from the brew chamber, and place the espresso capsule in the holder. Place the espresso capsule holder back into brew chamber and close brew head.



4. Turn the START/STOP knob clockwise to select ESPRESSO, then choose your desired ESPRESSO brewing size. Press the START/STOP knob on selected ESPRESSO size. The ON indicator will illuminate and brewing will begin. Once fully dispensed, one short beep will sound.



USING STEAM WAND FOR FROTHING MILK

1. Fill a mug or frothing pitcher with milk of your choice. For best results, use a range of 4–8 ounces for your drink recipe to avoid overflow when frothing.



2. Turn the START/STOP knob clockwise to select the STEAM function. Purge the steam wand of any water: with the steam wand positioned over the drip tray, activate the steam function by pressing START/STOP knob to start steam process. Swing the steam wand back to the side of the unit. To end the purging, press START/STOP.



3. Place the mug or frothing pitcher under the hot water/steam wand. Place the steam wand in the milk so that the nozzle is just below the surface of the milk.



4. Press the START/STOP knob to start the steaming feature. The ON indicator will illuminate, signifying steam process has started. Once the milk begins to steam, bring the nozzle closer to the top of the milk to begin frothing.



5. As the steam heats and textures the milk, the level of the milk in the pitcher will begin to rise. As this happens, follow the level of the milk by lowering the pitcher, always keeping the tip of the steam nozzle just below the surface. **NOTE:** Do not allow the steam to spurt unevenly, or it will create aerated froth/large bubbles. If this is happening, raise the pitcher so that the steam nozzle is lowered farther into the milk.



6. Stop the STEAM function by pressing the START/STOP knob. Remove the pitcher, immediately wipe the steam nozzle and wand with a clean damp cloth, and purge a small amount of steam.



USING STEAM WAND FOR HOT WATER

1. Add water to the 72-ounce water reservoir if ADD WATER indicator is on.

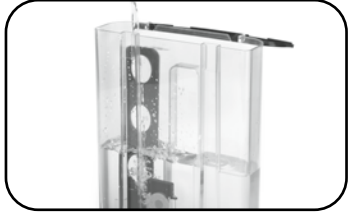

2. Place a cup or container under the hot water/steam wand.



3. Turn the START/STOP knob clockwise to select HOT WATER, and press the START/STOP knob to start hot water. The ON indicator will illuminate.



4. When desired amount of water is dispensed, press the START/STOP knob to stop the HOT WATER function. The HOT WATER indicator will remain illuminated and the ON indicator will turn off.

