



# QUICK SETUP GUIDE

## RF-WRSK18 / RF-WRSK18-C, Wireless Rear Speaker Kit

### PACKAGE CONTENTS

- Wireless sender
- Wireless receiver
- 2-foot speaker wires (2)
- 5V DC Power adapter (wireless sender)
- 18V DC Power adapter (wireless receiver)
- *Quick Setup Guide*

### FEATURES

- 2.4 GHz wireless sender and wireless receiver
- Transmits high quality audio over a radio frequency communication link
- Compact size
- Hidden antennas
- Low power consumption

#### Wireless sender

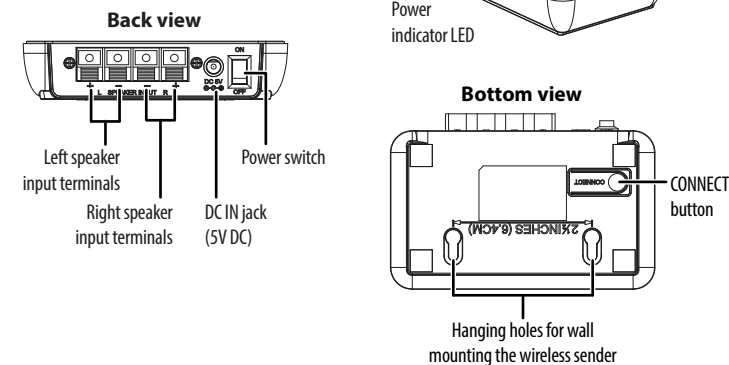

Before using your new product, please read these instructions to prevent any damage.

#### Wireless receiver

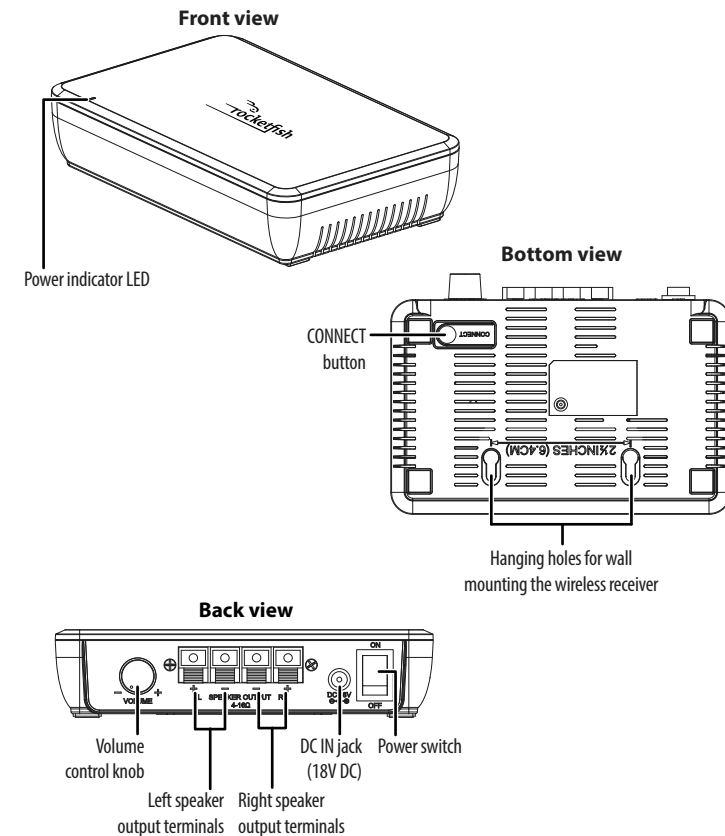

### SETTING UP YOUR WIRELESS REAR SPEAKER KIT

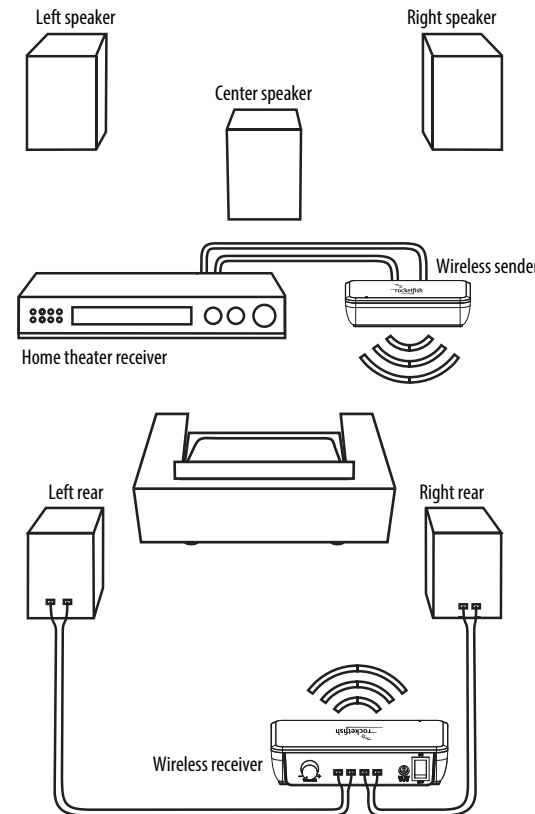

### CONNECTING THE WIRELESS SENDER TO YOUR HOME THEATER RECEIVER

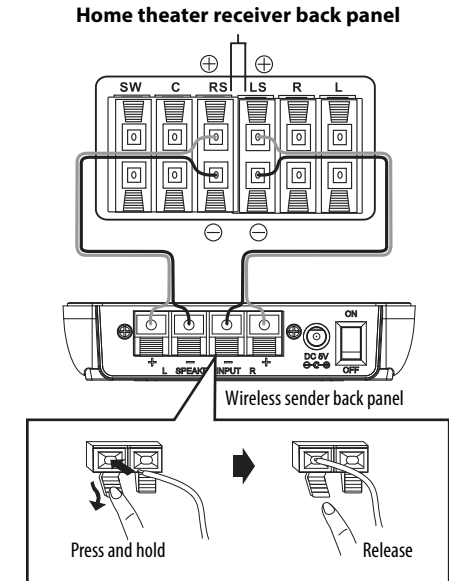

**Caution:** Turn off your home theater receiver while connecting the speaker kit.

- 1 Using the included two-foot speaker cords, connect the right rear speaker terminals of your home theater receiver to the right speaker terminals of the wireless sender by connecting the red wire to the red (+) terminals, and the black wire to the black (-) terminals.
- 2 Connect the left rear speaker terminals of the home theater receiver the same way.

### CONNECTING THE WIRELESS RECEIVER TO YOUR REAR SPEAKERS

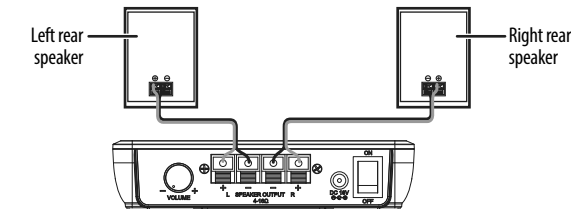

- 1 Connect the right speaker to the right speaker terminals of the wireless receiver, and the left speaker to the left speaker terminals.
- 2 If the speaker wires are attached to the speakers already, connect the positive (+) wire from the right speaker to the red (+) terminal for the right speaker on the wireless receiver and the negative (-) wire from the right speaker to the black (-) terminal for the right speaker on the wireless receiver.
- 3 Connect the left speaker the same way.

CONNECTING THE WIRELESS SENDER AND WIRELESS RECEIVER TO A POWER OUTLET

To connect the wireless sender to the power adapter:

- 1 Plug the DC power cord from the 5V DC power adapter into the DC 5V jack on the wireless sender.
- 2 Plug the 5V DC power adapter into a power outlet.

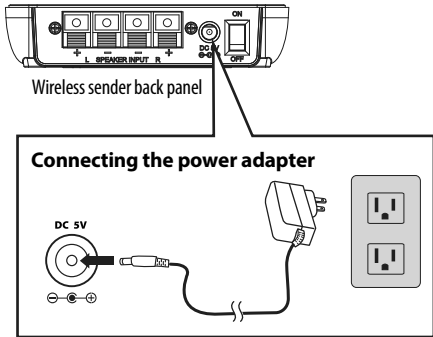

**Caution:** To avoid risk of fire, and to prevent damage, only use the power adapters supplied with your wireless rear speaker kit.

To connect the wireless receiver to a power outlet:

**Note:** Plug the power cord in only after all speakers are connected to the wireless receiver.

- 1 Plug the small (female) end of the power cord into the AC input of the 18V DC power adapter.
- 2 Plug the DC power cord from the power adapter into the DC 18V jack on the wireless receiver.
- 3 Plug the large (male) end of the power cord into a power outlet.

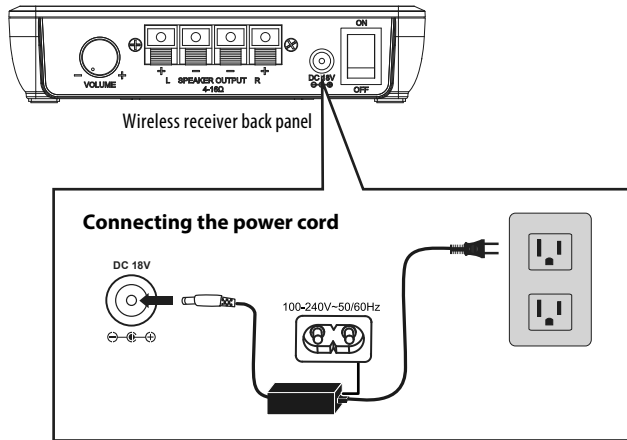

USING YOUR UNIVERSAL WIRELESS REAR SPEAKER KIT

To turn on the system:

- Turn on the power switch on the back panel of both the wireless sender and wireless receiver. The LED indicator blinks to indicate that the devices are plugged in.

Establishing communications between the wireless sender and wireless receiver

- If the front panel LEDs light solid on both units, a link has been established. If the front panel LEDs are blinking on one or both units, do the following:

- 1 Press and hold the CONNECT button on either the wireless sender or wireless receiver for two seconds to enter connection mode. (While in “connection mode,” the LED indicators blink at a faster rate.)
- 2 Within 30 seconds, press the CONNECT button on the other unit so it will enter connection mode. A link will be established automatically and the LED indicators will light solid.

**Note:** If the LED indicators keep blinking after 30 seconds, try pressing the CONNECT buttons again.

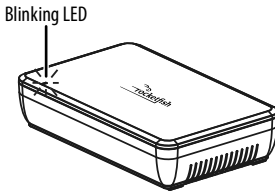
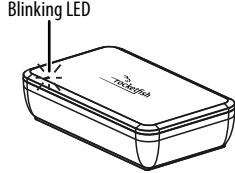

TROUBLESHOOTING

PROBLEM	SOLUTION
<b>No sound</b>	<ul style="list-style-type: none"><li>• Check to see if the LEDs illuminate on the front of both the wireless sender and wireless receiver units. If the LEDs are lit solidly, the communication is working correctly and all speaker wires and the home theater receiver operation should be checked. If the LEDs are flashing, refer to the “Establishing communications between the wireless sender and wireless receiver” section.</li><li>• Make sure that the speaker wire connections are correct and secure.</li><li>• Make sure that the wireless sender and wireless receiver are both connected to a working power outlet.</li><li>• Make sure that the home theater receiver is turned on.</li><li>• Make sure that the correct input is selected on your home theater receiver.</li><li>• Turn up the volume on the home theater receiver.</li><li>• Depending on what you are listening to, audio may not always play from the rear speakers.</li></ul>
<b>Sound interference</b>	<ul style="list-style-type: none"><li>• Move the wireless sender and wireless receiver slowly to find the best reception position for your system.</li><li>• Shorten the distance between your wireless sender and wireless receiver. The maximum distance is 100 feet.</li><li>• Other devices, such as cordless phones or microwaves, may cause interference with the wireless sender and wireless receiver. Try turning off one device at a time to determine which device is causing interference. Make sure that the wireless sender is more than 18 inches away from any Wi-Fi routers.</li></ul>

LEGAL NOTICES

FCC Statement

This device complies with Part 15 of the FCC Rules. Operation is subject to the following two conditions: (1) this device may not cause harmful interference, and (2) this device must accept any interference received, including interference that may cause undesired operation.

This equipment has been tested and found to comply with the limits for a Class B digital device, pursuant to Part 15 of the FCC Rules. These limits are designed to provide reasonable protection against harmful interference in a residential installation. This equipment generates, uses, and can radiate radio frequency energy and, if not installed and used in accordance with the instructions, may cause harmful interference to radio communications. However, there is no guarantee that interference will not occur in a particular installation. If this equipment does cause harmful interference to radio or television reception, which can be determined by turning the equipment off and on, the user is encouraged to try to correct the interference by one or more of the following measures.

- Reorient or relocate the receiving antenna.
- Increase the separation between the equipment and receiver.
- Connect the equipment into an outlet on a circuit different from that to which the receiver is connected.
- Consult the dealer or an experienced radio/TV technician for help.

**Warning:** Changes or modifications not expressly approved by the party responsible for compliance could void the user’s authority to operate the equipment.

IC Statement

The device can be used in portable exposure condition without restriction.

Le dispositif peut être utilisé dans des conditions d’exposition portatives sans restriction.

ONE-YEAR LIMITED WARRANTY

Visit [www.rocketfishproducts.com](http://www.rocketfishproducts.com) for details.

CONTACT ROCKETFISH:

For customer service please call 1-800-620-2790

[www.rocketfishproducts.com](http://www.rocketfishproducts.com)

ROCKETFISH is a trademark of Best Buy and its affiliated companies.  
Distributed by Best Buy Purchasing, LLC  
7601 Penn Ave South, Richfield, MN 55423 U.S.A.  
©2022 Best Buy. All rights reserved.

LISTENING TO THE SYSTEM

- 1 Turn on the system. Make sure that there is an active link between the wireless sender and wireless receiver.
- 2 Turn on your home theater receiver, then play the audio or video source through your home theater receiver.

The volume control on the wireless receiver is only used to adjust the balance of the volume between the front and rear speakers. After the system is set up, we recommend that you adjust the volume balance one time.