

# MEDIAONE M30

Powered Studio Monitors



OWNER'S MANUAL

---

**SAMSON®**

# Important Safety Information



AVIS  
RISQUE DE CHOC ÉLECTRONIQUE -  
NE PAS OUVRIR



This lightning flash with arrowhead symbol within an equilateral triangle is intended to alert the user to the presence of non-insulated "dangerous voltage" within the product's enclosure that may be of sufficient magnitude to constitute a risk of electric shock.



The exclamation point within an equilateral triangle is intended to alert the user to the presence of important operating and maintenance instructions in the literature accompanying the appliance.

To reduce the risk of electric shock, do not remove cover (or back) as there are no user-serviceable parts inside. Refer to servicing to qualified service personnel.

## FCC Notice

1. This device complies with Part 15 of the FCC Rules. Operation is subject to the following two conditions:
  - (1) This device may not cause harmful interference.
  - (2) This device must accept any interference received, including interference that may cause undesired operation.
2. Changes or modifications not expressly approved by the party responsible for compliance could void the user's authority to operate the equipment.



If you want to dispose this product, do not mix it with general household waste. There is a separate collection system for used electronic products in accordance with legislation that requires proper treatment, recovery and recycling.

Private household in the 28 member states of the EU, in Switzerland and Norway may return their used electronic products free of charge to designated collection facilities or to a retailer (if you purchase a similar new one).

For Countries not mentioned above, please contact your local authorities for a correct method of disposal.

By doing so you will ensure that your disposed product undergoes the necessary treatment, recovery and recycling and thus prevent potential negative effects on the environment and human health.

## Important Safety Information

1. Read these instructions.
2. Keep these instructions.
3. Heed all warnings.
4. Follow all instructions.
5. Do not use this apparatus near water.
6. Clean only with dry cloth.
7. Do not block any ventilation openings. Install in accordance with the manufacturer's instructions.
8. Do not install near any heat sources such as radiators, heat registers, stoves, or other apparatus (including amplifiers) that produce heat.
9. Do not defeat the safety purpose of the polarized or grounding type plug. A polarized plug has two blades with one wider than the other. A grounding type plug has two blades and a third grounding prong. The wide blade or the third prong are provided for your safety. If the provided plug does not fit into your outlet, consult an electrician for replacement of the obsolete outlet.
10. Protect the power cord from being walked on or pinched particularly at the plugs, convenience receptacles, and at the point where they exit from the apparatus.
11. Only use attachments/accessories specified by the manufacturer.
12. Use only with the cart, stand, tripod, bracket, or table specified by the manufacturer, or sold with the apparatus. When a cart is used, use caution when moving the cart/apparatus combination to avoid injury from tip-over.
13. Unplug the apparatus during lightning storms or when unused for long periods of time.
14. Refer all servicing to qualified personnel. Servicing is required when the apparatus has been damaged in any way, such as power supply cord or plug is damaged, liquid has been spilled or objects have fallen into the apparatus has been exposed to rain or moisture, does not operate normally, or has been dropped.
15. The apparatus shall not be exposed to dripping or splashing and that objects filled with liquids, such as vases, shall not be placed on apparatus.
16. Caution-to prevent electric shock, match wide blade plug wide slot fully insert.
17. Please keep a good ventilation environment around the entire unit.
18. **WARNING:** The mains plug/appliance coupler is used as disconnect device, the disconnect device shall remain readily operable.
19.  This equipment is a Class II or double insulated electrical appliance. It has been designed in such a way that it does not require a safety connection to electrical earth.
20. No naked flame sources, such as lighted candles, should be placed on the apparatus.



## Introduction

Thank you for purchasing the MediaOne M30 Powered Studio Monitors from Samson. Whether you are in need of a monitor system for your recording studio, video production suite, or if you just want better speakers for gaming and listening to music on your computer, MediaOne M30 speakers are the perfect solution. The monitor system produces a powerful, full-range sound thanks to the internal amplifier, extended range 3" copolymer woofers, and 3/4" silk dome tweeters. Plus, the MediaOne system delivers deep bass and extended highs in an amazingly compact size.

The MediaOne M30 system includes one powered monitor for the right-side and a passive monitor for the left-side. For easy integration the speakers feature rear panel RCA inputs and 1/8" Stereo / Sub output for extending your system. For listening privacy, the speakers will mute when a pair of headphones are connected.

In the box, you'll find a registration card enclosed—please don't forget to follow the instructions so that you can receive online technical support and so we can send you updated information about this and other Samson products in the future. We recommend you keep the following records for reference, as well as a copy of your sales receipt.

Serial number: \_\_\_\_\_

Date of purchase: \_\_\_\_\_

Dealer name: \_\_\_\_\_

If you have any questions or comments regarding the MediaOne M30 Powered Studio Monitors or any other products from Samson, do not hesitate to contact us at **support@samsontech.com**.

With proper care and maintenance, your MediaOne M30 will operate trouble-free for many years. Should your MediaOne M30 ever require servicing, a Return Authorization (RA) number must be obtained before shipping your unit to Samson. Without this number, the unit will not be accepted. Please visit **[www.samsontech.com/ra](http://www.samsontech.com/ra)** for an RA number prior to shipping your unit. Please retain the original packing materials and, if possible, return the unit in its original carton. If your MediaOne M30 was purchased outside of the United States, contact your local distributor for warranty details and service information.

## Features

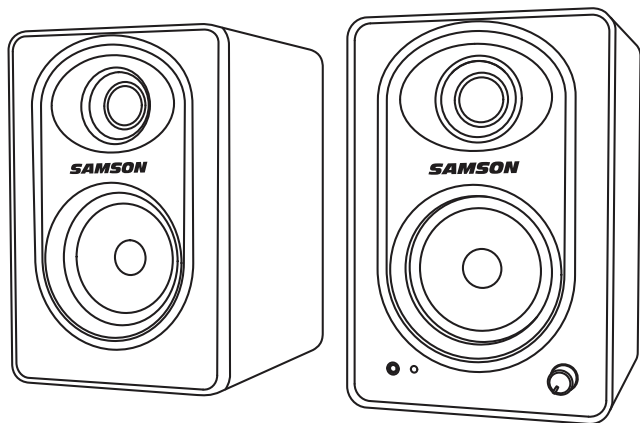

- Ported, tuned enclosures providing extremely accurate monitoring for desktop recording, playback and multi-media applications.
- 3" Copolymer woofers with butyl surrounds
- 1" silk dome high frequency driver set in a custom-designed wave guide.
- Front panel volume control
- Front panel stereo 3.5mm headphone jack mutes speaker
- Rear panel RCA inputs accept -10 dBV line level input
- 3.5mm stereo subwoofer output
- Solid MDF (Medium Density Fiberboard) construction

## Quick Start

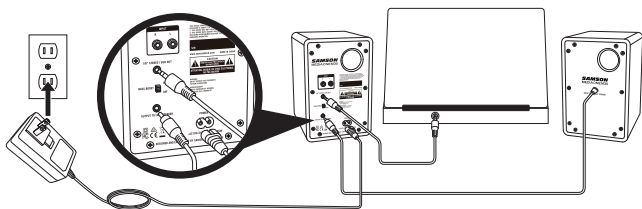

The MediaOne M30 main input connections can be made via the rear panel RCA inputs. Follow the simple steps and diagram below for connecting an audio source to the speakers.

1. Connect the left and right speakers using the included two-conductor, 3.5mm speaker cable.
2. Turn the MediaOne M30 Volume control completely counter-clockwise until it clicks to the minimum/off setting.
3. Connect the MediaOne M30 to an AC power outlet using the included power cable.
4. Connect the audio output from your audio source such as a computer or portable audio device to the RCA inputs of the MediaOne M30 right side speaker.
5. Turn the Volume control clockwise until it clicks to turn the MediaOne M30 speakers on. The front panel Power Indicator will light white.
6. Play music from your audio source and slowly raise the volume of the MediaOne M30 to a comfortable listening level.

*Note: Before plugging in and turning on, remember the “last on, first off” rule of powered speakers. When powering up your system, be sure that all the wires are connected, turn your mixer and any other outboard gear on, and then last turn on your MediaOne M30. When powering down, turn your MediaOne M30 off first and then your mixer and outboard gear.*

## Adding an Active Subwoofer

Adding a subwoofer to extend the low frequency response of your monitor system can be beneficial when mixing your music. Typically, it is best to set the subwoofer level to be equal to that of the main speakers. Because deep-bass frequencies are non-directional, it is difficult for our ears to locate the sound source, and the precise placement of the subwoofer is not as critical as the main speakers. The ideal location is between the two main speakers. If you notice there are frequencies that sound quieter than others, move the subwoofer slightly to the left or right.

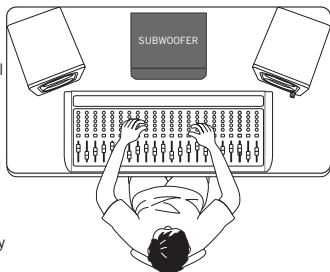

To add a powered subwoofer to your MediaOne M30 speakers to create a 2.1 system:

- Connect your audio source to the left and right RCA Inputs of the MediaOne M30.
- Connect the MediaOne M30 1/8" STEREO / SUB Output to the left and right line inputs of your active subwoofer.
- Play music from your audio source.
- Turn up your MediaOne M30 to your desired listening level.
- Turn up the level of the subwoofer to desired level.

*Note: The MediaOne M30 front panel Volume control will control the level of the entire system.*

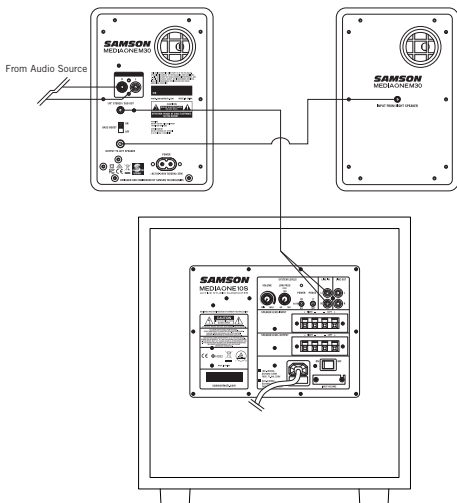

## MediaOne M30 Layout

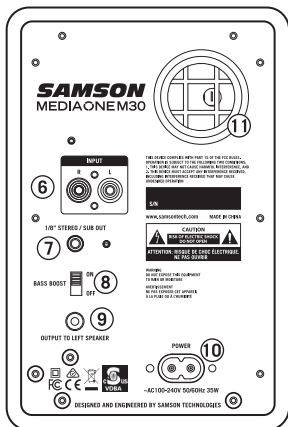
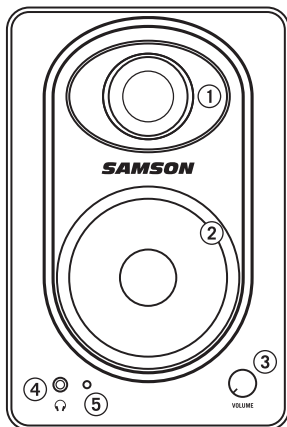

### Powered Speaker (right speaker)

- 1. Tweeter** - 1" silk dome tweeter set in a custom waveguide
- 2. Low Frequency Driver** - Heavy duty 3" woofer with a polypropylene cone and butyl surround for extend low frequency response
- 3. Power / VOLUME (active)** - This rotary knob controls the overall amount of the output level. Turn the control clockwise to turn the system on. Turn the knob counterclockwise until it clicks to turn the system off.
- 4. Headphone Jack** - 3.5mm stereo output jack for connecting headphones. The monitors automatically mute when headphones are connected
- 5. Power Indicator (active)** - LED lights white indicating the unit is powered on.
- 6. AUDIO INPUT** - Unbalanced, Stereo RCA-type input connectors, for connecting audio output from consumer level (-10dBV) devices such as a computer, MP3 player, or smartphone. The red connector is the for right input and the white is for the left input.
- 7. 1/8" STEREO / SUB OUT** - This 3.5mm jack outputs stereo full audio to connect to an external audio device or to an active subwoofer.
- 8. Bass Boost Switch** - This switch enables a bass boost to enhance the low-frequency response.



## MediaOne M30 Layout

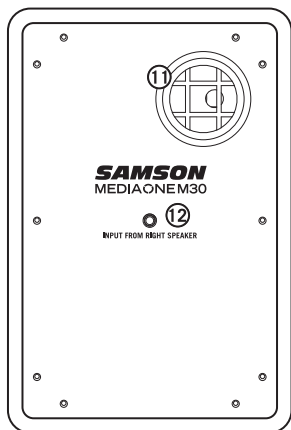

Passive Speaker (left speaker)

9. **TO LEFT SPEAKER** - 3.5mm jack for connecting the passive left-side extension speaker using the included two-conductor speaker cable.
10. **AC INLET** - Connect the supplied power cable here
11. **Bass Port** - Tuned low frequency bass port for extending the low end of the speaker cabinets. Do not block the ports as this will restrict the overall performance of the speakers.
12. **Speaker Connections** - 3.5mm jack for connecting the passive left-side extension speaker using the included two-conductor speaker cable.

## Positioning the Speakers

A major objective when setting up your studio monitors is to obtain the best possible stereo image. The MediaOne M30 monitors are designed to be used in a vertical position, with the tweeter and woofer symmetrically in line. Do not place these speakers horizontally as this will cause an offset in sound between the woofer and the tweeter, limiting your ability to find optimal listening positions.

Near field (close to the listener) monitoring has become the choice of many engineers because of the cost and complexities associated with mounting monitors onto a wall. Positioning your studio monitors correctly is very important. Correct placement not only creates the proper stereo image, but also minimizes the effects of your room's reflections. This is especially important in today's project studios, which are often multi-use spaces. By taking some time and listening carefully when setting up your monitors, you can create an optimal listening environment.

The most important consideration when evaluating room acoustics is the presence of reflective surfaces near the monitoring area. These can include flat tabletops, glass mirrors or framed pictures, large open walls and even the surface of your mixing console. Most reflecting sound will eventually reach the listening position, but since it is slightly delayed from the direct source, the result is random cancellation of some frequencies, or comb filtering. If possible, remove any and all reflective surfaces. You may also want to hang some acoustic foam on walls near the monitors.

When positioning the monitors, you'll want to set up what is commonly referred to as the "mix triangle" (shown below). In this ideal configuration, the space between the left and right monitor is equal to the distance from the listener to each monitor, forming an equilateral triangle.

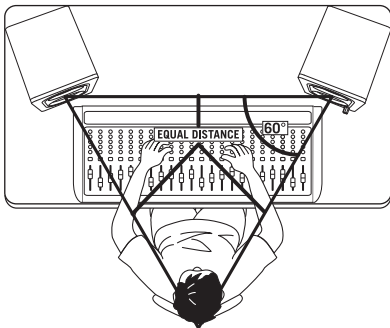

## Specifications

<b>Low Frequency Speakers</b>	3" (76.2mm) woofer, polypropylene cone with butyl surround
<b>High Frequency Speakers</b>	3/4" silk dome tweeter
<b>Frequency response</b>	50Hz - 20kHz (-2dB)
<b>Amplifier Power Rating</b>	2 x 10 watts (RMS)
<b>Distortion (T.H.D.)</b>	<0.1%
<b>Signal-To-Noise</b>	83dB
<b>Inputs Connectors</b>	RCA (rear panel)
<b>Headphone</b>	1/8" (3.5mm) Stereo Output
<b>Subwoofer Output</b>	1/8" (3.5mm)
<b>Controls</b>	Power / Volume Knob, Bass Boost Switch
<b>Indicators</b>	White (Power)
<b>Enclosure</b>	MDF with textured vinyl covering
<b>Dimensions (LxWxH)</b>	5" x 5.78" x 7.48" 127mm x 147mm x 190mm
<b>Weight</b>	6.5 lb 2.95 kg

*At Samson, we are continually improving our products, therefore specifications and images are subject to change without notice.*

Samson Technologies Corp.  
278-B Duffy Ave  
Hicksville, New York 11801  
Phone: 1-800-3-SAMSON (1-800-372-6766)  
[www.samsontech.com](http://www.samsontech.com)