

INSIGNIA™

## USER GUIDE

# 2.2 Cu. Ft. Countertop Microwave

**NS-MW22SS6/NS-MW22SS6-C**



Before using your new product, please read these instructions to prevent any damage.

## Contents

SAFETY INFORMATION .....	3
GROUNDING INSTRUCTIONS .....	5
RADIO INTERFERENCE .....	6
Cookware and cooking materials .....	6
Materials you can use .....	7
Materials to be avoided .....	7
Package contents .....	8
Unpacking your microwave .....	8
Features .....	8
Microwave .....	9
Control panel .....	10
Setting up your microwave .....	12
Installing the glass turntable .....	12
Setting the clock and the timer .....	13
Setting the clock .....	13
Using the kitchen timer .....	14
Cooking with your microwave .....	14
Microwave cooking .....	14
Cooking quickly .....	14
Cooking with the auto menus .....	15
Melting and softening food .....	16
Using a memorized procedure .....	17
Multi-stage cooking .....	18
Muting the sound .....	18
Using power saving mode .....	18
Defrosting in your microwave .....	19
Defrosting by time .....	19
Defrosting by weight .....	19
Changing other microwave settings .....	19
Using the child-lock .....	19
Checking the time and power level while cooking .....	19
Cleaning and maintaining your microwave .....	20
Cleaning the outside of your microwave .....	20
Cleaning the inside of your microwave .....	20
Troubleshooting .....	21
Obtaining replacement parts .....	21
Specifications .....	22
ONE-YEAR LIMITED WARRANTY .....	23
For Québec Customers Only .....	25

# SAFETY INFORMATION

## PRECAUTIONS TO AVOID POSSIBLE EXPOSURE TO EXCESSIVE MICROWAVE ENERGY:

- 1 Do not attempt to operate this microwave with the door open because this can result in harmful exposure to microwave energy. It is important not to defeat or tamper with the safety interlocks.
- 2 Do not place any object between the microwave front face and the door or allow soil or cleaner residue to accumulate on sealing surfaces.
- 3 Do not operate the microwave if it is damaged. It is particularly important that the microwave door closes properly and that there is no damage to the:
  - (a) DOOR (bent)
  - (b) HINGES and LATCHES (broken or loosened)
  - (c) DOOR SEALS and SEALING SURFACES
- 4 The microwave should not be adjusted or repaired by anyone except properly qualified service personnel.

## IMPORTANT SAFETY INSTRUCTIONS

When using electrical appliances basic safety precautions should be followed, including the following:

**WARNING:** To reduce the risk of burns, electric shock, fire, injury to persons, or exposure to excessive microwave energy when using your microwave, follow these basic safety precautions.

- 1 Read all instructions before using the microwave.
- 2 Read and follow the specific: **PRECAUTIONS TO AVOID POSSIBLE EXPOSURE TO EXCESSIVE MICROWAVE ENERGY**: found on page 3.
- 3 This microwave must be grounded. Connect only to a properly grounded outlet. See **GROUNDING INSTRUCTIONS** found on page 5.
- 4 Install or locate this appliance only in accordance with the provided installation instructions.
- 5 Some products, such as whole eggs and sealed containers (for example closed glass jars), are able to explode and should not be heated in this microwave.
- 6 Use this microwave only for its intended purpose, as described in this manual. Do not use corrosive chemicals or vapors in this microwave. This microwave is specifically designed to heat, cook, or dry food. It is not designed for industrial or laboratory use.

- 7** HOT CONTENTS CAN CAUSE SEVERE BURNS. DO NOT ALLOW CHILDREN TO USE THE MICROWAVE. Use caution when removing hot items.
- 8** Do not operate this microwave if it has a damaged cord or plug, if it is not working properly, or if it has been damaged or dropped.
- 9** This microwave should be serviced only by qualified service technicians. Contact the nearest authorized service facility for examination, repair, or adjustment.
- 10** Do not cover or block any openings on the microwave.
- 11** Do not store or use this microwave outdoors. Do not use this microwave near water (for example, near a kitchen sink, in a wet basement, near a swimming pool, or similar locations).
- 12** Do not immerse the cord or plug in water.
- 13** Keep the cord away from heated surfaces.
- 14** Do not let the cord hang over the edge of a table or counter.
- 15** When cleaning the surfaces of the door and the microwave that come together on closing the door, use only mild, nonabrasive soaps or detergents applied with a sponge or soft cloth.
- 16** To reduce the risk of fire in the microwave cavity:
  - Do not overcook food. Carefully attend the microwave when paper, plastic, or other combustible materials are placed inside the microwave to facilitate cooking.
  - Remove wire twist-ties and metal handles from paper or plastic containers/bags before placing them in the microwave.
  - If materials inside the microwave ignite, keep the microwave door closed. Turn the microwave off and unplug the microwave or shut off power at the fuse or circuit breaker panel.
  - Do not use the microwave cavity for storage purposes. Do not leave paper products, cooking utensils, or food in the cavity when not in use.
- 17** Liquids, such as water, coffee, or tea can be overheated beyond the boiling point without appearing to be boiling. Visible bubbling or boiling when the container is removed from the microwave is not always present. **THIS COULD RESULT IN VERY HOT LIQUIDS SUDDENLY BOILING OVER WHEN THE CONTAINER IS DISTURBED OR A SPOON OR OTHER UTENSIL IS INSERTED INTO THE LIQUID.**

To reduce the risk of injury to persons:

  - Do not overheat the liquid.
  - Stir the liquid both before and halfway through heating it.
  - Do not use straight-sided containers with narrow necks.
  - After heating, allow the container to stand in the microwave for a short time before removing the container.
  - Use extreme care when inserting a spoon or other utensil into the container.

**SAVE THESE INSTRUCTIONS**  
**HOUSEHOLD USE ONLY**  
**(NOT FOR COMMERCIAL USE)**

# GROUNDING INSTRUCTIONS

This appliance must be grounded. In the event of an electrical short circuit, grounding reduces the risk of electric shock by providing an escape wire for the electric current. This appliance is equipped with a cord having a grounding wire with a grounding plug. The plug must be plugged into an outlet that is properly installed and grounded.

	<p><b>WARNING - Electric Shock Hazard</b></p> <p>Improper use of the grounding can result in a risk of electric shock. Consult a qualified electrician or serviceman if the grounding instructions are not completely understood, or if doubt exists as to whether the appliance is properly grounded. If it is necessary to use an extension cord, use only a 3-wire extension cord that has a 3-blade grounded plug, and 3-slot receptacle that will accept the plug on the appliance. The marked rating of the extension cord shall be equal to or greater than the electrical rating of the appliance.</p>
---	--

	<p><b>DANGER - Electric Shock Hazard</b></p> <p>Touching some of the internal components can cause serious personal injury. Do not disassemble this appliance.</p>
---	--

	<p><b>WARNING - Electric Shock Hazard</b></p> <p>Improper use of the grounding can result in a risk of electric shock. Do not plug into an outlet until the appliance is properly installed and grounded.</p>
---	---

- 1 A short power supply cord is provided to reduce the risks resulting from becoming entangled in or tripping over a longer cord.
- 2 Longer cord sets or extension cords are available and may be used if care is exercised in their use.
- 3 If a long cord or extension cord is used:
  - The marked electrical rating of the cord set or extension cord should be at least as great as the electrical rating of the appliance.
  - The extension cord must be a grounding-type 3-wire cord.
  - The longer cord should be arranged so that it will not drape over the counter top or tabletop where it can be pulled on by children or tripped over unintentionally.

# RADIO INTERFERENCE

- 1 Operation of the microwave may cause interference to your radio, TV, or similar equipment.
- 2 When there is interference, it may be reduced or eliminated by taking the following measures:
  - Clean the door and the sealing surface of the microwave.
  - Reorient the receiving antenna of the radio or television.
  - Relocate the microwave with respect to the receiver.
  - Move the microwave away from the receiver.
  - Plug the microwave into a different outlet so that the microwave and receiver are on different branch circuits.
- 3 This equipment generates, uses and can radiate radio frequency energy and, if not installed and used in accordance with the instructions, may cause harmful interference to radio communications. However, there is no guarantee that interference will not occur in a particular installation. If this equipment does cause harmful interference to radio or television reception, which can be determined by turning the equipment off and on, the user is encouraged to try to correct the interference by one or more of the following measures:
  - 1) Reorient or relocate the receiving antenna.
  - 2) Increase the separation between the equipment and receiver.
  - 3) Connect the equipment into an outlet on a circuit different from that to which the receiver is connected.
  - 4) Consult the dealer or an experienced radio/TV technician for help.

**This device complies with part 18 of the FCC Rules.**

## Cookware and cooking materials

### WARNING:

Personal Injury Hazard

Tightly-closed containers could explode. Closed containers should be opened and plastic pouches should be pierced before cooking.

Refer to the **Materials you can use** and **Materials to be avoided** tables below as a guide, then test before using.

There may be non-metallic utensils that are not safe to use for microwaving. If in doubt, you can test the utensil in question, following the procedure below.

### Utensils test

- 1 Fill a microwave-safe container with 1 cup (250 ml) of cold water, along with the utensil in question.
- 2 Cook on maximum power for one minute. **Do not exceed one minute cooking time.**
- 3 Carefully feel the utensil. If the empty utensil is warm, do not use it for microwave cooking.

## Materials you can use

MATERIAL	REMARKS
Browning dish	Follow the manufacturer's instructions. The bottom of the browning dish must be at least 3/16 in. (5 mm) above the turntable. Incorrect usage may cause the turntable to break.
Dinnerware	Use microwave-safe only. Follow the manufacturer's instructions. Do not use cracked or chipped dishes.
Glass jars	Always remove the lid. Use only to heat food until just warm. Most glass jars are not heat resistant and may break.
Glassware	Use heat-resistant oven glassware only. Make sure there is no metallic trim. Do not use cracked or chipped dishes.
Oven cooking bags	Follow the manufacturer's instructions. Do not close with a metal tie. Make slits to allow steam to escape.
Paper plates and cups	Use for short-term cooking/warming only. Do not leave the microwave unattended while cooking.
Paper towels	Use to cover food for reheating and absorbing fat. Use with supervision for short-term cooking only.
Parchment paper	Use as a cover to prevent splattering or a wrap for steaming.
Plastic	Use only if labeled "Microwave Safe." Follow the manufacturer's instructions. Some plastic containers soften as the food inside gets hot. "Boiling bags" and tightly closed plastic bags should be slit, pierced, or vented, as indicated on the package.
Plastic wrap	Use microwave-safe only. Use to cover food during cooking to retain moisture. Do not allow plastic wrap to touch food.
Thermometers	Use microwave-safe only (such as meat and candy thermometers).
Wax paper	Use as a cover to prevent splattering and retain moisture.

## Materials to be avoided

MATERIAL	REMARKS
Aluminum foil	May cause an electric spark. Use a microwave-safe dish instead.
Aluminum tray	May cause an electric spark. Use a microwave-safe dish instead.
Food carton with metal handle	May cause an electric spark. Use a microwave-safe dish instead.
Metal or metal trimmed utensils	Metal shields the food from microwave energy. The metal trim may cause arcing.
Metal twist ties	May cause an electric spark and could cause a fire in the microwave.
Paper bags	May cause a fire in the microwave.

MATERIAL	REMARKS
Plastic foam	Plastic foam may melt or contaminate the liquid inside when exposed to high temperature.
Wood	Wood will dry out when used in the microwave and may split or crack.

Package contents

- 2.2 Cu. Ft. Countertop Microwave
- Glass turntable
- Turntable ring
- *User Guide*

Unpacking your microwave

Remove your microwave and all materials from the box and microwave cavity. Your microwave comes with the following accessories:

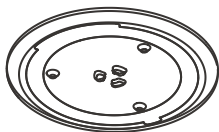

Glass turntable

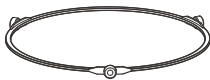

Turntable ring assembly

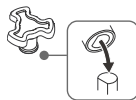

Turntable shaft



*User Guide*

Features

- Inverter technology uses a constant stream of power to provide even heating to your meals
- Spacious 2.2 cu. ft. design reheats all your favorite meals
- Sensor cook function heats your food to the ideal temperature every time
- 11 power levels help you cook or reheat meat, vegetables, pasta, and more
- 19 preset functions heat baked potatoes, pizza, and more
- Internal light lets you keep an eye on your meal’s progress
- 16.54 in. (42.01 cm) glass turntable helps distribute heat evenly
- Stainless steel finish looks modern and is easy to clean



Microwave

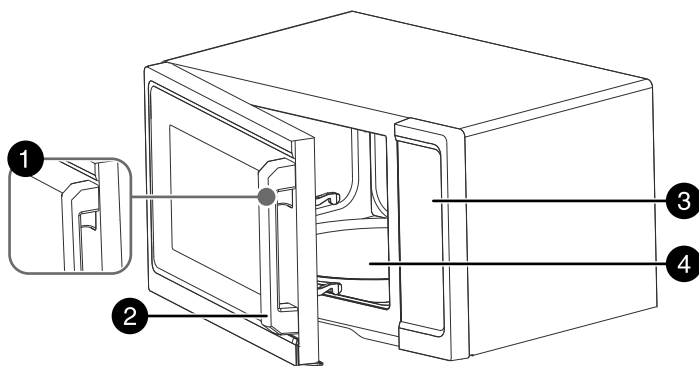

#	ITEM	DESCRIPTION
1	Door release button	Press to release the door, then pull the handle to open.
2	Door handle	Grip and pull to open the door, after pressing the door release button.
3	Control panel	Provides controls to set cooking times and enter other information as needed.
4	Glass turntable	Allows food to cook evenly.

Control panel

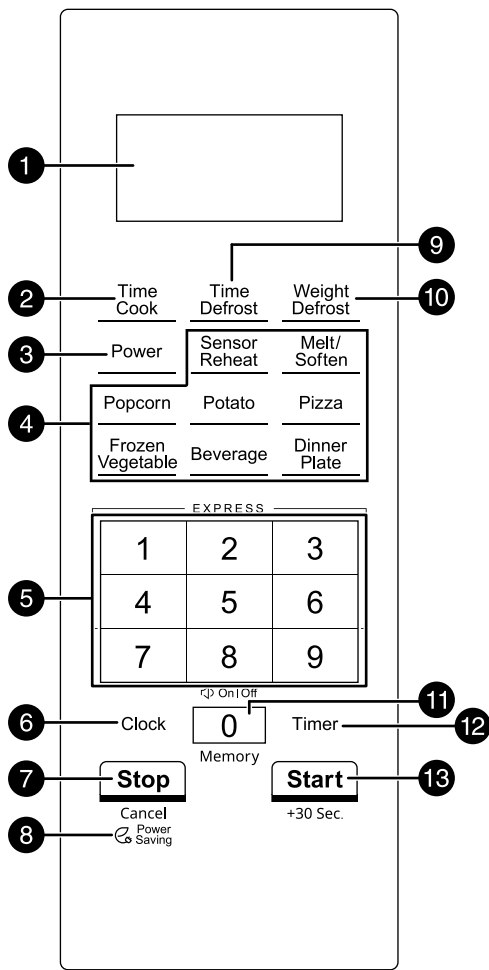

#	ITEM	DESCRIPTION
1	Display	In standby mode, shows the time. In cooking mode, shows cooking time, weight, and other information.
2	Time Cook	Press to set the amount of time you want to heat your food, then press the number buttons to enter the time you want (up to 99 minutes and 99 seconds).
3	Power	Press to set the power level of your microwave, then press the number buttons to set the level you want (PL0 [0%] - PL10 [100%]).

#	ITEM	DESCRIPTION
4	<b>Auto menu</b>	Press one of these buttons to cook the item indicated. See <a href="#">Cooking with the auto menus</a> on page 15.
5	Number pad/ <b>Express cook</b>	Press to enter cook time, defrost time, clock time, and other information. For express cooking, in standby mode press numbers one to six to quickly start cooking for one to six minutes. See <a href="#">Cooking quickly</a> on page 14.
6	<b>Clock</b>	Press to set or check the clock. See <a href="#">Setting the clock</a> on page 13.
7	<b>Stop/Cancel</b>	Press to stop the cooking process. Press again to cancel the cooking operation.
8	<b>Power Saving</b>	In standby mode, press <b>Stop/Cancel</b> to enter the power saving mode and turn off the display. Press again to cancel and turn the display back on.
9	<b>Time Defrost</b>	Press, then enter the time you want for an item to defrost. See <a href="#">Changing other microwave settings</a> on page 19.
10	<b>Weight Defrost</b>	Press, then enter the weight of the item you want to defrost. The cooking time is set automatically. See <a href="#">Defrosting by weight</a> on page 19.
11	<b>0/Memory</b>	Press repeatedly to choose one of three possible memorized procedures.
12	<b>Timer</b>	Press this button, then enter the time you want to count down. See <a href="#">Using the kitchen timer</a> on page 14.
13	<b>Start / +30 Sec.</b>	In standby mode, press this button to begin cooking. While cooking, press this button to add 30 seconds to cooking time.

## Setting up your microwave

- 1 Remove all packing material, protective film, and accessories. Do not remove the cream-colored plastic cover that is attached to the interior wall to protect the magnetron.
- 2 Check for any damage such as dents or a broken door. Do not use your microwave if it is damaged.
- 3 Select a level surface that provides enough open space for the vents.

### CAUTIONS:

- Do not install your microwave over a range cooktop or other heat-producing appliance. Installing over a heat source can damage your microwave and void your warranty.
- One side of your microwave must be unrestricted (open).
- Do not remove the feet from your microwave.
- Do not block intake or outlet openings.
- Place your microwave as far away from radios and TVs as possible, as it may cause interference.
- The accessible surface may be hot during operation.

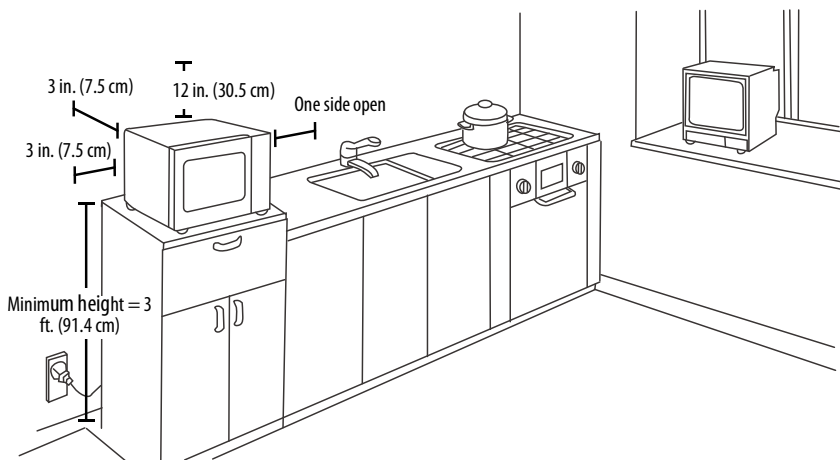

- 4 Plug your microwave into a power outlet.

## Installing the glass turntable

- 1 Remove all packing materials from your microwave, then remove the shipping tape from the turntable shaft.
- 2 Clean the cooking compartment and the accessories.
- 3 Place the turntable ring assembly into the round depression in the bottom of your microwave so that it turns freely.

- 4** Place the glass turntable (flat side up) on the turntable ring so that the hub engages the turntable shaft in the bottom of your microwave. The glass turntable should not turn freely when it is correctly installed.

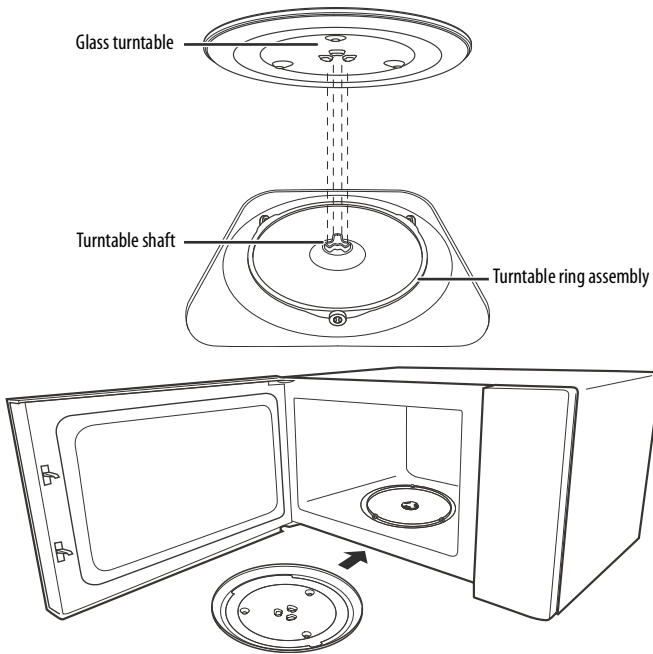

**Notes:**

- Never use your microwave without the glass turntable and turntable ring.
- Never place the glass turntable into your microwave upside down. The glass turntable should never be restricted.
- Both the glass turntable and turntable ring assembly must always be used during cooking.
- Always place all food and containers of food on the glass turntable for cooking.
- Do not restrict the movement of the glass turntable.
- If the glass turntable or turntable ring cracks or breaks, contact your nearest authorized service center.

## Setting the clock and the timer

### Setting the clock

- 1** Plug in your microwave. "12:00" appears on the display.
- 2** Press the number keys to enter the current time. For example, if the current time is 12:10, press **1**, **2**, **1**, and **0** using the number keys.

- 3 Press **Clock** to confirm the setting. The clock is set.

**Notes:**

- While setting the clock, if you press **Stop/Cancel** or if you don't press a button within 30 seconds, your microwave goes back to its last setting.
- The clock display is a 12 hour clock. If the numbers entered are not within the range of 1:00 to 12:59, they are invalid and the clock will not be reset.

**Using the kitchen timer**

- 1 Press **Timer** once. "00:00" appears on the display.
- 2 Press the number keys to enter the time you want (the maximum time is 99 minutes and 99 seconds).
- 3 Press **Start/+30 Sec.** to confirm the setting. The timer begins counting down. When the time reaches 0, the display shows the current time.

**Cooking with your microwave****Microwave cooking**

- 1 Press **Time Cook** once. "00:00" appears on the display.
- 2 Press the number keys to enter the cooking time you want (the maximum cooking time is 99 minutes and 99 seconds). For example, press **1, 5, 0, 0** to cook for 15 minutes.
- 3 Press **Power** once. The display shows "PL10" (the default power is 100%).

LEVEL	10	9	8	7	6	5	4	3	2	1	0
Power	100%	90%	80%	70%	60%	50%	40%	30%	20%	10%	0%
Display	PL10	PL9	PL8	PL7	PL6	PL5	PL4	PL3	PL2	PL1	PL0

- 4 Press the number keys to adjust the power level. For example, press **5** to set the power level to 50%.
- 5 Press **Start/+30 Sec.** to start cooking. Your microwave beeps when it is finished.

**Notes:**

- When setting the microwave, if the **Stop/Cancel** button is pressed or if there is no operation within 30 seconds, the microwave goes back to the previous setting automatically.
- If "PL0" is selected, the fan turns on with 0% power. You can use this level to remove an odor in the microwave.
- When setting the microwave, press **Power** at any time to change the power setting to any setting you want. The microwave cooks at the new power setting for the remainder of the cook time.
- Open the door or press **Stop** at any time to interrupt the current mode.

**Cooking quickly**

- In standby mode, with the microwave door closed, you can instantly cook something at 100% power by pressing any number from **1** to **6** (to cook from 1 to 6 minutes). Cooking begins immediately.  
OR

- In standby mode, with the microwave door closed, you can press **Start/+30 Sec.** to cook at 100% power for 30 seconds. You can increase the cooking time in 30 second increments by repeatedly pressing **Start/+30 Sec.** The maximum cooking time is 99 minutes and 99 seconds.

## Cooking with the auto menus

### Auto menus

BUTTON	AMOUNT	DISPLAY
<b>Popcorn</b>	3.0 oz.	3.0
	3.5 oz.	3.5
	1.75 oz.	1.75
<b>Beverage</b>	1 cup (120 ml)	1
	2 cups (240 ml)	2
	3 cups (360 ml)	3

BUTTON	RECOMMENDED AMOUNT	DISPLAY
<b>Sensor Reheat</b>	8 oz. - 32 oz.	SC-1
<b>Pizza</b>	6 oz. - 12 oz.	SC-2
<b>Potato</b>	1 (about 8 oz.) - 4 (about 32 oz.)	SC-3
<b>Frozen Vegetable</b>	4 oz. - 16 oz.	SC-4
<b>Dinner Plate</b>	8 oz. - 32 oz.	SC-5

### Cooking popcorn

- 1 Press **Popcorn** repeatedly until the weight of popcorn you want shows on the display. The display cycles through 3.0, 3.5, and 1.75 (oz.).

Press **Start/+30 Sec.** to begin cooking. The buzzer sounds once. When the popcorn is done popping, there will be a beep and "End" will appear on the display. If the door is not opened or the **Stop/Cancel** button is not pressed within nine minutes, your microwave will sound two beeps every three minutes. After nine minutes, your microwave will return to standby mode.

### Heating beverages

- 1 Press **Beverage** repeatedly until the number of cups you want to heat shows on the display. The display cycles through 1, 2, 3 cups (one cup is approximately 4 oz. [120 ml]).
- 2 Press **Start/+30 Sec.** to begin heating. The buzzer sounds once. When the food is cooked, there will be a beep and "End" will appear on the display. If the door is not opened or the **Stop/Cancel** button is not pressed within nine minutes, your microwave will sound two beeps every three minutes. After nine minutes, your microwave will return to standby mode.

**Using Sensor Reheat**

- 1 Press **Sensor Reheat**
- 2 Press **Start/+30 Sec.** to begin cooking. The buzzer sounds once. When the food is cooked, there will be a beep and "End" will appear on the display. If the door is not opened or the **Stop/Cancel** button is not pressed within nine minutes, your microwave will sound two beeps every three minutes. After nine minutes, your microwave will return to standby mode.

**Heating pizza**

- 1 Press **Pizza**
- 2 Press **Start/+30 Sec.** to begin cooking. The buzzer sounds once. When the food is cooked, there will be a beep and "End" will appear on the display. If the door is not opened or the **Stop/Cancel** button is not pressed within nine minutes, your microwave will sound two beeps every three minutes. After nine minutes, your microwave will return to standby mode.

**Cooking potatoes**

- 1 Press **Potato**
- 2 Press **Start/+30 Sec.** to begin cooking. The buzzer sounds once. When the food is cooked, there will be a beep and "End" will appear on the display. If the door is not opened or the **Stop/Cancel** button is not pressed within nine minutes, your microwave will sound two beeps every three minutes. After nine minutes, your microwave will return to standby mode.

**Cooking frozen vegetables**

- 1 Press **Frozen Vegetable**
- 2 Press **Start/+30 Sec.** to begin cooking. The buzzer sounds once. When the food is cooked, there will be a beep and "End" will appear on the display. If the door is not opened or the **Stop/Cancel** button is not pressed within nine minutes, your microwave will sound two beeps every three minutes. After nine minutes, your microwave will return to standby mode.

**Heating a dinner plate**

**Note:** The steps below are based on food having an initial starting temperature of 41° F (5° C) to heat on a dinner plate. Remember that foods should be thoroughly thawed before attempting to heat on a plate.

- 1 Press **Dinner Plate**
- 2 Press **Start/+30 Sec.** to begin heating. The buzzer sounds once. When the food is heated, there will be a beep and "End" will appear on the display. If the door is not opened or the **Stop/Cancel** button is not pressed within nine minutes, your microwave will sound two beeps every three minutes. After nine minutes, your microwave will return to standby mode.

**Melting and softening food**

- 1 Press **Melt/Soften** once. The display shows "S-1".
- 2 Press **Melt/Soften** repeatedly until the melt/soften program you want is displayed. Program options include S-1 through S-7. See the Melt/Soften table to determine the program you need.
- 3 Press **Start/+30 Sec.** to confirm.



- 4 Press **Melt/Soften** repeatedly to select the weight of the food you want to melt or soften. Options vary, based on the program selected.
- 5 Press **Stop/Cancel** to begin the process.

### Melt/Soften menu

FOOD	DISPLAY	RANGE	POWER
<b>Butter/ Margarine (melt)</b>	S-1	1 stick (4 oz.) 2 sticks (8 oz.) 3 sticks (12 oz.)	PL8
<b>Chocolate (melt)</b>	S-2	4 oz. 8 oz.	PL5
<b>Cheese (melt)</b>	S-3	8 oz. 16 oz.	PL5
<b>Marshmallows (melt)</b>	S-4	5 oz. 10 oz.	PL10
<b>Butter (soften)</b>	S-5	1 stick (4 oz.) 2 sticks (8 oz.) 3 sticks (12 oz.)	PL2
<b>Ice Cream/ Frozen Juice (soften)</b>	S-6	6 oz. 12 oz. 16 oz.	PL10
<b>Cream Cheese (soften)</b>	S-7	3 oz. 8 oz.	PL3

### Using a memorized procedure

You can set up to three memory settings for frequently used cook times and power levels. The settings remain in memory as long as your microwave has power.

#### To memorize a procedure:

The following procedure represents an EXAMPLE of how to set memory #2 to cook something for 3 minutes and 20 seconds at 80% power.

- 1 Press **0/Memory** twice, until the display shows "2" (for memory #2).
- 2 Press **Time Cook** once, then press **3, 2,** and **0** (for 3:20).
- 3 Press **Power** once. When "PL10" appears on the display, press **8**. The display shows "PL8" (for 80% power).
- 4 Press **Start/+30 Sec.** to save the setting in memory. The buzzer sounds once, the display shows "2", then the microwave returns to standby mode. If you press **Start/+30 Sec.** again, the procedure will be saved as memory #2 and cooking begins.

#### Notes:

- The procedure is saved until the power is cut off.
- Auto menu and express cooking cannot be saved to memory.

**To use a memorized procedure:**

- 1 Put the item to be cooked into the microwave and close the door.
- 2 Press **0/Memory** repeatedly to cycle through memory 1, 2, or 3. The display shows "1", "2", or "3." Stop when you get to the memorized procedure you want to use.
- 3 Press **Start/+30 Sec.** to use the procedure.

**Multi-stage cooking****Notes:**

- You can set up two stages of cooking (maximum). For example, you can set up one stage for defrosting and one stage for cooking.
- If you set the defrosting function, it will automatically be the first stage.
- Auto menu and express cooking cannot be set as one of the stages.

In this example, using the following steps, we set up a defrost time of 5 minutes and 7 minutes of cooking at 80% power;

- 1 Press **Time Defrost** once. The display shows "dEF2."
- 2 Press **5, 0, 0** to set the defrosting time to five minutes.
- 3 Press **Time Cook**. The display shows "00:00".
- 4 Press **7, 0, 0** to set the cooking time to seven minutes.
- 5 Press **Power** once. The display shows "PL10".
- 6 Press **8** to select 80% power.
- 7 Press **Start/+30sec.** to start cooking. When cooking is complete, there will be a beep and "End" will appear on the display. If the door is not opened or the **Stop/Cancel** button is not pressed within nine minutes, your microwave will sound two beeps every three minutes. After nine minutes, your microwave will return to standby mode.

**Muting the sound**

- 1 In standby mode, press and hold the **8** button for three seconds. A long beep sounds and the buzzer is turned off.
- 2 To turn the buzzer back on, press and hold the **8** button for three seconds. A long beep sounds and the buzzer is turned back on.

**Using power saving mode**

Power saving mode turns off the LED display to save power.

- In standby mode, press and release **Stop/Cancel**. The display turns off and your microwave enters power saving mode.
- To exit the power saving mode, press any button, then open the door. The display turns on.

## Defrosting in your microwave

### Defrosting by time

- 1 Press **Time Defrost**. The display shows "dEF2."
- 2 Press the number buttons to input the defrosting time you want. The maximum defrost time is 99 minutes and 99 seconds.
- 3 The default microwave power for time defrost is power level 3. If you want to change the power level, press **Power** once. The display shows "PL 3."
- 4 Press the number button of the power level you want.
- 5 Press **Start/+30 Sec.** to start defrosting. The remaining cooking time is displayed.

#### Notes:

- Your microwave beeps and displays "turn" during the defrost operation to remind you to turn the food over. If you do not open your microwave to turn the food, the defrost operation continues.
- The power cannot be changed during defrosting.

### Defrosting by weight

- 1 Press **Weight Defrost**. The display shows "dEF1."
- 2 Press the number buttons to input the weight of the item to be defrosted (in ounces). Input weight must be between 4 and 100 ounces.
- 3 Press **Start/+30 Sec.** to start defrosting and the remaining cooking time is displayed.

**Note:** Your microwave beeps and displays "turn" during the defrost operation to remind you to turn the food over. If you do not open your microwave to turn the food, the defrost operation continues.

## Changing other microwave settings

### Using the child-lock

- To lock the microwave — Press and hold **Stop/Cancel** for three seconds. The microwave sounds a long beep and the display shows **LOCK**, indicating that the lock is active.
- To unlock the microwave — When the microwave is locked, press and hold **Stop/Cancel** for three seconds. The microwave sounds a long beep, indicating that lock is released.

### Checking the time and power level while cooking

- To check the time while cooking a meal, press **Clock**. The display shows the current time for three seconds, then returns to the cooking time remaining.
- To check the power level while cooking a meal, press **Power**. The display shows the power level being used for three seconds, then returns to the cooking time remaining.

## Cleaning and maintaining your microwave

### Cleaning the outside of your microwave

#### Exterior

Clean the outside with a damp cloth. If needed you can use mild soap and water, then rinse and dry with a soft cloth. Do not use any type of household or abrasive cleaner. To prevent damage to the operating parts inside your microwave, make sure that water does not get into the ventilation openings.

#### Door

Wipe the window and door on both sides, the door seals, and adjacent parts with a damp cloth to remove any spills or splatters. Metal parts are easier to maintain if wiped frequently with a damp cloth. Avoid the use of spray and other harsh cleaners as they may stain, streak, or dull the door surface.

#### Control panel

If the control panel is dirty, open the microwave door before cleaning to prevent your microwave from turning on. Wipe the panel with a cloth dampened slightly with water only. Dry with a soft cloth. Do not scrub or use any sort of chemical cleaners. Close the door and press **STOP/CANCEL** to clear any buttons you may have pressed.

### Cleaning the inside of your microwave

**Note:** Unplug your microwave while cleaning the interior.

#### Interior

Wipe with a soft cloth and warm water. Do not use abrasive or harsh cleaners or scouring pads. For baked-on food, use baking soda or a mild soap, then rinse thoroughly with hot water.

**Tip:** For easier cleaning of cooked-on food on the interior walls, place half a lemon in a bowl, add 1/2 pint (300ml) of water, and heat at 100% power for 10 minutes. Wipe the microwave clean using a soft, dry cloth.

#### Waveguide cover

The waveguide cover is located on the side wall inside the microwave cavity. It is made from mica so it requires special care. Keep the waveguide cover clean to assure good microwave performance. Carefully wipe with a damp cloth any food splatters from the surface of the cover immediately after they occur. Built-up splatters may overheat and cause smoke or possibly catch fire. **DO NOT REMOVE THE WAVEGUIDE COVER.**

#### Removing odors

Occasionally, a cooking odor may remain in your microwave. To remove, combine one cup (.25 L) water, grated peel and juice of one lemon, and several whole cloves in a two-cup (.5 L) glass measuring cup. Boil for several minutes using 100% power, then let it cool in your microwave. Wipe the interior with a soft cloth.

### Glass turntable

Remove the glass turntable and wash it in mild, sudsy water. For stubborn stains, use a mild cleanser and non-abrasive scouring sponge. You can also wash it in the top rack of a dishwasher.

The turntable motor shaft is not sealed, so excess water or spills should be wiped up immediately.

Clean the ring and the floor regularly to avoid excessive noise. Wipe the bottom surface of your microwave with mild detergent. Wash the ring in mild, soapy water or in a dishwasher. When removing the ring, make sure that you replace it in its original position.

## Troubleshooting

If you have a problem with your microwave, review the following chart for a possible solution. If your microwave still doesn't work correctly, contact the nearest authorized service center.

PROBLEM	POSSIBLE SOLUTION
My microwave won't start	Plug the electrical cord into a power outlet.
	Close the door and try again.
Arcing or sparking in my microwave	Use only microwave-safe materials. See <a href="#">Materials you can use</a> on page Z.
	Don't operate your microwave when it's empty.
	Clean the interior of your microwave with a moist towel.
Unevenly cooked foods	Use only microwave-safe materials. See <a href="#">Materials you can use</a> on page Z.
	Defrost the food completely before cooking it.
	Use the correct cooking time and power level.
	Turn or stir the food intermittently to ensure even cooking.
Overcooked foods	Use the correct cooking time and power level.
Undercooked foods	Use only microwave-safe materials. See <a href="#">Materials you can use</a> on page Z.
	Defrost the food completely before attempting to cook it.
	Use the correct cooking time and power level.
	Make sure that the air vents aren't blocked or restricted.
Incorrect defrosting	Use only microwave-safe materials. See <a href="#">Materials you can use</a> on page Z.
	Use the correct cooking time and power level.
	Turn or stir the food intermittently to ensure even cooking.

### Obtaining replacement parts

Call Insignia Customer Service at 1-877-467-4289.

Specifications

Rated voltage	120VAC, 60Hz
Rated input power (microwave)	1,350W
Rated output power (microwave)	1,200W
Microwave capacity	2.2 Cu. Ft.
Turntable diameter	16.54 in. (42 cm)
External dimensions (HxWxD)	13.55 x 24.45 x 19.69 in. (34.42 x 62.1 x 50.01 cm)
Internal dimensions (HxWxD)	11.18 x 17.83 x 19.09 in. (28.39 x 45.28 x 48.48 cm)
Certifications	NS-MW22SS6: UL approved NS-MW22SS6-C: CUL approved
Power cord length	39.17 in. (99.5 cm)
Net weight	33.71 lbs. (15.29 kg)

## ONE-YEAR LIMITED WARRANTY

Best Buy, or its Authorized Partner of Insignia branded products, warrants to you, the original purchaser of this new Insignia branded product ("Product"), that the Product shall be free of defects in the original manufacture of the material or workmanship for a period of one (1) year from the date of your purchase of the Product or the date of delivery (if later than the date of purchase) ("Warranty Period").

For this warranty to apply, your Product must be (i) purchased in the United States or Canada from a Best Buy branded retail store, online at [www.bestbuy.com](http://www.bestbuy.com) or [www.bestbuy.ca](http://www.bestbuy.ca), or from Best Buy's Authorized Partner, and (ii) packaged or sold with this warranty statement.

The term "Best Buy", as used in this warranty, refers to Best Buy branded retail stores, [www.bestbuy.com](http://www.bestbuy.com), [www.bestbuy.ca](http://www.bestbuy.ca), and Best Buy's Authorized Partner.

Because Insignia cannot control the quality of products sold by unauthorized sellers, this warranty applies only to Products that were purchased from Best Buy or an Insignia Authorized Partner, unless otherwise prohibited by law. Insignia reserves the right to reject warranty claims for Products purchased from unauthorized sellers, including unauthorized websites.

REPAIR OR REPLACEMENT, AS PROVIDED UNDER THIS WARRANTY, IS YOUR EXCLUSIVE REMEDY FOR BREACH OF WARRANTY. INSIGNIA SHALL NOT BE LIABLE FOR ANY INCIDENTAL OR CONSEQUENTIAL DAMAGES FOR THE BREACH OF ANY EXPRESSED OR IMPLIED WARRANTY ON THIS PRODUCT, INCLUDING, BUT NOT LIMITED TO, LOST DATA, LOSS OF USE OF YOUR PRODUCT, LOST BUSINESS, OR LOST PROFITS. INSIGNIA PRODUCTS MAKES NO OTHER EXPRESS WARRANTIES WITH RESPECT TO THE PRODUCT. ALL EXPRESSED AND IMPLIED WARRANTIES FOR THE PRODUCT, INCLUDING BUT NOT LIMITED TO ANY IMPLIED WARRANTIES OF AND CONDITIONS OF MERCHANTABILITY AND FITNESS FOR A PARTICULAR PURPOSE, ARE LIMITED IN DURATION TO THE WARRANTY PERIOD SET FORTH ABOVE AND NO WARRANTIES, WHETHER EXPRESSED OR IMPLIED, WILL APPLY AFTER THE WARRANTY PERIOD. SOME STATES, PROVINCES, AND JURISDICTIONS DO NOT ALLOW LIMITATIONS ON (i) HOW LONG AN IMPLIED WARRANTY LASTS, (ii) EXCLUSION OR LIMITATION OF INCIDENTAL OR CONSEQUENTIAL DAMAGES, or (iii) LIMITATION OF INCIDENTAL OR CONSEQUENTIAL DAMAGES, SO THE ABOVE LIMITATIONS OR EXCLUSIONS MAY NOT APPLY TO YOU. THIS WARRANTY GIVES YOU SPECIFIC LEGAL RIGHTS, AND YOU MAY ALSO HAVE OTHER RIGHTS, WHICH VARY FROM STATE TO STATE OR PROVINCE TO PROVINCE.

### ***How long does the coverage last?***

The Warranty Period lasts for 1 year (365 days) from the date you purchased the Product or the date of delivery (if later than the date of purchase). Your purchase date is printed on the receipt you received with the Product. In the event that Authorized Partner ceases to sell the covered Insignia branded product, this warranty shall terminate for that product and there shall be no repair or replacement of the Product.

### ***What does this warranty cover?***

During the Warranty Period, if the original manufacture of the material or workmanship of the Product is determined to be defective by an authorized Insignia repair center or store personnel, Insignia will (at its sole option): (1) repair the Product with new or rebuilt parts; or (2) replace the Product at no charge with new or rebuilt comparable products or parts. Products and parts replaced under this warranty become the property of Insignia and are not returned to you. If service of Products or parts are required after the Warranty Period expires, you must pay all labor and parts charges. This warranty lasts as long as you own your Insignia Product during the Warranty Period. Warranty coverage terminates if you sell or otherwise transfer the Product.

### ***How to obtain warranty service?***

If you purchased the Product at a Best Buy retail store location or from a Best Buy online website ([www.bestbuy.com](http://www.bestbuy.com) or [www.bestbuy.ca](http://www.bestbuy.ca)), please take your original receipt and the Product to any Best Buy store. Make sure that you place the Product in its original packaging or packaging that provides the same amount of protection as the original packaging. If you purchased your Product from an Authorized Partner, call Insignia at 1-877-467-4289.

To obtain warranty service, in the United States and Canada call 1-877-467-4289. Call agents may diagnose and correct the issue over the phone.

If you purchased the Product from an Authorized Partner other than Best Buy, please call 1-888-BESTBUY in the United States or 1-866-BESTBUY in Canada. You will be asked to provide proof of purchase and to return your Product to Best Buy. Make sure that you put the Product in its original packaging or packaging that provides the same amount of protection as the original packaging.

***Where is the warranty valid?***

This warranty is valid only in the United States and Canada to the original purchaser of the product from an Authorized Partner, in the country where the original purchase was made.

***What does the warranty not cover?***

- Food, beverage, and/or medicine loss/spoilage.
- Damage to other products caused by a power surge or other similar issue while connected to the Product.
- Customer instruction/education.
- Installation.
- Set up adjustments.
- Cosmetic damage.
- Damage due to weather, lightning, and other acts of God, such as power surges.
- Accidental damage.
- Misuse.
- Abuse.
- Negligence.
- Commercial purposes/use, including but not limited to use in a place of business or in communal areas of a multiple dwelling condominium or apartment complex, or otherwise used in a place of other than a private home.
- Modification of any part of the Product, including the antenna.
- Display panel damaged by static (non-moving) images applied for lengthy periods (burn-in).
- Damage due to incorrect operation or maintenance.
- Connection to an incorrect voltage or power supply.
- Damage due to attempted repair by any person not authorized by Insignia to service the Product.
- Products sold "as is" or "with all faults".
- Consumables, including but not limited to batteries (i.e. AA, AAA, C etc.).
- Products where the factory applied serial number has been altered or removed.
- Loss or Theft of this product or any part of the product.
- Display panels containing up to three (3) pixel failures (dots that are dark or incorrectly illuminated) grouped in an area smaller than one tenth (1/10) of the display size or up to five (5) pixel failures throughout the display. (Pixel based displays may contain a limited number of pixels that may not function normally.).
- Failures or Damage caused by any contact including but not limited to liquids, gels or pastes.

1-877-467-4289 | [www.insigniaproducts.com](http://www.insigniaproducts.com)

INSIGNIA is a trademark of Best Buy and its affiliated companies.

Distributed by Best Buy Purchasing, LLC

7601 Penn Ave South, Richfield, MN 55423 U.S.A

©2025 Best Buy. All rights reserved.



# For Québec Customers Only

## Availability Guarantee

**Notice for Section 39 of the *Consumer Protection Act* Regarding the Availability Guarantee of Replacement Parts, Repair Services, and Maintenance Information**

Please be advised that Best Buy Canada Ltd. ("Best Buy"), including its affiliated entities, does not guarantee, within the meaning of Section 39 of the *Consumer Protection Act* and the applicable regulations, the availability of replacement parts, repair services, or maintenance or repair information relating to products sold, manufactured, imported, advertised, or sold by Best Buy or under its Insignia brand, Best Buy Essentials, Rocketfish, or other brands sold or manufactured by Best Buy.

**This Notice does not affect Best Buy's One-Year Limited Warranty for Insignia Products.**

**Please visit [www.bestbuy.ca/garantie-disponibilite](http://www.bestbuy.ca/garantie-disponibilite) for additional information.**



INSIGNIA™

**[www.insigniaproducts.com](http://www.insigniaproducts.com)**

1-877-467-4289 (U.S. and Canada)



INSIGNIA is a trademark of Best Buy and its affiliated companies.

Distributed by Best Buy Purchasing, LLC

Richfield, MN 55423

©2025 Best Buy. All rights reserved.

V3 ENGLISH  
25-0979