

Jack&Rose

Portable Travel Steamer Iron

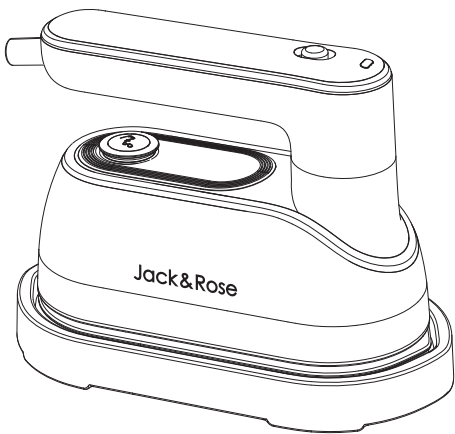

User Manual
Model: CS2364S

JC-D68

User Notice:

1. This appliance is not wide-voltage compatible. Before plugging in, verify the voltage matches the appliance's specifications to prevent damage.
2. This product is not suitable for use by persons (including children) with reduced physical, sensory, or mental capabilities, or lack of experience and knowledge, unless under the supervision or instruction of a responsible person ensuring their safety.
3. Children should use this appliance under adult supervision to prevent tampering, especially when hot. Keep out of reach of children to avoid burns.
4. Exercise caution with steam discharge during use. Avoid directing steam toward people or animals to prevent burns.
5. Unplug the power cord before adding water or cleaning. Do not pull the cord; grasp the plug firmly to disconnect.
6. Do not use the garment steamer if it has been dropped, shows visible damage, or leaks water.
7. Never leave the product unattended while plugged in. Avoid hanging the power cord over table edges or placing it near any heated surfaces.
8. This appliance must be used and placed on a stable surface. When placed on a stand, ensure the stand's surface is also stable.
9. If the power cord or product is damaged, discontinue use immediately to avoid danger. Have it replaced by the manufacturer or a qualified technician, or contact our customer service: email@.
10. Do not touch the heating plate while the appliance is powered on or immediately after use to prevent burns.
11. Do not immerse this product in water or other liquids. Do not handle the product with wet hands.
12. Use purified or distilled water when refilling to prevent scale buildup and blockages.
13. To avoid circuit overload, do not operate other high-power appliances simultaneously.
14. After each ironing session, unplug the power cord and empty any remaining water from the tank to prevent accidental spills during travel.
15. All units undergo 100% steam testing at the factory. If water droplets are present in the tank upon receipt, this is normal and the product is safe to use.

Package List

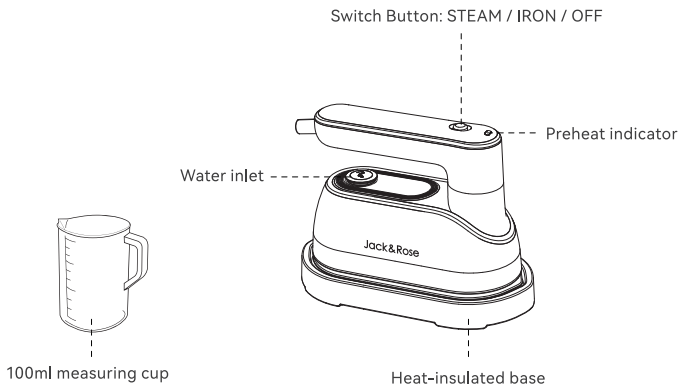

Specifications

Product Name	Portable Travel Steamer Iron
Product Model	CS2364S
Rated Voltage	UK: 220V~240V~50Hz US: 110V~120V~60Hz
Rated power	1200W
Water tank capacity	160ml
Product Dimensions	20.5×15.5×11.5cm

Instructions



①

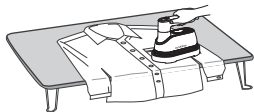

②



③

1. Water Filling

Unplug the unit, fill the purified/distilled water through the water inlet with the provided cup, finally cover the cap.

2. Dry Ironing

- ① Position fabric on flat surface
- ② Plug in and slide the switch to the IRON mode
- ③ When the light flashes, it's preheating; when steady, it's ready to iron.

3. Steam Ironing

- ① Add water, plug in, then slide switch to IRON mode to preheat. (Sliding directly to STEAM mode will auto-generate steam once preheated.)
- ② Post-preheat: slide to STEAM to start ironing.
- ③ To pause: switch to IRON/OFF to avoid steam burns.

NOTES:

- Initial water droplets during first use are normal
- Place damp cloth over delicate fabrics (e.g., silk) before ironing
- Rotate the handle 180° for vertical steaming mode before plugging



No Steam Output

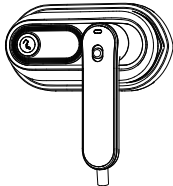

Abnormal Steam Output



Normal Steam Output

Maintenance

Cleaning:

- ① Unplug the unit and allow it to cool completely
- ② Use a soft cloth moistened with mild cleaner (no steel wool/abrasives/acidic solutions) to clear the steam vents
- ③ When cleaning the product, never submerge it in water. Simply unplug it and wipe it dry with a towel.

Storage:

- ① Drain residual water
- ② Cool completely
- ③ Store in original packaging
- ④ Keep in dry, ventilated area where is inaccessible to children

Troubleshooting

Issue	Cause	Solution
No power	Loose connection	Check power supply
Overseas malfunction	Voltage mismatch	Use voltage converter
No heating	Circuit failure	Contact support@jackandrose.net
Steam failure	Low water/incorrect angle	Refill/Rotate handle 180°
	Mineral buildup	Mix citric acid solution (1:10 ratio with purified water), open the steam button, activate steam function briefly, unplug and stand still for 30 minutes, pour out the remaining water.
	Pump failure	Contact support@jackandrose.net
Persistent issues	System error	Contact our customer service for help: support@jackandrose.net

Warranty Information

Thank you for choosing Jack & Rose.

We offer a 2-year warranty on all our products. If you have any issues with your Jack & Rose product, please feel free to contact us for support. Our dedicated Customer Support Team will promptly review your claim and provide further instructions within 24 hours. Your satisfaction is our utmost priority, and we're committed to resolving any concerns you may have.

To initiate a warranty claim, please include the following information in your message for a quicker process:

- Proof of purchase
- Model number of the product
- Relevant photos or videos showcasing the issue

By providing these details, you'll help expedite the handling of your warranty claim.

Please note that our warranty only applies to new products purchased from authorized sellers. Used products or purchases from unauthorized sellers are not covered under the warranty.

✉ support@jackandrose.net

📞 +1 (866) 695-7865 (US) Mon-Fri 8am-5pm(PST)

🌐 www.jackandrose.net



Jack & Rose
Support



@jackandrose_official

GPSR Product Information



Name: Apex CE Specialists GmbH
Add: Grafenberger Allee 277-287,40237 Düsseldorf,DE
Contact Person: Wells Yan
Zip Code: 40237
E-mal: Info@apex-ce.de
Tel: +353212066339



Name: APEX CE SPECIALISTS LIMITED
Add: 6f East Union Street, Manchester, England, M16 9AE
Contact: Wells
Tel: +441616371080
E-Mail: Info@apex-ce.com

GPSR Manufacturer info

Business Name: huizhoushiqihuedianzishangwuyouxiangongsi
Manufacturer Address: Guangdongsheng,Huizhoushi,Huichengqqu,shuikou-jiedaobanshichu,lichenggongyedadao16hao,103shiChina 516000
E-Mail: jackroseofficial@hotmail.com
Telephone number: +86 16675325319

Product Name: Iron Steamer
Brand: Jack&Rose
Product Model: CS2364S
Rated power: 1200W

FCC Compliance Statement:

This device complies with Part 15 of the FCC Rules.Operationis subject to the following two conditions:

- (1)This devicemaynotcause harmful interference,and
- (2) This devicemust acceptanyinterferencereceived, includinginterference that may cause undesired operation.

