

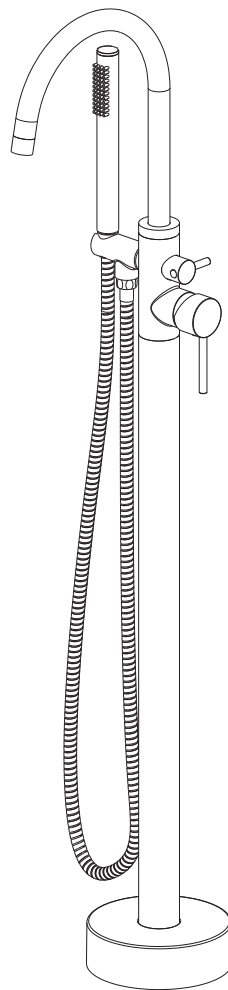

Installation Instructions

Freestanding Tub Filler Faucet Manual

CUPC Model #	Finish
3557C-1-4G-CPR	Chrome
3557C-1-4G-BLK	Matte Black
3557C-1-4G-BNG	Brushed Nickel Glossy
3557C-1-4G-BGM	Brushed Gold Matte



CALIFORNIA PROP 65 WARNING
WARNING! Cancer and Reproductive Harm
www.P65Warnings.ca.gov

ASME A112.18.1/CSA B125.1
NSF61,NSF372
≤1.75 GPM (6.6L/min) at 60 psi c 

Installation Instructions

 **READ ALL INSTRUCTIONS BEFORE UNPACKING THE PRODUCT** 

Important

- 1- For best results, we recommend that this unit be installed by a licensed, professional plumber.
- 2- Please read over these instructions thoroughly before beginning installation. Make sure that you have all tools and supplies needed to complete the installation.
- 3- Please flush the water system to ensure that no metal swarf, solder, and other impurities can enter the faucet that might damage the cartridge. (Most of the leakages and water flow issues are from avoiding this very necessary step).
- 4- Turn off the hot and cold water lines at the angle valve and turn on the old faucet to release any built-up pressure.
- 5- Keep this booklet and the receipt (or other proof of date and place of purchase) for this product in a safe place. The receipt is required should it be necessary to request warranty parts.
- 6- Please keep the box and packaging materials until your product is completely installed and functional.

Cleaning and care

Clean the faucet often with a soft cloth to keep it looking like new. For heavy cleaning you can use mild liquid detergents or non-abrasive liquid polisher. Rinse with water and dry with a soft cloth. Avoid abrasive cleaners, steel wool and harsh chemicals as these will dull the finish and void your warranty.

Tools you may need



1. Drill

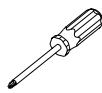

2. Phillips Screwdriver



3. Tape Measure



4. Pencil

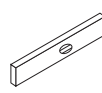

5. Level



6. Plumbers tape



7. Silicone/Caulk Gun



8. Adjustable wrench



9. Hammer

Installation

PARTS&COMPONENTS

No	COMPONENT
1	TRAIANGLE BASE
2	RING
3	BASE
4	STRAIGHT PIPE
5	CARTRIDGE
6	LOCKNUT
7	DOME CAP
8	BUTTON
9	SCREW
10	HANDLE
11	BUTTON
12	SCREW
13	HANLDE
14	NUT
15	O RING
16	CARTRIDGE
17	BODY
18	SPOUT
19	AERATOR
20	HOLDER
21	FLEXIBLE HOSE (H/C)
22	SHOWER HOSE
23	HANLDE SHOWER
24	CHECK VALVE
25	EXPANSION SCREW

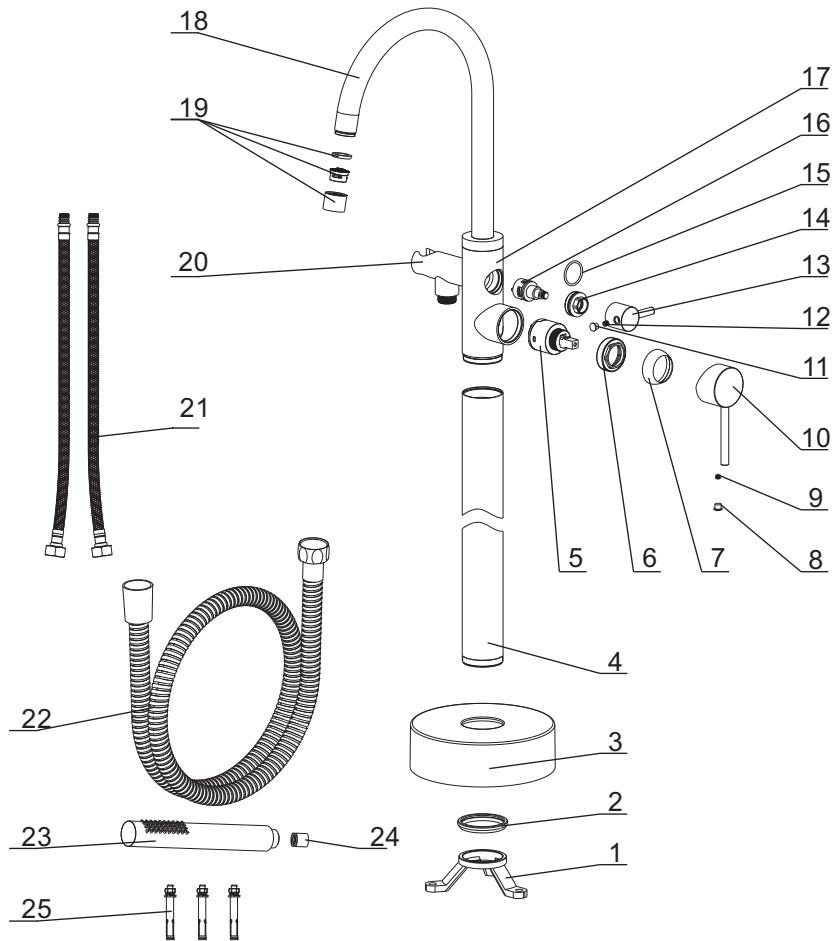

Installation

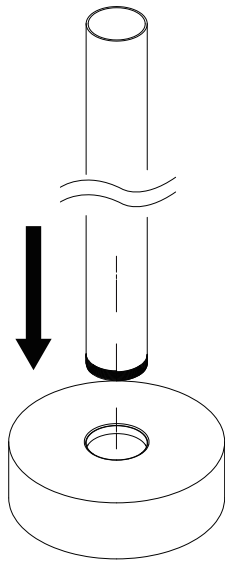

1. The Base Cover through the straight tube from top to bottom.

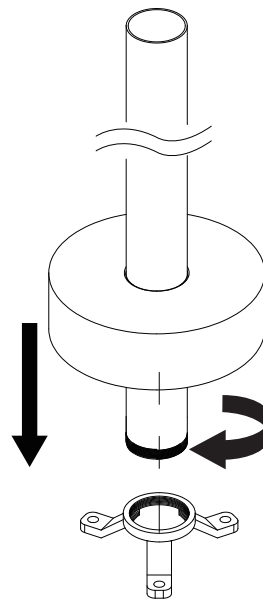

2. Install the permanent seat.

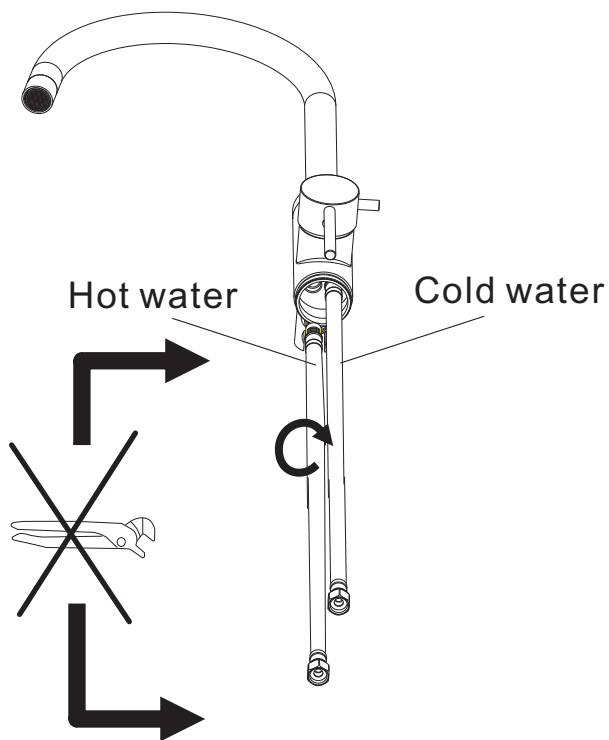

3. Distinguish the hot and cold hose and tighten the flexible hose by **HAND**.
Do NOT USE PLIER

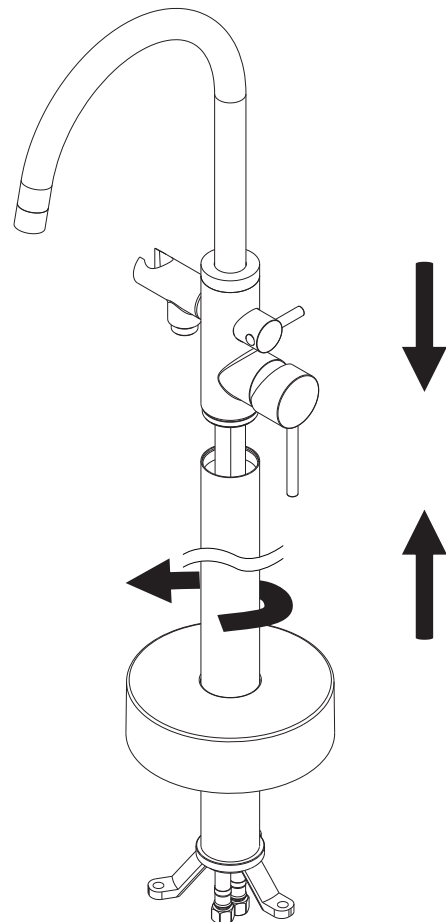

4. Tighten the straight tube with faucet body

Installation

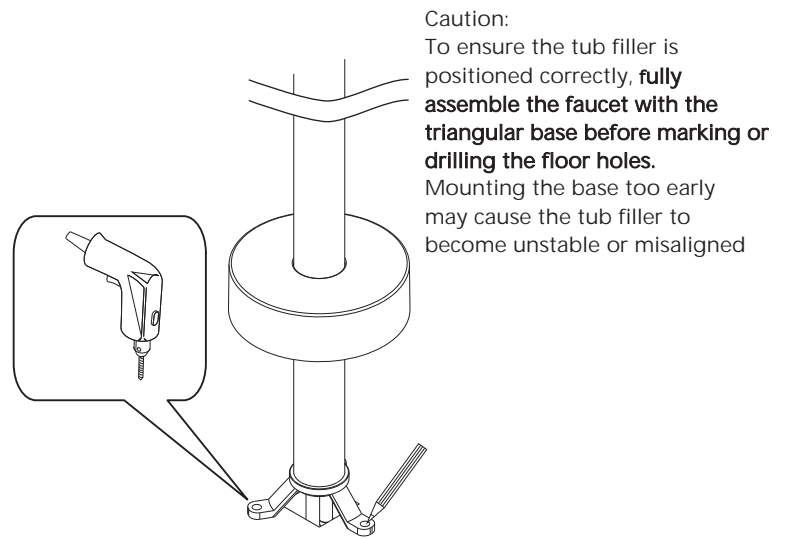
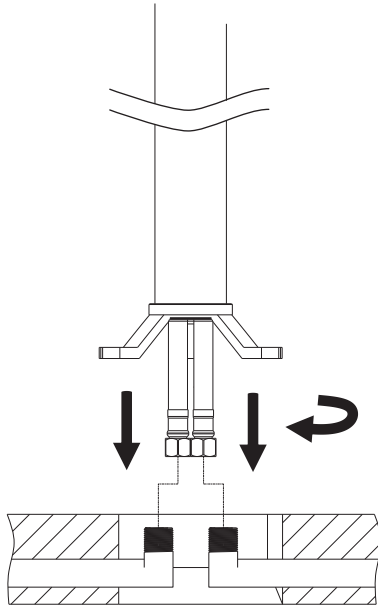

5. Install the hot-cold flexible hoses with valve.

6. Mark 3 holes' position, and Drill the 3 holes.

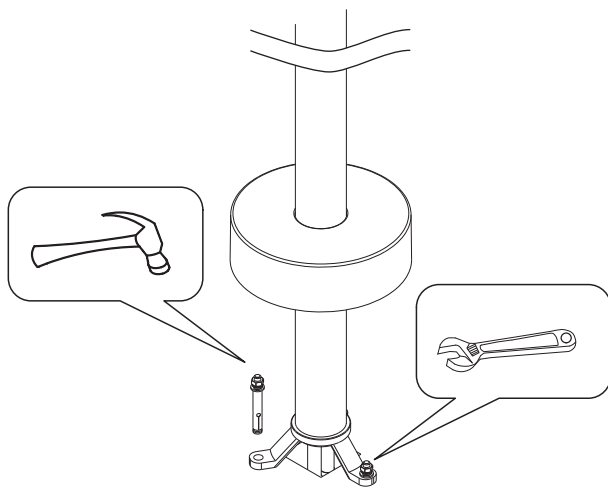

7. Secure the permanent seat on the floor using the attached 3 explosive screws, and Fix it by wrench.

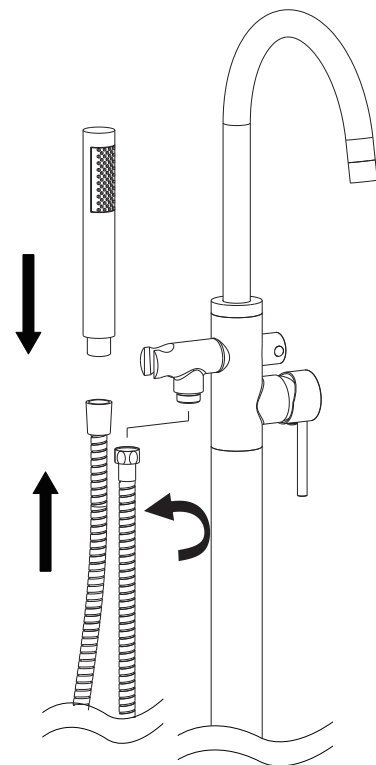

8. Install the hand shower hose.