

1. Bluetooth Setup (Smartphone)

1.1 For App of Smartphone Setup



Note:

Before installing the APP, please make sure you've calibrated the printer correctly as following steps:

1. Feed labels.
2. Long press feed button until printer beep one, release your fingers.
3. Printer will automatically calibrate the printer and load two labels.



Note:

For our app would be updated periodically, considering customers convenience, the latest app user manual would be updated on our website : support.jadens.com

“App Store or Google Player to Search Shipping Printer”



IOS



Android

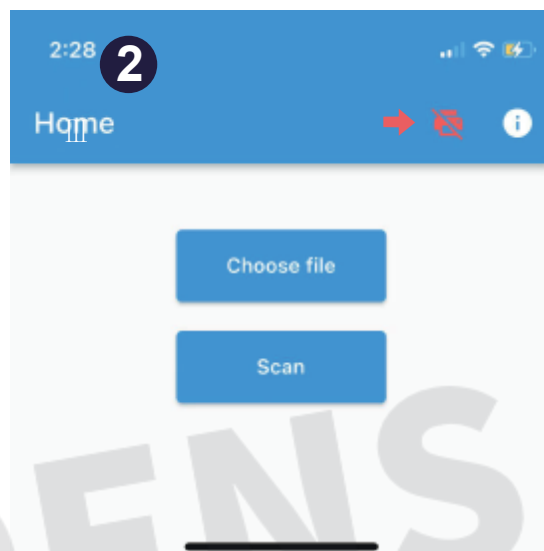

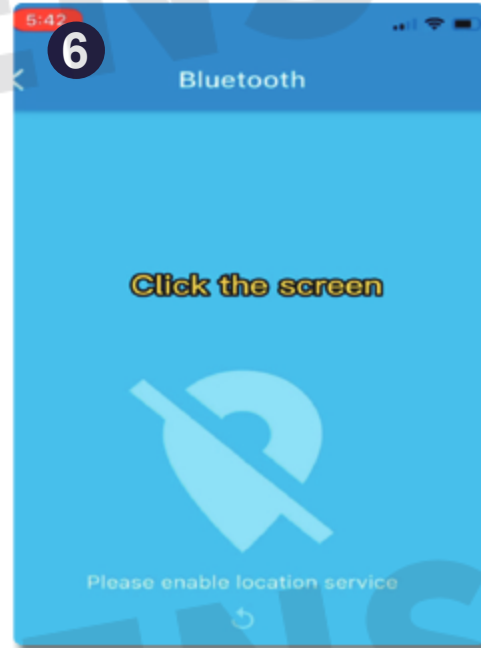
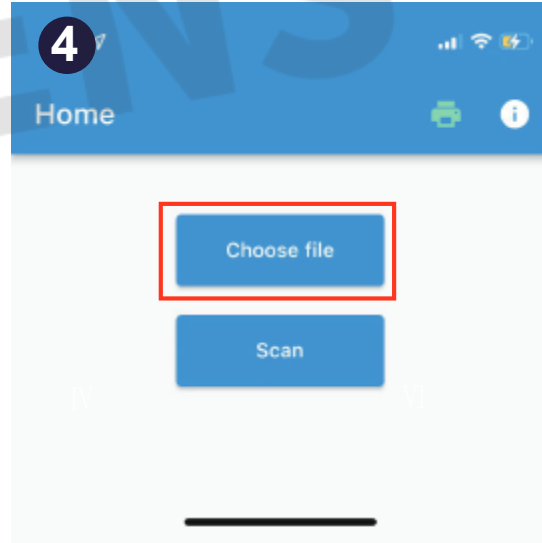
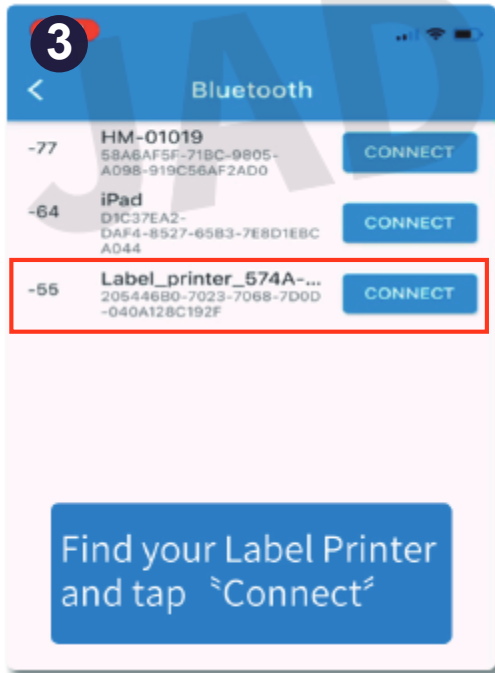

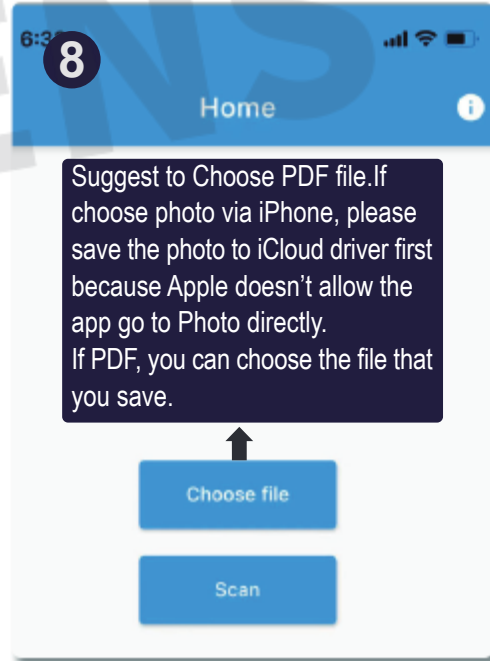

1.1.1 More Setup:

For IOS

If you can not find the file in Pic 4 of page 2 , you can start the printing device by Pic 9 - Pic 13.





If you still can not find the file , you can share PDF file through social media, pls follow the Pic 14 - 17 . And then continue to pic1 to pic 8 on page 2 and3

Note:

If you have received a label (pdf. file) from Twitter or Instagram or other apps, you can open and print it as below.



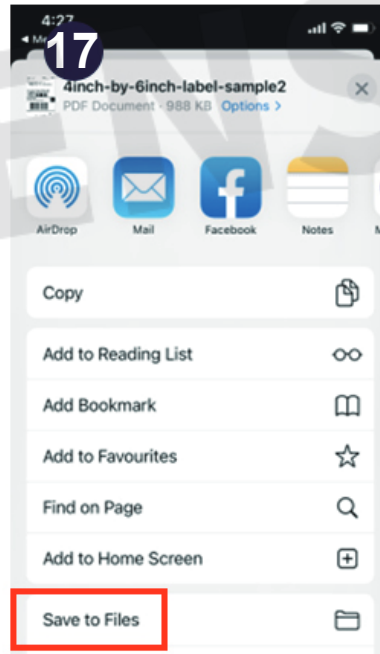

For Android

If you cannot find the file with Android, there are two methods you can print. (open the file in Messenger.) The first one “Download official version”. If finishing, open the shipping printer - choosefile, you can find the file. The second one “Other apps”, click it. And then tap the “Shipping Printer” by Pic18 -Pic 21, and then continue to pic 1 to pic 8 as page 2 and page 3 showed.

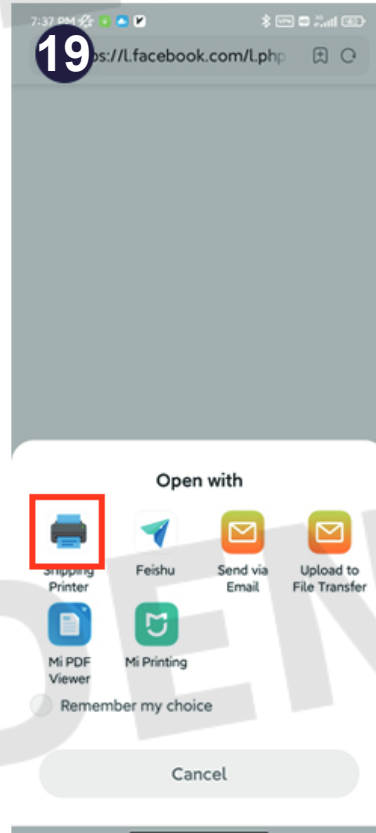
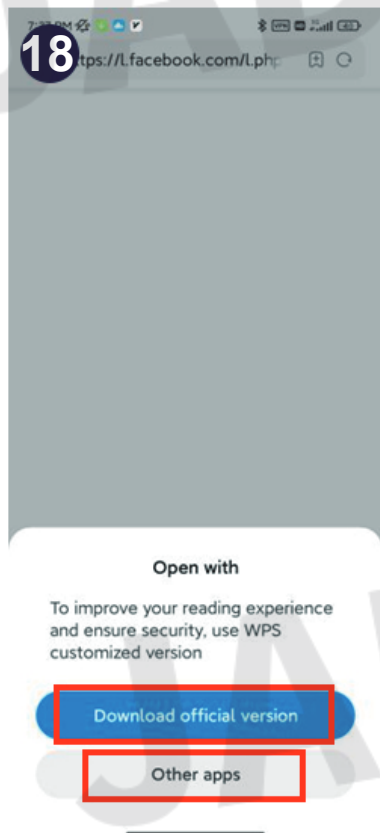



! Note:

If you can not connect Bluetooth in Pic 3 of page 2 , pls make sure your “Location Service” and “Tracking” on by Pic 22-Pic 23 . And then follow pic 1 to pic8 as page 1,2,3 showed.

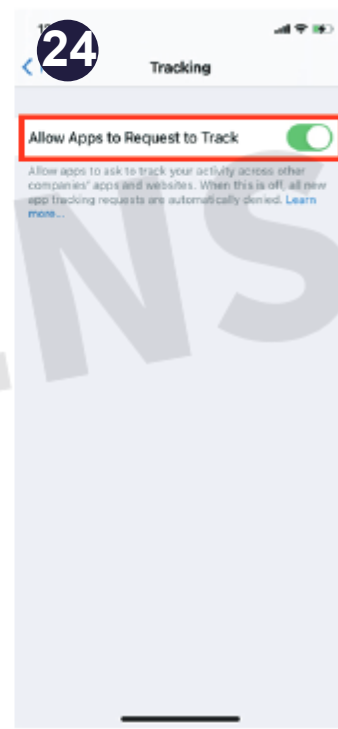
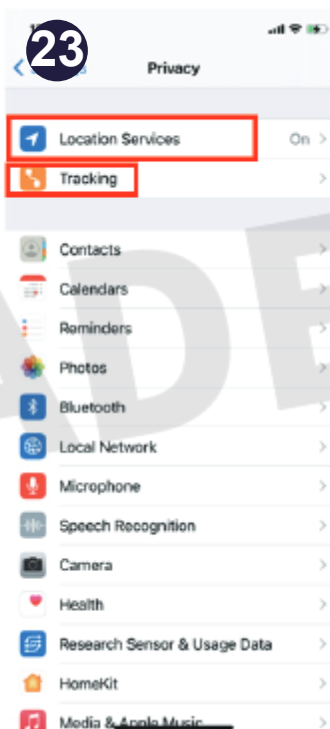
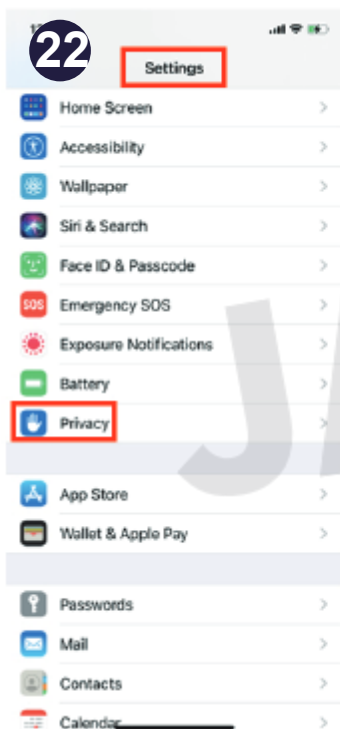

More features.

Scan and print small bar code.

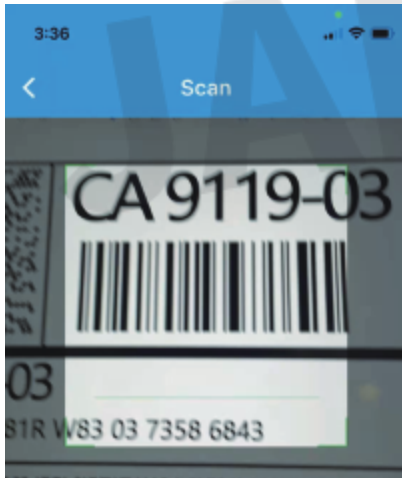

Scan the barcode

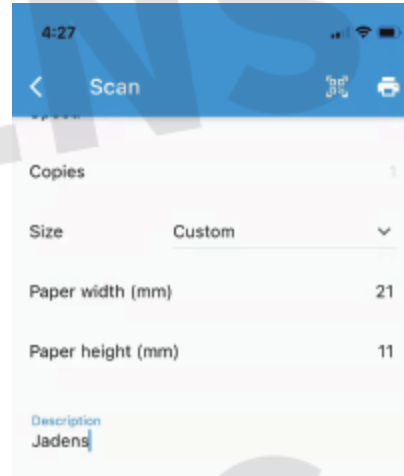

Edit the file
(Please customize the size according to the label size you are printing.)



Note:

1. Please print PDF file but not picture. The quality of print PDF is better than photo. If you have to use photo, you should use the high-quality picture.
2. The iPad device may not be compatible with the printer, it is better to use the mobile phone Bluetooth to print.

Can we help?

For further assistance please contact

JADENS®



support@jadens.com



1-833-470-2950



support.jadens.com



Customer Support

Scan or upload this QR code using the WhatsApp camera to add us

Scan the below QR code to talk with us