

Revell

JUNIOR KIT

LEVEL 1

- 1
- 2
- 3
- 4
- 5



23 PARTS
30 - 45 MIN

1.



2.



3.



Thank you for your interest in the Revell Junior Kit. This Limited Warranty applies to the physical goods, and only the physical goods purchased. The Limited Warranty is good for 12 months past the purchase date of the product and covers any defects in material or workmanship under normal use during the Warranty Period. During the Warranty Period Revell will replace, at no charge, products or parts of a product that proves defective because of improper material or workmanship, under normal use and maintenance. This Limited Warranty does not cover any problem caused by conditions, malfunctions or damage not resulting in material or workmanship.

Gracias por su interés en el Kit Revell Junior. Esta Garantía Limitada se aplica a los bienes físicos, y sólo a los bienes físicos comprados. La Garantía Limitada es válida por 12 meses después de la fecha de compra del producto y cubre todos los defectos de materiales o mano de obra bajo un uso normal durante el Período de Garantía. Durante el Período de Garantía, Revell sustituirá, sin costo alguno, los productos o las piezas de un producto que se demuestre que sean defectuosos debido a materiales o mano de obra inadecuados, bajo un uso y mantenimiento normales. Esta Garantía Limitada no cubre ningún problema causado por condiciones, funcionamiento incorrecto o daños no debidos a los materiales o la mano de obra.



Merci de l'intérêt que vous portez au kit Junior de Revell. Cette garantie limitée s'applique aux biens physiques, et seulement aux biens physiques achetés. Cette garantie limitée est valable pendant 12 mois à partir de la date d'achat du produit et couvre tout vice de fabrication et de matériaux dans des conditions normales d'utilisation durant la période de garantie. Durant la période de garantie, Revell remplacera gratuitement les produits ou pièces d'un produit qui s'avère défectueux en raison de matériaux ou d'une fabrication impropres, dans des conditions normales d'utilisation et d'entretien. Cette garantie limitée ne couvre pas les problèmes causés par des conditions, des dysfonctionnements ou des dommages sans lien avec les matériaux ou la fabrication.

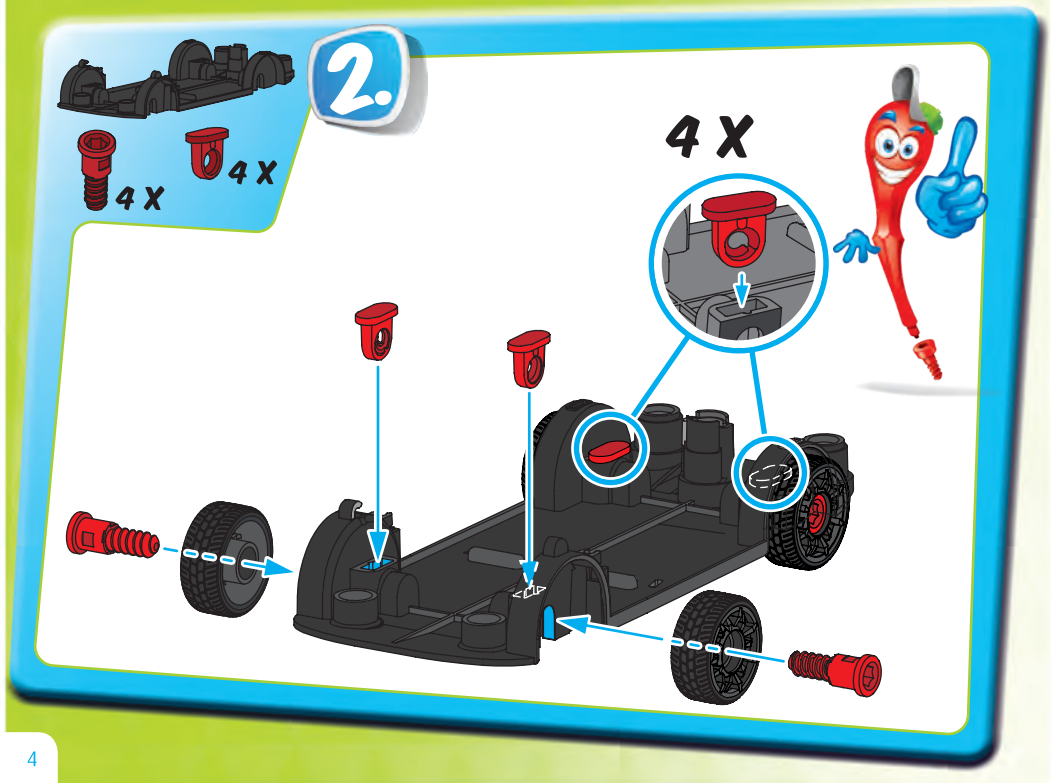

5.



CLICK!



CLICK!

6.



CLICK!

CLICK!

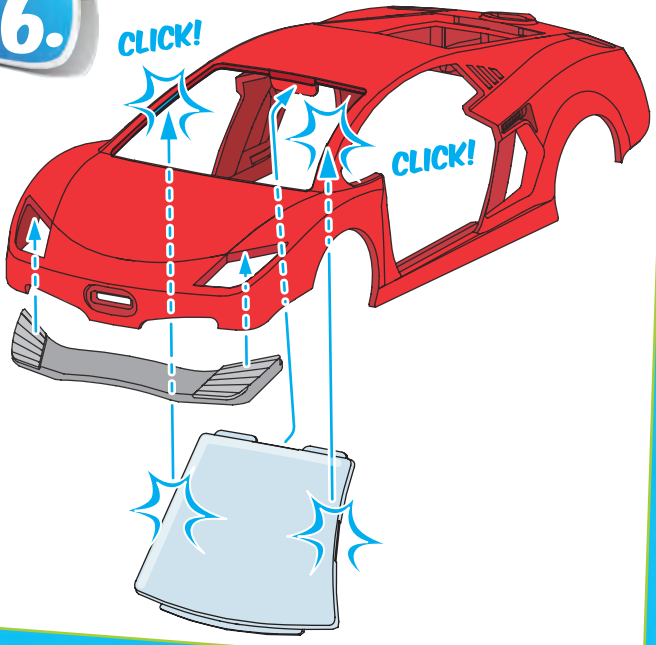

7.

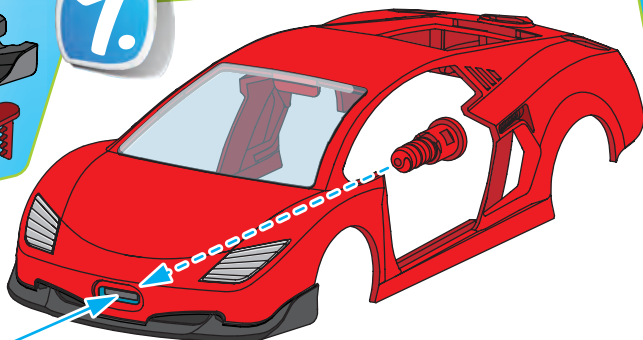
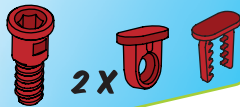
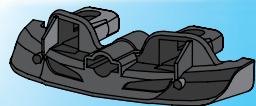

REV-800

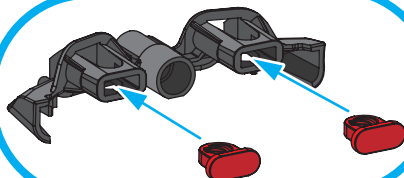
STICKER
17

8.

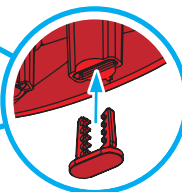
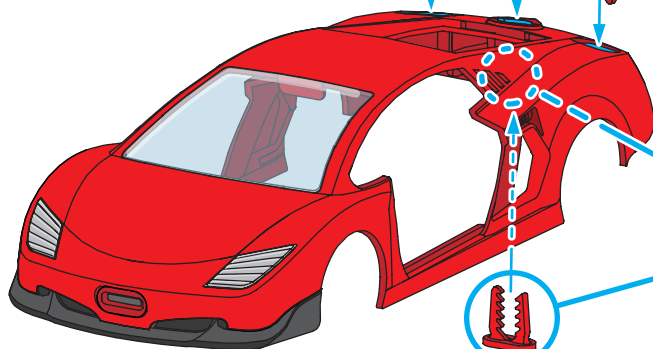
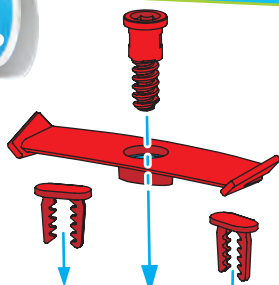
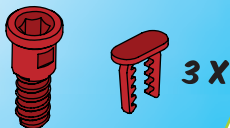
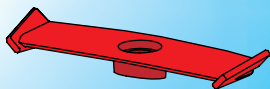

9.

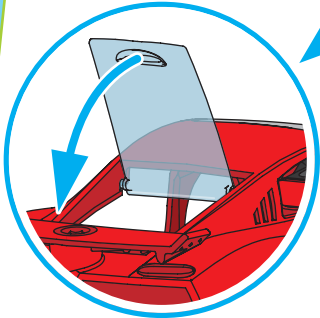
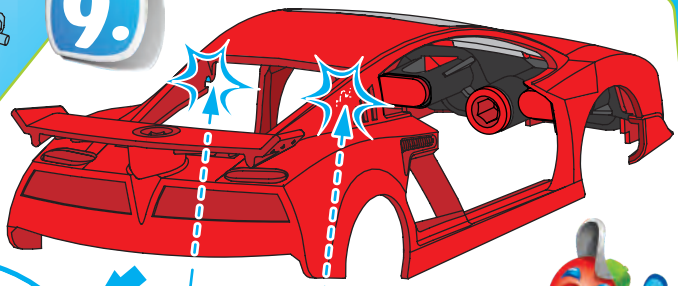
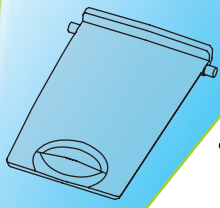

10.

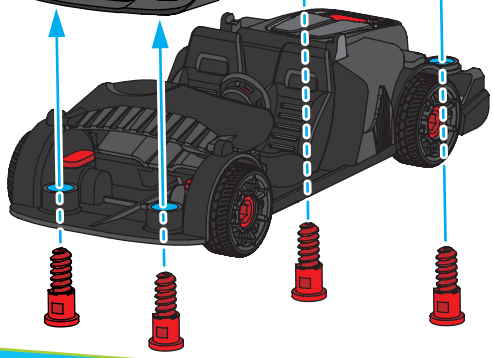
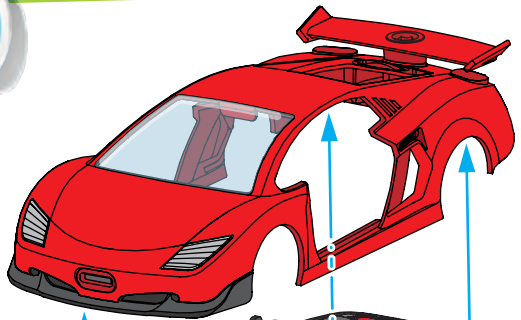

11.



CLICK!

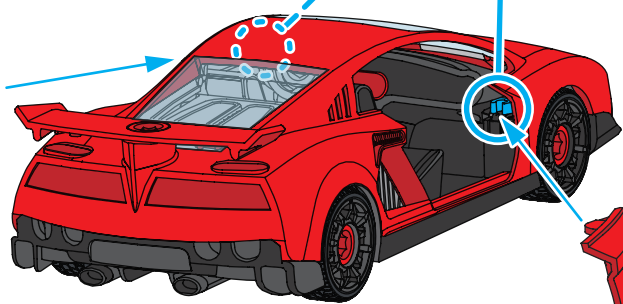
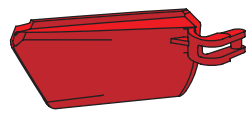
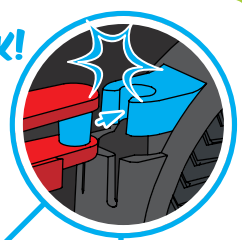

12.

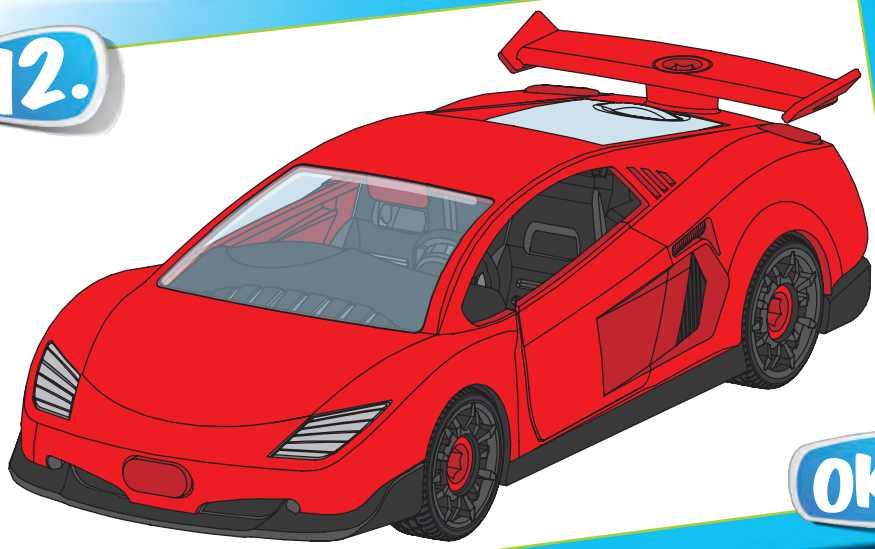

OK!

13.

STICKER 15

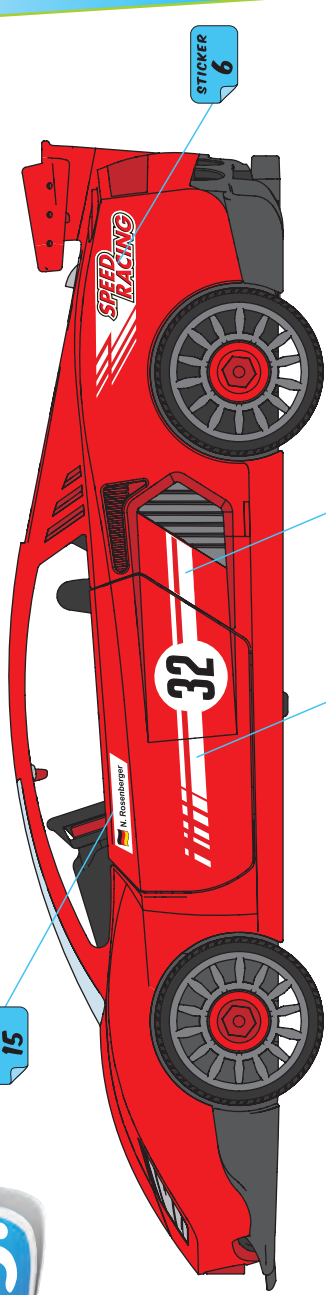

STICKER 6

STICKER 13

STICKER 11

STICKER 16

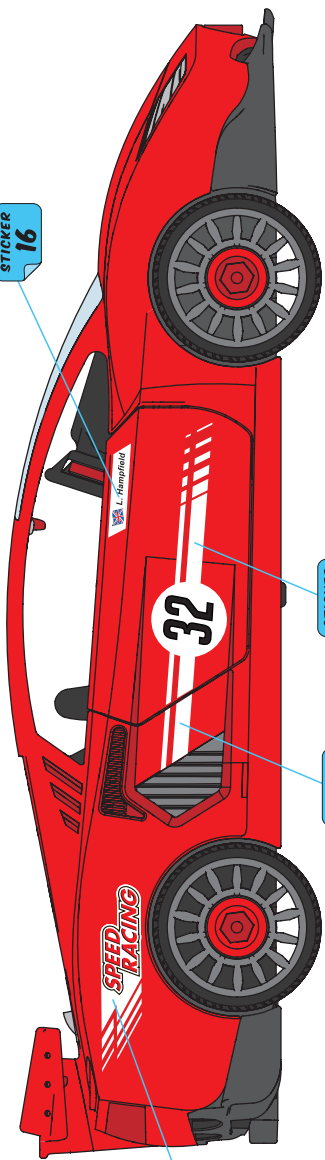

STICKER 7

STICKER 14

STICKER 12

14.

STICKER 1

STICKER 2

STICKER 3

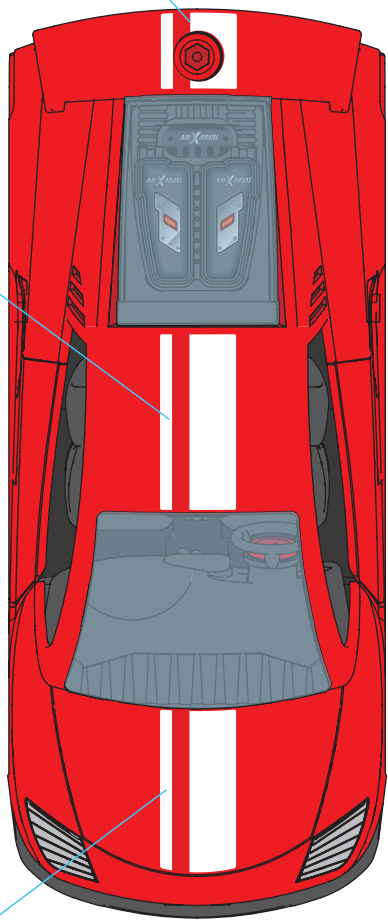

STICKER 5

STICKER 4

STICKER 18

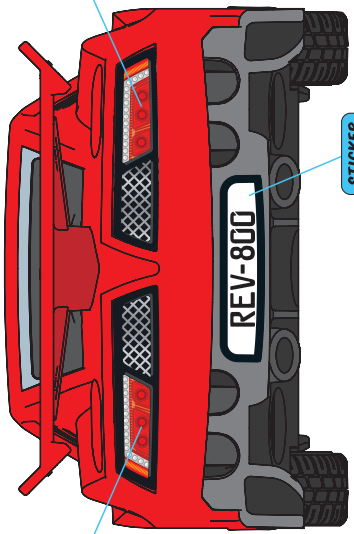



© 2016 Revell, Inc. All rights Reserved.
www.revelljunior.com