



# Whole Home HD Extender

RF-HPL302

## User Guide

Before using your new product, please read these instructions to prevent any damage.



# Rocketfish RF-HPL302 Whole Home HD Extender

## Contents

Introduction.....	2
Features.....	5
Set up your HD Extender .....	11
Use your HD Extender .....	15
Troubleshooting.....	16
Specifications .....	18
Legal notices.....	18
One-Year Limited Warranty.....	21

## Introduction

Congratulations on your purchase of a Rocketfish Whole Home HD Extender. This system delivers 1080p full HD video and audio content anywhere in your home, using your home's power lines. Power line transmission results in great range and high performance video without wireless interference or WiFi range limitations.

You can connect a cable or satellite box, DVR, or other video source to another TV anywhere in the house. An IR receiver cable and an IR emitter cable are included, allowing you to control your video source device, even when it's in another room.

## Safety information



### WARNING:

**TO REDUCE THE RISK OF FIRE OR ELECTRIC SHOCK,  
DO NOT EXPOSE THIS APPLIANCE TO RAIN OR  
MOISTURE.**

	The lightning flash with arrowhead symbol, within an equilateral triangle is intended to alert the user to the presence of uninsulated dangerous voltage within the product's enclosure that may be of sufficient magnitude to constitute a risk of electric shock.
	The exclamation point within an equilateral triangle is intended to alert the user to the presence of important operating and maintenance (servicing) instructions in the literature accompanying the appliance.

## Important Safety Instructions

- 1) Read these instructions.
- 2) Keep these instructions.
- 3) Heed all warnings.
- 4) Follow all instructions.
- 5) Do not use this apparatus near water.
- 6) Clean only with dry cloth.



- 7) Do not block any ventilation openings. Install in accordance with the manufacturer's instructions.
- 8) Do not install near any heat sources such as radiators, heat registers, stoves, or other apparatus (including amplifiers) that produce heat.
- 9) Do not defeat the safety purpose of the polarized or grounding-type plug. A polarized plug has two blades with one wider than the other. A grounding type plug has two blades and a third grounding prong. The wide blade or the third prong are provided for your safety. If the provided plug does not fit into your outlet, consult an electrician for replacement of the obsolete outlet.
- 10) Protect the power cord from being walked on or pinched particularly at plugs, convenience receptacles, and the point where they exit from the apparatus.
- 11) Only use attachments/accessories specified by the manufacturer.
- 12) Unplug this apparatus during lightning storms or when unused for long periods of time.
- 13) Refer all servicing to qualified service personnel. Servicing is required when the apparatus has been damaged in any way, such as power-supply cord or plug is damaged, liquid has been spilled or objects have fallen into the apparatus, the apparatus has been exposed to rain or moisture, does not operate normally, or has been dropped.

## **Additional safety information**

- Do not expose the system to any dripping or splashing liquid.
- The AC plug is used as the disconnect device. The disconnect device shall remain readily available.

- Read the Rating Labels on the bottom of the Transmitter and Receiver for power input and other safety information.

## Features

### Package contents

- Transmitter
- Receiver
- AC power cords (2)
- HDMI cables (2)
- Dual IR emitter cable
- IR Receiver cable
- Remote control
- AAA Batteries (2)
- *Quick Setup Guide*
- *User Guide*



## Transmitter

### Front panel

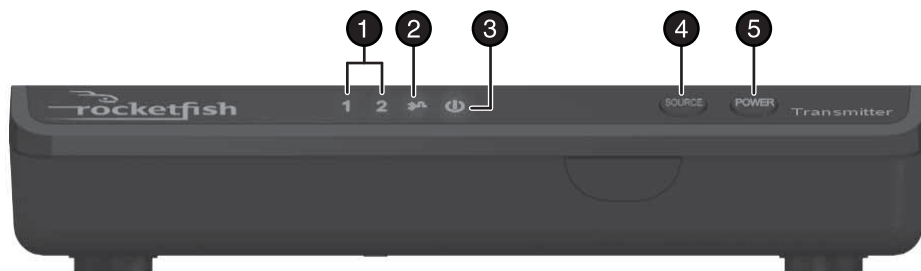

#	Item	Description
1	Source indicators	Light to show which input source is selected.
2	Sync indicator	If this indicator is off, the HD Extender Transmitter and Receiver have not established a connection. When they are connected, the indicator will blink according to the quality of the connection: as the connection quality improves, the indicator will blink slower. When the quality of the connection is perfect, the indicator stays on (non-blinking). <b>Note:</b> The Sync indicator will always be active to show the power line sync state, regardless of whether the Transmitter is turned on or not.
3	Power indicator	Lights green to indicate that the power is turned on. Turns red in standby mode.
4	Source selector button	Press to toggle between input sources.
5	Power button	Press to turn the Transmitter on. Press again to go into standby mode.

## Back panel

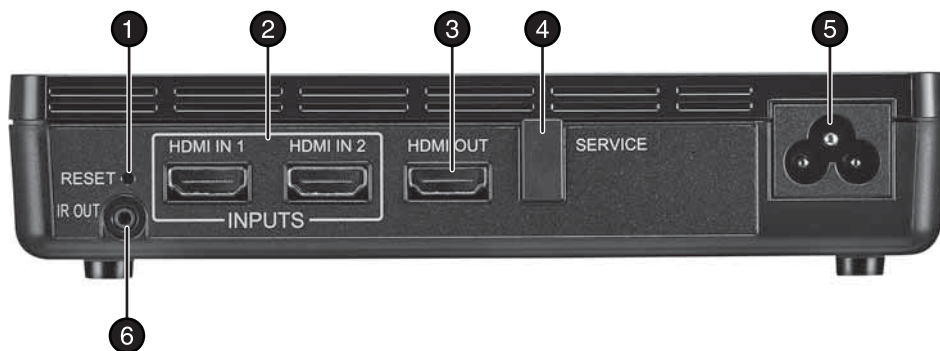

#	Item	Description
1	<b>RESET</b> button	Press (with a pen tip or paperclip) to reset to factory default settings.
2	<b>HDMI INPUTS</b>	Plug the HDMI cable from the source HD audio/video devices into these jacks. HDMI 1 is the default.
3	<b>HDMI OUT</b>	Plug the HDMI cable from an HD TV into this jack.
4	<b>SERVICE</b> port	Service port, do not use.
5	AC input	Plug the AC power cord into this jack.
6	<b>IR OUT</b> jack	Plug the Dual IR Emitter cable into this jack.



## Receiver

### Front panel

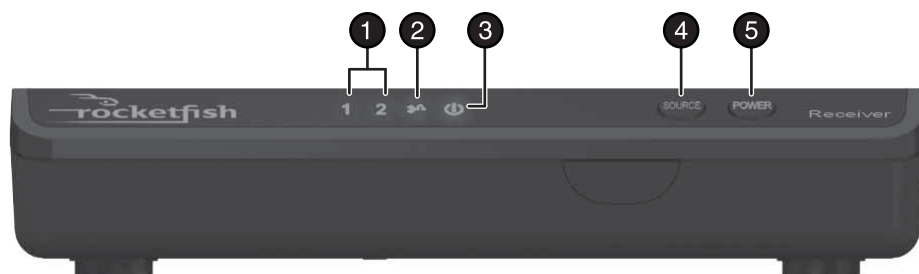

#	Item	Description
1	Source indicators	Light to show which input source is selected.
2	Sync indicator	If this indicator is off, the HD Extender Transmitter and Receiver have not established a connection. When they are connected, the indicator will blink according to the quality of the connection: as the connection quality improves, the indicator will blink slower. When the quality of the connection is perfect, the indicator stays on (non-blinking). <b>Note:</b> The Sync indicator will always be active to show the power line sync state, regardless of whether the Receiver is turned on or not.
3	Power indicator	Lights green to indicate that the power is turned on. Turns red in standby mode.
4	Source selector button	Press to toggle between input sources.
5	Power button	Press to turn the Receiver on. Press again to go into standby mode.



## Back panel

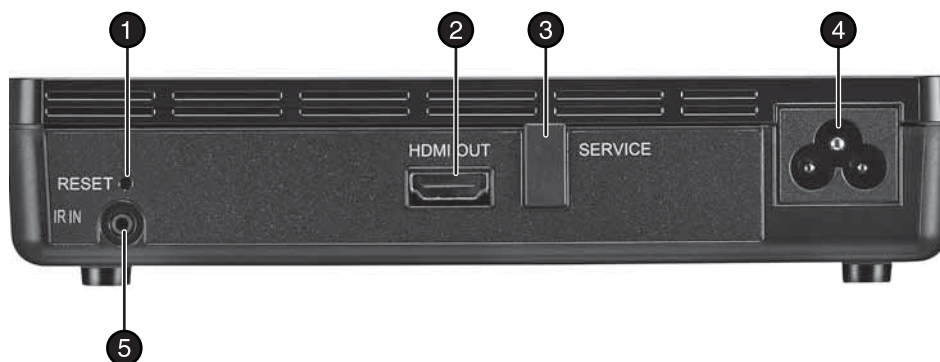

#	Item	Description
1	<b>RESET</b> button	Press (with a pen tip or paperclip) to reset to factory default settings.
2	<b>HDMI OUT</b>	Plug the HDMI cable from an HD TV into this jack.
3	<b>SERVICE</b> port	Service port, do not use.
4	AC input	Plug the AC power cord into this jack.
5	<b>IR IN</b> jack	Plug the IR Receiver cable into this jack.



## Remote control

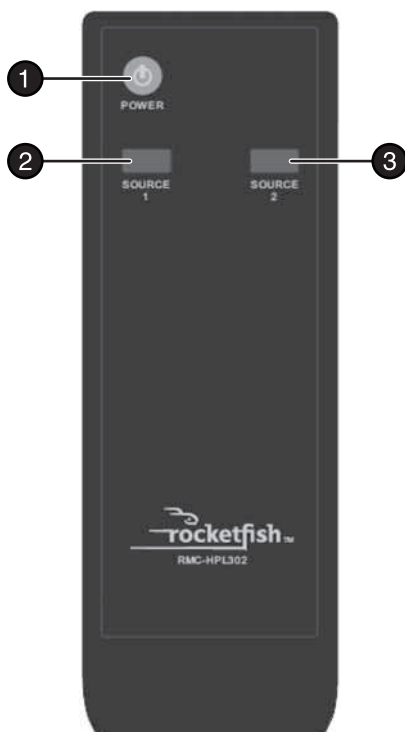

#	Item	Description
1	⏻ (power)	Press to turn on power to the Transmitter or Receiver. Press to switch to standby mode.
2	<b>Source 1</b>	Press to select the SOURCE 1 input.
3	<b>Source 2</b>	Press to select the SOURCE 2 input.

## Set up your HD Extender

This unique technology allows you to connect a DVR, cable box, or other video device to another TV anywhere in your home! Connect the Transmitter to your video device(s) and TV, then connect the Receiver to another TV to extend your viewing environment.

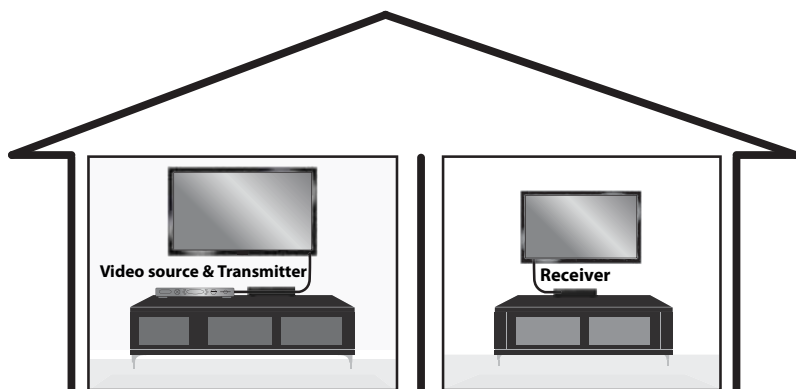

Or if you're just looking to move your video devices away from your main TV, connect the Transmitter to those devices and the Receiver to your TV.

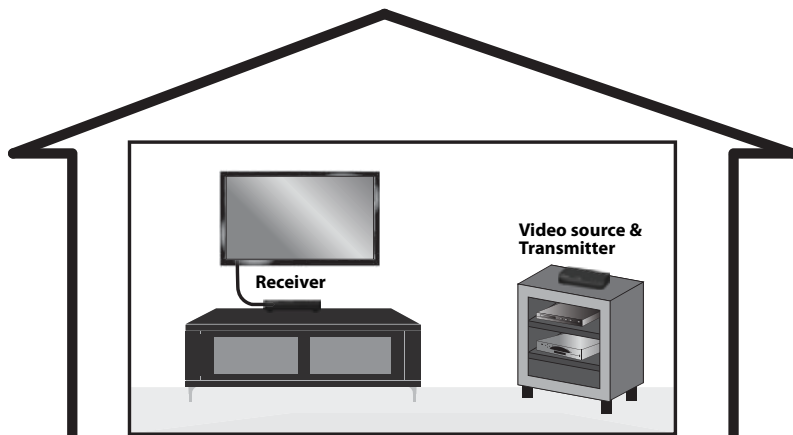



### ***To set up your HD Extender:***

- 1** Place your Transmitter near your DVR, cable box, or other video device.
- 2** Connect your video source devices' HDMI output to the Transmitter's **HDMI IN 1** or **HDMI IN 2** inputs. You do not have to connect video devices to both HDMI inputs.
- 3** If your TV is near your video sources, connect the TV's **HDMI IN** jack to the Transmitter's **HDMI OUT** jack. This connection will allow you to view your video device(s) on this TV and on the TV connected to your Receiver in another room. If your TV is not near your video devices (across the room or in another room), you can connect it to the Receiver.
- 4** Plug the Transmitter into AC power.

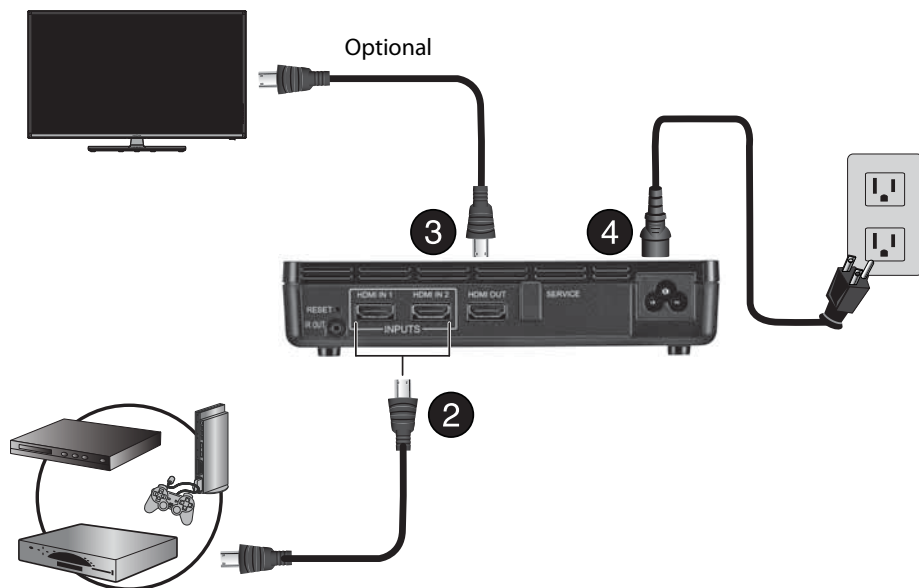

- 5 Place your Receiver near your TV.
- 6 Connect the Receiver's **HDMI OUT** jack to your TV's **HDMI IN** jack.
- 7 Press the **Source/Input** button on your TV's remote to select the correct HDMI input.
- 8 Plug the Receiver into AC power.

After the receiver and transmitter are turned on, the Sync indicators blink while establishing a connection over the power line. After they have connected, the indicators blink slower (good connection) or light solid (perfect connection).

Even if the light is blinking, you will still be able to receive video. The system will automatically adjust the video data rate so that it can be sent over the power line interface.



**Note:** It's best to connect the AC power cord directly to a wall outlet. Using a surge protector with noise filtering may decrease the data rate and may affect the quality of the signal.



## Set up the IR emitter and IR receiver

An IR receiver cable and an IR emitter cable are included, allowing you to control a video source, even when it's in another room. Just point your devices' remote control at the IR receiver instead of your video sources themselves.

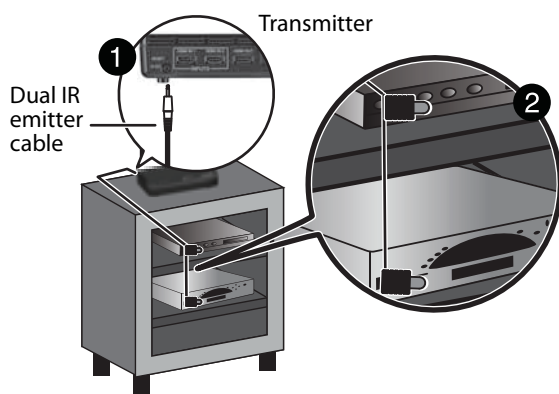

Stick each emitter to the IR sensor on your video sources.

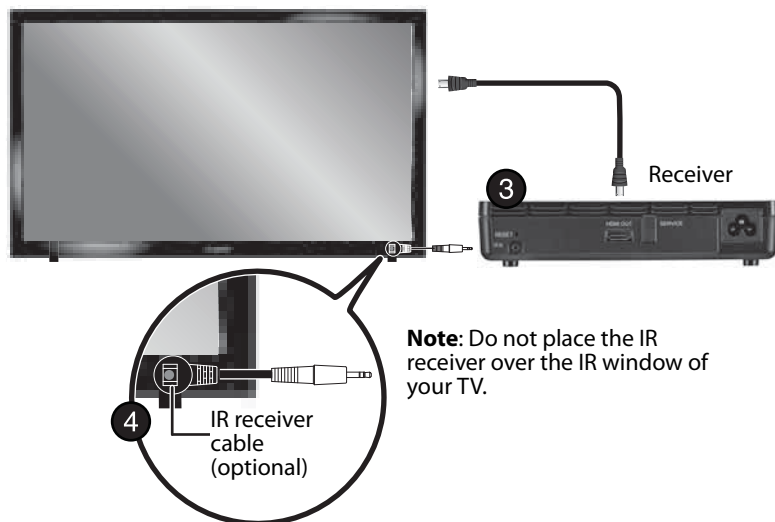

- 1 Plug the IR emitter cable into the Transmitter.
- 2 The IR emitter cable has two separate IR emitters, one for each video source device you want to control. For each IR emitter, remove the protective cover from the tape on the emitter and stick the emitter near the IR sensors on your video sources.
- 3 Plug the IR receiver cable into the Receiver if your Receiver is out of view or hidden in a media cabinet. If you can point your remote directly at the Receiver, you do not need to connect this cable, go to Use your HD Extender (page 15).
- 4 Remove the protective cover from the tape on the IR receiver and stick the IR receiver on the front of your TV, or in another visible location you can point to with your remote.

**Note:** Do not place the IR receiver over the IR window of your TV.

## Use your HD Extender

- 1 Place two AAA batteries (included) into the remote control.
- 2 Press  (power) on the Transmitter and Receiver to turn them on. The Sync indicators blink while establishing a connection over the power line. Once connected, the indicators blink slower (good connection) or light solid (perfect connection). You can watch video and hear audio through your TV.
- 3 Make sure your video device is turned on, then press the **SOURCE 1** or **SOURCE 2** button on the remote control or the Receiver and Transmitter to select the source you want to view.
- 4 Turn on your TV and set it to the correct HDMI input.



**Notes:** *The Receiver and Transmitter will automatically turn on and off based on the power state of the TVs connected to the Receiver and Transmitter.*

- *When the TV connected to the Transmitter is turned on, the Transmitter automatically turns on.*
- *When the TV connected to the Transmitter is turned off, the Transmitter will automatically turn off after a few minutes if the TV connected to the Receiver is not turned on.*
- *When the TV connected to the Receiver is turned on, the Receiver and Transmitter automatically turn on.*
- *When the TV connected to the Receiver is turned off, the Receiver automatically turns off after a few minutes. The Transmitter will also turn off after a few minutes as long as the TV connected to the Transmitter is not turned on.*

**Note:** *Up to three HD Extender Receiver and Transmitter pairs can work in one home. Each new Transmitter and Receiver pair forms a new and unique power line network. The video transmitted from each Transmitter can only be viewed at the corresponding Receiver with which it is paired.*

## Troubleshooting

Please read this *User Guide* carefully before using your HD Extender. Check this list for a possible troubleshooting solution before calling for service. Refer to [rocketfishproducts.com](http://rocketfishproducts.com) for additional information.

Problem	Solution
The ⏻ (power) indicator does not turn on	<ul style="list-style-type: none"><li>• Make sure that the AC power cords to the Transmitter and Receiver are plugged in.</li><li>• Make sure that the AC power outlet is working.</li></ul>



Problem	Solution
No picture on your TV or projector	<ul style="list-style-type: none"> <li>• Make sure that the connections are correct and secure between the Transmitter input and your HD device output.</li> <li>• Make sure that an HDMI input has been selected as the source on your TV or projector.</li> <li>• Make sure that the  (power) indicator is on (lit green) and the SOURCE indicator shows the correct input.</li> <li>• Make sure that the video resolution from your HD device is set to 1080p, 1080i, 720p, or 480p.</li> <li>• Reconnect the HDMI cable to the TV first. If you still do not have video, power cycle both the transmitter and receiver units by unplugging the power cords for five seconds and then plugging them back in.</li> <li>• Make sure you are connected directly into the wall and not into a surge protector. Some surge protectors can interfere with powerline networking and could degrade performance.</li> <li>• Make sure the Receiver is not located too far away from the Transmitter. To check this, move the Receiver into the same room as the Transmitter and verify that it works there, then try again in the remote room. Observe the Sync LED to make sure it is not blinking rapidly. If it is off or blinking rapidly, it indicates that the Receiver is positioned too far from the transmitter.</li> </ul>
You can't view different channels or video content	<ul style="list-style-type: none"> <li>• Remember that the HD Extender is not an additional TV tuner for your Cable or TV service. It will only show the video output from the video source devices that your HD Extender Transmitter is connected to.</li> </ul>
Poor picture quality	<ul style="list-style-type: none"> <li>• Make sure that the video resolution from your HD device is 1080p, 1080i, 720p, or 480p.</li> </ul>
Intermittent or no sound	<ul style="list-style-type: none"> <li>• Make sure that your TV's volume is turned up and not set to MUTE.</li> <li>• Reconnect the HDMI cable to the TV first. If you still do not have audio, power cycle both the Transmitter and Receiver units by unplugging the power cords for five seconds and then plugging them back in.</li> </ul>
The IR emitter will not control the source device	<ul style="list-style-type: none"> <li>• Make sure that the IR emitter is aligned with the IR sensor on the source device.</li> </ul>



## Specifications

Video CODEC	H.264 video encode and decode
Video Resolution	Support up to 1920 x 1080 @ 60p
Digital audio	Dual channel, Linear PCM, 44.1 KHz, 48KHz
Power Line Link speed	500 Mbps SmartLink PLC technology
Power Consumption	Standby - 4.2 W On - 6.0 W

## Legal notices

### FCC

This device complies with Part 15 of the FCC Rules. Operation is subject to the following two conditions: (1) this device may not cause harmful interference, and (2) this device must accept any interference received, including interference that may cause undesired operation.

This equipment has been tested and found to comply with the limits for a Class B digital device, pursuant to Part 15 of the FCC Rules. These limits are designed to provide reasonable protection against harmful interference in a residential installation. This equipment generates, uses and can radiate radio frequency energy and, if not installed and used in accordance with the instructions, may cause harmful interference to radio communications. However, there is no guarantee that interference will not occur in a particular installation. If this equipment does cause harmful interference to radio or television reception, which can be determined by

turning the equipment off and on, the user is encouraged to try to correct the interference by one or more of the following measures.

- Reorient or relocate the receiving antenna.
- Increase the separation between the equipment and Receiver.
- Connect the equipment into an outlet on a circuit different from that to which the Receiver is connected.
- Consult the dealer or an experienced radio/TV technician for help.

**Warning:** Changes or modifications not expressly approved by the party responsible for compliance could void the user's authority to operate the equipment.

## Copyright

© 2014 Rocketfish. Rocketfish and the Rocketfish logo are trademarks of Best Buy Enterprise Services, Inc. Other brands and product names are trademarks or registered trademarks of their respective holders. Specifications and features are subject to change without notice or obligation.

For service and support call (800) 620-2790.

## Open Source Software

For Open Source Software information, if you require additional information or you wish to receive the complete corresponding licensed source code, please call the Rocketfish support line at 1-800-620-2790. This source code is available for a period of three (3) years from the date of the distribution of this product by Rocketfish.



## One-Year Limited Warranty

Rocketfish Products ("Rocketfish") warrants to you, the original purchaser of this new **RF-HPL302** ("Product"), that the Product shall be free of defects in the original manufacture of the material or workmanship for one (1) year from the purchase of the Product ("Warranty Period"). This Product must be purchased from an authorized dealer of Rocketfish brand products and packaged with this warranty statement. This warranty does not cover refurbished Product. If you notify Rocketfish during the Warranty Period of a defect covered by this warranty that requires service, terms of this warranty apply.

### How long does the coverage last?

The Warranty Period lasts for one year (365 days), beginning on the date you purchased the Product. The purchase date is printed on the receipt you received with the product.

### What does this warranty cover?

During the Warranty Period, if the original manufacture of the material or workmanship of the Product is determined to be defective by an authorized Rocketfish repair center or store personnel, Rocketfish will (at its sole option): (1) repair the Product with new or rebuilt parts; or (2) replace the Product at no charge with new or rebuilt comparable products or parts. Products and parts replaced under this warranty become the property of Rocketfish and are not returned to you. If service of Products and parts are required after the Warranty Period expires, you must pay all labor and parts charges. This warranty lasts as long as you own your Rocketfish Product during the Warranty Period. Warranty coverage terminates if you sell or otherwise transfer the Product.

### How to obtain warranty service?

If you purchased the Product at a retail store location, take your original receipt and the Product to the store you purchased it from. Make sure that you place the Product in its original packaging or packaging that provides the same amount of protection as the original packaging. If you purchased the Product from an online web site, mail your original receipt and the Product to the address listed on the web site. Make sure that you put the Product in its original packaging or packaging that provides the same amount of protection as the original packaging.

### Where is the warranty valid?

This warranty is valid only to the original purchaser of the Product in the United States, Canada, and Mexico.



## What does the warranty not cover?

This warranty does not cover:

- Customer instruction
- Installation
- Set up adjustments
- Cosmetic damage
- Damage due to acts of God, such as lightning strikes
- Accident
- Misuse
- Abuse
- Negligence
- Commercial use
- Modification of any part of the Product, including the antenna

This warranty also does not cover:

- Damage due to incorrect operation or maintenance
- Connection to an incorrect voltage supply
- Attempted repair by anyone other than a facility authorized by Rocketfish to service the Product
- Products sold as is or with all faults
- Consumables, such as fuses or batteries
- Products where the factory applied serial number has been altered or removed

REPAIR REPLACEMENT AS PROVIDED UNDER THIS WARRANTY IS YOUR EXCLUSIVE REMEDY. ROCKETFISH SHALL NOT BE LIABLE FOR ANY INCIDENTAL OR CONSEQUENTIAL DAMAGES FOR THE BREACH OF ANY EXPRESS OR IMPLIED WARRANTY ON THIS PRODUCT, INCLUDING, BUT NOT LIMITED TO, LOST DATA, LOSS OF USE OF YOUR PRODUCT, LOST BUSINESS OR LOST PROFITS. ROCKETFISH PRODUCTS MAKES NO OTHER EXPRESS WARRANTIES WITH RESPECT TO THE PRODUCT, ALL EXPRESS AND IMPLIED WARRANTIES FOR THE PRODUCT, INCLUDING, BUT NOT LIMITED TO, ANY IMPLIED WARRANTIES OF AND CONDITIONS OF MERCHANTABILITY AND FITNESS FOR A PARTICULAR PURPOSE, ARE LIMITED IN DURATION TO THE WARRANTY PERIOD SET FORTH ABOVE AND NO WARRANTIES, WHETHER EXPRESS OR IMPLIED, WILL APPLY AFTER THE WARRANTY PERIOD. SOME STATES, PROVINCES AND JURISDICTIONS DO NOT ALLOW LIMITATIONS ON HOW LONG AN IMPLIED WARRANTY LASTS, SO THE ABOVE LIMITATION MAY NOT APPLY TO YOU. THIS WARRANTY GIVES YOU SPECIFIC LEGAL RIGHTS, AND YOU MAY ALSO HAVE OTHER RIGHTS, WHICH VARY FROM STATE TO STATE OR PROVINCE TO PROVINCE.

Contact Rocketfish:

For customer service please call 1-800-620-2790

[www.rocketfishproducts.com](http://www.rocketfishproducts.com)

Distributed by Best Buy Purchasing, LLC

7601 Penn Avenue South, Richfield, Minnesota, U.S.A. 55423-3645

© 2014 Best Buy Enterprise Services, Inc.

All rights reserved. ROCKETFISH is a trademark of Best Buy Enterprise Services, Inc.

Registered in some countries. All other products and brand names are trademarks of their respective owners.



[www.rocketfishproducts.com](http://www.rocketfishproducts.com) (800) 620-2790

Distributed by Best Buy Purchasing, LLC

7601 Penn Avenue South, Richfield, MN 55423-3645 USA

© 2014 BBY Solutions, Inc.

All rights reserved. ROCKETFISH is a trademark of BBY Solutions, Inc.

All other products and brand names are trademarks of their respective owners.