



**Product:** 36 INCH PROFESSIONAL ELECTRIC RANGE IN BLACK  
**Model Number:** RSE36PB

### TECHNICAL DETAILS

Fuel Type	Electric
Installation Type	Freestanding
Burner Type	Radiant
Type of Grate	Glass-Ceramic
Required Circuit	50A
Volts (V)	240V
Frequency (Hz)	60Hz
Control Type	Knob
Plug Type	nema 14-50p
Power Cord Length (in.)	Canada only. Not included in USA/Mexico

### FEATURES & BENEFITS

- + Glass-Ceramic Cooktop:** Sleek, durable surface withstands high heat and wipes clean with ease.
- + High Performance Burners:** Featuring a minimum output of 100 watts for gentle warming and a maximum of 3,000 watts for high-intensity cooking.
- + 6.0 cu. ft. Oven Capacity –** Spacious oven easily fits large baking sheets, roasting pans, and multiple dishes at once.
- + Panoramic Viewing Window:** Take a look inside the oven through the panoramic viewing window for a full, clear view of your dishes as they cook, allowing you to monitor progress without opening the door.
- + Powerful Broil Element:** The oven broiler features a 3,500 watts tube for quick and efficient broiling.
- + True Convection Fan:** 1300W heating element with manual fan control delivers on-demand, even heat for pro-level baking and roasting.
- + Telescopic Oven Rack:** Glides smoothly on rails for safe, easy access to hot cookware.
- + Hidden Bake Element:** Hidden bake element is positioned below the oven floor, creating a smooth oven surface so spills are easy to clean without maneuvering around heating elements.
- + White Projector Light on Panel:** The panel is illuminated by a white projector light, ensuring easy visibility and a modern look.





BLACK  
RSE36PB-BLK



BLUE  
RSE36PB-BLU



BRONZE  
RSE36PB-BRZ



ROSE GOLD  
RSE36PB-RSG

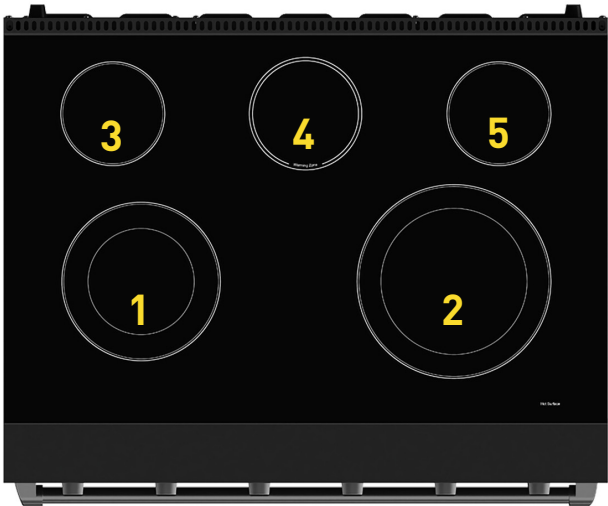

COOKTOP PERFORMANCE	
Total Number Of Cooktop Elements	5
(1) Front Left Burner 6"/9"	3,000W (Dual)
(2) Front Right Burner 9"/12"	3,000W (Dual)
(3) Rear Left Burner 6"	1,200W
(4) Rear Center Burner 6"	100W
(5) Rear Right Burner 6"	1,200W

OVEN	
Oven Capacity	6.0 cu. ft.
Oven Control Features	Light on/off, Convection Fan
Oven Cooking Modes	Bake, Broil
Bake Element Power	3,500W
Broil Element Power	3,500W
Convection	True Convection 1300 W
Oven Lights	Yes
Oven Racks (Standard)	1
Oven Racks (Telescopic)	1
Baking Sheet Size	Fits Standard Three-Quarter Sheet Pan
Self Clean	No
Oven Internal Width	29-3/4"
Oven Internal Depth	19-1/2"
Oven Internal Height	18"

PRODUCT DIMENSIONS & WEIGHTS	
Product Dimensions (WxDxH)	35-3/4" x 24" x 36"
Product Height (From Bottom To Top Of Back Splash)	36-1/8"
Product Height (From Bottom To Top Of Side Panel)	34-9/16"
Product Depth (From Back Panel To Bullnose)	28-1/4"
Product Depth (From Back Panel To Control Panel)	27"
Product Depth (From Back Panel To Side Panel Front)	24"
Packaging Dimensions (WxDxH)	39" x 30-1/8" x 44-1/2"
Adjustable Height	1"
Net Weight	227 lbs
Gross Weight	268 lbs

ACCESSORIES (INCLUDED)	
	1 Standard Rack
	1 Telescopic Rack
	1 Broiler Pan Set

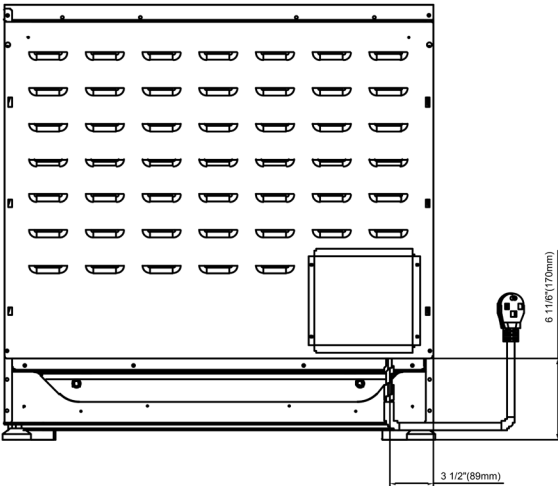
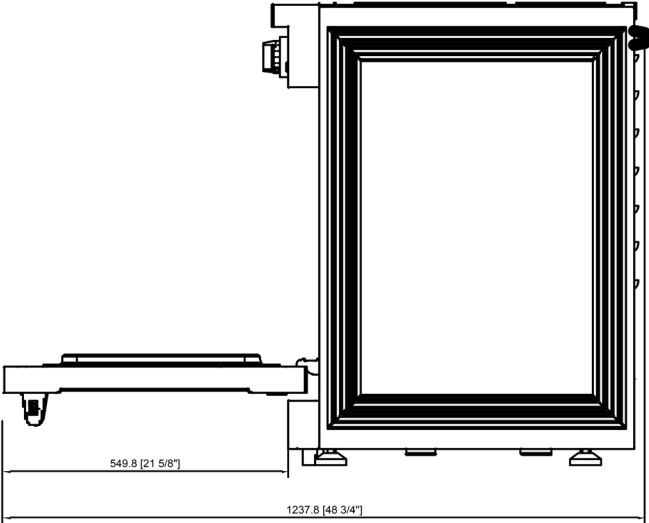
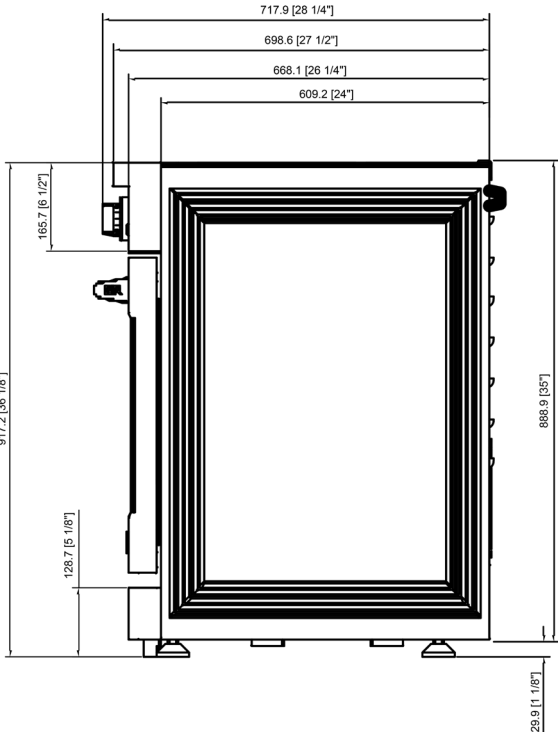
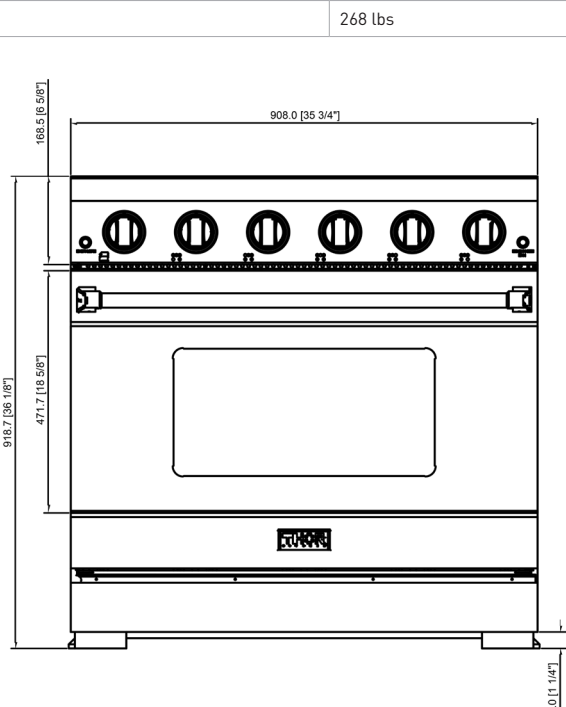

(Power cord is not included in US/Mexico market)