

ecozy

SPHERE ICE MAKER

IM-BM401C

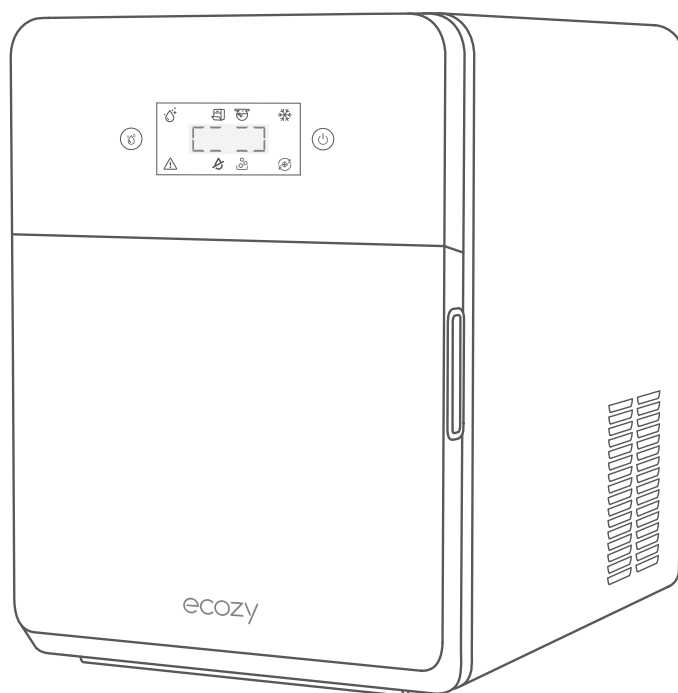

User Manual

Please read these instructions before using your ice maker and keep them in a safe place for future reference.

Thank you for purchasing from ecozy.
If you have any questions or need further assistance,
please contact us at
support@ecozy.com
or call us via hotline
(443) 991-8777 (UTC 14:00-22:00, Monday to Friday).

CONTENTS

- SAFETY INSTRUCTIONS 01
- PACKAGE CONTENTS 02
- PRODUCT OVERVIEW 03
 - Ice Maker 03
 - Control Panel & LED Display 04
- BEFORE FIRST USE 05
- WATER HOSE CONNECTION 07
 - Connect the Water Supply Hose to the Ice Maker 07
 - Connect the Water Drain Hose 08
 - Connect the Water Supply Hose to the Water Supply System 09
- USE YOUR ICE MAKER 09
 - Add Water 09
 - Self-Cleaning Mode 10
 - Start/Stop Making Ice 10
 - Ice Full 11
 - Water Drain 11
 - Light 12
- SPECIFICATIONS 12
- TROUBLESHOOTING 12

SAFETY INSTRUCTIONS

- Disconnect power before servicing.
- Do not pull directly on wire when plugging or unplugging the unit.
- If ice is abnormal, please contact our service team.
- It is normal for the compressor and condenser surface to reach temperatures between 158°F (70°C) and 194°F (90°C) during operation and surrounding areas may be hot. Please don't touch it.
- Due to fast freezing, ice balls may appear “Cloudy”. This is trapped air in the water and it will not affect quality or taste of ice.
- If the supply cord is damaged, it must be replaced by the manufacturer or its service agent or a similarly qualified person in order to avoid a hazard.
- This appliance can be used by children aged from 8 years and above and persons with reduced physical, sensory or mental capabilities or lack of experience and knowledge if they have been given supervision or instruction concerning use of the appliance in a safe way and understand the hazards involved.
- Children shall not play with the appliance.
- Cleaning and user maintenance shall not be made by children without supervision.
- During transportation, the incline angle of the cabinet should not be over 45°. Do not turn the Ice maker upside down. As this may damage the compressor and sealed system.
- Do not install the Ice maker near an oven, radiator, or any other heat source.
- Ensure that the voltage indicated on the ice maker corresponds with the voltage in your home.
- WARNING: Fill with drinking water only. Do not fill with fruit juices or other drink types.
- WARNING – Keep the air vents on the sides of the machine unblocked at all times.
- WARNING – Do not use mechanical devices or other means to accelerate the defrosting process, other than those recommended by the manufacturer.
- WARNING – Do not damage the refrigerant circuit.

PACKAGE CONTENTS

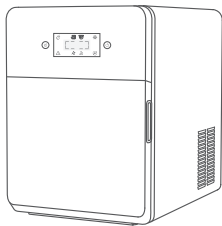

Ice Maker x 1

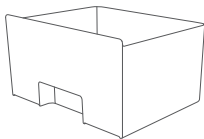

Ice Basket x 1 (Preinstalled)



Ice Tongs x 1

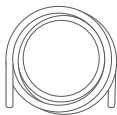

1.5m Water Drain Hose
(Transparent) x 1

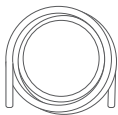

2m Water Supply Hose
(White) x 1



Water Supply Hose
Connector x 1



Water Drain Hose
Connector x 1



Water Tray x 1



User Manual x1



Quick Guide x 1



Water Inlet/Drain Port Plug x 2

* If there is any part missing, please contact our customer service: support@ecozy.com.

PRODUCT OVERVIEW

Ice Maker

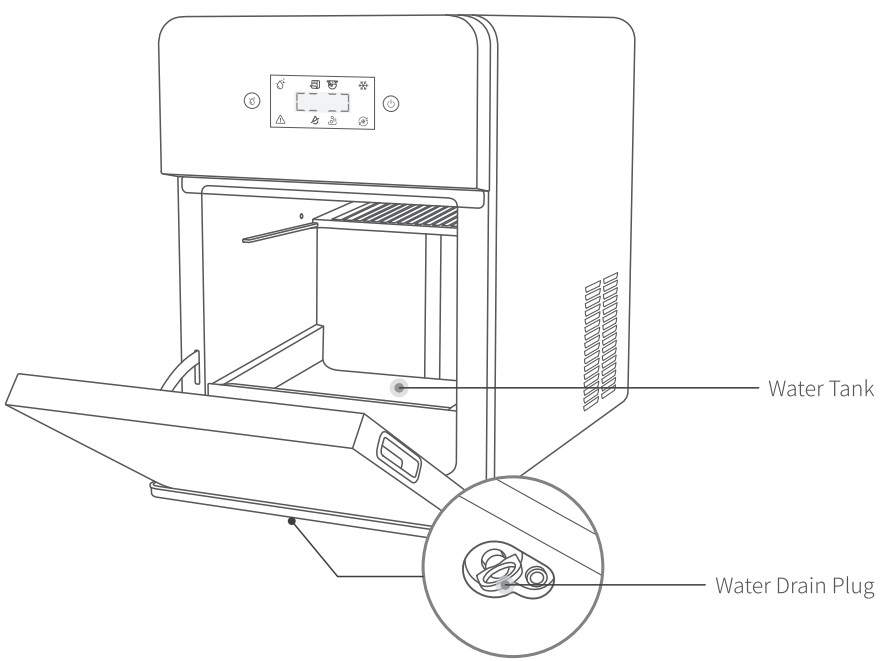
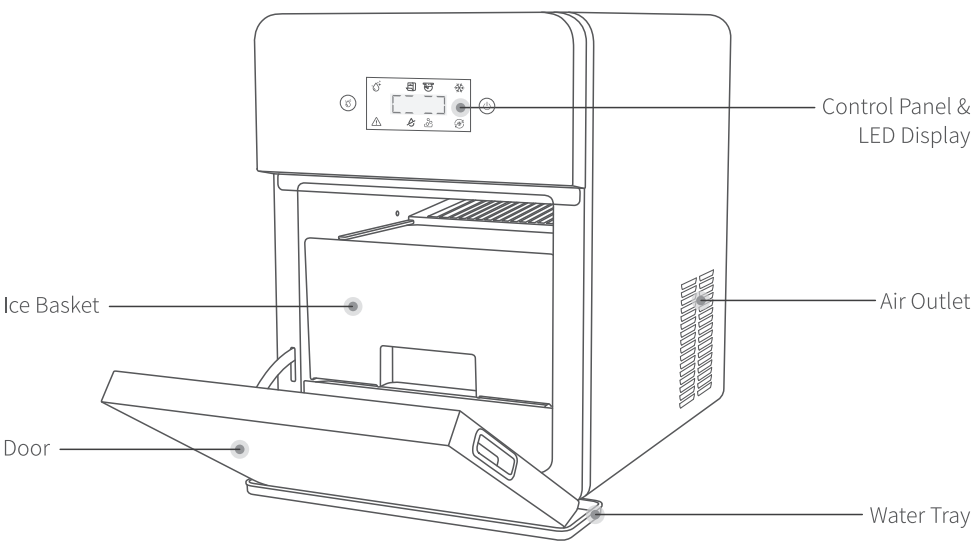

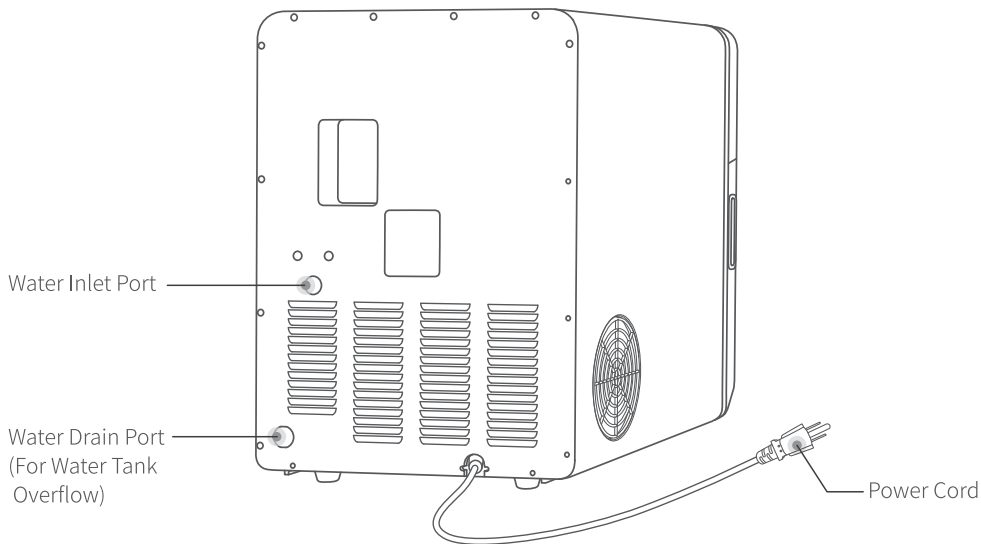

Control Panel & LED Display



Start/Stop Button

Press once to start/stop ice-making;
press and hold for 5 seconds to reset the machine.



Cleaning/Mute Button

In standby mode, press once to start/stop the self-cleaning process; press and hold for 3 seconds to mute/unmute the sound.



Cleaning Indicator

Lights up when the machine is performing self-cleaning.



Door Open Indicator

Flashes when the door is open.



Ice Harvesting Indicator

Lights up during ice harvesting or defrosting.



Ice Making Indicator

Lights up when the machine is making ice.



Cooling Indicator

Lights up when the ice maker enters cooling mode to keep the ice balls cold.



Ice Full Indicator

Lights up when the ice storage is full.



Add Water Indicator

Lights up when there is insufficient water in the water tank.



Error Warning

Ice harvesting error; Infrared sensor error.

BEFORE FIRST USE

- 1 Unpack the ice maker, then remove all the packaging materials.
- 2 Clean the interior of the ice maker, ice basket and ice scoop with warm water and a soft cloth 3-5 times to remove possible odor or residue caused by the manufacturing or transportation.
- 3 Place the ice maker on a flat, level surface in a location where your ice maker is protected from direct sunlight and other sources of heat (such as a stove, furnace, or radiator).

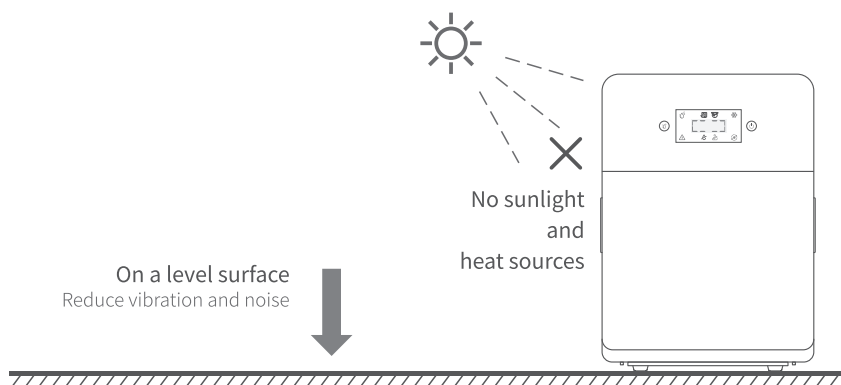

- 4 Make sure to leave at least 6 inches (15 cm) clearance on all sides of the ice maker for proper air circulation. Then attach the drip tray to the ice maker.

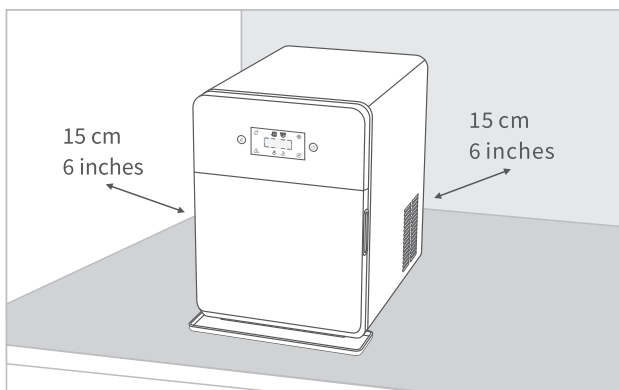

- 5 For a steady water supply and drainage when the water tank is full, it's recommended to connect the water supply and drain hoses. Refer the **WATER HOSE CONNECTION** section for details.
- 6 Before plugging in, please let the ice maker stand upright for 2 hours to allow the refrigerant to settle, ensuring the door is open.
- 7 Plug the ice maker into a well-grounded outlet.

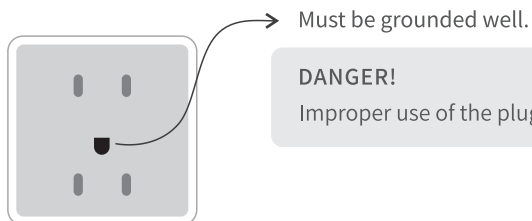

DANGER!

Improper use of the plug may result in the risk of electrical shock.

* There may be water vapor in the product, which is normal because we have tested all our products before they left the factory.

WATER HOSE CONNECTION

Connect the Water Supply Hose to the Ice Maker

Tip:

If not using the water supply hose, remove the clip from the back water inlet port, seal it with the plug from the accessory bag, and reattach the clip. Then skip the following step.

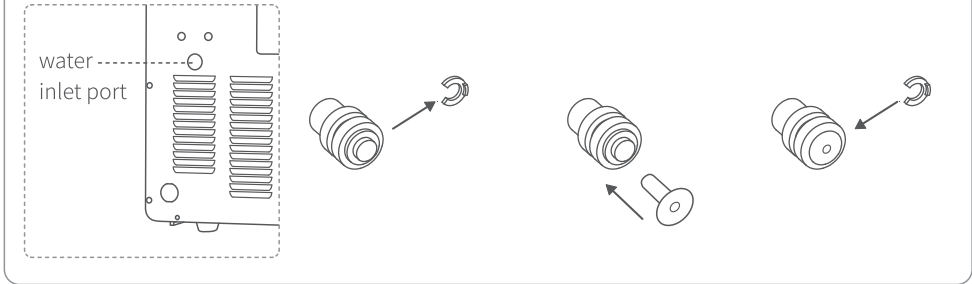

Remove the clip from the back water inlet port, insert one end of the water supply hose deeply into the port, and reattach the clip.

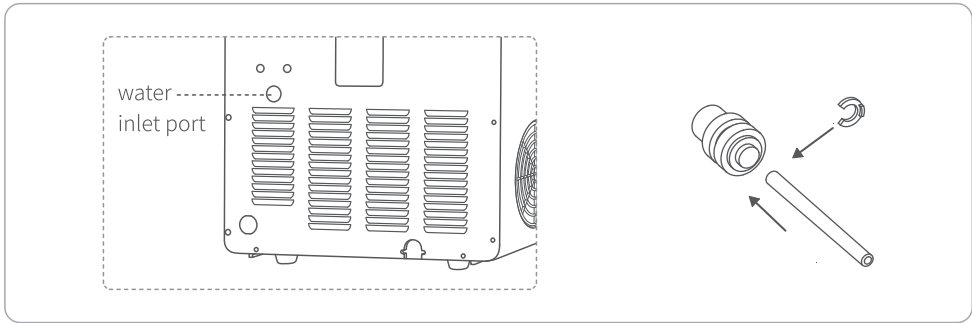

Connect the Water Drain Hose

Tips:

* If not using the water drain hose, remove the clip from the back water drain port, attach the drain hose connector, secure it with the clip, seal the connector with the plug, and skip the following steps.

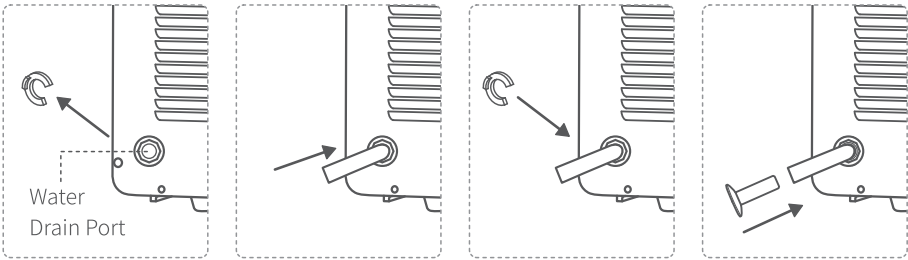

* The back drain port is used to drain water when the water tank is full. To fully drain the water in the ice maker, unplug the bottom drain port.

- 1 Remove the clip from the back water drain port, insert the water drain hose connector into the port, and reattach the clip.
- 2 Insert one end of the water drain hose into the connector and connect the other end to the water drain pipeline.

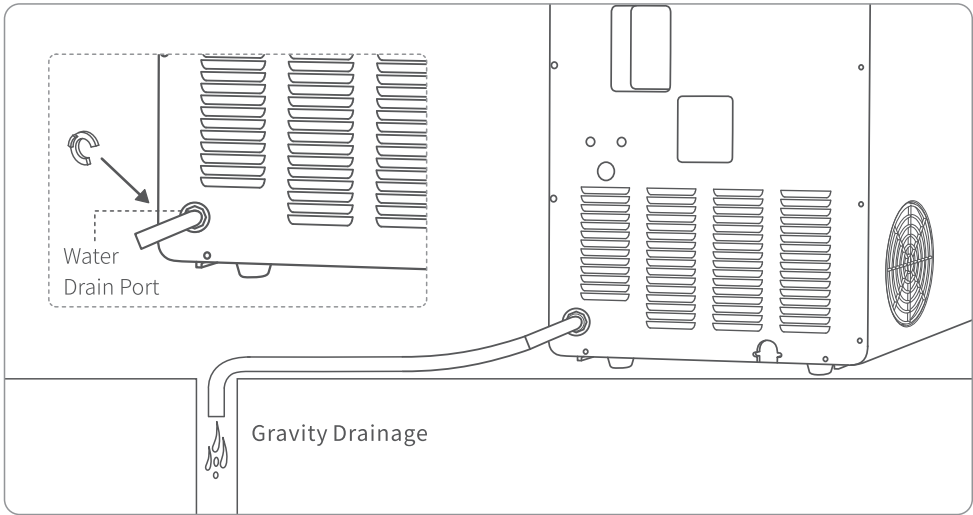

Connect the Water Supply Hose to the Water Supply System

- 1 Install the provided water supply hose connector onto the water faucet of the main water supply system and remove the clip from the connector.
- 2 Insert the other end of the water supply hose fully into the connector port, then reattach the clip.

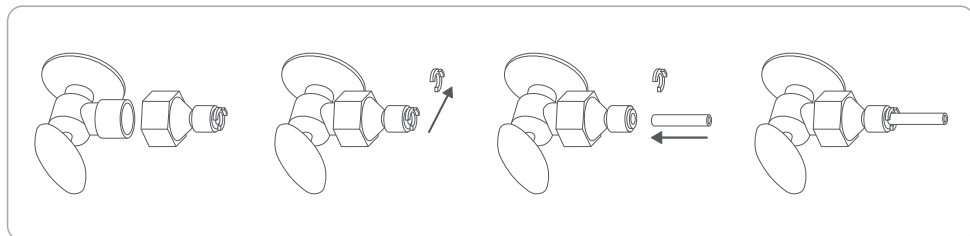

Notes:

- * The water faucet is not included in the package.
- * Connect to the potable water supply system only.

USE YOUR ICE MAKER

Add Water

Option 1:

Open the door, remove the ice basket, then fill the water tank with clean drinking water. Make sure that the water level is below the **water drain port**. After adding water, please place the ice basket back and close the door.

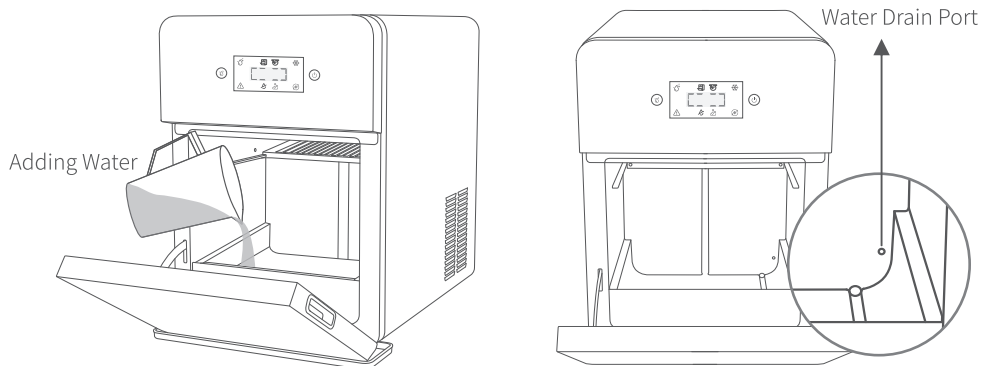

Option 2:

Connect the ice maker's water inlet port to the water supply system as instructed above. The water will automatically add to the water tank.

Notes:

- * The **Add Water** indicator lights up when there is not enough water in the water tank. Please add water in time.
- * Please use clean drinking water. Do not use beverages including sparkling water or coke.

Self-Cleaning Mode

It is recommended to run the self-cleaning process before the first use or after the ice maker is unused for over 48 hours.

After plugging in the ice maker, the ice maker is in standby mode. Fill the water tank with lukewarm water, then press the **Cleaning/Mute** button to start self-cleaning. The self-cleaning process consists of 3 cycles and takes about 3 minutes to complete. During the cleaning process, the  indicator will be on.



To stop the cleaning process, press the **Cleaning/Mute** button once.

Start/Stop Making Ice

After plugging in the ice maker and adding enough clean drinking water, press the **Start/Stop** button. The ice maker will start making ice, with  staying lit. To stop making ice, simply press the **Start/Stop** button again.



Tip:

The ice-making cycle typically lasts about 35 minutes but may vary slightly depending on ambient and water temperatures. The initial cycles may take longer.

After the ice-making cycle finishes, the ice maker will automatically enter the ice-harvesting process, with  staying lit. This process takes about 5 minutes. Then the ice balls will drop into the ice basket.

Ice Full

The indicator  will light up when the ice full sensor detects that the ice basket is full. Please remove the ice, and then the ice maker will resume working.

Water Drain

After the ice maker finishes the ice-making or self-cleaning, move the ice maker to the edge of the counter and take out the Water Drain Plug at the bottom of the ice maker to drain the water.

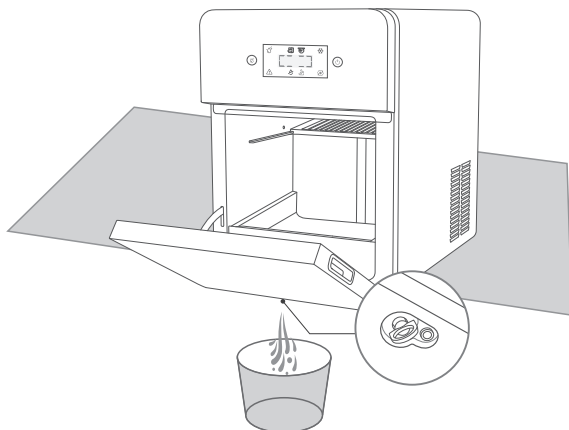

Light

Opening the door automatically turns on the light, allowing you to monitor the ice-making process.

SPECIFICATIONS

Model	IM-BM401C
Power Supply	110V/60 Hz
Power Consumption	260W
Rated Current	2.5 A
Refrigerant	R290/0.882 Ounces
Net Weight	35.27 lbs/16kg
Dimensions	17.91x12.6x17.91 inches/455x320x455mm
System Pressure	High Side 280 psig; Low Side 90 psig

TROUBLESHOOTING

Issue	Possible Cause(s)	Solution
Compressor works abnormally with a buzzing noise	Voltage lower than recommended	Stop the ice maker and wait until the voltage is normal before restarting.
	Not rest for 2 hours after transportation	Stop immediately, place the machine on a flat surface for 24 hours, then restart.
Add Water indicator lights up	Water level too low	Fill the water tank with water below the drain port or ensure water is added via the supply hose. Then press the Start/Stop button to resume operation.
	Air trapped in the pump	Remove the bottom drain plug, let a few drops of water flow out, then restart.

Issue	Possible Cause(s)	Solution
 appears on the display	Ice harvesting failed and machine not working	Press and hold the Start/Stop button for 5 seconds to reset the machine and then restart. Or, unplug the ice maker, wait a moment, then plug it back in and restart.
	Infrared sensor error	
Machine runs, but water gets warmer	Magnetic valve not working	Turn on the machine for 1 minute, then turn it off and unplug. Repeat this process 5 times, then restart it.
	Magnetic valve error	
Ice is made, but won't drop from evaporator	Magnetic valve error	Unplug the ice maker, wait for 30 minutes, then plug it back in. If the problem persists, contact customer support.
Ice making process seems correct, but no ice is made	No refrigerant in the compressor	Unplug the ice maker, then plug it back in and try again.

If there is any issue unresolved, please contact us at: support@ecozy.com.



Intertek

3078034

Conforms to UL STD.563
Certified to CSA STD.C22.2
No.120