

WiFi Smartphone+APP Rear View Parking System

user's manual

VTL500R

1. Parts list



A Wireless transmission camera×1



B Monitor power extending line×2



C Cigarette lighter power line×1



D Screw×2



E User's manual×1

2. Testing

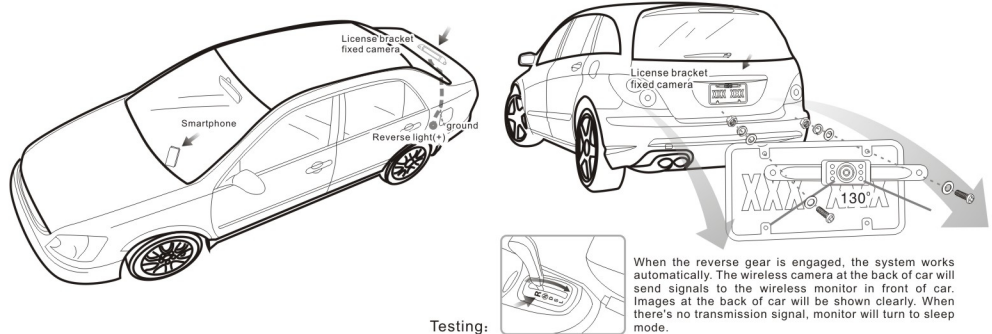

3. Preparations

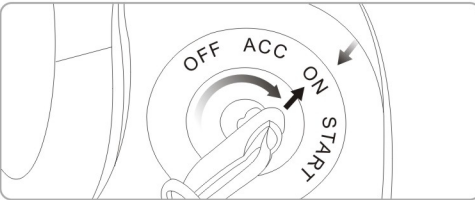

① Turn the key to the on, the power of the car is on.

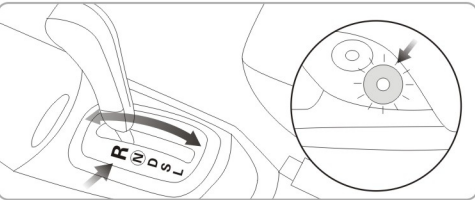

② Turn to the reverse gear, the reverse light is on

4. Camera installation

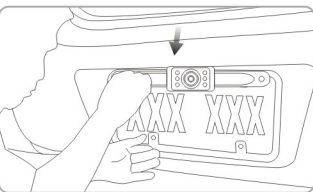
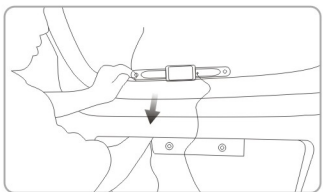
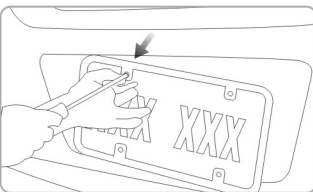

①Take down the license plate. ②Tow the camera power line into the car though the interstices of the car. ③Install the camera onto the license plate, fix it with the spared screws.

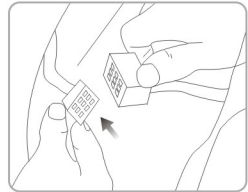

④Find the power lines from the trunk at the back of car. Cut off the power of car.

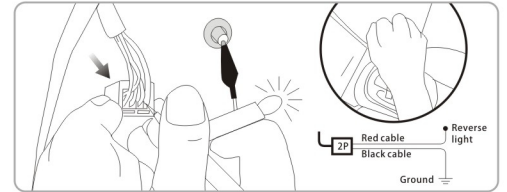

⑤Black clamp connects to any iron part of car. Use the red pen to test every power line from the reverse light until the LED light is on. Then you can ensure that this is the power line.

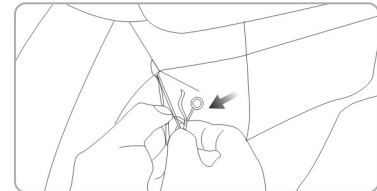

⑥Connect the camera power line to the reverse light power line, anode to anode, cathode to cathode, then fix the cables with the rubberized fabric.

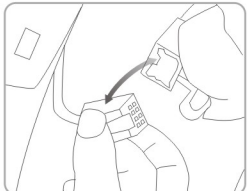

⑦Connect the power lines as before.

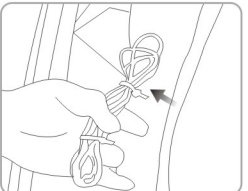

⑧Enlace and hind other lines properly.

5. Android phone connection

Open the phone settings → WLAN → Search and connect "SmartCar-XXXXXXXXXXXX"

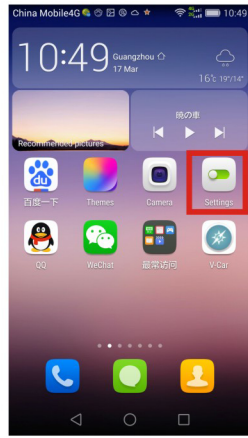

Click app icon

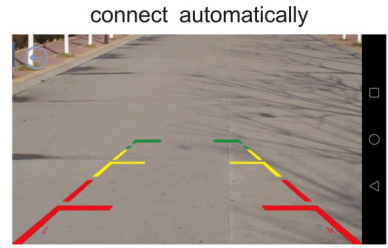
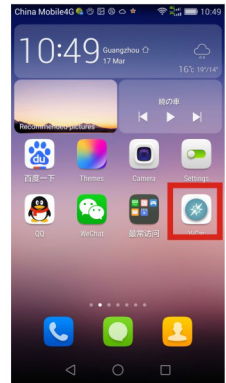
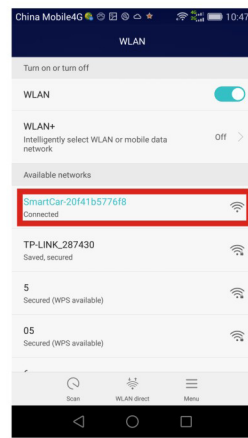
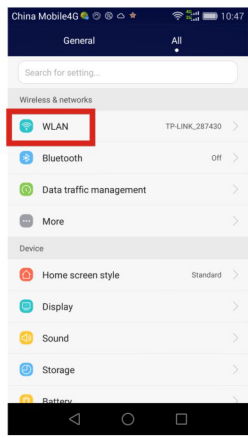

connect automatically