

Stinger®

6.8"
Infotainment
System

Wireless

Works with
Apple CarPlay
Works with
Android Auto

PN: IE268



IE268

Install / Quick Setup Guide



Scan For Detailed User Guide

<https://stingerdrive.com/pages/ie268-welcome>

SiriusXM
READY

Bluetooth®



Included **Parts**

QTY	Description	Part NO
1	Radio Module	IE268
1	Radio Harness	-
1	GPS Antenna	PSEH-1109
1	External Microphone	PSEH-1108
1	Radio Trim	-
1	Radio Cage	-
6	Mounting Screws	-

Radio **Wiring**

Color	Polarity	Function
Yellow	+	Constant 12 volt power source regardless of key position.
Red	+	Accessory 12-volt power source that is active when the key is in the ACC or ON position.
Black	-	Chassis ground.
Orange	+	Illumination wire. Provides 0 volts when the lights are off and 12 volts when the vehicle exterior lights are on.
Lt Green	-	Parking brake, vehicle provides a ground signal when parking brake is engaged.
Blue	+	Power antenna, provides 12 volts from the receiver when the FM or AM radio is being used. Turns off on any other source.

Radio **Wiring Cont**

Color	Polarity	Function
Blue/ White	+	Amplifier turn on, provides 12 volts from the receiver when receiver is turned on.
Pink	+	V.S.S. – Vehicle speed sense (Recommended)
White/ Grey	+	Camera 2 Trigger (Optional)
White/ Green	+	Camera 3 Trigger (Optional)
White/ Purple	+	Camera 4 Trigger (Optional)
White	+	Left Front Speaker
White/ Black	-	Left Front Speaker
Grey	+	Right Front Speaker
Grey/ Black	-	Right Front Speaker
Green	+	Left Rear Speaker
Green/ Black	-	Left Rear Speaker
Purple	+	Right Rear Speaker
Purple/ Black	-	Right Rear Speaker
Brown	Input	SWC 1 (Steering Wheel Control 1)
Brown/ Black	Input	SWC 2 (Steering Wheel Control 2)
Orange 3.5	Input	SWC input to Radio



Installation **Notes**

- When connecting optional steering wheel controls, please refer to SWC manufacture's wiring instructions to connect.
- The IE268 Power harness should color match wire colors of vehicle specific harness being used to connect to vehicle. This harness is sold separately.
- It is not advised to remove OEM radio plugs to wire IE268 directly. A vehicle specific harness is needed.
- If searching for a vehicle specific harness, please visit **www.PAC-Audio.com**.
- When making wire connections, soldering or using proper butt connectors is recommended.
- No exposed wire strands should remain after making connections.
- Do not plug the wire harness into the vehicle until all wire connections have been completed and verified to be secure, with no exposed wires or wire strands.

Installation **Notes Cont**

- If wires are unused, tape and secure wire ends for safety and to avoid unwanted failures.
- If the radio does not power on when the vehicle is started after installation is complete, verify that all wiring connections are correct and secure. Also verify that there are no blown fuses in the vehicle's fuse panels.

Wire **Diagram**

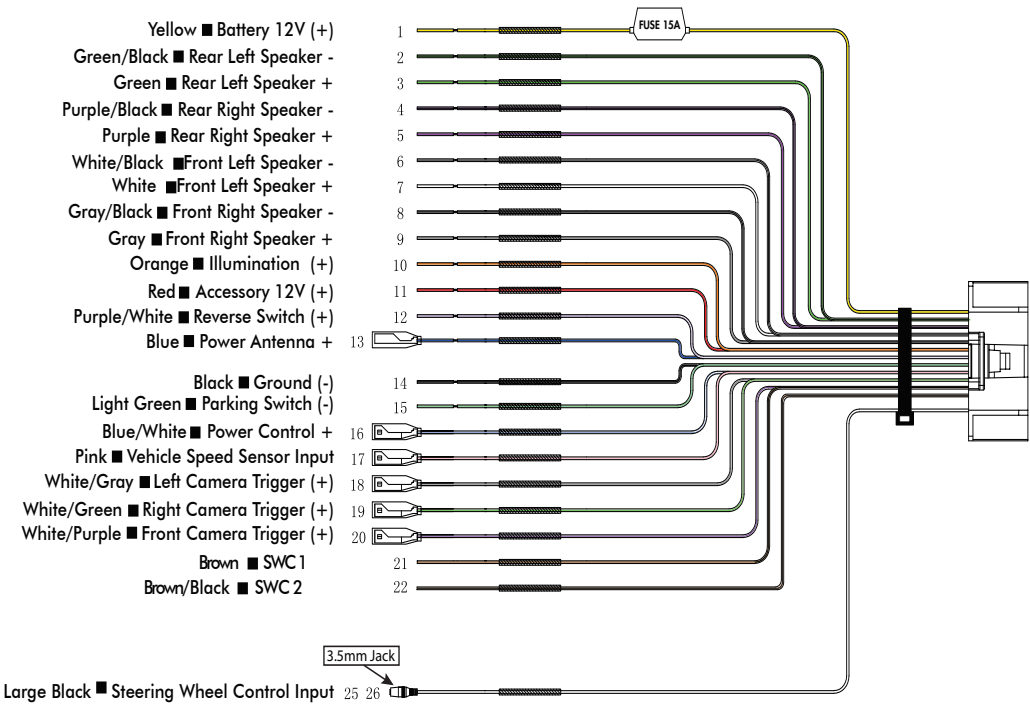



Radio Connections

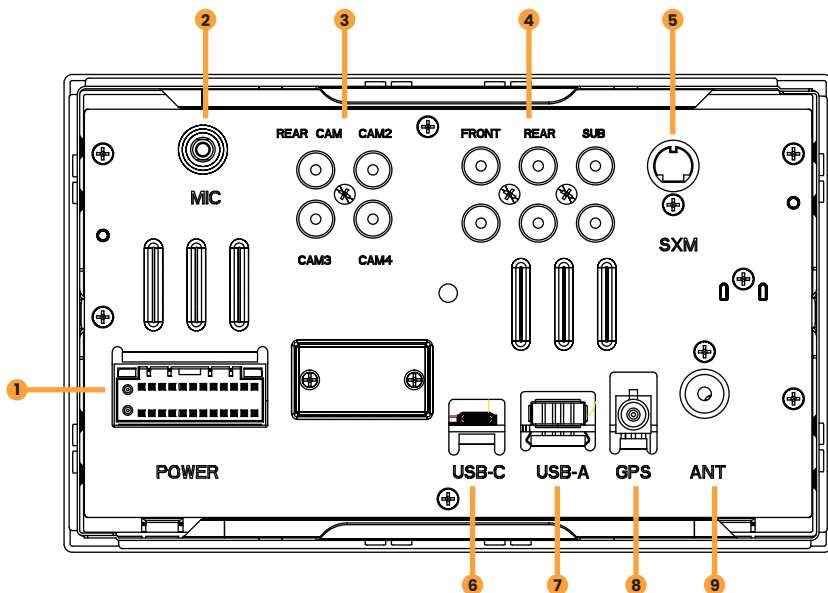

1. Power Connection

Main radio harness connection for power and factory wired speakers.

2. External Mic Connection (optional)

3.5mm connection for External Microphone.

3. Camera Connection

Yellow RCA terminals allowing up to 4 camera connections.

4. RCA Audio Outputs

RCA outputs to allow connection to aftermarket amplifiers.

5. SiriusXM Connection

Used when adding (optional) SXM Tuner **Sold Separately**.

6. USB-C Connection

Used for wired CarPlay/Android Auto and phone charging. **Additional Cable Required**

7. USB-A

Used for Firmware updates, USB media, and phone charging. **Additional Cable Required**

8. GPS Antenna Connection

Port to connect provided GPS antenna.

9. AM/FM Antenna Connection

Factory radio antenna connection.

THE BASICS



1. Reset Button

Used to factory reset the radio.

2. Home Menu Button

Tap: Access the Home Menu. Dimmed menu items are not selectable.

3. Voice Button

Launches voice control.

4. Mute Button

Mutes all Audio.

5. Volume Control

Increase or decrease volume

6. Power Button

Long press to power unit off / on.

7. Clock

Tap: Adjust Clock Settings.

8. Phone Status

Displays CP/AA connection. Phone service level and battery life.

9. Home Menu

Tap: Launch selected app.

GETTING STARTED

Clock

Source / Info

Connected Devices



POWER UP!

With vehicle ignition in the ON or ACC position, the radio will automatically power on.

The radio will automatically return to the last source used before the iE268 was powered off.

You can adjust the audio volume at start-up in **Audio Settings**.

The **Information Bar** is located at the top of the screen. Depending on the selected source, the Information Bar will display source information or content-sensitive controls. Also, displays time, phone info and Android Auto or CarPlay connection status.

To select a SOURCE, press the HOME button. Sources that are not currently available are grayed out.

Display Off

Press **Home Button > Swipe left > Display Off** to turn off your iE268.

This is useful at night to help reduce eye fatigue.

Tap anywhere on the screen to turn the display back on.

GET CONNECTED

1. Swipe left on the home screen and tap Device List.

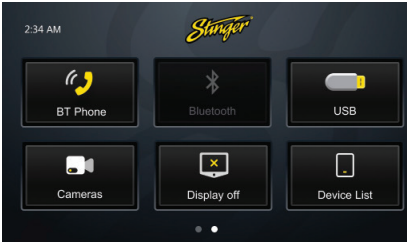

2. Make sure your device is in pairing mode and tap + Add a Device.

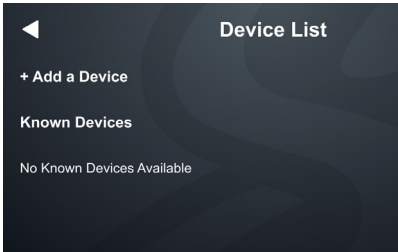

3. Select your device from the list.



If your device does not appear in the device list, confirm it is discoverable and tap Available Devices to rescan.

4. Confirm PIN Code on the head unit screen and the device.

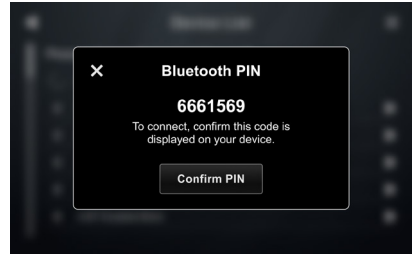

5. Select the connection type you want to use with your device (Bluetooth / CP & AA).

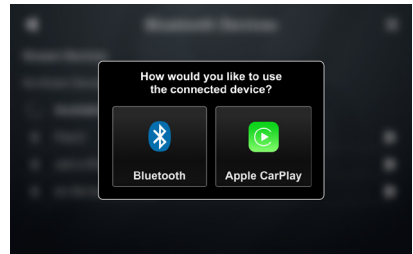

If you choose CP/AA, your phone application will launch automatically.

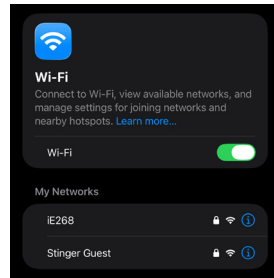

Note: When Wireless CarPlay or Android Auto is connected, a Wi-Fi network will appear on your device. The iE268 does not have built-in Wi-Fi, and no manual Wi-Fi connection is required through the device's Wi-Fi menu.



System Firmware Updates

Checking and updating the System Firmware is an important step for proper operation. This should be done first before setting any system and vehicle settings as those settings may be lost after an update.

Make sure a thumb drive containing your firmware update is inserted into an available USB port and tap System Firmware Update.

You can find firmware updates on the [iE268 Product Page](#)



FCC Statement

This equipment has been tested and found to comply with the limits for a Class B digital device, pursuant to part 15 of the FCC Rules. These limits are designed to provide reasonable protection against harmful interference in a residential installation. This equipment generates, uses and can radiate radio frequency energy and, if not installed and used in accordance with the instructions, may cause harmful interference to radio communications. However, there is

no guarantee that interference will not occur in a particular installation. If this equipment does cause harmful interference to radio or television reception, which can be determined by turning the equipment off and on, the user is encouraged to try to correct the interference by one or more of the following measures:

- Reorient or relocate the receiving antenna.
- Increase the separation between the equipment and receiver.
- Connect the equipment into an outlet on a circuit different from that to which the receiver is connected.
- Consult the dealer or an experienced radio/TV technician for help.

This device complies with Part 15 of the FCC Rules. Operation is subject to the following two conditions:

- (1) this device may not cause harmful interference, and
- (2) this device must accept any interference received, including interference that may cause undesired operation.

Any changes or modifications not expressly approved by the party responsible for compliance could void the user's authority to operate the equipment.

This device complies with FCC radiation exposure limits set forth for an uncontrolled environment. This equipment should be installed and operated with minimum distance of 20 cm between the radiator and your body.



Apple CarPlay is a trademark of Apple Inc. Use of the Apple CarPlay logo means that a vehicle user interface meets Apple performance standards. Apple is not responsible for the operation of this vehicle or its compliance with safety and regulatory standards. Please note that the use of this product with iPhone, iPod, or iPad may affect wireless performance.

SiriusXM and all related marks and logos are trademarks of Sirius XM Radio Inc. All rights reserved.

Android, Android Auto, Google Play and other marks are trademarks of Google LLC.

The Bluetooth word mark and logos are registered trademarks owned by Bluetooth SIG, INC. and any use of such marks by Stinger is under license.

Stinger and the Stinger logo are trademarks or registered trademarks of Stinger in the United States and other countries.

IE268 and the IE268 logo are trademarks or registered trademarks of Stinger in the United States and other countries.

Visit stingerdrive.com for updates and further information.

TECHNICAL SUPPORT:

727-592-5991

CUSTOMER SOLUTIONS:

727-803-0285

E-MAIL:

Support@stingerdrive.com

Stinger

9620 Executive Center Dr N, STE 200
St. Petersburg, FL 33702

USER AGREEMENT: End user agrees to use this product in compliance with the instructions and terms of use and with all State and Federal laws. STINGER provides instructions and safety warnings with respect to this product and disclaims all liability for any use not in conjunction with those instructions or other misuse of its product. If you do not agree, please discontinue use and contact STINGER. This product is intended for off-road use and passenger use only.

Stinger[®]

SiriusXM
READY

 **Bluetooth**[®]