



With your inspiring rating, COSTWAY will be more consistent to offer you EASY SHOPPING EXPERIENCE, GOOD PRODUCTS and EFFICIENT SERVICE!

Mit Ihrer inspirierenden Bewertung wird COSTWAY konsistenter sein, um Ihnen EIN SCHÖNES EINKAUFSERLEBNIS, GUTE PRODUKTE und EFFIZIENTEN SERVICE zu bieten!

Avec votre évaluation inspirante, COSTWAY continuera à fournir une EXPÉRIENCE D'ACHAT PRATIQUE, des PRODUITS DE QUALITÉ et un SERVICE EFFICACE !

Con su calificación inspiradora, COSTWAY será más consistente para ofrecerle EXPERIENCIA DE COMPRA FÁCIL, BUENOS PRODUCTOS y SERVICIO EFICIENTE.

Con la tua valutazione incoraggiante, COSTWAY sarà più coerente per offrirti ESPERIENZA DI ACQUISTO FACILE, BUONI PRODOTTI e SERVIZIO EFFICIENTE!

Dzięki twojej opinii COSTWAY będzie mógł oferować jeszcze WYGODNIEJSZE ZAKUPY, LEPSZE PRODUKTY i SPRAWNIEJSZĄ OBSŁUGĘ KLIENTA.

US office: Fontana

UK office: Ipswich

DE office: FDS GmbH, Neuer Höltingbaum 36, 22143 Hamburg, Deutschland

FR office : 26 RUE DU VERTUQUET, 59960 NEUVILLE EN FERRAIN, FRANCE



GIANTEX

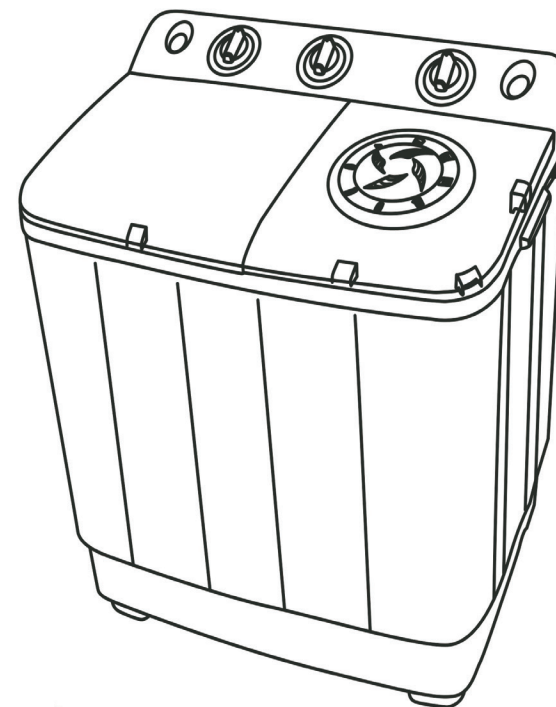

USER'S MANUAL

SEMI-AUTOMATIC WASHING MACHINE

FP10012US

NAME OF PARTS

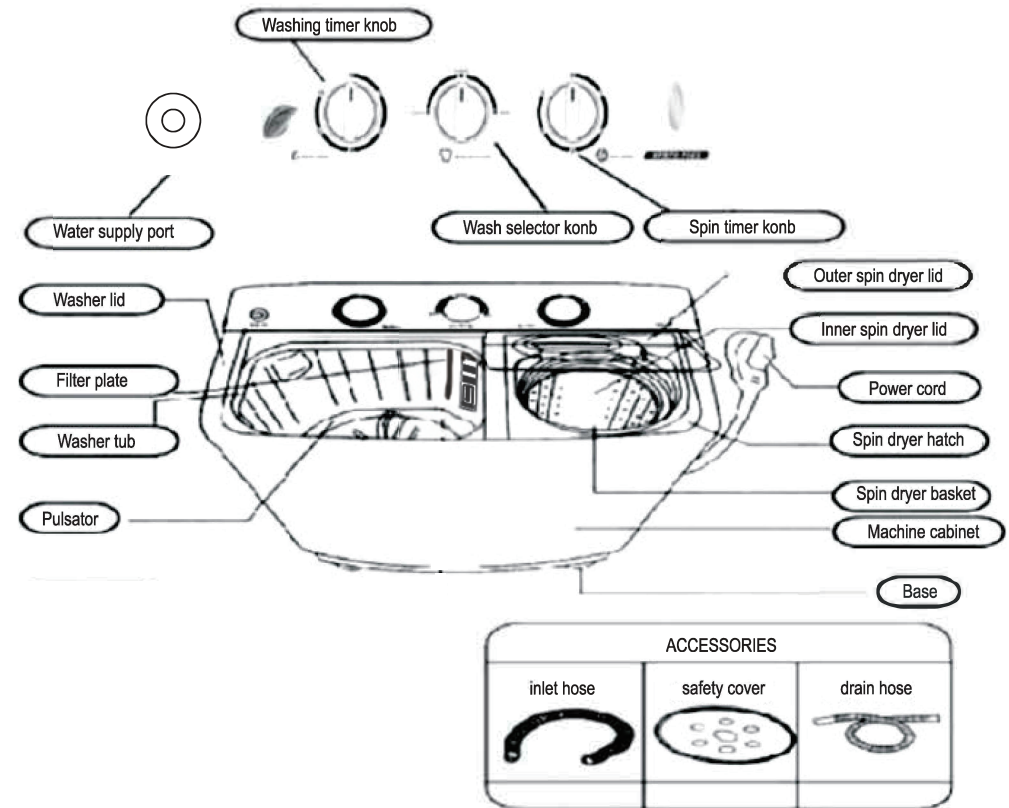

FUNCTION AND FEATURE

WITH PERFECT DESIGN AND PP SHELL, THE SEMI-AUTOMATIC WASHING MACHINE IS NEVER RUSTY WHEN WASHING.

DOUBLE-FLOW WATER LEVEL AND THE HANDWHEEL DESIGN MAKE IT EASIER TO CLEAN OFF THE GREASE AND DIRT ON THE CLOTHES. WASHING WITH DOUBLE-FLOW WATER LEVEL, IT HELPS GET THE CLOTHING OUT OF TWINING OR TWISTING AND CLEAN WITH LITTLE WEARING.

DISSOLVES WASHING POWDER QUICKLY AND FEATURES MORE EFFICIENT CLEANING THAN THE COMMON DOUBLE-TUBE WASHING MACHINE.

STRONG FUNCTIONS AND LOW NOISE. HANDWHEEL NEVER FRAYS.

After Washing

Pull out the plug, turn off the water tab and then hang up the drain pipe. Clean the drying machine and open its plastic cover to keep it dry.

Clean The Lint Filter

Please clean the lint filter after washing every time.

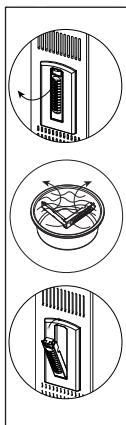

★ Take down the lint filter

★ Clean the lint filter with water

★ Put the bottom into the hole and then press it

Notice



Do not install the washing machine in places with sloping floor or ground.



Do not pour water on the switch.



When using warm water, the temperature deviation should not exceed 50°C (122°F).



Do not use gasoline, alcohol and other organic solvents to wash the machine.

WARNING

- ★ Please pull out the plug after washing.
- ★ Measure the distance between the drain pipe and the drain spigot before installation. The length of the drain pipe is 130 cm (51 ft).
- ★ Do not press the drain hose into the sewer.
- ★ If the inlet hose has air intake, the entrance of it should not be blocked.
- ★ This machine is not intended for use by children unless someone who understands how to operate it supervises or instructs the use of the appliance.
- ★ If the power cord is damaged, it must be replaced by the manufacturer.
- ★ Children are not allowed to play with this appliance.
- ★ Children under 3 should be kept away from the machine.

Installation

Install it in places with firm and smooth ground

- ★ The washing machine should be installed on a firm and level ground, allowing 2 cm (1 inch) slopes.
- ★ The washing machine should be 5 cm (2 inch) away from the wall.

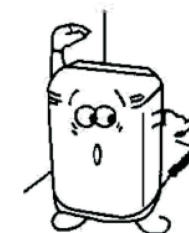





Connect the intake pipe





- ★ Position the intake pipe correctly.
- ★ Insert the affusion spigot into the affusion hole.





Before Washing

	1. Take out coins, nails or other things on the clothes.		2. Do not put clothes containing chemical reagents into the washing machine.
	3. Turn out the fabric inside when washing clothes.		4. Put easy-to-fraying clothes in the laundry bag when washing.

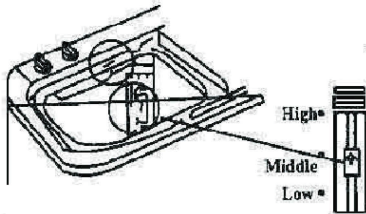
Washing Operation

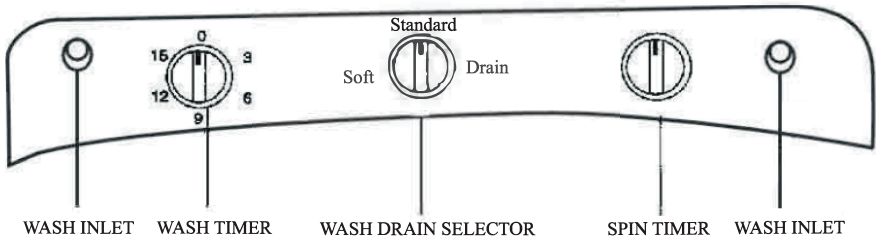
	Connect the intake pipe with the water spigot		Insert the plug
	Put down the drain pipe		Put the clothes and then the washing powder into the washing machine
<div><div>★Choose high, medium, and low water levels according to the number of clothing. ★Middle or high setting is the most suitable for double-flow water level.</div></div>			



● Choose the washing mode. 
Turn on the switch and choose “soft or standard” mode according to the quantity of the clothes. Then the washing machine starts to work.
● Choose the washing time. 
When the water reaches the water level, choose the washing time from 3 to 15 minutes.

Choose the Washing Mode	Soft	Standard
Clothing Type	Silk or floss clothes	Linen or dirty clothes
Washing Time	3-5 min	5-9 min or 9-15 min
Water Level	Quantities of Washing Powder	
High	40-57g	
Middle	30-48g	
Low	25-40g	
<div>• Drain When finishing washing, turn the switch to drain position.</div> <div>• Choose drain time ★ After washing, put the wet clothes into the drying tub and then cover the lid. ★ Turn the spin timer in sequence and the machine begins to work.</div>		

Second Washing

Perform the washing procedure twice. Wash and drain twice.
After finishing first draining, begin to the second washing and draining to save energy.

Second Washing While Affusion

Flush twice, open the water valve, and pour water into the flushing pipe.

Notice When Draining

- ★ Cover the plastic lid when the machine is drying.
- ★ Do not dry when draining, put the clothes into the drying tub after draining, so as not to damage the machine.
- ★ Cover the lid tightly when spinning to avoid clothes flying out of the tub.
- ★ Never put hands into the drying tub while working, and especially keep children away from the machine.