

The background of the entire page is a close-up photograph of a black gas cooktop. Several burners are visible, with bright blue flames rising from them. The lighting is dramatic, with the flames providing a primary light source against the dark background of the cooktop.

THOR
K I T C H E N[®]

INSTALLATION INSTRUCTIONS

TRHP | TRHPB | TRHPW Models
TRH48P | TRH36P | TRH30P
TRH48PB | TRH36PB | TRH30PB
TRH48PW | TRH36PW | TRH30PW

INSTALLATION INSTRUCTIONS

TRHP|TRHPB|TRHPW PROFESSIONAL RANGE HOODS

TRHP|TRHPB|TRHPW MODELS

TRH48P | TRH36P | TRH30P

TRH48PB | TRH36PB | TRH30PB

TRH48PW | TRH36PW | TRH30PW

THOR
K I T C H E N[®]

TABLE OF CONTENTS

IMPORTANT SAFETY INSTRUCTIONS	4
ATTENTION	4
WARNING	4-6
GROUNDING INSTRUCTIONS	7
NOTICE	7
DIMENSIONS	8
CIRCUIT DIAGRAM	8
SPECIFICATION CHART	9
PRODUCT DIMENSION	10
EXPLODED DIAGRAM	11-12
INSTALLATION & USE	13
INSTALLATION DRILLING AND ALINING	13
MOUNTING THE HOOD	13-14
FIX THE AIR OUTLET	14
DUCT FIXING	14
CONNECTIONS	15
OPERATION OF CONTROLS CONTROL SWITCH	16
MAINTENANCE	17
GREASE FILTER	17
CHARCOAL FILTER FOR DUCTLESS INSTALLATION(NOT INCLUDED)	18
LED BULBS	18
HOOD CLEANING	19
WARRANTY	20

Dear Customer,

If you follow the recommendations contained in this Instruction Manual, our appliance will give you constant high performance and will remain efficient for many years to come.

IMPORTANT SAFETY INSTRUCTIONS

ATTENTION

- *The manufacturer will not be held liable for any damages resulting from incorrect or improper installation.
- *Please read this instruction manual before installing and using this range hood. Properly keep this instruction manual in a safe place for future reference.
- *This range hood can be used in Ducted or Ductless installation (internal air recirculation).For ductless installation accessory charcoal filters will need to be purchased separately.
- * Only a qualified and trained service technician can perform the installation and service.

WARNING

READ AND SAVE THESE INSTRUCTIONS.

WARNING:TO REDUCE THE RISK OF FIRE,ELECTRIC SHOCK,OR INJURY TO PERSONS,READ THE FOLLOWING INSTRUCTIONS:

- *Use this unit only in the manner intended by manufacturer. Please contact customer service if you have any questions.
- *Before servicing or cleaning the unit,securely fasten a prominent warning device,such as a tag,to the service panel.
- *Installation work and electrical wiring must be done by qualified technician(s)in accordance with all applicable codes and standards including fire-rated construction.
- *Do not operate any fan with a damaged cord or plug.
- *Sufficient air is needed for proper combustion and exhaust of gas through the flue(chimney)of fuel burning equipment to prevent back drafting.Follow the appliance manufacturer's guideline and safety standards,such as those published by National Fire Protection Association(NFPA),the American Society for Heating, Refrigeration and Air Conditioning Engineers(ASHRAE),and the local code authorities.
- *When cutting and drilling into wall or ceiling;do not damage electrical wiring and other utilities.
- *Ducted fans must always be vented outdoors.
- *CAUTION:For residential kitchen ventilating use only.Do not use to exhaust hazardous or explosive materials and vapors.

IMPORTANT SAFETY INSTRUCTIONS

***CAUTION:**To reduce risk of fire and to properly exhaust air, be sure to duct air outside-do not vent exhaust air into space within walls or ceilings, attics or into crawl spaces, or garages.

WARNING - TO REDUCE THE RISK OF FIRE, USE ONLY METAL DUCTWORK.

WARNING- TO REDUCE THE RISK OF A RANGE TOP GREASE FIRE:

- a) Never leave surface units unattended at high settings. Boil overs cause smoking and greasy spillovers that may ignite. Heat oils slowly on low or medium settings.
- b) Always turn hood ON when cooking at high heat or when flambeing food (i.e. Crepes Suzette, Cherries Jubilee, Peppercorn Beef Flambe).
- c) Clean ventilating fans frequently. Grease should not be allowed to accumulate on fan or filter.
- d) Use proper pan size. Always use cookware appropriate for the size of the surface burner /element .

WARNING-TO REDUCE THE RISK OF INJURY TO PERSONS IN THE EVENT OF A RANGE TOP GREASE FIRE, OBSERVE THE FOLLOWING:

- a) **SMOTHER FLAMES** with a close-fitting lid, cookie sheet, or metal tray, then turn off the burner. **BE CAREFUL TO PREVENT BURNS.** If the flames do not go out immediately, **EVACUATE AND CALL THE FIRE DEPARTMENT.**
- b) **NEVER PICK UP A FLAMING PAN**– You may be burned.
- c) **DO NOT USE WATER**, including wet dishcloths or towels - a violent steam explosion will result.
- d) Use an extinguisher **ONLY** if:
 - 1) You know you have a Class ABC extinguisher, and you already know how to operate it.
 - 2) The fire is small and contained in the area where it started.
 - 3) The fire department is being called.
 - 4) You can fight the fire with your back to an exit.

Based on "Kitchen Fire Safety Tips" published by NFPA.

WARNING: TO REDUCE THE RISK OF FIRE OR ELECTRICAL SHOCK, DO NOT USE THIS FAN WITH ANY SOLID-STATE SPEED CONTROL DEVICE

***Check voltage corresponds to the one indicated on the rating plate/label plate fixed inside the hood.**

IMPORTANT SAFETY INSTRUCTIONS

*Check that the domestic power supply guarantees adequate grounding.

*Do not connect the hood to exhaust ducts carrying combustion fumes(boilers,fireplaces,etc.)

*If the hood is used in conjunction with non-electrical appliances(e.g.gas burning appliances),a sufficient degree of aeration must be guaranteed in the room in order to prevent the backflow of exhaust gas.The kitchen must have an opening directly with the open air in order to guarantee the entry of clean air.

*The minimum distance is 30 inches from the range hood to a gas cooktop,and is 25 inches to an electric cooktop.If the installation instructions for gas cooktop specify a greater distance,this must be taken into account.

In certain circumstances electrical appliances may be a danger hazard.

*Do not check the status of the filters while the range hood is operating.

*Do not touch the light bulbs during or right after appliance in use.

*Do not operate or disconnect the appliance with wet hands.

*Avoid free flame,as it is damaging for the filters and a fire hazard.

*Constantly check food frying to prevent that overheated oil may become a fire hazard.

*Disconnect electrical plug prior to any maintenance.

* The hood should not be used by children or person not instructed in its correct use.Children don't recognize the risks of electrical appliances. Therefore, use or keep the appliance only under supervision of adults and out of the reach from children.

* Don't use this product outdoor.

*There shall be adequate ventilation of the room when the range hood is used at the same time as appliances burning gas or other fuels.

*There is a fire risk if cleaning is not carried out in accordance with instructions.

* Do not flambe under the range hood.

*The discharge air must not be discharged into a flue which is used for exhausting fumes from appliances burning gas or other fuels.

WARNING:TO PROVIDE PROTECTION AGAINST ELECTRIC SHOCK,CONNECT TO PROPERLY GROUNDED OUTLETS ONLY

IMPORTANT SAFETY INSTRUCTIONS

GROUNDING INSTRUCTIONS

This appliance must be grounded. In the event of an electrical short circuit, grounding reduces the risk of electric shock by providing an escape wire for the electric current. This appliance is equipped with a cord having a grounding wire with a grounding plug. The plug must be plugged into an outlet that is properly installed and grounded.

WARNING: IMPROPER GROUNDING CAN RESULT IN A RISK OF ELECTRIC SHOCK

Consult a qualified electrician if you do not fully understand the grounding instructions or if there is any doubt as to whether the appliance is properly grounded.

Key Grounding Safety Tips:

Never remove or alter the grounding prong from the plug.

Do not use an extension cord with this appliance. If the power cord is too short, have a licensed electrician install a grounded outlet near the appliance.

Ensure the outlet is grounded. Cutting or tampering with the electrical cord will void the warranty and may result in serious safety hazards.

IMPORTANT: If you have any concerns about proper grounding or installation, please consult a qualified electrician before use.

NOTICE

*Installation and Handling:

Important: Due to the appliance's weight, two or more people are required for installation or moving. Attempting to move or install it alone may result in physical injury.

*Intended Use:

This rangehood is designed solely for residential use and is intended to eliminate kitchen fumes. It should not be used for any other purpose.

*Fire Safety:

Never leave an open flame unattended under the rangehood while it is in operation.

Adjust the flame intensity to ensure it is directed only onto the bottom of the pan, avoiding any contact with the pan sides to prevent excess heat or flare-ups.

*Deep Fryer Safety:

If using a deep fryer, always monitor it continuously during operation. Overheated oil can catch fire quickly and cause serious hazards.

DIMENSIONS

CIRCUIT DIAGRAM

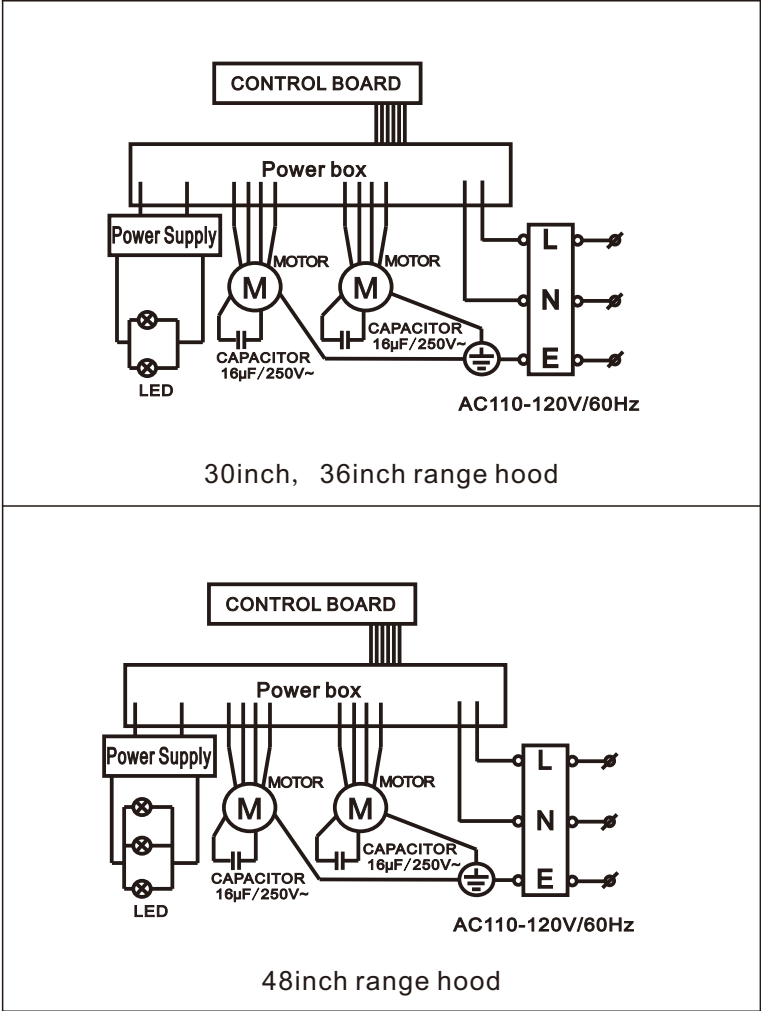

SPECIFICATION CHART

Models	TRH30P/TRH36P/TRH48P TRH30PB/TRH36PB/TRH48PB
Net Weight (lbs)	50.27 / 51.81 / 58.42
Measurement (inches) (Without chimney cover)	(W)30 × (D)22-1/2 × (H)14 (W)36 × (D)22-1/2 × (H)14 (W)48 × (D)22-1/2 × (H)14
Measurement (inches) (With chimney cover)	(W)30 × (D)22-1/2 × (H)35-55 (W)36 × (D)22-1/2 × (H)35-55 (W)48 × (D)22-1/2 × (H)35-55
Maximum Voltage	110-120V~ 60Hz
Exhaust Pipe Diameter	Round 8 inches
Light	30/36 inches 2W LED × 2 48 inches 2W LED × 3
Certification	

DIMENSIONS

PRODUCT DIMENSION

*All measurements in parenthesis are in millimeter.

*All inch measurements are converted form millimeters,thus inch measurements are estimated.

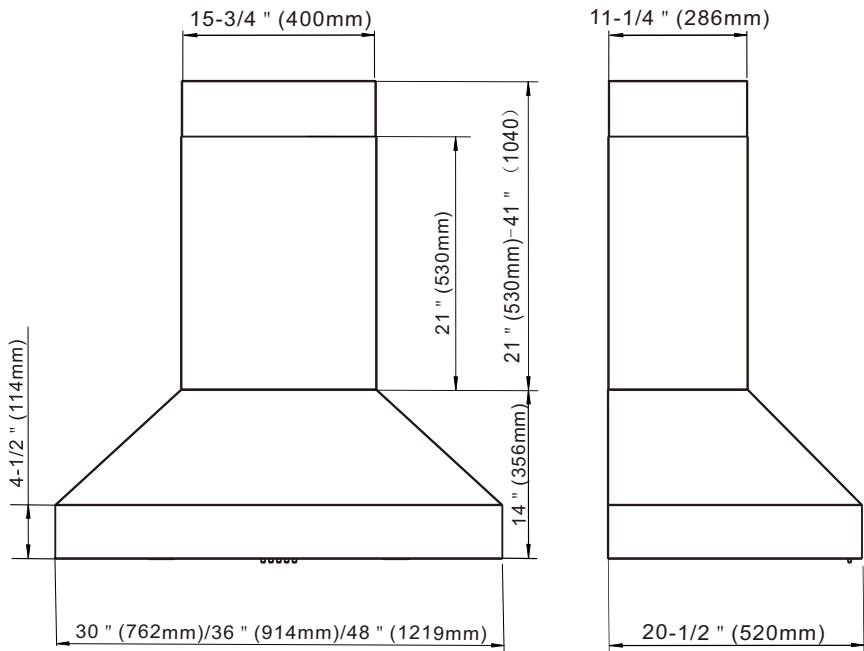

EXPLODED DIAGRAM

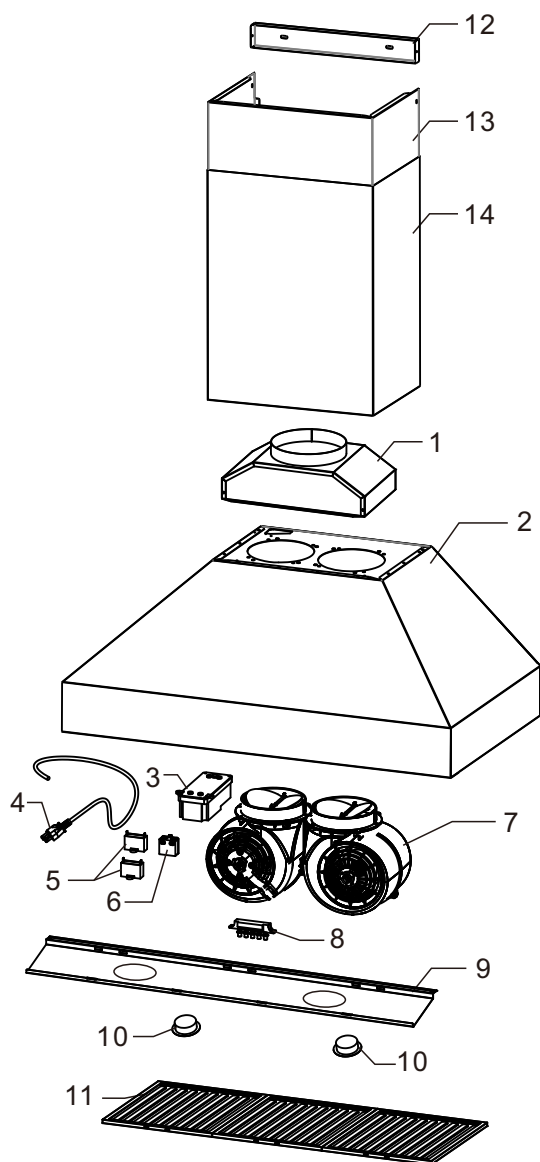

EXPLODED DIAGRAM

NO.	PART NAME	30"QTY	36"QTY	48"QTY
1	Outlet fitting	1	1	1
2	Hood Body	1	1	1
3	Power Box	1	1	1
4	Cower cord	1	1	1
5	Capacitor	2	2	2
6	Transformer	1	1	1
7	Motor	2	2	2
8	Control&Control line	1	1	1
9	Lamp board	1	1	1
10	Led	2	2	3
11	Filter	2	3	4
12	Support panel	1	1	1
13	Upper chimney cover	1	1	1
14	Lower chimney cover	1	1	1

USE ONLY THE PROVIDED RANGE HOOD CORD CONNECTION KITS FOR THIS APPLIANCE. USING UNAUTHORIZED KITS MAY AFFECT PERFORMANCE AND SAFETY.

Note 1: Before installation, carefully remove the plastic protective film from all exterior surfaces, including the hood, filters, and duct cover.

Note 2: Due to the weight and size of the range hood, a minimum of two people is required for mounting.

INSTALLATION DRILLING AND ALINING

1. Draw a vertical reference line on the wall where the hood will be installed, extending up to the ceiling or as high as needed.
2. Draw a horizontal line 28-30 inches above an electric cooktop, or 30-32 inches above a gas cooktop.
3. Position the chimney mounting brackets on the wall as shown, about 1" (27mm) from the ceiling or upper limit. Align the center notch of the bracket with the vertical reference line.

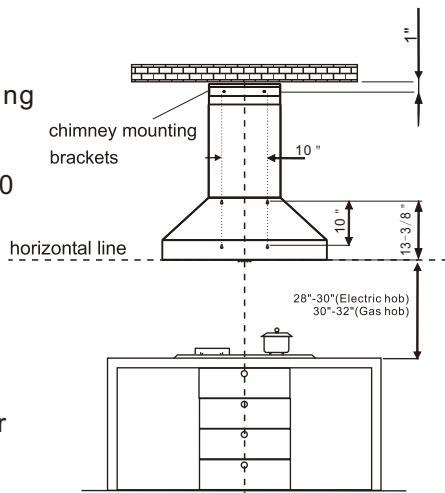

MOUNTING THE HOOD

1. Install the two main mounting screws into the wall, along a line that is 13" above the horizontal line. Ensure the screws are parallel to the horizontal line to maintain proper alignment.

INSTALLATION & USE

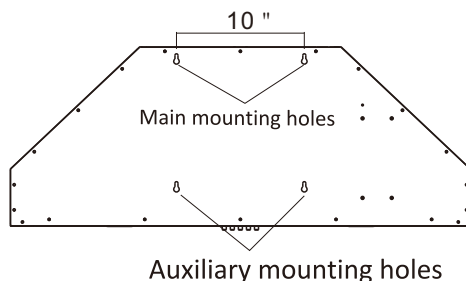

2. Align the mounting holes on the back of the range hood with the mounting screws on the wall.
3. Place the range hood onto the screws and tighten them securely.

FIX THE AIR OUTLET

1. Place the sealing strip (provided in the accessories bag) around the air outlet joint cover. Ensure it forms a complete circle to prevent air leakage.
2. Install the joint cover onto the range hood using the 4 screws provided.

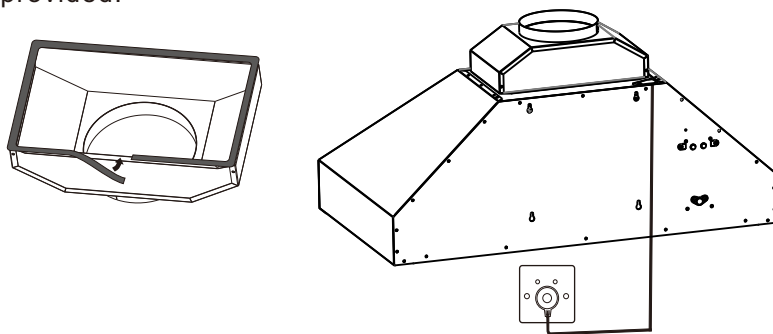

DUCT FIXING

- Caution: To reduce the risk of fire, use only metal ductwork. (Metal ducts can be easily sourced from local hardware stores.)
1. Attach a sufficient length of 8" round duct to the top of the outlet adapter (Φ).
 2. Secure the duct using fasteners, ensuring it is firmly attached.

CONNECTIONS

Ducted mode air exhaust system

Caution: To reduce the risk of fire, use metal ductwork only. (Metal duct should be sourced by locally.)

1. Decide where the ductwork will run between the hood and the outside.
2. A straight, short duct run will allow the hood to perform most efficiently.
3. Long duct runs, elbows, and transitions will reduce the performance of the hood. Use as few of them as possible. Larger ducting may be required for best performance with longer duct runs.
4. Attach an adequate length of $\phi 8$ " round duct to the air outlet adapter.
5. The air must not be discharged into a flue that is used for exhausting fumes from appliances burning gas or other fuels.

Regulations concerning the discharge of air have to be fulfilled.

6. Install wall cap or roof cap. Connect round metal ductwork to cap and work back towards the hood location. Use duct tape to seal the joints between duct work sections.

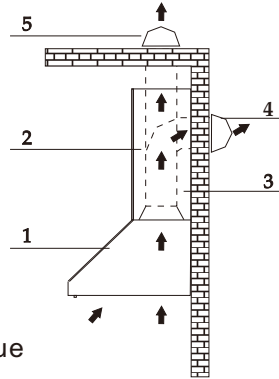

Recirculation Mode

Caution: Do not use plastic or rigid metal ducting.

1. Install the charcoal filter on.
2. Please note that the air will flow out from the two grids on the two sides of the chimney top.
3. If choosing recirculation kit, for exhausting air smoothly, please make sure that there is a gap of 20mm at least between the cabinet or chimney cover and the ceiling.

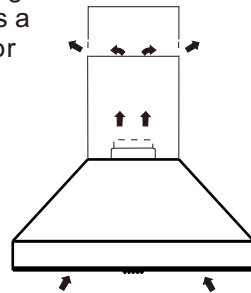

INSTALLATION & USE

Electrical Connection

*Wiring must be performed by a qualified professional in accordance with all applicable codes and standards. Ensure electrical power is turned off at the service entrance before starting any wiring work.

*If the supply cord is damaged, it must be replaced by the manufacturer, its service agent, or similarly qualified individuals to avoid any hazards.

*Do not use any plugs or extension cords other than the ones initially supplied with the range hood.

*Grounding is required: This appliance must be properly grounded. In the event of an electrical short circuit, grounding reduces the risk of electric shock by providing an escape path for the electrical current.

*This appliance is equipped with a cord that includes a grounding wire and plug. The plug must be inserted into a properly grounded outlet.

*Do not remove the grounding prong from the plug, as it is a critical safety feature.

OPERATION OF CONTROLS CONTROL SWITCH

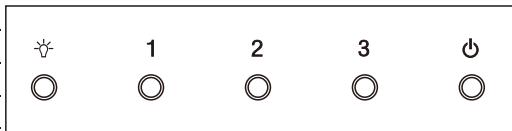

☛ – Turn the light on/off

1 – Low speed setting

2 – Medium speed setting

3 – High speed setting

⏻ – Turn the hood on or off

Maintenance

Proper maintenance of the range hood is essential for ensuring its optimal performance and longevity.

Before performing any maintenance, disconnect the hood from the main power supply to prevent any electrical hazards.

GREASE FILTER

*Clean the grease filters regularly to maintain optimal performance. It is recommended to clean them every two months, or more frequently if the range hood is used heavily.

*Grease filters are washable. Clean them with a warm detergent solution to remove grease buildup.

* Replacement filters can be purchased at www.thorkitchen.com

(1) PUSH DOWN

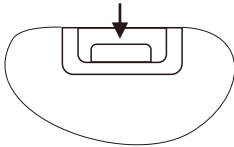

(2) LIFT OUT

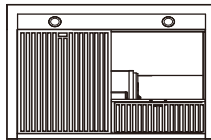

Grease Filter Maintenance

1. To remove the grease filter, push down each latch to disengage the filter from the hood. Tilt the filter downward and remove it.

2. Wash the filters carefully, ensuring they are not bent. Allow them to dry completely before refitting.

3. When refitting the filters, make sure the handle is visible from the outside.

4. To install the grease filter, align the rear filter tabs with the slots in the hood. Push down the latch, insert the filter, and release the latch. Ensure the filter is securely in place after installation.

MAINTENANCE

CHARCOAL FILTER (FOR DUCTLESS INSTALLATION)

Note: The charcoal filter is not washable and cannot be regenerated. It should be replaced approximately every 3 months, or more frequently for heavy use.

1. To install the charcoal filter (not included), insert it into the slot and lock it into place until you hear a click.
2. Install the grease filter after the charcoal filter is locked in place.

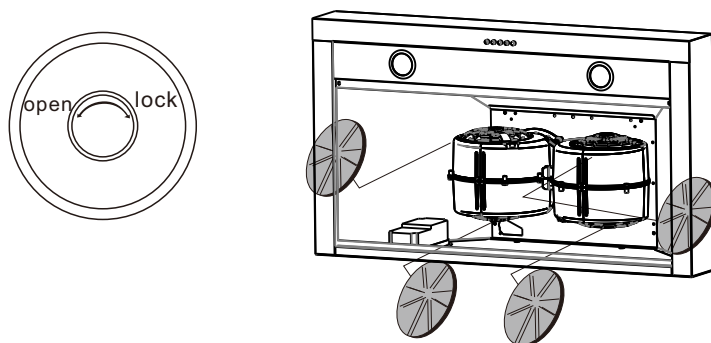

LED BULB REPLACEMENT

This range hood uses two DC12V 2.0W LED bulbs.

Warning: Always switch off the electrical supply before performing any maintenance on the appliance.

1. Switch off the power and wait for 5 minutes for the bulbs to cool down.
2. Wear gloves and remove the bulb by gently pulling it sideways, as indicated in the installation instructions.
3. Replace with DC12V 2.0W LED bulbs.

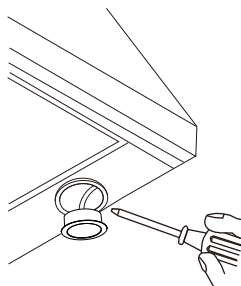

IMPORTANT SAFETY NOTES:

CAUTION: THE SURFACE OF THE BULBS MAY BE HOT. HANDLE THEM WITH CARE WHEN REMOVING OR REPLACING.

HOOD CLEANING

Stainless steel is easy to clean and maintain. Follow these tips to keep it looking great:

*General Cleaning: Use warm water with soap or detergent. Rinse with clear water and wipe dry with a soft cloth to avoid watermarks.

* For persistent discoloration or deposits: Use a non-scratching household cleaner or stainless steel polish with a soft cloth. For stubborn spots, use a plastic scouring pad or soft bristle brush with cleanser and water. Rub lightly in the direction of the grain to avoid marring the surface.

*Important: Do not allow deposits to sit for long periods. Avoid using ordinary steel wool or steel brushes as small bits of steel may scratch and cause rust.

*Chemical Caution: Do not allow salt solutions, disinfectants, bleaches, or cleaning compounds to remain in contact with stainless steel for extended periods. These chemicals may damage the surface. Rinse and wipe dry immediately after exposure.

Painted Surfaces: Clean only with warm water and mild detergent.

Disposal

Do not dispose of this product as unsorted municipal waste. Separate collection for special treatment is required.

WARRANTY

Warranty

This product has been manufactured by Thor International, 4651 EAirport Drive, California 91761.

For Customer Service, please call (877) 288 - 8099

For the most up to date warranty and service policy, please refer to our website

WWW.THORKITCHEN.COM/WARRANTY-REGISTRATION

For in-warranty service requests, please visit our website at WWW.THORKITCHEN.COM/SERVICE

Please Note: You must provide proof of purchase or installation date for any in-warranty service requests.

We Stand Behind the Quality of Our Appliances.



Reliability and customer satisfaction are our top priorities. We offer a solid two-year warranty on both parts and labor. Enjoy professional-grade performance with the confidence that we've got you covered.

Warranty Registration Made Easy.

01 Scan the QR Code or visit thorkitchen.com/register-your-product.

02 Input your purchase and product information and select register.

03 That's it. You're all set. Enjoy!

Questions: service@thorinternational.com



WARRANTY



PARTS

