



J-TECH DIGITAL[®]

USER MANUAL



1080P HDMI Extender One to Many 400ft HDMI Loop Out

JTD-3176 | JTECH-EX-120MV2



J-TECH DIGITAL INC.
9807 EMILY LANE
STAFFORD, TX 77477
TEL: 1-888-610-2818

E-MAIL: SUPPORT@JTECHDIGITAL.COM

Scan the QR code below or visit
<https://resource.jtechdigital.com/products/3176>
to view and access detailed digital
resources regarding this unit.



Safety Instructions:

- Before using this product, please carefully read the following safety instructions to ensure its proper use and keep this manual for future reference.
- To prevent electric shock, do not attempt to open the product.
- Only qualified personnel should perform any repairs or maintenance.
- Always place the product on a stable, flat surface to prevent it from falling.
- Do not expose the product to water, moisture, or high-humidity environments to avoid the risk of damage.
- To prevent damage from direct sunlight or high temperatures, do not expose the product to such environments.
- Do not place the product near heat sources like radiators, heat registers, stove, or other heat-producing apparatus.
- Do not place any objects on top of the product to avoid damage.
Use only the attachments and accessories specified by the manufacturer.
- During lightning storms or prolonged periods of disuse, unplug the power supply to prevent damage.

Table of Contents

- 1. Introduction ----- 5
- 2. Packing Contents ----- 5
- 3. Feature ----- 5
- 4. Panel Description ----- 6
- 5. Connection Diagram ----- 7
- 6. Specification ----- 8
- 7. Troubleshooting ----- 9
- 8. Maintenance ----- 10
- 9. Warranty ----- 10
- 10. Mail-In Service ----- 10
- 11. Limited Warranty Limits and Exclusions ----- 11

1. Introduction

The HDM™ video Extender lets you extend HDMI™ signal or DVI Signal (using HDMI™-DVI adapter, not included) by up to 120m (395 ft) for full HD video and 200m (660 ft) for HD video, over single Cat6 cable. An ideal solution for sharing a display or projector over an LAN network so that even the video source lacking digital video output can still connect.

2. Packing Contents

- 1) Main Unit TX&RX
- 2) DC 5V Power Adapter with screw x2

3. Feature

- Features 3 extension mode: simple mode, allocation mode and infinite mode.
- Following TCP/IP standard
- Supports resolution up to 480p/720p/1080i/1080p
- Supports max video bandwidth to 1.65Gbps/165MHz per channel (4.95Gbps all channels).
- CAT5e/6 cable follows the standard of IEEE-568B

4. Panel Description

TX



RX



1. RESET: function as restart
2. RJ45 OUT: Connect to the CAT6 cable to receiver or the network switch or router
3. IR OUT: IR Signal Output Port
4. HDMI OUT: Connect to Output Devices via HDMI Male Output Port for remote out
5. HDMI IN: Connect to Input Sources via HDMI Male Input Port
6. DC 5V: DC 5V In
7. RJ45 IN: Connect to the CAT6 cable to sender or the network switch or router
8. IR IN: IR Signal Input Port

5. Connection Diagram

(1) Simple mode

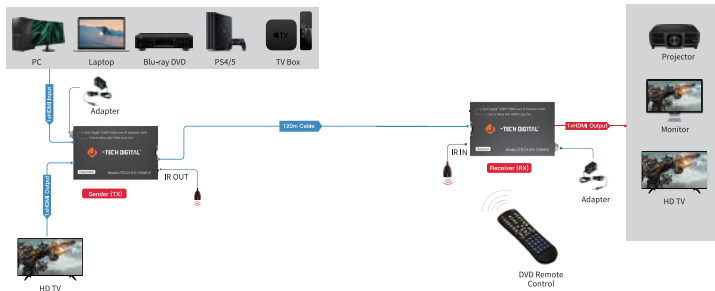

(2) Allocation mode

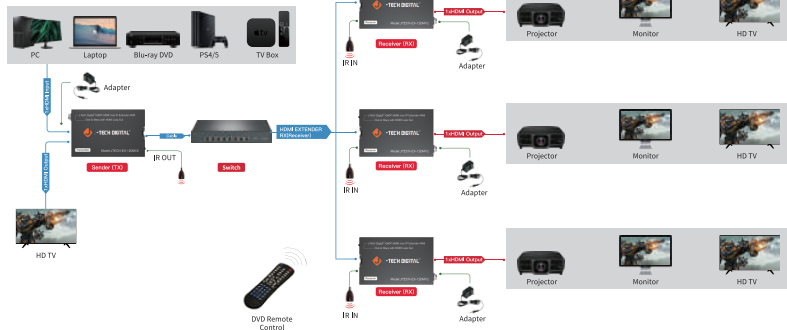

(3) Infinite mode

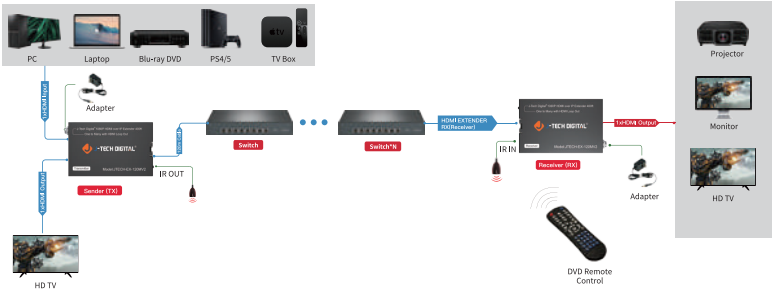

6. Specification

Signal Input	HDMI Signal
Input Video Signal	0.5-1.0volts/p-p
Output Video	HDMI Signal
Transmission Distance (via Cat6 cable)	120m@1080p
Vertical Frequency Range	50/60Hz
Interlaced (50&60Hz)	1080i
Progressive(50&60Hz)	480p,576p,720p,1080p
Limited Warranty	1 Year Parts and Labor
Operating Temperature	0 C to +50 C
Storage Humidity	5% to 90 % RH (no condensation)
Power Supply	DC 5V 1A x 2pcs
Power Consumption (Max)	TX: 2W RX: 1W
Extender Unit Cert	FCC, CE, RoHS

Power Supply Cert	CE, FCC, RoHS
Power Adapter	US, UK, EU, US Standard etc
Dimension(LxWxH)	TX/RX: 98.65 x 63.8 x 15.8mm
Net Weight	TX:134g, RX:132g
Material	Metal
User Manual	English Version

7. Troubleshooting

Problems	Causes	Solutions
Non-power-connected/all LED off	Maybe the power supply is not connecting well or use the wrong power adapter	Please check if the power supply is connecting well and the output voltage value is correct as recommended
No sound or sound issues	Maybe the HDMI connection is not well; the audio format is not supported by the displays; the source player set another port to output audio	Please check if the HDMI cables are connecting well; if the audio format is supported by the displays, customers can change to the supported audio format or the player's audio output is setting HDMI audio output or not
No picture or picture flicker	Maybe the HDMI cable quality and UTP cable quality is not good enough or not connecting well	Please check if the HDMI and UTP connection is well, or change another good quality HDMI 1.4 standard HDMI cable or UTP(CAT5e/CAT6 or better cable is recommended) cable will solve the issue.

8. Maintenance

Clean this unit with a soft, dry cloth. Never use alcohol, paint thinner, or benzene to clean.

9. Warranty

If your product does not work properly because of a defect in materials or workmanship, our company (referred to as "the warrantor") will, for the length of the period indicated as below, "Parts and Labor (1) Year" which starts with the date of original purchase ("Limited Warranty period"), at its option either (a) repair your product with new or refurbished parts, or (b) replace it with a new or a refurbished product. The decision to repair or replace will be made by the warrantor. During the "Labor" limited warranty period, there will be no charge for labor. During the "Parts" warranty period, there will be no charge for parts. You must mail-in your product during the warranty period. This Limited Warranty is extended only to the original purchaser and only covers products purchased as new. A purchase receipt or other proof of original purchase date is required for Limited Warranty service.

10. Mail-In Service

When shipping the unit, carefully pack and send it prepaid, adequately insured, and preferably in the original carton. Include a letter detailing the complaint and provide a day time phone and/or email address where you can be reached.

11. Limited Warranty Limits and Exclusions

This Limited Warranty ONLY COVERS failures due to defects in material or workmanship, and DOES NOT COVER normal wear and tear or cosmetic damage. The Limited Warranty ALSO DOES NOT COVER damages which occurred in shipment, or failures which are caused by products not supplied by warrantor, or failures which result from accidents, misuse, abuse, neglect, mishandling, misapplication, alteration, faulty installation, set-up adjustments, mis. adjustment of consumer controls, improper maintenance, power line surge, lightning damage, modification, or service by anyone other than a Factory Service center or other Authorized Servicer, or damage that is attributed to acts of God. There are no express warranties except as listed under "Limited Warranty Coverage". The warrantor is not liable for incidental or consequential damages resulting from the use of this product or arising out of any breach of this warranty. (As examples, this excludes damages for lost time, cost of having someone remove or re-install an installed unit if applicable, travel to and from the service, loss of or damage to media or images, data or other recorded content. The items listed are not exclusive but are for illustration only). Parts and service, which are not covered by this limited warranty, are your responsibility.



WWW.JTECHDIGITAL.COM
PUBLISHED BY J-TECH DIGITAL INC.

9807 EMILY LANE
STAFFORD, TX 77477
TEL: 1-888-610-2818
E-MAIL: SUPPORT@JTECHDIGITAL.COM