

LEISURE 3W PRO

USER MANUAL

Please read this manual thoroughly before using this product and keep it for future reference.

CONTENT

WHAT'S INCLUDED	01
NOTICE.....	01
PRODUCT OVERVIEW	02
QUICK START	03
MULTIMEDIA CONNECTION	05
USB Disk/Memory Card Connection	05
HD Connection	06
AV Connection	07
VGA Connection	08
SCREEN MIRRORING	09
For iOS System	09
For Android System	11
SETTINGS.....	13
PROJECTION DISTANCE&SIZE	15
SPECIFICATION	16
TROUBLESHOOTING GUIDE	17

WHAT'S INCLUDED

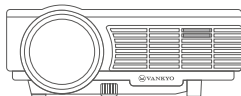

Projector



Remote (Batteries Not Included)



User Manual

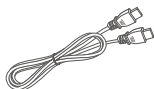

HD Cable

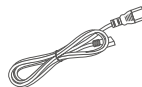

Power Cable

NOTICE

Recommended

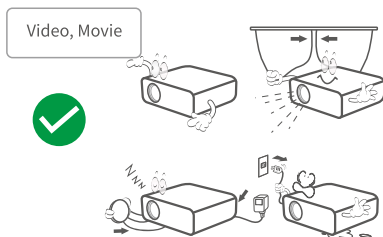

NOT Recommended

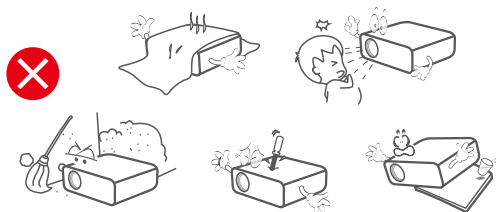

PRODUCT OVERVIEW

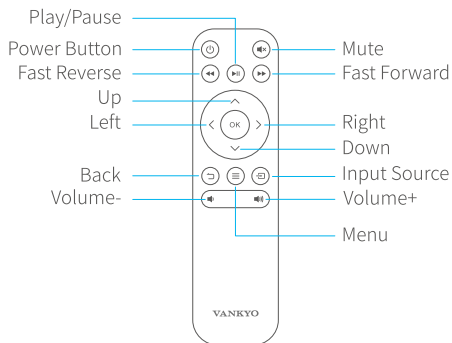
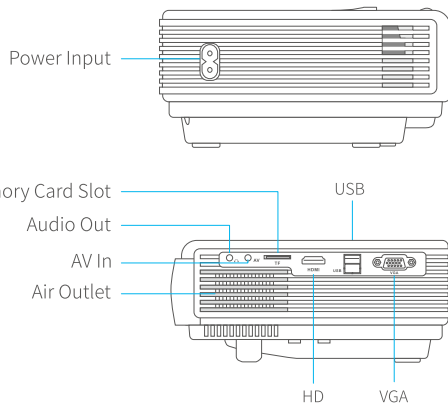
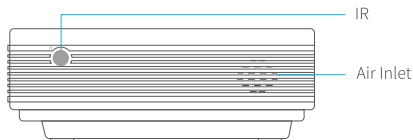
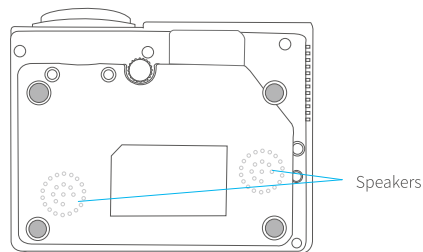
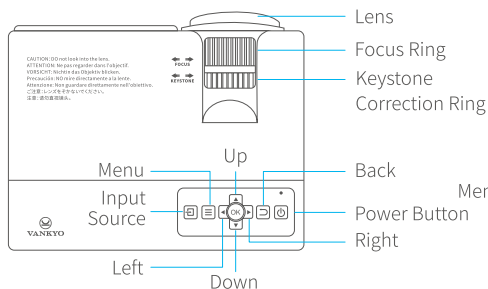

QUICK START

1. Projector Installation

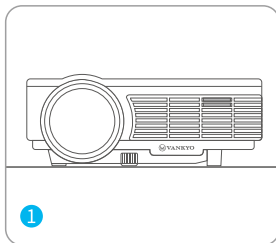

Horizontal Placement

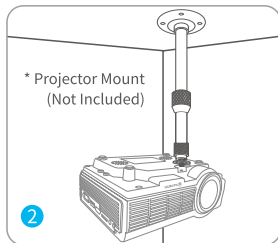

Ceiling Mounting

Note:

Whichever installation option you select, please make sure:

1. the projector is centered directly in front of the wall/screen, but not tilted or angled toward it;
2. to select the corresponding projection mode so the images can be projected correctly.

2. Power On/Off

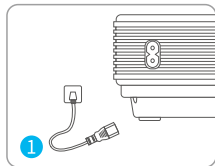

Plug the power cord into an outlet.

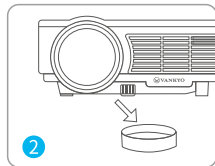

Take off the lens cover.

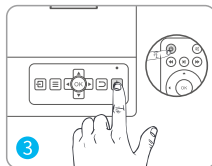

Press the **Power Button** to turn on the projector.

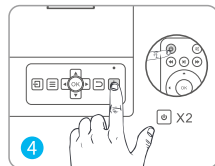

Press the **Power Button** twice to turn off the projector.

3. Images Adjustment

- 1 Rotate the **Keystone Correction Ring** to correct **Vertical Keystone Distortion** until the image is evenly rectangular.

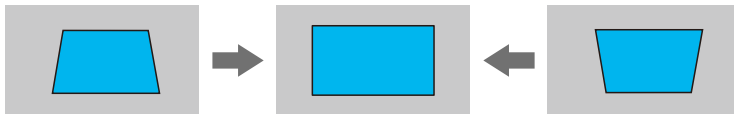

- 2 Rotate the **Focus Ring** to sharpen the **Image Focus** until the blurred image becomes clear.

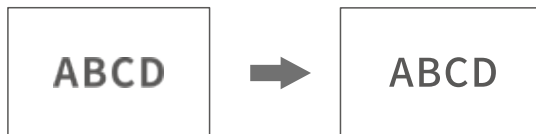

4. Homepage Overview

The default interface after booting is **Homepage** as shown.

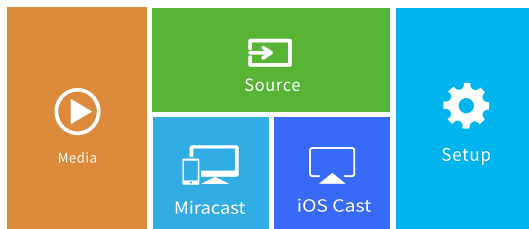

- * **Media.** Displays file categories of Multimedia input(USB Disk or Memory Card), including **Movie**, **Music**, **Photo** and **Text**.
- * **Source.** Displays three categories of input source, including **HDMI**, **VGA** and **AV**.
- * **Miracast.** Enter to start screen mirroring for Android devices.
- * **iOS Cast.** Enter to start screen mirroring for iOS devices.
- * **Setup.** Guides you through all setting options for the projector.

MULTIMEDIA CONNECTION

USB Disk/Memory Card Connection

Step 1: Turn on the projector and insert your USB Disk/Memory Card into the USB port/Memory Card Slot.

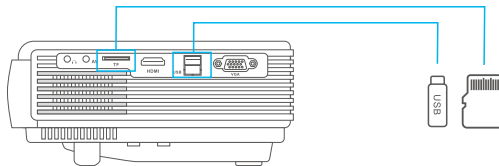

Step 2: Go to **Homepage > Media** and select the file category you would like to display among **Movie**, **Music**, **Photo** and **Text**, then enter the inserted USB Disk/Memory Card to check all files stored.

Step 3: To play a video file, please follow the below steps:

- ① Select **Movie** to correspondingly read video files stored.
- ② Press **OK** / **▶** on the projector/remote for a certain video file to enter full-screen display.
- ③ Press **OK** on the projector or press **OK** / **≡** on the remote when playing a video to bring up the toolbar to control the video playing.

Note:

Operation for playing a music file, a photo file and a text file is the same with that for playing a video file, but make sure to select the correct file category; that is, for playing a music file, select **Music** in **Media** interface; likewise, for photo, select **Photo**, for text, select **Text**.

Step 4: Press  on the projector/remote to go back to **Homepage**.

File Category	Format Supported	File Category	Format Supported
Video	AVI/MKV/MOV/MP4/FLV/VOB/ MPEG1/MPEG/RMVB/3GP/ H.264/XVID	Music	MP2/MP3/WMA/AAC/FLAC/PCM
Photo	JPEG/BMP/PNG/JPG/GIF	Text	TXT

HD Connection

Step 1: Turn on the projector and connect your device to the **HDMI port** of the projector with the provided HD cable.

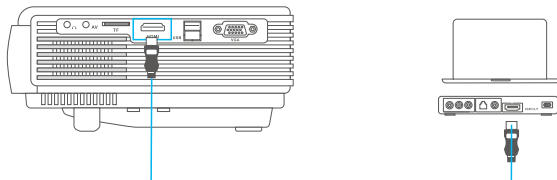

Step 2: Go to **Homepage > Source**, select **HDMI** as the input source, then the contents of your device will be mirrored to the screen/wall.

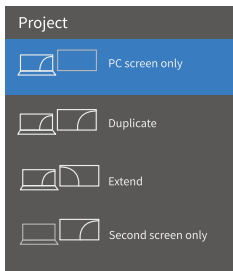

Tip:

For **Windows 7 or higher** system, press the "**Windows Logo + P**" key combination to access the below four display modes.

- 1 **PC screen only** option displays contents on computer screen only.
- 2 **Duplicate** option displays the same contents on both computer screen and projected screen.
- 3 **Extend** option splits the display between the computer screen and the projected screen.
- 4 **Second screen only** option displays contents only on the projected screen.

AV Connection

Step 1: Turn on the projector and connect your device to the **AV Port** of the projector with an AV cable(not included).

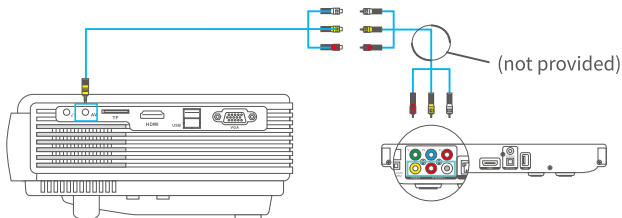

Step 2: Go to **Homepage > Source**, select **AV** as the input source, then the contents of your device will be mirrored to the screen/wall.

VGA Connection

Step 1: Turn on the projector and connect your device to the **VGA port** of the projector with a VGA cable(not included).

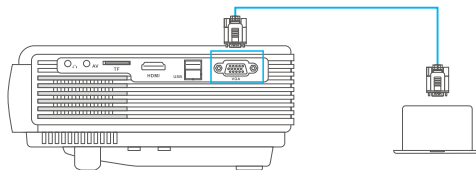

Step 2: Go to **Homepage > Source**, select **VGA** as the input source, then the contents of your device will be projected to the screen/wall.

Note:

For better viewing experience, you can press  to bring up the tool bar and change settings about **Image**, **Sound** and **VGA Set (Exclusive for VGA Input)** for contents from HDMI, AV and VGA connection.

* **Image:** Enter to set **Image Mode**, **Aspect Ratio**, **Brightness**, **Contrast**, **Color** and **Sharpness**.

* **Sound:** Enter to select a desire **Sound Mode** and set **Bass**, **Treble**, **Balance** and **Equalizer**.

* **VGA Set:** Enter to access **Auto Adjust**, **HPosition**, **VPosition**, **Phase** and **Frequency**.

SCREEN MIRRORING

For iOS System

Screen Mirroring via Router's WiFi

- 1 Go to **Homepage** > **Setup** to enter **Settings** interface, then select **Network** > **WiFi** > **Scan** to search and connect the projector to your router's WiFi.

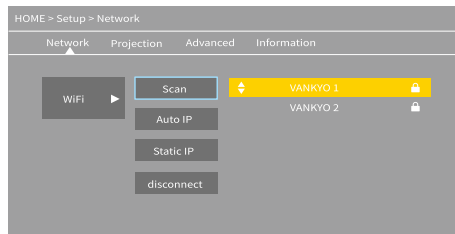

- 2 Enter WiFi settings of your iOS device and connect it to the same router's WiFi.
- 3 Return the screen back to **Homepage**, then select **iOS Cast** to enter the following interface.

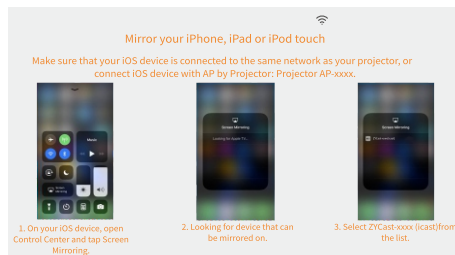

- 4 Activate **Screen Mirroring/AirPlay Mirroring** in the **Control Center** of your iOS device and search for the projector.
- 5 Select **ZYCast-xxxx(icast)** from the searching list to connect.

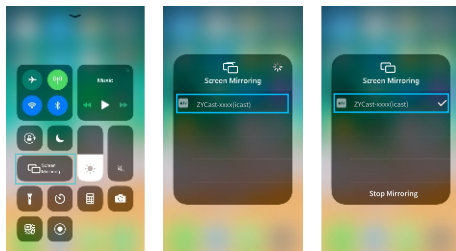

- 6 The contents on your iOS device will be mirrored to the wall/screen after a successful connection.

Tip:

To activate screen mirroring function of your **MacBook**, please follow the below steps:

- 1 Click **Control Center** icon in the menu bar at the top of the Mac screen.
- 2 Click **Screen Mirroring** to search for the projector.
- 3 Select **ZYCast-xxxx(icast)** to connect.

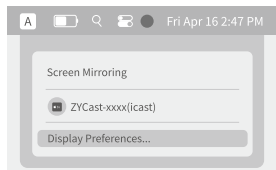
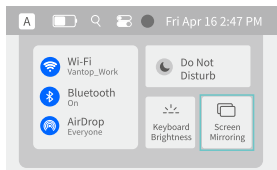

Screen Mirroring via Cellular Data

- 1 Go to Homepage > iOS Cast to enter the following interface.

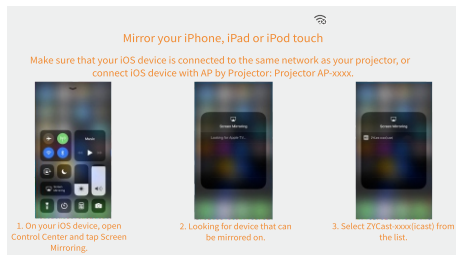

- 2 Enter WiFi settings of your iOS device and connect it to the WiFi of Projector AP-xxxx.
- 3 Activate **Screen Mirroring/AirPlay Mirroring** in the **Control Center** of your iOS device and search for the projector.
- 4 Select **ZYCast-xxxx(icast)** from the searching list to connect.
- 5 The contents on your iOS device will be mirrored to the wall/screen.

For Android System

To activate this function, please make sure your Android device supports **Multi-screen/Wireless display**. Names may differ from one Android device to another.

- 1 Turn on the WiFi switch on your Android device.

Note:

Successful WiFi connection is not a must, but please make sure the WiFi switch on your Android device is ON.

- 2 Go to Homepage > Miracast to enter the following interface.



- 3 Activate **Multi-Screen** function on your Android device and search for the projector.
- 4 Select **ZYCast-xxxx(mcast)** from the searching list to connect.
- 5 The contents on your Android device will be mirrored to the wall/screen after a successful connection.

Note:

For screen mirroring through wired connection, please prepare an extra Lightning/Micro USB/Type C to HDMI adapter to connect your mobile device with the projector.

Notes:

- 1 Due to copyright restrictions of Hulu, Netflix, and similar services, the contents CAN NOT be mirrored or cast.
- 2 If the projected image freezes, check the network connection; or reboot the projector, then go to **Homepage > Setup > Advanced > Restore Factory Default** and select **Confirm** to do a reset on the projector.
- 3 The fluency of screen mirroring will be affected by the network connection. A bandwidth of 100Mbit or more is recommended when using screen mirroring.
- 4 Make sure your mobile device is close to the projector when using wireless connection. A distance within 3ft is recommended.
- 5 Some mobile devices may not support screen mirroring due to the compatibility.

SETTINGS

Go to **Homepage > Setup** to enter the following interface, then press ◀ / ▶ to toggle through menu options including **Network**, **Projection**, **Advanced** and **Information** and preview their corresponding submenu lists.

Press ▼ to enter a certain submenu and press ↶ to return to the main menu bar.

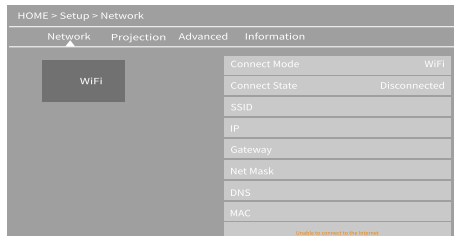

1 Network

Go to **WiFi > Scan** to search and connect the projector to your router's WiFi.

2 Projection

* Projection Mode

Depending on how you position your projector, you may need to change projection modes so that the images can be projected correctly. Available options include **Front Desktop**(default), **Rear Desktop**, **Front Ceiling** and **Rear Ceiling**.

3 Advanced

* Language

Enter to select a language for the projector.

* Boot Source

Set your desire booting screen for the projector. Options include **Home**(default), **HDMI**, **VGA**, **AV** and **Media**.

* **Sleep Timer**

Set the time duration for the projector to shut down automatically. Options include **Off**, **10min**, **20min**, **30min**, **60min**, **90min** and **120min**.

* **iOS Play Mode**

Set to mirror or cast contents on your iOS devices. When you select **screen mirroring SD**, you are mirroring the screen of your device after a successful connection; otherwise, when you select **screen casting SD**, you can cast a video to the projected screen and still use your device without interrupting the video.

* **Local Update**

Update the projector using a USB disk with upgrade file. (Contact our customer service to get the upgrade file.)

* **Online Update**

Enter to update the firmware of the projector when a newer version is available.

* **Restore Factory Default**

Restore the projector to the factory settings.

4 Information

Displays detailed information of the projector, including **Model Number**, **Memory**, **Extended Storage** and **Software Version**.

PROJECTION DISTANCE&SIZE

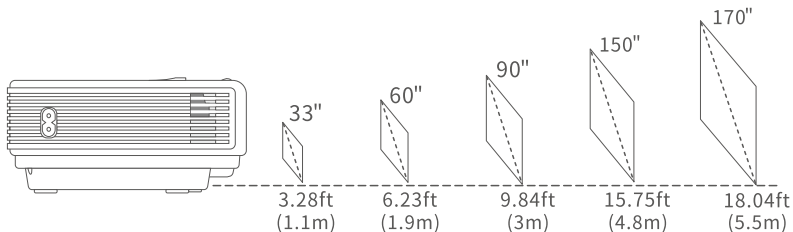

* The recommended projection distance varies with different projection contents. Please adjust the distance between the wall/ screen and the projector properly as needed.

* Ambient darkness will improve the clarity of the projected images.

SPECIFICATION

Display Technology	LCD	Light Source	LED
Resolution	Native 1280 x 720	Input Signal	576i, 576P, 720i, 720P, 1080i, 1080P
Installation Type	Front/Rear/Ceiling	Aspect Ratio	16:9/4:3/Auto
Focus	Manual	Electronic Keystone	± 15°
Speaker	2W/8ohm x 2	Power Supply	AC 100-240V, 50/60Hz
Unit Dimension	7.8 x 5.9 x 2.7 inches (198 x 148.6 x 68mm)	Unit Net Weight	1.98 lbs (0.9kg)
Photo Format Supported	JPG/E/BMP/PNG	Audio Format Supported	ACC/MP2/MP3/PCM/FLAC/WMA
Mounting Screws	M4 Metric	Screw Number	1
Video Format Supported	AVI/MP4/MKV/FLV/MOV/RMVB/3GP/MPEG1/MPEG2/H.264/XVID		
Ports	USB Port x 1 / HD In x 1 / AV In x 1 /VGA Port x 1/Audio Out x 1/Memory Card Slot x 1		

TROUBLESHOOTING GUIDE

- 1 The contents from Hulu, Netflix, and similar services can not be mirrored or cast.
 - * Due to the copyright restriction from Hulu, Netflix, and similar services, the contents CAN NOT be mirrored or cast.
- 2 What should I do if I want to watch the content from Hulu, Netflix, and similar services via the projector?
 - * Please prepare a Fire TV stick , Roku stick or Chromecast™ (not included), then connect it to the projector.
- 3 Blurry Image
 - * Adjust focus ring/keystone.
 - * Projector and screen/wall must be in effective distance.
- 4 Remote Unresponsive
 - * Make sure remote points at IR receiver directly.
 - * Do not cover IR receiver.
 - * Try a new pair of AAA batteries.
- 5 Upside Down Images
 - * Go to **Homepage > Setup > Projection > Projection Mode** to flip the projection image.
- 6 Factory Reset

Go to **Homepage > Setup > Advanced > Restore Factory Default**, then select **Confirm** to reset the projector to default settings.

FCC Statement

Any Changes or modifications not expressly approved by the party responsible for compliance could void the user's authority to operate the equipment. This device complies with part 15 of the FCC Rules. Operation is subject to the following two conditions:

- (1) This device may not cause harmful interference, and
- (2) this device must accept any interference received, including interference that may cause undesired operation.

NOTE: This equipment has been tested and found to comply with the limits for a Class B digital device, pursuant to part 15 of the FCC Rules. These limits are designed to provide reasonable protection against harmful interference in a residential installation. This equipment generates, uses and can radiate radio frequency energy and, if not installed and used in accordance with the instructions, may cause harmful interference to radio communications. However, there is no guarantee that interference will not occur in a particular installation. If this equipment does cause harmful interference to radio or television reception, which can be determined by turning the equipment off and on, the user is encouraged to try to correct the interference by one or more of the following measures:

- Reorient or relocate the receiving antenna.
- Increase the separation between the equipment and receiver.
- Connect the equipment into an outlet on a circuit different from that to which the receiver is connected.
- Consult the dealer or an experienced radio/TV technician for help.

This equipment complies with FCC radiation exposure limits set forth for an uncontrolled environment. This equipment should be installed and operated with minimum distance 20cm between the radiator & your body.

This transmitter must not be co-located or operating in conjunction with any other antenna or transmitter.

ISED/C Warning

This device complies with Industry Canada licence-exempt RSS standard(s). Operation is subject to the following two conditions:

- (1) this device may not cause interference, and
- (2) this device must accept any interference, including interference that may cause undesired operation of the device.

Le présent appareil est conforme aux CNR d'Industrie Canada applicables aux appareils radio exempts de licence. L'exploitation est autorisée aux deux conditions suivantes:

- (1) l'appareil ne doit pas produire de brouillage, et
- (2) l'utilisateur de l'appareil doit accepter tout brouillage radioélectrique subi, même si le brouillage est susceptible d'en compromettre le fonctionnement.

The device is compliance with RF exposure guidelines, users can obtain Canadian information on RF exposure and compliance. The minimum distance from body to use the device is 20cm.

Le présent appareil est conforme

Après examen de ce matériel aux conformité ou aux limites d'intensité de champ RF, les utilisateurs peuvent sur l'exposition aux radiofréquences et la conformité and compliance d'acquérir les informations correspondantes. La distance minimale du corps à utiliser le dispositif est de 20cm.

CAUTION

To avoid replacement of a battery with an incorrect type.

Don't dispose of a battery into fire or a hot oven, or mechanically crush or cut a Battery.

Don't leave a battery in an extremely high temperature surrounding environment.

To avoid battery subjected to extremely low air pressure.

The mains plug is used as the disconnect device, the disconnect device shall remain readily operable.



The symbol indicates for indoor use only



Class II equipment



The symbol indicates DC voltage



The symbol indicates AC voltage



RECYCLING

This product bears the selective sorting symbol for Waste electrical and electronic equipment (WEEE).

This means that this product must be handled pursuant to European directive 2012/19/EU in order to be recycled or dismantled to minimize its impact on the environment. User has the choice to give this product to a competent recycling organization or the retailer when he buys a new electrical or electronic equipment.

This product can be used across EU member states.

The mains plug is used as the disconnect device, the disconnect device shall remain readily operable.

EU Compliance Statement: Shenzhen VanTop Technology & Innovation Co., Ltd. hereby declares that this device is in compliance with the essential requirements and other relevant provisions of the Directive 2014/53/EU.

A copy of the EU Declaration of Conformity is available online at <https://doc.vantop.com/>.

VANKYO SUPPORT

North America support@ivankyo.com

United Kingdom support.uk@ivankyo.com



www.ivankyo.com



[@VankyoOfficial](https://www.facebook.com/VankyoOfficial)



VANKYO