

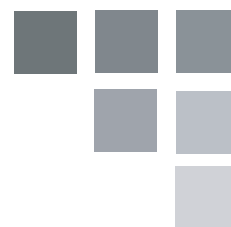

OWNER'S USE AND CARE GUIDE
GUIDE D'UTILISATION ET D'ENTRETIEN
GUÍA DE UTILIZACIÓN Y CUIDADO PARA EL PROPIETARIO

MODEL • MODÈLE • MODELO
DKC054A1BSLDB

KEG COOLER
GLACIÈRE DE BIÈRE PRESSION
BARRIL REFRIGERADOR





TO OBTAIN WARRANTY SERVICE YOU MUST PROVIDE A VALID PROOF OF PURCHASE.
PLEASE STAPLE YOUR RECEIPT TO THIS PAGE FOR FUTURE REFERENCE.

POUR OBTENIR LE SERVICE SUR GARANTIE VOUS DEVEZ FOURNIR UNE PREUVE D'ACHAT
VALIDE. VEUILLEZ AGRAFER VOTRE REÇU À CETTE PAGE POUR RÉFÉRENCE FUTURE.

PARA OBTENER SERVICIO DE GARANTÍA, DEBE PROVEER UN RECIBO ORIGINAL. POR
FAVOR ENGRAPE SU RECIBO A ÉSTA PÁGINA EN CASO QUE NECESITE HACER UN
RECLAMO.

IMPORTANT - GROUNDING METHOD

This product is factory equipped with a power supply cord that has a three-pronged grounded plug. It must be plugged into a mating grounding type receptacle in accordance with the National Electrical Code and applicable local codes and ordinances. If the circuit does not have a grounding type receptacle, it is the responsibility and obligation of the customer to exchange the existing receptacle in accordance with the National Electrical Code and applicable local codes and ordinances. The third ground prong should not, under any circumstances, be cut or removed. Never use the cord, the plug or the appliance when they show any sign of damage. Do not use your appliance with an extension cord unless it has been checked and tested by a qualified electrician or electrical supplier. Improper connection of the grounding plug can result in risk of fire, electric shock and/or injury to persons associated with the appliance. Check with a qualified service representative if in doubt that the appliance is properly grounded.

IMPORTANT - MÉTHODE POUR LA MISE À LA TERRE

Ce produit arrive d'origine avec un cordon d'alimentation équipé d'une prise à trois fiches. Il doit être branché dans une prise avec une fiche de mise à la terre en conformité avec le Code National de l'Électricité et les codes et règles locales applicables. Si la prise murale n'a pas de mise à la terre, il est de la responsabilité et l'obligation du client de changer la prise existante pour la rendre conforme aux Codes Nationaux de l'Électricité, aux codes et règles locaux applicables. La fiche de la mise à la terre ne doit pas, en aucune circonstance, être coupée ou retirée. Si vous apercevez des signes de dommage, n'utilisez jamais le cordon d'alimentation, la prise ou l'appareil. N'utilisez jamais l'appareil avec une rallonge sauf si elle a été vérifiée et testée par un électricien qualifié ou un fournisseur de matériel électrique. Une fiche de mise à la terre mal branchée peut entraîner un risque d'incendie, de choc électrique ou de blessures aux personnes qui utilisent l'appareil. Si vous n'êtes pas certain que l'appareil est correctement mis à la terre, consultez un préposé du service qualifié.

IMPORTANTE - MÉTODO DE CONEXIÓN A TIERRA

Este producto viene equipado con un cable eléctrico que tiene un enchufe de tres patas con conexión a tierra. Este debe colocarse en una toma de corriente con conexión a tierra de acuerdo con el Código nacional de electricidad y códigos y ordenanzas locales correspondientes. Si el circuito no cuenta con una toma de corriente con conexión a tierra, es responsabilidad y obligación del cliente sustituir la toma de corriente actual de acuerdo con el Código nacional de electricidad y códigos y ordenanzas locales correspondientes. Bajo ninguna circunstancia se debe cortar o eliminar la tercera pata de conexión a tierra. Nunca utilice el cable, el enchufe o el artefacto cuando muestre un signo de daño visible. No utilice el artefacto con una extensión salvo que un proveedor eléctrico o electricista calificado la inspeccione y la pruebe. Una instalación inadecuada de la conexión a tierra puede dar como resultado un riesgo de incendio, descarga eléctrica o lesiones a las personas asociadas con el artefacto. Verifique con un representante calificado de servicio en caso de dudas sobre si el artefacto tiene una buena conexión a tierra.

CONTENTS * TABLE DES MATIÈRES * ÍNDICE

KEG COOLER

Owner's Use and Care Guide1-16

- Welcome
- Important Safety Information
- Features
- Installation Instructions
- Operation Instructions
- Care and Maintenance
- Troubleshooting
- Warranty

GLACIÈRE DE BIÈRE PRESSION

Guide d'utilisation et d'entretien du propriétaire.....17-32

- Bienvenue
- Consignes de sécurité importantes
- Caractéristiques
- Consignes d'installation
- Consignes d'utilisation
- Soins et entretien
- Dépannage
- Garantie

BARRIL REFRIGERADOR

Guía de utilización y cuidado para el propietario.....33-48

- Bienvenido
- Información importante sobre seguridad
- Características
- Instrucciones de instalación
- Instrucciones de funcionamiento
- Cuidado y mantenimiento
- Solución sugerida
- Garantía

Includes American Sankey tap coupler only.

Inclut robinet de prise Américain Sankey
seulement.

Incluye grifo Americano solamente.

Model • Modèle • Modelo
DKC054A1BSLDB

Welcome

Welcome to the Danby family. We are proud of our quality products, and we believe in dependable service. We suggest that you read this Owner's Manual before plugging in your new appliance as it contains important operational information, safety information, troubleshooting and maintenance tips to ensure the reliability and longevity of your appliance. Visit www.Danby.com to access self-service tools, FAQs and much more. For additional assistance call 1-800-263-2629.

Note the information below; you will need this information to obtain service under warranty.
To receive service, you must provide the original receipt.

Model Number: _____
Serial Number: _____
Date of Purchase: _____

NEED HELP?

Before you call for service, here are a few things you can do to help us serve you better:

Read this Owner's Use and Care Guide:

It contains instructions to help you use and maintain your appliance properly.

If you received a damaged appliance:

Immediately contact the retailer (or builder) that sold you the appliance.

Save time and money:

Check the Troubleshooting section at the end of the guide before calling. This section helps you solve common problems that may occur.

If you do need service, you can relax, knowing help is only a phone call away.



1-800-26- **Danby**
(1-800-263-2629)



Important Safety Information

READ AND FOLLOW ALL SAFETY INSTRUCTIONS



IMPORTANT WARNING

DANGER: Risk of child entrapment. Before you throw away your old appliance:

- Take off doors or remove the gasket.
- Leave the shelves in place so that children may not easily climb in.

DON'T WAIT! DO IT NOW!

OPERATION REQUIREMENTS

To avoid installation or operation difficulties, read these instructions thoroughly.

- This appliance must be grounded. Connect only to a properly grounded outlet. See Grounding Instructions section.
- Do not operate this appliance if it has a damaged power cord or plug, if it is not working properly, or if the appliance has been damaged or dropped. If the power cord is damaged it must be replaced by the manufacturer, its service agent or similarly qualified person to avoid hazard.
- Never allow children to operate, play with, or crawl inside the appliance.
- Never clean appliance parts with flammable fluids. The fumes can create a fire hazard or explosion.
- Do not store or use gasoline or any other flammable vapors or liquids in the vicinity of this or any other appliance. The fumes can create a fire hazard or explosion.
- Do not splice the power cord that is equipped with this appliance.
- Keep power cord away from heated surfaces.
- Do not immerse power cord, plug or the appliance itself in water.
- Do not use this product near water for example, in a wet basement, laundry room or near a sink.
- Do not use corrosive chemicals or vapors in this appliance.
- Use this appliance only for its intended use, as described in this manual.
- Do not store open containers in this appliance.
- Do not cover or block any openings on the appliance.
- Do not store perishable food items such as (but not limited to) meats and dairy products in your wine cooler. This appliance does not get cold enough to be food safe.
- This appliance is intended for household use only. Do not operate or store this appliance outdoors.
- This appliance should be serviced only by qualified service personnel. Contact the nearest authorized service facility for examination, repair or adjustment.
- Before connecting the appliance to a power source, let it stand upright for approximately 6 hours; this will reduce the possibility of a malfunction in the cooling system from handling during transportation.

SAVE THESE INSTRUCTIONS!



Important Safety Information

READ AND FOLLOW ALL SAFETY INSTRUCTIONS

GROUNDING INSTRUCTIONS

This appliance is equipped with a cord having a grounding wire with a grounding plug. The plug must be plugged into an outlet that is properly installed and grounded. This appliance must be grounded. In the event of an electrical short circuit, grounding reduces the risk of electric shock by providing an escape wire for the electric current.

WARNING - Improper use of the grounding plug can result in a risk of electric shock. Consult a qualified electrician or service agent if the grounding instructions are not completely understood, or if doubt exists as to whether the appliance is properly grounded.

If the outlet is a standard 2-prong wall outlet, it is your personal responsibility and obligation to have it replaced with a properly grounded 3-prong wall outlet.

For best operation, plug this appliance into its own electrical outlet to prevent flickering of lights, blowing of fuse or tripping of circuit breaker

DO NOT USE AN EXTENSION CORD

Use an exclusive 115V wall outlet. Do not connect your appliance to extension cords or together with another appliance in the same wall outlet. Do not splice the cord. Do not under any circumstances cut or remove the third ground prong from the power cord. Do not use an adapter plug with this appliance.

SAFETY REQUIREMENTS

Ensure that component parts shall be replaced with like components and that servicing shall be done by factory authorized service personnel, so as to minimize the risk of possible ignition due to incorrect parts or improper service.

This appliance must be grounded. In the event of an electrical short circuit, grounding reduces the risk of electrical shock by providing an escape wire for the electrical current. The serial rating plate indicates the voltage and frequency the appliance is designed for.

WARNING! EXPLOSION HAZARD! Risk of fire or explosion due to puncturing of refrigerant tubing. Do not use sharp objects to aid in defrost. Please handle with care. Keep flammable materials and vapors such as gasoline away from the refrigerator. Use nonflammable cleaner.

Disposal of this unit should be in accordance with federal and local regulations.

This appliance is not intended for use by persons (including children) whose physical, sensory or mental capabilities may be different or reduced, or who lack experience or knowledge, unless such persons receive supervision or training to operate the appliance by a person responsible for their safety.

WARNING: Keep ventilation openings, in the appliance enclosure or in the built-in structure, clear of obstruction.

WARNING: Do not use mechanical devices or other means to accelerate the defrosting process, other than those recommended by the manufacturer.

WARNING: Do not damage the refrigerant circuit.

WARNING: Do not use electrical appliances inside the food storage compartments of the appliance, unless they are of the type recommended by the manufacturer.

SAVE THESE INSTRUCTIONS!



Important Safety Information

READ AND FOLLOW ALL SAFETY INSTRUCTIONS

WARNING: CO₂ CAN BE DANGEROUS!

CO₂ Cylinders, when charged, contain high pressure compressed gas which can be hazardous if not handled properly. Read and understand the following procedures for CO₂ cylinders before installation:

1. Always check the D.O.T. (Department of Transportation) as well as the T.C. (Transport Canada) test date located on the neck of the cylinder before installation. If the date is older than five (5) years, do not use! Return the gas cylinder to a gas supplier for re-certification (service charges may be applicable).
2. Always connect a CO₂ gas cylinder to a regulator. Failure to do so could result in an explosion which can possibly result in death or injury when the cylinder valve is opened.
3. Always follow correct procedures when cylinders are changed as per local codes.
4. Always secure a CO₂ gas cylinder in an “upright” position.
5. Always keep a CO₂ gas cylinder away from heat. Store extra cylinders in a cool place (preferably 70°F/21°C). Securely fasten with a chain in an upright position when storing.
6. Always ventilate and leave the area immediately after any leakage of CO₂.
7. Never connect a CO₂ gas cylinder directly to a beer keg.
8. Never drop or throw a CO₂ cylinder.
9. Never connect a keg without at least one safety pressure release. There are two safety mechanisms in the pressure system;
 - One at or on the CO₂ regulator.
 - One at or on the product container coupler in the pressure gas line.

Note: The regulator and keg coupler supplied with this unit are inclusive of such safety mechanisms.



CO₂ WARNING

If it becomes difficult to breathe and/or your head starts to ache, abnormal concentrations of carbon dioxide (CO₂) may be present in the area.

CLOSE THE MAIN VALVE ON THE CO₂ CYLINDER, VENTILATE AND LEAVE THE ROOM IMMEDIATELY!



IMPORTANT WARNING

Beer is easily available with Danby's Keg Cooler, however, it is not intended to be available to people under the legal age to consume beer. Danby does not assume liability for the unlawful use or consumption of the beer.

PLEASE DRINK RESPONSIBLY AND PLEASE DON'T DRINK AND DRIVE!

SAVE THESE INSTRUCTIONS!



Installation Instructions

INCLUDED ACCESSORIES

Remove and inspect all accessories supplied with this unit and ensure they are all present and in good condition. In the event any of the accessories are missing and/or not in good condition, please call Danby toll free at **1-800-263-2629** and speak with one of our Consumer Service Representatives.

1. **Beer Tower**
2. **Rubber Gasket** (may not be required in all unit configurations)
3. **Safety Guard Rail**
4. **Drip Tray**
5. **Adjustable Thermostat**
6. **CO₂ Regulator**
7. **CO₂ Gas Cylinder**
8. **CO₂ Gas Cylinder Support**
9. **Evaporator**
10. **Door**
11. **Beer Keg** (not included)
12. **Metal Plate**
13. **Castors (4)**

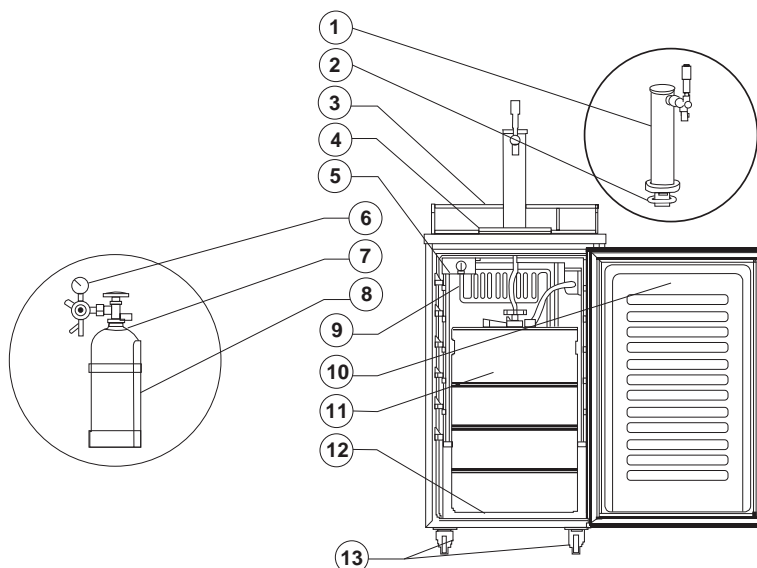

BEFORE USING YOUR KEG COOLER

- Remove the exterior and interior packaging.
- Check to be sure you have all the following parts:
 - 1 Safety Guard Rail
 - 1 drip tray (2 pieces)
 - 1 CO₂ Cylinder support
 - 1 CO₂ Regulator
 - 1 CO₂ Empty Cylinder
 - 1 CO₂ Gas line hose (coloured)
 - 1 Beer Hose
 - 1 Beer keg couplers
 - 1 Beer tower
 - 1 Pull handle (Beer tower faucet)
 - 4 Plugs: For guard rail holes
 - 1 metal plate for cabinet bottom
 - 3 Wire shelf
 - 1 steel clamp for coloured hose
 - 2 plastic washers for front casters
 - 4 Casters (2 front with locks)
- Before plugging in the keg cooler, let it stand upright for approximately 6 hours. This will reduce the possibility of a malfunction in the cooling system from handling during transportation.
- Clean the interior surface with lukewarm water using a soft cloth.



Installation Instructions

INSTALLATION OF KEG COOLER

- This appliance is designed to be free standing only and should not be recessed or built-in.
- Place your keg cooler on a floor that is strong enough to support the unit when it is fully loaded.
- Allow 8-12 cm (3-5 inches) of space between the back and sides of the keg cooler and any adjacent wall to allow proper air circulation to cool the compressor.
- Locate the keg cooler away from direct sunlight and sources of heat (stove, heater, radiator, etc.). Direct sunlight may affect the acrylic coating and heat sources may increase electrical consumption. Extreme cold ambient temperatures may also cause the keg cooler not to perform properly.
- This unit is not designed for outside installation (i.e. garages, porches, etc.).
- Avoid locating the keg cooler in excessive humidity.
- Plug the keg cooler into a dedicated, properly installed-grounded wall outlet. Do not under any circumstance cut or remove the third ground prong from the power cord. Any questions concerning power and or grounding should be directed toward a certified electrician or an authorized service centre.
- After plugging the appliance into a wall outlet, allow the unit to cool down for 2-3 hours before placing any contents in the keg cooler compartment.



WARNING

CO₂ GAS CAN BE DANGEROUS

CO₂ cylinders contain high-pressure compressed gas which can be hazardous if not handled properly. Make sure you read and understand all safety procedures for CO₂ cylinders before installation.

BEER KEG INSTALLATION INSTRUCTIONS

Keg Installation Sketch

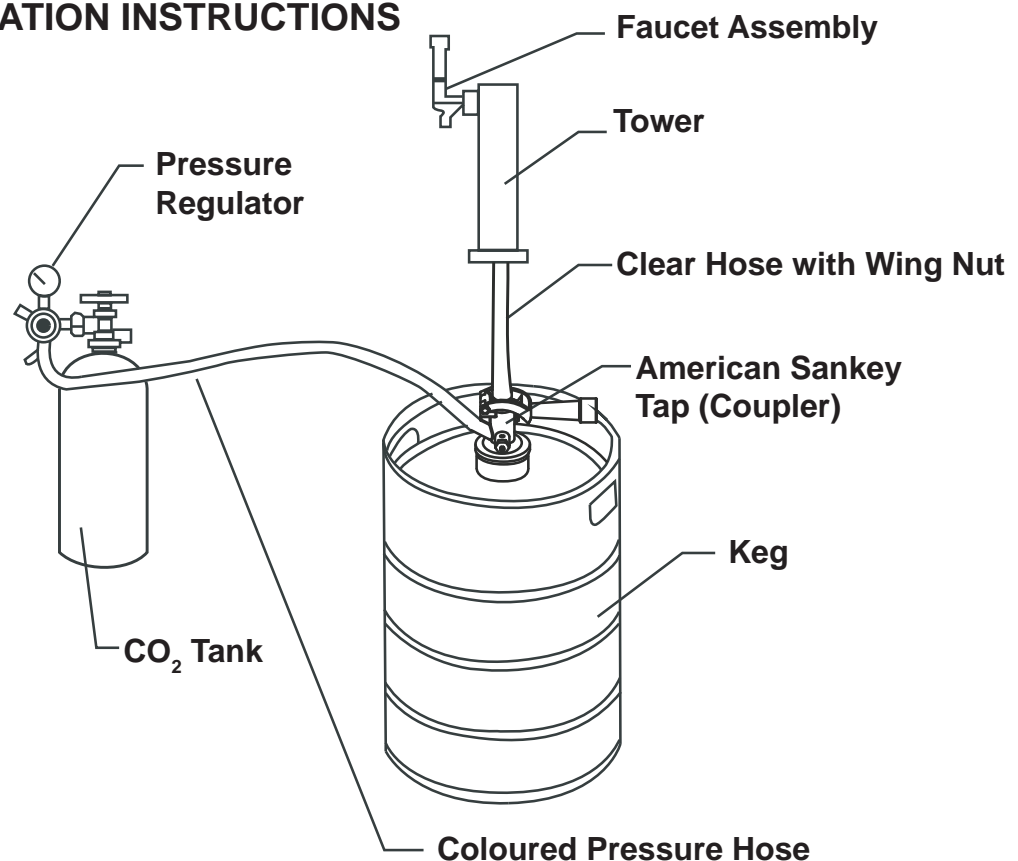



Installation Instructions

BEER KEG INSTALLATION INSTRUCTIONS

Install the four castors. The two locking castors should be placed at the front. Four screw holes have been pre-drilled into the unit's bottom at each corner for each castor. Put the metal washers provided on the front castors before installing them.

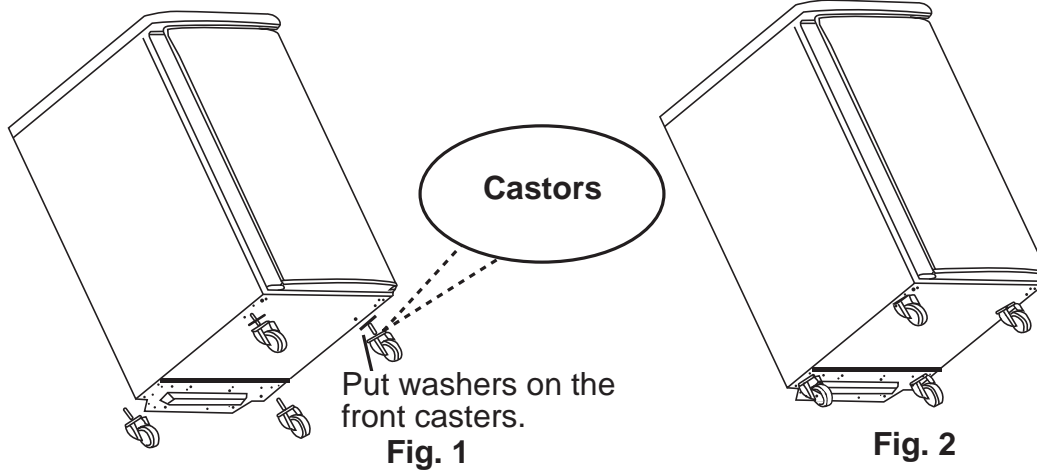

Castor Brake Guide

The two front castors are supplied with brakes to ensure the unit does not move excessively while being used. It is recommended to engage the brakes while the unit is in use to avoid damage to the unit, the contents or your personal property.

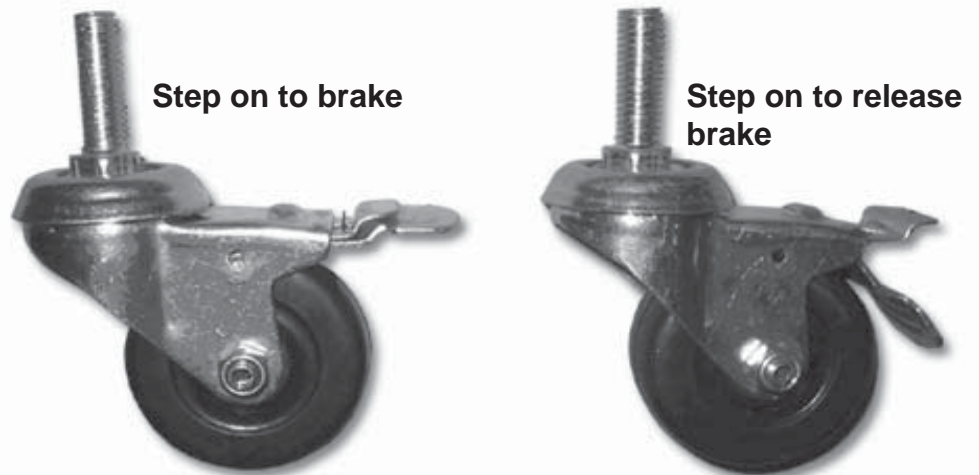

Installation of CO₂ Cylinder Support

Install the metal support provided onto the four studs located on the exterior back wall of the chassis.

Align the holes in the support with the studs and push down firmly.

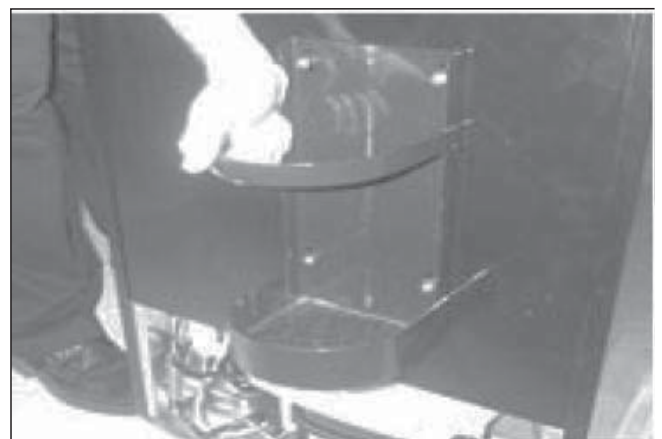



Installation Instructions

Installation of CO₂ Cylinder and CO₂ Regulator

The CO₂ cylinder does not come filled. The cylinder must be filled with CO₂ before use.

Place the charged cylinder into the support stand.

Attach the CO₂ regulator to the cylinder by turning the regulator nut onto the cylinder valve, making sure the washer is securely inserted into the connecting nut. Tighten snug using an adjustable wrench (not supplied) and ensure there are no leaks, i.e. no hissing sounds when the CO₂ is turned on.



Installation of CO₂ Air Line Outside Cabinet and CO₂ Air Line Hose to Regulator

Remove the plug located at the exterior back of the cabinet, in the top left hand corner. Save the plug for later use if you decide to convert the unit to a refrigerator.

Feed the gas line through the cabinet and out through the uncovered hole.

Attach the open end of the hose to the hose barb connection on the regulator. Secure the hose by using one clamp provided. Use pliers or a screwdriver to tighten the clamp to prevent leaks.



Installation of the Beer Tower

- Remove the plug from the top of the fridge cabinet by twisting and pulling out. Save the plug for later use if you decide to convert the unit to a refrigerator.
- Unravel the beer line (clear hose) from the tower and insert the beer line and wing nut through the uncovered hole on top of the unit.
- Lock the beer tower assembly to the top of the unit and make sure to position the beer faucet so it is aligned with the front of the cabinet.
- The rubber gasket can be used to make the connection between the tower and the cooler tighter if needed. If the beer tower will not turn to lock in place, try removing the rubber gasket. (The rubber gasket may not be required in all unit configurations).
- If the tower faucet is leaking or if the beer is very foamy, ensure that the washers inside the faucet are intact. Replace the washers with spare parts from the accessory bag, if necessary.

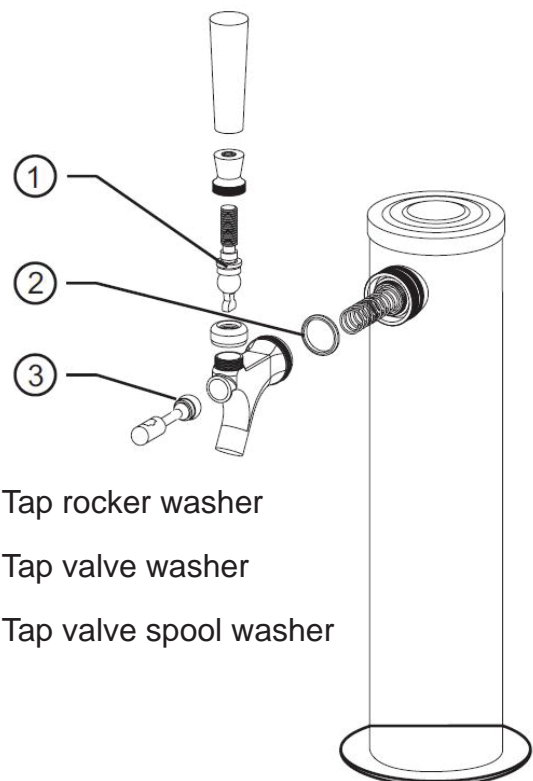

1. Tap rocker washer
2. Tap valve washer
3. Tap valve spool washer



Installation Instructions

Installation of the Protective Metal Plate

The protective metal plate should be installed on the bottom of the inside of the cabinet. This plate should always be installed when a keg is in place to protect the floor of the cabinet against damage.

Installation of the Beer Keg

- Position the beer keg directly in front of the open door. Using keg handles only, carefully lift the beer keg.
- To place the beer keg inside the cabinet, brace your knees behind the beer keg. Lift the front of the keg just enough so the front end of the keg is resting on the front edge of the keg cooler bottom cabinet.
- Grasp the keg handles and slide it all the way into the cabinet.

Note: Two people should lift the keg to avoid back injury.



Installation of the CO₂ Air Line Hose

Attach the end of the air line (coloured) hose provided to the hose connection on the side of the coupler. Ensure that the check valve is inserted into the connection, number 4 on the image below.

If, after assembly, beer will not flow, ensure that the check valve has a small hole in it. If there is no hole in the check valve then CO₂ cannot enter the line and the beer will not flow.

Connecting the Beer Tower to the Coupler

- Ensure all washers are properly inserted into the coupler, as per below image.
- Ensure the valve spool plastic rod is in place inside the coupler, number 2 on the below image.
- Place the wing nut attached to the end of the beer line into the top of the coupler, turning until tight.

If, after assembly, the beer is very foamy, it most likely means that a connection in the coupler is leaking and air is entering the lines. Double check all connections in the coupler and replace the washers from the accessory bag as necessary.

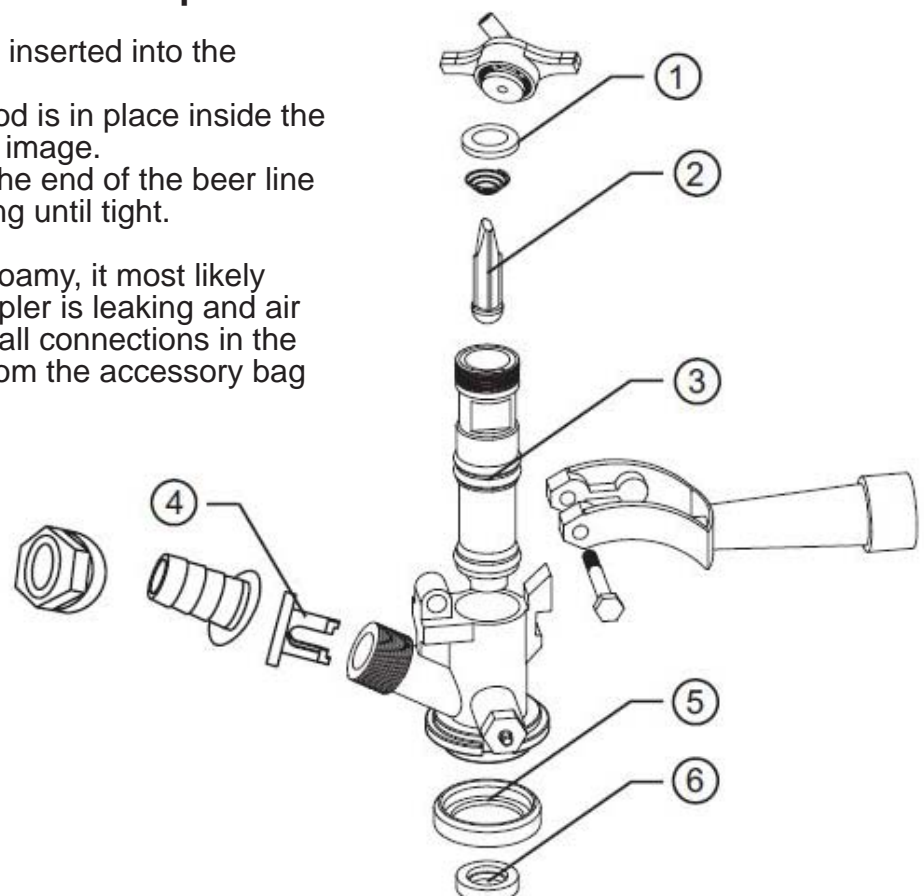

1. Valve washer
2. Valve spool plastic rod
3. Valve spool O-type washer
4. Check valve
5. Valve washer
6. Valve washer



Installation Instructions

Installation of the Keg Coupler

Insert the keg coupler into the locking neck of the beer keg and turn it clockwise to lock into position, making sure the keg coupler handle is in the closed position, with the handle up.

How to Tap a Keg of Beer

- Make sure the CO₂ is turned off and the valve on the regulator is in the closed position.
- Pull out and release the pressure release valve on the coupler to purge any air pressure.
- Make sure the beer tower faucet handle is in the closed position.
- Pull coupler handle out and downward until it locks into its open position. The teeth on the underside of the coupler will bite into the locking neck of the beer keg.

Note: If a keg is very tall, it may be necessary to connect the coupler to the keg before inserting the keg into the keg cooler.

Coupler closed position

Coupler open position

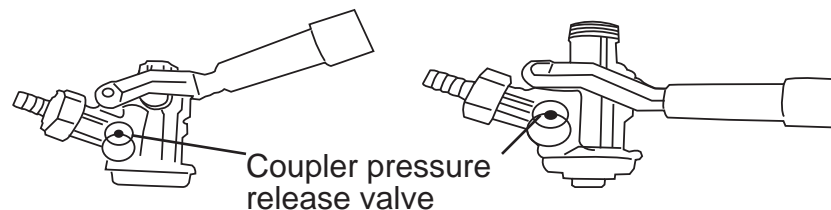

Opening the CO₂ Cylinder Main Valve

- Make sure the secondary shut-off valve (shown below in “open” position) is closed. To open the main CO₂ cylinder valve, slowly turn the main valve counter-clockwise until fully open.
- Notice the needle on the regulator gauge start to climb.

Adjusting the CO₂ Regulator

The gauge monitors low internal keg pressure and should be adjusted to read between 8-12 PSI. The pressure can be adjusted as needed. If the beer is very foamy, try turning the PSI down. If the flow of beer is very weak, try turning the PSI up.

Note: After making any adjustment to the PSI, wait 5 - 10 minutes before attempting to pour another beer to allow the pressure to equalize.

- Release adjustment lock nut marked 2.
- Using a flat screwdriver, turn regulator screw marked 3.
 - To increase pressure, turn screw clockwise.
 - To decrease pressure, turn screw counter-clockwise.
- Retighten lock nut marked 2.
- Open secondary shut off valve to let CO₂ flow into the keg.
- Allow several minutes for the keg to properly pressurize. Regulator gauge may drop while this happens.

Note: Listen for hissing along all connections to identify if there are any leaks.

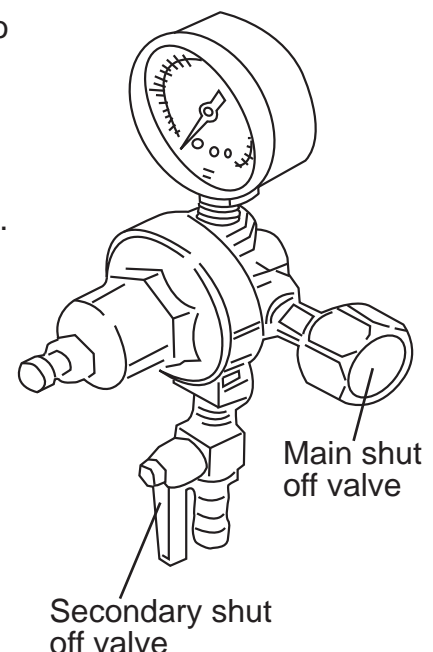



Installation Instructions

Spanner Faucet Wrench

Spanner faucet wrench (provided) is for either removing or tightening the faucet connection.

Note: To prevent leakage, use the provided wrench to further tighten the faucet connection.

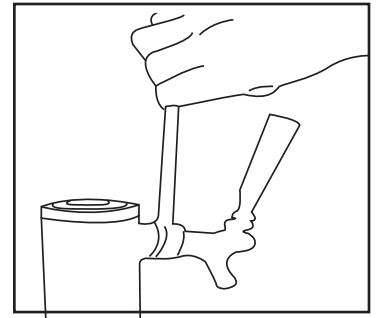

Plastic Faucet Lever

Attach the black plastic lever (pull handle) to the top of the faucet by tightening it by hand going clockwise until the end, holding in the silver nut underneath so it does not turn. If there is still a small drip from the faucet, you may have overtightened the silver nut and may need to unscrew silver snug going counter-clockwise (as shown one turn).

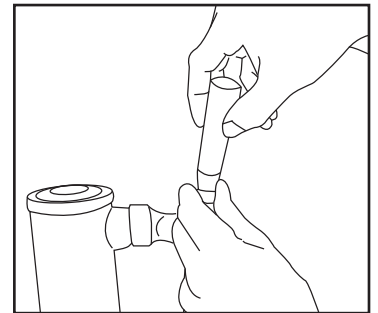

DISPENSING OF BEER

- Keep beer keg refrigerated at all times.
- Never allow beer lines to dry out.
- Use clean glassware before pouring.
- Hold glass at a 45° angle, when it is 2/3 full, start to straighten glass as the glass fills.
- Always make sure the faucet handle is pushed all the way back.

Keg sizes that can be used in your keg cooler				
1/2 barrel	59 Liters	15.5 gals	1984 oz.	164 12-oz. Glasses
1/4 barrel	30 Liters	7.8 gals.	992 oz.	82 12-oz. Glasses
1/6 barrel	20 Liters	5.2 gals.	661 oz.	55 12-oz. Glasses
1/8 barrel	15 Liters	4.0 gals.	496 oz.	41 12-oz. Glasses

Note: The refrigerator compartment cannot accommodate the “Coors” style beveled barrel keg.

Note: Our keg cooler accepts domestic kegs up to 16-1/8” in diameter and up to 23-3/8” in height. Check with your distributor to make sure keg is correct size.

Note: It is important to allow the keg to sit upright and undisturbed, for 2 hours before tapping.



Operating Instructions

SETTING THE TEMPERATURE

The temperature is controlled by adjusting the thermostat control knob. To start the unit and achieve maximum cooling quickly:

- Turn the temperature control knob clockwise to the maximum setting on the wide, blue section of the control dial (Fig. A).
- Allow the unit to run at this setting for 3-4 hours.
- When maximum cooling is achieved, turn back the temperature control knob to a medium temperature.
- To turn off the cooling, rotate the control knob to the “0” (OFF) position (Fig. B).

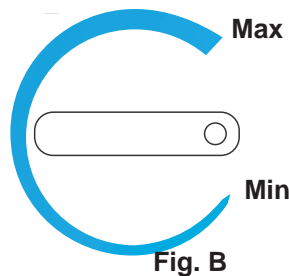
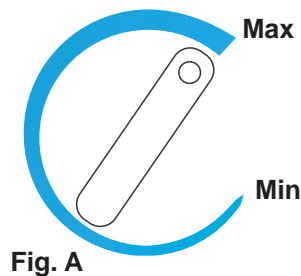

AUTOMATIC DEFROSTING

There is no need to defrost the keg cooler. Defrost water collects and passes through the drain outlet in the rear wall into a tray located above the compressor, where it evaporates.

Note: If the unit is unplugged, power lost or turned off, you must wait 3 to 5 minutes before restarting the unit. If you attempt to restart before this time delay, the compressor may not start.

CONVERTING TO AN ALL REFRIGERATOR

1. Turn the control knob to the “OFF” position.
2. Close the main valve on the CO₂ cylinder.
3. Close the secondary shut-off valve on the regulator pipe.
4. Close the connection between the beer keg and the keg coupler.
5. Drain any remaining beer from the lines. (We recommend cleaning at this point, please see Care and Maintenance section).
6. Disconnect the beer line and CO₂ gas line from the keg coupler.
7. Remove the beer keg.
8. Remove the keg coupler.
9. Disconnect the gas line from the CO₂ cylinder.
10. Remove the CO₂ gas line from cabinet plug.
11. Replace the gas line rear cabinet plug.
12. Remove the beer tower. Also pull the beer line through the top of the cabinet.
13. Replace the top cabinet plug.
14. Adjust the temperature as desired.

Note: In order to convert the unit, you must disconnect the gas line from the regulator in order to remove it from the cabinet.

Note: If you desire a shelf in the converted “All Refrigerator” install the shelf by sliding it into the desired spot in the unit.



Operating Instructions

DOOR REVERSAL INSTRUCTIONS

To avoid personal injury to yourself or property, we recommend that someone assist you during the door reversal process.

This keg cooler has a door that can be set to open from the left or right side. This unit is delivered to you with the door opening from the left side. To reverse the opening direction, please follow the instructions below.

1. Undo the three (3) screws in each bracket using a Phillips screwdriver.
2. Remove the screws and bracket. Place to one side.
3. Slide the door down about 15 cm (6") and off the top hinge pin and lift away.
4. Use a flat head screwdriver to remove the pin from the top bracket. Replace it in the hinge bracket on the opposite side.
5. Remove the screw from the side of the fridge where the bracket is to be re-fitted.
6. Slide the fridge door back onto the top hinge, making sure it's the right way up. Screw the bottom hinge into place on the new side.
7. Check that the door is aligned horizontally and vertically and that the seals are closed on all sides before finally tightening the bottom hinge.

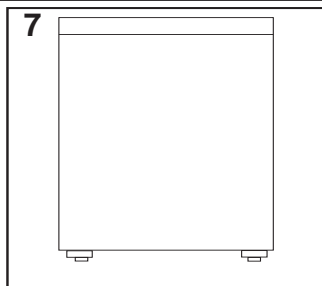
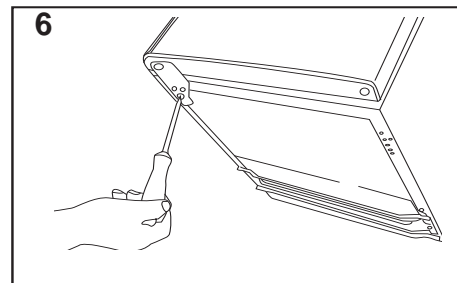
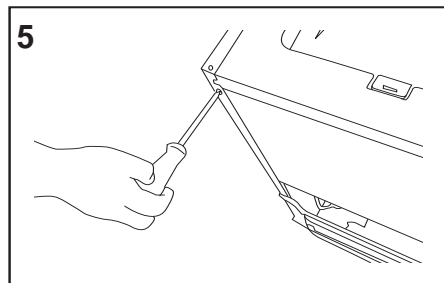
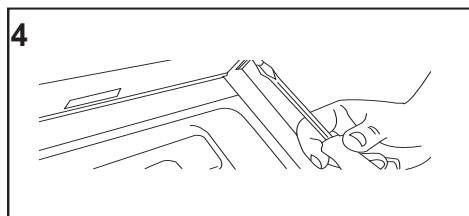
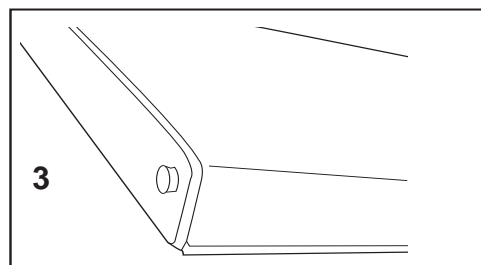
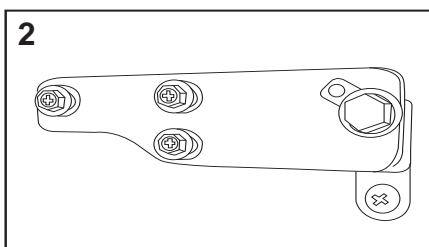
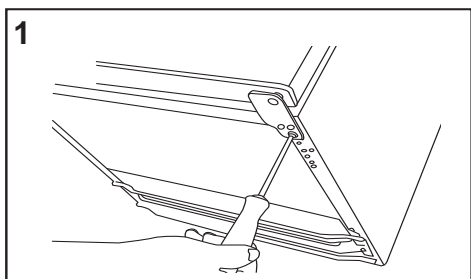



Care and Maintenance

CLEANING YOUR KEG COOLER

- Turn the temperature control to “OFF”, unplug the keg cooler, and remove the contents.
- Wash the inside surfaces with a warm water and baking soda solution. The solution should be 2 tablespoons of baking soda to a quart of water.
- Wash the shelves and stand with a mild detergent solution.
- Wipe down any electrical controls with a dry cloth.
- Wash the outside cabinet with warm water and mild liquid detergent. Rinse well and wipe dry with a clean soft cloth.

CLEANING YOUR BEER LINES

Beer lines have to periodically be cleaned because of a crystallized sugar build up which forms on the fittings, lines and taps commonly referred to as “beerstore”. If the “beerstore” is not completely removed in a cleaning process it will leave an unsanitary surface that can harbor microorganisms which will cause an undesirable flavour and/or cause the beer to go flat. Sufficient “beerstore” will also lead to dispense problems ranging from ‘wild’ beer (too much foam) to flat beer, regardless of the carbonation levels or quality (age) of the beer in the keg.

Scheduled line and faucet cleaning, with the proper equipment and chemical, eliminates the build-up of “beerstore” protecting the integrity of the product and condition of the dispense system and seals. The dispenser (beer) line should be cleaned approximately once every three (3) weeks or every other keg - whichever comes first. The dispenser faucet should be cleaned on a weekly basis or prior to every use if not used on a regular basis.

Note: If you have trouble manipulating the faucet lever, this is usually indicative that it may require cleaning. **DO NOT** apply force to move the handle in this situation, as this will likely lead to damaging the handle or faucet, and will not be covered by your warranty.

A standard cleaning kit will perform approximately eight (8) scheduled line cleanings. Line cleaning kits are readily available and can be purchased through our after sales service department.

For more information please call 1-800-26-DANBY (1-800-263-2629).

VACATION

Short Vacations - Leave the keg cooler operating during vacations of less than three (3) weeks.

Long Vacations - If the appliance will not be used for several months, remove all contents and unplug the power cord. Clean and dry the interior thoroughly. To prevent odor and mold growth, leave the door open slightly.

MOVING YOUR KEG COOLER

- Remove all the contents.
- Securely tape down all loose items inside your keg cooler.
- Tape the door shut.
- Be sure the keg cooler stays secure in the upright position during transportation. Also protect the outside of the keg cooler with a blanket or similar item.



Troubleshooting

Danby Consumer Care: 1-800-263-2629

Hours of operation:

Monday to Thursday 8:30 am - 6:00 pm Eastern Standard Time

Friday 8:30 am - 4:00 pm Eastern Standard Time

PROBLEM	POSSIBLE CAUSE
The unit does not operate	<ul style="list-style-type: none">• Not plugged in• The circuit breaker tripped or blown fuse
Turns on and off frequently	<ul style="list-style-type: none">• The room temperature is hotter than normal• The door is open too often• The door is not closed completely• The temperature control is not set correctly• The door gasket does not seal properly• The unit does not have proper clearance
Vibrations	<ul style="list-style-type: none">• Check that the keg cooler is level
The keg cooler seems to make too much noise	<ul style="list-style-type: none">• The rattling noise may come from the flow of refrigerant, which is normal• Gurgling, caused by liquid refrigerant cycling is normal• Contraction and expansion of the inside walls may cause popping and crackling noises• The keg cooler is not level
The door will not close properly	<ul style="list-style-type: none">• The keg cooler is not level• The door was reversed and not properly reinstalled• The gasket is dirty• The shelves or stand are out of position• The keg is not properly centered in the unit• The casters are not attached
Excessive beer foam	<ul style="list-style-type: none">• Ensure the beer line hose from the tower and the CO₂ air line hose from the CO₂ regulator are attached to the correct connections on the coupler; beer line to the top of the coupler, CO₂ air line to the side of the coupler• Check that there are no leaks in any connections• Ensure that the reed valve in the CO₂ connection at the coupler has a hole in it• The CO₂ pressure may be set too high; try turning the pressure down• Ensure that the valve spool plastic rod is inserted into the coupler
Weak beer flow	<ul style="list-style-type: none">• Ensure the beer line hose from the tower and the CO₂ air line hose from the CO₂ regulator are attached to the correct connections on the coupler; beer line to the top of the coupler, CO₂ air line to the side of the coupler• Check that there are no leaks in any connections• Ensure that the reed valve in the CO₂ connection at the coupler has a hole in it• The CO₂ pressure may be set too high; try turning the pressure down• Ensure there are no bends or kinks in any of the hoses that could impede flow

LIMITED IN-HOME APPLIANCE WARRANTY

This quality product is warranted to be free from manufacturer's defects in material and workmanship, provided that the unit is used under the normal operating conditions intended by the manufacturer.

This warranty is available only to the person to whom the unit was originally sold by Danby Products Limited (Canada) or Danby Products Inc. (U.S.A.) (hereafter "Danby") or by an authorized distributor of Danby, and is non-transferable.

TERMS OF WARRANTY

Plastic parts, are warranted for thirty (30) days only from purchase date, with no extensions provided.

First year During the first twelve (12) months, any functional parts of this product found to be defective, will be repaired or replaced, at warrantor's option, at no charge to the ORIGINAL purchaser.

To obtain service Danby reserves the right to limit the boundaries of "In Home Service" to the proximity of an Authorized Service Depot. Any appliance requiring service outside the limited boundaries of "In Home Service", it will be the consumer's responsibility to transport the appliance (at their own expense) to the original retailer (point of purchase) or a service depot for repair. See "Boundaries of In Home Service" below. Contact your dealer from whom your unit was purchased, or contact your nearest authorized Danby service depot, where service must be performed by a qualified service technician. If service is performed on the units by anyone other than an authorized service depot, or the unit is used for commercial application, all obligations of Danby under this warranty shall be void.

Boundaries of in-home service If the appliance is installed in a location that is 100 kilometres (62 miles) or more from the nearest service centre your unit must be delivered to the nearest authorized Danby Service Depot, as service must only be performed by a technician qualified and certified for warranty service by Danby. Transportation charges to and from the service location are not protected by this warranty and are the responsibility of the purchaser.

Nothing within this warranty shall imply that Danby will be responsible or liable for any spoilage or damage to food or other contents of this appliance, whether due to any defect of the appliance, or its use, whether proper or improper.

EXCLUSIONS

Save as herein provided, by Danby, there are no other warranties, conditions, representations or guarantees, express or implied, made or intended by Danby or its authorized distributors and all other warranties, conditions, representations or guarantees, including any warranties, conditions, representations or guarantees under any Sale of Goods Act or like legislation or statute is hereby expressly excluded. Save as herein provided, Danby shall not be responsible for any damages to persons or property, including the unit itself, howsoever caused or any consequential damages arising from the malfunction of the unit and by the purchase of the unit, the purchaser does hereby agree to indemnify and hold harmless Danby from any claim for damages to persons or property caused by the unit.

GENERAL PROVISIONS

No warranty or insurance herein contained or set out shall apply when damage or repair is caused by any of the following:

- 1) Power failure.
- 2) Damage in transit or when moving the appliance.
- 3) Improper power supply such as low voltage, defective house wiring or inadequate fuses.
- 4) Accident, alteration, abuse or misuse of the appliance such as inadequate air circulation in the room or abnormal operating conditions (extremely high or low room temperature).
- 5) Use for commercial or industrial purposes (i.e., If the appliance is not installed in a domestic residence).
- 6) Fire, water damage, theft, war, riot, hostility, acts of God such as hurricanes, floods etc.
- 7) Service calls resulting in customer education.
- 8) Improper Installation (i.e., building-in of a free standing appliance or using an appliance outdoors that is not approved for outdoor application). Proof of purchase date will be required for warranty claims; so, please retain bills of sale. In the event warranty service is required, present this document to our AUTHORIZED SERVICE DEPOT.

Warranty Service In-home

Danby Products Limited
PO Box 1778, Guelph, Ontario, Canada N1H 6Z9
Telephone: (519) 837-0920 FAX: (519) 837-0449

1-800-263-2629
07/14

Danby Products Inc.
PO Box 669, Findlay, Ohio, U.S.A. 45840
Telephone: (419) 425-8627 FAX: (419) 425-8629