

# sobro

Coffee Table User Manual

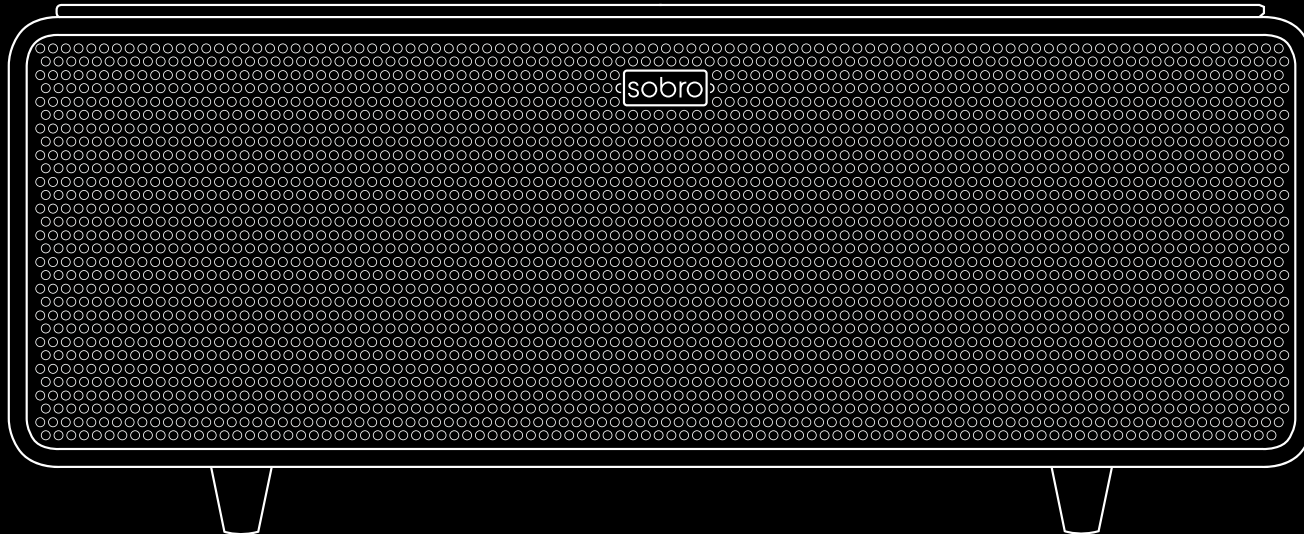

Designed in NYC | Patent Pending

Congrats on being ahead of the curve and being among the first to get the Sobro Coffee Table. You win.

Get ready to experience the sheer bliss of never having to get up from the couch to get a cold beverage in the middle of a game, the happiness of charging your phone without crawling underneath your couch to find a plug, and the exhilaration of watching your friends reactions at your next party.

So relax, put your feet up and read these instructions and we'll have you up and running in no time.

Without your support, we would not have been able to bring this amazing product to life.

Show us your Sobro style and post photos to Instagram with the hashtag **#sobrodesign**, to our Facebook page Sobro Home or email us at **info@storebound.com**.

Cheers,



Evan Dash, CEO, and the StoreBound team



# sobro

coffee table

Welcome..... 3

Sobro Timeline.....6-8

Important Safeguards..... 10

Choosing your Location..... 11

Installing Legs and Wheels..... 14-15

Installing the Power Cord ..... 16

Parts and Features ..... 18-19

Control Panel..... 20-21

Bluetooth Dongle..... 22

Audio Selection ..... 23

Settings ..... 24-25

Maintenance & Cleaning ..... 26

Troubleshooting & Support..... 27

# THE EVOLUTION OF THE SOBRO COFFEE TABLE

## Early Bro

Considered to be short with words but long with a battle stick, the early bro most definitely chilled out after a good hunt.



## The Table

The earliest incarnation, believed to be a simple block of stone, was used by the Egyptians for eating. Beer Pong came later.

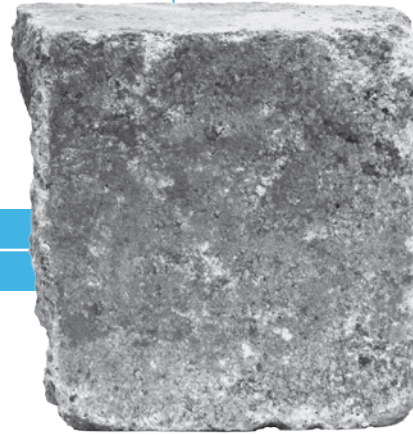

## The Loudspeaker

Bass from the first loudspeaker wouldn't exactly rattle your Prius' windows. The design was part of the first phone created by Alexander Graham Bell.

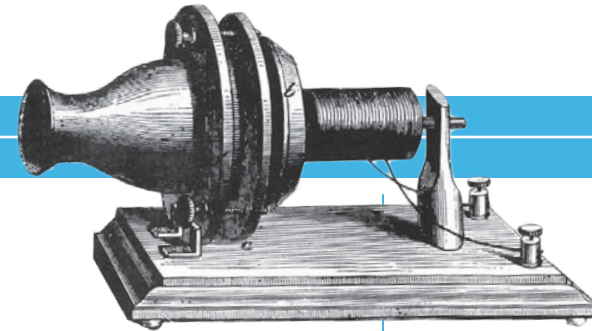

## Refrigeration

Most post WW2 households could afford a modern style fridge, allowing men all over the opportunity to let food spoil at a slower rate.



## The LED

Light-emitting diodes were invented by Nick Holonyak, Jr. in 1962 while working for GE. Dude later went on to win the Nobel Prize. You could say he lit things up in life.

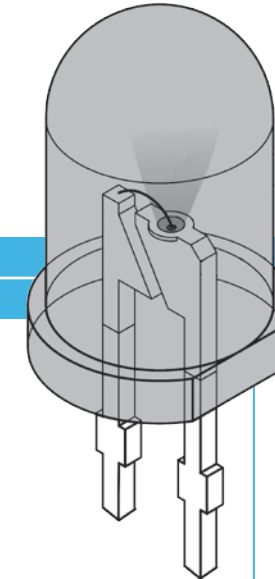

## Bluetooth

This radio wave based technology was named for a Danish King who enjoyed eating blueberries, and it was later incorporated into the goofiest tech to ever hang from your ear.





### The Sobro Coffee Table

With a refrigerated drawer, Bluetooth speakers, charging ports, and LED lights, the Sobro keeps you powered up. It could be the greatest living room innovation since the remote control.

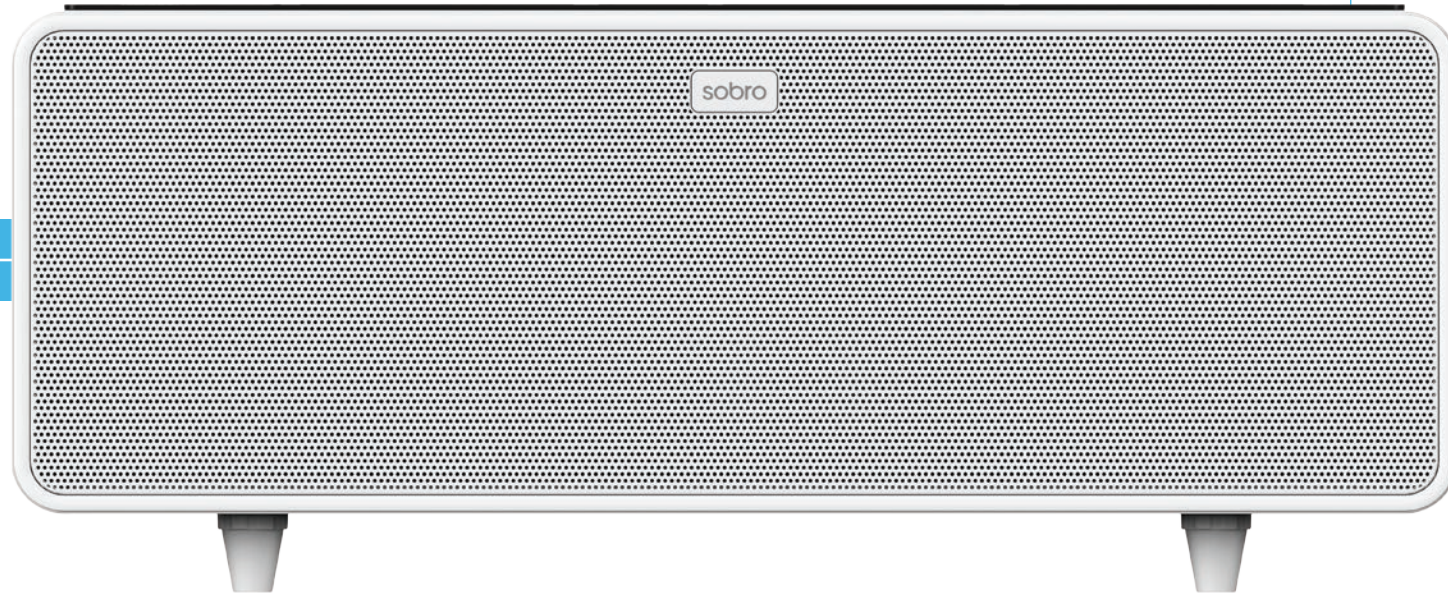

Designed for a digital lifestyle, Sobro is the furniture of the future. We've elevated the coffee table from a piece of wood that props up unopened large-format books, to an all-in-one center that connects your powered up life.

And the Sobro Coffee Table is just the start of our smart furniture revolution.

Stay tuned...

# IMPORTANT SAFEGUARDS: PLEASE READ AND SAVE THIS INSTRUCTION MANUAL

When using electrical appliances, basic safety precautions should be followed, including:

- Read all instructions.
- Make sure the appliance is cleaned thoroughly before using.
- Do not use appliance for other than its intended use. For household use only. Do not use outdoors.
- CAUTION: flammable refrigerant used! When handling, moving, and using the refrigerator; make sure to avoid either damaging the refrigerant tubing which may increase the risk of a leak.
- Remove all bags and packaging from appliance before use.
- For maintenance other than cleaning, please contact StoreBound directly at 1-800-898-6970 from 7AM-7PM PST Monday-Friday or by email at support@storebound.com.
- StoreBound shall not accept liability for damages caused by improper use of the appliance.
- The safety and operating instructions should be retained for future reference.
- Heed all warnings. All warnings on this product and in the operating instruction manual should be adhered to.
- DANGER - Risk of child entrapment. Before throwing away a refrigerator, remove the doors so that children may not easily climb inside.
- Refrain from using attachments that are not recommended by the appliance manufacturer, as this may result in fire, electric shock, or personal injury.
- Do not use the product near water and/or moisture, for example: near a bathtub, sink, in a wet basement; or near a swimming pool.
- Clean only with a slightly damp, lint-free cloth. Unplug this product from the wall outlet before cleaning.
- Do not block any ventilation openings. Install the appliance in accordance with the manufacturer's instructions.
- Slots and openings in the cabinet are provided for ventilation and to ensure reliable operation of the product and to protect it from overheating.
- This product should never be placed near or above a radiator or heat source. This product should not be placed in a built-in installation such as a bookcase or rack unless proper ventilation is provided or the manufacturer's instructions have been adhered to.
- This appliance has a polarized plug (one blade is wider than the other). To reduce the risk of electric shock, this plug will fit in a polarized outlet only one way. If the plug does not completely fit in the outlet, reverse the plug. If it still does not fit, contact a qualified electrician. Do not attempt to modify the plug in any way.
- A short power supply cord is to be provided to reduce the risk resulting from becoming entangled in or tripping over a longer cord. An extension cord may be used if care is exercised in its use. If an extension cord is used, the marked electrical rating of the extension cord should be at least as great as the electrical rating of the appliance. The extension cord should be arranged so that it will not drape over the countertop or tabletop where it can be pulled on by children or tripped over unintentionally.
- Do not operate this appliance with a damaged cord, damaged plug, after the appliance malfunctions, is dropped, or damaged in any manner. Return appliance to the nearest authorized service facility for examination, repair, or adjustment.
- Always unplug the appliance when not in use for an extended period of time.
- Safety check - upon completion of any service or repairs to this product ask the service technician to perform safety checks to determine that the product is in proper operating condition.
- The product should be operated only from the type of power source indicated on the marking label. If you are not sure of the type of power supply to your home, consult your appliance dealer or local power company. For products intended to operate from battery power, or other sources, refer to the operating instructions.
- Do not overload wall outlets and extension cords as this can result in the risk of fire or electric shock.
- Object and liquid entry -Never push objects of any kind into the product as they may touch dangerous voltage points or short out parts that could result in fire or electric shock. Never spill or spray any type of liquid on the product.
- Do not attempt to service this product yourself. Contact please contact StoreBound directly at 1-800-898-6970 from 7AM-7PM PST Monday-Friday or by email at support@storebound.com.
- When replacement parts are required, be sure the service technician uses replacement parts specified by the appliance manufacturer, or those that have the same characteristics as the original part.
- WARNING - Please refer to the information on the inside of the drawer for electrical and safety information before installing or operating the appliance.



Do not open the Circuit Board Cabinet as this will result in damage to the circuitry or electrical shock. If a foreign object should get into the appliance, contact customer service.



When removing the power plug from the wall outlet, always pull directly on the plug, never pull the cord.

**ATTENTION:** it is dangerous to use the same multipurpose power outlet for the Sobro table and other home appliances. Please do not use the same power outlet for the table along with any other home appliances.

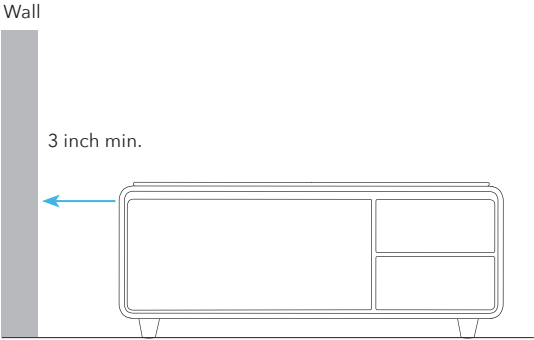

## Location

Place the Sobro Coffee Table in a dry and well-ventilated room. Do not place the appliance near a heat source (e.g. radiators, water heaters or similar devices) and do not expose the appliance to direct sunlight.



Before installing your Sobro, choose the location carefully. Avoid placing the Sobro in direct sunlight or close to a heat source. Avoid locations subject to vibrations and excessive dust, cold, or moisture.

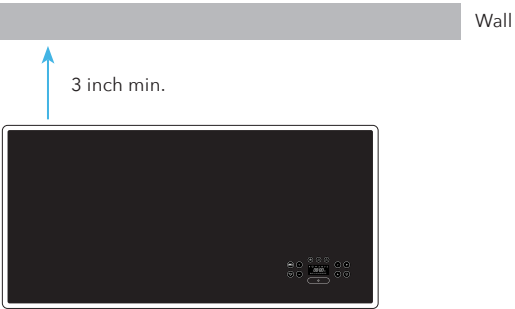

## Ventilation

Make sure that there is ample room around the Sobro Coffee Table to ensure adequate ventilation for the refrigerator. Do not place the back of the Sobro Coffee Table against a wall as this may result in overheating.



Before connecting the appliance to an electrical power supply, let the Sobro stand unplugged for about 4 hours in its final location, This will reduce the possibility of a malfunction in the cooling system due to mishandling or jostling in transport.



“Every once in a while we come across an invention that makes us slap our foreheads...the Sobro Coffee Table is one of those ideas”

—Way Important Reporter



**PLEASE READ:** Do not attempt to attach the legs or fully install the Sobro table on your own. You will need **two people** or more to completely install the Sobro. Then you can party on.

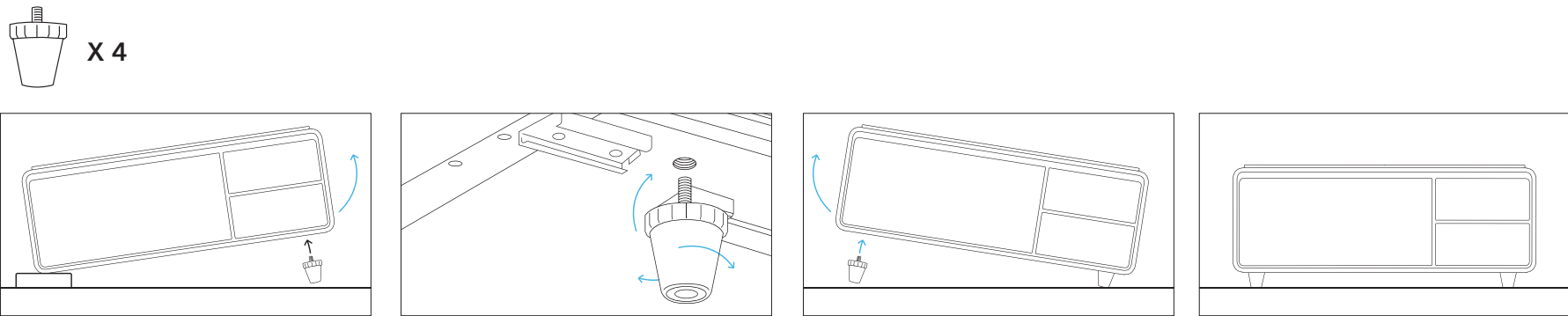

- Step One**

When attaching the four legs to your Sobro, use the foam shipping inserts or a blanket to serve as a cushion for the table to rest on.

Have one partner lift one side of the Sobro table off the ground\*. Rest the opposing side on a foam insert or cushion for protection.
- Step Two**

While the corner of the Sobro table is lifted, the other partner should attach the leg by screwing it into the leg nut. Screw in the leg until it is fully inserted into the Sobro table and is secure. Do not overtighten.
- Step Three**

Repeat the process with the other three legs of the Sobro. Remember to always protect the corners without legs by using either one of the foam inserts or a blanket to avoid damaging the table.
- Step Four**

After installing the legs or moving the Sobro, you must let the refrigerator coolant settle for a minimum of 4 hours before plugging in the Sobro.

**WE REPEAT:** Do not plug in the Sobro Coffee Table until 4 hours have passed.

**\* USE PROPER LIFTING TECHNIQUE**

(Refer to: [webmd.com/back-pain/proper-lifting-technique](http://webmd.com/back-pain/proper-lifting-technique)) If you have a history of back pain or injury, do not attempt to lift table. Sobro (Storebound, LLC) will not accept responsibility for any injury that may occur during set up process.

**SOBRO A GOGO:** The two wheels included are intended to be installed to allow you to easily move the Sobro table to your desired location. **WARNING:** These are not for wheeling the table up and down any type of stairs or steps.

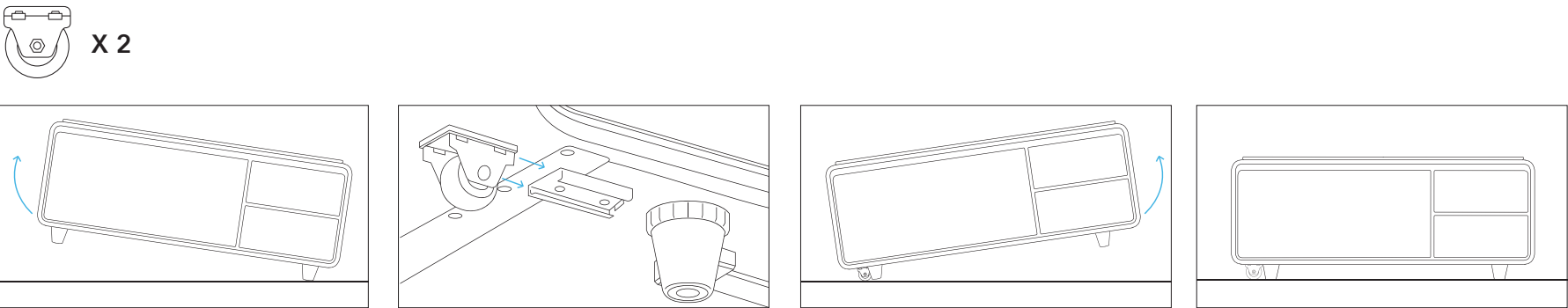

- Step One**

The Sobro Coffee Table comes with two wheel attachments for transportation. The two wheels attach to one side of the underside of the Sobro by sliding into the wheel braces.
- Step Two**

Have one partner lift one side\* of the Sobro table off the ground while the other partner slides each wheel into its corresponding wheel brace.
- Step Three**

To move the Sobro, after the wheels are installed, lift one end of the Sobro and use the wheels to roll it to the desired location. To remove the wheels, reverse the procedure in Step One.
- Step Four**

After installing the wheels and moving the Sobro, you must let the refrigerator coolant settle for a minimum of 4 hours before plugging in the Sobro.

**WE REPEAT:** Do not plug in the Sobro Coffee Table until 4 hours have passed.

**\* USE PROPER LIFTING TECHNIQUE**

(Refer to: [webmd.com/back-pain/proper-lifting-technique](http://webmd.com/back-pain/proper-lifting-technique)) If you have a history of back pain or injury, do not attempt to lift table. Sobro (Storebound, LLC) will not accept responsibility for any injury that may occur during set up process.



# INSTALLING THE POWER CORD



## Grounding Instructions:

This appliance must be plugged into a grounded socket. The power cord that is supplied with the appliance contains the appropriate grounding conductor and grounding plug.

The plug must be inserted into a wall outlet that has been grounded in accordance with the existing local codes and ordinances. The required nominal voltage and frequency are indicated on the rating label. Consult a qualified electrician for other concerns.

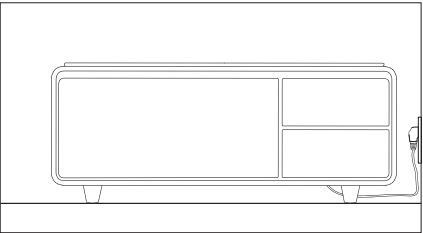
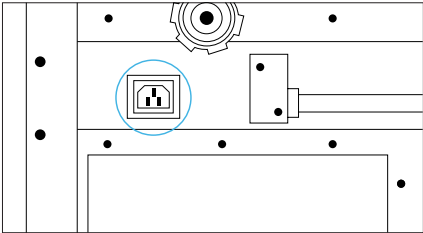
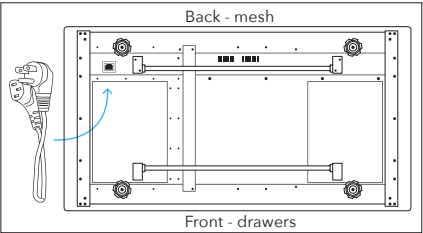
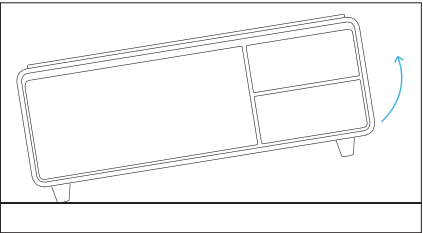

### Step One

**WARNING:** Do not attempt to install the power cord until the legs are installed.

Have one partner lift the right side\* of the Sobro table off the ground. Rest the opposing side on a foam insert or cushion for protection.

### Step Two

The power socket is located on the underside of the Sobro Coffee Table towards the back right corner.

Locate the socket and unwrap the power cord before attaching.

### Step Three

Plug in the adaptor end of the cord to the socket in the indicated location above.

### Step Four

After installing the legs or moving the Sobro, you must let the refrigerator coolant settle for a minimum of 4 hours before plugging in the Sobro.

**WE REPEAT:** Do not plug in the Sobro Coffee Table until 4 hours have passed.

### \* USE PROPER LIFTING TECHNIQUE

(Refer to: [webmd.com/back-pain/proper-lifting-technique](http://webmd.com/back-pain/proper-lifting-technique)) If you have a history of back pain or injury, do not attempt to lift table. Sobro (Storebound, LLC) will not accept responsibility for any injury that may occur during set up process.



**NOTE:** The maximum power draw on the Sobro table is 800 watts for all the outlets combined. Do not plug in appliances such as vacuums or blenders into the table to prevent the possibility of a short. If a short occurs, unplug items that are plugged into the table and the outlet should reset itself in 1 minute.

**NOTE:** The USB Ports can be used to charge mobile devices but are not part of the audio input system.

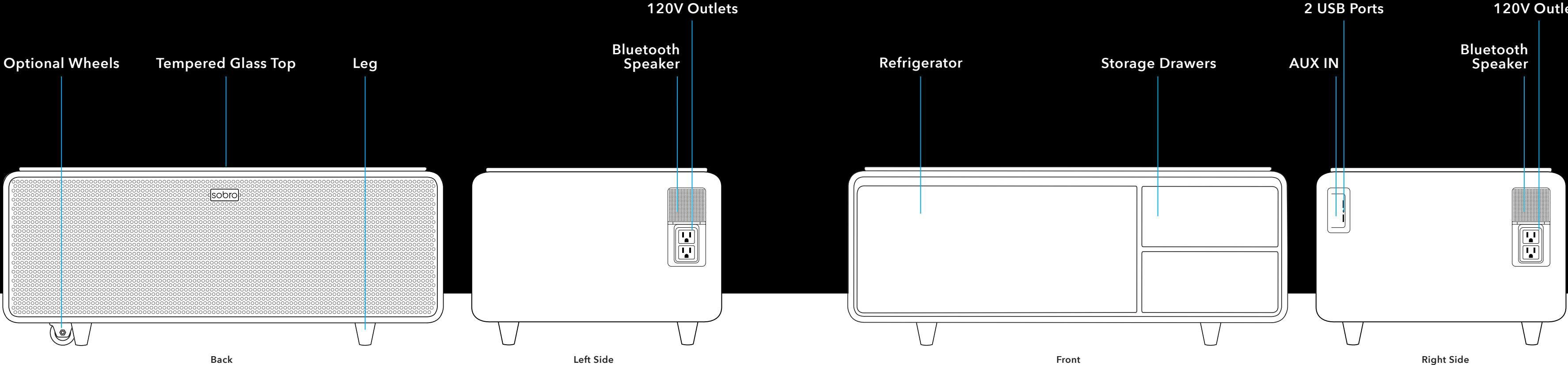

CONTROL PANEL

The table must be unlocked to use the control panel. To unlock the control panel, tap the Power/Lock & Unlock button. The control panel locks automatically after 30 seconds if no operation is performed.

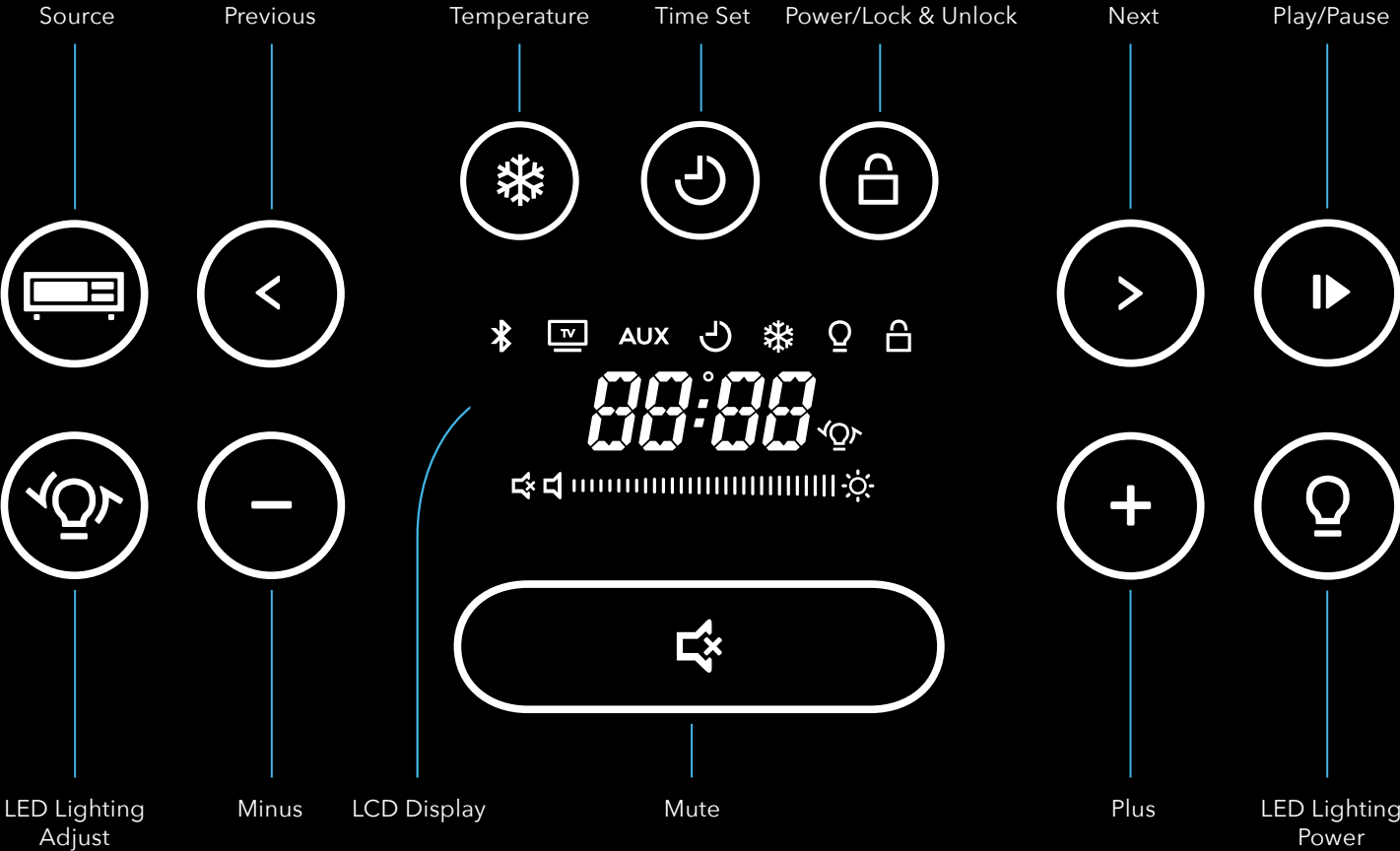

Primary

**Power/Lock & Unlock**  
Hold the button for 2 seconds to power on the table initially.  
Tap the button once to lock or unlock the panel.  
To turn the power off, the table must first be unlocked. Then, hold the button for 2 seconds. The refrigerator will remain on.

**Source**  
Press repeatedly to change the audio input source from Bluetooth, TV Dongle, or AUX-IN.

Settings

**Temperature**  
Press and hold for 2 seconds to enter the temperature setting.

**Time Set**  
Press and hold for 2 seconds to enter the time setting.

Controls

The table must be unlocked before using the controls.

**Play/Pause**  
Press once to pause the playback, press again to resume.

**Previous**  
Press this button to select the previous song or go back.

**Next**  
Press this button to select the next song or to skip forward.

**Plus**  
Increase the volume level, set the time or raise the refrigerator temperature.

**Minus**  
Decrease the volume level, set the time or lower the refrigerator temperature.

**Mute**  
Press to mute the sound, press again to resume.

Lights

The table must be unlocked before adjusting the lights

**LED Lighting Power**  
Press to turn on the LED lights, press again to turn off.

**LED Lighting Adjust**  
Press to adjust the LED color and/or brightness level.

Display



**LCD Display**  
Displays current operations and the time.



BLUETOOTH DONGLE

The Bluetooth dongle provided helps connect your non-Bluetooth enabled TV or device to the Sobro table. If you have a smart TV with Bluetooth built-in, you may not need the Bluetooth dongle to connect the audio from your TV to the Sobro table.

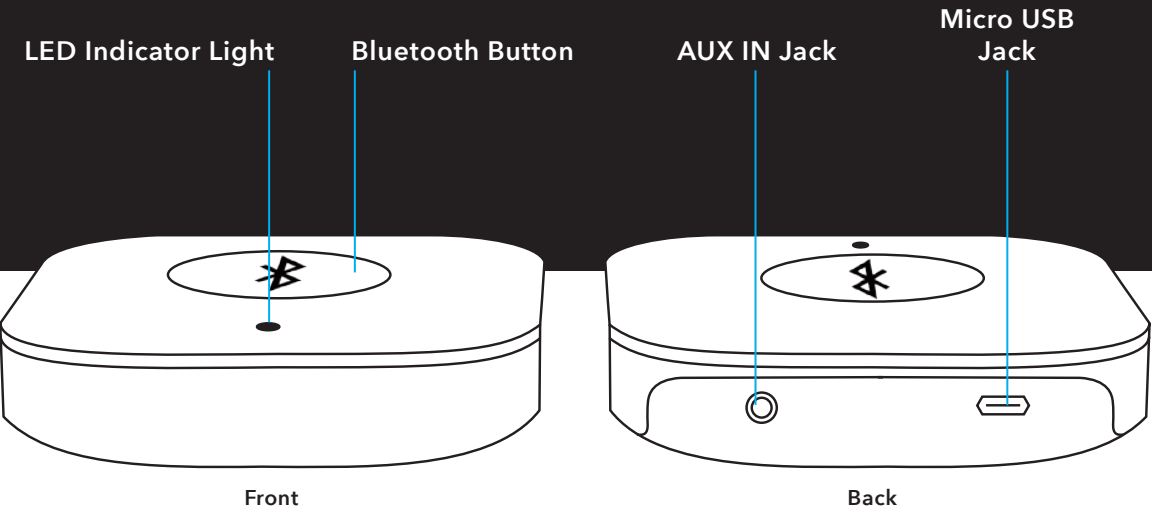

Setup & Assembly

- 1. Connect the Micro USB plug to the Micro USB jack on the back of the dongle.
- 2. Connect the USB end into the power adapter and then into a wall outlet to power the dongle.
- 3. Connect either the 3.5mm cable or RCA cable to the AUX IN jack on the back of the dongle based on the outputs of your TV or device.
- 4. Connect either the 3.5 mm or RCA plugs to the audio output of your TV or device.
- 5. Press the Power/Bluetooth button once to start the dongle.
- 6. To turn off the dongle, press and hold the Bluetooth button for 5 seconds.

Connect to the Sobro table:

- 1. Power on the dongle by pressing the Bluetooth button and to get ready to pair.
- 2. Wait for 5 seconds and the dongle will connect to the Sobro table automatically.
- 3. Put Sobro in TV mode.
- 4. When connecting, the blue LED indicator light will pulse.
- 5. When the Bluetooth connection is completed, the LED indicator will stop flashing.

AUDIO SELECTION

Press

Icon Lights Up

**Bluetooth: Default Mode**

After powering on the Sobro table, the Bluetooth icon on the display will automatically light up and flash. On the device you want to pair with the Sobro (mobile phone, tablet, Smart TV, etc...) begin Bluetooth pairing mode. Pair with the device called "SOBRO." When paired, the Bluetooth icon will illuminate steadily.

Specific procedures for Bluetooth pairing may vary from device to device. Check the user manual of your device for specific instructions about Bluetooth pairing. In some cases, you may need to enter a password on your mobile device to pair. If so, type in the password 0000.

Only one Bluetooth-enabled device can be paired with the Sobro at a time. To connect a new Bluetooth-enabled device, unpair the first one, or press and hold the "Source" button to disconnect. **NOTE:** Please keep the pairing range within 10 meters.

Press

Icon Lights Up

**TV Mode:**

This mode is designed for pairing the table with the Bluetooth dongle. First, power on the table. To select the TV mode, press the "Source" button until the TV icon on the display screen lights up.

Press

Icon Lights Up

**Audio Input Mode:**

When you have selected the AUX input, the "AUX In" logo will illuminate. Connect a 3.5mm audio cable (provided) between your device and the Sobro Coffee Table. You can now control the playback with your connected device. The USB ports do not support audio input.

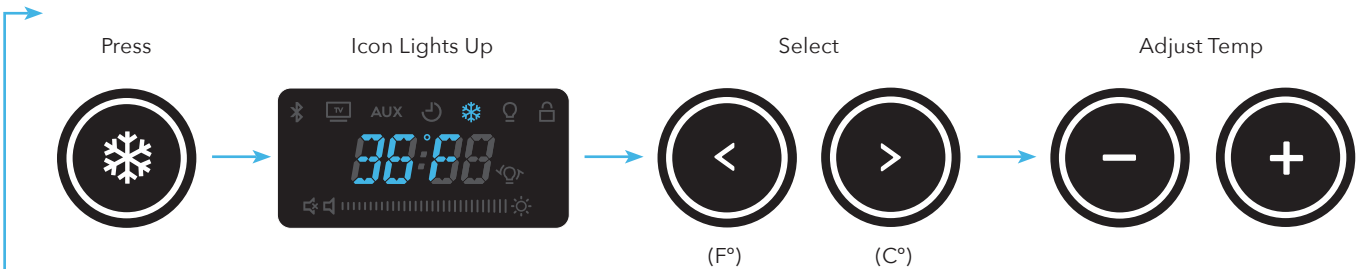

**Setting the Temperature:**

The Sobro must be powered on and unlocked before changing the settings. Press and hold the “Temp.” button to change the temperature settings. The “Temp.” icon will light up on the display. Use the “Previous” or “Next” button to switch the temperature between “Degrees Celsius” and “Degrees Fahrenheit”. Adjust the

temperature level by pressing the “+” or “-” button to increase or decrease the temperature of the refrigerator. Note: press the “Temp.” button again to save the settings. The settings will also be saved automatically if not changed after 5 seconds.

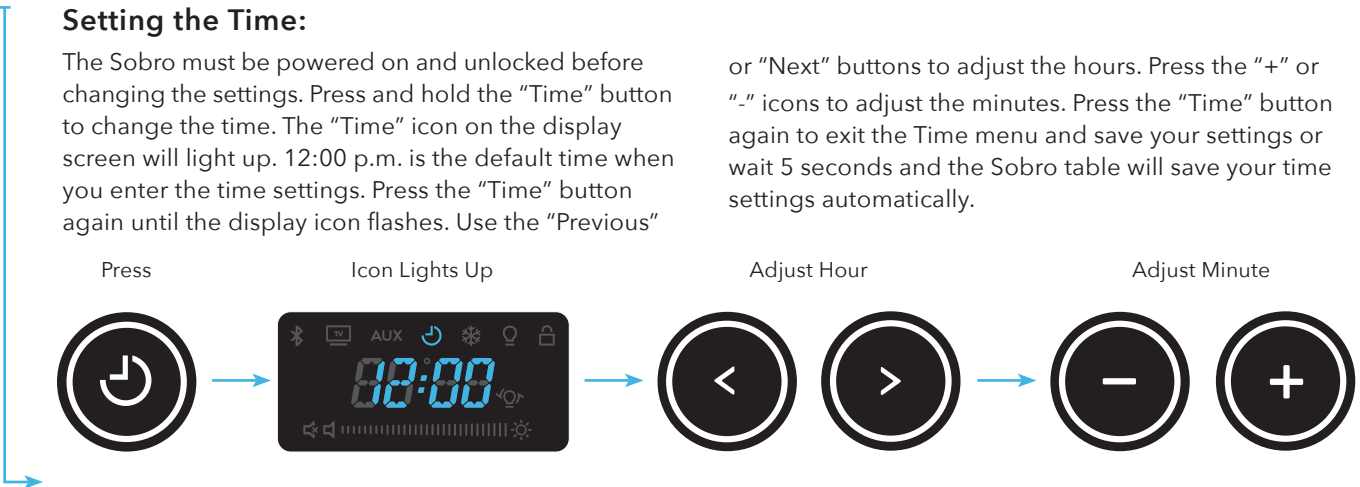

**Setting the Time:**

The Sobro must be powered on and unlocked before changing the settings. Press and hold the “Time” button to change the time. The “Time” icon on the display screen will light up. 12:00 p.m. is the default time when you enter the time settings. Press the “Time” button again until the display icon flashes. Use the “Previous”

or “Next” buttons to adjust the hours. Press the “+” or “-” icons to adjust the minutes. Press the “Time” button again to exit the Time menu and save your settings or wait 5 seconds and the Sobro table will save your time settings automatically.

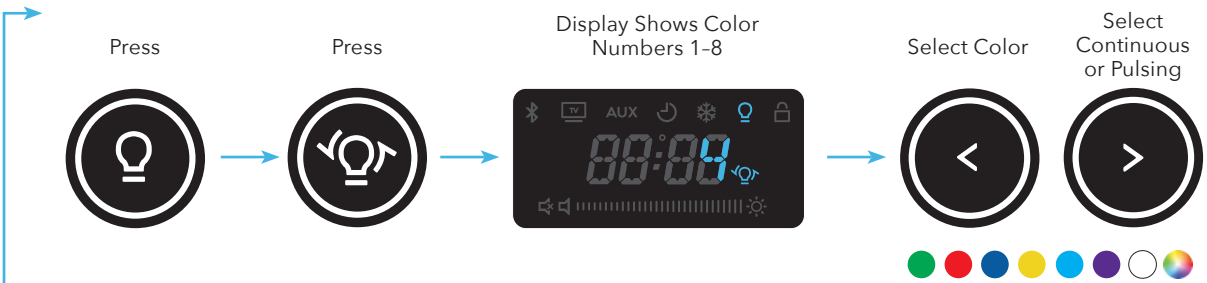

**Control the LED Color:**

The Sobro must be powered on and unlocked before changing the settings. First press the “LED Lighting Power” button and then press the “LED Lighting Adjust” button. Once the “LED Lighting Adjust” button is pressed the light bulb icon on the display will illuminate. This means you can now adjust the color. Press the “Previous”

button to change the color of the lights. There are 8 color choices. Press the “Next” button to determine if your selected color is continuous or pulses. The program will automatically exit in 5 seconds and save your settings.

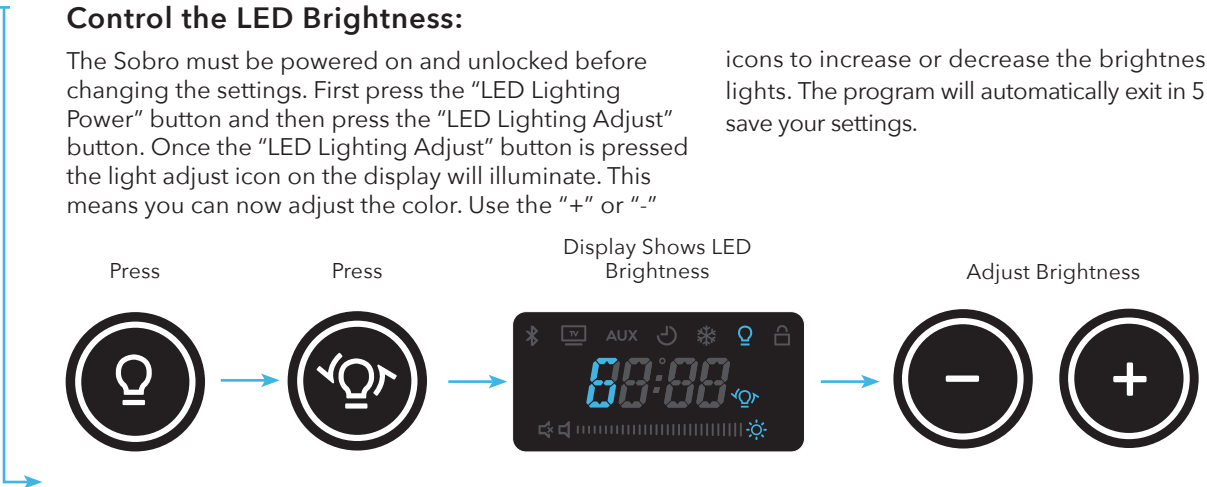

**Control the LED Brightness:**

The Sobro must be powered on and unlocked before changing the settings. First press the “LED Lighting Power” button and then press the “LED Lighting Adjust” button. Once the “LED Lighting Adjust” button is pressed the light adjust icon on the display will illuminate. This means you can now adjust the color. Use the “+” or “-”

icons to increase or decrease the brightness level of the lights. The program will automatically exit in 5 seconds and save your settings.

Clean the Sobro regularly to avoid dust accumulation. Wipe the surface of the table with the included microfiber cloth.

Use a small handheld vacuum or a soft brush to clean any dust. Do not use abrasive or sharp tools to clean your Sobro.

If you are powering off the table for an extended period of time, clean and dry the refrigerator drawer and store them in a clean, dry location. Do not place any parts outdoors.

Before cleaning the Sobro, please make sure to turn off the table and remove the plug. Do not submerge or douse any part of the appliance with water or any other liquid. Do not use abrasive or corrosive cleaning agents to clean the Sobro.

How To Prevent Odor Build-up:

Foods that may expire easily should not be placed in the refrigerator. Store foods in sealed plastic bags.

Keep the refrigerator clean and dry. Clean the drawer on a regular basis

Auto Shut-off Function:

The Sobro table has a freezing function that will shut the refrigerator off automatically if the ambient temperature is too low. If the ambient temperature is lower than 5°F, the refrigerator will not work.

How To Remove Odors:

If your refrigerator begins to develop an odor, clean the refrigerator with a non-corrosive or non-abrasive cleaning agent. Dry the refrigerator with a soft cloth and shut the drawer for 24 hours to remove the smell.

In order to avoid generating an odor in the refrigerator, avoid placing foods that will expire in the refrigerator for a long period of time.

For product support, warranty, and maintenance related questions, please contact StoreBound directly at: 1-800-898-6970 from 7AM - 7PM PST, Monday - Friday, or by email at support@storebound.com.

REPAIRS: DANGER! Risk of electric shock! The Sobro is an electrical appliance. Do not attempt to repair the appliance yourself under any circumstances. Contact Customer Support regarding repairs to the device.

ISSUE	SOLUTION
If the Sobro is placed unsteadily.	Adjust the placement of the Sobro by adjusting the four legs under the table. Rotate the legs to adjust.
The Sobro table is not chilling ingredients or beverages in the refrigerator.	The refrigerator may be too full. Remove some of the beverages or food in the refrigerator. Ensure the drawer is closed properly. Adjust the temperature to its lowest setting. Ensure the back of the table is properly vented. If the table is still not chilling, call customer service.
The refrigerator temperature is high.	Ensure that the refrigerator drawer is always closed tightly. Do not place hot food in the refrigerator. Do not overfill the refrigerator. Make sure the Sobro table is properly ventilated.
Odor from refrigerator.	Unit should be cleaned before using for the first time. This will clear any odors that may have been trapped during shipment. Clean unit and refrigerator drawer thoroughly. Any uncovered foods will create a odor. Remove and clean drawer.
The unit does not turn on.	Assure that the power cord is attached properly. Check to make sure the outlet the table is plugged into has power
There is a burning odor during operation.	This may occur when you first turn on the unit as the motor cycles through. If it continues, unplug the unit and call customer service.



# So much more than furniture...

We've thought about every detail of the Sobro Coffee Table to make it into the ultimate convenience. Play music and change the song from your phone or via touch controls on the top of the table.

LED lights set the mood or start the party. And you can connect your Smart TV and run the audio through the speakers in the table.

With the Sobro coffee table, you may never have to leave the couch again.



# WARRANTY

## SOBRO RESIDENTIAL LIMITED WARRANTY

### FOR RESIDENTIAL INDOOR USE ONLY

#### FULL ONE YEAR WARRANTY\*

For one year from the date of original delivery, this Sobro (a division of StoreBound, LLC) product warranty covers all parts and labor to repair or replace, under normal residential use, any part of the product that proves to be defective in material or workmanship. All service provided by StoreBound under the above warranty must be performed by a Sobro factory certified service, unless otherwise specified by StoreBound. Service will be provided during normal business hours.

#### FULL TWO YEAR SEALED SYSTEM WARRANTY\*

For two years from the date of original delivery, this Sobro product warranty covers all parts and labor to repair replace, under normal residential use, these parts that prove to be defective in materials or workmanship: compressor, condenser, evaporator, drier and all connecting tubing. All service provided by StoreBound under the above warranty must be performed by Sobro factory certified service, unless otherwise specified by StoreBound. Service will be provided during normal business hours.

#### TERMS APPLICABLE TO EACH WARRANTY

The warranty applies only to products installed for normal residential use. The warranty applies only to products installed in any one of the 50 states of the United States, the District of Columbia or the 10 provinces of Canada. This warranty does not cover any parts or labor to correct any defect caused by negligence, accident or improper use, maintenance, installation, service or repair.

THE REMEDIES DESCRIBED ABOVE FOR EACH WARRANTY ARE THE ONLY ONES THAT STOREBOUND, LLC WILL PROVIDE, EITHER UNDER THIS WARRANTY OR UNDER ANY WARRANTY ARISING BY OPERATION OF LAW. STOREBOUND, LLC WILL NOT BE RESPONSIBLE FOR ANY CONSEQUENTIAL OR INCIDENTAL DAMAGES ARISING FROM THE BREACH OF THIS WARRANTY OR ANY OTHER WARRANTY, WHETHER EXPRESS, IMPLIED OR STATUTORY.

Some states do not allow the exclusion or limitation of incidental or consequential damages, so the above limitation or exclusion may not apply to you. This warranty gives you specific legal rights and you may also have other legal rights that vary from state to state.

To receive parts and/or service and the name of Sobro factory certified service nearest you, contact Customer Support at 1-800-898-6970 or email us at support@storebound.com.

\*Any opening of the circuit board cabinet or refrigerator parts cabinet by customer or non-Sobro factory certified service provider will void all warranties for this product.

SOCTB300\_20170718\_V4

# FCC STATEMENT

## IMPORTANT NOTES FCC STATEMENT:

This device complies with part 15 of the FCC Rules. Operation is subject to following two conditions: (1)this device may not cause harmful interference, and (2)this device must accept any interference received, including interference that may cause undesired operation.

Changes or modifications not expressly approved by the party responsible for compliance could void the user's authority to operate the equipment.

NOTE: This equipment has been tested and found to comply with the limits for a Class B digital device, pursuant to Part 15 of the FCC Rules. These limits are designed to provide reasonable protection against harmful interference in a residential installation. This equipment generates, uses and can radiate radio frequency energy and, if not installed and used in accordance with the instructions, may cause harmful interference to radio communications. However, there is no guarantee that interference will not occur in a particular installation. If this equipment does cause harmful interference to radio or television reception, which can be determined by turning the equipment off and on, the user is encouraged to try to correct the interference by one or more of the following measures:

- Reorient or relocate the receiving antenna.
- Increase the separation between the equipment and receiver.
- Connect the equipment into an outlet on a circuit different from that to which the receiver is connected.
- Consult the dealer or an experienced radio/TV technician for help.

## INDUSTRY CANADA:

This device complies with Industry Canada license-exempt RSS standard(s). Operation is subject to the following two conditions: (1) this device may not cause interference, and (2) this device must accept any interference, including interference that may cause undesired operation of the device.

Le présent appareil est conforme aux CNR d'Industrie Canada applicables aux appareils radio exempts de licence. L'exploitation est autorisée aux deux conditions suivantes : (1) l'appareil ne doit pas produire de brouillage, et. (2) l'utilisateur de l'appareil doit accepter tout brouillage radioélectrique subi, même si le brouillage est susceptible d'en compromettre le fonctionnement.

# sobro

Coffee Table User Manual