

TOSHIBA

fire tv edition

32" / 43" 60 Hz LED TV

QUICK SETUP GUIDE

32LF221U21 | TF-32A710U21
43LF421U21

INCLUDED ACCESSORIES



FIND YOUR USER GUIDE ONLINE!
Go to www.toshiba.com and search for
32LF221U21, TF-32A710U21, or 43LF421U21

WHAT YOU NEED (not included)

- Phillips screwdriver
 - Internet connection (wired or wireless)*
- *Subscription or other payment may be required to access certain content.

1 START HERE

How do I attach the stands to my TV? (not for wall mounting)
You'll need: Soft surface and a Phillips screwdriver.
Carefully place your TV face-down on a cushioned, clean surface.
Secure each TV stand to the bottom of your TV with two of the provided screws.
The stands are labeled R (right) and L (left).

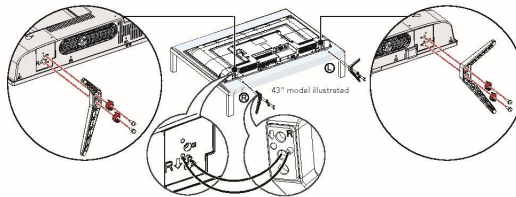

WALL MOUNT

How do I prepare my TV for wall mounting? (not for use with a TV stand)
You'll need: Soft surface and a Phillips screwdriver.
Before you mount your TV, make sure that:
• You remove the stands.
• The bracket supports the weight of your TV.
Carefully place your TV face-down on a cushioned, clean surface.
See the instructions that came with your wall mount for more information about how to correctly mount your TV.

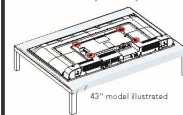

VESA Mounting Pattern
32" 100 × 100 – M4 × 12 mm type screws (8 pcs)
43" 400 × 200 – M6 × 35 mm type screws (8 pcs)
Note: Wall-mount screws are not included.

Your TV has four VESA mounting holes on the back. If you attach a wall-mount bracket to the back of your TV, the bracket must be securely attached using all four holes. If you do not use all four mounting holes, your TV may fall and cause property damage or personal injury. See the documentation that came with your wall mount for complete mounting instructions.

FEATURES

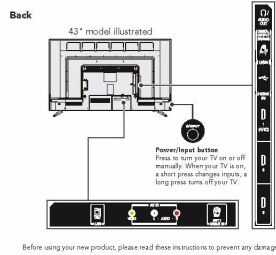
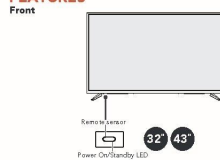

2 MAKING CONNECTIONS

How do I watch TV (cable, satellite, or antenna) or connect a device such as a DVD or Blu-ray disc player or game console?
How do I connect to the internet?

HDMI® (BEST)
Best video quality

Note: Connect an ARC-enabled home theater receiver to the HDMI IN 1 (ARC) port.



AV (GOOD)

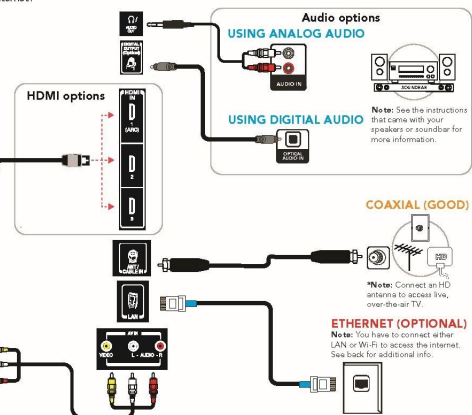

Note: See the instructions that came with your speakers or soundbar for more information.

*Note: Connect an HD antenna to access live, over-the-air TV.

Note: You have to connect either LAN or Wi-Fi to access the internet. See back for additional info.

Before using your new product, please read these instructions to prevent any damage.