



15"/19"/22"/24" LED-LCD TV

# QUICK SETUP GUIDE

NS-15E720A12/NS-19E720A12

NS-22E730A12/NS-24E730A12

**Thank You**  
for purchasing this fine Insignia television. We hope you enjoy the quality and reliability of this product for years to come.

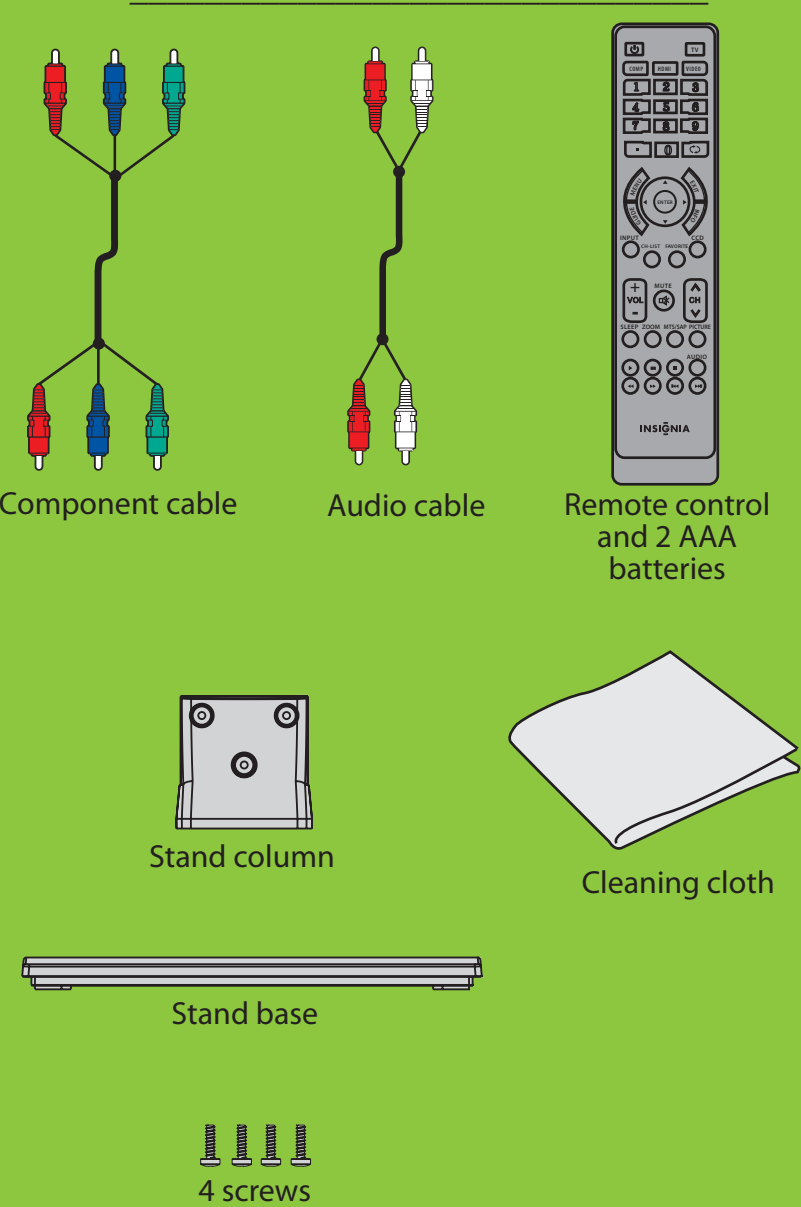

## Front features

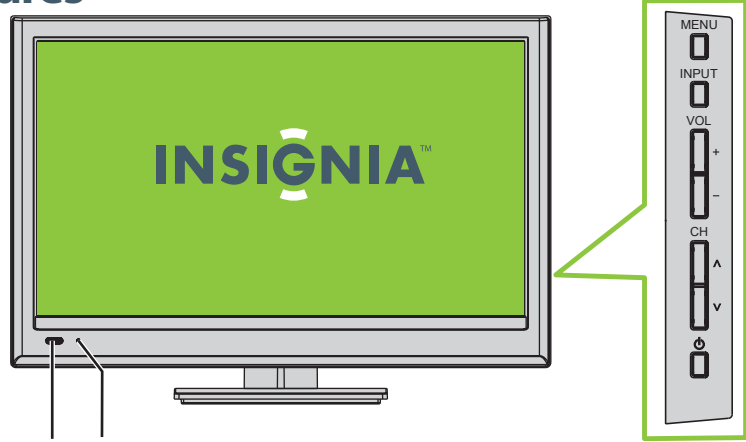

Remote control sensor  
Power indicator

## Installing the stand

- 1 Carefully place your TV screen face-down on a cushioned, clean surface to protect the screen from damages and scratches.
- 2 Attach the stand column to the back of the TV, and then secure the stand column to the TV with the three provided screws.
- 3 Align the stand base to the stand column, then secure the stand base to the stand column with the provided screw.

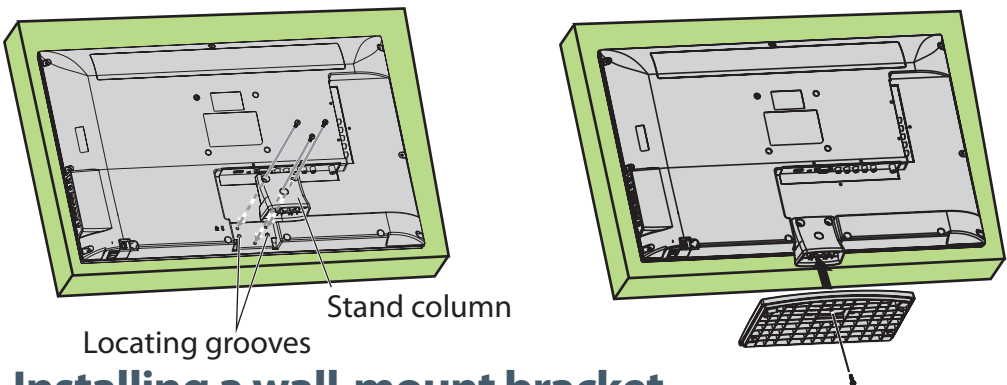

## Installing a wall-mount bracket

If you are mounting the 15" or 19" and plan on using the back inputs, a low profile wall mount may not work with your TV.

- 1 Carefully place your TV screen face-down on a cushioned, clean surface to protect the screen from damages and scratches.
- 2 Remove the three screws holding the TV to its stand column.
- 3 Remove the stand column.
- 4 Attach the wall-mount bracket to your TV using the mounting holes on the back of your TV. See the instructions that came with the wall-mount bracket for information about how to correctly hang your TV.

### Warning

This apparatus is intended to be supported by a UL Listed wall mount bracket.

## Identifying cables

Your TV has several connection types for connecting devices. For the best video quality, connect a device to the best available connection.

Connection type	Video quality	Cable connector
HDMI video/audio	Best	
OR		
Component video and analog audio	Better	
OR		
Composite video and analog audio	Good	

You can use an HDMI jack to connect a DVI device to your TV. You need to attach an HDMI-to-DVI adapter to the end of the HDMI cable that connects to the DVI device's jack.

## Connecting a DVD or Blu-ray DVD player, cable box, satellite receiver, or game station

Using an HDMI cable (best)

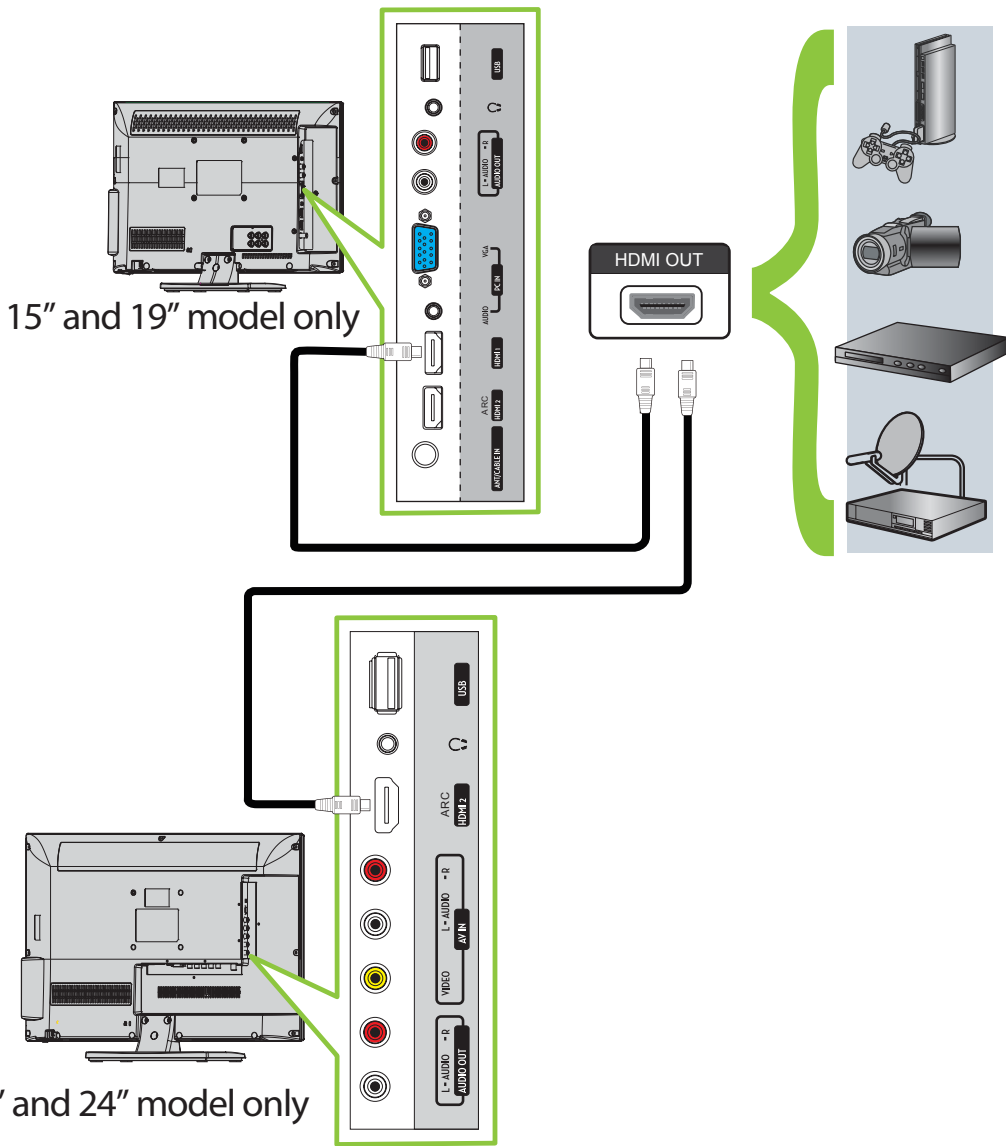

Using component cables (better)

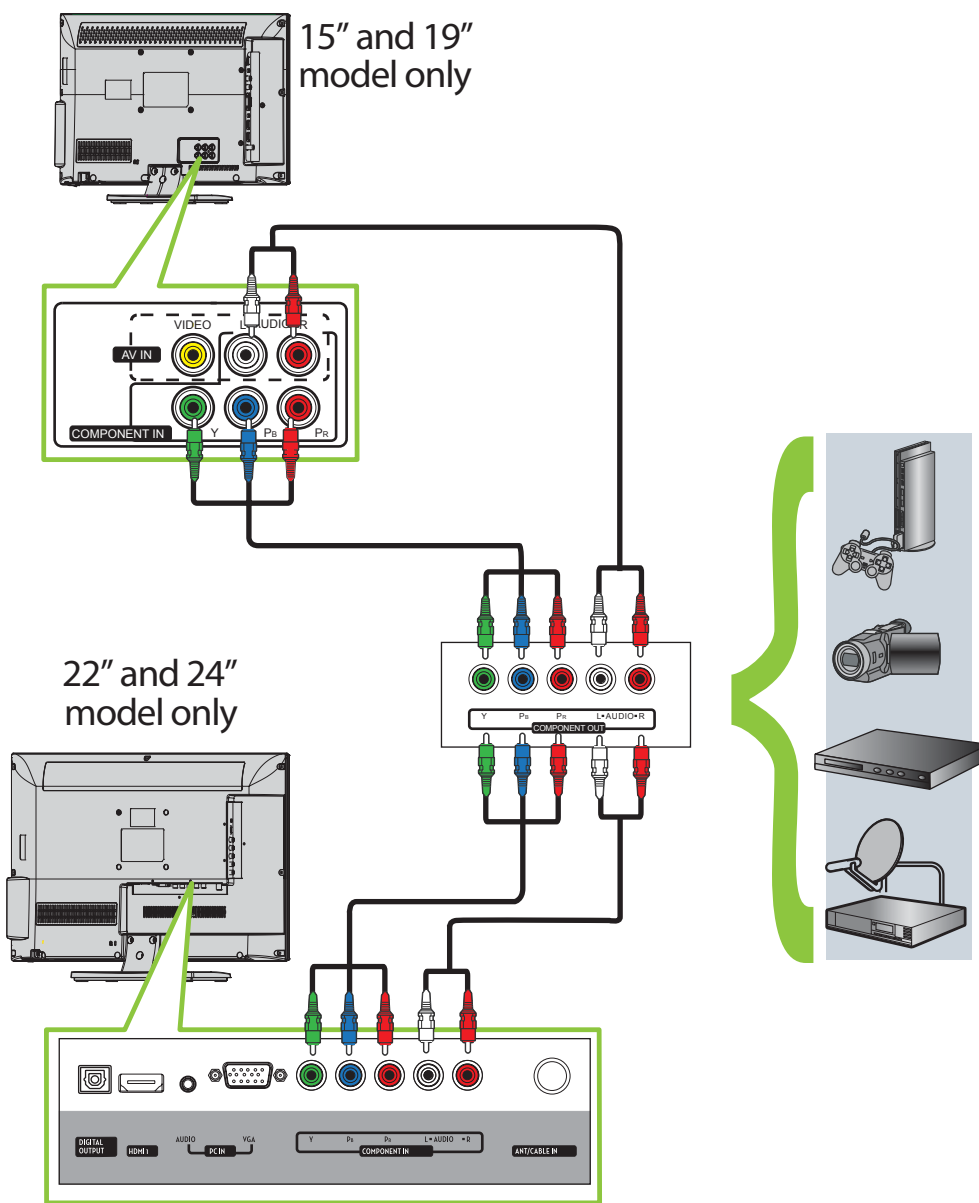

Using composite cables (good)

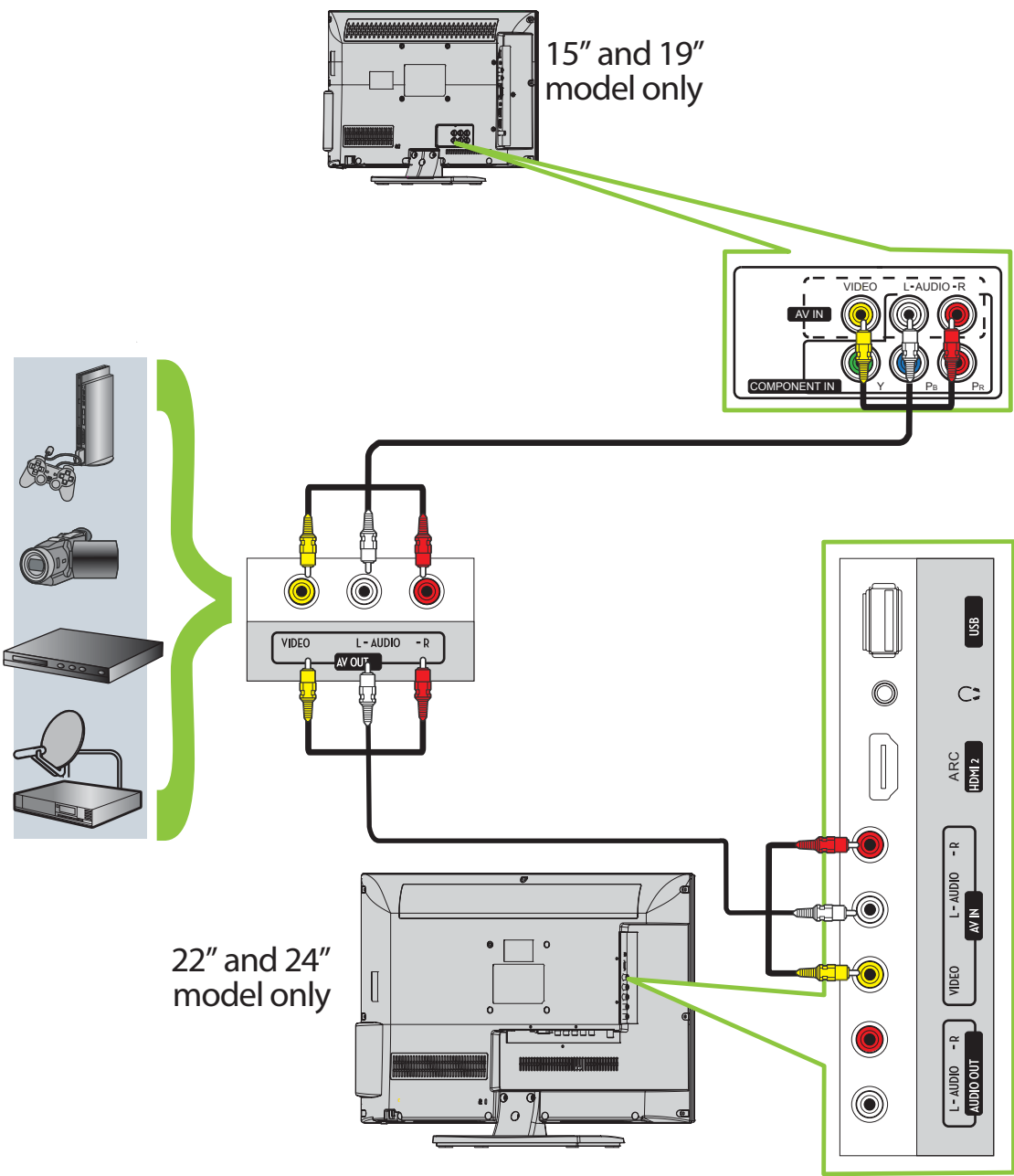

## Connecting an antenna/cable wall jack

Connect a coaxial cable (not included) to the **ANT/CABLE IN** jack on the back of your TV and to the Antenna/Cable wall jack.

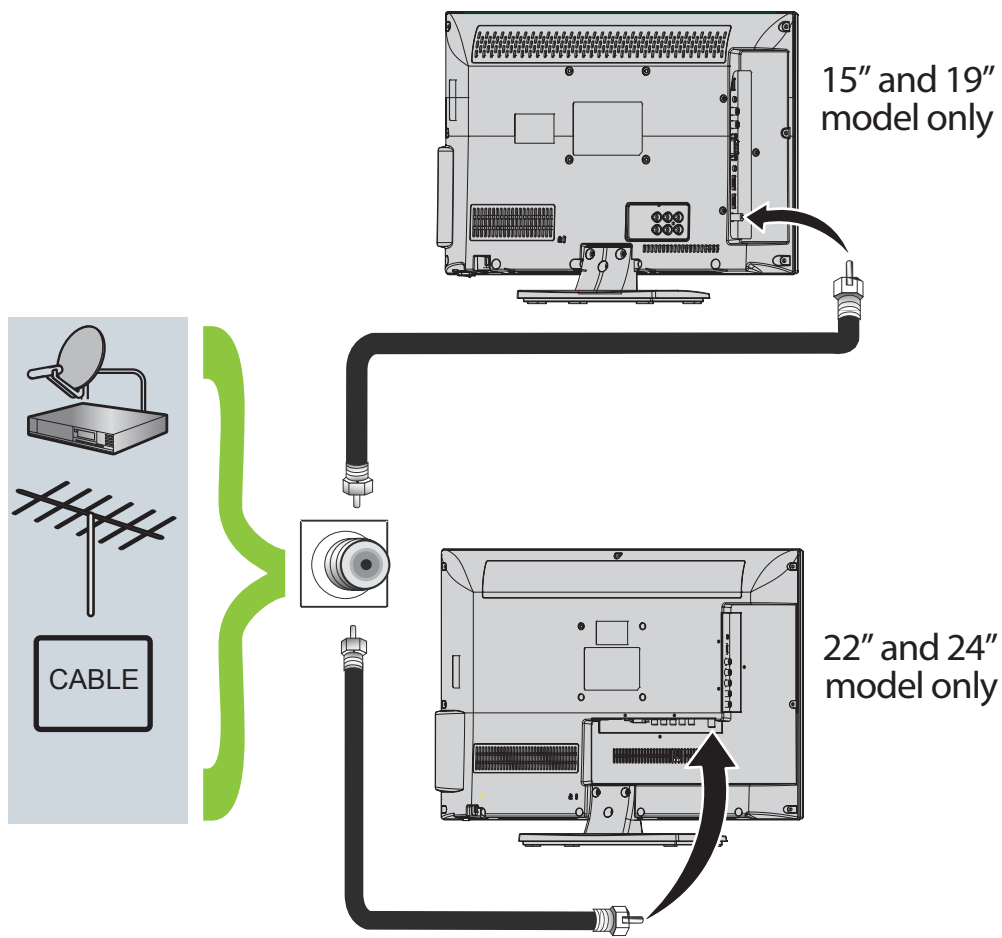



## Connecting a Home Theater System

Using Digital audio

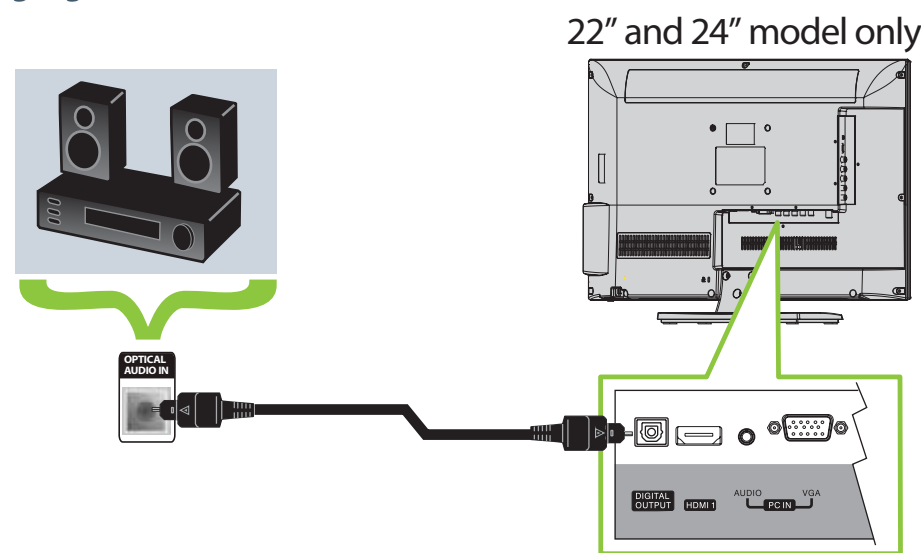

Using Analog audio

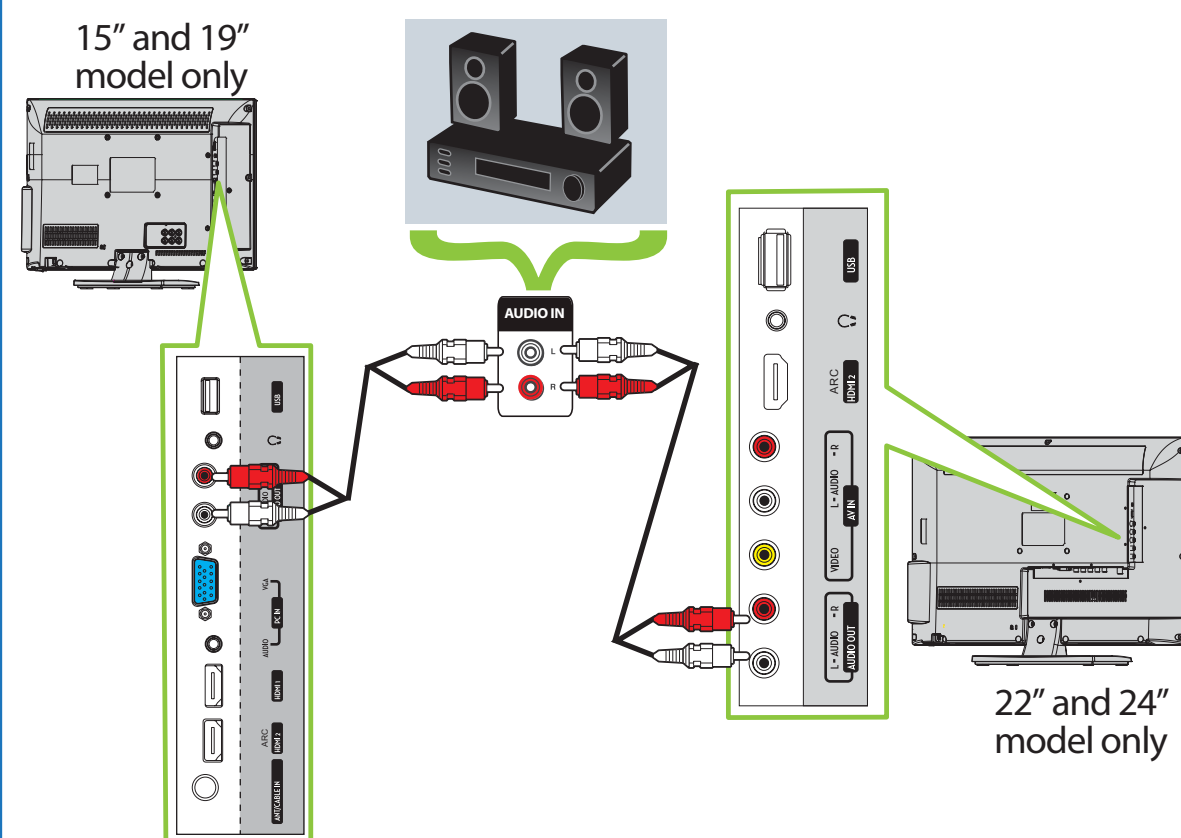

## Connecting a home theater system with multiple devices

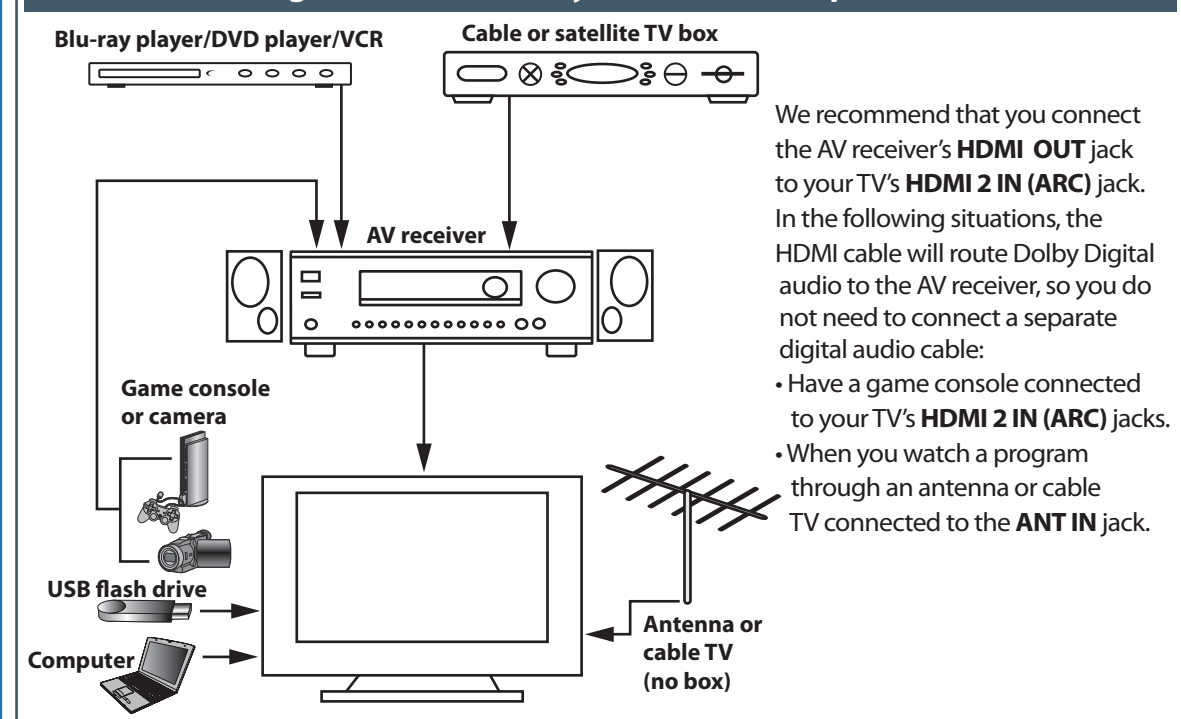

## Connecting power

Plug the AC power cord into the AC power outlet.

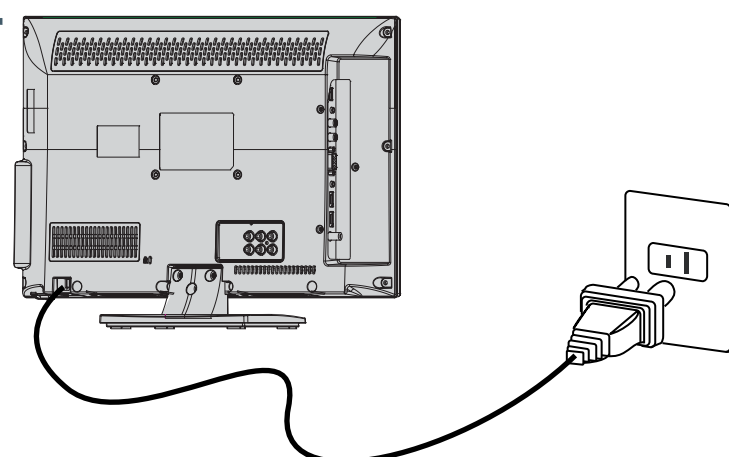

## Setting up and using your remote control

1 Press the release button on the back of the remote to remove the battery compartment cover.

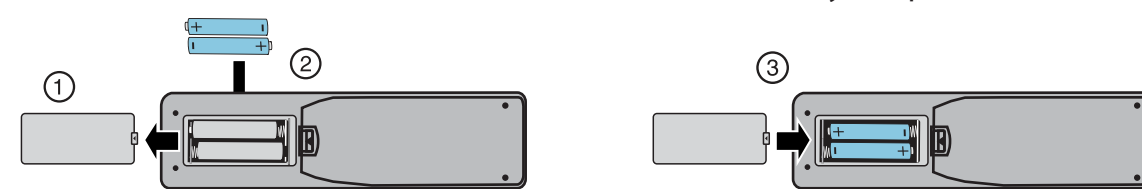

2 Insert two AAA batteries into the battery compartment. Make sure that the + and - symbols on the batteries match with the + and - symbols in the battery compartment.  
3 Replace the cover.

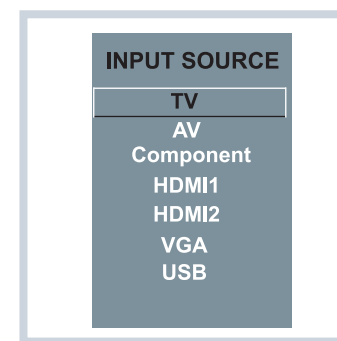
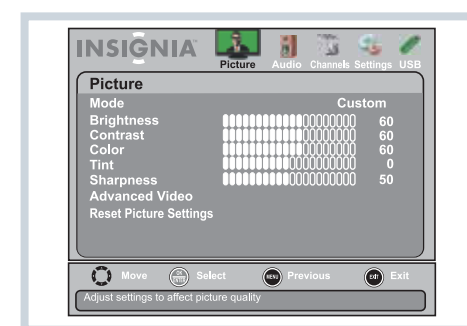

### Aspect ratio options



**Normal:**  
Displays the original 4:3 aspect ratio with black bars vertical on the left and right hand side of the screen. If the image's original aspect ratio is 16:9, it will be displayed in 16:9.



**Zoom:**  
Expands the image to fill the screen. The top and bottom of the image may be cropped.



**Wide:**  
Use this option to view content recorded in a 16:9 (wide-screen) aspect ratio.



**Cinema:**  
Stretches the image at the edges, but keeps a clear image in the center.



**Auto:**  
Automatically adjusts the image based on the screen size and the TV program. **Note:** Auto is only available when Auto Zoom in the CHANNELS menu is set to On.

## Programming your remote control

To program your universal remote control to work with your new Insignia TV, see the table for common codes. If you have problems programming your remote or need a different remote control code, visit [www.insigniaproducts.com](http://www.insigniaproducts.com) for the latest remote control code information.

Universal remote control TV codes (for all Insignia TVs manufactured after Jan. 1, 2007)											
Universal remote control makers and models				Cable/Satellite/Set-top box							
Philips	RCA	One for All	Sony	Comcast	DirectTV	Dish Network	Time Warner	Cox	Charter	Verizon	Cablevision
0198, 0490	135	0054	068, 069, 078, 096, 100, 164, 168, 229, 026	10171, 11204, 11326, 11517, 11641, 11780, 11892, 11963, 12002	10171, 11204, 11326, 11517, 11641, 11780, 11564, 11641, 11963, 12002	720	450, 461, 456	1326	2002, 1204, 1423, 1517, 0171, 1963, 0463, 0842, 1326, 167, 415, 424, 450, 456, 461, 507, 523, 567, 577, 586	0198, 0490	068, 069, 078, 096, 100, 164, 168, 229, 026
											Tivo
											0091

## Turning on your TV for the first time

- Connect the power cord to a power outlet, then press **Power**. The power indicator turns on and the *Choose your menu language* screen opens.
- Press **▲** or **▼** to highlight a language, then press **ENTER**. The *Choose your Time Setting* screen opens with Mode highlighted.
- Press **◀** or **▶** to select **Auto** or **Manual**. If you select **Auto**, the date and time are set automatically from a digital TV signal. If you select **Manual**, you can manually set the date and time. Press **ENTER**. The *Choose your Picture Mode* screen opens.
- Press **▲** or **▼** to highlight **Home** mode or **Retail** mode, then press **ENTER**. If you select **Retail** mode, a message asks you to confirm your selection. Select **Yes** or **No**. **Retail** mode is not an energy-saving mode. The *Choose your TV source* screen opens.
- Press **▲** or **▼** to highlight **Antenna**, **Cable**, or **Cable/Satellite box**. If you select **Antenna** or **Cable**, your TV scans for available channels. The scan may take several minutes. **If you select Cable/Satellite box, your TV does not scan for channels.**
- To watch TV, press **TV** on the remote control.

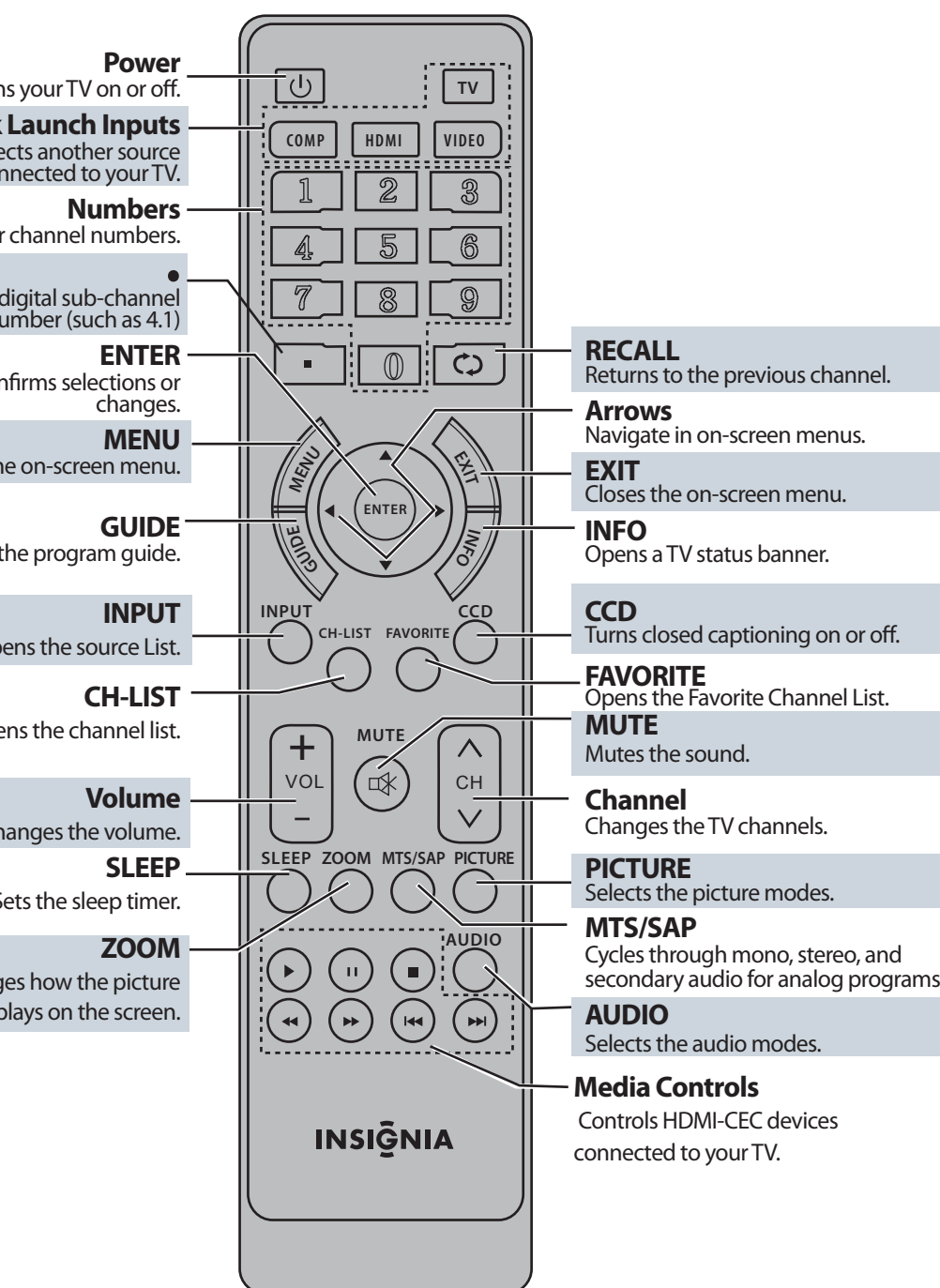

INSIGNIA™

Two-year limited warranty

Visit [www.insigniaproducts.com](http://www.insigniaproducts.com) for details.

## Need additional help?

See your **Online User Guide**! This comprehensive guide includes everything from basic how-to steps to more advanced features. A copy of your *User Guide* is not provided in the box but is available online. Go to [www.insigniaproducts.com](http://www.insigniaproducts.com), click **Support & Service**, enter your model number in the *Product Search* field, then click **Search**.

Check out our online **community forum** at [www.insigniaproducts.com](http://www.insigniaproducts.com) for helpful information from other Insignia TV owners.

**We're here for you**

[www.insigniaproducts.com](http://www.insigniaproducts.com)

For customer service, call:

**877-467-4289 (U.S./Canada markets)**

Distributed by Best Buy Purchasing, LLC  
7601 Penn Avenue South, Richfield, MN USA 55423-3645

© 2011 BBY Solutions, Inc.

All rights reserved. INSIGNIA is a trademark of BBY Solutions, Inc. Registered in some countries. All other products and brand names are trademarks of their respective owners.

## WE ARE GOING GREEN!

A copy of your *User Guide* is not provided in the box but is available online. Go to [www.insigniaproducts.com](http://www.insigniaproducts.com), click **Support & Service**, enter your model number in the *Product Search* field, then click **Search**.



Occasionally, Insignia posts firmware updates to improve your product. To download firmware updates, go to [www.insigniaproducts.com](http://www.insigniaproducts.com).