



Power chargers CLS 124_23-0813_QSG_V6_EN.ai 1 11/21/2023 4:31:12 PM

Final flat size: 16.54 x 5.5 in (420 x 140 mm)
Final fold size: 2.8 x 2.8 in (70 x 70 mm)



QUICK SETUP GUIDE



Wall Charger

- 35W
 - NS-PW335C2B23 (dual ports)
- 45W
 - NS-PW345C1W22
- 65W
 - NS-PW365C1W22
- 70W
 - NS-PW370C2W24 (dual ports)
- 100W
 - NS-PW31XC2W22 (dual ports)
 - NS-PW31XC2W22B (dual ports)
- 140W
 - NS-PW3X4C2W22B (dual ports)



Before using your new product, please read these instructions to prevent any damage.

FEATURES

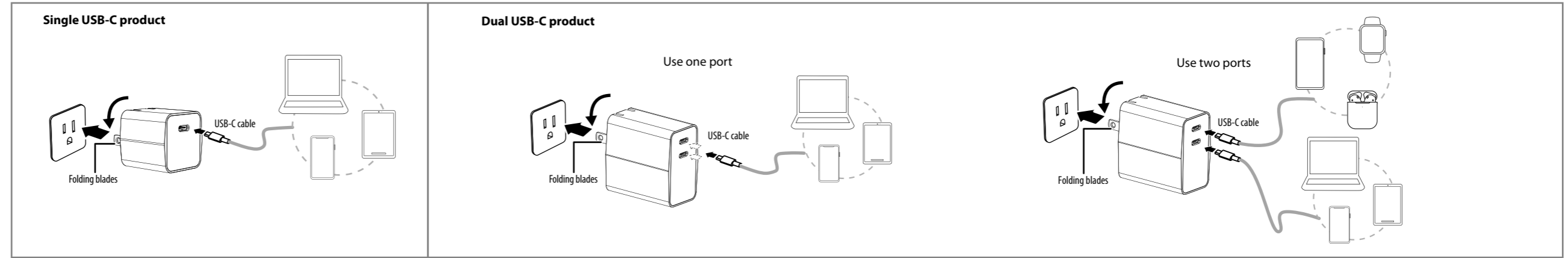

SPECIFICATIONS

	FOR MACBOOK AIR AND MOBILE DEVICES	FOR CHROMEBOOK	FOR LAPTOPS AND MACBOOK PRO 13"		FOR MACBOOK PRO 14" & 15"		FOR MACBOOK PRO 16"	
MODEL#	NS-PW335C2B23	NS-PW345C1W22	NS-PW365C1W22	NS-PW370C2W24	NS-PW31XC2W22	NS-PW31XC2W22B	NS-PW3X4C2W22B	
POWER	35W Dual Ports	45W	65W	70W	100W Dual Ports	100W Dual Ports with Cable	140W Dual Ports with Cable	
WORKS BEST WITH	<p>TWO DEVICES SIMULTANEOUSLY: MacBook Air + Apple Watch / AirPods iPad + Apple Watch / AirPods iPhone + Apple Watch / AirPods</p> <p>OR ONE DEVICE: MacBook Air (M2, 2022) iPad Pro 11-inch Apple Watch MacBook Air (M1, 2020) (3rd & 4th generation) AirPods MacBook Air (13-inch, 2020) iPad Air (4th & 5th generation) MacBook Air (13-inch, 2018-2019) iPad mini (6th generation) MacBook (12-inch) iPad (9th & 10th generation) iPad Pro 12.9-inch (5th & 6th generation) iPhone SERIES</p>	<p>Chromebook MacBook Air Surface Pro Galaxy Tab S SERIES iPad SERIES Smartphone: Galaxy S SERIES Galaxy NOTE SERIES Galaxy Z SERIES iPhone SERIES</p> <p>Others: Apple Watch AirPods</p>	<p>ONE DEVICE: HP Spectre HP EliteBook Dell XPS Dell Inspiron Dell Latitude Lenovo ThinkPad Lenovo YOGA Lenovo IdeaPad</p>	<p>MacBook Pro (14-inch, 2023) MacBook Pro (14-inch, 2021) MacBook Pro (13-inch, M2, 2022) MacBook Pro (13-inch, M1, 2021) MacBook Pro (13-inch, 2020) MacBook Pro (13-inch, 2016-2019) MacBook Air (M2, 2022) MacBook Air (M1, 2020) MacBook Air (13-inch, 2020) MacBook Air (13-inch, 2018-2019)</p>	<p>ONE DEVICE: MacBook Pro (16-inch, 2023) MacBook Pro (14-inch, 2023) MacBook Pro (13-inch, M2, 2022) MacBook Air (15-inch, M2, 2022) HP Spectre / EliteBook Dell XPS / Inspiron / Latitude Lenovo Thinkpad /IdeaPad /YOGA</p> <p>OR FOR TWO DEVICES SIMULTANEOUSLY: MacBook Air + iPad Pro / iPhone Laptop + Tablet / Smartphone Chromebook + Tablet / Smartphone</p>	<p>ONE DEVICE: MacBook Pro (14-inch, 2023) MacBook Pro (14-inch, 2021) MacBook Pro (16-inch, 2019) MacBook Pro (15-inch, 2016-2019)</p> <p>OR FOR TWO DEVICES SIMULTANEOUSLY: MacBook Pro + iPad Pro / iPhone Laptop + Tablet / Smartphone Chromebook + Tablet / Smartphone</p>	<p>ONE DEVICE: MacBook Pro (14-inch, 2023) MacBook Pro (14-inch, 2021) MacBook Pro (16-inch, 2019) MacBook Pro (15-inch, 2016-2019)</p> <p>OR FOR TWO DEVICES SIMULTANEOUSLY: MacBook Pro + iPad Pro / iPhone 15 series Laptop + Tablet / Smartphone Chromebook + Tablet / Smartphone</p>	<p>ONE DEVICE: MacBook Pro (16-inch, 2023) MacBook Pro (16-inch, 2021)</p> <p>OR FOR TWO DEVICES SIMULTANEOUSLY: MacBook Pro + iPad Pro / iPhone 15 series Laptop + Tablet / Smartphone</p>
COMPATIBILITY DEVICES								
PACKAGE CONTENTS	<ul style="list-style-type: none"> • Wall Charger • Quick Setup Guide 	<ul style="list-style-type: none"> • Wall Charger • Quick Setup Guide 	<ul style="list-style-type: none"> • Wall Charger • Quick Setup Guide 	<ul style="list-style-type: none"> • Wall Charger • Quick Setup Guide 	<ul style="list-style-type: none"> • Wall Charger • Quick Setup Guide 	<ul style="list-style-type: none"> • Wall Charger • 8 ft. 100W Certified USB-C to USB-C Cable • Quick Setup Guide 	<ul style="list-style-type: none"> • Wall Charger • 8 ft. 240W Certified USB-C to USB-C Cable • Quick Setup Guide 	

	FOR MACBOOK AIR AND MOBILE DEVICES	FOR CHROMEBOOK	FOR LAPTOPS AND MACBOOK PRO 13"		FOR MACBOOK PRO 14" & 15"	FOR MACBOOK PRO 16"
MODEL#	NS-PW335C2BZ3	NS-PW345C1W22	NS-PW365C1W22	NS-PW370C2W24	NS-PW31XC2W22 / NS-PW31XC2W22B	NS-PW3X4C2W22B
INPUT	100-240V ~ 50/60Hz	100-240V ~ 50/60Hz	100-240V ~ 50/60Hz	100-240V ~ 50/60Hz 1.7A	100-240V ~ 50/60Hz	100-240V ~ 50/60Hz
OUTPUT	5V==3A, 9V==3A, 15V==2.33A, 20V==1.75A	5V==3A, 9V==3A, 15V==3A, 20V==2.25A (PPS) 3.3-16V/3A, 45W Max	5V==3A, 9V==3A, 15V==3A, 20V==3.25A (PPS) 3.3-21V/3.25A, 65W Max	Use One Port: 70W 5V==3A, 9V==3A, 15V==3A, 20V==3.5A (PPS) 3.3-21V/3.5A, 70W Max Use Two Ports: 20W + 45W USB-C1: 5V==3A, 9V==2.22A, (PPS) 3.3-11V/2.2A, 20W Max USB-C2: 5V==3A, 9V==3A, 15V==3A, 20V==2.25A (PPS) 3.3-16V/3A, 45W Max	Use One Port: 100W 5V==3A, 9V==3A, 15V==3A, 20V==5A (PPS) 3.3-21V/5A, 100W Max Use Two Ports: 30W + 65W USB-C1: 5V==3A, 9V==3A, 15V==2A, 20V==1.5A (PPS) 3.3-11V/3A, 30W Max USB-C2: 5V==3A, 9V==3A, 15V==3A, 20V==3.25A (PPS) 3.3-21V/3.25A, 65W Max	Use One Port: 140W 5V==3A, 9V==3A, 15V==3A, 20V==5A, 28V==5V Use Two Ports: 45W + 100W USB-C1: 5V==3A, 9V==3A, 15V==3A, 20V==2.25A (PPS) 3.3-16V/3A, 45W Max USB-C2: 5V==3A, 9V==3A, 15V==3A, 20V==5A (PPS) 3.3-21V/5A, 100W Max
DIMENSION (H x W x D)	1.3 x 1.6 x 1.6 in. (32 x 40 x 40 mm)	1.6 x 1.5 x 1.5 in. (41.5 x 38 x 38 mm)	1.9 x 1.7 x 1.7 in. (47 x 42 x 42 mm)	2.1 x 1.2 x 2.1 in. (54 x 32 x 54 mm)	2.7 x 1.3 x 2.3 in. (68 x 32 x 58 mm)	2.8 x 1.3 x 3.3 in. (70 x 33 x 83 mm)
WEIGHT (CHARGER ONLY, Approx.)	0.13 lbs. (60 g)	0.15 lbs. (70 g)	0.20 lbs. (90 g)	0.28 lbs. (130.8 g)	0.33 lbs. (150 g)	0.44 lbs. (200 g)

TROUBLESHOOTING

My device isn't charging.

- Make sure that the charger is connected securely to the wall plug.
- Make sure that your device is securely connected to the charger.

My device is charging slowly.

- Make sure that the power requirements of your device match the power delivery of the charger.
- Stop using your device while it is charging.
- Close apps that run in the background on your device.

- Devices may start charging slower as they get older. This is normal.

SAFETY INFORMATION/CAUTION

READ ALL INSTRUCTIONS BEFORE USING.

- THIS PRODUCT IS NOT A VOLTAGE CONVERTER. Use this adapter only if the power outlet voltage is within the range of your device's voltage. Using this adapter with an incompatible device and power outlet may result in a risk of fire, electric shock, injury to persons, or damage to the device.
- Always disconnect the adapter and the device from the power outlet when not in use.
- Do not expose the adapter to high temperatures or humid environments.

- Do not place the product into a fire or submerge it in liquid.
- Do not disassemble the product.
- Avoid external shocks.
- The product will heat slightly when charging and discharging. This is normal.
- Do not operate the adapter with wet hands.
- Keep out of reach of children.
- Indoor use only
- Protection class II appliance.

LEGAL NOTICES

1. FCC Caution:

Changes or modifications not expressly approved by the part responsible for compliance could void the user's authority to operate the equipment.

FCC Statement: This equipment has been tested and found to comply with the limits for a class B digital device, pursuant to part 15 of the FCC Rules. These limits are designed to provide reasonable protection against harmful interference in a residential installation. This equipment generates, uses and can radiate radio frequency energy and, if not installed and used in accordance with the instructions, may cause harmful interference to radio communications. However, there is no guarantee that interference will not occur in a particular installation. If this equipment does cause harmful interference to radio or television reception, which can be determined by turning the equipment off and on, the user is encouraged to try to correct the interference by one or more of the following measures:

- Reorient or relocate the receiving antenna.
 - Increase the separation between the equipment and receiver.
 - Connect the equipment into an outlet on a circuit different from that to which the receiver is connected.
 - Consult the dealer or an experienced radio/TV technician for help.
- This device complies with part 15 of the FCC Rules. Operation is subject to the following two conditions: (1) This device may not cause harmful interference, and (2) this device must accept any interference received, including interference that may cause undesired operation.
- 2. CAN ICES-003 B/NMB-003 B**

ONE-YEAR LIMITED WARRANTY

Visit www.insigniaproducts.com for details.

CONTACT INSIGNIA:

For customer service, call 1-877-467-4289 (U.S. and Canada) www.insigniaproducts.com

INSIGNIA is a trademark of Best Buy and its affiliated companies
Distributed by Best Buy Purchasing, LLC
7601 Penn Ave South, Richfield, MN 55423 U.S.A.
©2023 Best Buy. All rights reserved.