

Linkind

User Manual

Linkind Smart Solar Pool Light S05

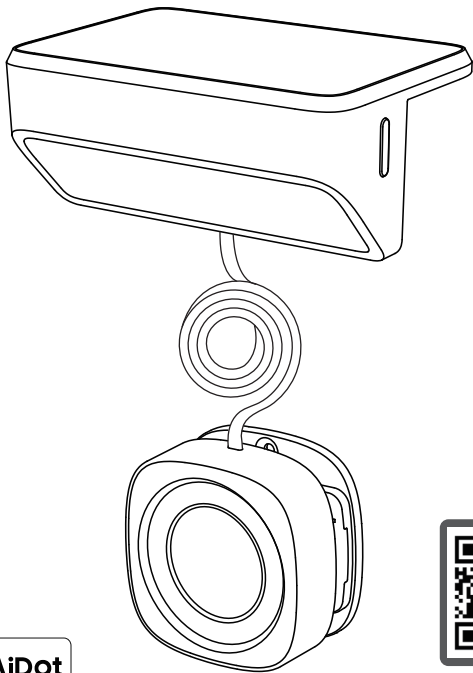

Works with  AiDot



Scan To Get Support

CONTENT English

Download AiDot App	01
Compatible Pool Types	01
What's in the Box	02
Installation for In-ground Pools	03
Installation for Above-ground Frame Pools	05
Button Operation	09
Connecting to the AiDot App	09
Troubleshooting	10
Tips	11

Download AiDot App

You can search for "AiDot" in the App Store or Google Play, or scan the QR code below to download the app.

Before installation, make sure your SO5 device has been added to the AiDot App.

During pairing, keep your phone within 15ft. (4.6 m) of the device to ensure a stable signal.



AiDot App

Google, Google Home and Google Play are trademarks of Google LLC.

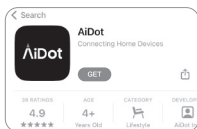

Download Interface

Compatible Pool Types

• In-ground Pools

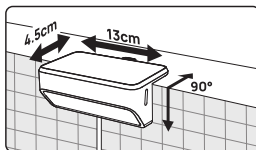
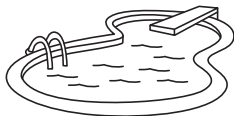

Straight right-angle edge

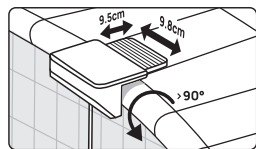

Large rounded edge

• Above-ground Frame Pools

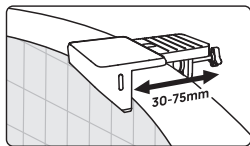
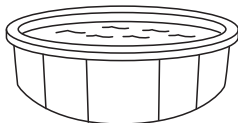

What's in the Box

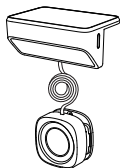

A. Pool Light



B. Short Mounting Plate



C. Long Mounting Plate



D. Frame Mounting Clamp



E. Underwater Glue



F. VHB Tape



G. Screw Accessory Pack



H. User Manual

Item	Description	Qty
A. Pool Light	Independent upper-water and underwater dual-zone lighting	2
B. Short Mounting Plate	For right-angle in-ground pool edges	2
C. Long Mounting Plate	For large rounded in-ground pool edges	2
D. Frame Mounting Clamp	For above-ground frame pool installation	2
E. Underwater Glue	Can be used underwater; must cure for 24 hours before use	6
F. VHB Tape	For attaching mounting plates; only for smooth, dry surfaces	6
G. Screw Accessory Pack	Spare accessory for wall installation	1
H. User Manual	/	1

▲*Note:

• Quantities listed above apply to the 2-pack version. Please check your purchase specification.

• Before using adhesives, always check your pool surface material.

Underwater glue works on most surfaces.

VHB tape only works on smooth, dry surfaces. It will not adhere well to wet or rough surfaces.

• If your pool edge is irregular (e.g., curved or non-standard), test the fit of the mounting plate before installation.

• Please use the underwater glue immediately after opening. It will start to cure and dry out if left exposed for too long.

Installation for In-ground Pools

Applicable Scenarios:

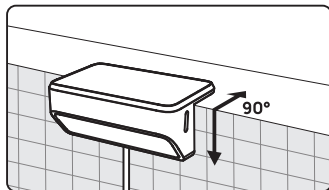

Right-angle edge

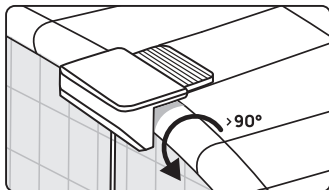

Large rounded edge

Required Accessories:



Magnetic base



Or



Short or long mounting plate



Or



VHB tape or
underwater glue

Installation Steps:

- 1 Clean the Surface

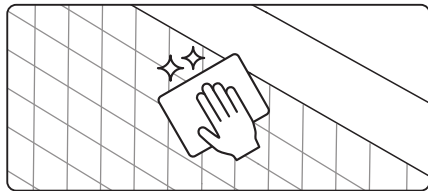

② Apply Underwater Glue or VHB Tape

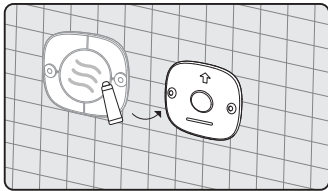
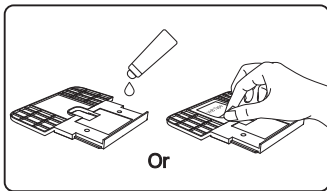

③ Install the Bracket and Magnetic Plate

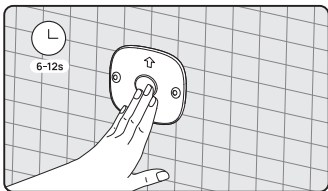
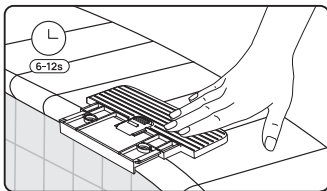

④ Install the Light after the Adhesive Cures for 24 Hours

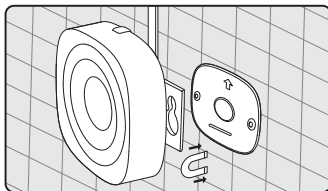
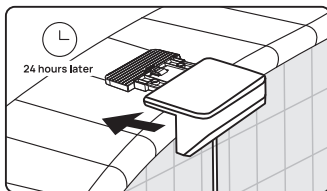

Step 1: Use a soft cloth or mild cleaner to wipe the pool wall. Remove all dust, oil, wax, algae, etc., to avoid adhesive failure.

Step 2:

A. Underwater Glue

Apply evenly on the mounting plate's adhesive area. Use a moderate amount to avoid overflow.

B. VHB Tape

Only for mounting plates. Make sure the surface is completely dry before

sticking.

▲ **Reminder:**

If your pool water level frequently changes, choose underwater glue. VHB adhesion decreases in humid conditions.

Step 3: Press firmly when attaching. Avoid repositioning during installation – this will weaken the adhesive.

Step 4: Wait 24 hours before installing the lights. Installing too early may cause the mounting plate to loosen.

- **How to Remove the Light**

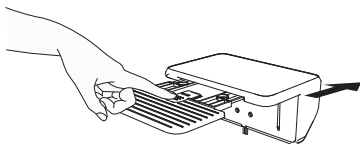

Press the latch on the base and pull the SO5 light out.

Installation for Above-ground Frame Pools

- **Applicable Scenarios**

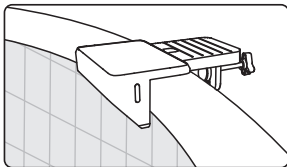

Required Accessories:



Magnetic base



Frame mounting clamp

Tool needed
(not included):



• Installation Steps

① Measure the Pool Frame Size

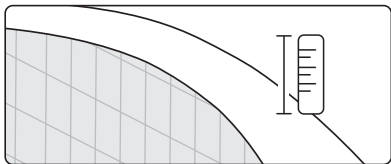

② Adjust the Mounting Clamp

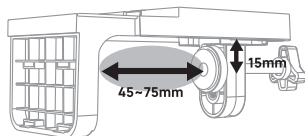
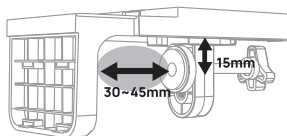
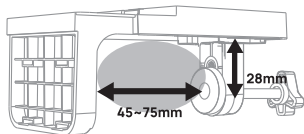
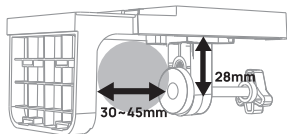

③ Attach the Clamp to the Frame

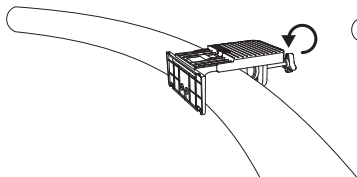

④ Install the Upper Water Light onto the Clamp

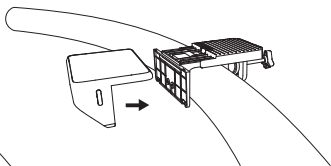

5 Install the Underwater Light

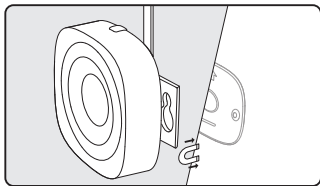

Step 1: Measure the pool frame size.

Step 2: Match the clamp size to the pool frame. If the fit is incorrect, the clamp may loosen.

▲ **Reminder:**

Pool liners can reduce friction between the clamp and frame, leading to slippage.

Step 3: Attach the clamp to the frame.

Step 4: Install the upper water light onto the clamp.

Step 5: Place the underwater light into the pool and adjust height. Position the magnetic base outside the pool to lock it in place.

Adjusting the Clamp Size

- Adjust clamp width

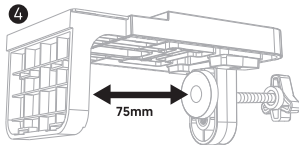
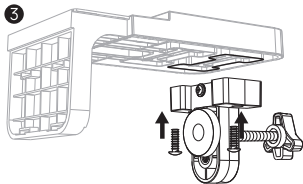
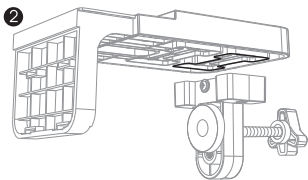
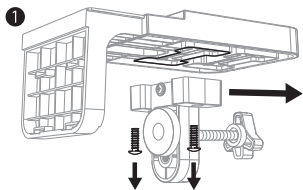

- Adjust clamp height

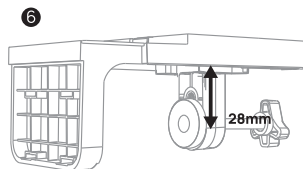
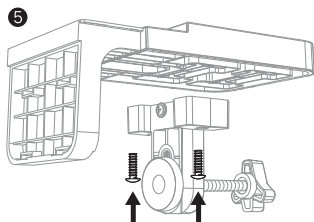
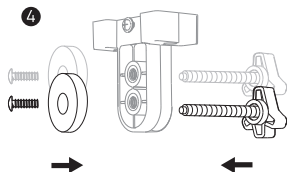
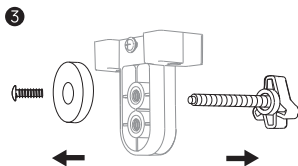
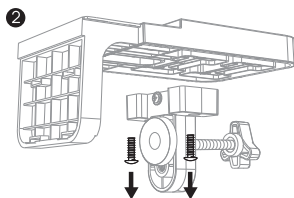
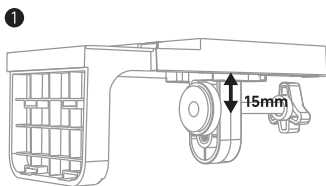

Button Operation

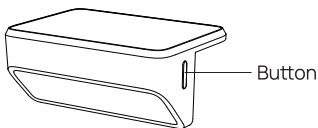

The SO5 is off by default. Press the button to turn it on and switch lighting modes.

***Note:** If using SO5 during daytime, cover the solar panel.

1. Switches lighting modes in sequence:

Red → Orange → Yellow → Green → Blue → Indigo → Purple → 2700K warm white → 6500K cool white → Off

2. Press and hold for 5 seconds to enter pairing mode.

The light will alternate between warm white and cool white to indicate successful pairing.

Connecting to the AiDot App

Steps to connect SO5 to the AiDot App:

1. Search "AiDot" on the App Store, Google Play, or simply scan the QR code.



AiDot App

Google, Google Home and Google Play are trademarks of Google LLC.

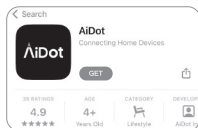

Download Interface

2. Open the AiDot App and sign in, or create a new account.

3. Make sure Bluetooth is enabled on your mobile device.

4. Press and hold the button on the light until it enters pairing mode. The light will cycle between warm white and cool white to indicate this.

5. Tap "Add Device" or the "+" button. You can also use the "Nearby" option, which will search for nearby AiDot products in pairing mode. The App may ask for Bluetooth permissions on your phone. Allow these to connect to SO5.

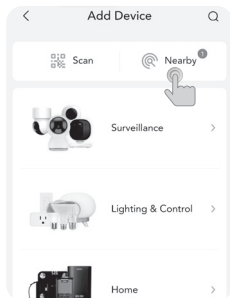
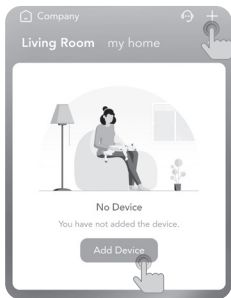

6. If you can't find your SO5 in the App, ensure it's in pairing mode as described in step 4. Then, try connecting again using the App.

***Note:** SO5 can be controlled from a distance of up to 98 ft. (30 m) when unobstructed.

Troubleshooting

Problem	Solution
SO5 won't turn on	a) Check ambient light — strong light may prevent activation. Cover the solar panel and test again. b) Ensure button clicks properly.
Multiple SO5 lights don't turn on at the same time	a) Light sensor sensitivity varies — allow up to 15 minutes for all lights to activate automatically.
VHB tape won't stick	a) Surface must be clean, dry, smooth. b) Let the tape cure for 1 hour before water contact.
Underwater glue detaches	a) Press firmly for 6–12 seconds during installation. b) Avoid movement for 24 hours. c) If it fails, remove old glue and reinstall.
Water scale or algae buildup on the light	a) Wipe regularly with a soft cloth. Avoid corrosive cleaners. b) In hard-water areas, inspect monthly.
Slow charging on cloudy days	a) Solar charging depends on sunlight intensity. b) Clean solar panel regularly and ensure no obstruction.

Battery drains quickly	<p>a) High temperatures accelerate battery aging. Avoid long-term exposure to extreme heat.</p> <p>b) Use energy-saving mode if unused for long periods.</p>
Incorrect color or tint	<p>a) Wait 2–3 seconds after mode change.</p> <p>b) Water quality or algae may affect color — clean lens regularly.</p> <p>c) Sync group settings in the app if colors differ.</p>
App group control not working	<p>a) Ensure all devices are paired and added to the same group.</p> <p>b) Update firmware.</p> <p>c) Check battery and connectivity for offline devices.</p>

Tips

1. During installation, make sure that the solar charging panel is not obstructed in any way to ensure smooth charging operations and maintain excellent battery life.
2. To ensure you a longer battery life, we recommend for installing the solar light in a place with direct sunlight and no shade to let the solar spotlight fully charge for 48 hours before the first use, which let you enjoy your colorful yard better.

▲ FCC WARNING

This device complies with part 15 of the FCC Rules. Operation is subject to the following two conditions: (1) this device may not cause harmful interference, and (2) this device must accept any interference received, including interference that may cause undesired operation.

Any changes or modifications not expressly approved by the party responsible for compliance could void the user's authority to operate the equipment.

Note: This equipment has been tested and found to comply with the limits for a Class B digital device, pursuant to Part 15 of the FCC Rules. These limits are designed to provide reasonable protection against harmful interference in a residential installation. This equipment generates, uses and can radiate radio frequency energy and, if not installed and used in accordance with the instructions, may cause harmful interference to radio communications.

However, there is no guarantee that interference will not occur in a particular installation. If this equipment does cause harmful interference to radio or television reception,

which can be determined by turning the equipment off and on, the user is encouraged to try to correct the interference by one or more of the following measures:

- Reorient or relocate the receiving antenna.
- Increase the separation between the equipment and receiver.
- Connect the equipment into an outlet on a circuit different from that to which the receiver is connected.
- Consult the dealer or an experienced radio/TV technician for help.

To maintain compliance with FCC's RF Exposure guidelines, This equipment should be installed and operated with minimum 20cm distance between the radiator and your body: Use only the supplied antenna.



The Bluetooth® word mark and logos are registered trademarks owned by Bluetooth SIG, Inc. and any use of such marks by Linkind is under license.

Other trademarks and trade names are those of their respective owners.

Linkind

Our goal is to bring you the best shopping experience . If you have any questions about our product, please feel free to contact us. Our customer service is right here to resolve the case.

IP68
RoHS

Recycle
Made in China



☎ 1 (877) 770-5727 Mon. Fri., 8:00 AM - 5:00 PM (PT)

✉ service@linkind.com

🌐 <http://www.linkind.com>

Why not share your stories to help other buyers?

📘 <https://www.facebook.com/linkind.lights>

📷 <https://www.instagram.com/linkindofficial>

▶ <https://www.youtube.com/@linkindofficial>

A Brand of
AiDot