

Quick start guide

- 1 Insert plug behind the charge base. Shorten the cord as needed by wrapping it behind the charge base.

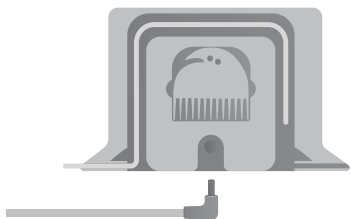

- 2 Select a clear area with good Wi-Fi coverage. Make sure the charge base is against the wall and plugged in.

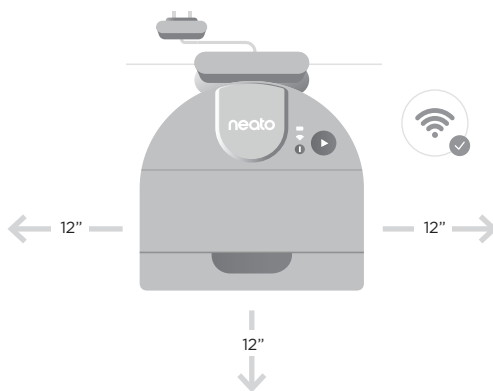

- 3 Place the robot against the charge base. When docked properly, the battery icon will light up.

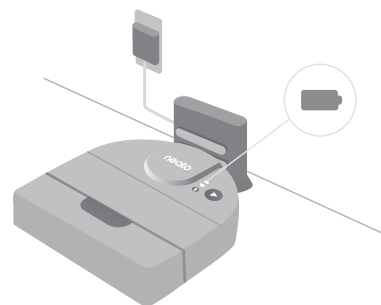

- 4 Download the MyNeato application.

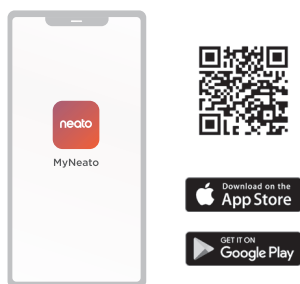

- 5 Check your mobile device setting to make sure the Bluetooth is switched on.

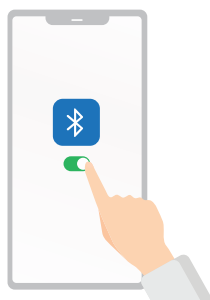

- 6 Finish your set up process with the MyNeato application.

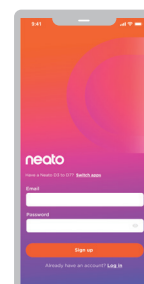

Helpful hints

Set up your house

Before the robot starts to vacuum, pick up items that could become tangled, such as cables, socks, and shoelaces. Tuck fringes under rugs.

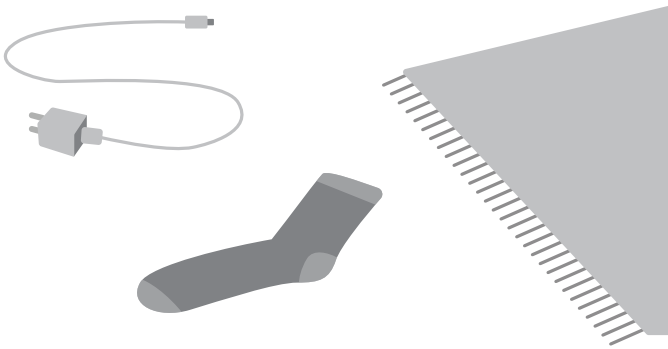

Keep your charge base secure

Your charge base comes with a pad designed to keep it secure on a hardwood floor. Remove these pads if you plan to place the charge base on carpet.

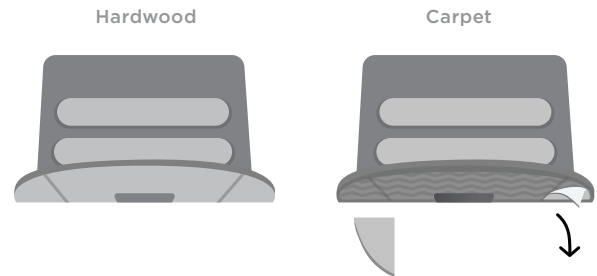

Clean with the MyNeato app

Use the MyNeato app to:

- Schedule your robot
- View cleaning maps
- Create No-Go lines or zones
- Clean specific rooms or areas

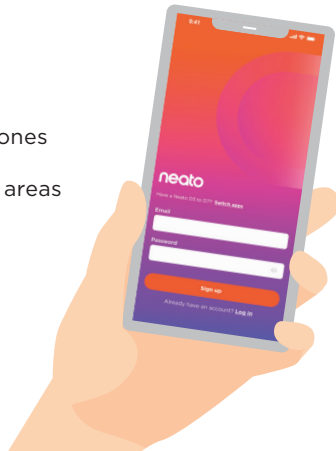

Need assistance?

Learn more about your robot:
www.NeatoRobotics.com/UG

We are here to help. Contact us at:
www.NeatoRobotics.com/contact-us



neato®

P/N 515-0072 Rev D