

# 32" LCD TV

## QUICK SETUP GUIDE

DX-32L152A11



Remote control and 2 AAA batteries

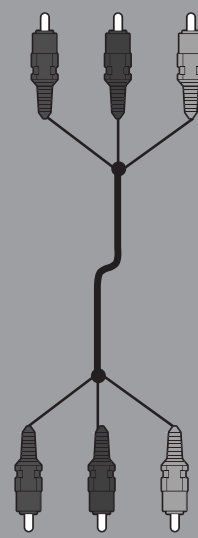

Composite cable

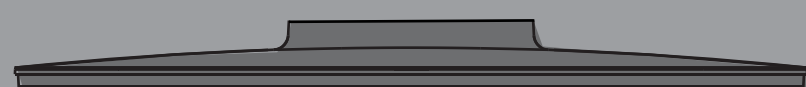

TV stand and screws

### Front and side features

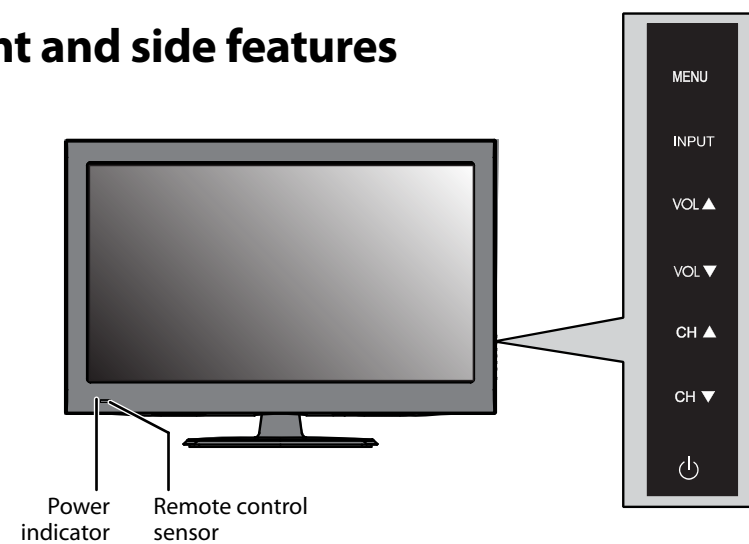

### Installing the stand

- 1 Remove the stand from the box and place it on a table or bench.
- 2 Lay the TV on a flat, cushioned surface.
- 3 Align the base with the bottom of the TV, then secure the base to the TV with the three screws provided.

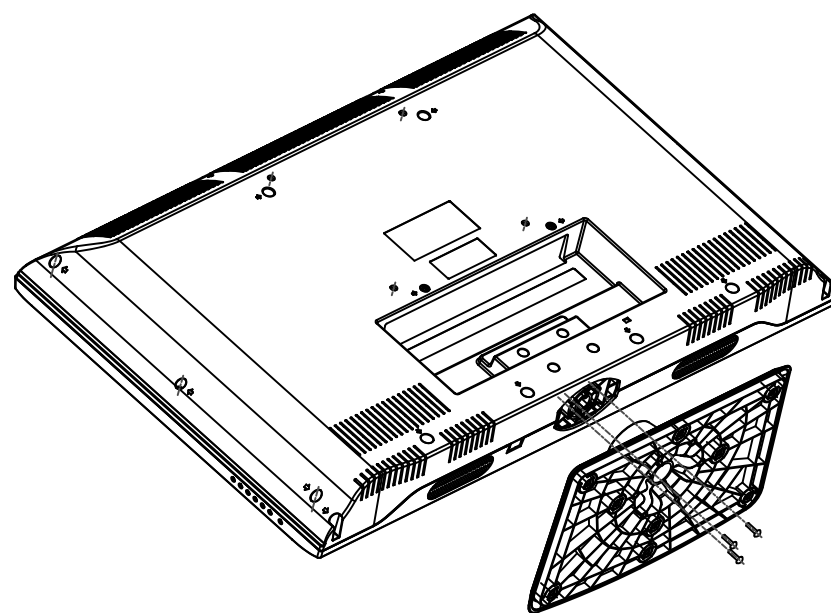

### Installing a wall-mount bracket

- 1 Carefully place your TV screen face-down on a cushioned, clean surface to protect the screen from damages and scratches.
- 2 Remove the pedestal stand. See "Removing the stand" in your *User Guide*.
- 3 Secure the wall-mount bracket to the back of your TV using the four screws provided with the bracket.

### Connecting a DVD or Blu-ray DVD player, cable box, satellite receiver, or game station

Using HDMI (best)

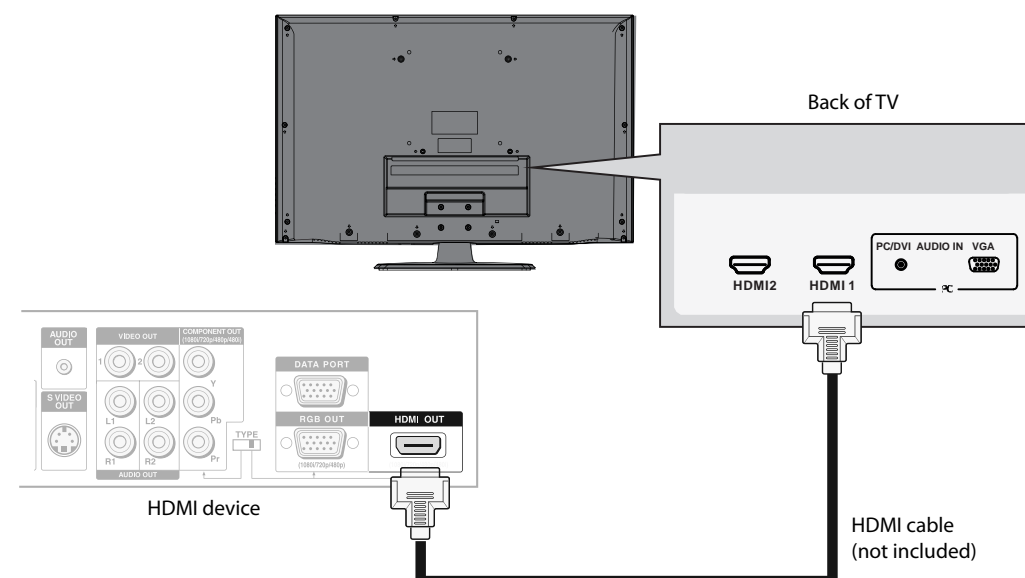

Using component (better)

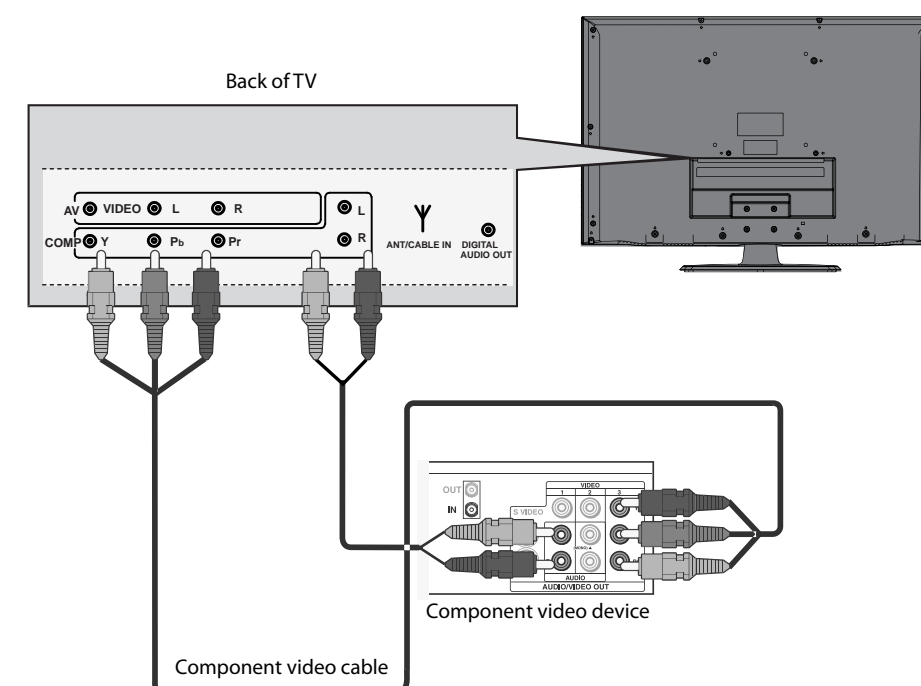

**Note:** Cable connectors and jacks are often color-coded. Match the colors when you connect the component video and AV cables.

Using composite (good)

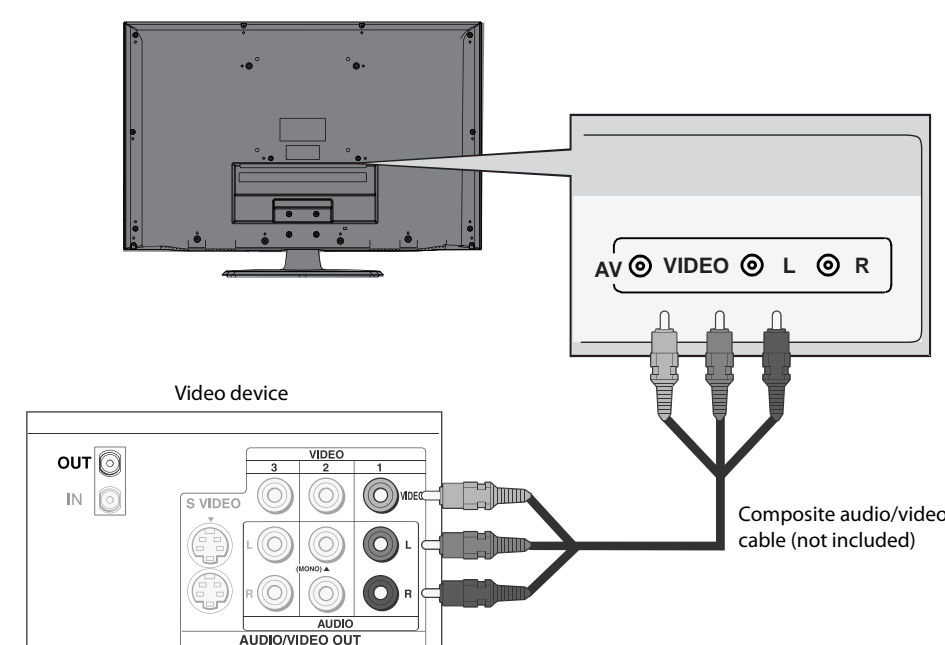

**Note:** Cable connectors and jacks are often color-coded. Match the colors when you connect the composite AV cable.

### Connecting an antenna

Connect a 75 ohm cable (not included) to the ANT/CABLE IN jack on the back of your TV and the RF OUT jack on the antenna.

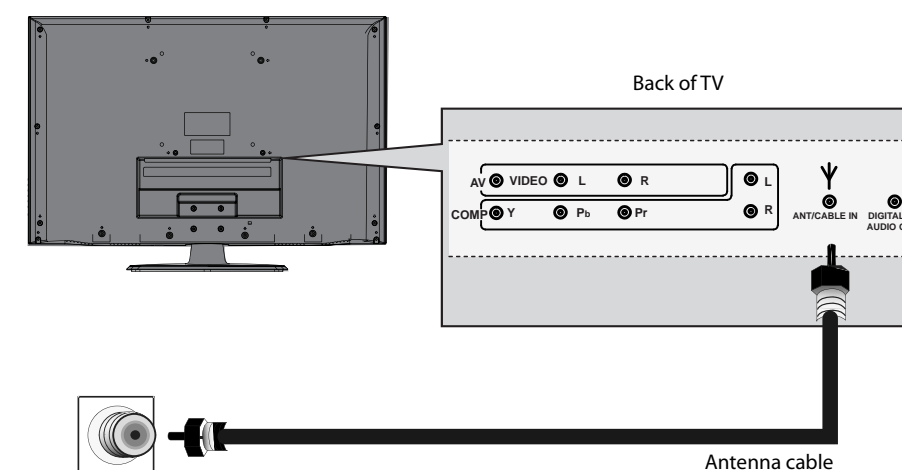

### Connecting a home theater system

Using digital audio:

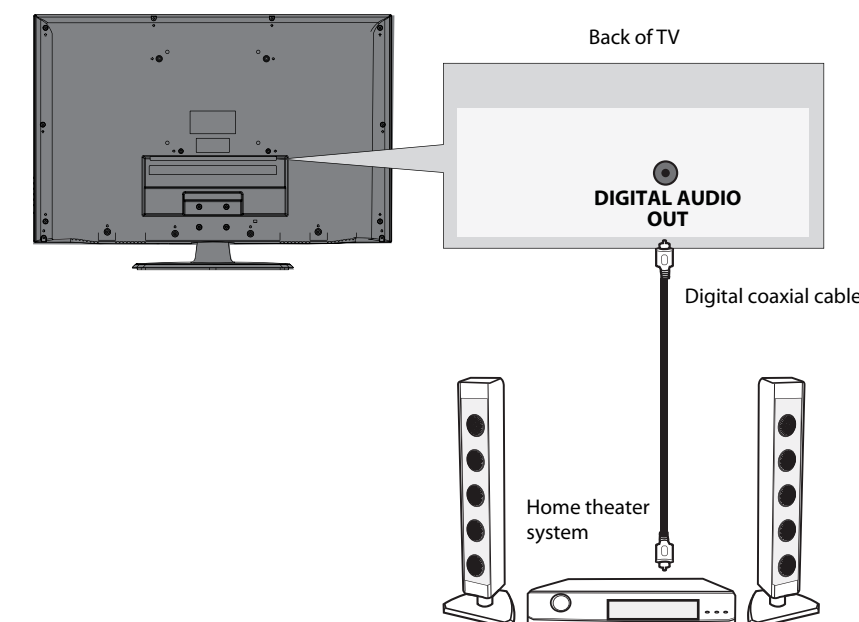

**Note:** The DIGITAL OUTPUT jack only works with digital TV channels.

### Connecting power

Connect the power cable to a power outlet.

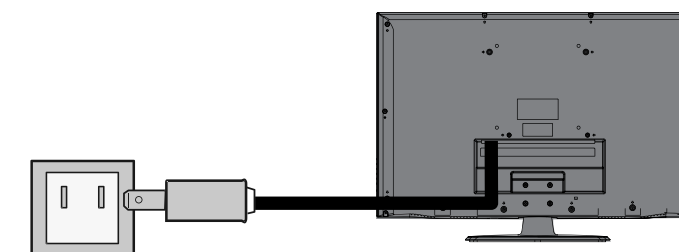

### Setting up your remote control

- 1 While pressing the release button on the battery compartment cover on the back of the remote, lift the cover off the remote.
- 2 Insert two AAA batteries into the battery compartment. Make sure that the + and - symbols on the batteries align with the + and - symbols in the battery compartment.
- 3 Replace the cover. Make sure that the lock snaps into place.

To program your existing remote control to work with your Dynex TV, see the table below for common codes. If you have problems programming your remote, or need a different remote control code, visit [www.dynexproducts.com](http://www.dynexproducts.com) for the latest remote control code information.

Universal remote control TV codes (for all Dynex TVs manufactured after Jan. 1, 2007)								
Universal remote control makers and models				Set-top box makers and models				
Philips PHVD05, PHED05, PMVDVR8, PMVR8	RCA RCU807	One for All URC-6690	Sony RM-VL600	Comcast M1057	Dish Network VIP508, VIP622	Motorola DRC800	TIVO Series 3, HD	DirectTV RC23
115	135	0464	8043	0463	720	0463	0091	10463

For step-by-step instructions on programming the remote control, see your *User Guide*.

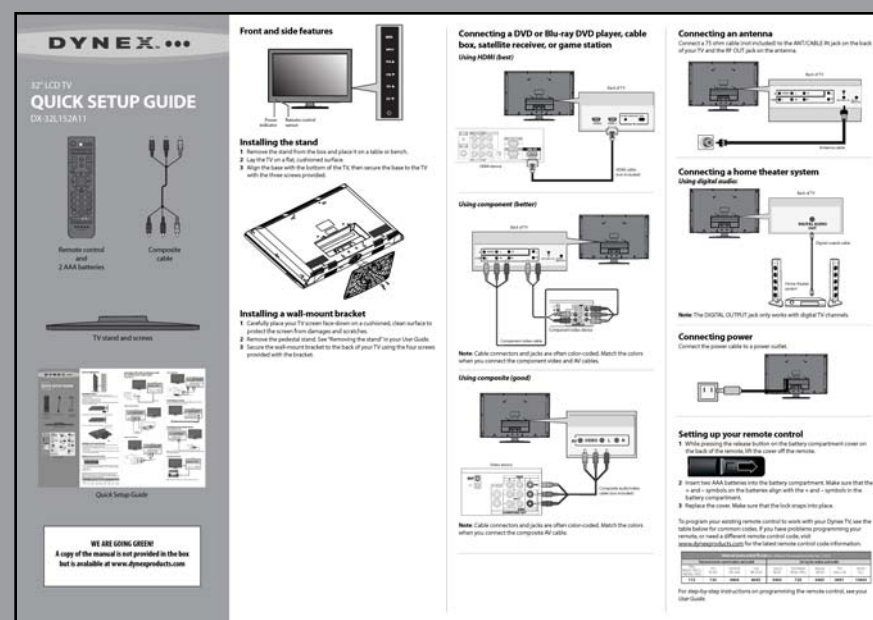

Quick Setup Guide

**WE ARE GOING GREEN!**  
A copy of the manual is not provided in the box  
but is available at [www.dynexproducts.com](http://www.dynexproducts.com)

Turning on your TV for the first time

- 1 Make sure that you have inserted the batteries in the remote control, connected your devices to the TV, and connected the AC power.
- 2 Press **(Power)**, then wait several seconds. The *Initial Setup* screen opens (only the first time you turn on your TV). Follow the prompts to complete the setup.



- 3 Press **▲** or **▼** to select the menu language you want, then press **ENTER**. The *Picture Mode* screen opens.



- 4 Press **▲** or **▼** to select the **Home Mode** or **Retail Mode**, then press **ENTER**. Home Mode reduces the TV's total power consumption. The *Tuner Mode* screen opens.

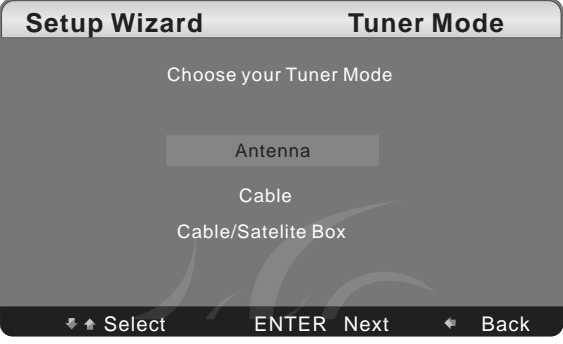

- 5 Press **▲** or **▼** to highlight **Antenna**, **Cable**, or **Satellite Box**, depending on the type of connection you have, then press **ENTER**. The *Channel* screen opens.
  - If you are using an antenna for a standard or HD TV signal or if your cable TV is connected directly to the TV (without a box), select **Antenna**.
  - If a cable is connected to your TV, select **Cable**.
  - If your TV is connected to a cable/satellite box, select **Cable/Satellite Box**.

- 6 Press **▲** or **▼** to select **Scan**, then press **ENTER**. The channel scan begins.

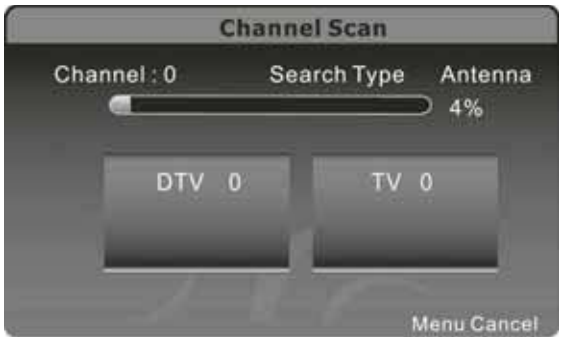

Selecting the video input source

- Press **INPUT**, press **▲** or **▼** to highlight a source, then press **ENTER**. You can also press any of the video source buttons directly.

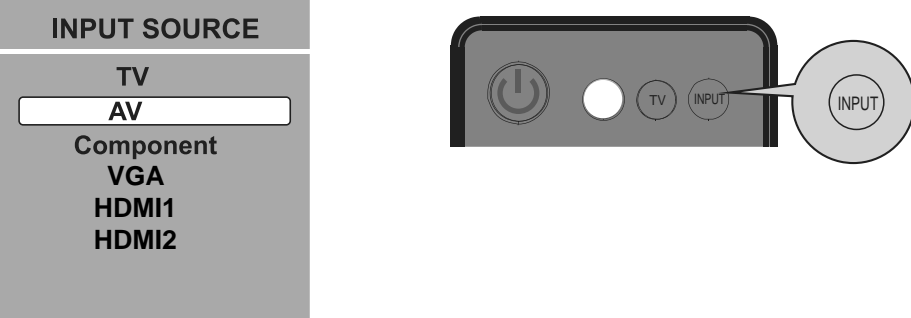

Adjusting the volume

- Press **VOL+** or **VOL-** to change the volume.
- Press **MUTE** to turn off the sound.

Selecting a channel

- To move to a different channel in the channel list, press **CH▲** or **CH▼**. OR
- Enter the channel number directly using the number buttons.

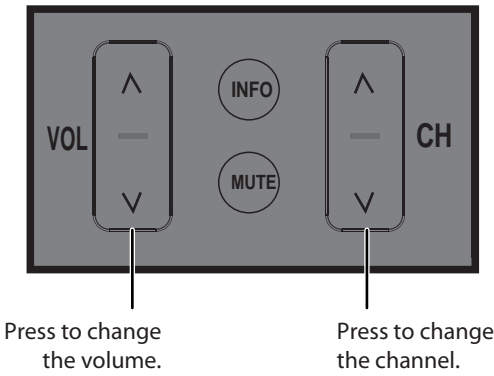

Viewing channel information

- Press **INFO** to view an information banner. The information banner shows the current program information such as channel number, video input source, and resolution.
  - Digital mode information—Displays the channel number, station name, channel label, broadcast program name, TV rating, signal type, audio information, resolution, CC mode, signal strength, and current program start and end times.
  - Analog mode information—Displays channel number, channel label (if preset), signal type, audio information, and resolution.
- Press **GUIDE** to show the digital program guide, which may view a list of available programs, program times, and program summaries, depending on the information provided by the broadcaster.

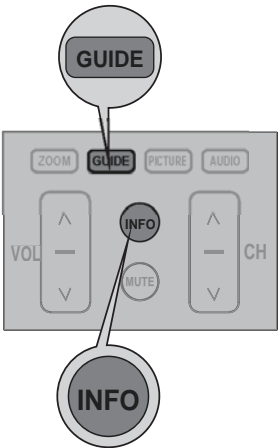

Changing picture size

Press **ZOOM** repeatedly to cycle through the display formats:

- **Auto** selects the correct aspect ratio automatically.
- **Normal** selects the correct aspect ratio to match the source image.
- **Wide** shows a full-screen picture.
- **Zoom** enlarges the picture but may crop the top and bottom.
- **Cinema** stretches the picture at the edges, but maintains a good aspect ratio at the center of the screen.

On-screen menu overview

Picture menu

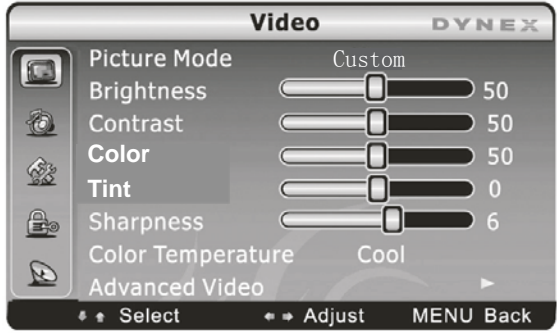

AUDIO menu



SETUP menu



Parental menu



CHANNEL menu



Navigating menus with your remote control

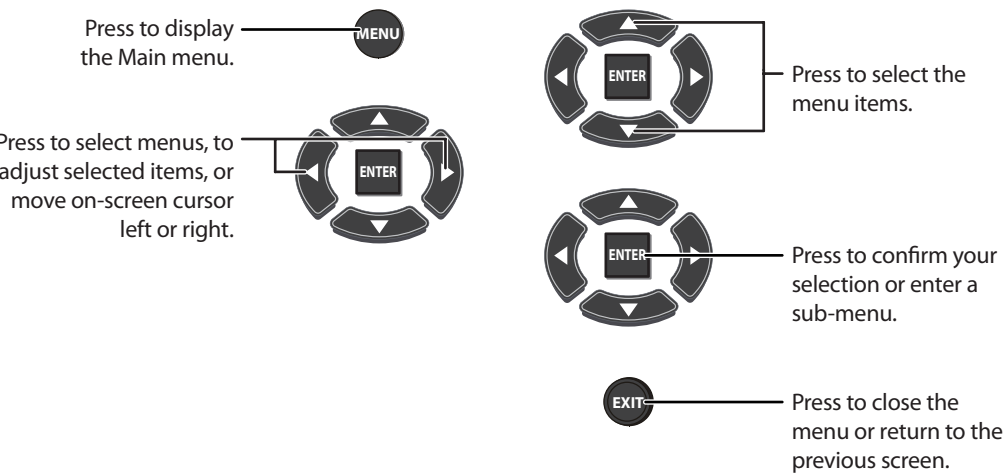

DYNEX

One-year limited warranty

Visit [www.dynexproducts.com](http://www.dynexproducts.com) for details.

Need additional help?

See your **User Guide!** This comprehensive guide includes everything from basic how-to steps to more advanced features.

We're here for you

[www.dynexproducts.com](http://www.dynexproducts.com)

For customer service, call:

**800-305-2204 (U.S./Canada markets)**

**01 800-926-3020 (Mexico market)**

Distributed by Best Buy Purchasing, LLC  
7601 Penn Avenue South, Richfield, MN USA 55423-3645  
Best Buy Imports, S. de R.L. de C.V. Av. Santa Fe 485, Segundo Piso, Colonia Cruz Manca, Programa Parcial de Desarrollo Santa Fe, Delegación Cuajimalpa, Distrito Federal, México 05349  
RFC#BBI0802114Q2

© 2010 BBY Solutions, Inc., All Rights Reserved.  
DYNEX is a trademark of BBY Solutions, Inc. Registered in some countries. All other products and brand names are trademarks of their respective owners.