

Barbie

12V Barbie E-Scooter

Parent and Rider Manual

STOP!

DO NOT RETURN TO STORE

**This product cannot be returned
for a refund after it has been
unpacked and used.**

**Call us Toll-Free
at 1-866-204-9737 for
assistance and information
from our trained staff.**

**For product related questions
or custom service needs please
email info@hypertoys.com**

**VISIT US ONLINE@
www.hypertoys.com**



WARNING: USE AT YOUR OWN RISK. ADULT SUPERVISION IS REQUIRED
THIS IS A POWERFUL TOY AND IS NOT INTENDED FOR RIDERS UNDER THE AGE OF 8 YEARS OLD

Do not discard this owner's manual. Refer to the manual for important instructions before operating and to progress in skill.

No more than 1 rider at a time. Do not exceed 120 lbs (54kgs) rider weight.

Do not allow riders under the age of 8 years old to use this product. Adult supervision is required.

Always wear shoes and proper protective gear, such as ANSI, SNELL, or ASTM approved helmets. Elbow and knee pads are also recommended.

Battery life may be reduced in extreme temperatures or with a maximum weight load.

Use only in safe controlled areas, not on public streets, or near motorized vehicles.

Do not ride at night or in low visibility conditions.

Steep, rough, uneven, low traction or wet surfaces can increase risk to the rider.

Be sure to check local regulations to understand how and where it is allowed to use this product.

CONTAINS LEAD ACID BATTERY. MUST BE RECYCLED OR DISPOSED OF SAFELY.

FOR ASSISTANCE WITH
YOUR ASSEMBLY CALL:
1-866-204-9737 TOLL FREE

HYPER TOY
CO

Barbie

12V Barbie E-Scooter

Parent and Rider Manual

With directions
for assembly and
operation

Please read this manual before assembly.
Remember to save your receipt.

12 VOLT
ELECTRIC

AGE **8+**
MAX WEIGHT
120 lbs, (54 kg)



⚠ WARNING:
Assembly by an adult.

⚠ WARNING:
CHOKING HAZARD- Small parts.
Not for children under 36 months.

MAX WEIGHT: 120 LBS (54 KGS)
MAX RIDERS: 1
MAX SPEED: UP TO 10 MPH (16 KPH)
EASY PUSH-BUTTON OPERATION
12 VOLT BATTERY AND CHARGER INCLUDED
WORKS ON HARD SURFACES
CONTAINS LEAD ACID BATTERY

www.HyperToys.com

FOR ASSISTANCE WITH
YOUR ASSEMBLY CALL:
1-866-204-9737 TOLL FREE

HYPER TOY
CO

Table of Contents

Table of Contents	1	Disposal	13
Safety, Warnings and Cautions	3	Limited Warranty	14
Riding Safety	4-5	Product Registration	16
Battery & Charging	6		
Parts	7		
Assembly	8		
Rider Controls	9		
Maintenance	10		
Care & Pre-Ride Check	11		
Troubleshooting	12		

Important Information

• ADULT ASSEMBLY AND SUPERVISION REQUIRED.

- The battery must be charged for 12 hours before first use.
- To start charging the battery before starting assembly, see Battery Charging and Installation Information on page 6.
- Instruct children on safe operation and riding rules before they take their first ride:
 - Only one rider at a time.
 - Always wear shoes while operating this electric scooter.
 - Always wear a helmet and protective pads while operating electric scooter.
 - Do not allow other children around this electric scooter while riding.
 - Do not place your hands, feet, any part of your body, clothing, or other articles near moving parts of this electric scooter while electric scooter is in operation.
 - The rider must always stand in the center of the electric scooter deck while riding.
 - The rider must never use their mobile phone or wear headphones while riding this electric scooter.
- California Proposition 65 Warning: This product contains or emits chemicals known to State of California to cause cancer and birth defects or other reproductive harm.
- Do not overload this electric scooter or exceed the maximum weight capacity of 120 lbs, (54 kg).
If you have questions please call 1-866-204-9737 toll free.
- **Please read this manual completely** for operation and safety information **before** operating this electric scooter. Keep this manual for future reference.

FOR ASSISTANCE WITH
YOUR ASSEMBLY CALL:
1-866-204-9737 TOLL FREE

This image shows a full page of white paper with horizontal blue or grey ruling lines. The lines are evenly spaced and run across the width of the page, providing a template for writing. There are no margins, text, or other markings on the page.

2

HYPER TOY CO

WARNING: Electrical Hazard

RISK OF FIRE , DO NOT BYPASS.

- Only use a Hyper Toy Co. 12V lead acid battery and battery charger provided with this electric scooter.
- Never modify the electrical system. Modifying the electrical system could start a fire resulting in damage to electric scooter, serious injury or death.
- Only adults should handle the lead acid battery and charging of lead acid battery. Dropping the lead acid battery can cause serious injury or damage to the electrical system.
- The charger will get warm or hot while charging the lead acid battery, this is normal.
- Each time you charge the battery check for any damage to the battery port or battery charger before charging.

WARNING: Riding Hazard

To reduce the risk of injury, adult supervision is required.

- Never use in roadways, near motor vehicles.
- Never use on or near steep inclines or steps.
- Never near swimming pools or other bodies of water.
- Always wear shoes.
- Never allow more than 1 rider.
- Max weight of 120lbs, (54 kgs).

WARNING: Battery Charger

Changes or modifications to this unit not expressly approved by the party responsible for compliance could void the user's authority to operate the equipment.

NOTE: This equipment has been tested and found to comply with the limits for a Class B digital device, pursuant to Part 15 of the FCC Rules. These limits are designed to provide reasonable protection against harmful interference in a residential installation. This equipment generates, uses and can radiate radio frequency energy and, if not installed and used in accordance with the instructions, may cause harmful interference to radio communications.

However, there is no guarantee that interference will not occur in a particular installation. If this equipment does cause harmful interference to radio or television reception, which can be determined by turning the equipment off and on, the user is encouraged to try to correct the interference by one or more of the following measures:

- Reorient or relocate the receiving antenna.
- Increase the separation between the equipment and receiver.
- Connect the equipment into an outlet on a circuit different from that to which the receiver is connected.

Consult the dealer or an experienced radio/TV technician for help.

WARNING: Battery Charger

- When fully unassembled, this package contains small parts. Adult assembly is required.
- Use the charger in dry areas only.

CALIFORNIA PROPOSITION 65 WARNING:

This product can expose you to chemicals including lead, which is known to the State of California to cause cancer and birth defects or other reproductive harm. For more information go to www.P65Warning.ca.gov

Adult Supervision Required

- ALWAYS TEACH SAFELY FIRST.
- While most children can develop the physical skills necessary to operate this electric scooter it's important to remember that they do not yet have mature judgment skills. Children should never be allowed to ride this electric scooter without adult supervision. Before any child rides this electric scooter an adult must evaluate the child's skill levels and abilities to operate this electric scooter safely. Hazards are not always anticipated or recognized by children. So before any child operates this electric scooter they must be taught the appropriate safety rules.
- THERE IS NO SUBSTITUTE FOR DIRECT ADULT SUPERVISION.

Before Riding

- Always test the braking system before using this electric scooter.
- Always inspect the tires condition before using this electric scooter.
- Never overload this electric scooter over the maximum weight limit of 120 lbs, (54 kgs).
- Always make sure the battery is fully charged before using this electric scooter.
- Always inspect all the electric scooters components if they are loose or damaged, tighten loose components or call customer service if parts need to be replaced.

Safe Riding Rules

⚠ WARNING: E-scooter speed limits in different states and regions can and do vary. Please ensure that the E-scooter is used in accordance with the latest relevant local/national e-scooter law and speed limit. Riding an electric scooter can be a dangerous activity. Certain conditions may cause components to fail at no fault of the manufacturer. The scooter can, and is intended to, move and it is therefore possible to lose control, fall off or for dangerous situations to occur that no amount of care, instruction or expertise can prevent. This can result in serious injury or death, even with the use of safety equipment and other safety precautions.

RIDE AT YOUR OWN RISK AND ALWAYS USE COMMON SENSE

Since any incident can result in serious injury or even death, we do not repeat the warning of possible serious injury or death each time such a possibility is mentioned in this manual. This manual contains extremely important safety information. It is your responsibility to completely review this information and make sure that all riders understand warnings, cautions, instructions and safety topics and to ensure that all riders are able to safely and responsibly use this scooter. The manufacturer advises that you periodically review and reinforce all the information in this manual with all riders and that you inspect and maintain your scooter to ensure their safety. This product must be assembled by an adult.

READ ALL INSTRUCTIONS BEFORE USING THE VEHICLE FOR THE FIRST TIME.

Keep this manual for future reference. Correct assembly of this product is vital. Incorrect assembly can result in harm to the rider. Please check the product before each use. This product should be used with caution since skill is required to avoid falling or preventing collisions, which can cause injury to user or third parties. Not suitable for children with a body weight of over 54kg, (120lbs). Rider weight does not always mean a person's size is appropriate to fit or maintain control of the scooter. Only one rider to use the product at a time. Keep away from small children and remember it's intended use is only by persons who are, at minimum, completely competent and comfortable whilst operating this product.

Safety Rules

**NOTE: To reduce the risk of injury
adult supervision is required!**

- Not for children under 8 years. Small part Choking hazard.
- The recommended rider age is over 8 years older. Any rider that is unable to fit comfortably on the scooter should never attempt to ride it. A parent's decision to allow their child to use the scooter should be based on the child's maturity, skill and ability to follow rules.
- Adult supervision is required for children under 16 years old.
- Do not activate this electric scooters electric throttle, on the hand grip, unless you are riding in a safe outdoor environment that is suitable for riding.
- Never operate this electric scooter on busy streets, roads, highways, or near any motorized vehicles.
- Always use a protective helmet, knee and elbow pads, and always wear shoes when using this electric scooter.
- Always keep both hands on the electric scooters handlebars while riding this electric scooter.
- Only use the this product on smooth, dry and level surfaces.
- Never use near swimming pools or other bodies of water.
- Never ride in the dark or in dimly lit areas.
- Never ride in hilly areas or on steep slopes.
- Never immerse the scooter in water, the electrical system and drive components could be damaged by water.
- Clean the electric scooter with a damp soft cloth only and never submerge or spray this electric scooter with water.
- Please check the local laws for legal places to use this electric scooter.
- Always keep fingers and any other body parts away from any moving parts on this electric scooter.
- Never ride while using a phone or wearing headphones.
- Never hitch on to or with another moving vehicle while operating this electric scooter.
- Do not activate the speed control on the hand grip unless you are on the electric scooter and in a safe outdoor environment that is suitable for riding.
- Only use this product on smooth, dry and level surfaces.
- Never use on busy streets, roads or highways
- Always use this electric scooter with caution, it may take time to acquire the skills required to ride this electric scooter safely in public areas without causing injury to yourself or others.
- Do not attempt or perform any stunts or tricks on this electric scooter. This product is not made to withstand abuse from jumping, curb grinding or any other type of misuse or stunts.
- FAILURE TO COMPLY WITH THE WARNINGS LISTED ABOVE INCREASES RISK OF POTENTIAL SERIOUS INJURY. USE THE APPROPRIATE CAUTION WHEN RIDING AND ALWAYS WEAR PROTECTIVE GEAR.
- Always inspect before riding the electric scooters axle guards or any other guards are in place and in good condition.
- Always inspect and test before riding that the brakes are functioning properly.
- Always inspect before riding all components are properly secured and are functioning according to the manufacturer's specifications.
- Always Inspect before riding the wheels for excess wear and replace if necessary.
- Always inspect before riding the quick release steering tube folding mechanism is fully locked and secured.
- Always inspect before riding the hand-grips and steering tube are fully tightened and secured.
- Components should be maintained and repaired in accordance with the manufacturers authorized replacement parts with installation performed by skilled individuals or dealers.
- Do not use this electric scooter if you have any heart conditions, have any injury to your head, neck, or back including prior surgery to any of these areas, or if you are pregnant.
- Never use this electric scooter to race, perform stunts, or perform any other maneuvers which may cause a loss of control.
- Always check that all the components on this electric scooter are in working order before riding.
- It's encouraged that the rider add lights, add light reflectors, and wear bright clothing when using this electric scooter.
- Always avoid sharp bumps, drainage grates, and loose traction surfaces while riding this electric scooter.
- It's important the rider and the supervising adult read and understand this electric scooters manual before first use.

Battery

Charging Instructions

CAUTION! To reduce the risk of injury adult supervision is required!

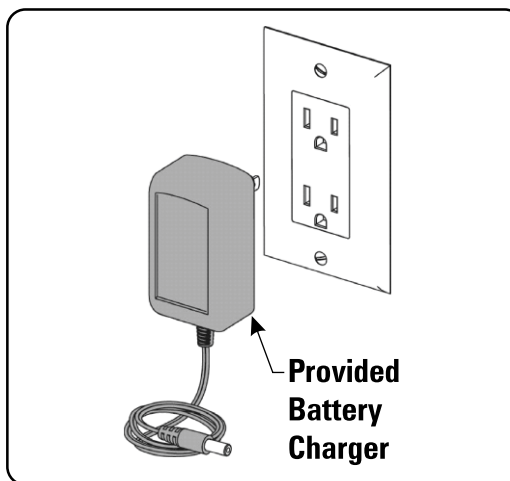
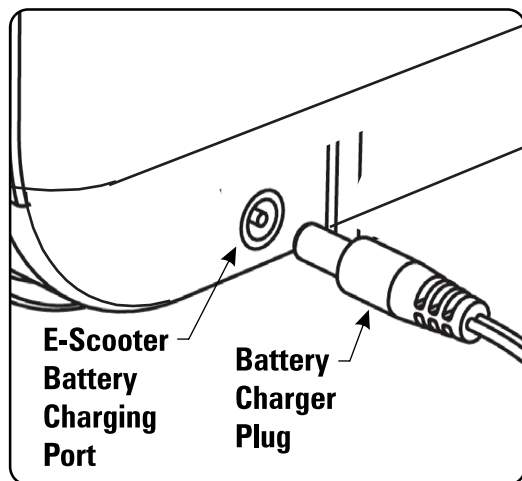

1. Open the charging rubber cover on the pedal and insert the charger output connector into the charging hole .
2. Plug the charger into the wall power outlet (AC 100V - 240V).
3. Make sure the E-Scooter ON/OFF switch is in the OFF mode then connected the charger plug to the e-scooter battery port located on the e-scooter deck right side.
4. When charging the e-scooter battery the charger indicator light will turn red when it's charging. When the battery charger is finished charging the battery the charger indicator light will turn green.
5. Always charge the battery in a dry and well ventilated environment.
6. Keep away from flammable material while charging the battery.

NOTE: The dedicated charger provided by the company has a charging protection function and when the battery is 100% fully charged it will automatically stop charging the battery.

- Use only the charger and battery that is packaged with this electric scooter.
- Before first use, the battery should be recharged for 12 hours.
- The charger is not a toy and only be used by an adult.
- Only use the charger and battery that is originally provided with this electric scooter.
- Never charge for more than 12 hours as this will shorten the battery lifetime.
- Do not allow children to play with the charger or to recharge the battery.
- Always unplug the battery charger when not in use.
- It is normal for the charger to feel warm while charging the battery.
- Fully charge the electric scooters battery before storing for long periods of time.
- Recharge the product once a month when not in use to prolong the battery life.
- Non-rechargeable batteries are not to be recharged.
- Never use mixed battery types or old and new batteries on this electric scooter.
- Always install batteries with the correct polarity.
- Examine the charger regularly for damage to the cord, plug, housing and other parts. If damage is found stop using the charger and call customer service for a replacement battery charger.
- Do not store this electric scooter in freezing or below freezing temperatures this will permanently damage the battery.
- The supply terminals are not to be short-circuited or modified in any way.
- Estimated battery lifetime is 1 -2 years if battery charging instructions listed in this manual are followed.
- It is normal for the charger to feel warm during charging.
- Never dismantle or modify the lead acid battery or the battery charging kit provided with this electric scooter.
- Estimated battery lifetime is 1 -2 years depending on following the battery charging instructions in this manual.

FOR ASSISTANCE WITH
YOUR ASSEMBLY CALL:
1-866-204-9737 TOLL FREE

Parts

ATTENTION! Please make sure you have all the parts and tools listed below.

Part Description

1. Frame
2. Electric Motor
3. Front Fork & Rotation Limit
4. Headset (Upper & Lower)
5. Stem Clamp
6. Kickstand
7. Battery Box
8. Deck
9. Rear Wheel
10. Front Wheel
11. Spring Plate
12. Foot Brake
13. Electric Thumb Throttle
14. Right Grip
15. Left Grip
16. Controller
17. Batteries
18. Handlebar/Stem
19. Charger Port & Dust Cover
20. On/Off Switch
21. Brake Cut Off Switch
22. Transmission
23. Motor Cover
24. Steering Limit Cover
25. Spring Button
26. Electric Thumb Throttle Connector

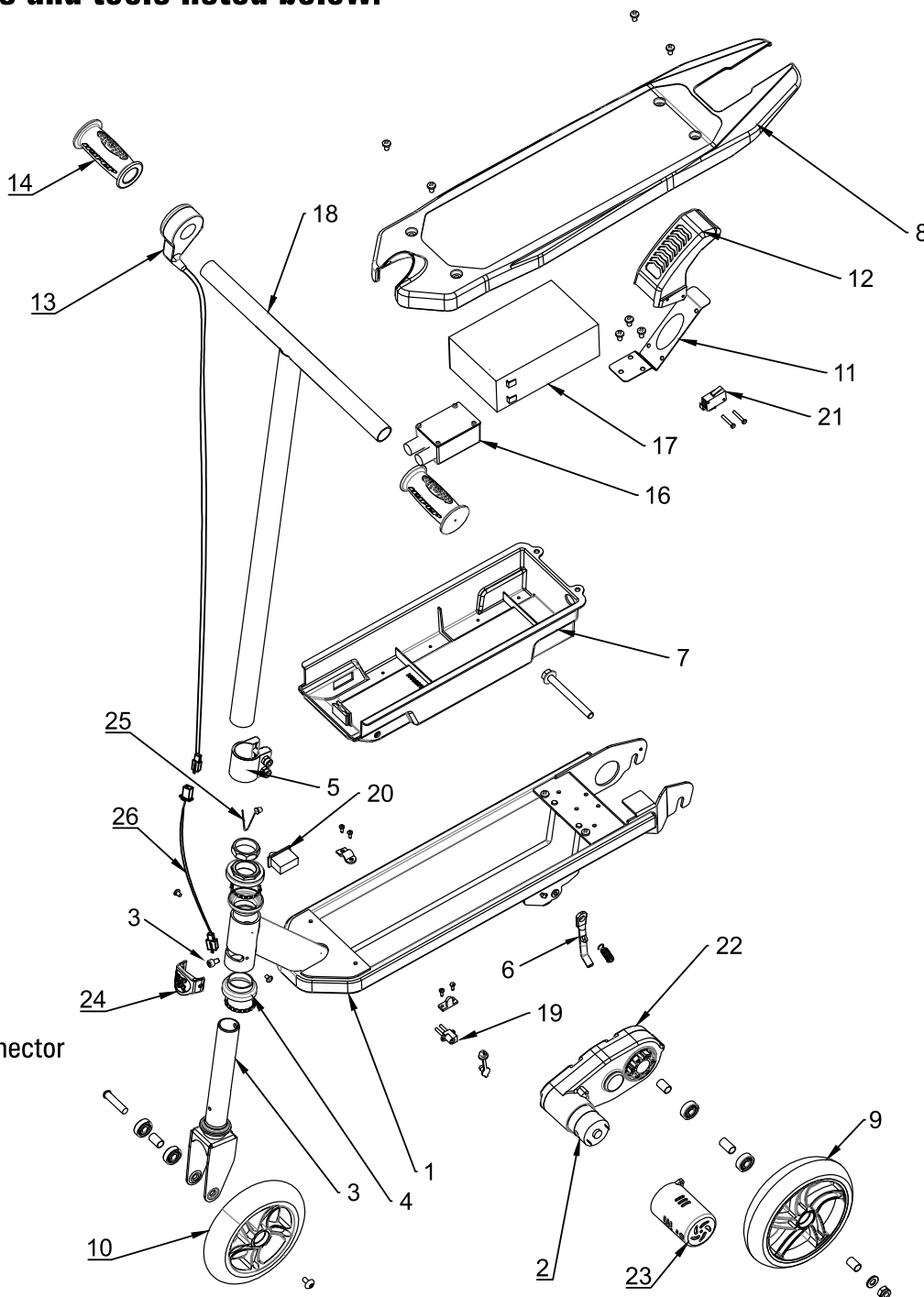

Battery & Charger

1 Battery Charger Kit



Tools

1 Hex Wrench



1 Wrench

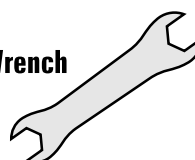

FOR ASSISTANCE WITH
YOUR ASSEMBLY CALL:
1-866-204-9737 TOLL FREE

Assembly

ATTENTION! Make sure this electric scooter is turned off before assembly. This electric scooter comes mostly assembled within the packaging, only some minor assembly is required. For the initial assembly all the required parts are included in the box. The assembly should be performed as shown below.

1. Connect Electric Thumb Throttle

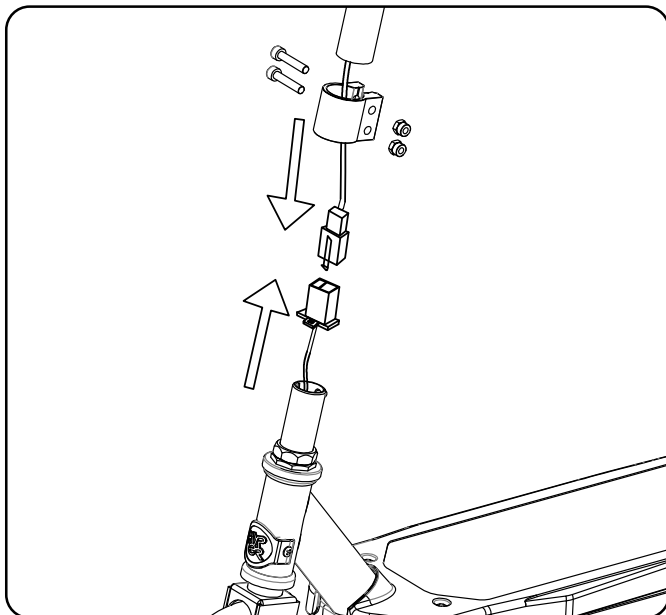

Connect the two plugs well. Depress the push button located on the rear of the fork tube and insert the handlebar steer tube onto the fork tube. The push button should align with the locator hole in the handlebar steer tube and lock the steer tube securely in place. Once the push button pops out of the locator hole, lift up on the steer tube to ensure it cannot slide off. If it cannot, then proceed to step 2.

2. Handlebar/Stem Installation

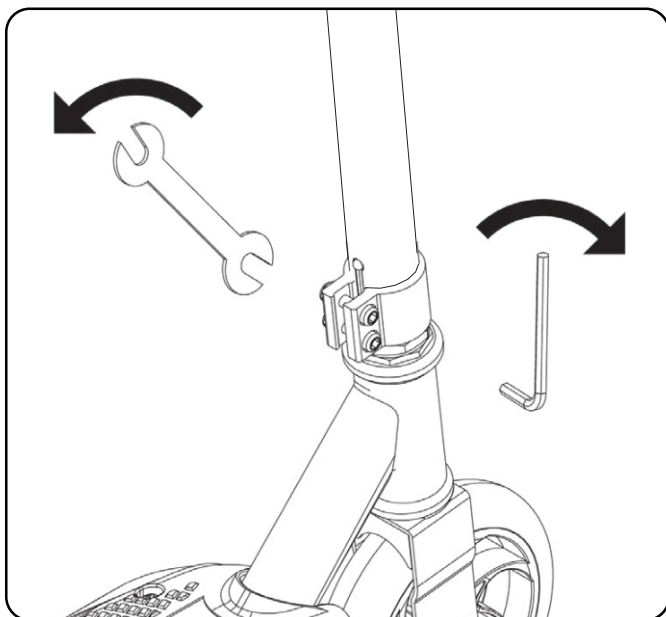

Tighten the bolts with the 5 mm hex wrench and 10 mm wrench as shown. Tighten bolts evenly and securely.

WARNING! Failure to tighten the handlebar/stem clamp bolts securely can cause the rider to lose control of this electric scooter causing serious injury to the rider or damage to this electric scooter voiding the warranty.

⚠ WARNING!

Always check that the e-scooters steering stem clamp, handlebar grips, rear foot brake, front and rear wheels, and electric thumb throttle are all secure before every ride.

FOR ASSISTANCE WITH
YOUR ASSEMBLY CALL:
1-866-204-9737 TOLL FREE

Rider Controls

Rider Controls

ATTENTION! To reduce the risk of injury adult supervision is required! Always wear the proper protective gear while operating this electric scooter.

Step 1: Turn the electric scooter to the "ON" mode with the red ON/OFF switch located on the bottom right side of the electric scooter.

Step 2: Put the kickstand in the folded position, securely away from the ground. Hold the handlebar grips with both hands and place one foot on the deck with the other foot on the ground. With your right thumb slowly press down the electric throttle. Place both feet on electric scooter deck when this e-scooter begins to gain speed. With the first ride you should carefully operate the electric thumb throttle until you are comfortable with the electric thumb throttle function.

Step 3: To stop this e-scooter release the electric throttle and slowly use your rear foot press down on the rear foot brake in order to slow down or come to a complete stop. When stopped place one foot at a time off the e-scooters deck and onto the ground. Take extra caution when dismounting for the first time.

Step 4: Turn off the e-scooter when not in use. Always charge the scooter at least once a month when not in use.

⚠ WARNING!

Always check that the e-scooters is fully charged before using. Also make sure the steering stem clamp, handlebar grips, rear foot brake, front and rear wheels, and electric thumb throttle are all secure and free of damage before every ride.

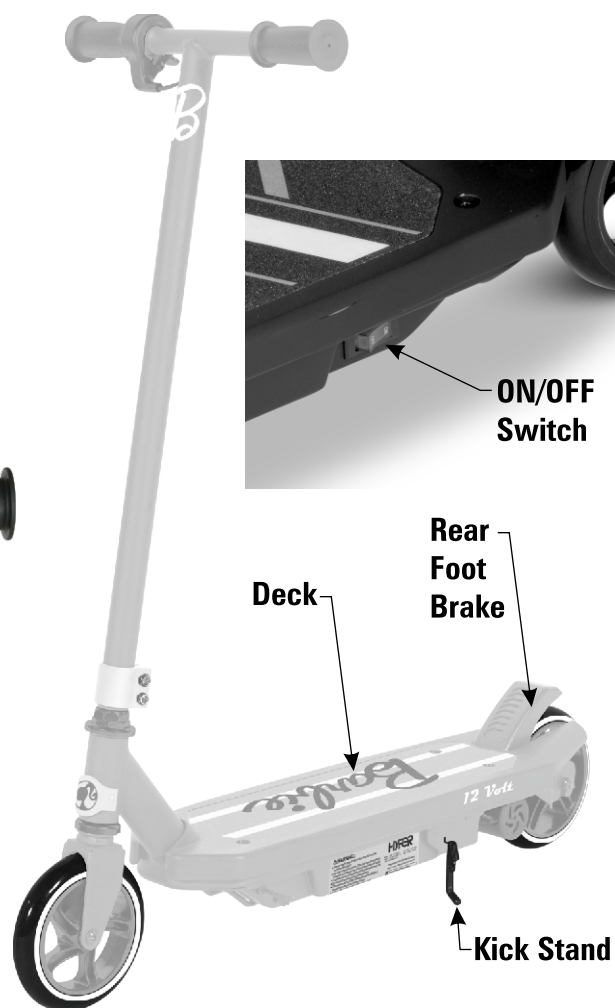
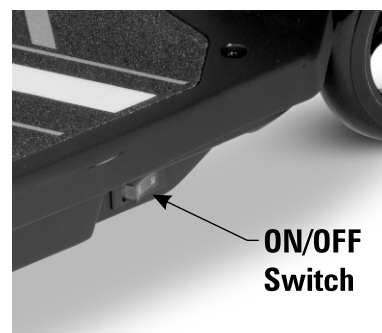
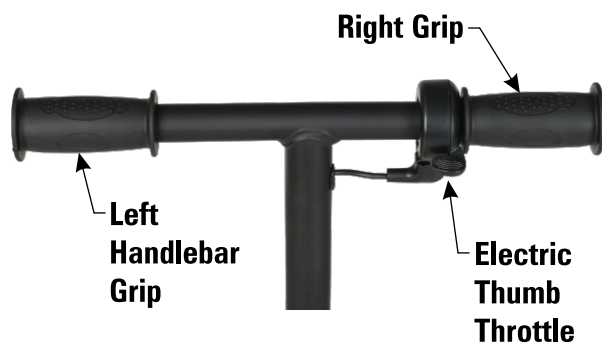

FOR ASSISTANCE WITH
YOUR ASSEMBLY CALL:
1-866-204-9737 TOLL FREE

Maintenance

Rear Wheel Transmission/Motor Replacement

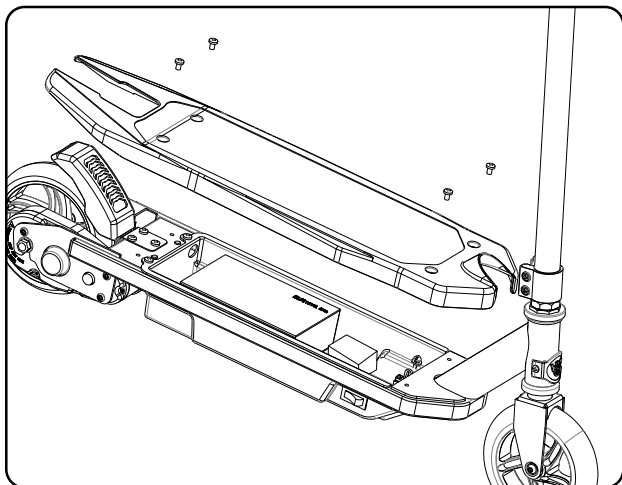

1. Using a #2 phillips screwdriver, remove the 4 deck screws and lift the deck away by moving it up and towards the rear of the scooter allowing the deck to slip off of the brake pedal. NOTE: The foot brake pedal will not come off with the deck.

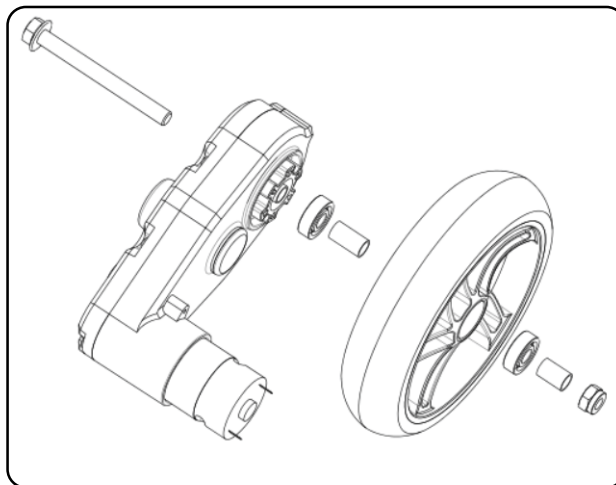

2. Using two 13 mm wrenches loosen the rear wheel axle nut and bolt. carefully remove the wheel and transmission assembly from the frame, with the wheel and motor remaining on the transmission. NOTE: the location of all rear wheel assembly hardware and ensure to properly re-install all items, including the deck and deck screws, tightly and securely.

Front Wheel Replacement

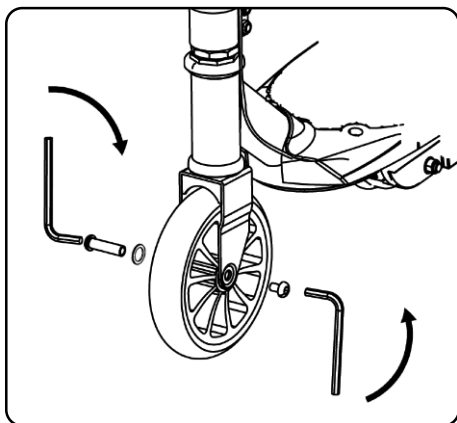

1. Using two 5 mm hex wrenches loosen and remove the front axle by turning the wrenches counter clockwise.

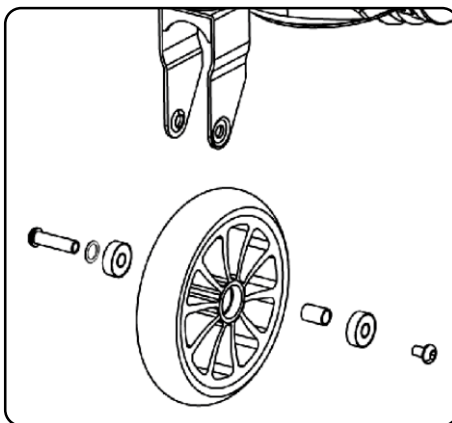

2. Reinstall new replacement wheel ensuring to note the order and location of all components.

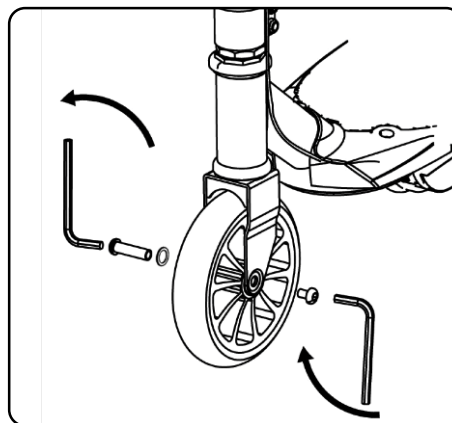

3. Reinstall hardware and tighten clockwise with a 5 mm hex wrench.

FOR ASSISTANCE WITH
YOUR ASSEMBLY CALL:
1-866-204-9737 TOLL FREE

Care & Pre-Ride Check

⚠ ATTENTION! Adult supervision is always required while this electric scooter is being operated, battery re-charged, assembled, or repaired.

- ☑ Check all screws, nuts, and protective coverings regularly and tighten securely.
- ☑ Check all plastic parts on a regular basis for cracks or broken pieces.
- ☑ Never use this battery powered electric scooter near water or in wet weather conditions such as rain and snow.
- ☑ Never operate this electric scooter in mud, sand, loose dirt, or gravel. This can cause the electric switches and motor to fail.
- ☑ Never wash this battery powered electric scooter with soap and water, this can cause the electric parts of the electric scooter to fail. To clean this electric scooter only use a non-wax furniture polish applied to a soft micro-fiber soft cloth.
- ☑ Always store electric scooter inside or under a protective cover.
- ☑ Always re-charge this electric scooters battery 10 hours once a month while not in regular use to extend the life of the battery.
- ☑ All safety labels need to be in place and understood by the operator.
- ☑ Persons with the following conditions shall be cautioned not to operate. Persons with any mental or physical conditions that may make them susceptible to injury or impair their physical dexterity or mental capabilities to recognize, understand, and perform all of the safety instructions and to be able to assume the hazards inherent in unit use.

FOR ASSISTANCE WITH
YOUR ASSEMBLY CALL:
1-866-204-9737 TOLL FREE

Troubleshooting Guide

Completely read through this manual and troubleshooting guide before contacting customer service at 1-866-204-9737.

NOTE: The electric scooter's battery should be fully charged and in the OFF mode before troubleshooting.

Problem	Possible Cause	Solution
Electric Scooter doesn't turn on	Possible central control board damage	Contact customer service.
Electric Scooter does not run	Battery low on power	Fully recharge battery.
	Circuit breaker has tripped	Reduce the weight and do not overload, Maximum weight is 120 lbs, (54 kg), the fuse will recover to the normal status.
	Battery connector or wires are loose	Check that the battery connectors are firmly plugged into each other. If wires are loose around the motor contact customer service.
	Battery is dead	Replace battery, contact customer service.
	Electrical system is damaged	Contact customer service.
	Motor is damaged	Contact customer service.
	Power display and control damaged	Contact customer service.
	Throttle wire is loose	Contact customer service.
	Battery charger plugged in	Contact customer service.
Electric Scooter does not run very long	Battery low on power	Charge the battery at least for 10 hours
	Battery is old or damaged	Replace battery, contact customer service.
Electric Scooter runs sluggishly	Battery low on power	Recharge battery
	Battery is old or damaged	Replace battery, contact customer service.
	Electric Scooter is overloaded	Maximum user weight is 120 lbs, (54 kg).
	Electric Scooter used in harsh conditions	Avoid using electric scooter in harsh conditions.
Loud grinding or clicking noises coming from motor or rear hub	Motor or rear hub is damaged	Contact customer service
Battery will not recharge	Battery connector or adapter is loose	Contact customer service.
	Charger not plugged in	Plug charger into wall power outlet
	Charger is not working	Contact customer service.
Charger feels warm when charging	This is normal, no need for concern.	

NOTE: THIS ELECTRIC SCOOTER IS EQUIPPED WITH AN INTERNAL SELF-RESETTING CIRCUIT BREAKER THAT WILL TURN OFF THE POWER WHEN THE ELECTRIC SCOOTER IS OVERLOADED TO PROTECT THE ELECTRIC MOTOR. YOU MUST WAIT FOR AT LEAST ONE MINUTE TO ALLOW THE CIRCUIT BREAKER TO FULLY RESET BEFORE NEXT USE.

FOR ASSISTANCE WITH
YOUR ASSEMBLY CALL:
1-866-204-9737 TOLL FREE

Storage & Disposal

Cleaning & Storage

- Always turned OFF this electric scooter before cleaning or while storing.
- Clean your device using a damp soft cloth and non abrasive cleansers only.
- If you scratch any plastic parts on this electric scooter you can lightly sand and polish the surface.
- Never use a pressure washer on any part of this electric scooter.
- Never pour water onto any part of this electric scooter.
- Store this electric scooter in a secure, dry indoor location, out of direct sunlight.
- Never leave this electric scooter outside in the rain or in damp conditions.



CALIFORNIA PROPOSITION 65 WARNING:

This product can expose you to chemicals including lead, which is known to the State of California to cause cancer and birth defects or other reproductive harm. (For more information go to www.P65Warnings.ca.gov.)

Supplier's Declaration of Conformity 47 CFR 2.1077 Compliance Information

Unique Identifier
Trade Name: Hyper
Model No.: HYP-S12-8200
Responsible Party U.S. Contact Information
Hyper Bicycles, Inc.
Address: 177 Malaga Park Dr., NJ 08328, USA
Telephone: 1-866-204-9737
Email: info@hypertoys.com

FCC Compliance Statement

This device complies with Part 15 of the FCC Rules.

Operation is subject to the following two conditions:

- (1) This device may not cause harmful interference, and
- (2) this device must accept any interference received, including interference that may cause undesired operation.

Disposal

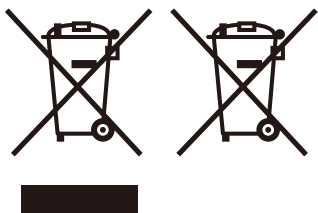

Old appliances may not be disposed of with household waste! If the electric scooter can no longer be used, all consumers are required by law to bring the old appliance to a separate waste collection point, for example in their community or district, and must not dispose of them in the household waste. This ensures that the old appliances are properly recycled and that negative effects on the environment are avoided. For this reason, electrical appliances are marked with this symbol.

Please take defective batteries or ones that are no longer usable to your local collection point. Look for the symbol on the battery.

Dispose of the packaging according to type.

Dispose of paper and cardboard as waste paper, foils via recyclables collection.



Dispose of the packaging according to type.

Dispose of paper and cardboard as waste paper, foils via recyclables collection.

FOR ASSISTANCE WITH
YOUR ASSEMBLY CALL:
1-866-204-9737 TOLL FREE

Limited Warranty

**DON'T RETURN YOUR
ELECTRIC SCOOTER TO THE STORE**

Do not take back to store, call customer service with any problems or questions.

Hyper Toy Company offers the following limitations, terms and conditions to the original owner of the Hyper Toy Company Electric Scooter. Should this Hyper Toy Company Electric Scooter or an part be determined defective by Hyper Toy Company to be covered by this Limited Warranty, it will be repaired or replaced, at Hyper Toy Company sole option, which will be conclusive and binding. Under no circumstances does this limited warranty include the cost of travel or shipment to and from any retailer or consumer. Such cost, if any, shall be borne by the original or subsequent owner.

This Hyper Toy Company electric scooter has not been designed or engineered for ramp riding, jumping, aggressive riding, in severe climates or over severe terrain, riding with heavy loads of over (120 lbs or 54 kgs) or any similar activities. Such uses may damage the Hyper Toy Company electric scooter, that can cause serious injury to the rider and in all cases will void this warranty.

90 days from the purchase date of electric scooter

Hyper Toy Company electric scooter 12V lead acid battery and power supply are warranted from 90 days from date of purchase to The Original Purchaser against any defects in material, manufacturing, and/or workmanship. If there is any evidence of consumer repair the warranty is voided. Any claim of damage under this clause cannot be due to owner abuse or neglect and must first be reported to Hyper Toy Company Customer Service and a Return Merchandise Authorization (RMA) tag to be issued.

This Limited Warranty does not cover normal wear and tear, tires, cables, or any damage, failure or loss caused by improper assembly, maintenance, storage or use of this brand electric scooter. This warranty is limited to the replacement of defective parts only.

Items not covered under warranty terms under any conditions.

1. Damage due to failure to maintain the 12V lead acid battery as accurately described on various product warning stickers and the products owner's manual.
2. Damage due to maintenance or the actual damage caused by the lack of maintenance.
3. Damage due to improperly assembled products.
4. Damage due to climatic or environmental events, various cleaners and/or chemicals that may result in damage to the finish.

This warranty does not cover and is intended to exclude, any liability on the part of Hyper Toy Company. Whether under this warranty or implied by law or indirect or consequential damages for breach of warranty.

This warranty gives you specific legal rights. You may also have other rights that vary from state to state and province to province. In those states that do not allow the exclusion of implied warranties or limitation of incidental or consequential damages, the above limitations or exclusions may not apply to you. This warranty applies to the United States and Canada.

DON'T RETURN YOUR ELECTRIC SCOOTER TO THE STORE. Should you require service or assistance with your electric scooter during the warranty period, contact our trained technical staff at Hyper Toy Company 1-866-204-9737.

FOR ASSISTANCE WITH
YOUR ASSEMBLY CALL:
1-866-204-9737 TOLL FREE

[illegible]

Product Registration

Barbie

Note:

Activation of your warranty gives you FREE telephone and online technical service help. Please visit www.hypertoys.com to complete product registration and activate your warranty. You will need to provide the product serial number to complete registration. You will be able to find the product serial number on the underside of the electric scooter.

Hyper Toy Company

Customer Service Contact:

177 Malaga Park Dr.

Malaga, NJ 08328

Call Toll Free

1-866-204-9737

Monday-Friday 8:00AM to 5:00PM (CST)

For product related questions or customer service needs please email info@hypertoys.com

VISIT US ONLINE@

www.hypertoys.com



WARNING: USE AT YOUR OWN RISK. ADULT SUPERVISION IS REQUIRED

THIS IS A POWERFUL TOY AND IS NOT INTENDED FOR RIDERS UNDER THE AGE OF 8 YEARS OLD

Do not discard this owner's manual. Refer to the manual for important instructions before operating and to progress in skill.

No more than 1 rider at a time. Do not exceed 120 lbs (54kgs) rider weight.

Do not allow riders under the age of 8 years old to use this product. Adult supervision is required.

Always wear shoes and proper protective gear, such as ANSI, SNELL, or ASTM approved helmets. Elbow and knee pads are also recommended.

Battery life may be reduced in extreme temperatures or with a maximum weight load.

Use only in safe controlled areas, not on public streets, or near motorized vehicles.

Do not ride at night or in low visibility conditions.

Steep, rough, uneven, low traction or wet surfaces can increase risk to the rider.

Be sure to check local regulations to understand how and where it is allowed to use this product.

CONTAINS LEAD ACID BATTERY. MUST BE RECYCLED OR DISPOSED OF SAFELY.

FOR ASSISTANCE WITH
YOUR ASSEMBLY CALL:
1-866-204-9737 TOLL FREE