

Samsung Galaxy J7 **SAMSUNG**

INITIAL SETUP GUIDE



Consumer Cellular®

Thank you for choosing Consumer Cellular!

We know you're excited to use your new smartphone and this guide will help you get it set up as quickly as possible. Each section includes step-by-step instructions and pictures to help you through the setup process. If you would like to learn even more, we offer a wide variety of customer support options at the back of this guide, including information on our **HOW-TO VIDEOS** and ways to **CONTACT US**. We're always happy to help you!

We hope you enjoy your new Samsung Galaxy J7.

Need More Information?

Visit our website at **ConsumerCellular.com/Help**

Call us at **(800) 686-4460**

TABLE OF CONTENTS	
Introduction	2–3
Initial Setup	4–6
Google Account Setup	6-10
Screen Lock Security Setup	11–14
Easy Mode	14-16
Data Tips & Wi-Fi	16-22
Email Setup	23-29
My Consumer Cellular App	29-32
Facebook Setup	33
Quick Tips	34
How-To Videos & Contact Us	35



BEFORE YOU GET STARTED

Take a moment to familiarize yourself with your new smartphone's buttons and icons. You can refer back to this diagram as you read through this initial setup guide.

INITIAL SETUP

To begin, press the smartphone's **Power Button**, located along the top, right outer edge of the phone.



NOTE:



This is also the button that you will use to turn your phone off. Press and hold the power button for several seconds until a menu appears, and select Power Off. It's a good idea to leave your phone on most of the time. Your phone must be turned on to receive calls and text messages, and to check your battery. When your phone is turned off, all calls are automatically sent to voicemail.

Choose the language that you prefer.

Then press **Start**.

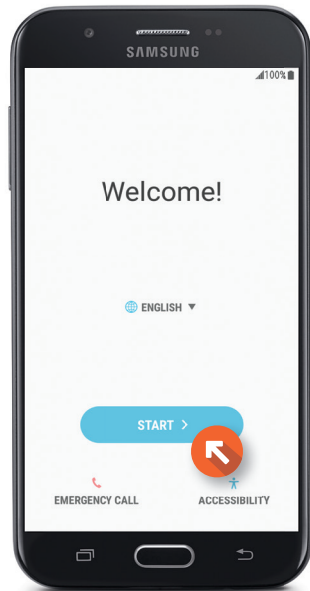

You will then be asked to select a Wi-Fi network.

Select your **Wi-Fi** network, then enter your password.

You can find more details about how to set up Wi-Fi on page 20.

We strongly suggest connecting to Wi-Fi to avoid excess data usage from your Connect Plan.

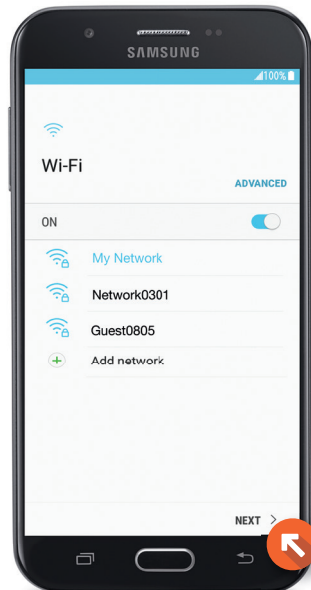

GOOGLE ACCOUNT SETUP

NOTE: if you skip Wi-Fi setup you will not have the opportunity to set up a Google account during the initial setup process.

Next you will be asked to review Samsung's terms and conditions. To continue, press **Next**.

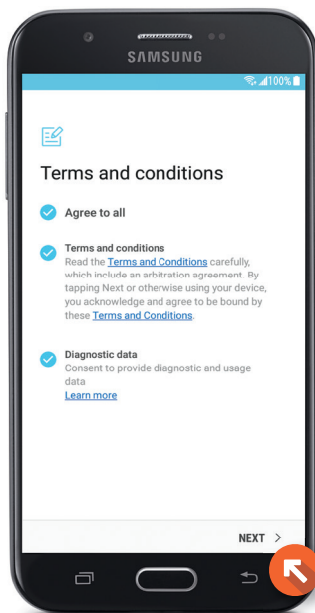

GOOGLE ACCOUNT

You will be asked to add your Google account if you have one. You will need a Google account to use many features of your smartphone, including Gmail and the Play Store.

If you already have a Google account or a Gmail address, enter it and press **Next**.

If you do not have a Google account, select **Or create a new account** to go through the account creation process described on pages 7–10.

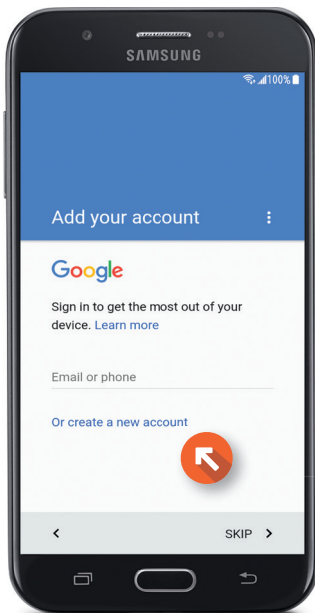

CREATING A GOOGLE ACCOUNT

Enter your first name by selecting the first line. A keyboard will appear. Type your first name, and then select the second line. Use the keyboard to enter your last name.

Then press **Next**.

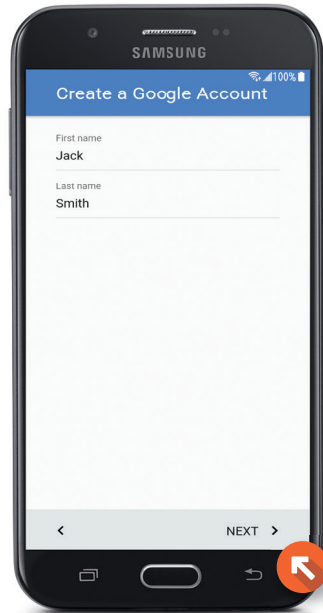

Enter additional Basic Information and press **Next**.

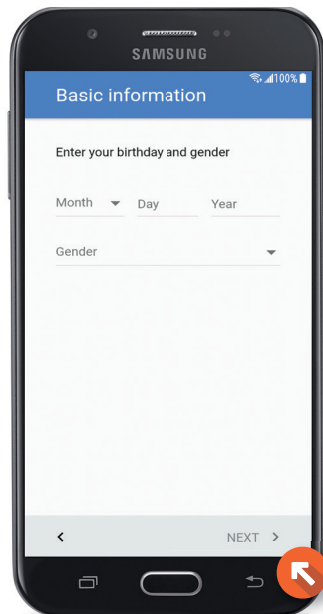

GOOGLE ACCOUNT SETUP

Google will now ask you to choose a user name. Select your user name, then press **Next**.

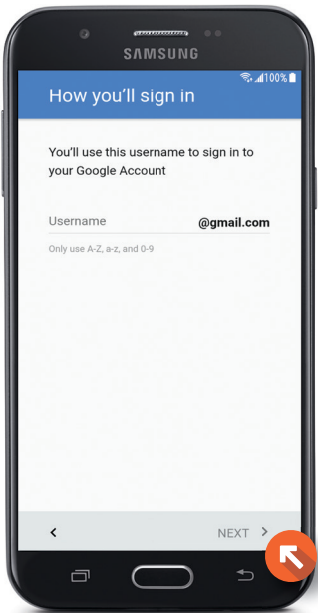

Next you will set a password.

Select the password line. Type your password, then re-type the password on the second line.

Then press **Next**.

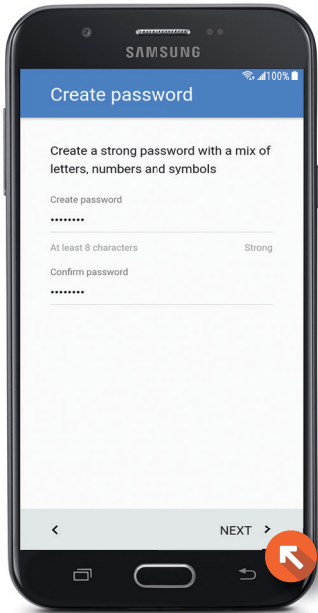

You can choose to enter your phone number to recover your account in case you forget your password.

Press **Next** if you would like to add the number shown on the screen, or press **Skip** if you choose not to. You can always add or remove this information later.

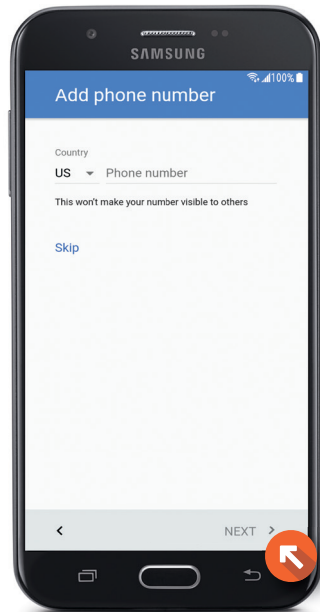

You will now be given the opportunity to review Google's Privacy Policy and Terms of Service.

To continue with the setup process, press **I Agree**.

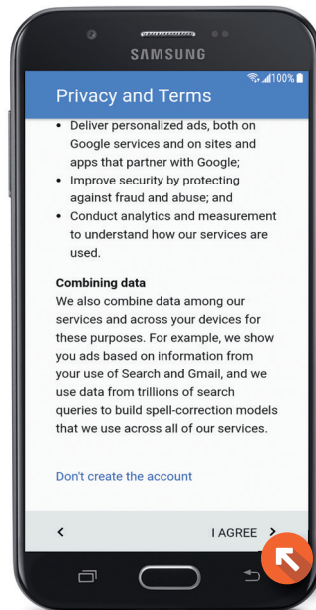

FINGERPRINT SECURITY SETUP

Google will now save your account. This may take a moment.

To finish the account setup, press **Next**.

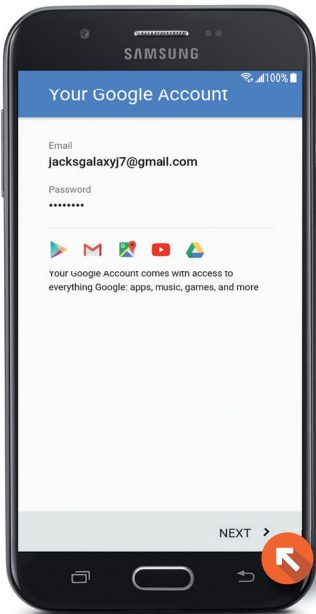

You will next see a list of additional Google services which are included on your phone. To disable any of them, slide the button to the left, then press **Next**.

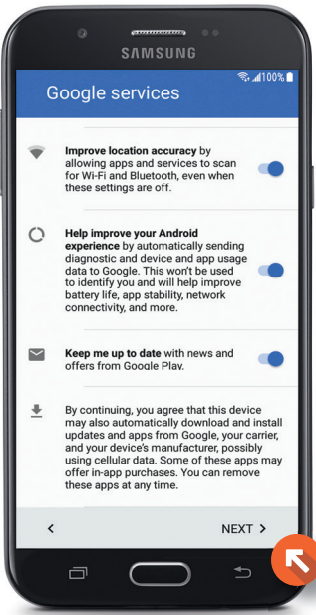

SCREEN LOCK SECURITY

Next you will be able to set up security to protect your phone from others using it without your permission.

We recommend selecting a **Pattern** to secure your phone.

Select Pattern, then press **Next**.

If you would like to skip this step for now and continue with the setup process, press **Not Now**.

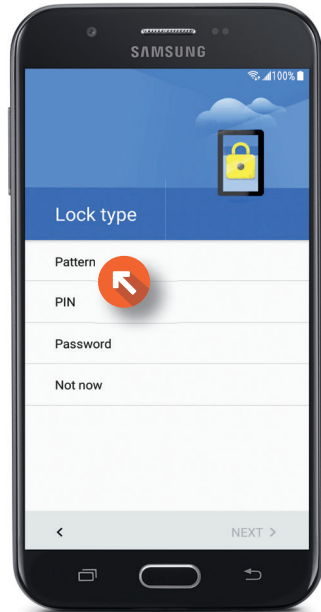

Choose the form of security you wish you wish to use for locking your screen.

The following pages will show you how to setup the **Pattern** option.

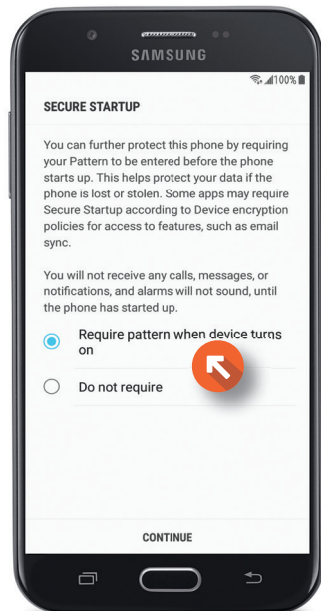

FINGERPRINT SECURITY SETUP

Use your finger to trace the pattern you wish to use to access your phone.

Then, press **Continue**.

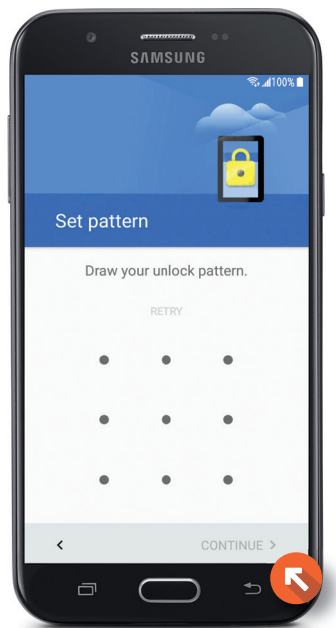

You will be shown the pattern you entered for confirmation.

You can either Retry, if you wish to enter a different pattern, or press **Continue**.

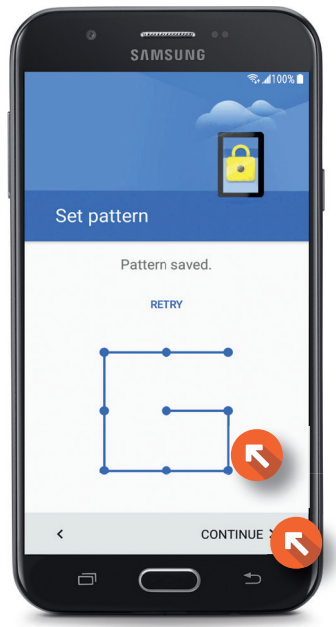

Choose how you prefer to receive notifications when your screen is locked.

Then, press **Done**.

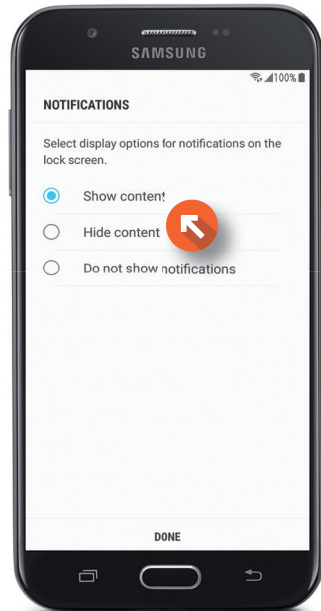

You will be asked to create a Samsung account to access additional apps on your phone.

We recommend skipping this step for now. You can create a Samsung account at any time after the initial setup process is complete.

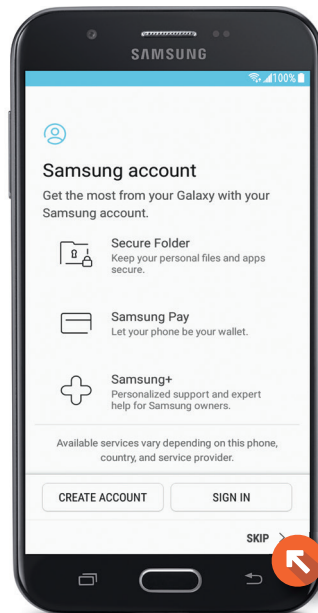

EASY MODE

Review additional setup options shown, then press **Finish**.

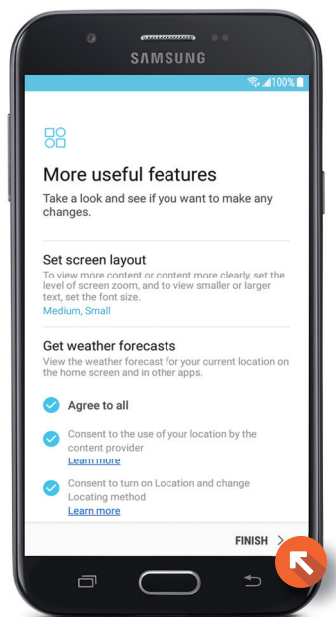

EASY MODE SETUP

Return to your Home Screen.

Then, press **Apps**.



Press **Settings**.

The following pages will show the steps to set up **Easy mode**.



Next, press **Advanced Features**.
Scroll down through the list shown until you reach **Easy mode**.

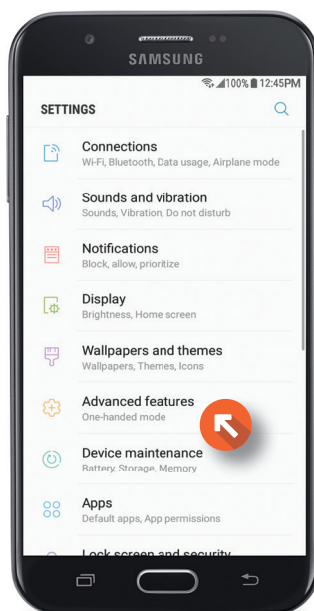

EASY MODE

Click on the **Easy mode** button to activate it.

With Easy mode, all of your apps and features are organized in a customizable, easy-to-use format.

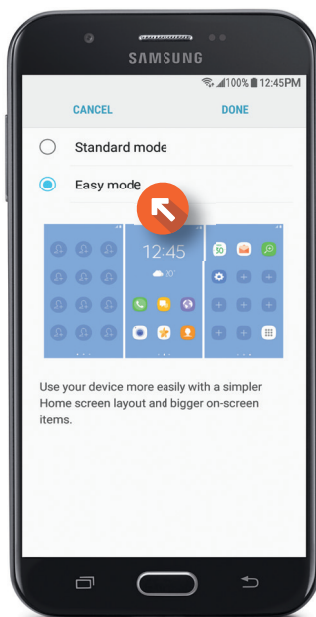

WI-FI & DATA SETUP

Return to your Home Screen.

Then, press **Apps**.



NOTE BEFORE USING DATA:

Your Samsung Galaxy J7 allows you to browse the Internet, access email and check social networking sites. It is important to remember, however, that these activities require data and impact your data usage for each billing cycle. It is recommended that you connect to a Wi-Fi network if you plan to stream video, audio or download large files. When you connect to Wi-Fi, you are not using data from your Consumer Cellular Connect Plan.

Press **Settings**.



Next, press **Connections**.

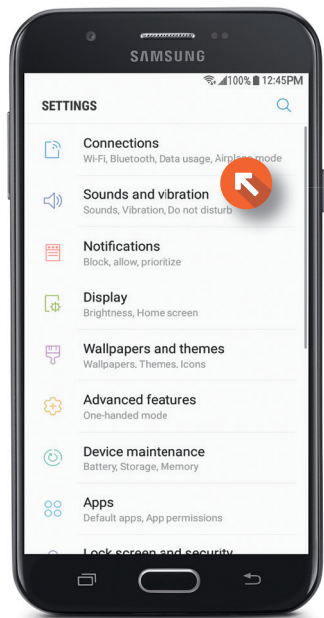

Press **Data usage**.

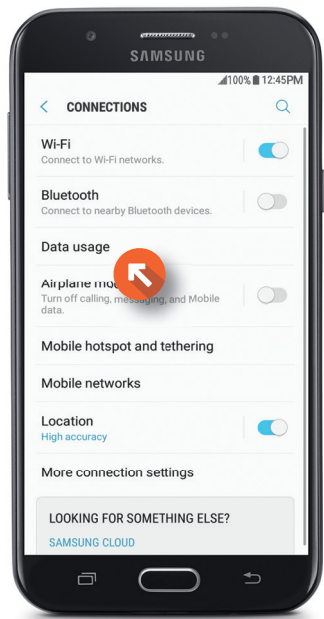

Press **Mobile data**.

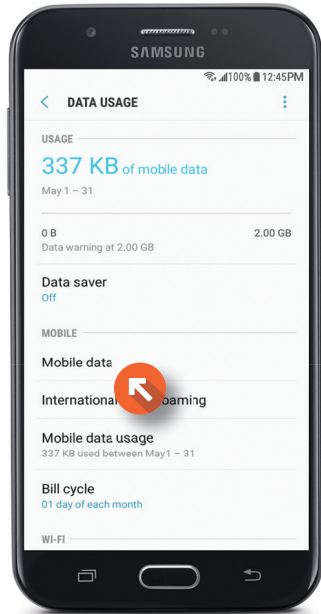

If you wish to turn mobile data off, click to uncheck next to **Mobile data**.

Then, press **Ok**.

Data will now be disabled.

To use data from your plan, turn data back on by clicking next to **Mobile data**.

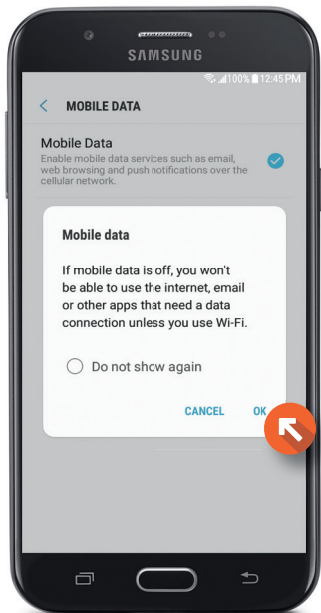

SETTING UP WI-FI

Return to the Settings menu, and press **Connections**.

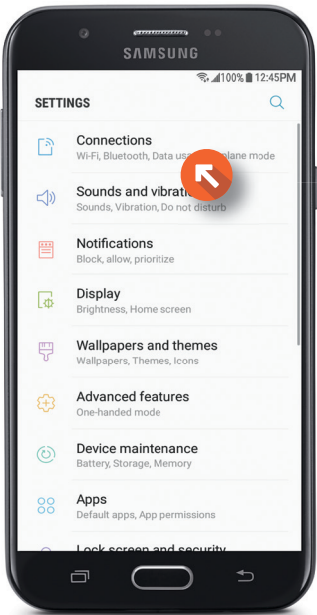

Then, press **Wi-Fi**.

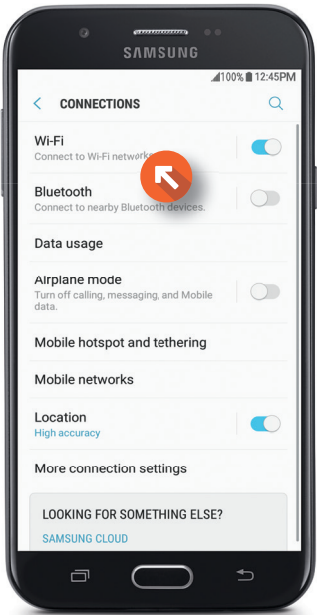

To turn on Wi-Fi, slide the Off button to the **right**.

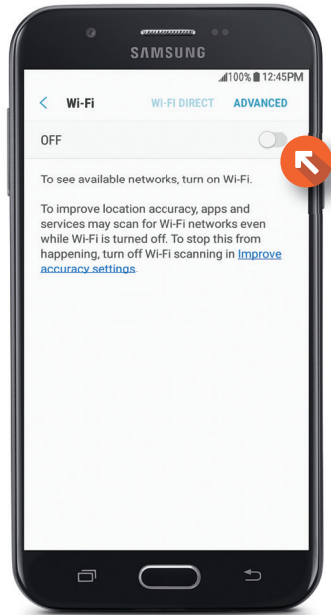

After a few moments you will see a list of available wireless networks. Secured networks will have a lock icon to the left of the network name

Select your **Wi-Fi** network.

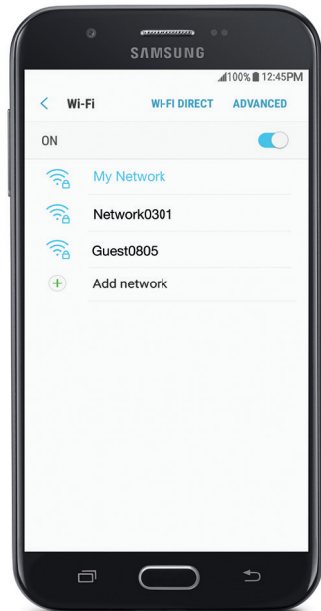

DATA TIPS & WI-FI

You will need to type in a password if your Wi-Fi network is secured.

Select the Password line and a keyboard will appear. Enter your password, then press **Connect**.

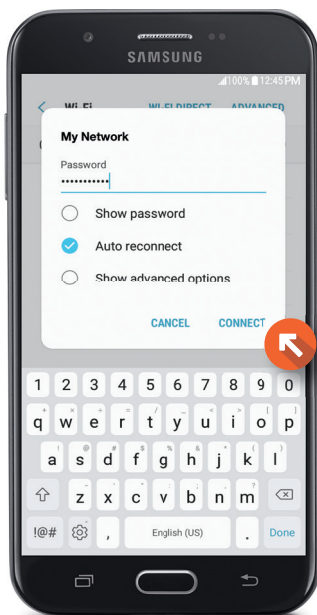

Once you are connected, a Wi-Fi icon will appear in the notification bar at the top of your screen.

When you are ready, press the **Home Button** to exit.

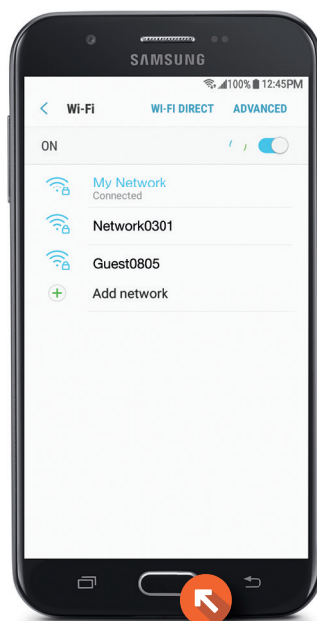

EMAIL SETUP**GMAIL**

To access email from an existing Gmail account, you will need to set up the Gmail app.

Press the **Gmail** folder icon on the home screen.



To continue with the setup process, press **the arrow on the right**.

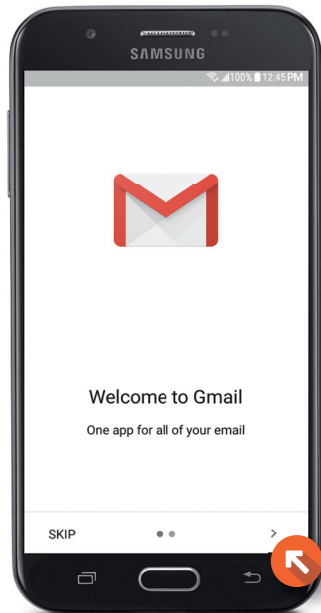

EMAIL SETUP

If you signed in to or created a Google account at the beginning of this guide, your Gmail address will automatically appear within the Gmail app.

Select the account you would like to access, and press **Take Me to Gmail.**

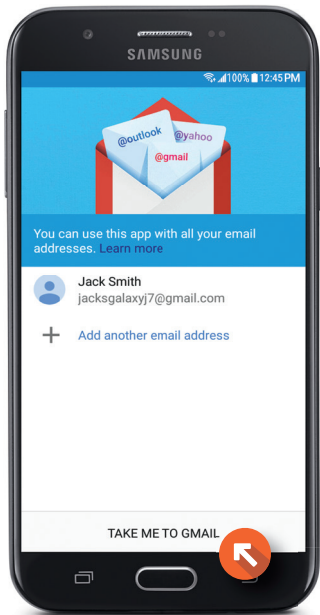

You will then be taken to your email inbox.

If you would like to change settings on your email account, you can do so using the **Menu** in the top, left corner.

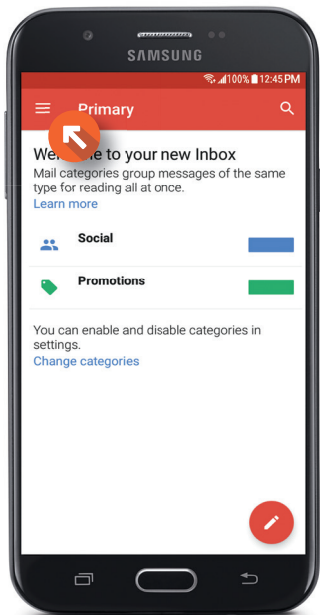

Scroll down to the bottom of the menu, and press **Settings**.

Here you can change the settings on your account. You can choose how your inbox is sorted, how you would like to be notified, and more.

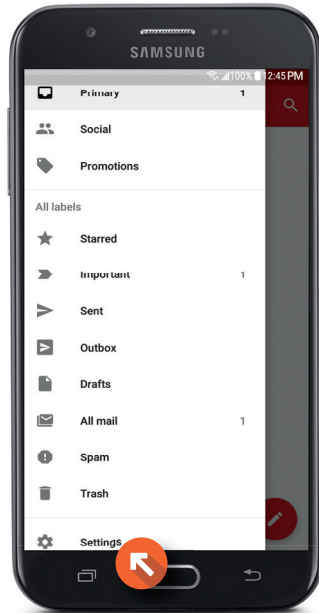

Once you have chosen your settings, press the **back arrow** in the top, left corner to return to the menu, or press the **Home Button** if you are ready to return to the home screen.

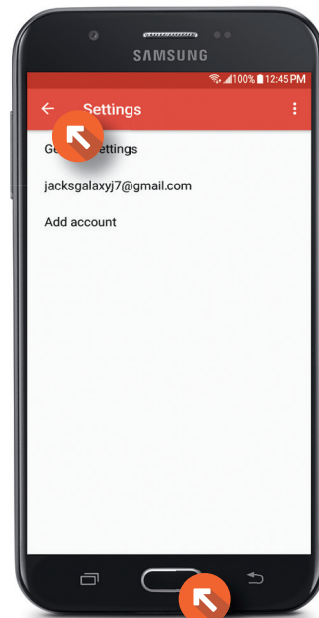

EMAIL SETUP

EMAIL SETUP

WITHOUT A GOOGLE ACCOUNT

If you do not have a Gmail account, you can still access, send and receive emails from your smartphone.

On the home screen, press **Email**.



You will be taken to the Set up account screen. To add an email address, press **Add New Account**.

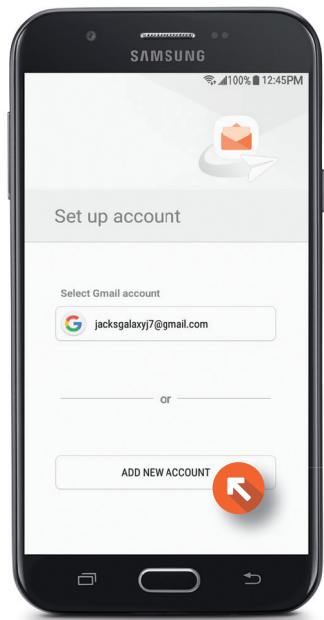

Enter the email address and password for the email account you would like to add, and press **Sign In**.

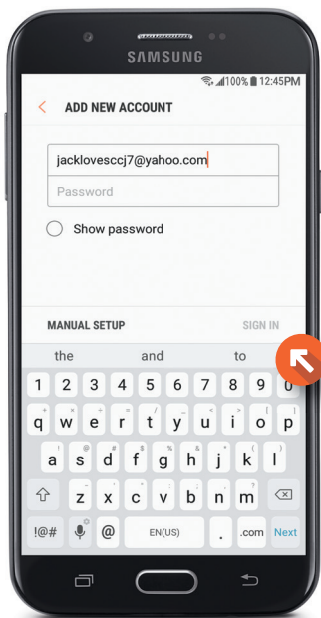

You will now be taken to your email sign-in. Enter your account information and press **Next**.

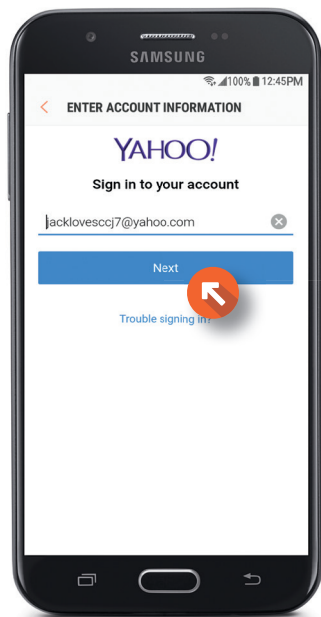

EMAIL SETUP

You will now be taken to your email inbox.

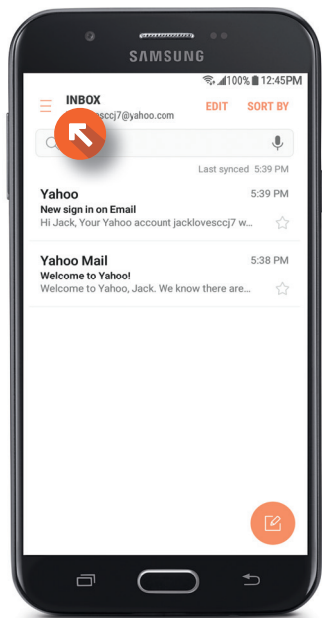

Press the “tool” icon shown to access your email settings.

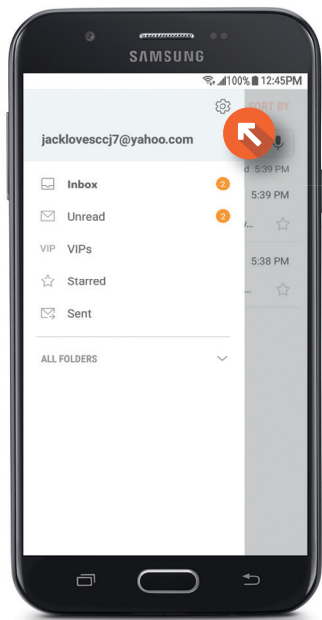

You have the option to setup or change your **Email Settings**.

You can choose how you want to receive notifications, manage spam, and more.

Once you have chosen your settings, press the **back arrow** in the top, left corner to return to the menu, or press the **Home Button** if you are ready to return to the home screen.

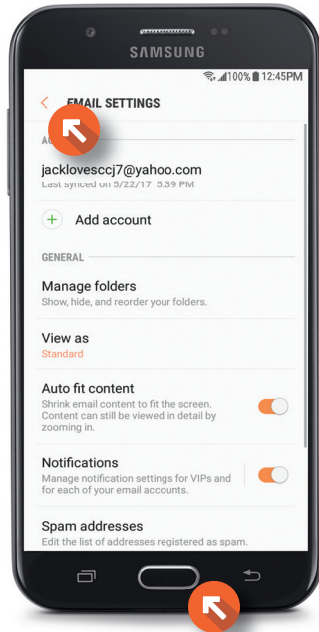

MY CC APP

The My Consumer Cellular app allows you to track your minutes, texts and data usage from the convenience of your smartphone. AARP members also have a scannable version of their AARP card within the app.

To download the My CC app, press the **Play Store** icon on the home screen.



MY CONSUMER CELLULAR APP

Press **Get Started** to continue.

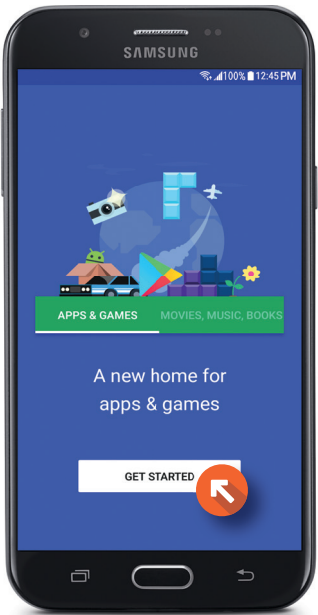

A keyboard will appear. Type in “My Consumer Cellular” and select **My Consumer Cellular** in the dropdown list that appears.

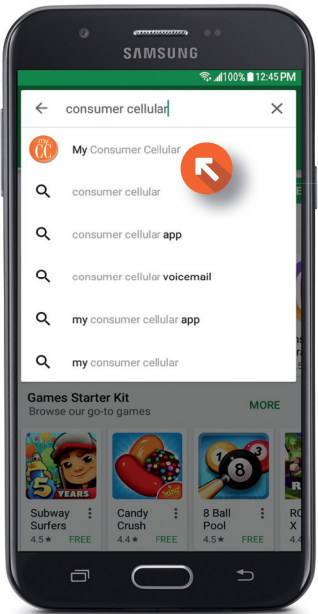

You will then be taken to the My Consumer Cellular app page.

To download the app, press **Install**.

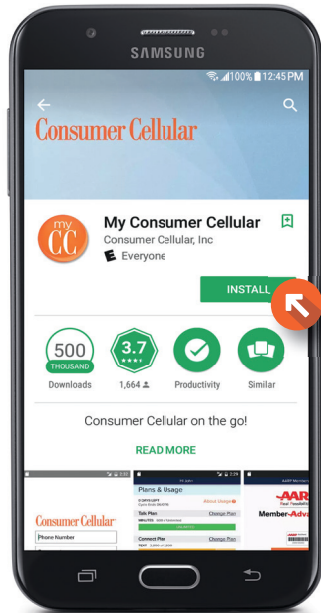

A menu will appear giving you the option of entering payment information for the future purchase of paid apps (not shown).

You may skip this step at this time, and enter the information later.

Once the app has finished downloading, press **Open**. You will then need to log in with your cellphone number and password (not shown).

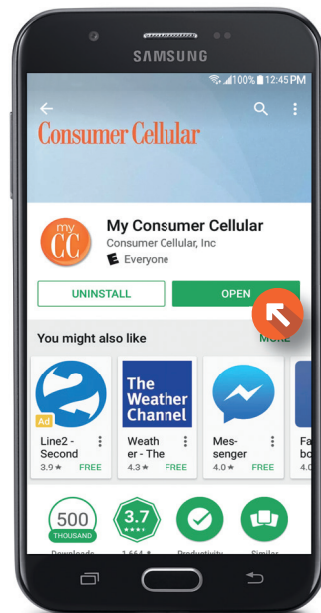

MY CONSUMER CELLULAR APP

The first screen that appears is your Usage Summary screen. Here you can track your minutes, texts and data usage as well as pay your bill. It's a good idea to check your usage throughout the month, especially if you plan to use data often.

Press **More** on the bottom right corner of the screen to see additional options.

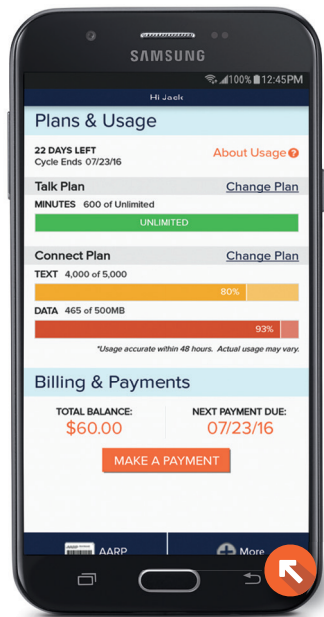

To exit the My CC app, press the **Home Button**.

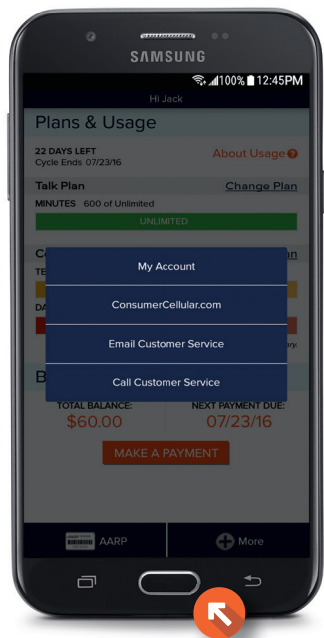

FACEBOOK SETUP

Facebook is pre-installed on your phone. To access it, press the Facebook icon on your .Apps screen.



You will then be taken to the Facebook log in screen.

To log in, you will need your Facebook credentials.

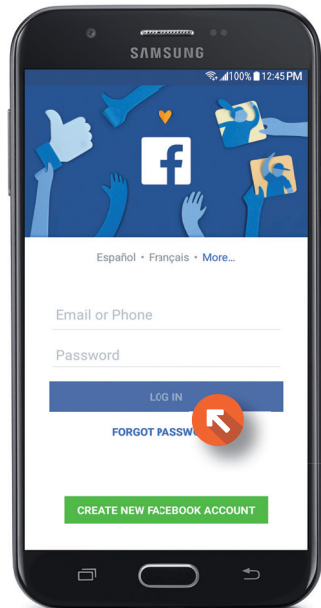

QUICK TIPS

QUICK TIPS

Now that your smartphone is set up and ready to go, you can follow these quick tips for some commonly used features.

MAKING A CALL

With your smartphone, you always need to dial the area code along with the seven digit number you're calling. However, you never need to dial a "1" first. It's OK if you do, but it's not necessary on a smartphone.

To make a call, press the **Phone** icon on the home screen. Dial the number you want to call and press the **Green Telephone Button** below the keypad.

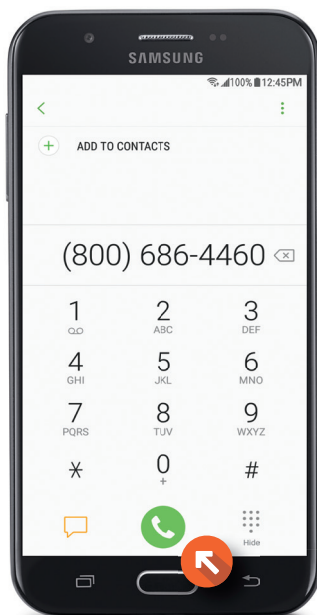

ENDING A CALL

When you are finished with a call, press the **Red Telephone Button** at the bottom of the screen. This will end the call as well as the billing for it.

Be sure to press this button when you are finished with every call to ensure you are no longer using minutes or being billed for the call.

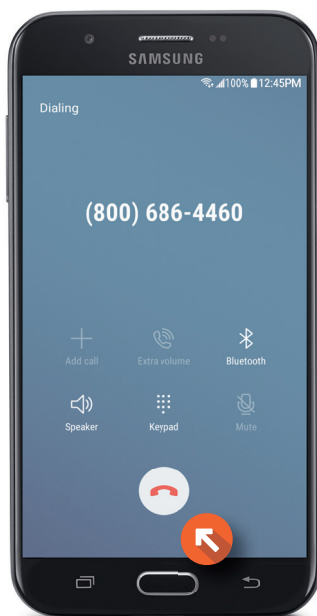



HOW-TO VIDEOS

Get to know your Samsung Galaxy J7 with our How-To Videos, located on our website at:

ConsumerCellular.com/SamsungGalaxyJ7

Here, you will find simple, easy-to-follow videos that cover topics such as adding to your smartphone's contact list, using Wi-Fi, turning data on or off, downloading apps from the Play Store and much more. You will find a list of videos by topic, as well as your smartphone's manual.



CONTACT US

If you have any questions or need any assistance troubleshooting your device, our friendly U.S. based customer support representatives will be happy to help you. You can reach us for free by calling us at: **(800) 686-4460**.

You can also go online to find answers to frequently asked questions by visiting:

ConsumerCellular.com/Help

Or, you can view your smartphone's manual at:

ConsumerCellular.com/SamsungGalaxyJ7

Consumer Cellular®

ConsumerCellular.com

© 2017 Consumer Cellular, Inc. Consumer Cellular and the Consumer Cellular logo are trademarks of Consumer Cellular, Inc.

Other company names, product names, and marks mentioned herein are property of their respective owners and may be trademarks or registered trademarks.