

# 10,000 mAh Portable Battery

## Quick Setup Guide

BE-MMB10K22K

**BEST BUY**  
**essentials**<sup>TM</sup>

Before using your new product, please read these instructions to prevent any damage.

## Package contents

- 10,000 mAh Portable Battery
- 1 ft. (.3 m) micro USB cable
- Quick Setup Guide

## Compatibility

- Compatible with most mobile devices, including iPhones.
- Use with a standard USB-A to Lightning cable for Apple devices or a standard USB-A to USB-C cable for Android devices.

## Features

- 10,000 mAh capacity charges smartphones, tablets, and more
- Slim design conveniently fits a pocket or purse
- USB ports (18 W total) recharge two devices at the same time
- QC 3.0 port for fast charging of compatible devices
- LED power indicators show your remaining battery level

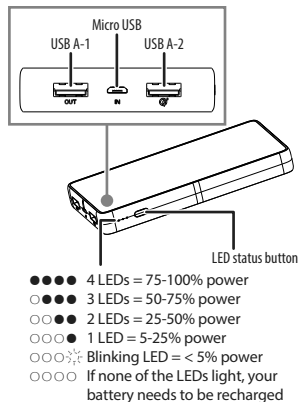

Press and hold the LED status button for three seconds to enter small charging current mode (<100 mA) to charge small current charging devices such as a Bluetooth earphone. Four LEDs blink one by one during this mode. ●○○○→○●○○→○○●○→○○○○ Your battery shuts down after two hours automatically. To exit this charging mode during the two hours, press and hold the button for three seconds.

## Charging your portable battery

Fully charge your portable battery before using it for the first time. Charging takes about six and a half hours.

- 1 Plug the small end of the included USB cable into your battery's USB IN port.
  - 2 Plug the other end into a standard USB port on your computer, car charger, or wall charger (not included). Your portable battery automatically begins charging and the LED turns on.
- Note:** All four LEDs turn on when your portable battery is fully charged.

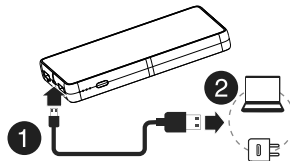

## Charging your devices

**Note:** You can charge two devices simultaneously.

- 1 Plug the large end of your phone's charging USB cable into one of your battery's USB ports. (Cable not included)  
**Note:** For the best performance, connect your device to the  (QC 3.0) port for faster charging (on compatible devices).
- 2 Plug the other end into your device. Your portable battery automatically begins charging your device.  
**WARNING:** Do not charge devices while your portable battery is recharging.  
**Note:** Use with a standard USB-A to Lightning cable for Apple devices or a standard USB-A to USB-C cable for Android devices.

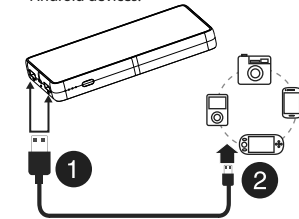

## Specifications

- **Dimensions (H × W × D):** 5.5 × 2.8 × 0.6 in. (14 × 7 × 1.6 cm)
- **Input:** Micro USB 5 V/2 A
- **Output:** USB A-1: 5 V/2.4 A  
USB A-2: 5 V/3 A; 9 V/2 A; 12 V/1.5 A (QC 3.0)
- **Total output:** 18 W
- **Built-in cell capacity:** 10,000 mAh, 3.7 V (37 Wh)
- **Power bank capacity:** 6,000 mAh (5 V/2.4 A)  
5,950 mAh (5 V/3 A)  
3,100 mAh (9 V/2 A)  
2,300 mAh (12 V/1.5 A)

Power bank capacity will be less than built-in cell capacity. Performance will vary based on settings and environmental conditions, and will decrease over time and with use.

## Safety information

- Do not expose your portable battery to heat, fire, or water.
- Do not modify, disassemble, open, drop, crush, puncture, or shred the internal battery.
- This is not a toy. Young children should be supervised to make sure that they do not play with the portable battery.
- Do not charge devices while the portable battery is recharging.
- Recharge the portable battery if it has not been used for more than 90 days.
- Risk of fires and burns. Do not open, crush, heat above 140° F (60° C), or incinerate. Follow the manufacturer's instructions.
- Operating environment temperatures:  
32 ~ 104° F (0 ~ 40° C)

This product is safe for regular use under normal conditions. As with any device using electrical power, some situations may be unsafe and injuries or damages could result. To minimize or avoid unsafe conditions, read and follow the instructions before using.

## Warning

When using this product, basic precautions should always be followed, including the following:

- 1 Read all the instructions before using the product.
- 2 To reduce the risk of injury, close supervision is necessary when the product is used near children.
- 3 Do not put fingers or hands into the product.
- 4 Do not expose the battery to liquids.
- 6 Do not use the battery in excess of its output rating. Overloaded outputs above that rating may result in a risk of fire or injury to persons.
- 7 Do not use a battery that is damaged or modified. Damaged or modified batteries may exhibit unpredictable behavior, resulting in fire, explosion, or risk of injury.
- 8 Do not disassemble the battery. Take it to a qualified service person when service or repair is required. Incorrect reassembly may result in a risk of injury to persons.
- 9 Do not expose a battery to fire or excessive temperature. Exposure to fire or temperature above 212° F (100° C) may cause an explosion.
- 10 Have servicing performed by a qualified repair person using only identical replacement parts. This will ensure that the safety of the product is maintained.

## Legal notices

### **Declaration of Conformity:**

Brand name/model number:

Best Buy essentials BE-MMB10K22K

This device complies with Part 15 of the FCC Rules.

Operation is subject to the following two conditions:

- (1) this device may not cause harmful interference, and
- (2) this device must accept any interference received, including interference that may cause undesired operation.

Suppliers Name: Best Buy Purchasing, LLC. Suppliers

Address (USA): 7601 Penn Ave South, Richfield, MN 55423

U.S.A. Suppliers phone number: 1-877-467-4289.

### **FCC Caution:**

Changes or modifications not expressly approved by the party responsible for compliance could void the user's authority to operate the equipment.

### **FCC Statement:**

**Note:** This equipment has been tested and found to comply with the limits for a Class B digital device, pursuant to Part 15 of the FCC Rules. These limits are designed to provide reasonable protection against harmful interference in a residential installation.

This equipment generates, uses, and can radiate radio frequency energy and, if not installed and used in accordance with the instructions, may cause harmful interference to radio communications. However, there is no guarantee that interference will not occur in a particular installation. If this equipment does cause harmful interference to radio or television reception, which can be determined by turning the equipment off and on, the user is encouraged to try and correct the interference by one or more of the following measures:

- Reorient or relocate the receiving antenna.
- Increase the separation between the equipment and receiver.
- Connect the equipment into an outlet on a circuit different from that to which the receiver is connected.
- Consult the dealer or an experienced technician for help.

### **ICES Statement**

CAN ICES-3(B)/NMB-3(B)

## One-year limited warranty

Visit

[www.bestbuy.com/bestbuyessentials](http://www.bestbuy.com/bestbuyessentials) for details.

## Contact Best Buy essentials

For customer service, call

866-597-8427 (U.S. and Canada)

[www.bestbuy.com/bestbuyessentials](http://www.bestbuy.com/bestbuyessentials)

Best Buy essentials is a trademark of Best Buy and its affiliated companies.

Distributed by Best Buy Purchasing, LLC

7601 Penn Ave South, Richfield, MN 55423 U.S.A.

©2021 Best Buy. All rights reserved.