

S I.® ZERO EDGE PRO



Owner's Manual



INSTALLERS: PLEASE BE SURE TO LEAVE THIS
MANUAL WITH THE OWNER. THANK YOU!

• "APPLY S/N" •
• "STICKER HERE" •



LIMITED ONE YEAR WARRANTY ON SCREEN INNOVATIONS PRODUCTS

Screen Innovations warrants its products, to the original purchaser only, to be free from defects in materials and workmanship for a period of one (1) year from the date of purchase by the original purchaser provided they are properly operated according to Screen Innovations' instructions and are not damaged due to improper handling or treatment after shipment from the factory.

This warranty does not apply to equipment showing evidence of misuse, abuse, or accidental damage, or which has been tampered with or repaired by a person other than authorized Screen Innovations personnel.

Screen Innovations' sole obligation under this warranty shall be to repair or to replace (at Screen Innovations' option) the defective part of the merchandise. Returns for service should be made to your Screen Innovations' dealer. If it is necessary for the dealer to return the screen or part to Screen Innovations, transportation expenses to and from Screen Innovations are payable by the purchaser and Screen Innovations is not responsible for damage in shipment. To protect yourself against damage or loss in transit, insure the product and prepay all transportation expenses.

THIS WARRANTY IS IN LIEU OF ALL OTHER WARRANTIES, EXPRESS OR IMPLIED, INCLUDING WARRANTIES AS TO FITNESS FOR USE AND MERCHANT ABILITY. Any implied warranties of fitness for use, or merchantability, that may be mandated by statute or rule of law are limited to the one (1) year warranty period. This warranty gives you specific legal rights, and you may also have other rights, which vary from state-to-state. NO LIABILITY IS ASSUMED FOR EXPENSES OR DAMAGES RESULTING FROM INTERRUPTION IN OPERATION OF EQUIPMENT, OR FOR INCIDENTAL, DIRECT, OR CONSEQUENTIAL DAMAGES OF ANY NATURE.

In the event that there is a defect in materials or workmanship of a Screen Innovations product, you may contact our Sales Partners at 9715-B Burnet Road Suite 400, Austin, TX 78758, (512) 832-6939.

IMPORTANT: THIS WARRANTY SHALL NOT BE VALID AND SCREEN INNOVATIONS SHALL NOT BE BOUND BY THIS WARRANTY IF THE PRODUCT IS NOT OPERATED IN ACCORDANCE WITH SCREEN INNOVATIONS' WRITTEN INSTRUCTIONS.

Keep your sales receipt to prove the date of purchase and your original ownership.

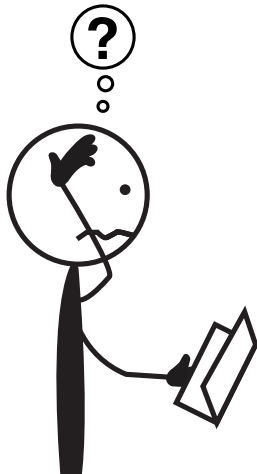
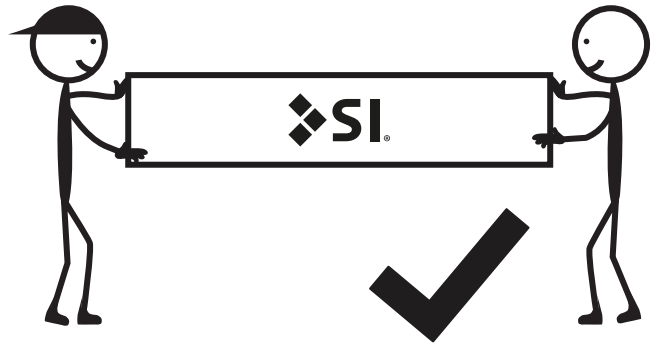
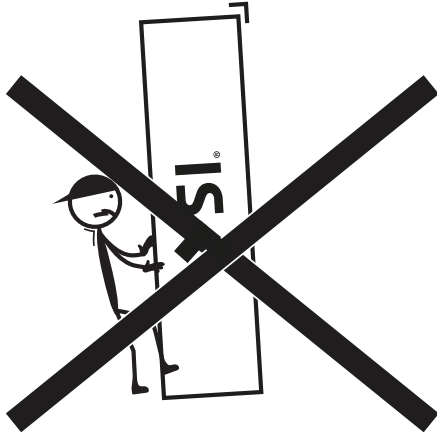

512-832-6939

9715-B Burnet Road Suite 400, Austin, TX 78758

SCREENINNOVATIONS.COM

Table of Contents

SUGGESTED PROJECTOR PLACEMENT	5
STANDARD FRAME PARTS LIST	7
STANDARD FRAME ASSEMBLY.....	9
SPLIT FRAME PARTS LIST	12
SPLIT FRAME ASSEMBLY.....	14
LED LIGHTS ATTACHMENT	18
BLACK DIAMOND OR SHORT THROW ATTACHMENT	21
SLATE OR PURE ATTACHMENT	25
BLACK BACKER ATTACHMENT	28
MAESTRO ATTACHMENT.....	29
BLACK BACKER ATTACHMENT	32
SMALL TRIM ATTACHMENT	34
MEDIUM OR LARGE TRIM ATTACHMENT.....	36
LOGO ATTACHMENT.....	38
TRIM REMOVAL	39
WALL INSTALLATION	41
FLOWN INSTALLATION.....	43
IR LIGHTING HEX CODES	45
IP CONTROLLED LIGHTING SETUP	46

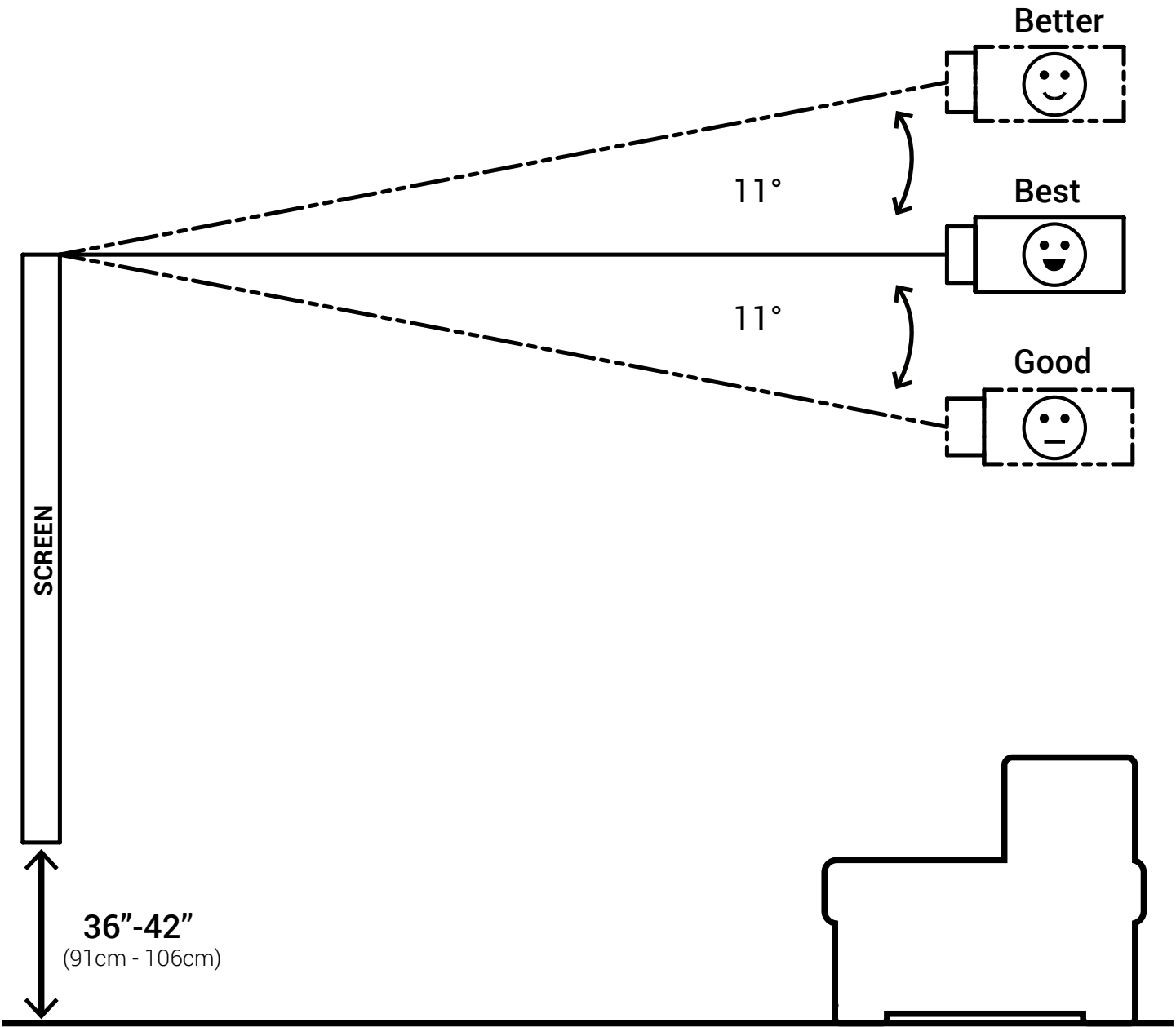

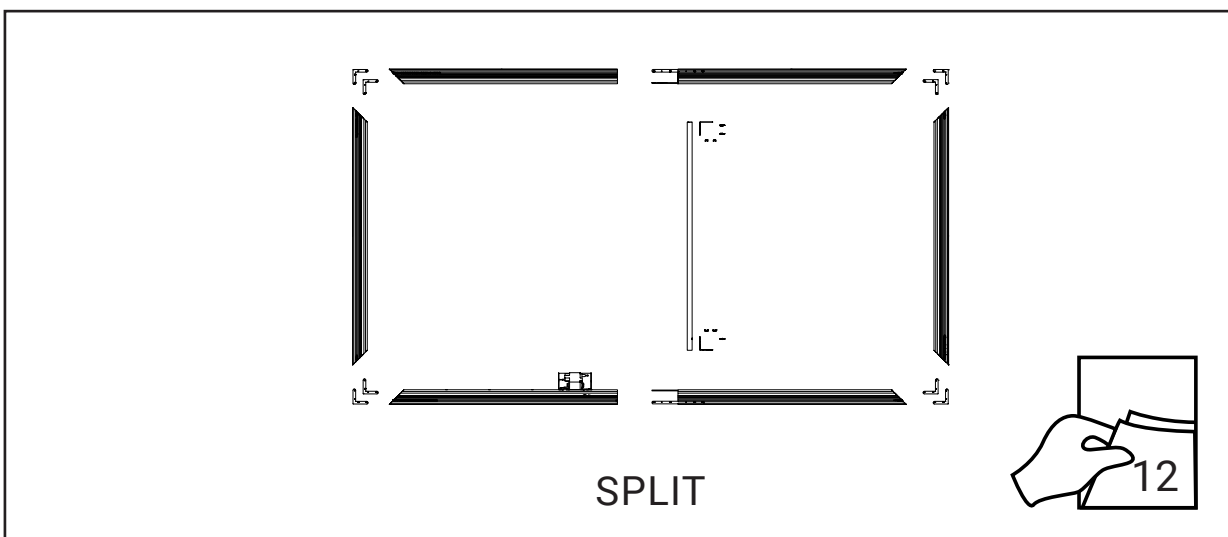
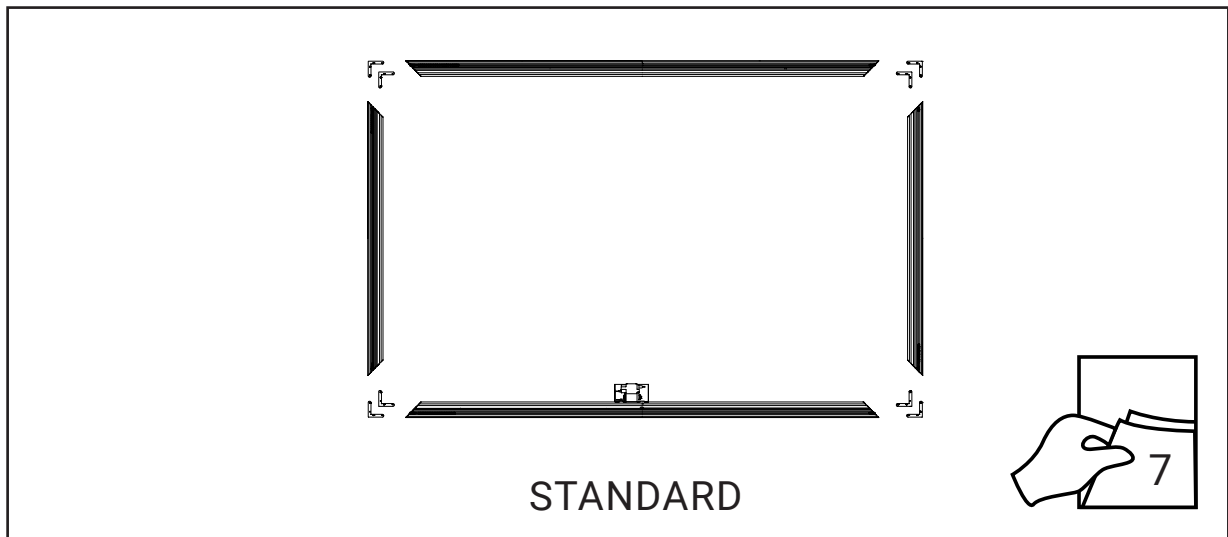
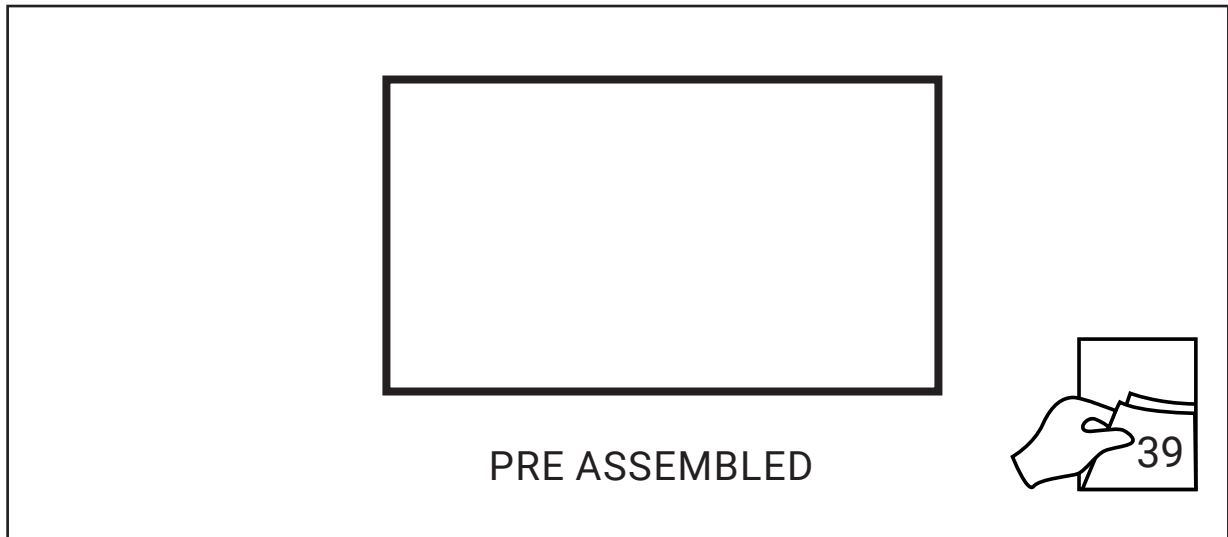

STANDARD FRAME PARTS LIST

(LED Lights Only)

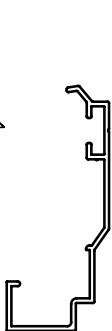
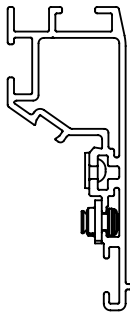
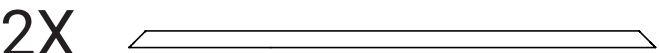
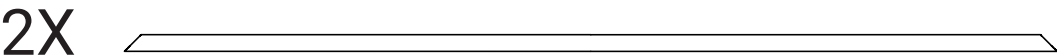
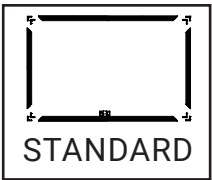

1/2" Small trim option

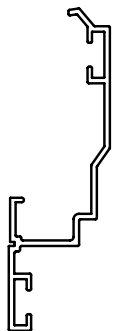

1 1/2" or 2" trim option

Hardware Kit

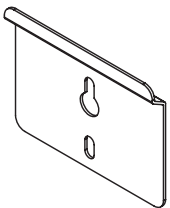

Wall Brackets

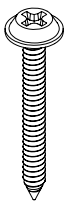

Mounting
Screws

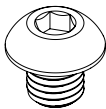

4X
1/4-20 x 1/4"
Screws
(Small trim only)

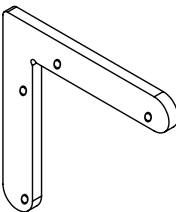

4X Thick Corner
Brackets

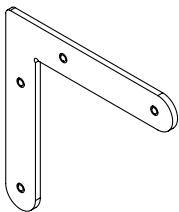

4X Thin Corner
Brackets

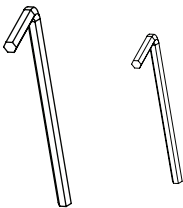

1/8" & 5/32"
Hex Keys

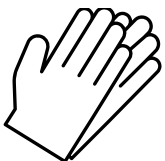

4X Gloves

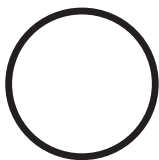

Bungees
(Maestro only)

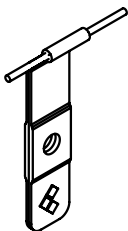

SI Attachment Bands
(Black Diamond and Short
Throw Only)

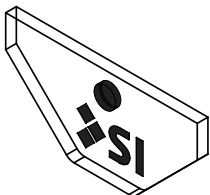

Acrylic Logo

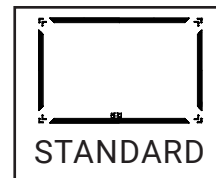

If IP controlled LED lights are ordered, Phillips Hue hub must be purchased and set up separately. See page 46 for IP lighting Instructions.

LED IR Controlled Only



LED Remote

Flying Mount Only

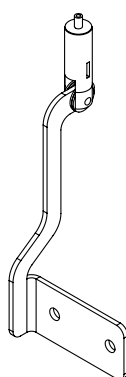

2X Flown Screen
Mount

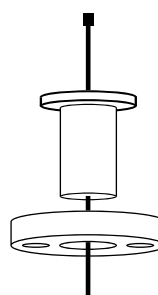

2X Flown Ceiling
Mount

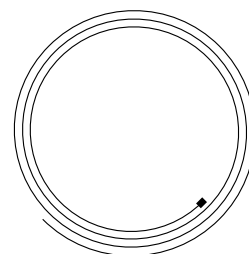

2X Flown
Cable

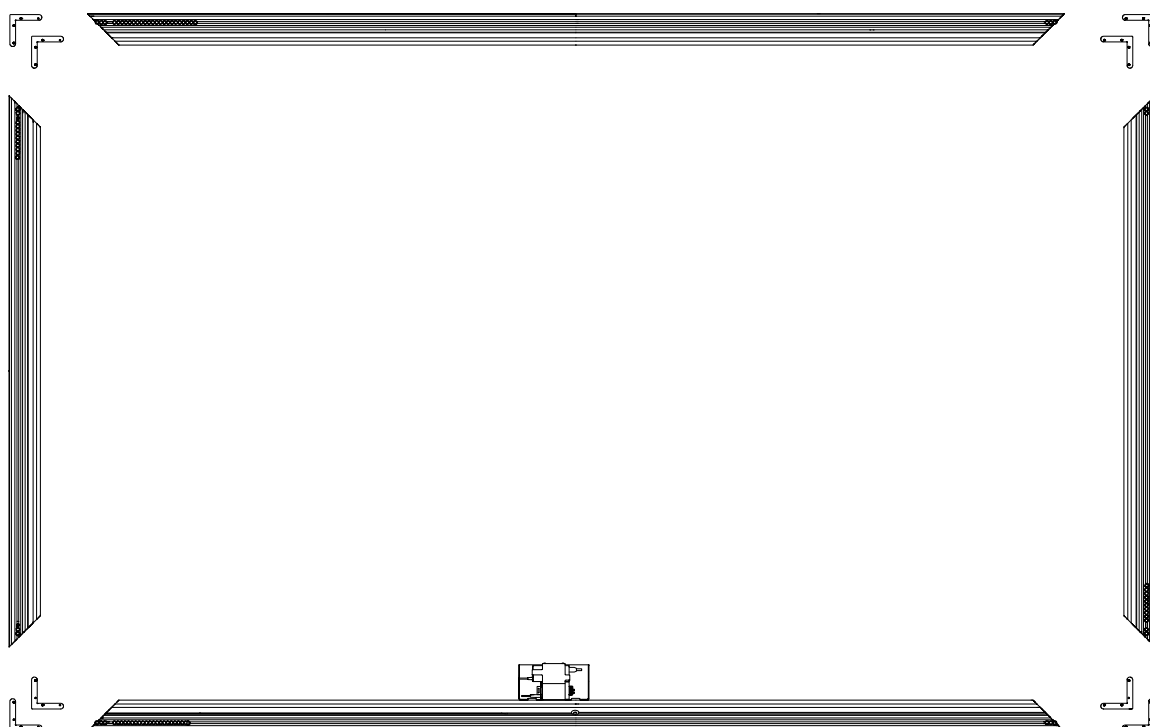

STANDARD FRAME ASSEMBLY

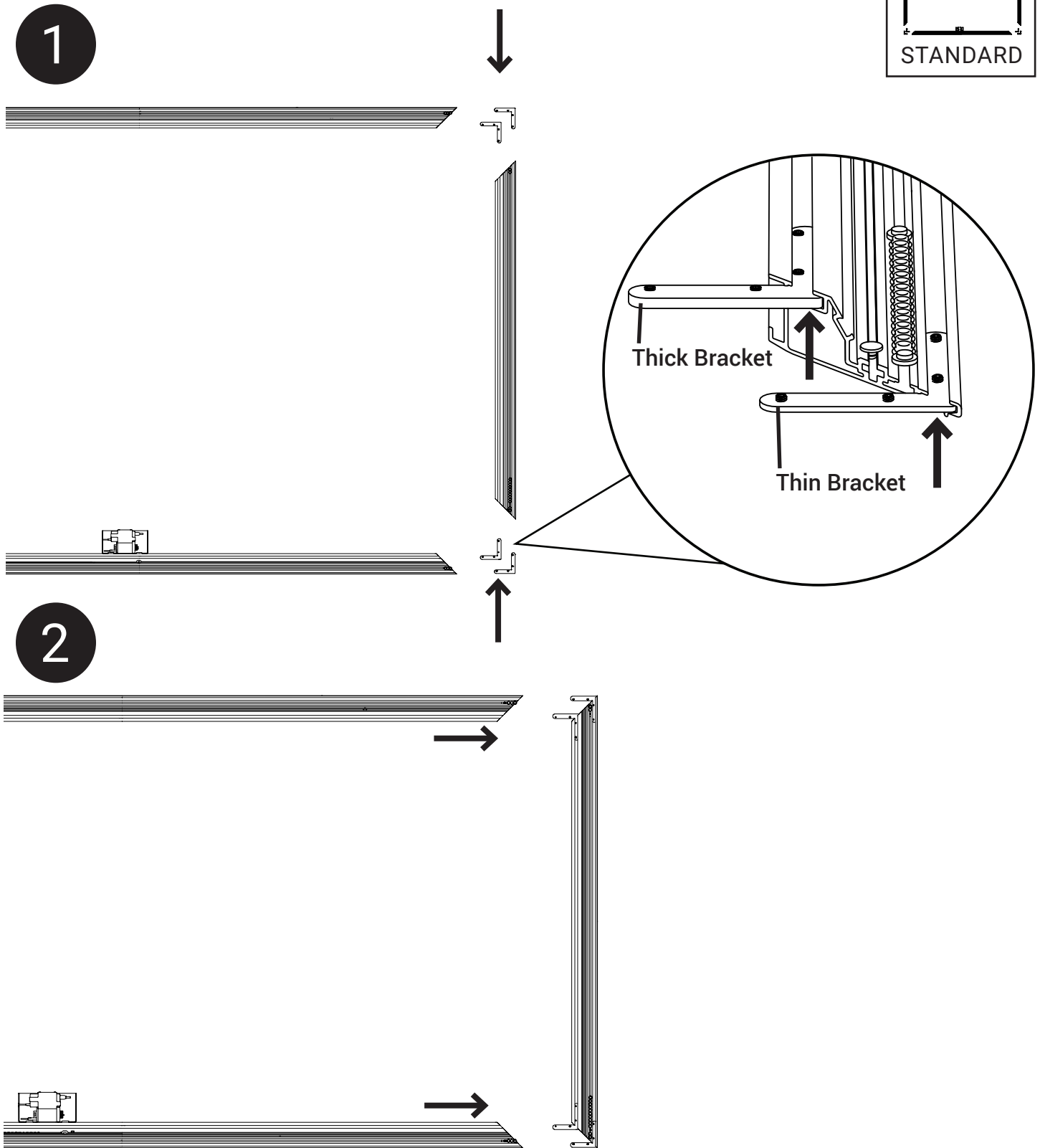
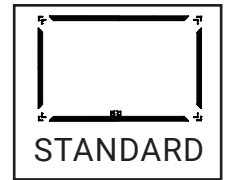

Insert the thin corner brackets into the outside channels and the thick corner brackets into the inside channels of the vertical frames. Then slide into the channels in the horizontal frames.



NOTE: If using AT or Maestro material then check to make sure the channel nuts are installed in the inner channel before proceeding.

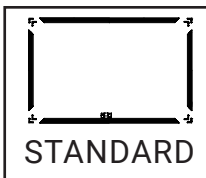

3

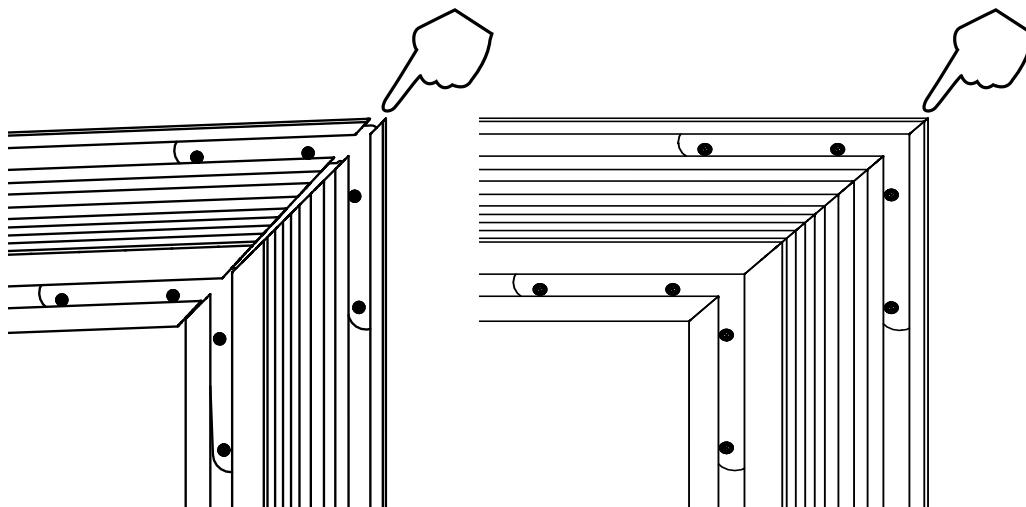

4

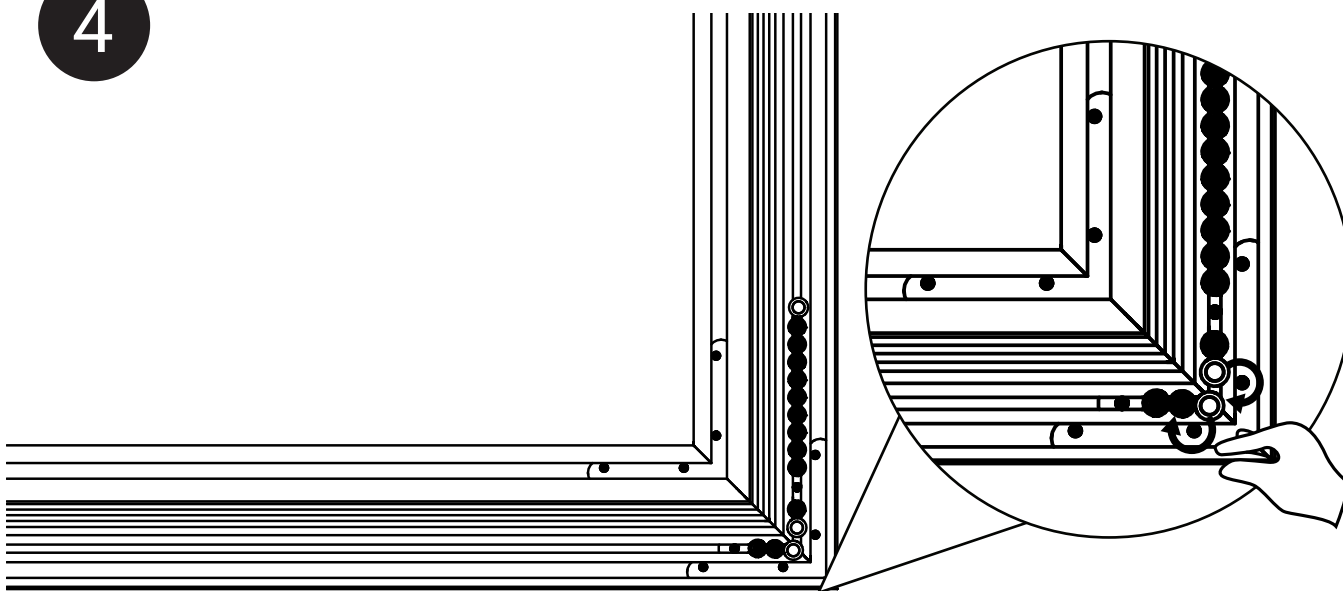

Make sure the points on the frame pieces line up. Then finger tighten 2 of the set screws to lock in the corners.

5

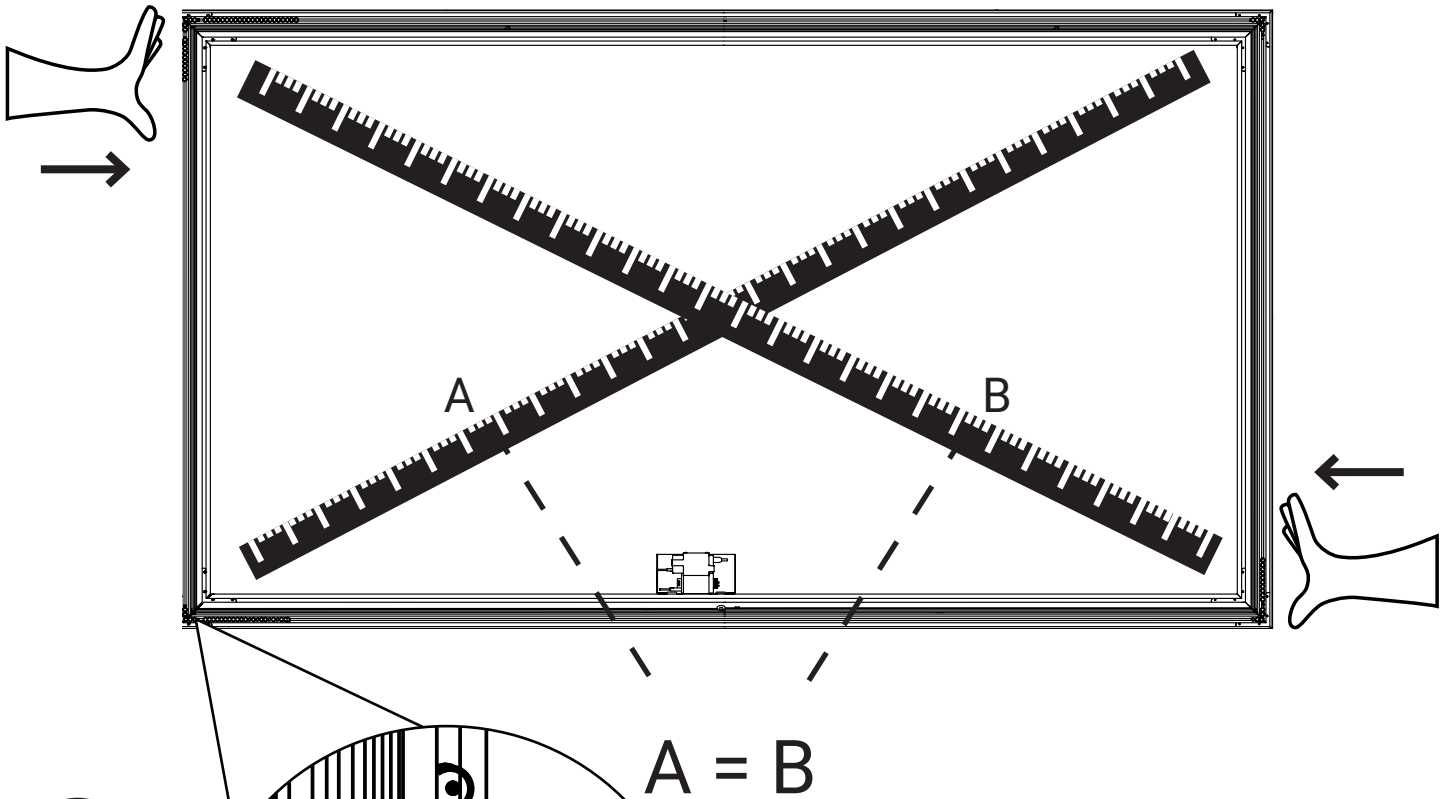
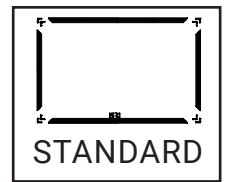
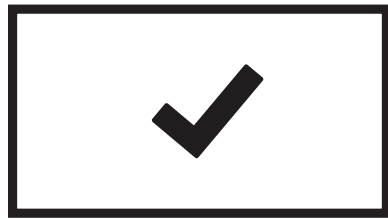
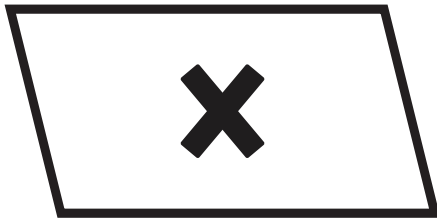

6

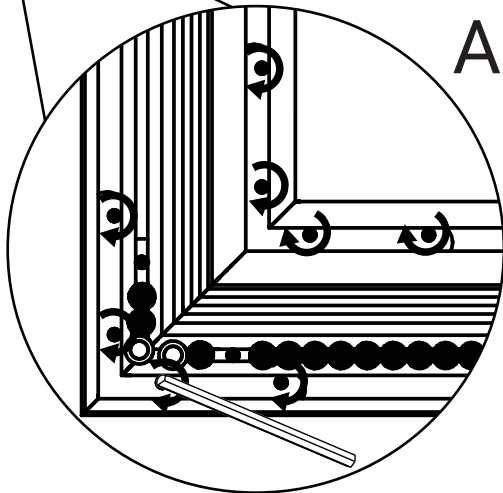

Measure the diagonals to check if frame is square. If one diagonal is longer then push on the corners at that diagonal. Tighten all set screws once the diagonals are equal to within 1/8".

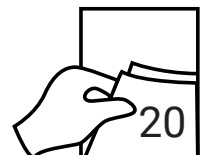
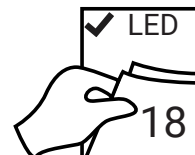

SPLIT FRAME PARTS LIST

(LED Lights Only)

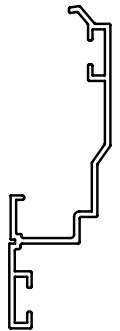
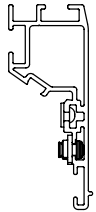
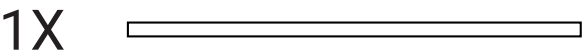
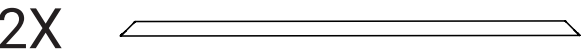
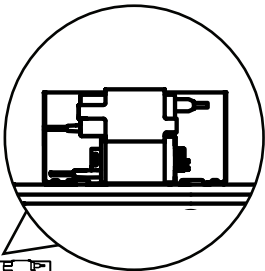
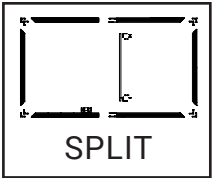

1/2" Small trim
option

1 1/2" or 2"
Trim option

Hardware Kit

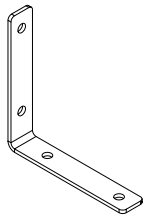
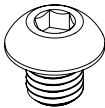
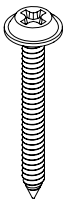
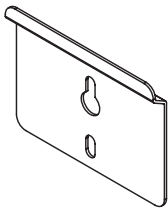

Wall Brackets

Mounting
Screws

12X
1/4-20 x 1/4"
Screws
(Small Trim Only)

4X
1/4-20 Wing nuts

4X
1/4-20 Thumb
Screws

2X Vertical
Support
Brackets

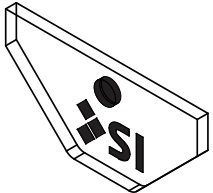
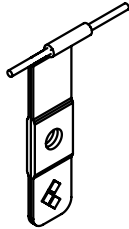
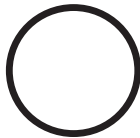
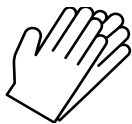
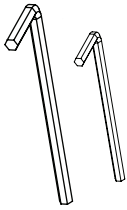
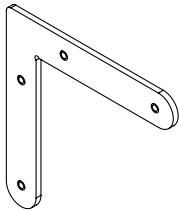
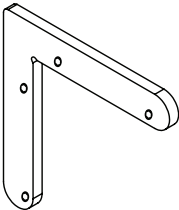

4X Thick Corner
Brackets

4X Thin Corner
Brackets

1/8" & 5/32" or
3/32" Hex Keys

4X Gloves

Bungees
(Maestro only)

SI Attachment
Bands
(Black Diamond and
Short Throw Only)

Acrylic Logo

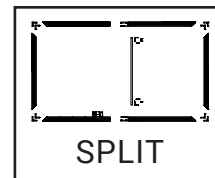

If IP controlled LED lights are ordered, Phillips Hue hub must be purchased and set up separately, see page 46 for IP lighting Instructions.

LED IR Controlled Only



LED Remote

Flying Mount Only

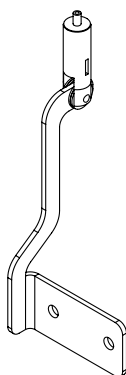

2X Flown Screen
Mount

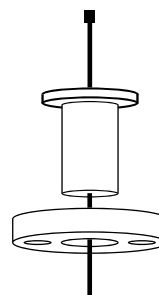

2X Flown Ceiling
Mount

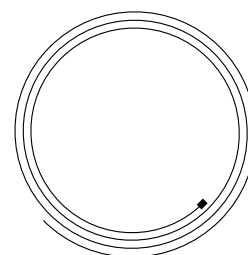

2X Flown
Cable

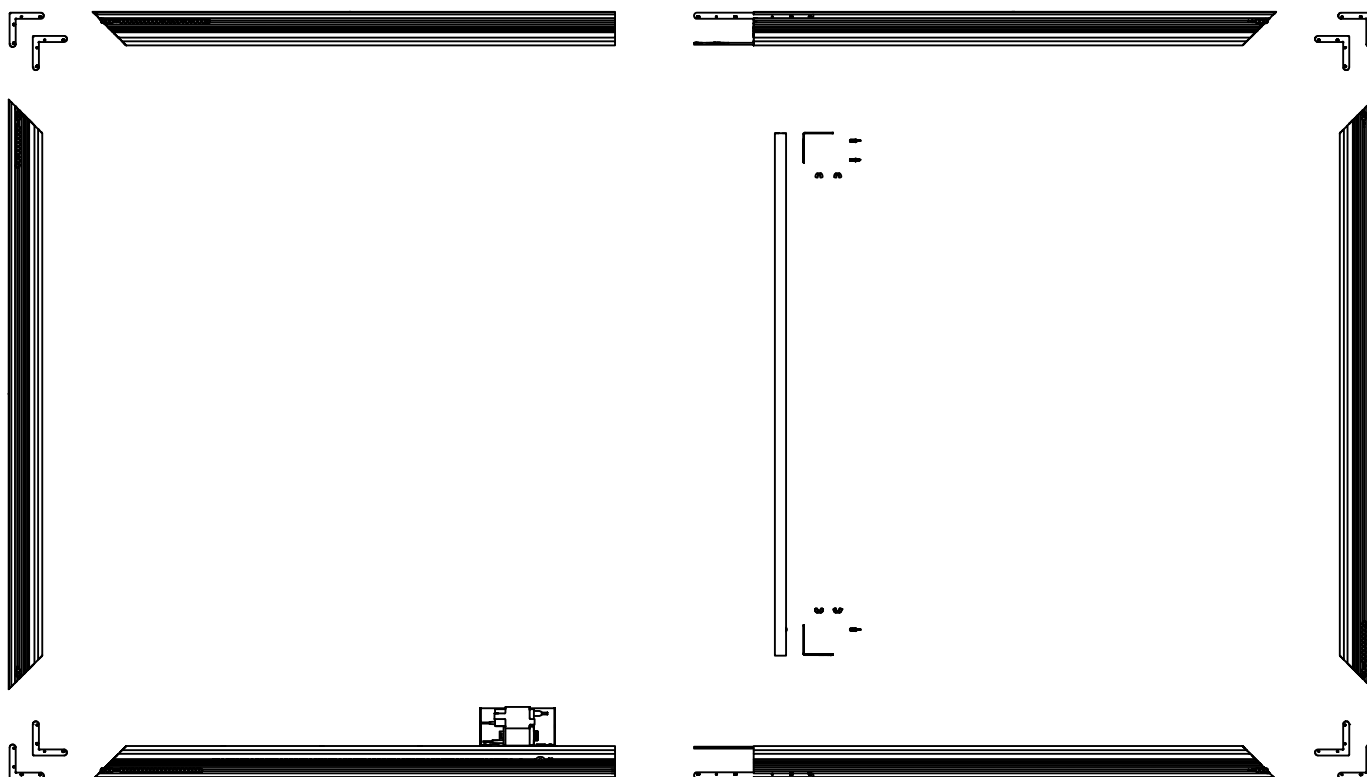

SPLIT FRAME ASSEMBLY

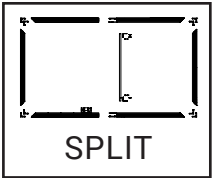

1

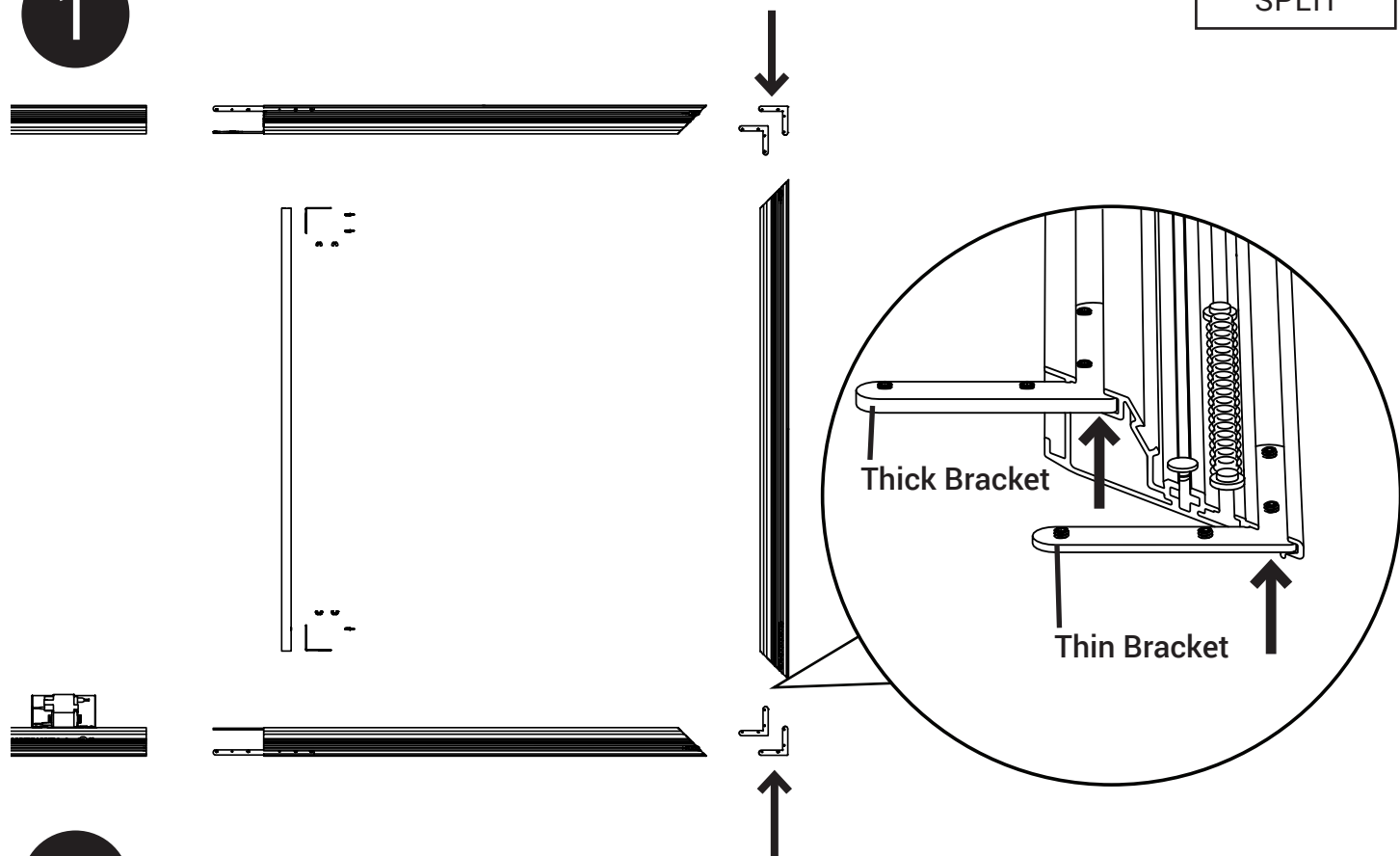

2

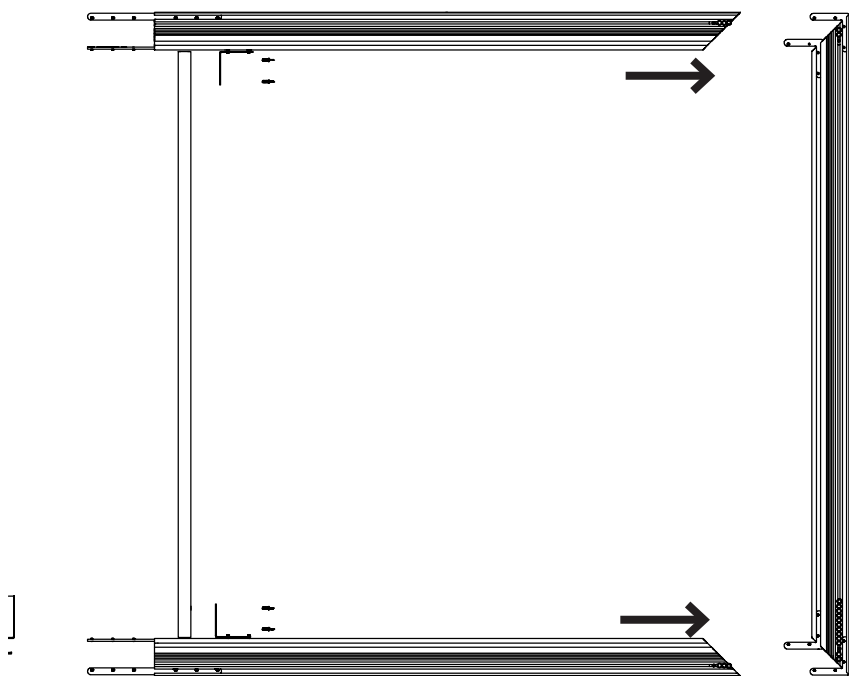

Insert the thin corner brackets into the outside channels and the thick corner brackets into the inside channels of the vertical frames. Then slide into the channels in the horizontal frames.



NOTE: If using AT or Maestro material then check to make sure the channel nuts are installed in the inner channel before proceeding.

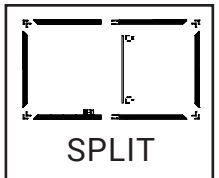

3

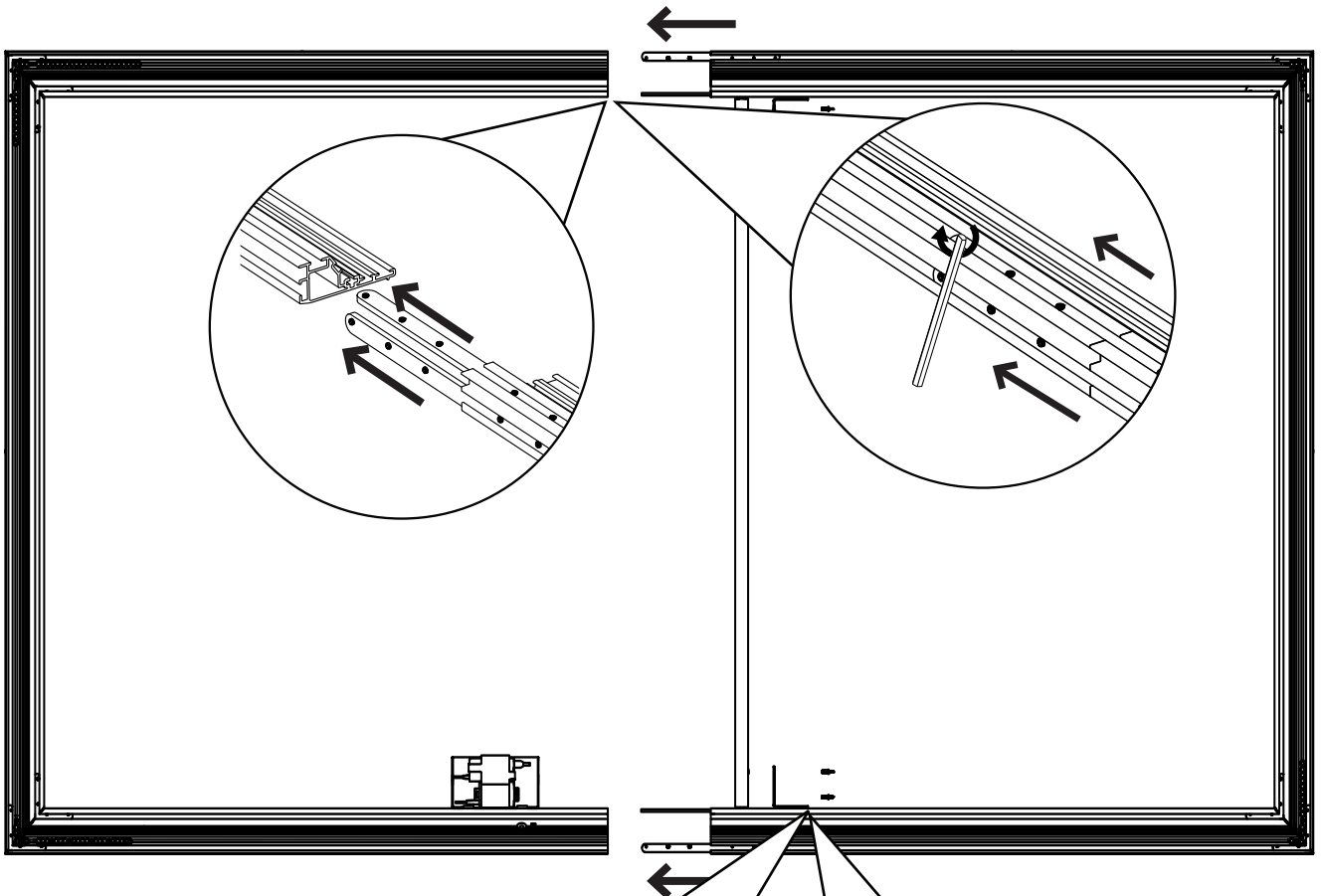

4

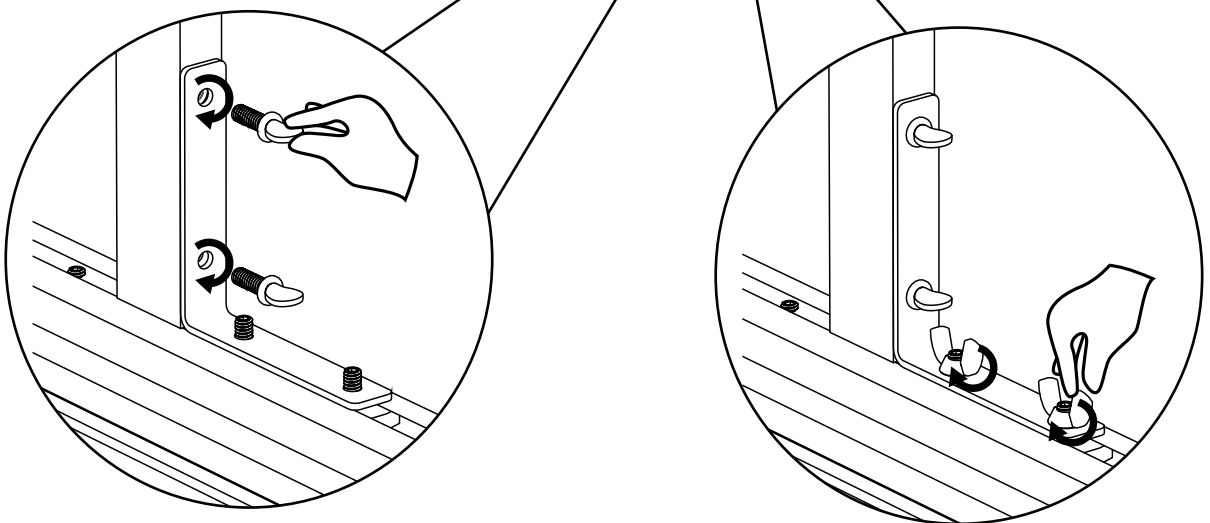

Slide the horizontal frame pieces together and secure with the splice bars. Then attach the vertical support to the frame as shown.

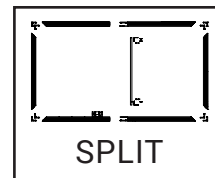

5

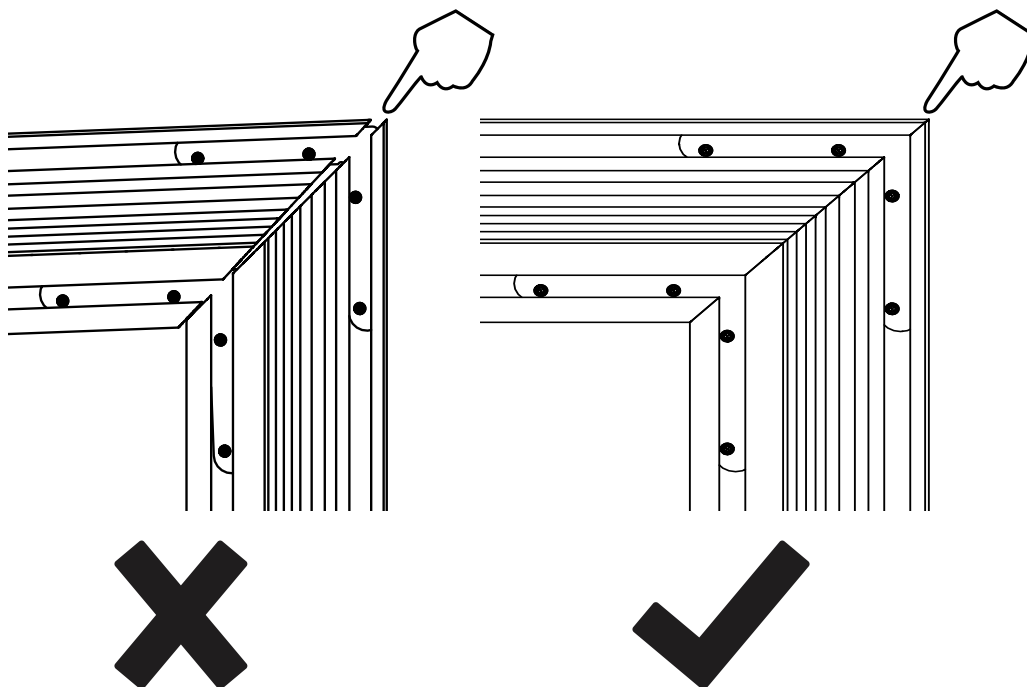

6

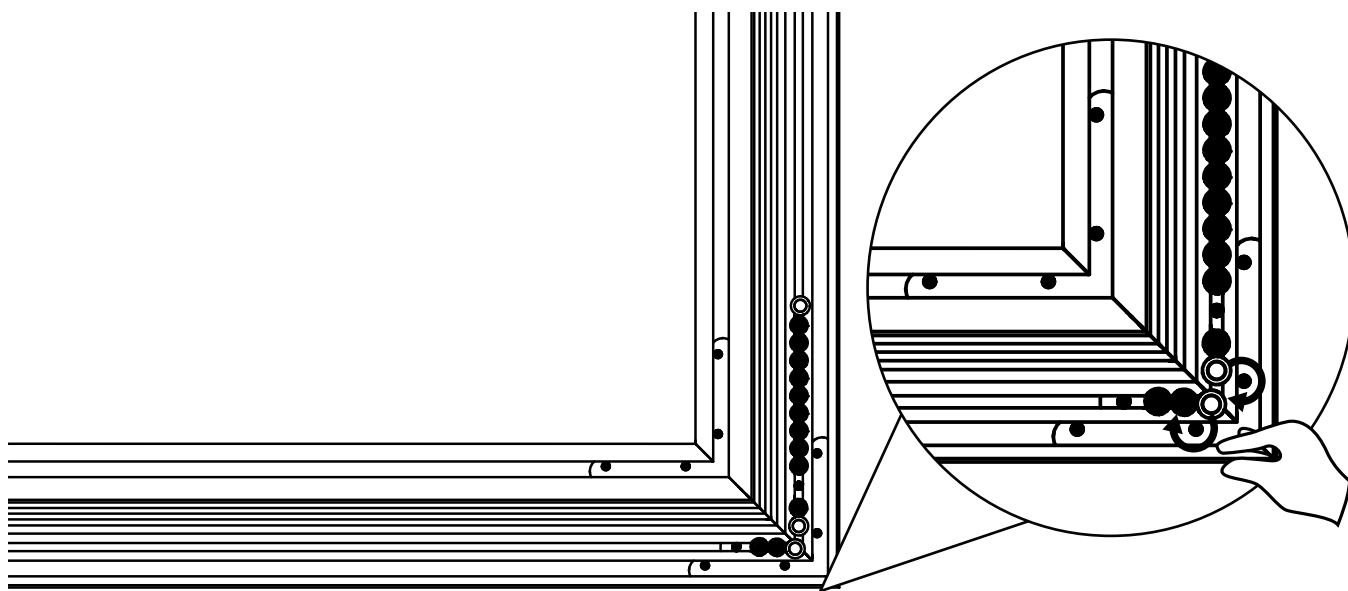

Make sure the points on the frame pieces line up. Then finger tighten 2 of the set screws to lock in the corners.

7

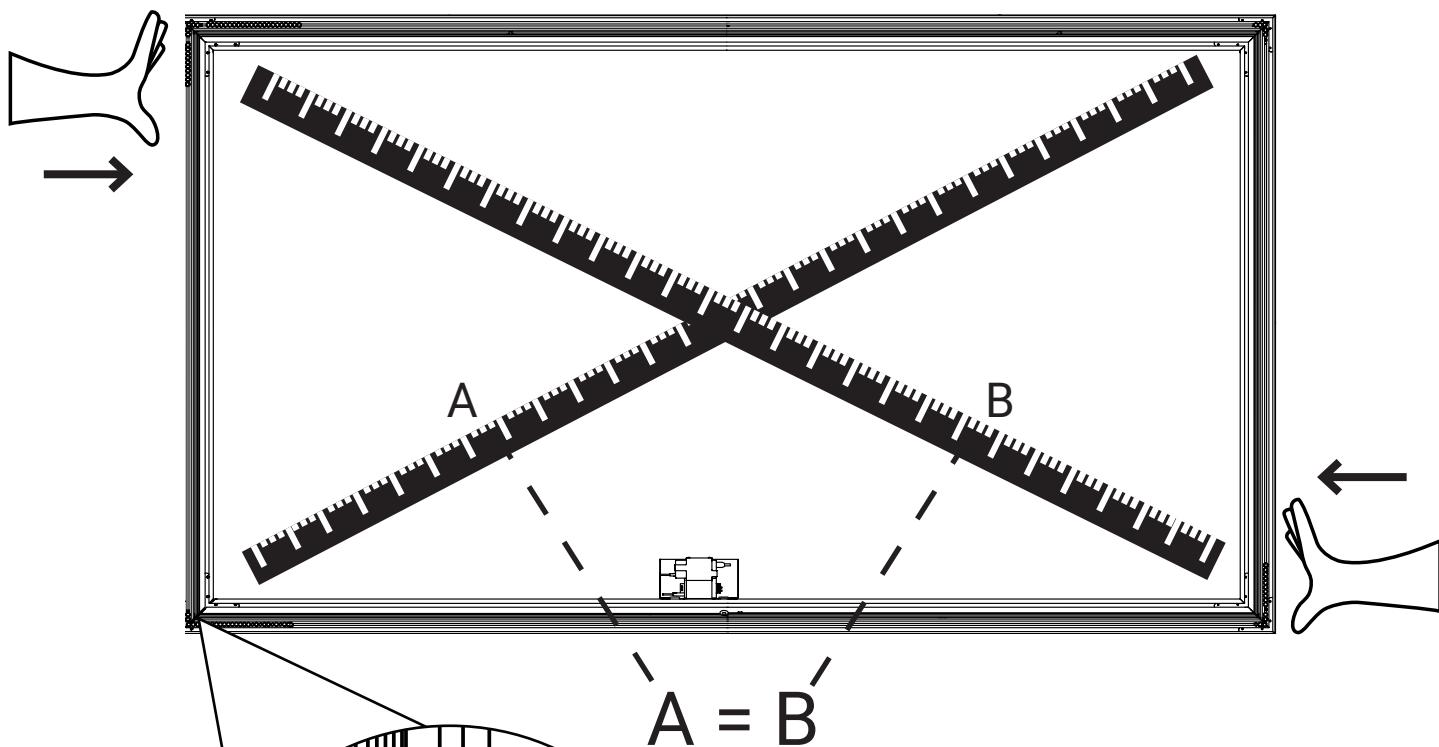
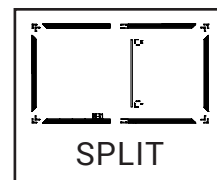
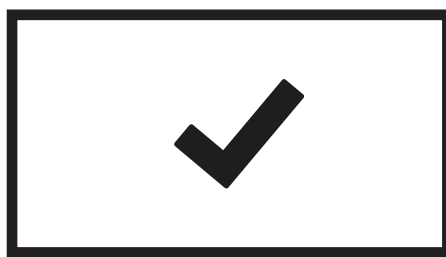

8

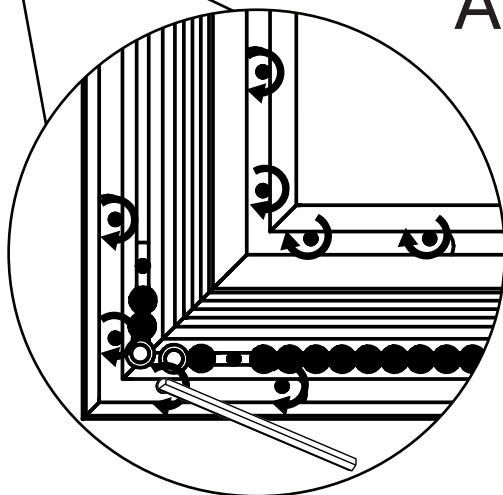

Measure the diagonals to check if frame is square. If one diagonal is longer then push on the corners at that diagonal. Tighten all set screws once the diagonals are equal to within 1/8".

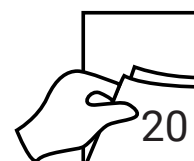



If IP controlled LED lights are ordered, Phillips Hue hub must be purchased and set up separately, see page 50 for IP lighting Instructions.

NOTE: Steps 1 and 2 will have already been completed if possible to be shipped that way. If so skip to step 3.

1

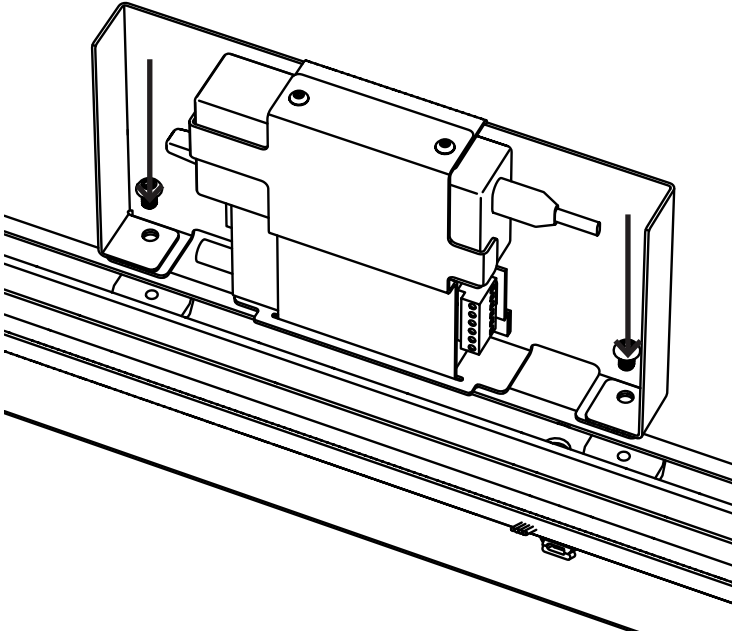

Connect the lighting harness with the included screws to the nuts in the frame piece with the lights attached to it.

2

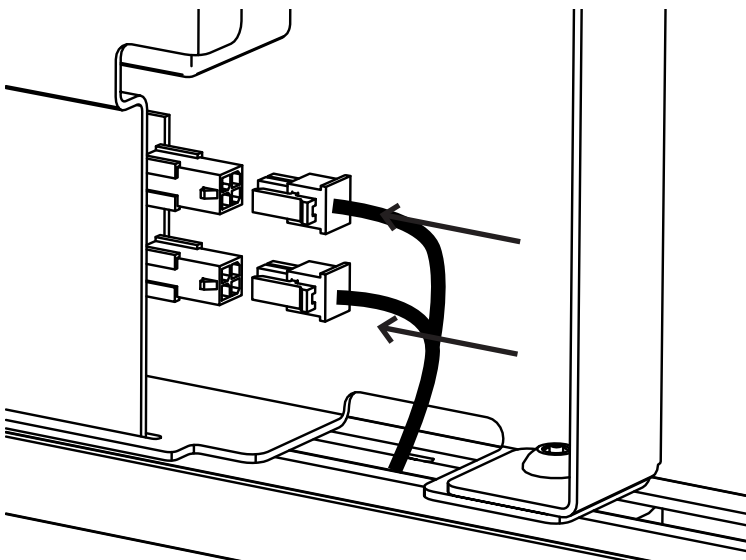

Plug in the lights to the controller plugs.

3

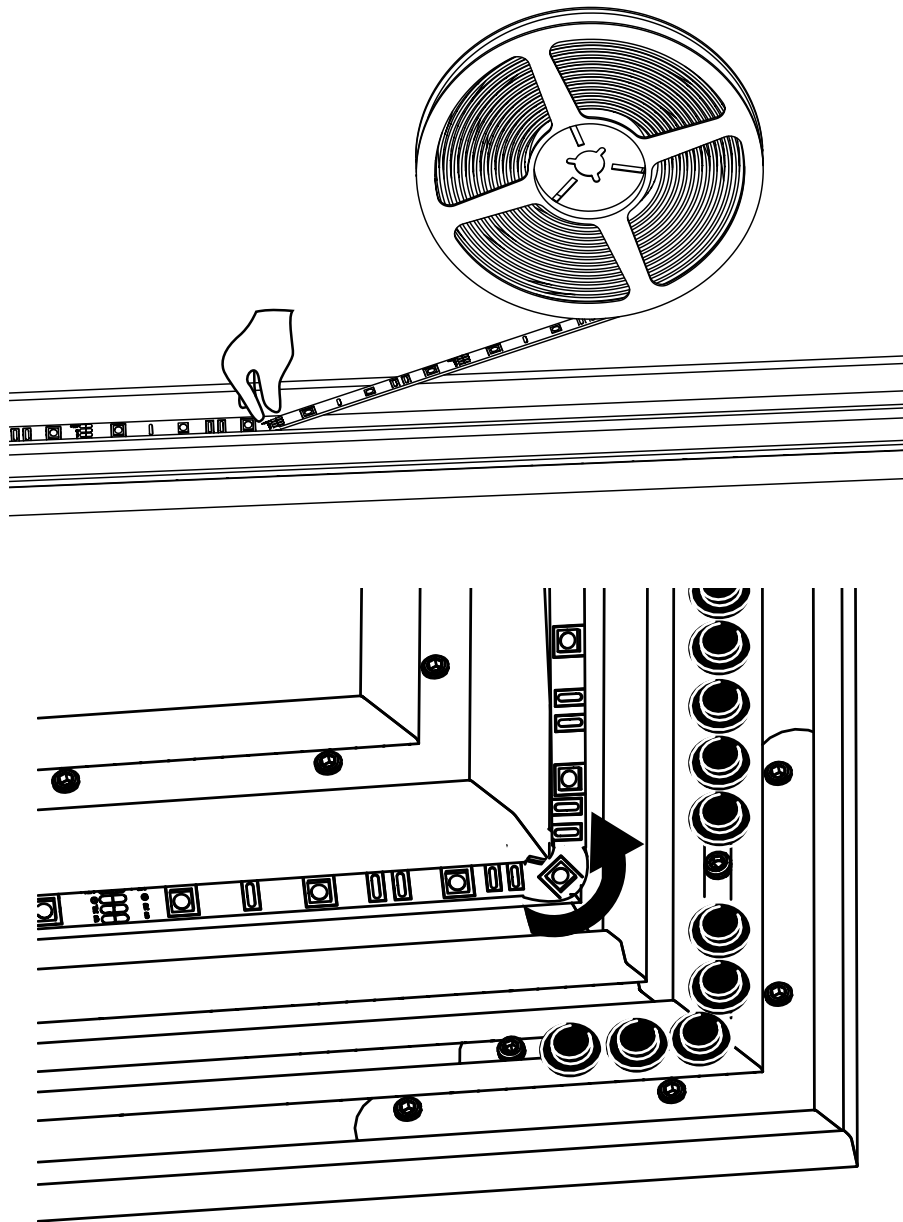

Press in the lights to the channel on the frame. Do not crease the lights at the corners.

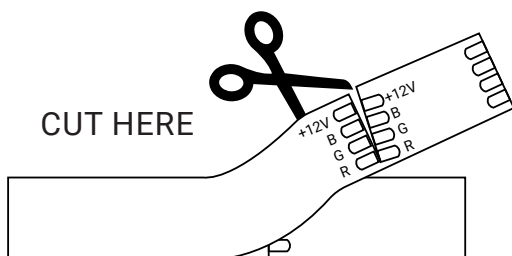

Cut the light strips at the copper pad as indicated to the correct length such that they just overlap at the middle of the top frame piece. DO NOT cut the light strips at any other location.

BLACK DIAMOND or
SHORT THROW

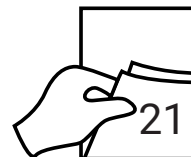

SLATE or PURE

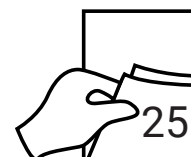

MAESTRO

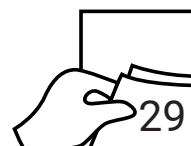

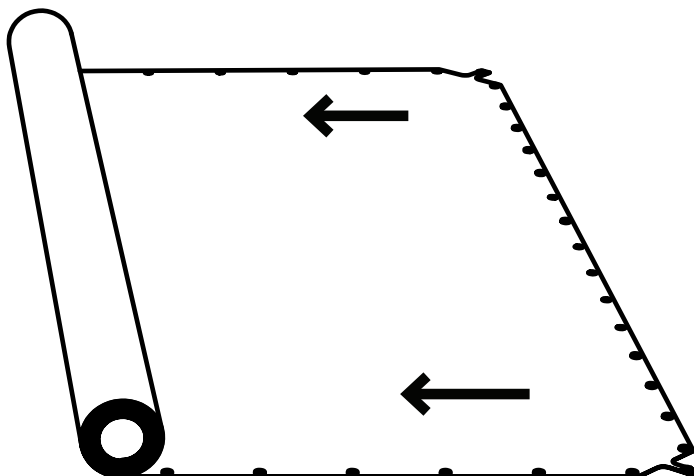
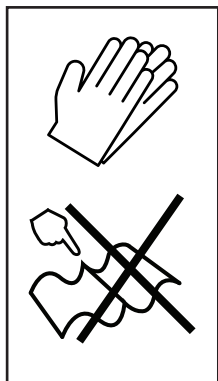

Black diamond and short throw material are highly sensitive. Take care to not bend or crease the material as you unroll it.

1

Wear gloves when handling material. Carefully unroll the screen material out onto a clean floor. Take care to not bend or crease the screen material.

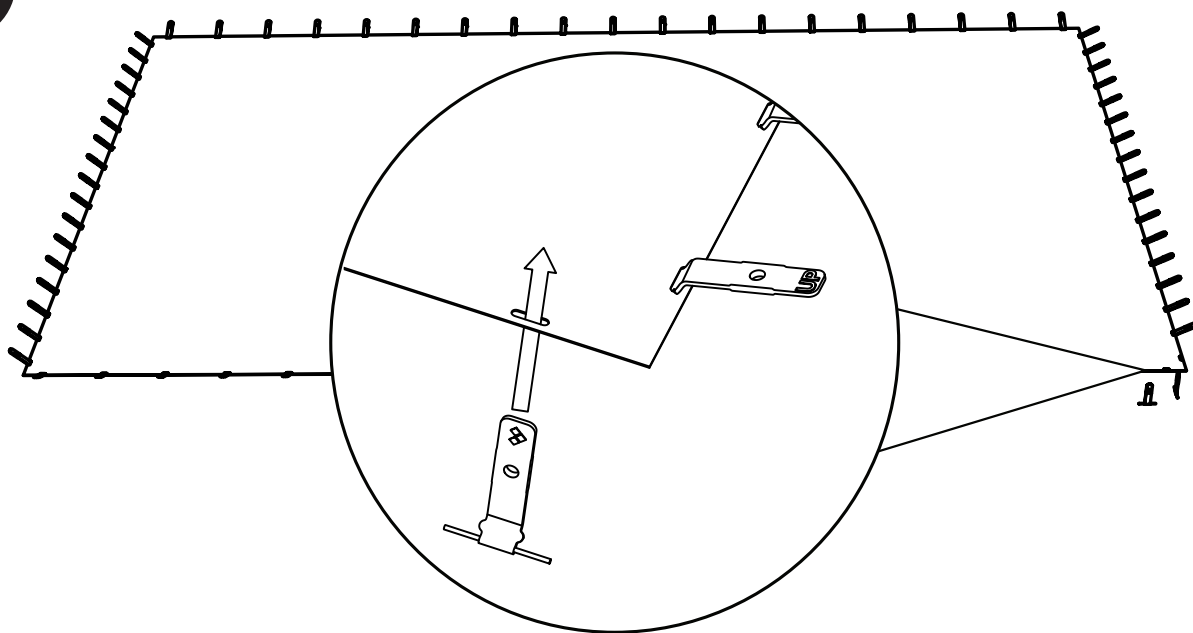
2

Insert the BD attaching bands up through the slots in the material. Note the orientation of the bands such that the bent band will naturally lie away from the material and the UP label is visible.



DO NOT drop the frame onto the screen material. Frame must be gently set down onto the screen material to avoid denting the material.

3

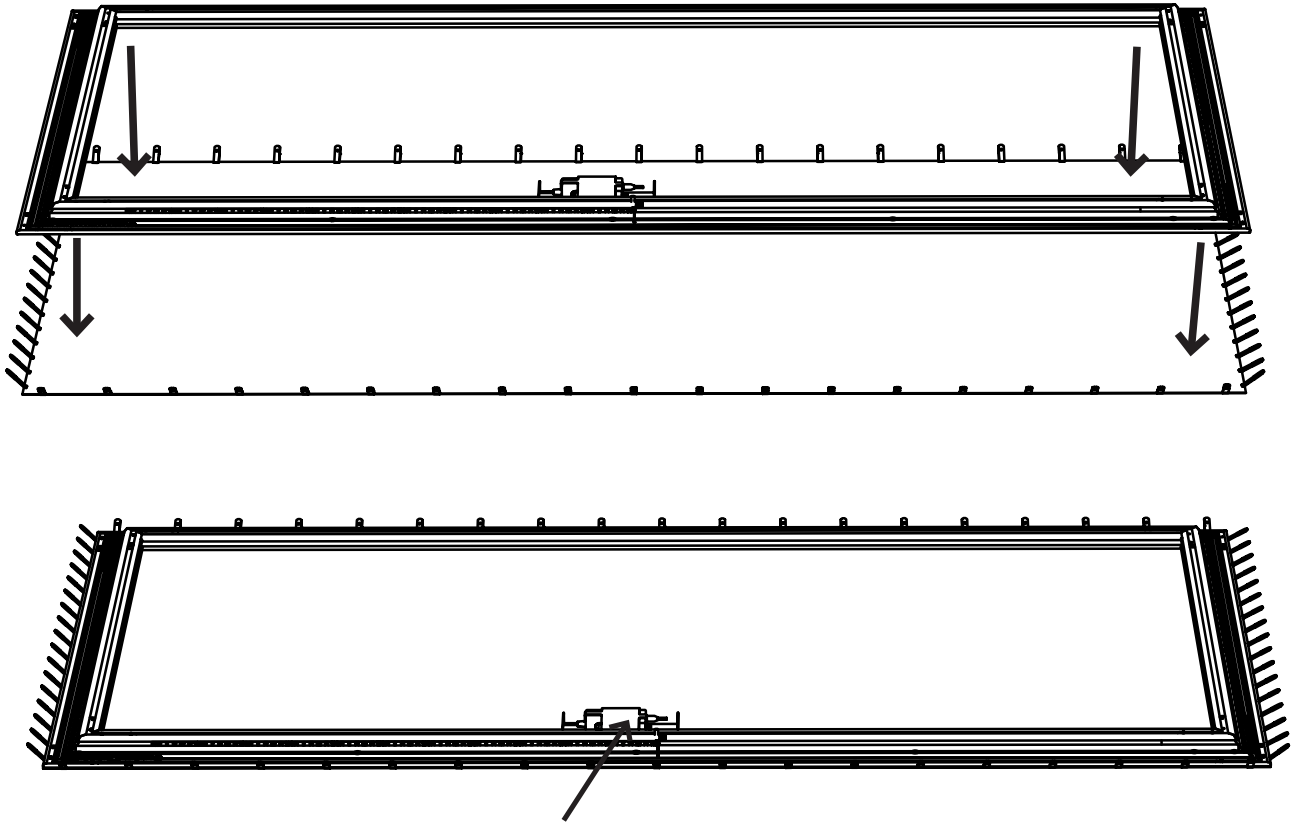

For Short Throw
LED harness at bottom

Carefully lie the frame onto the screen material making sure to not dent the screen material with the frame or frame corners. Align the edges of the screen material with the edges of the frame.

NOTE: For short throw material make sure the material is oriented such that the LED harness is at the bottom of the screen material.

4

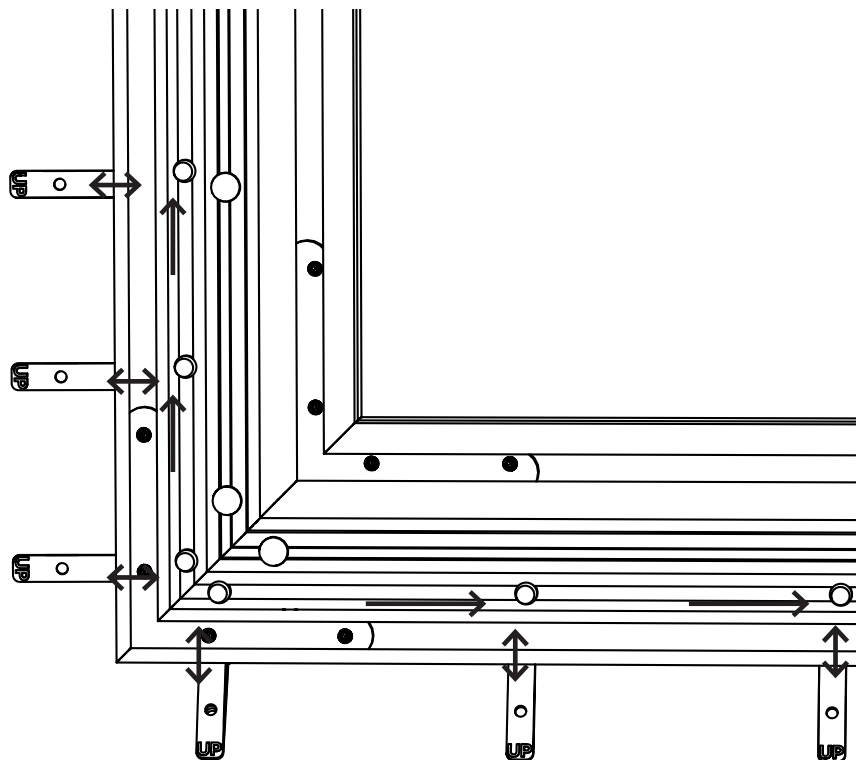

Remove and discard the black retaining bumpers then spread out the posts so that they align with the attaching bands.

5

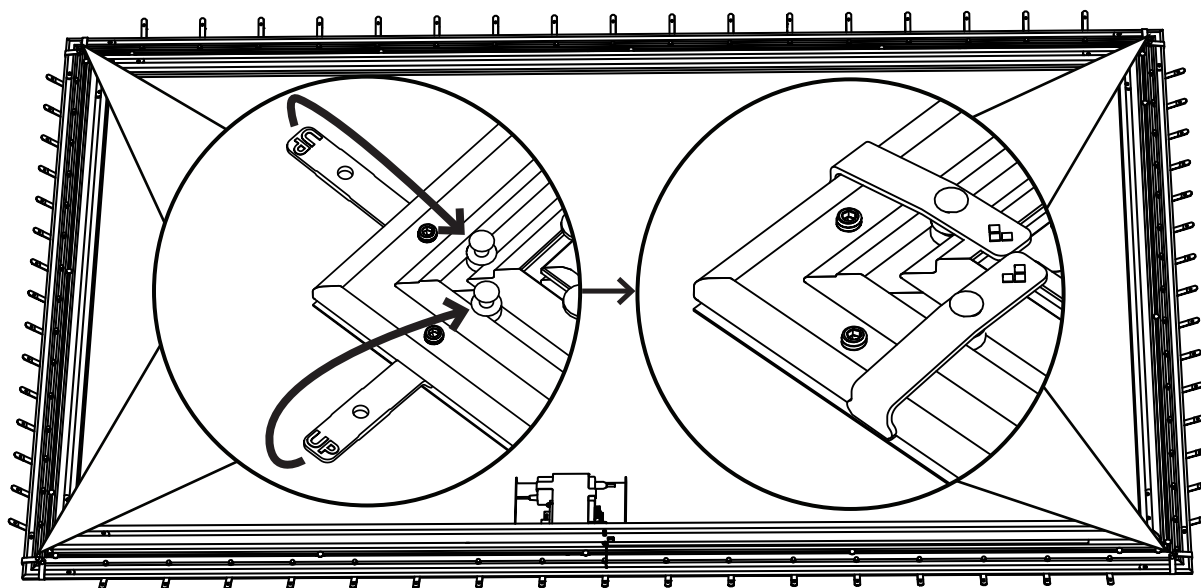

Pull up and then over on the bands to attach to the posts so that the SI diamonds are showing. Do this at all 4 corners before proceeding. Make sure the screen material is **centered about the frame** by making sure the edges of the screen material line up with the edges of the frame.



As you continue to attach the bands make sure the material is centered about the frame. This is easy to tell by making sure the edge of the material is flush with the edge of the frame.

6

Attach one band in the middle of all four frame pieces. This will center the material.

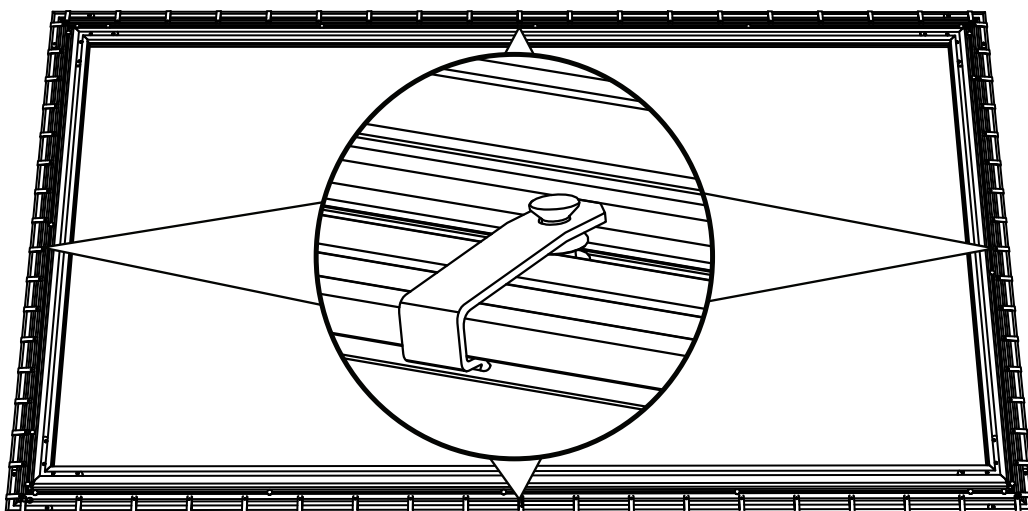

7

Attach the bands on the **vertical** frame pieces from the center towards the ends. Alternate sides to keep tension even on both sides. Make sure the edges of the material are even with the edges of the frame. Then, attach the bands on the horizontal frame pieces from the center towards the ends. Alternate sides to keep the tension even on both sides.

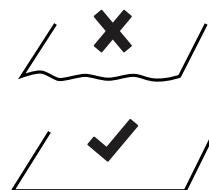
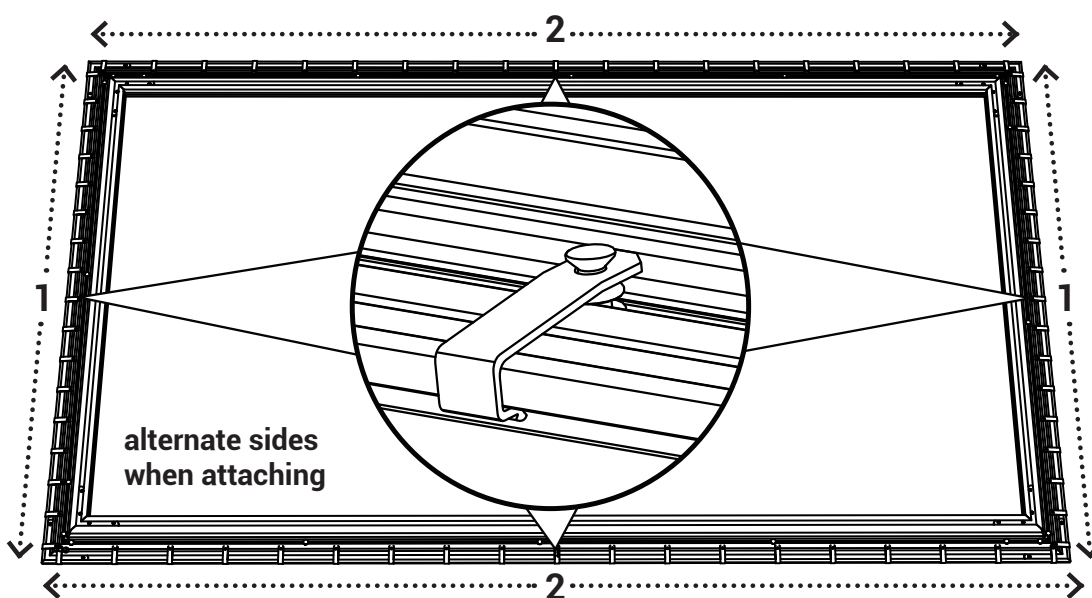

1

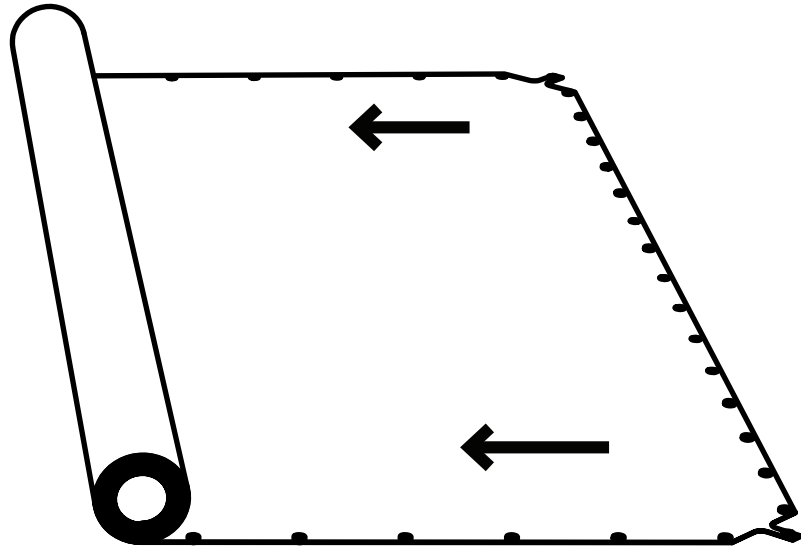
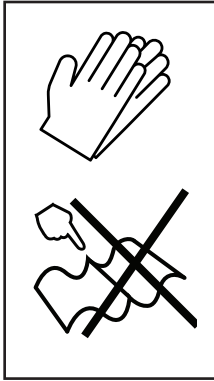

Wear gloves when handling material. Carefully unroll the screen material out onto a clean floor. Take care to not bend or crease the screen material.

2

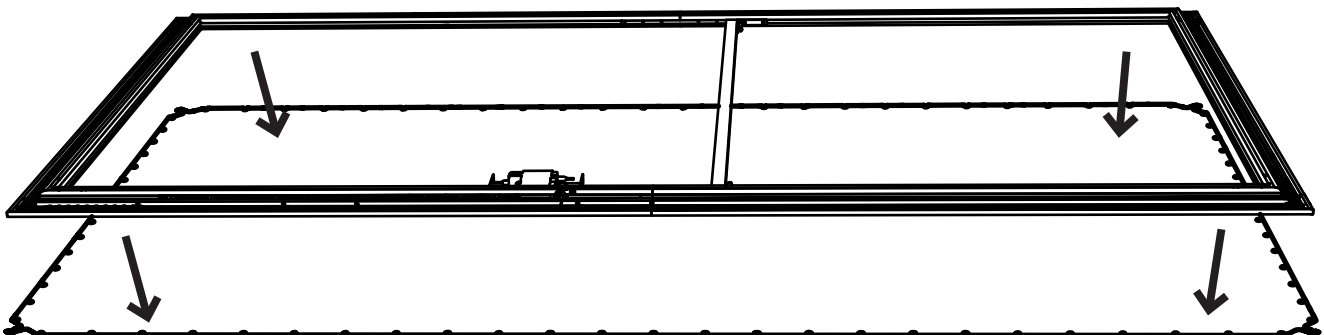

Carefully lie the frame onto the screen material. Center the frame about the screen material.

3

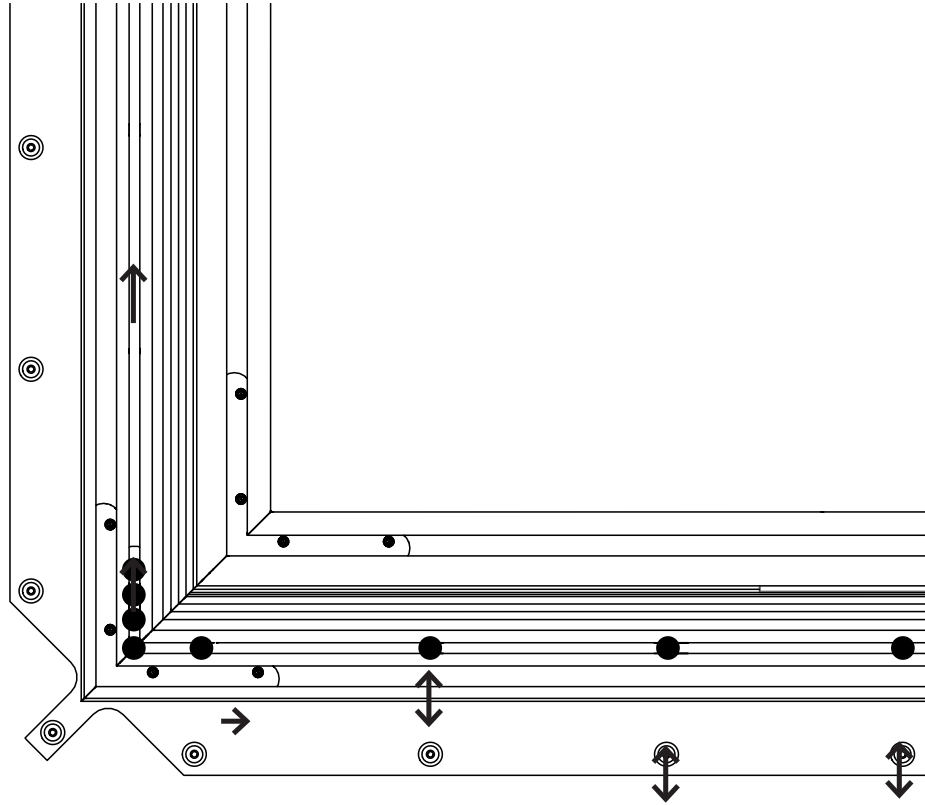

Remove and discard the black retaining bumpers then spread out the posts so that they aligning with the snaps on the screen material.

4

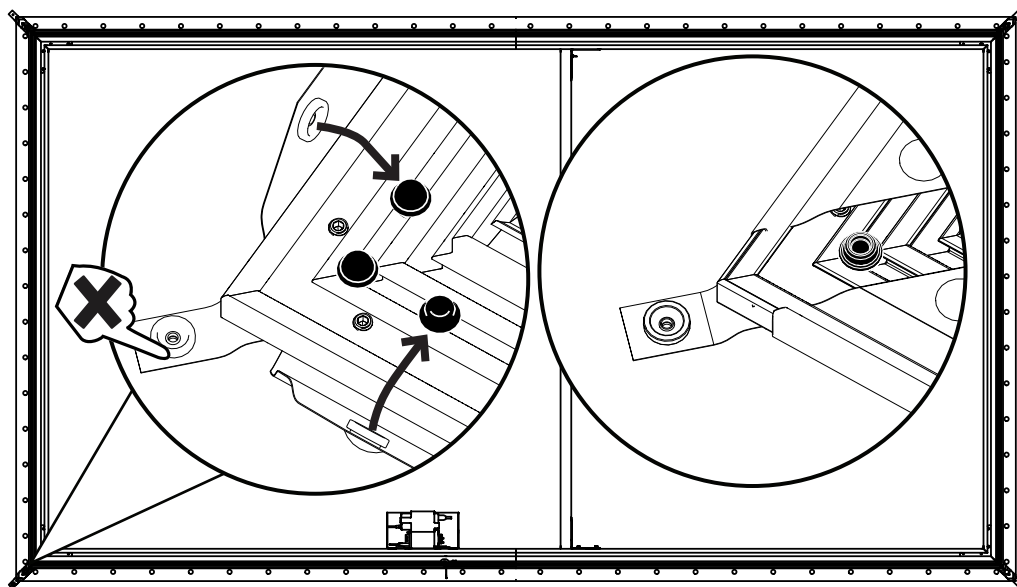

At all 4 corners attach the snaps at the end of screen material but NOT the snap on the corner tab. **Make sure the screen material is centered about the frame before proceeding.**

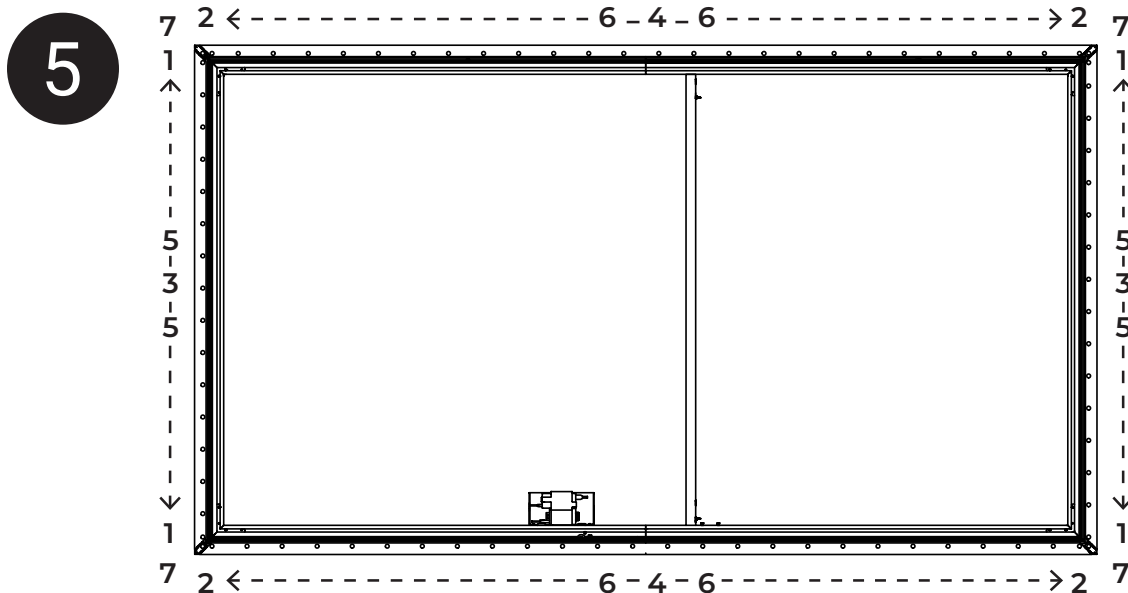

Attach the material to the frame using the sequence illustrated. Step 1. Attach the 2 snaps closest to the corners on the vertical frame rails to stretch the material horizontally (not the corner tab). Step 2. Attach the 2 snaps closest to the corners on the horizontal frame rails to stretch the material vertically (not the corner tab). Step 3. Attach the 2 center snaps on each vertical frame rails. Step 4. Attach the 2 center snaps on each horizontal frame rail. The profile of the material to the frame is now set. Step 5. Attach the remaining snaps on the vertical frame rails working from the center towards the corners. Step 6. Attach the remaining snaps on the horizontal frame rails working from the center towards the corners. Step 7. Attach the remaining corner tabs.

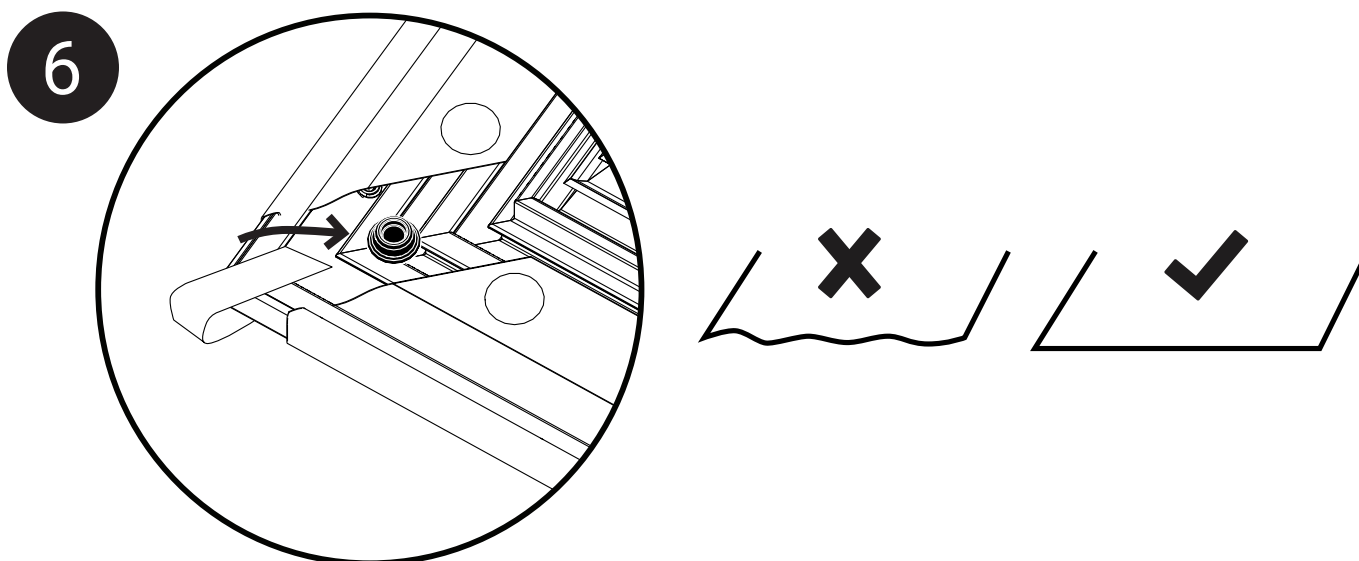

Then check to make sure the screen material is flat and adjust the snap positions if necessary to flatten the screen material. Once all snaps are attached **flip screen over and make sure that the screen material is flat and tight everywhere.**

For AT Material Only

7

Acoustically Transparent (AT) materials come with a black backer that must be installed to eliminate shine through.

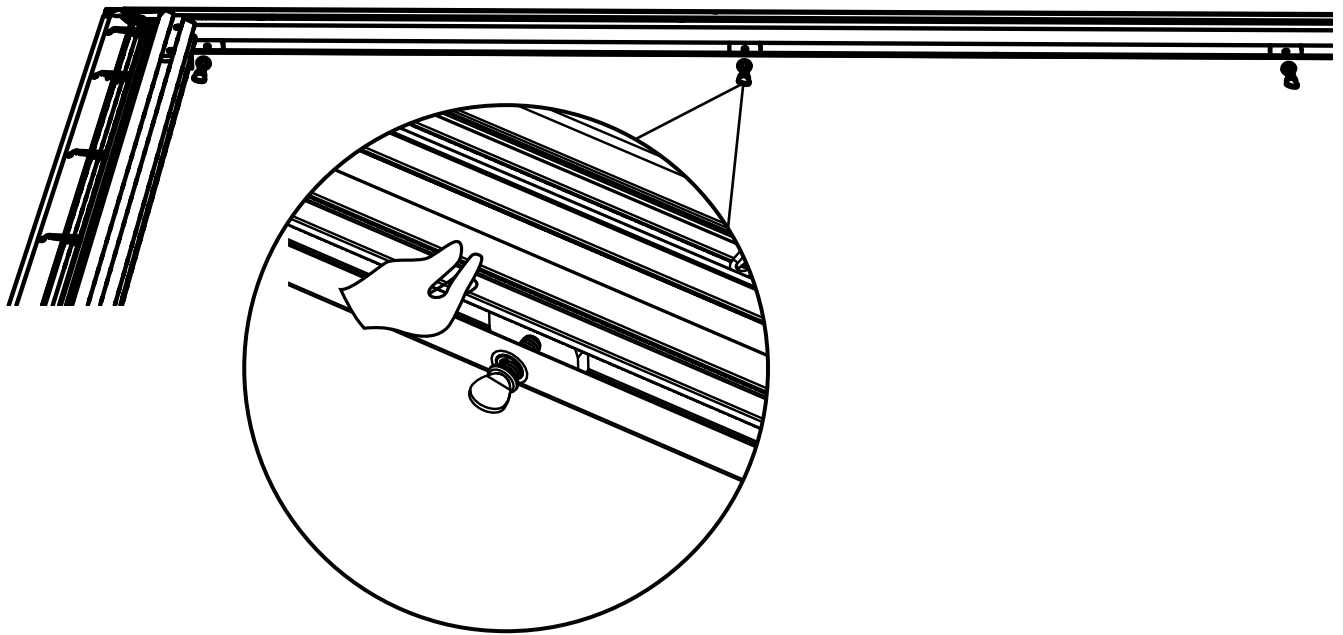

Spread out the nuts in the top frame piece and attach the black backer to the nuts with the thumb screws. **Flip screen over and make sure that the screen material is flat and tight everywhere.**

Note: If the notch in the black backer is not aligned with the vertical support then flip it over.



1

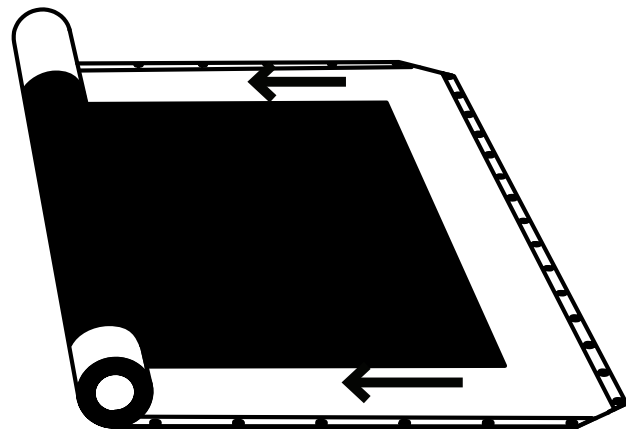
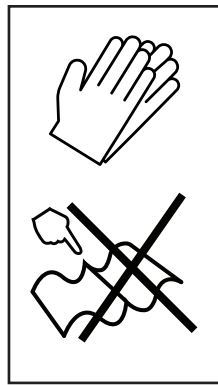

Wear gloves when handling material. Carefully unroll the screen material out onto a clean floor. Take care to not bend or crease the screen material.

2

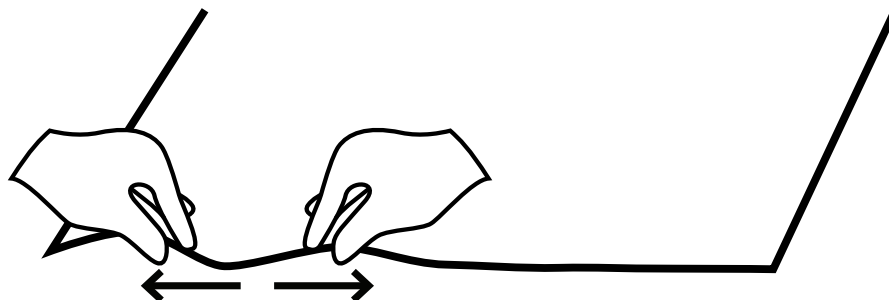
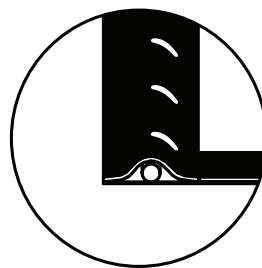
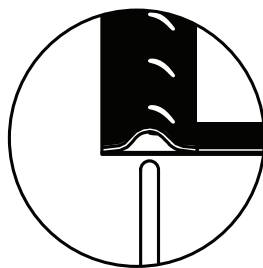

Insert the rods into the pocket in the screen material. Make sure the screen material is lying flat. If the screen material is bunched up at the rods then work from the middle out spreading out the screen material until it is flat.

3

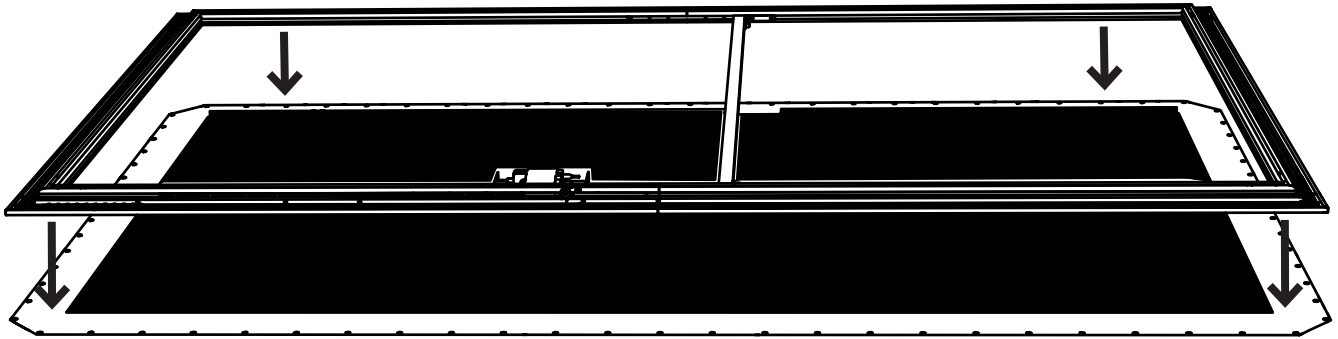

Carefully lay the frame onto the screen material. Center the frame about the screen material.

4

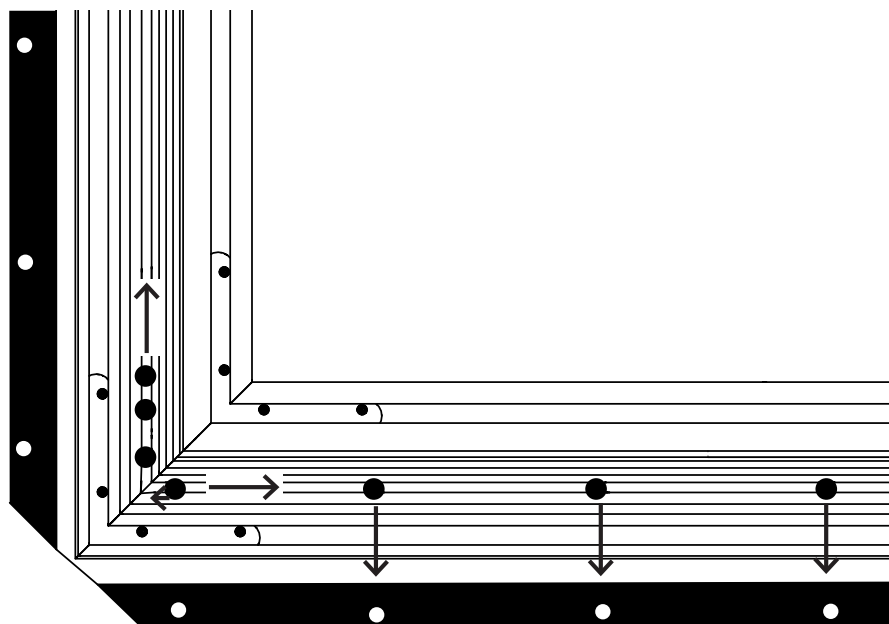

Remove and discard the black retaining bumpers then spread out the posts so that they aligning with the holes in the screen material.

5

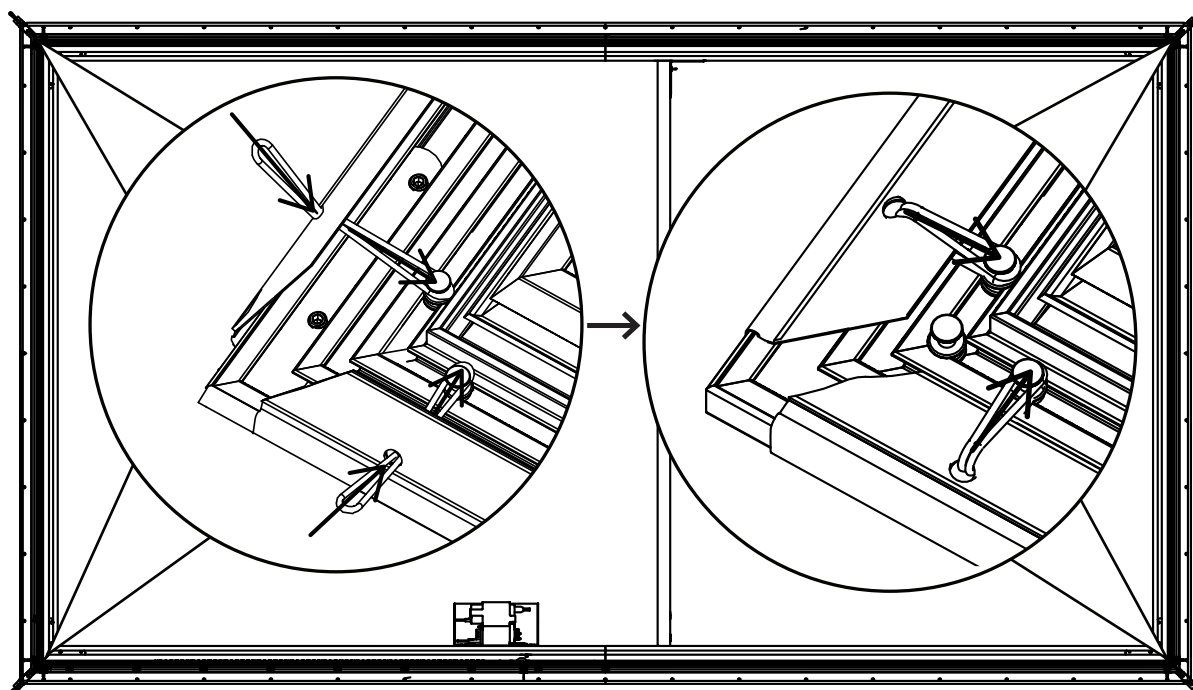

Put one end of the bungee through the hole in the material and place over the post while holding the other end. Then pull the other end of the over the post. Do this at all 4 corners first. **Make sure the screen material is centered about the frame before proceeding.**

6

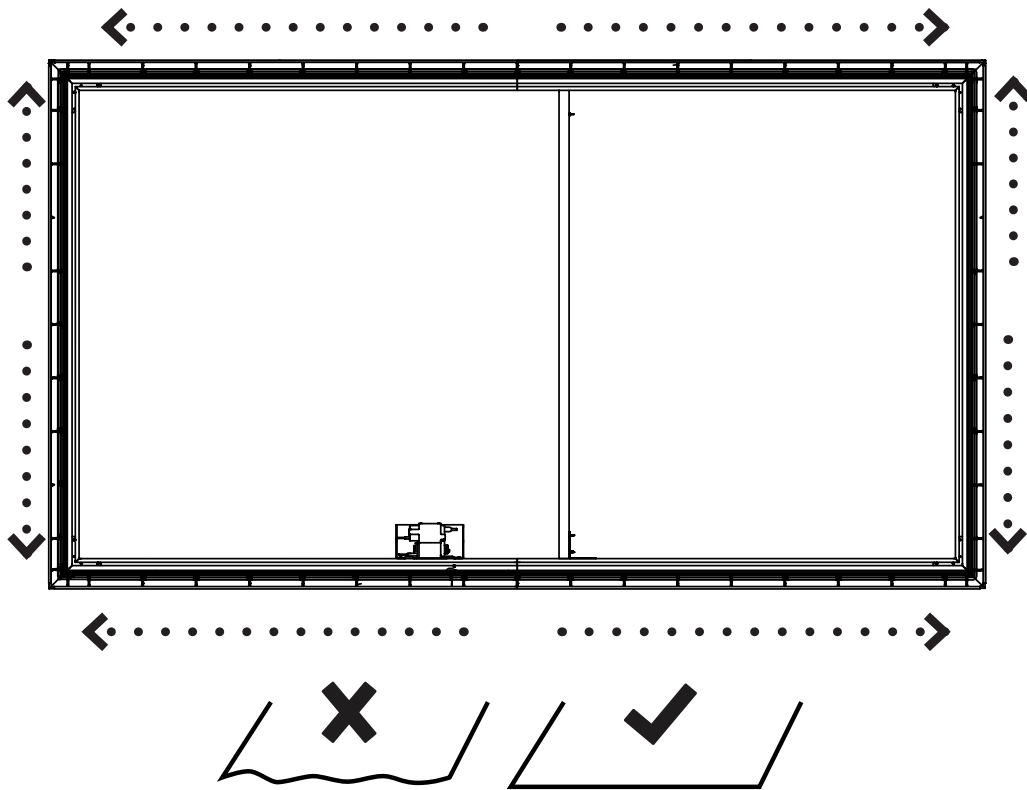

Attach the bungees at the middle and then work your way towards the ends on all 4 sides of the screen material. Check to make sure the screen material is flat and adjust the bungee positions if necessary to flatten the screen material.

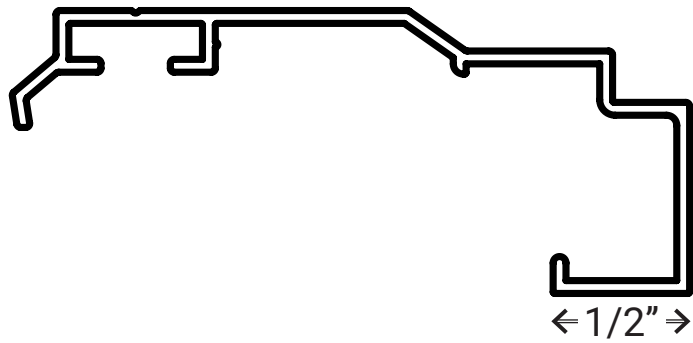

SMALL TRIM

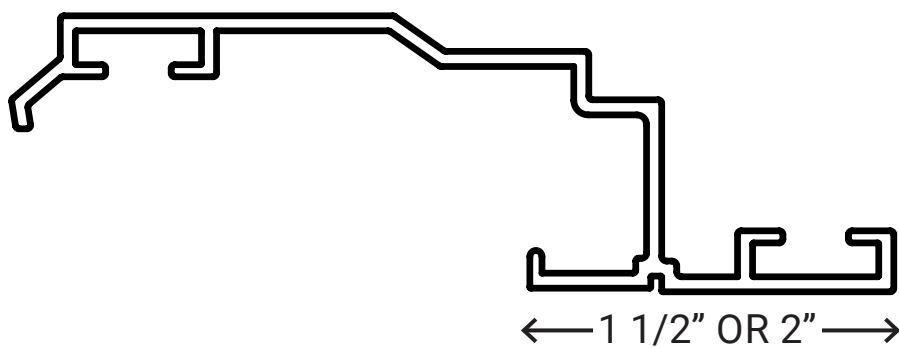
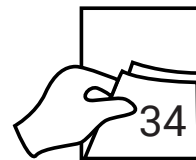

MEDIUM OR LARGE TRIM

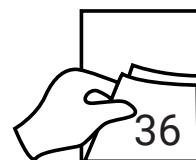



Velvet on trim is delicate, handle with care.
Install trim with screen flat on floor, NOT
when screen is vertical.

1

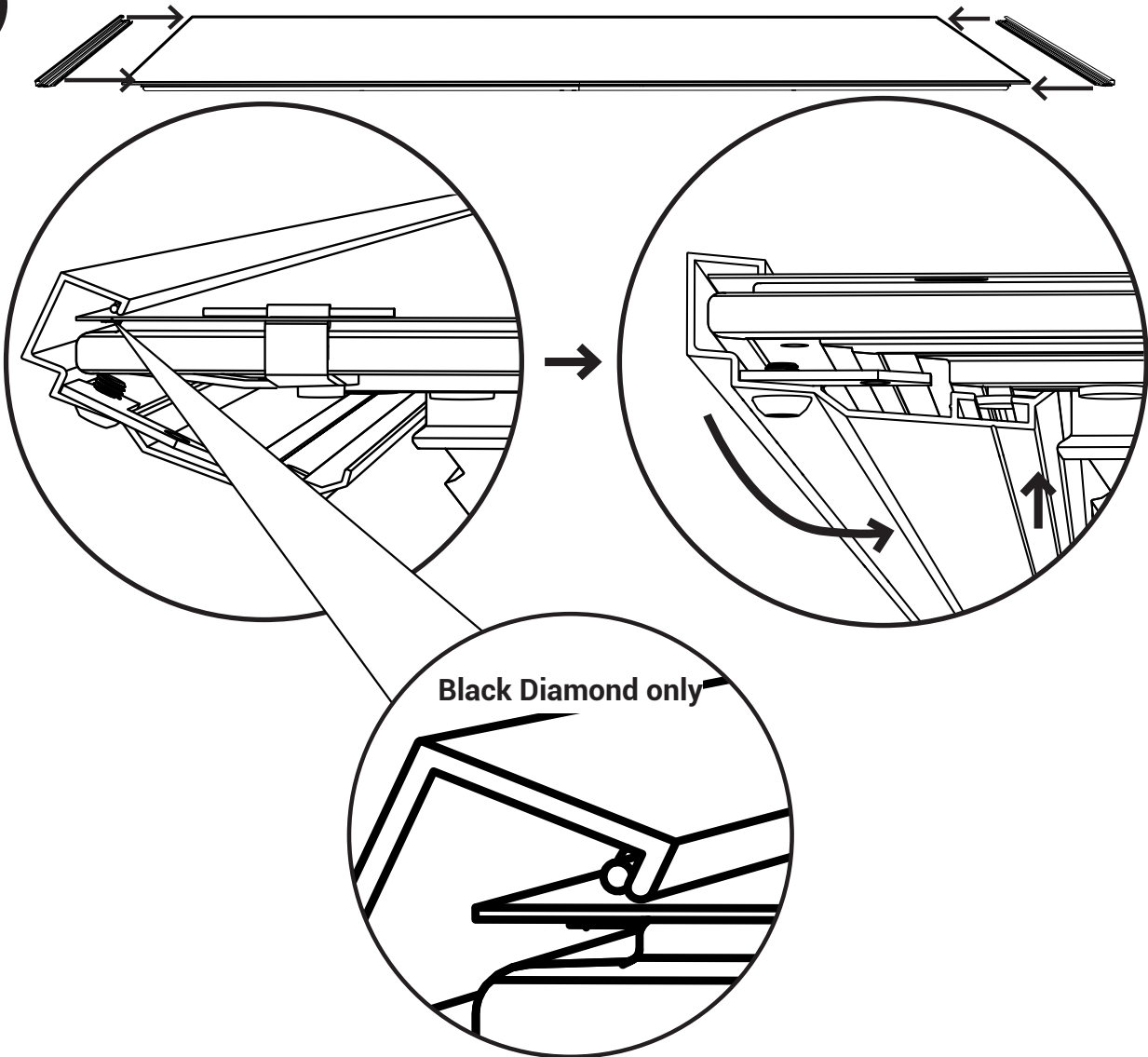

Attach the **vertical trim first** onto the screen as shown above.

NOTE: For Black Diamond and Short Throw make sure that the front lip of the trim is over the attaching bands before rotating the trim into place.

2

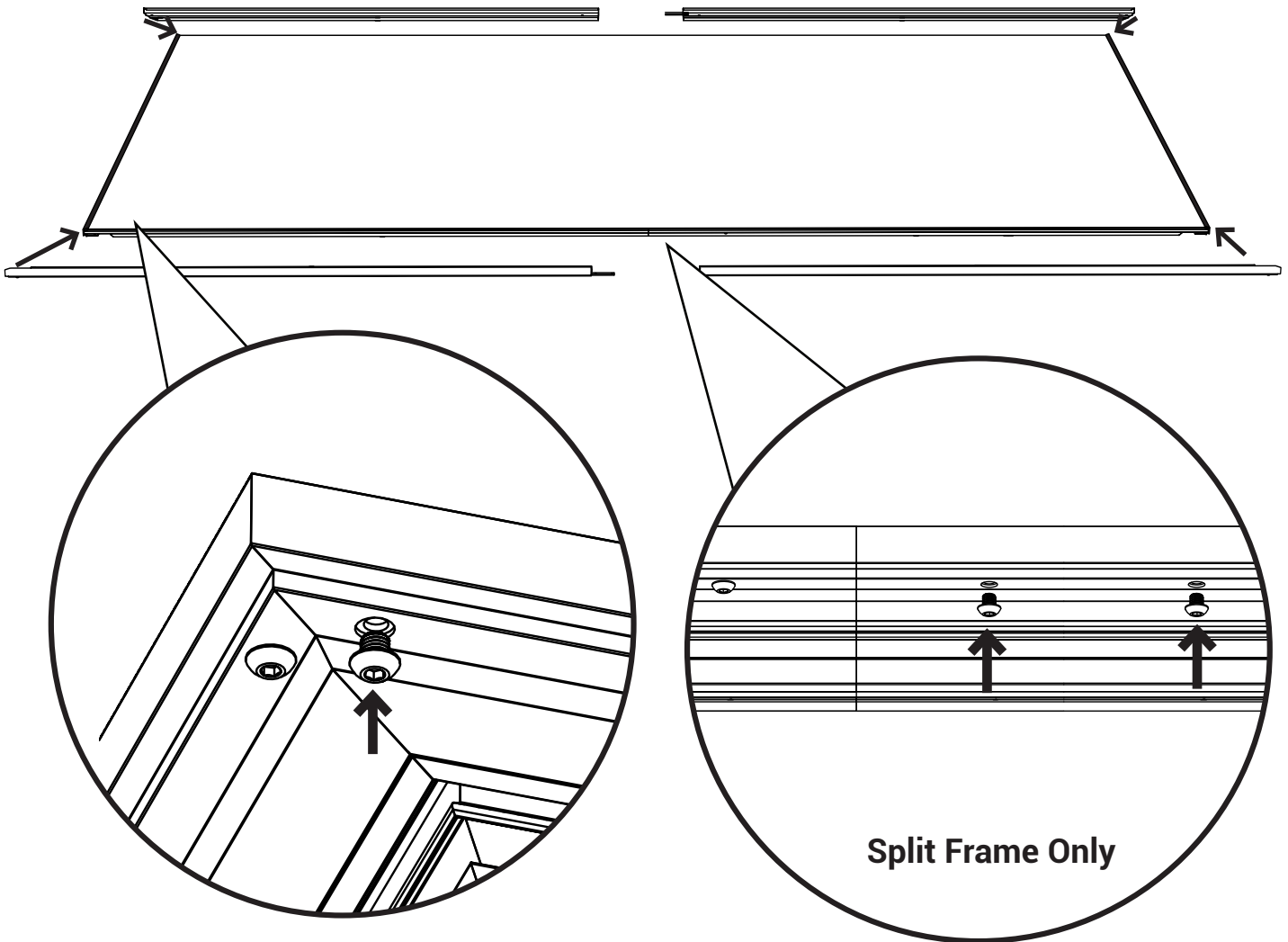

Attach the horizontal trim pieces. Align and secure the corners with the 1/4-20 x 1/4" screws as shown. Hold the trim corners together while tightening the screw to ensure a well aligned corner.

Split Frame Only: Connect the horizontals at the middle by installing quantity 4 1/4-20 x 1/4" screws trough the trim into the splice bar.

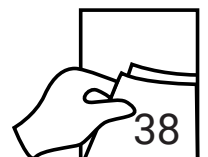

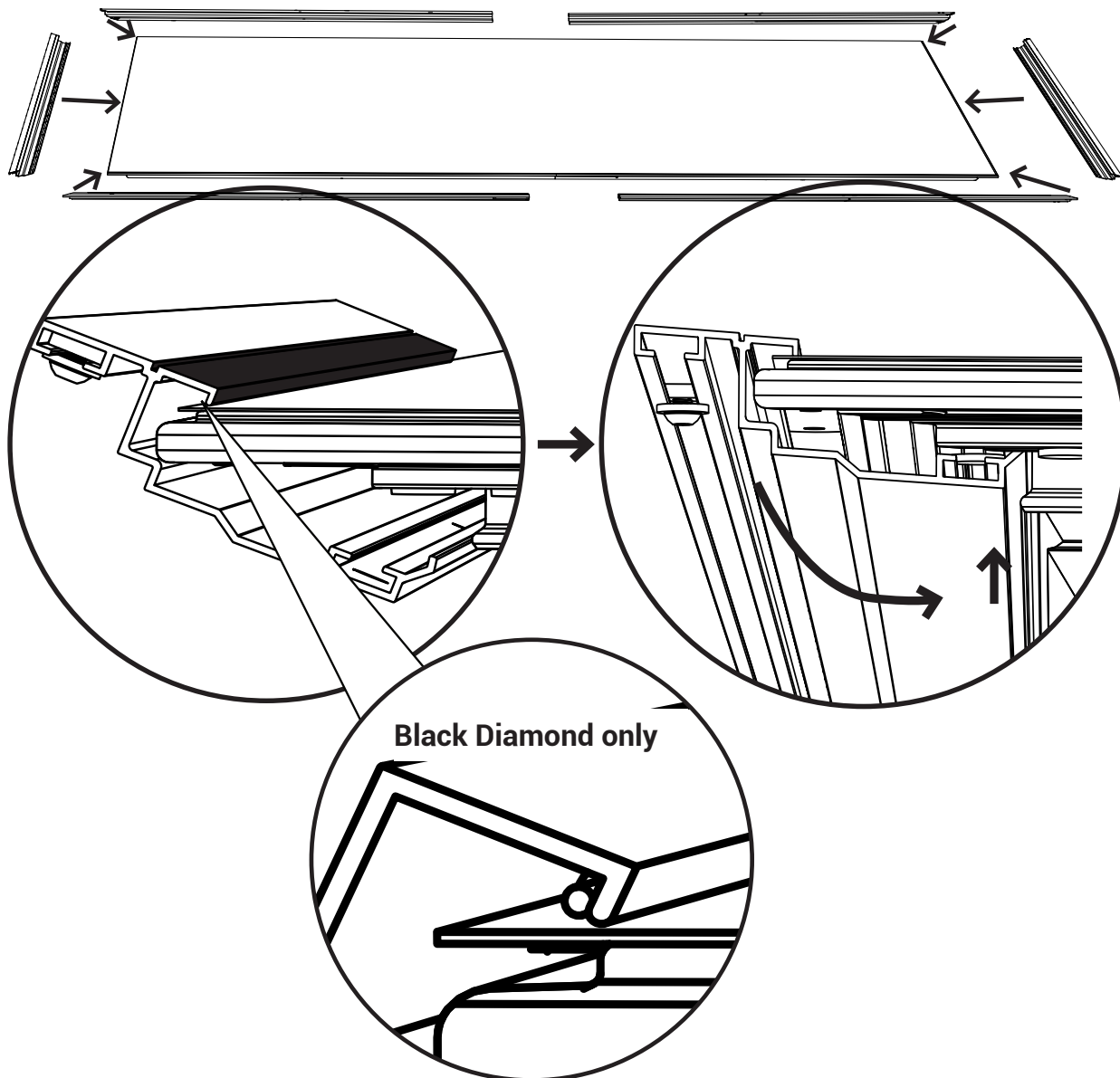

**Velvet on trim is delicate, handle with care.
Install trim with screen flat on floor, NOT
when screen is vertical.**

1

Attach the trim onto the screen as seen above.

NOTE: For Black Diamond make sure that the front lip of the trim is over the attaching bands before rotating the trim into place.

2

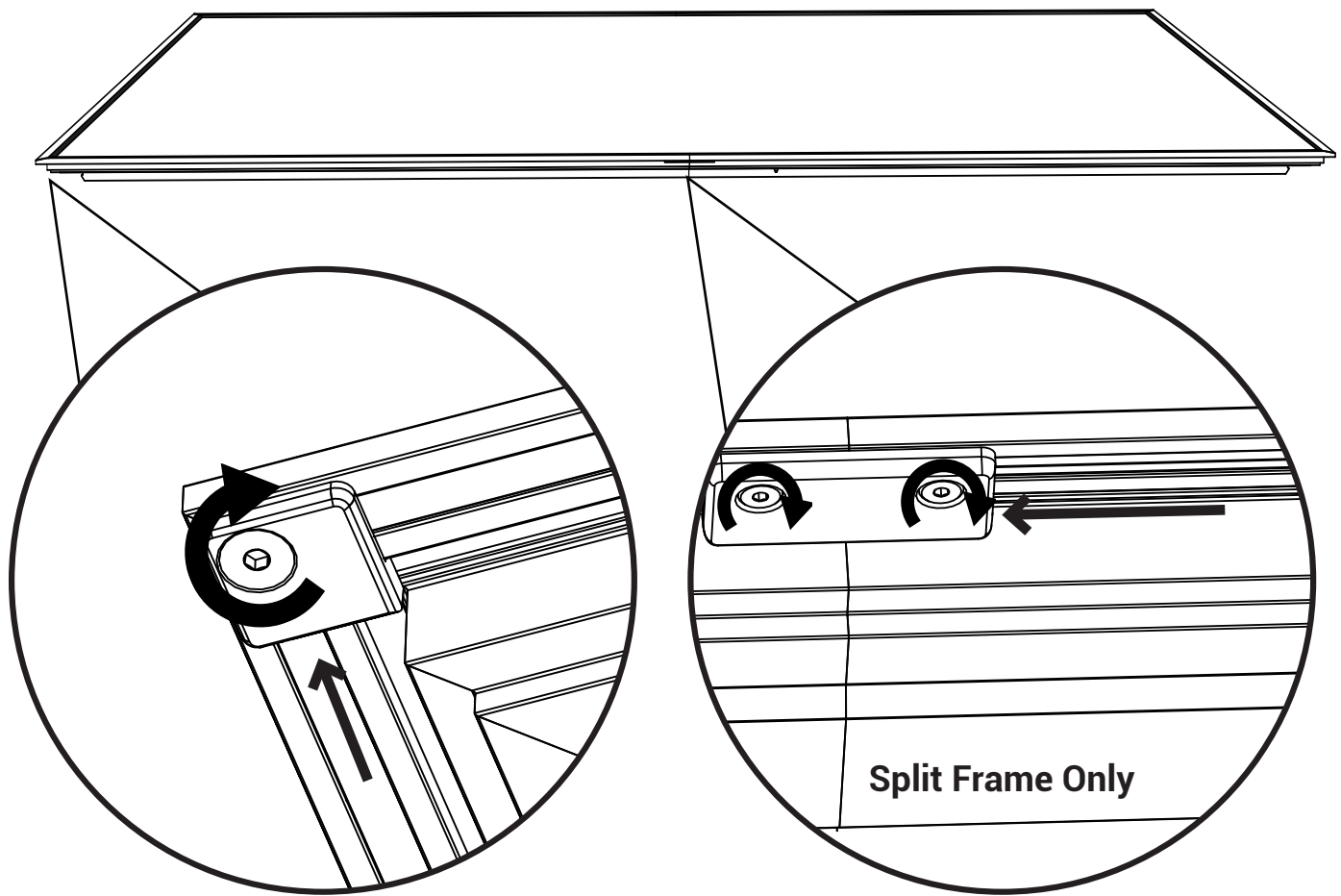

Loosen the screw on the corner plate, slide over to the corner, and hold the corners together while tightening the screw to secure the well aligned corners.

Split Frame Only: Loosen the screw on the center cover plate, slide over to the middle, and hold together trim pieces while tightening the screw to secure the well aligned center trim seam.

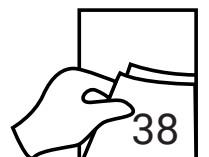

1

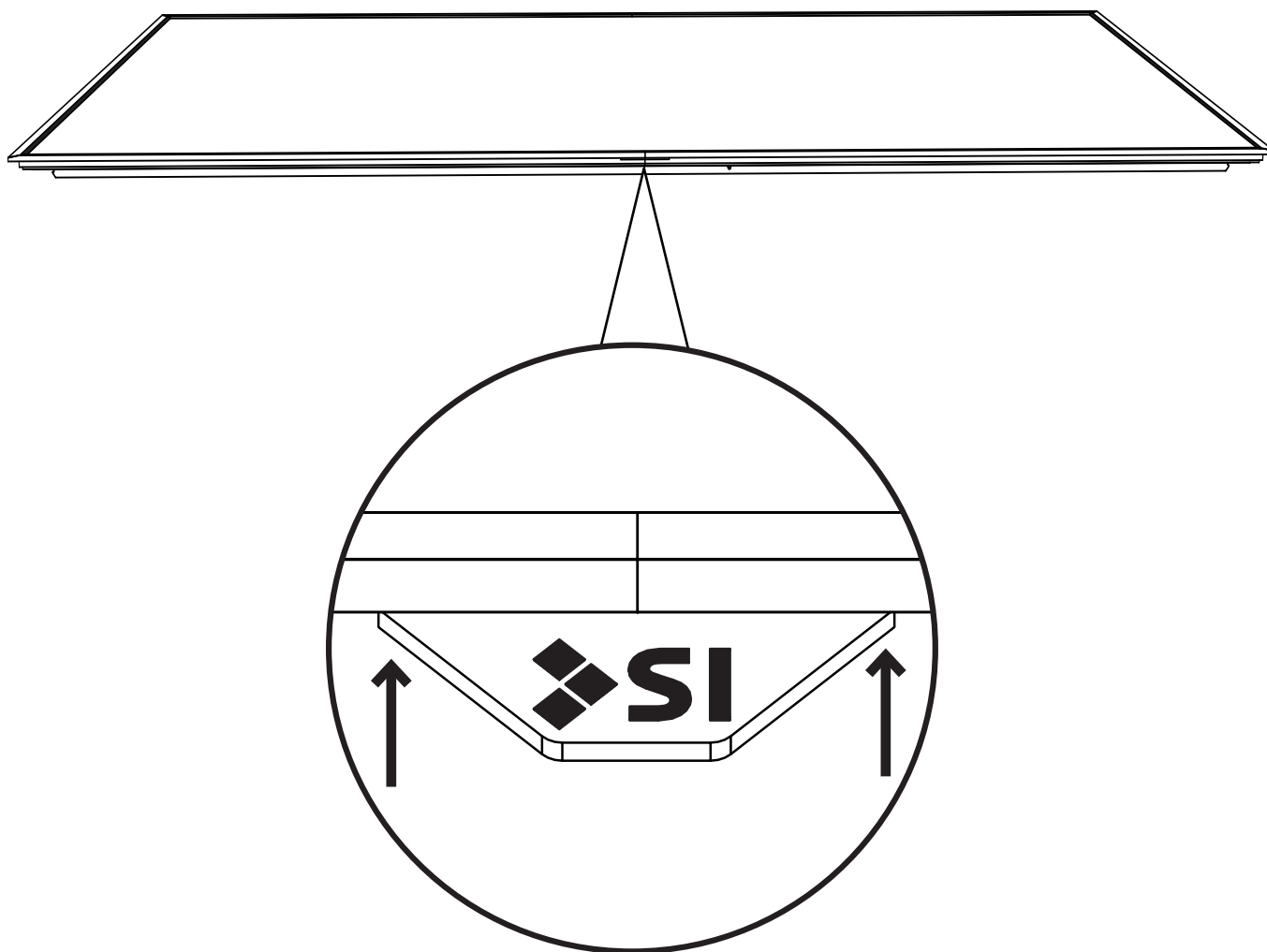

Attach the logo to the trim by holding it at the middle of the horizontal trim and letting the magnet pull it to and attach to the back of the trim.

NOTE: You can also attach the logo to the screen after it is installed on the wall or flown. The trim can attach to either horizontal trim piece. However if your screen has lights make sure the trim is attached to the side of the screen with the lighting harness.

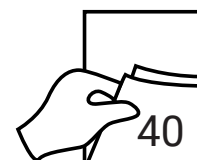

1

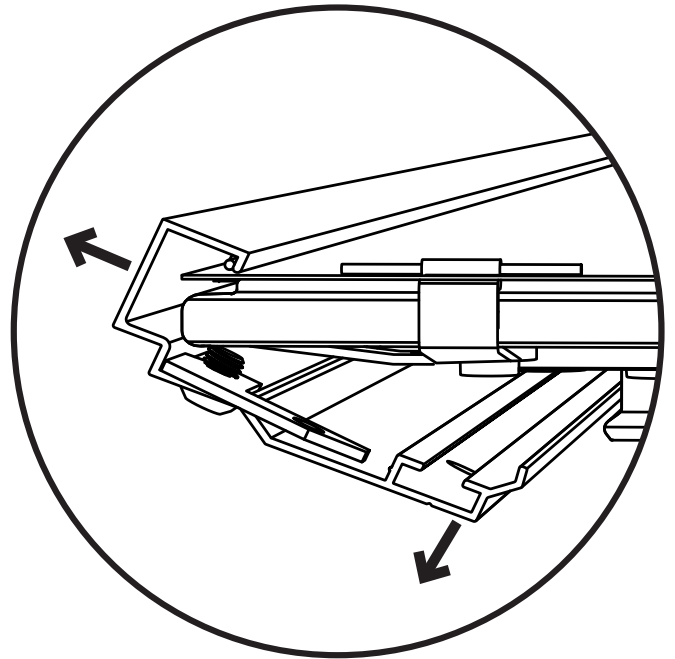
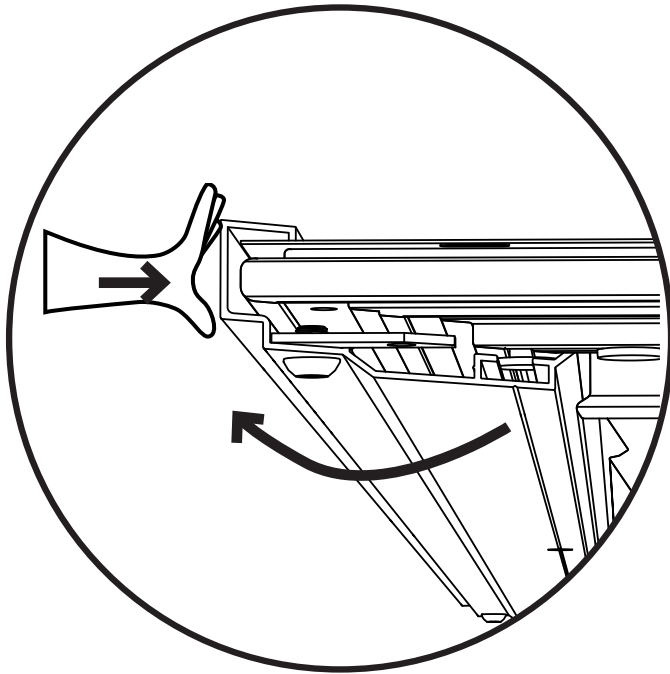

Disconnect the trim at the corners by either removing the screw or loosening the corner plate and sliding over.

Then push in on trim pieces while rotating trim off of frame. The magnet will hold the trim in place at first. Therefore you may need to shake the trim at first to get it to rotate away from the frame.

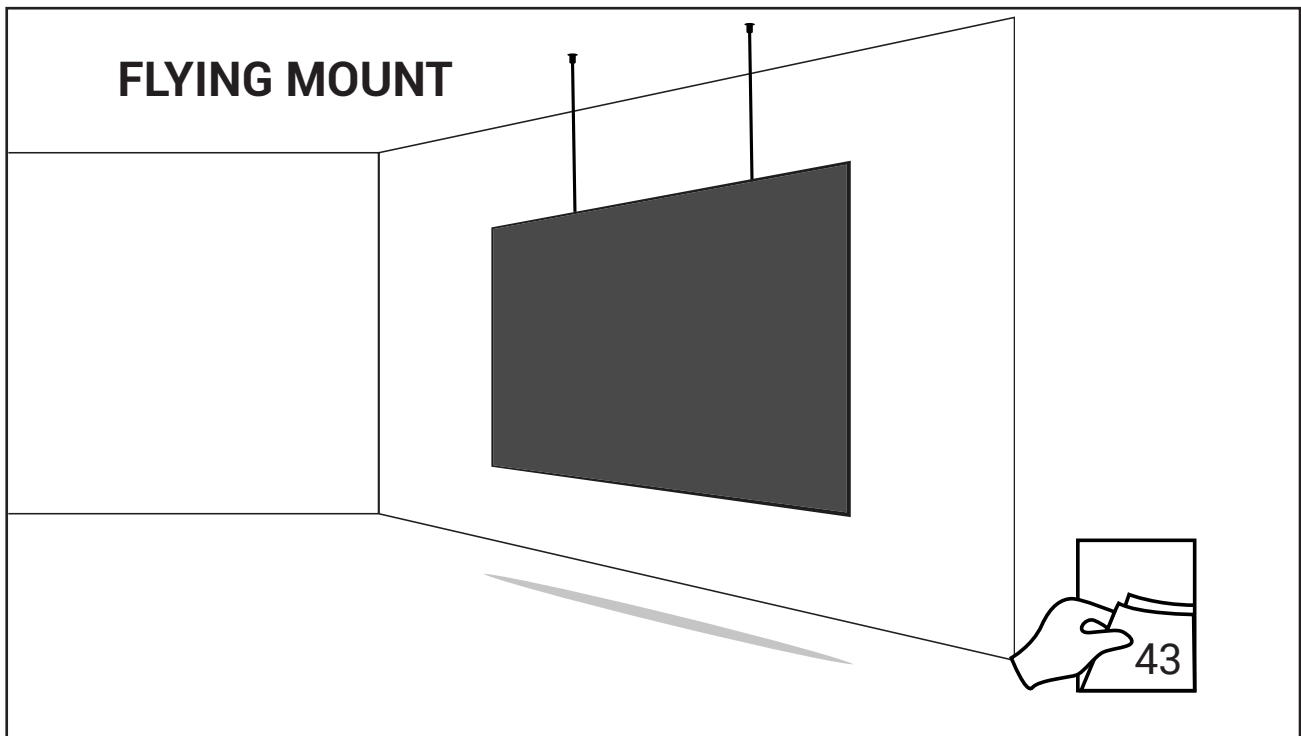
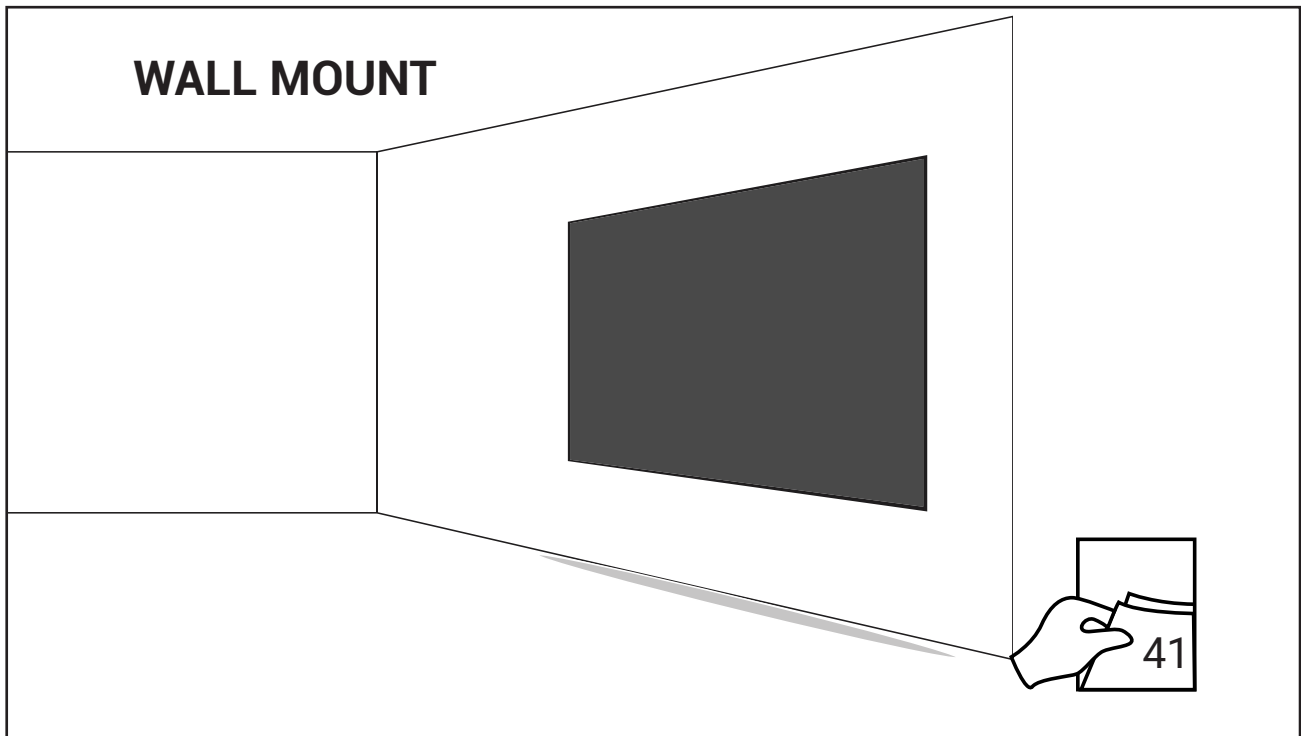

WALL INSTALLATION

1

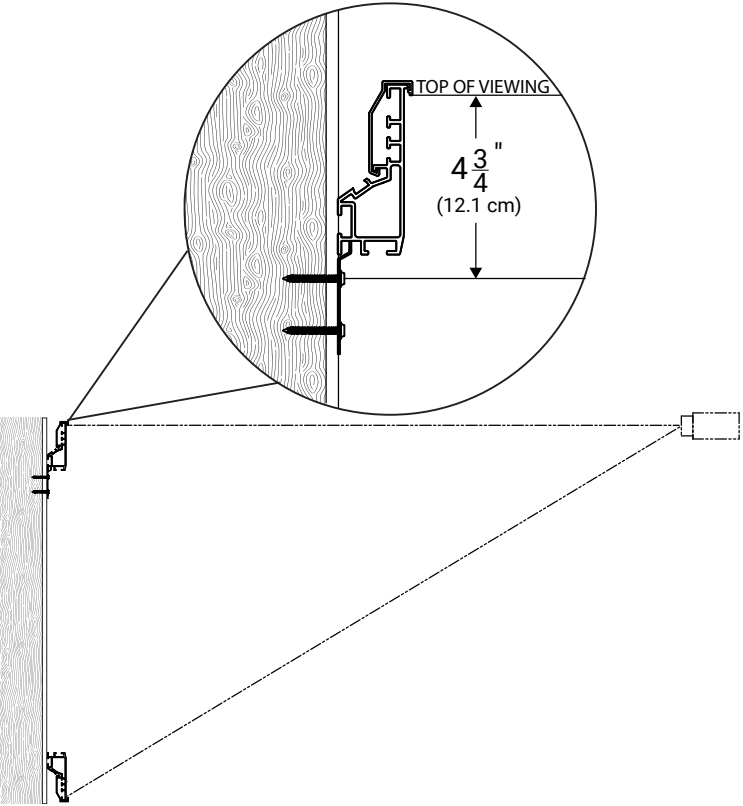
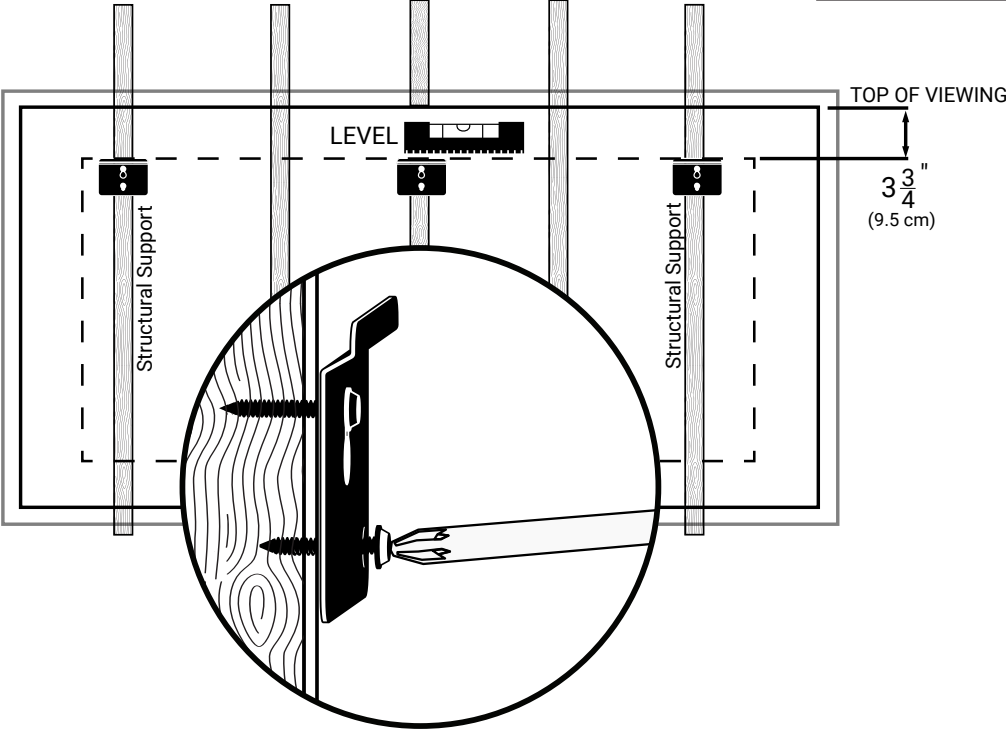
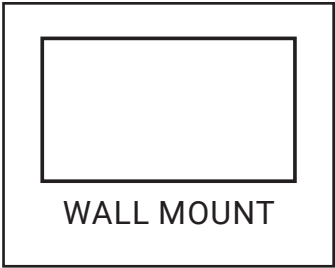

2

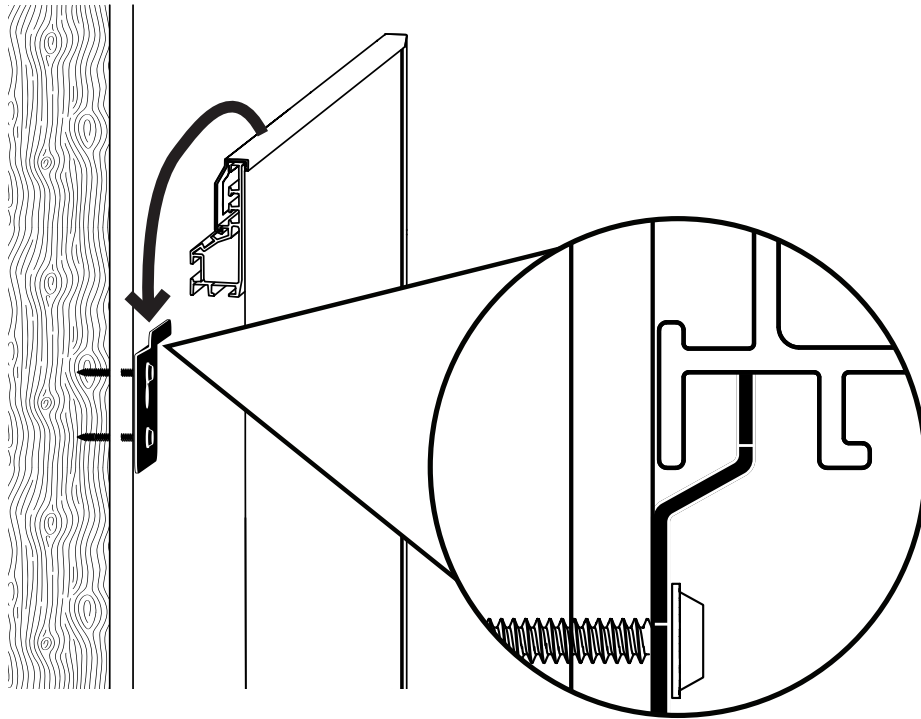
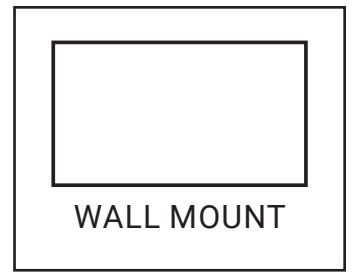

3

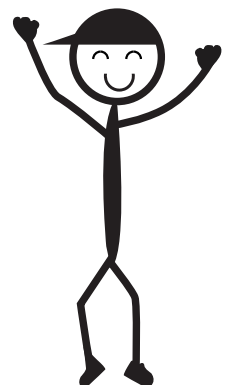
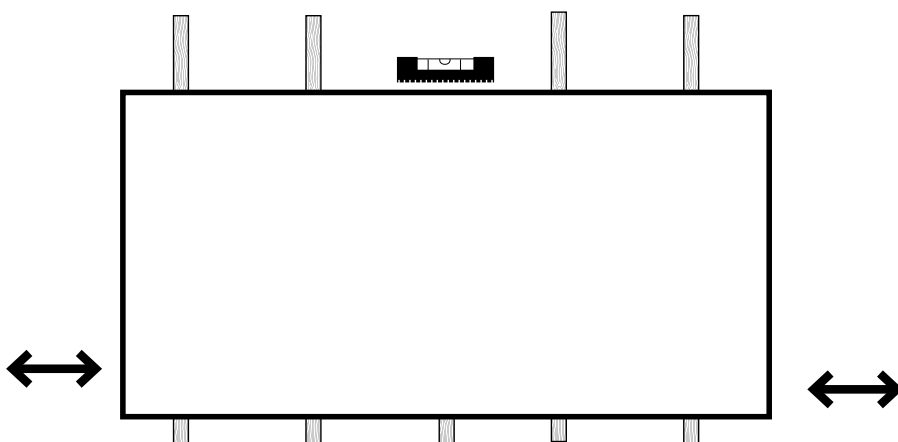

FLOWN INSTALLATION

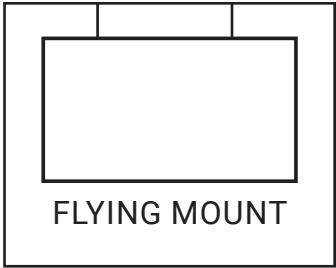

1

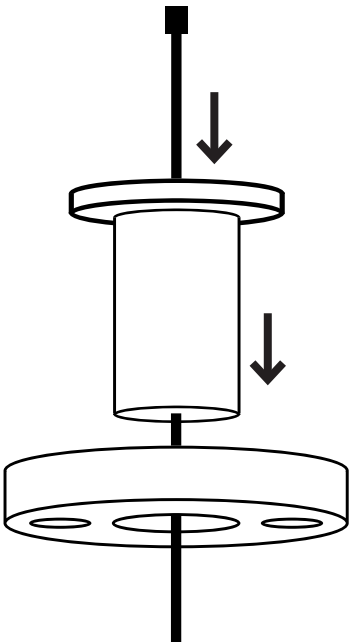

2

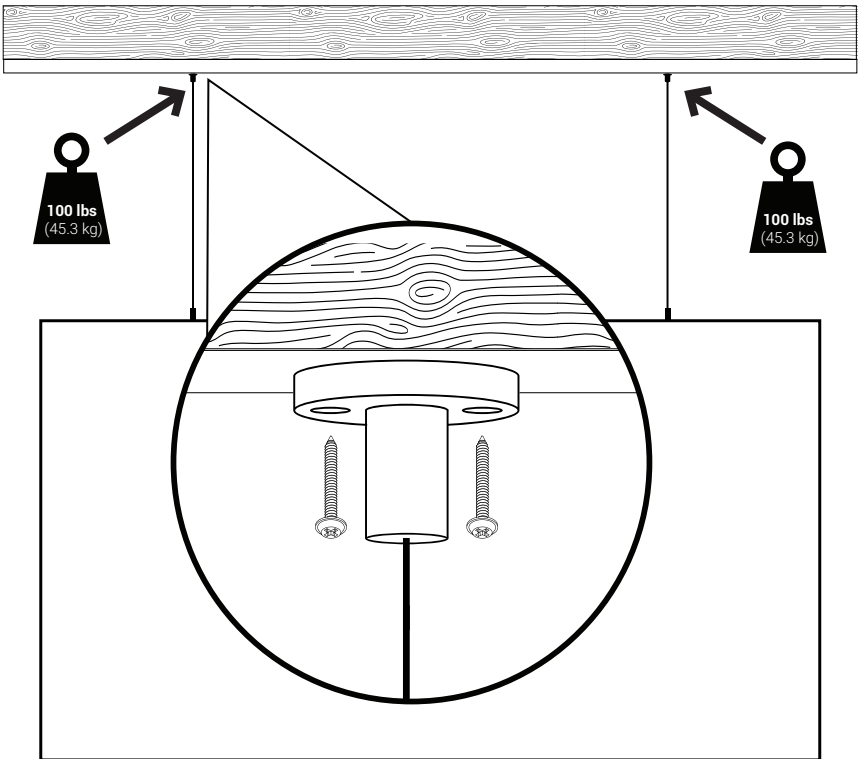

3

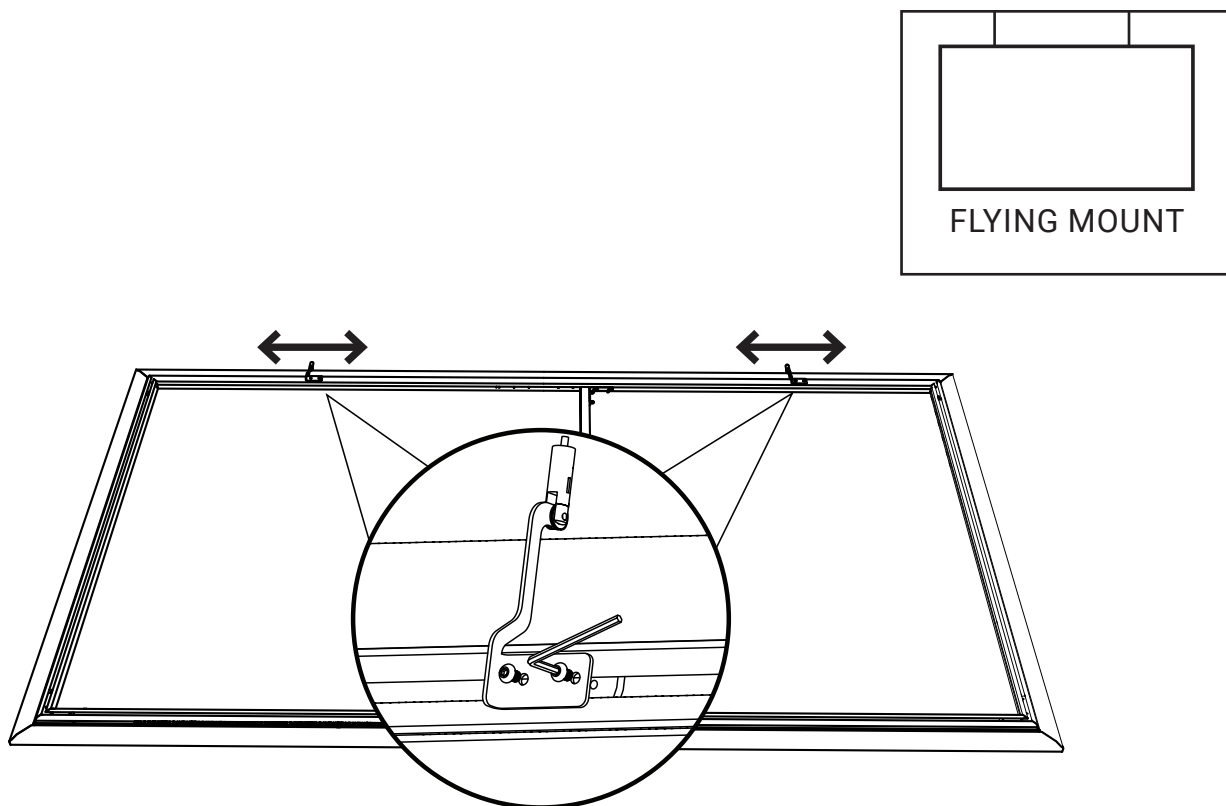

4

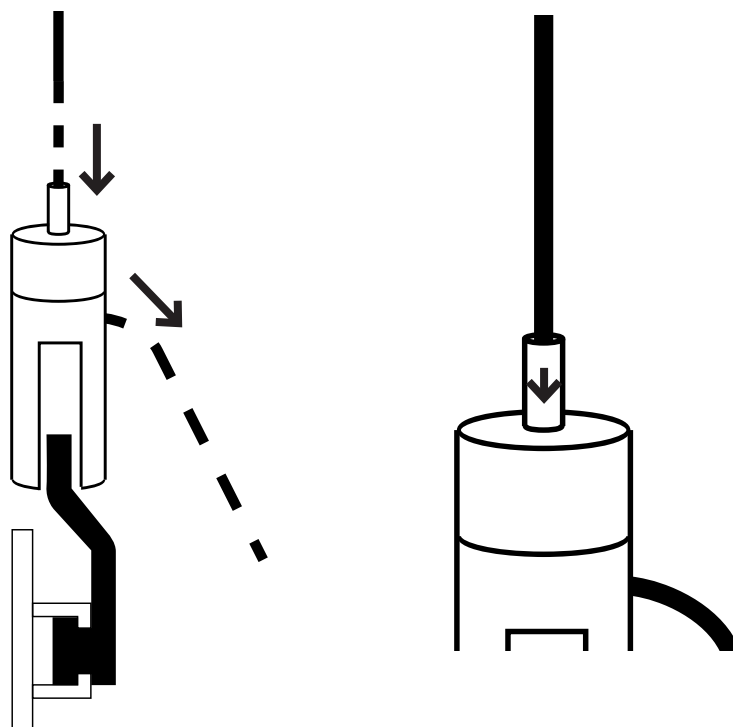

NOTE: If you pull too far the screen can be lowered by pushing down the button on the top of the flying mount.



We recommend you don't cut the extra cables for future adjustability. Simply tape the extra cable to the back of the screen frame.

IR Controlled Option Only

20 13 5C A3	20 13 5D A2	20 13 41 BE	20 13 40 BF
20 13 58 A7	20 13 59 A6	20 13 45 BA	20 13 44 BB
20 13 54 AB	20 13 55 AA	20 13 49 B6	20 13 48 B7
20 13 50 AF	20 13 51 AE	20 13 4D B2	20 13 4C B3
20 13 1C E3	20 13 1D E2	20 13 1E E1	20 13 1F E0
20 13 18 E7	20 13 19 E6	20 13 1A E5	20 13 1B E4
20 13 14 EB	20 13 15 EA	20 13 16 E9	20 13 17 E8
20 13 10 EF	20 13 11 EE	20 13 12 ED	20 13 13 EC
20 13 0C F3	20 13 0D F2	20 13 0E F1	20 13 0F F0
20 13 08 F7	20 13 09 F6	20 13 0A F5	20 13 0B F4
20 13 04 FB	20 13 05 FA	20 13 06 F9	20 13 07 F8

Backlight IP Option Only

Before attempting to connect your LED IP to Phillips Hue, ensure that the Hue Bridge is powered on and connected to the local WIFI network.

- 1. Begin by connecting the power supply to an electrical outlet. After a few seconds, the LEDs should power on to a white color.
- 2. Open the Phillips Hue app on your smart device, and navigate to **Light Setup** in the **settings tab**.
- 3. Press the **Plus** button in the lower right-hand corner, then press **Search**.
- 4. It can take several seconds to connect. Once connected, the LEDs will light green.
- 5. The LED IP will appear in the Phillips Hue app as **Extended Color light 1** and **Dimmable light 1**. Only use **Extended Color Light 1** to control the LED's. **Dimmable Light 1** should be deleted.
- 6. After the LED IP is connected, it can be renamed and used like any Hue lamp.

Reset Instructions (Required to connect to a different Phillips Hue)

- 1. Begin with the LED IP powered on
- 2. Turn off for a minimum of 2 seconds
- 3. Turn on and wait for LEDs to light
- 4. Repeat the off/on procedure a total of four times
- 5. At this point the LEDs will begin blinking for 10 seconds.
- 6. Once the LEDs stop blinking, repeat the off/on procedure two more times
- 7. At this point the LED IP will reset. Once complete, the LEDs will light a white color

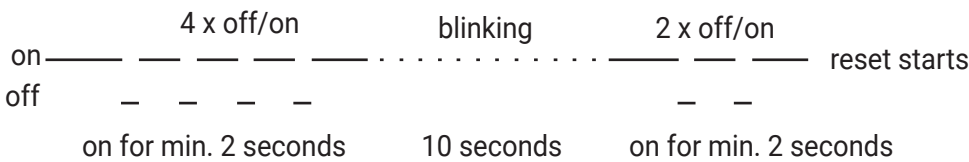

Note: The LED IP can be connected and controlled by only one Phillips Hue Bridge at a time



NOTES:

9715-B Burnet Road Suite 400, Austin, TX 78758

Tel: 512-832-6939 Fax: 512-832-6136

www.screeninnovations.com



NOTES:

9715-B Burnet Road Suite 400, Austin, TX 78758

Tel: 512-832-6939 Fax: 512-832-6136

www.screeninnovations.com