

.....

ULTIMATE DROP BOX, WALL MOUNTED MAILBOX

.....

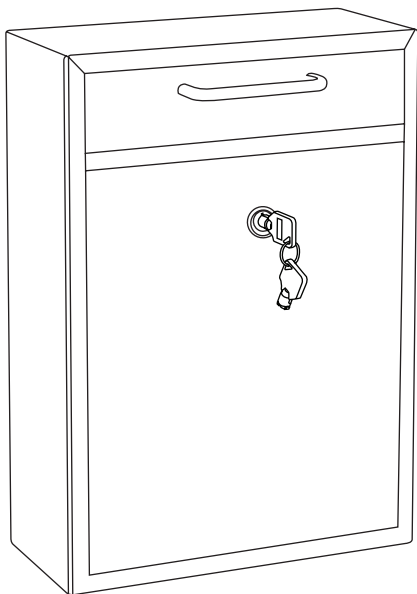

USER GUIDE

ADI631-04/-05-SERIES

Thank you for your purchase.

.....

**AdirOffice maintains a
strong practice of ongoing
development of products
and commercial research.**

.....

**We understand starting and maintaining a business
is expensive enough. We can help you make it cost
effective and beautiful. Plus, our expert team makes
sure everything you need works as efficiently as
possible.**

Table of Contents

- 2** Parts List
- 3** Hardware List
- 4** Tools Needed (But Not Included)
- 5** Assembly Instructions
- 9** Installing The Rain Guard
- 10** Warranty
- 11** Notes

Parts List

A

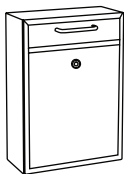

Drop Box

B

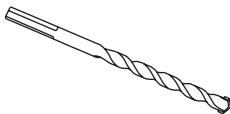

4 mm Drill Bit

C

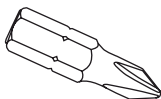

Drive Bit

D

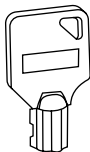

Key

E

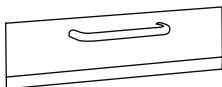

Handle

F

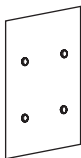

Drilling Template

G



Rain Guard

Hardware List

A

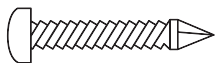

**Mounting Screws
(x4)**

B

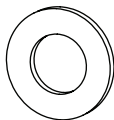

Steel Washers (x4)

C



**Plastic Wall
Anchors (x4)**

D

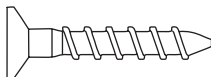

Screws (x2)

Tools Needed (But Not Included)

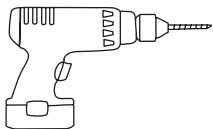

Drill

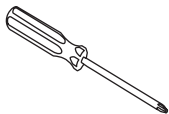

**Phillips Head
Screwdriver**

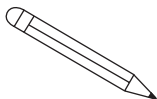

Pencil

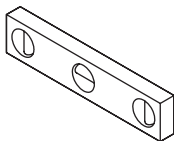

Level

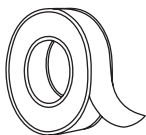

Painter's Tape

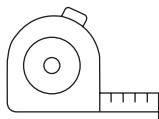

Tape Measure

Assembly Instructions

Step 1:

- A.** Locate the Wall Mounted Mailbox (A).
- B.** Lightly tip it forward, so the door opens.
- C.** Inside you will find the Handle (E) affixed to the door.
- D.** Take your Phillips Head Screwdriver and unscrew the two Screws (4).

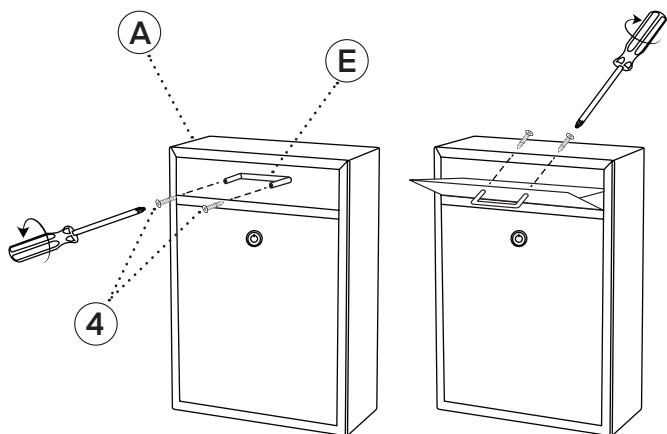

Step 2:

- A.** Locate your Drilling Template (F), apply a small piece of painter's tape, and place it on the wall where you will be installing your mailbox.
- B.** Check to see if the template is level and ensure the top two holes on the template are the correct distance above the floor.
- C.** Mark all four holes with your pencil.

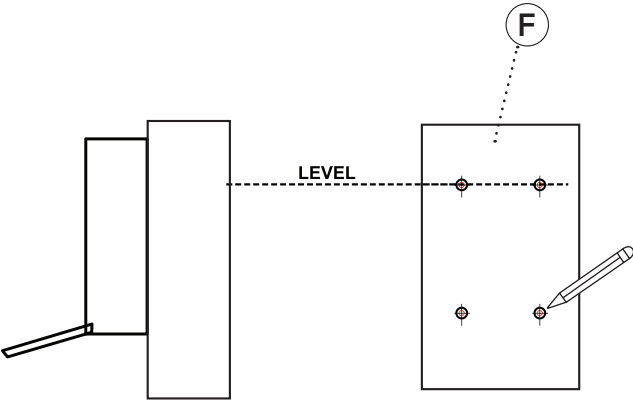

Step 3:

- A.** Using the 4 mm Drill Bit (B) provided, drill four holes, at least .39" deeper than the provided screws, or about 1.57" deep.
- B.** If the material is unusually hard, you may need to use a rotary impact drill rather than a standard drill to make the holes.
- C.** Additionally, you can apply a small amount of caulk or silicone into each hole to help hold the screws.
- D.** Place the Plastic Anchors (3) into the 4 holes.

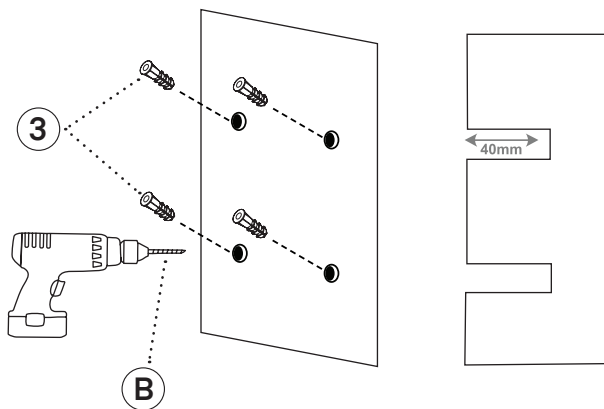

Step 4:

- A.** Unlock the front portion of the Wall Mounted Mailbox (A) with the Key (D).
- B.** Take the four Mounting Screws (1) and thread four Steel Washers (2) onto them.
- C.** Attach the Drive Bit (C) onto your hand drill.
- D.** Hold your Wall Mounted Mailbox (A) up to the pre-drilled holes and carefully screw in all four Mounting Screws (1).
 - Do not over-tighten the screws, or you risk the screws breaking off or stripping the holes.

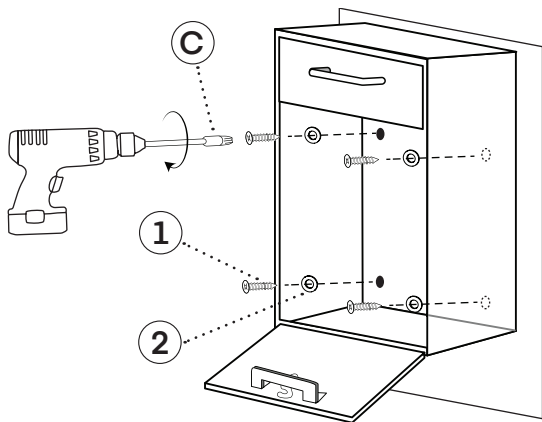

Your Ultimate Drop Box, Wall Mounted Mailbox is ready to use.

Installing The Rain Guard

Step 1:

- A.** Make sure the Drop Box's (A) top is clean and free of dust.
- B.** Remove the plastic backing from the adhesive on the Rain Guard (G).

Step 2:

- A.** Align the edge of the Rain Guard (G) with the front edge of the Drop Box (A).
 - a.** Lightly place the Rain Guard (G) on the Drop Box (A).
 - b.** Before proceeding to the next step, ensure the Rain Guard (G) is properly aligned.

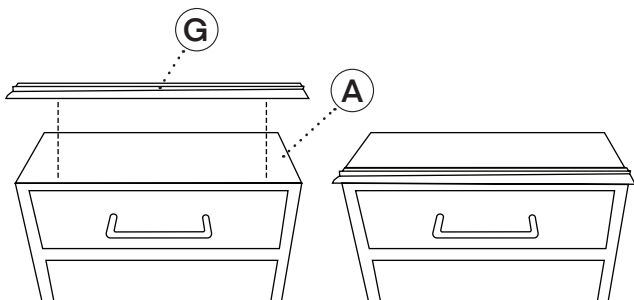

Step 3:

- A.** After confirming that the Rain Guard (G) is positioned and aligns with the edge of the Drop Box (A), firmly press down on the adhesive side of the guard for one minute.

Warranty

1. Adir Corp (the "Company" or "Tiger Companies") warrants to the purchaser that the product will be free from defects in workmanship and materials for a period of 1 year from the date of purchase. The warranty period is not extended if we repair, replace, exchange, or provide a refund for the product (as determined in our sole discretion). We may change the availability of this limited warranty at our discretion, but any changes will not be retroactive.
2. These warranties are not assignable or transferable to any other person, including without limitation, any subsequent owner or other transferee of the product.
3. This Warranty does not apply to: (a) damage caused by misuse, tampering, abuse, neglect, or accident; (b) damage caused by improper installation, modification, or service; (c) alteration of the serial number; or (d) use that violates the instructions furnished by the Company will void this warranty.
4. The sole responsibility of the Company shall be limited to (a) the repair or replacement (in its sole discretion) of any component of the product which fails to conform to this; (b) a refund the purchase price of such product (in its sole discretion), at no cost to the purchaser for the period of the warranty, or (c) an exchange for a similar product, comparable in function and price.
5. Contact the Company directly at 1-(800)-805-1790 to obtain service under this warranty. If it becomes applicable to send a defective product to the Company, a Return Authorization Number must first be obtained from the Company. In order to obtain service under this warranty, purchaser may be required to provide the Company with the following items (a) proof of purchase, (b) photographs and or videos (of the damage, and (c) a written testimonial describing the defect.
6. Products shipped without prior Return Authorization and Return Authorization Number may not be accepted, and the Company will not be responsible for their disposition and/or cost of return to the owner.
7. The Company will not assume any responsibility for any loss or damage incurred in shipping and or delivery.
8. The product(s) must be returned within 14 calendar days of receiving the return authorization from the Company and must include the original proof of purchase for the warranty to be honored.
9. Any implied warranties that the purchaser may have are limited to the duration of the warranties described above. There are no further warranties that extend or apply beyond the face hereof, and the Company expressly disclaims and excludes any and all warranties of merchantability or fitness for a particular purpose. Some states do not allow limitations on how long an implied warranty lasts, so the above limitation may not apply to you.
10. THE REMEDIES DESCRIBED ABOVE ARE YOUR SOLE AND EXCLUSIVE REMEDIES AND THE COMPANY'S ENTIRE LIABILITY FOR ANY BREACH OF THIS LIMITED WARRANTY. OUR LIABILITY SHALL UNDER NO CIRCUMSTANCES EXCEED THE ACTUAL AMOUNT PAID BY YOU FOR THE DEFECTIVE PRODUCT, NOR SHALL WE UNDER ANY CIRCUMSTANCES BE LIABLE FOR ANY CONSEQUENTIAL, INCIDENTAL, SPECIAL OR PUNITIVE DAMAGES OR LOSSES, WHETHER DIRECT OR INDIRECT. SOME STATES DO NOT ALLOW THE EXCLUSION OR LIMITATIONS OF INCIDENTAL OR CONSEQUENTIAL DAMAGES, SO THE LIMITATION MAY NOT APPLY TO YOU.
11. This warranty gives you specific legal rights, and you may also have additional rights which vary from state to state.

Notes

[illegible]

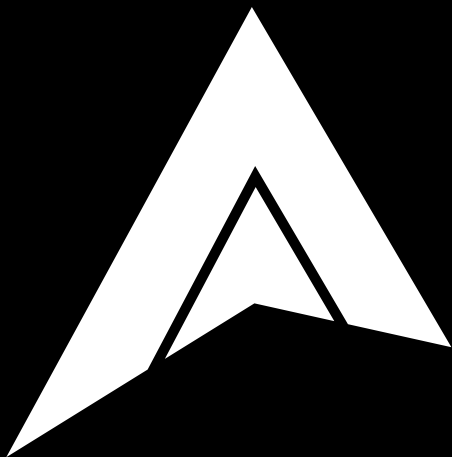

ADI631-04/-05-SERIES

© 2024 Adir Corp

adircorp.com