

# INSIGNIA™

## firetv

### QUICK SETUP GUIDE

# 50"/55"/58"

# LED TV

# 4K ULTRA HD

NS-50F301NA22 / NS-55F301NA22 /

NS-58F301NA22

### INCLUDED ACCESSORIES

Voice Remote with Alexa  
and two AAA batteries



50" 55" 58"

TV stands

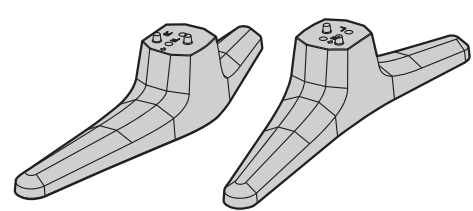

50" 55" 58"

M4 screws  
(20 mm length)  
(4pcs.)

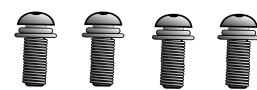

Power cord

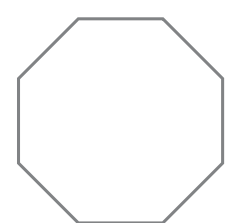
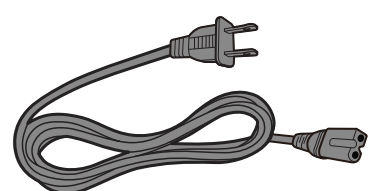

### STOP

Before using your new product, please read these instructions to prevent any damage. Do not plug your power cord in until all other devices have been connected.

## 1 INSTALLING THE STANDS OR A WALL MOUNT

Place your TV face-down on a cushioned, clean surface.

### STANDS

- Align the TV stand screw holes with the holes on your TV's bottom.
- Use a Phillips screwdriver and two provided screws to secure each stand to your TV.

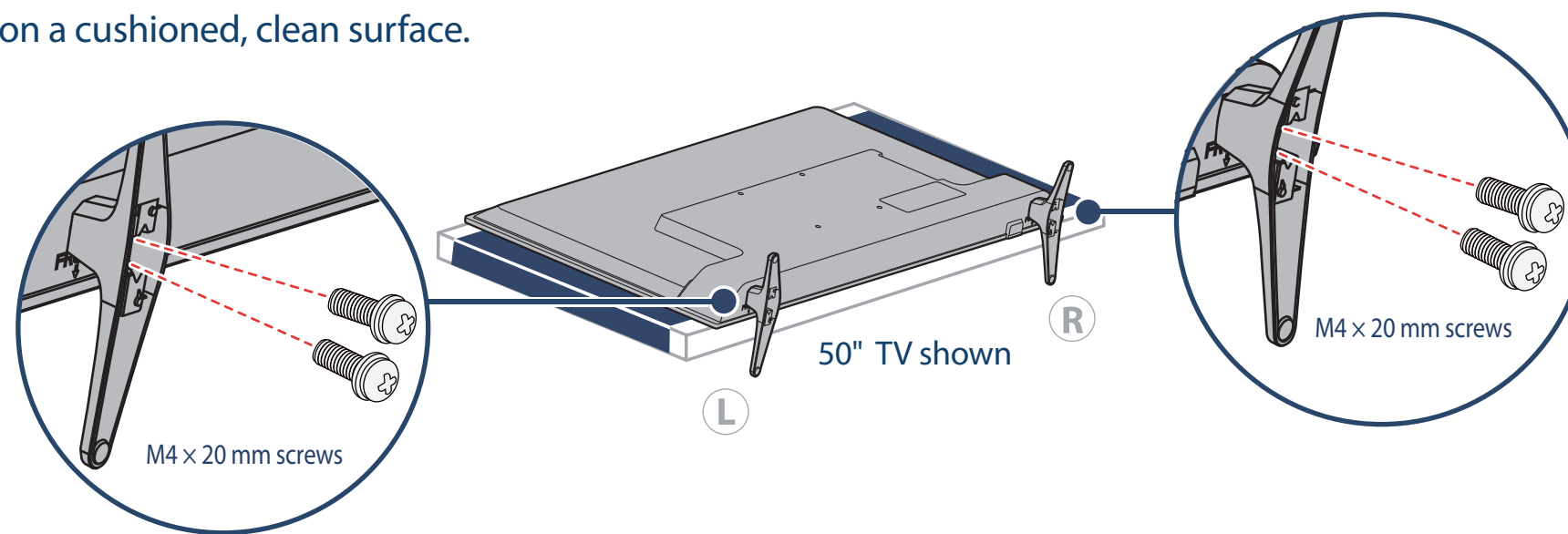

### WALL MOUNT

Before you mount your TV, make sure that:

- You remove the stands.
- The wall-mount bracket supports the weight of your TV.

See the instructions that came with your wall mount for more information about how to correctly mount your TV.

**WARNING:** Your TV has four VESA mounting holes on the back. You must secure a wall-mount bracket to all four holes. If you do not use all four holes, your TV may fall and cause property damage or personal injury.

**Note:** Wall-mount screws are not included.

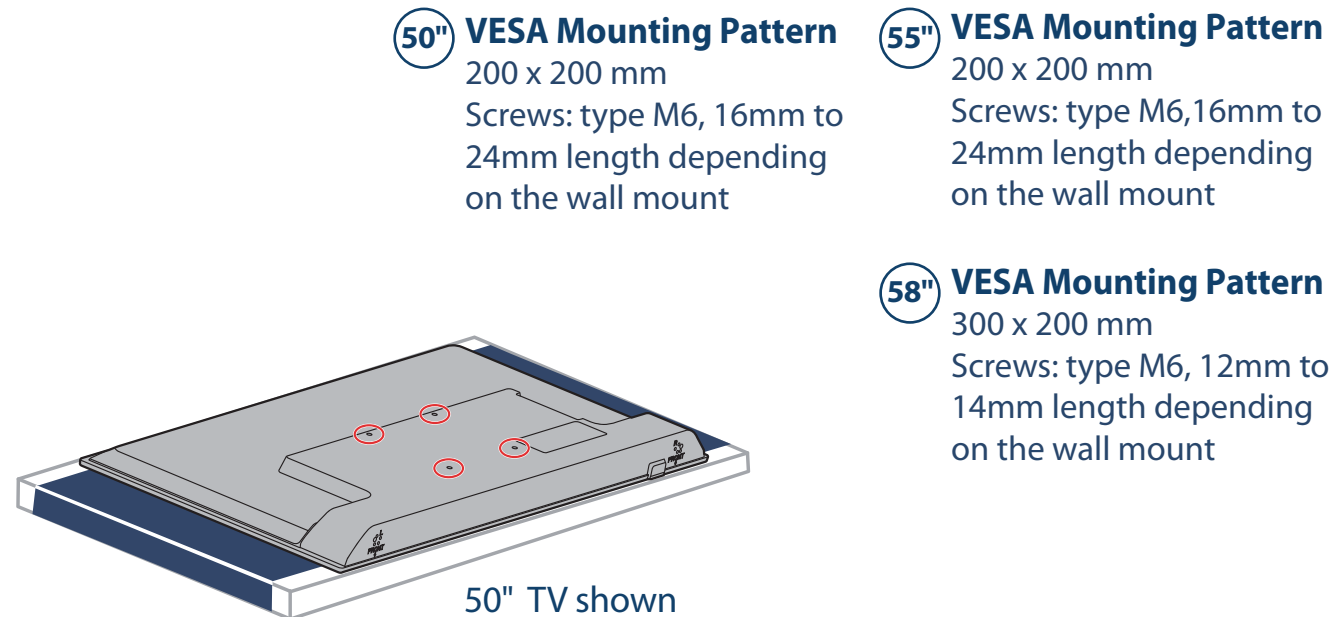

## FEATURES

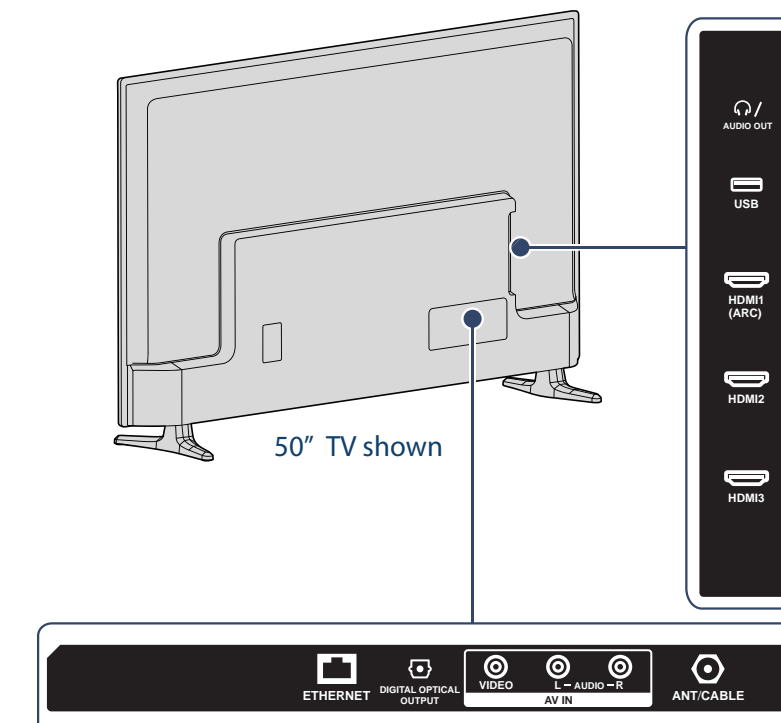
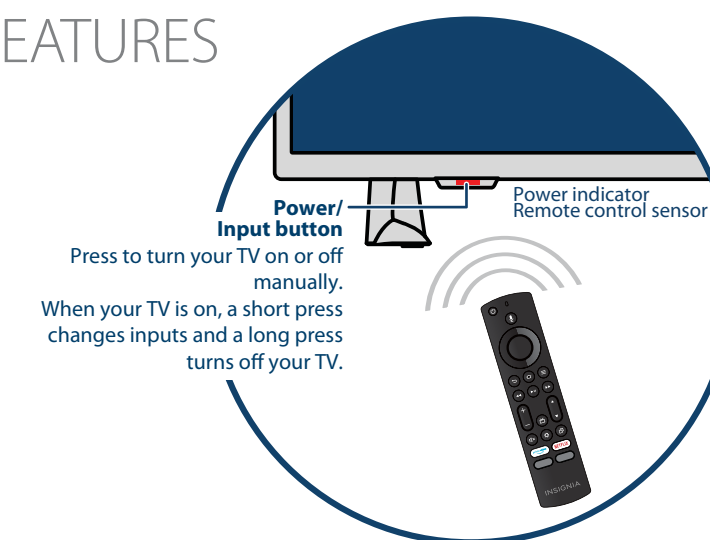

**Note:** Images do not necessarily represent the exact design of your television.

## 2 MAKING CONNECTIONS

### HDMI (best video quality)



**Note:** You can use the **HDMI 1 (eARC/ARC)** jack to connect a digital audio system.

### AV (good video quality)

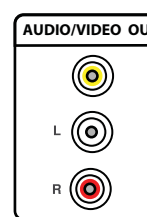

### Coaxial (good video quality)

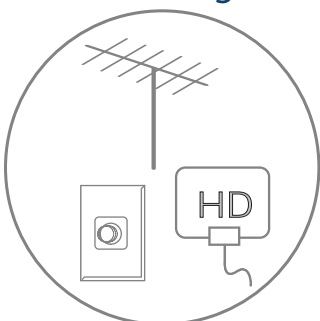

Connect an antenna to access live over-the-air TV.

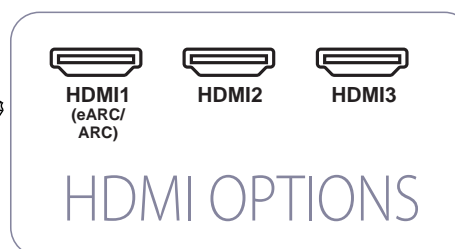
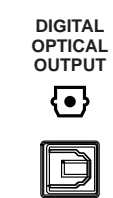

### DIGITAL

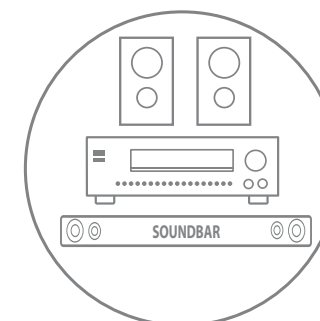

### AUDIO OPTIONS

You can use the **DIGITAL OPTICAL OUTPUT** jack or the **HDMI 1 (eARC/ARC)** jack. **Note:** If you need to change the digital audio format, go to the **Home** menu, select **Settings**, then select **Display & Sounds**. Select **Audio Output**, then select **Digital Audio Format** and change the setting to **PCM** or **Dolby Digital**.

### ANALOG

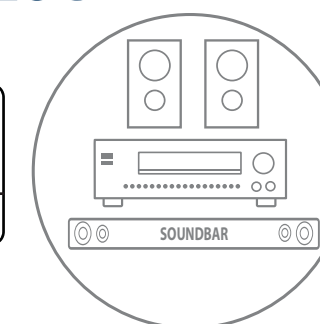
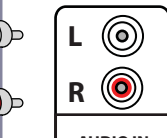

### ETHERNET (optional)



**Note:** You can use a wired Ethernet connection to access the internet instead of a WiFi connection. Plug an Ethernet cable into the **ETHERNET** jack on your TV and your Ethernet connection.

### 3 TURNING ON YOUR TV

1 Plug the power cord into the back of your TV and a power outlet.

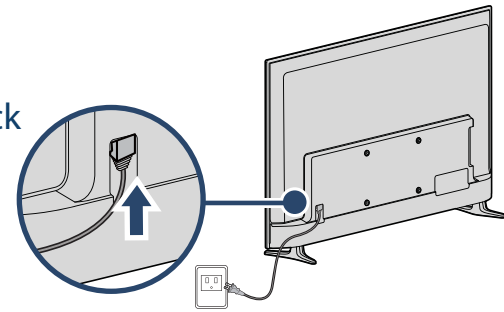

2 Remove the remote control cover and install the batteries.

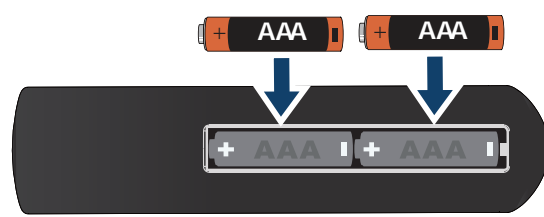

3 Press  on your Voice Remote with Alexa.

4 Follow the on-screen instructions.

### 4 COMPLETE THE ON-SCREEN SETUP

Your TV should automatically pair to your new Voice Remote with Alexa.

1 If your remote is not paired, press . If you continue to have issues, re-insert or replace the batteries and try again.

2 Select your Wi-Fi network from the displayed network list.

**Note:** If your Wi-Fi network is password protected, enter your network password using the on-screen keyboard. If your network is hidden, select the **Join Other Network** tile.

3 Select your experience: **Full** (recommended) or **Basic**.

- Select **Full** to access live TV, over tens of thousands of streaming movies and TV episodes, thousands of apps, and Alexa skills. To get started, sign into or sign up for a free Amazon account.
- Select **Basic** to access live TV and the six preset streaming apps. Alexa and the full Appstore are not included.

4 If you connected your TV to an antenna or cable wall jack:

**A** Go to **Settings > Live TV > Channel Scan**.

**B** Follow the on-screen instructions to scan for channels.

**Note:** To browse and watch live TV, use the **On Now** row or press  on your remote.

## USING YOUR VOICE REMOTE WITH ALEXA

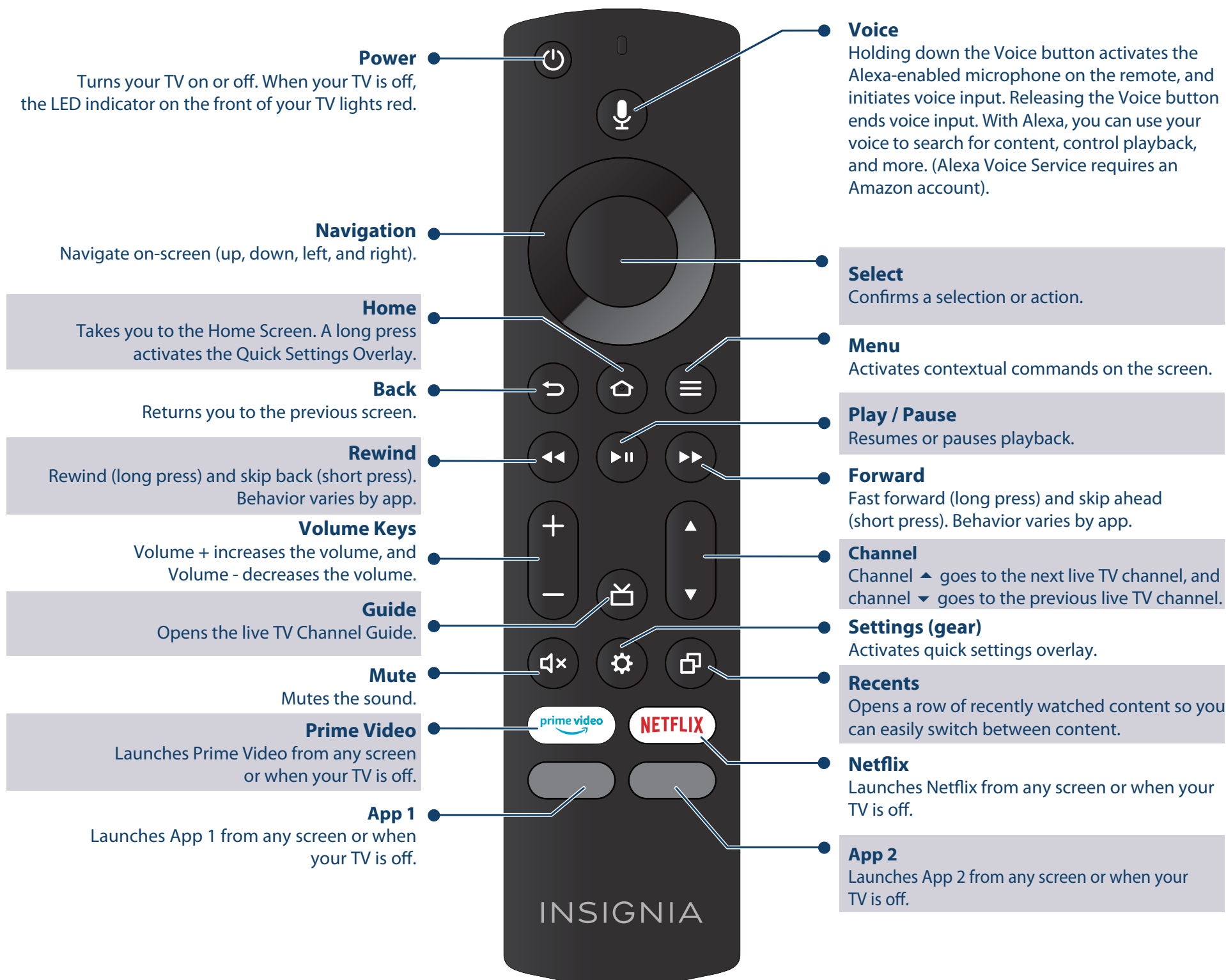

## FIND YOUR USER GUIDE ONLINE

1 Go to [www.insigniaproducts.com](http://www.insigniaproducts.com).

2 Use the search bar to find **NS-50F301NA22**, **NS-55F301NA22** or **NS-58F301NA22**.

3 Select **Support & Downloads**.

4 Next to *User Guide*, select the language you want.

# INSIGNIA™

## fire tv

**A Smarter TV Is Here**  
4K Picture Quality, Fire TV Experience Built-in,  
Voice Remote with Alexa



**Access Your Favorite Content – All Through One Home Screen**

Fire TV seamlessly integrates live over-the-air TV and streaming channels on a unified home screen.



**Endless Entertainment – Netflix, Prime Video, YouTube, Hulu, HBO Max, and more**

Watch over 500,000 streaming movies and TV episodes with access to tens of thousands of channels, apps, and Alexa skills.



**Voice Remote with Alexa**

Just press and ask to easily find, launch, and control movies and TV shows.

Full Experience required to access all features described.

**ONE-YEAR LIMITED WARRANTY**

Visit [www.insigniaproducts.com](http://www.insigniaproducts.com) for details.

**NEED ADDITIONAL HELP?**

Check out our **Support Community** at <http://community.insigniaproducts.com/> for helpful information from other Insignia TV owners.

**WE'RE HERE FOR YOU**

[www.insigniaproducts.com](http://www.insigniaproducts.com)

For customer service, call: **1-877-467-4289** (U.S./Canada)

**CONTACT AMAZON FIRE TV CUSTOMER SERVICE**

[www.amazon.com/deviceservices/support](http://www.amazon.com/deviceservices/support)

Press & ask



For DTS patents, see <http://patents.dts.com>. Manufactured under license from DTS, Inc. DTS, DTS Studio Sound, and the DTS logo are registered trademarks or trademarks of DTS, Inc. in the United States and other countries.  
© 2020 DTS, Inc. ALL RIGHTS RESERVED.

**AMAZON TERMS & POLICIES**

Before using Fire TV Edition, please read the terms located at [www.amazon.com/deviceservices/support](http://www.amazon.com/deviceservices/support). Please also read all terms and policies for services related to Fire TV Edition, including but not limited to Amazon's Privacy Notice located at [www.amazon.com/privacy](http://www.amazon.com/privacy), Amazon's Conditions of Use located at [www.amazon.com/conditionsofuse](http://www.amazon.com/conditionsofuse), and any other terms or usage provisions available at [www.amazon.com/deviceservices/support](http://www.amazon.com/deviceservices/support).

All terms, rules, notices, policies, and provisions are, collectively, the "Agreements." By using Fire TV Edition, you agree to be bound by the terms of the Agreements.

Amazon, Fire, and all related marks are trademarks of Amazon.com, Inc. or its affiliates.

Certain services are subject to change at any time, may not be available in all areas and languages, or in 4K UHD, and may require separate subscriptions or withdrawal.



Dolby, Dolby Audio, and the double-D symbol are trademarks of Dolby Laboratories Licensing Corporation. Manufactured under license from Dolby Laboratories. Confidential unpublished works.  
Copyright © 1992–2020 Dolby Laboratories. All rights reserved.

**U.S. and Canada:**

INSIGNIA is a trademark of Best Buy and its affiliated companies. Registered in some countries. Distributed by Best Buy Purchasing, LLC 7601 Penn Ave South, Richfield, MN 55423 U.S.A.

©2021 Best Buy. All rights reserved.

V2 ENGLISH 21-0337