

## 160 Pints Commercial Dehumidifier with Pump Drain

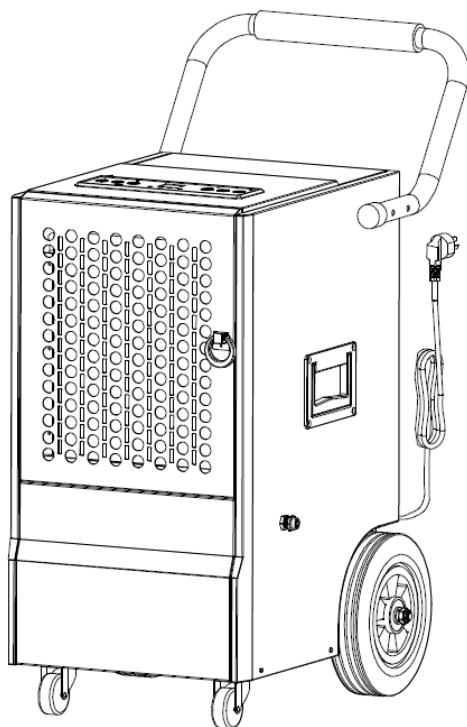

### OWNER'S MANUAL

Manuel de L'utilisateur

Manual del Propietario





## A Name You Can Trust

Trust should be earned and we will earn yours. Customer happiness is the focus of our business.

From the factory to the warehouse, from the sales floor to your home, the whole Newair family promises to provide you with innovative products, exceptional service, and support when you need it the most.

### Count on Newair

As a proud Newair owner, welcome to our family. There are no robots here, real people shipped your product and real people are here to help you.

### Contact Us

Please reach out to our customer service team before making a return to your store of purchase. We are happy to help with any questions or concerns!

Mon-Fri from 8-4 PST at:

**Call:** 1-855-963-9247 | **Email:** [support@newair.com](mailto:support@newair.com) | **Online:** [www.newair.com](http://www.newair.com)

A team member will respond to you within 24 hours.

### Follow Us



Facebook.com/newairusa



Instagram.com/newairusa



YouTube.com/newairusa



Twitter.com/newairusa

## REGISTER YOUR PRODUCT ONLINE

### Register Your Newair Product Online Today!

Take advantage of all the benefits product registration has to offer:



#### Service and Support

Diagnose troubleshooting and service issues faster and more accurately



#### Recall Notifications

Stay up to date for safety, system updates and recall notifications



#### Special Promotions

Opt-in for Newair promotions and offers

**Registering your product information online is safe & secure and takes less than 2 minutes to complete:**

[newair.com/register](http://newair.com/register)

Alternatively, we recommend you attach a copy of your sales receipt below and record the following information, located on the manufacturer's nameplate on the rear of the unit. You will need this information if it becomes necessary to contact the manufacturer for service inquiries.

<b>Date of Purchase:</b>	
<b>Serial Number:</b>	
<b>Model Number:</b>	



## READ AND SAVE THESE INSTRUCTIONS

### TABLE OF CONTENTS

Register Your Product Online .....	2
Table Of Contents .....	3
Specifications .....	3
Safety Information & Warnings .....	4
Parts List .....	8
Assembly & Installation .....	9
Package contents .....	9
Installation and Operation .....	9
Operating Instructions .....	11
The Control Panel .....	11
During Operation .....	12
Cleaning & Maintenance .....	13
Cleaning your dehumidifier .....	13
Storage requirement .....	13
Troubleshooting .....	14
Limited Manufacturer's Warranty .....	15

### SPECIFICATIONS

<b>MODEL NO.</b>	NCD160GA00
<b>VOLTAGE</b>	110-120V
<b>CURRENT</b>	920W @ 86°F, 80% RH
<b>FREQUENCY</b>	60Hz
<b>CAPACITY</b>	45 PPD (65 °F/60% RH) 120 PPD (86 °F/80% RH) 160 PPD (95 °F/90% RH)
<b>COVERAGE</b>	Up to 8000 sq. ft.
<b>DRAIN TYPE</b>	Pump Drain
<b>NET WEIGHT</b>	80 lbs
<b>PRODUCT SIZE(W×H×D)</b>	16" x 31" x 24.8"
<b>REFRIGERANT</b>	R32 (6.71 oz)



## SAFETY INFORMATION & WARNINGS



### **Your safety and the safety of others are very important to us.**

We have provided many important safety messages in this manual and on your appliance. Always read and obey all safety messages.

To reduce the risk of fire, electric shock, or personal injury, thoroughly read the manual and all instructions completely and carefully. Store this manual in a safe place for future reference. All owners, current or future, must have access to this manual.

### **WARNING**

- To avoid accidents or serious injury, all people using this appliance must be familiar with the contents of this User Manual, including Safety Information. The manufacturer is not responsible for damages or injury caused using this device outside of normal operations.
- This appliance is intended to be used by expert or trained users in shops, in light industry and on farms, or for commercial use by lay persons.
- This appliance is not recommended for use by children ages 8 years and under and persons with reduced physical, sensory, or mental capabilities unless supervised.
- This product is not a toy. Children shall not play with the or inside appliance. Small children and pets should be supervised when using the fridge.
- Cleaning and maintenance should be conducted by a suitable adult or child ages 8 years and above under supervision.
- The unit is designed only for use with R32(propane) gas as the designated refrigerant.
- The refrigerant loop is sealed. Only a qualified technician should attempt to service.
- Do not discharge the refrigerant into the atmosphere.
- R32 (propane) is flammable and heavier than air. It collects first in low areas but can be circulated by the fans.
- If propane gas is present or even suspected, do not allow untrained personnel to attempt to find the cause.
- The propane gas used in the unit has no odor. The lack of smell does not indicate a lack of escaped gas.
- If a leak is detected, immediately evacuate all persons from the store, ventilate the room and contact the local fire department to advise them that a propane leak has occurred.
- Do not let any persons back into the room until the qualified service technician has arrived and that technician advises that it is safe to return to the room.
- No open flames, cigarettes or other possible sources of ignition should be used inside or in the vicinity of the units.
- Component parts are designed for propane and non-incentive and non-sparking. Component parts shall only be replaced with identical repair parts.

**FAILURE TO ABIDE BY THIS WARNING COULD RESULT IN AN EXPLOSION, DEATH, INJURY AND PROPERTY DAMAGE.**



## IMPORTANT SAFETY INSTRUCTIONS





**Warning; Risk of fire / flammable materials**

### GENERAL SAFETY

- If the supply power cord is damaged, it must be replaced by the manufacturer, its service agent or similarly qualified persons in order to avoid a hazard.
- The appliance shall be disconnected from its power source during service.
- Always operate the unit from a power source of equal voltage, frequency and rating as indicated on the product identification plate.
- Always use a power outlet that is grounded.
- Unplug the power cord when cleaning or when not in use.
- Do not operate with wet hands. Prevent water from spilling onto the unit.
- Do not immerse or expose the unit to rain, moisture or any other liquid.
- Do not leave the unit running unattended. Do not tilt or turn over the unit.
- Do not unplug while the unit is operating.
- Do not unplug by pulling on the power cord.
- Do not use an extension cord or an adapter plug.
- Do not put objects on the unit.
- Do not climb or sit on the unit.
- Do not insert fingers or other objects into the air outlet.
- Do not touch the air inlet or the aluminum fins of the unit.
- Do not operate the unit if it is dropped, damaged or showing signs of product malfunction.
- Do not clean the appliance with any chemicals.
- Ensure the unit is far away from fire, inflammable, or explosive objects.
- The unit shall be installed in accordance with national wiring regulations.
- Do not use means to accelerate the defrosting process or to clean, other than those recommended by the manufacture.
- The appliance shall be stored in a room without continuously operation sources (for example: open flames, an operating gas appliance or an operating electric heater).
- The appliance shall be stored so as to prevent mechanical damage from occurring.
- Do not piece or burn, even after use.
- Be aware that refrigerants may not contain an odour.
- Pipe-work shall be protected from physical damage and shall not be installed in an unventilated space, if that space is smaller than 8 m<sup>2</sup> (86 sq. ft).
- Compliance with national gas regulations shall be observed.
- Keep any required ventilation openings clear of obstruction.
- The appliance shall be stored in a well-ventilated area where the room size corresponds to the room area as specified for operation.



 <b>WARNING</b>	<p><b>Any person who is involved with working on or breaking into a refrigerant circuit should hold a current valid certificate from an industry-accredited assessment authority, which authorizes their competence to handle refrigerants safely in accordance with an industry, recognized assessment specification.</b></p>
 <b>WARNING</b>	<p><b>Servicing shall only be performed as recommended by the equipment manufacturer. Maintenance and repair requiring the assistance of other skilled personnel shall be carried out under the supervision of the person competent in the use of flammable refrigerants.</b></p>

If you don't understand something or need help, please contact the manufacturer for services.

### SAFETY PRECAUTIONS ON SERVICING

Please follow these warnings when servicing an appliance with R32.

- **Checks to the area**  
Prior to beginning work on systems containing flammable refrigerants, safety checks are necessary to ensure that the risk of ignition is minimized. For repair to the refrigerating system, the following precautions shall be complied with prior to conducting work on the system.
- **Work procedure**  
Work shall be undertaken under a controlled procedure so as to minimize the risk of a flammable gas or vapor being present while the work is being performed.
- **General work area**  
All maintenance staff and others working in the local area shall be instructed on the nature of work being carried out. Work in confined spaces shall be avoided. The area around the work space shall be sectioned off. Ensure that the conditions within the area have been made safe by control of flammable material.
- **Checking for presence of refrigerant**  
The area shall be checked with an appropriate refrigerant detector prior to and during work, to ensure the technician is aware of potentially flammable atmospheres. Ensure that the leak detection equipment being used is suitable for use with flammable refrigerants, i.e. no sparking, adequately sealed or intrinsically safe.
- **Presence of fire extinguisher**  
If any hot work is to be conducted on the refrigeration equipment or any associated parts, appropriate fire extinguishing equipment shall be available to hand. Have a dry powder or CO2 fire extinguisher adjacent to the charging area.
- **No ignition sources**  
No person carrying out work in relation to a refrigeration system which involves exposing any pipe work that contains or has contained flammable refrigerant shall use any sources of ignition in such a manner that it may lead to the risk of fire or explosion. All possible ignition sources, including cigarette smoking, should be kept sufficiently far away from the site of installation, repairing, removing and disposal, during which flammable refrigerant can possibly be released to the surrounding space. Prior to work taking place, the area around the equipment is to be surveyed to



make sure that there are no flammable hazards or ignition risks. “No Smoking” signs shall be displayed.

- **Ventilated area**  
Ensure that the area is in the open or that it is adequately ventilated before breaking into the system or conducting any hot work. A degree of ventilation shall continue during the period that the work is carried out. The ventilation should safely disperse any released refrigerant and preferably expel it externally into the atmosphere.
- **Checks to the refrigeration equipment**  
Where electrical components are being changed, they shall be fit for the purpose and to the correct specification. At all times the manufacturer’s maintenance and service guidelines shall be followed. If in doubt consult the manufacturer’s technical department for assistance.
- **The following checks shall be applied to installations using flammable refrigerants:**
  - The charge size is in accordance with the room size within which the refrigerant containing parts are installed;
  - The ventilation machinery and outlets are operating adequately and are not obstructed;
  - If an indirect refrigerating circuit is being used, the secondary circuit shall be checked for the presence of refrigerant;
  - Marking to the equipment continues to be visible and legible. Markings and signs that are illegible shall be corrected;
  - refrigeration pipe or components are installed in a position where they are unlikely to be exposed to any substance which may corrode refrigerant containing components, unless the components are constructed of materials which are inherently resistant to being corroded or are suitably protected against being so corroded.
- **Checks to electrical devices**  
Repair and maintenance to electrical components shall include initial safety checks and component inspection procedures. If a fault exists that could compromise safety, then no electrical supply shall be connected to the circuit until it is satisfactorily dealt with. If the fault cannot be corrected immediately but it is necessary to continue operation, an adequate temporary solution shall be used. This shall be reported to the owner of the equipment so all parties are advised.
- **Initial safety checks shall include:**
  - Those capacitors are discharged: this shall be done in a safe manner to avoid possibility of sparking;
  - That there no live electrical components and wiring are exposed while charging, recovering or purging the system;
  - That there is continuity of earth bonding.

### **WARNING!**

- Install the unit in rooms which exceed 8 m<sup>2</sup>.
- Do not install the unit in a place where inflammable gas may leak.

### **NOTE!**

The manufacture may provide other suitable example or may provide additional information about the refrigerant odor.



# PARTS LIST

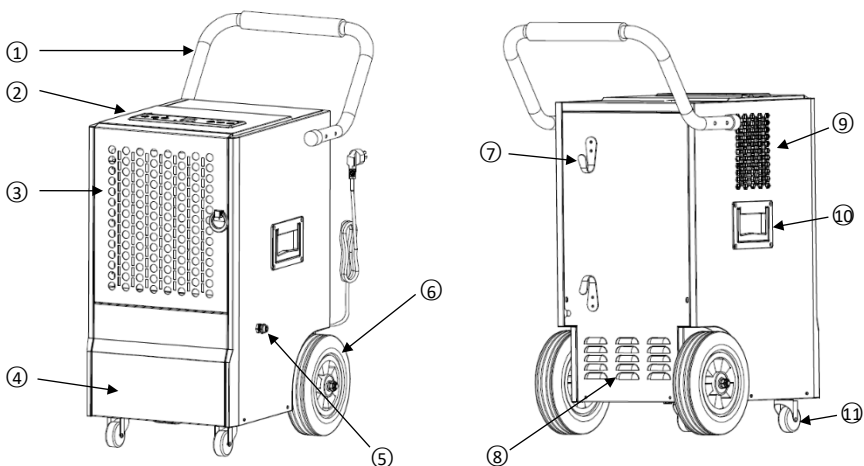

1. Handle

2. Control Panel

3. Air Inlet

4. Drain Pump Cover

5. Drain Outlet

6. Rear Wheels

7. Power Cord Hooks

8. Lower Vents

9. Air Outlet

10. Side Handle

11. Front Casters



## ASSEMBLY & INSTALLATION

### PACKAGE CONTENTS

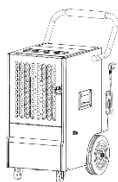

Dehumidifier x 1



User Manual x 1



Drain Hose  
(Length: 16.8 ft., Ø 0.5")



M6x35 Bolt x 6



Handle x 1

### INSTALLATION AND OPERATION

#### Handle Installation

Attach the handle to the appliance and tighten the screws as shown below.

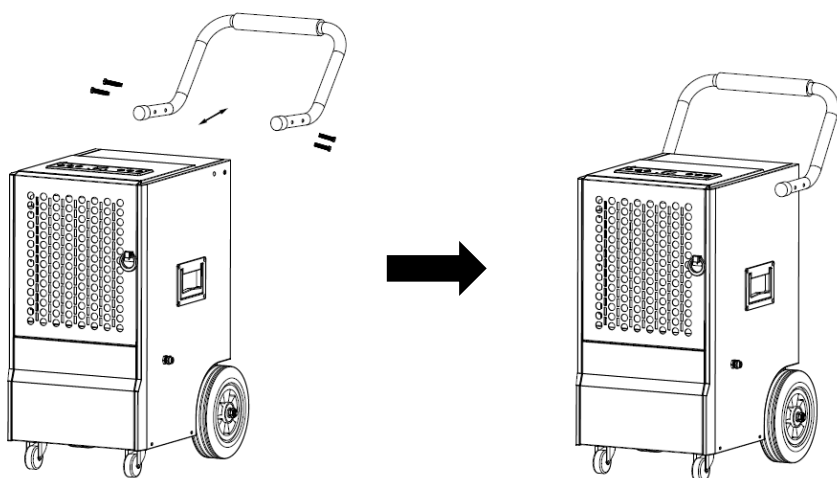



### Drain hose Installation

- Remove the hex nut on the drain hole located at the left side of the unit.
- Insert the PVC drain hose (included) through the hex nut into the drain hole and fasten the hex nut back to the drain hole. Place the other end of the hose to the desired area for drainage.

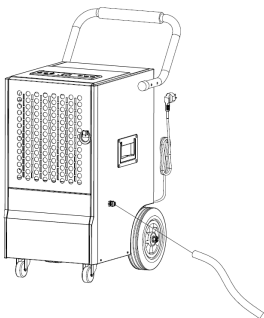

- The pump will automatically drain off water when its tank is full.
- Press the “DRAIN” button on the control panel to turn on the drain pump manually. The pump will operate for 30 seconds and automatically shut down. Repeatedly press this button to drain the unit completely.

### Placing the Dehumidifier

- Place the appliance on a firm and horizontal surface.
- Make sure there is at least 12” of clearance from all sides including the top of the dehumidifier.
- Do not install the appliance in locations that may be exposed to:
  - ✗ Heat sources such as radiators, heat registers, stoves, and etc.
  - ✗ Possible splashing of oil or water
  - ✗ Direct sunlight
  - ✗ Mechanical vibration or shock
  - ✗ Excessive dust
  - ✗ Lack of ventilation, such as a cabinet
  - ✗ Uneven surfaces



## OPERATING INSTRUCTIONS

### THE CONTROL PANEL

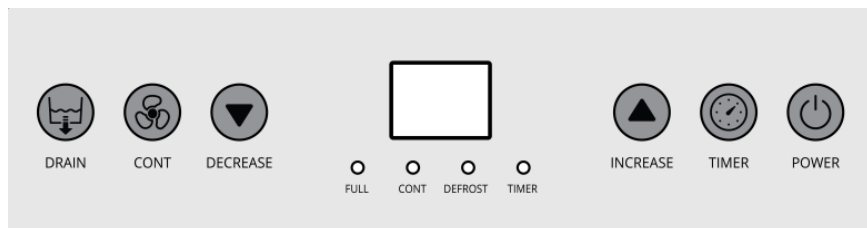

**POWER:** Press the button to turn on or off the unit. The fan and pump will continue to run for 1 minute after the unit is turned off.



**DRAIN:** Press and hold this button for 3-5 seconds to manually drain the water. The pump will operate for 30 seconds and automatically turn off. Repeat this step until all water is drained.

**Note:** The water pump will drain the water when the tank is full. You may also use this manual drain feature to drain the water at any level.



**CONT:** Press this button to toggle Continuous Mode on or off. When Continuous Mode is active, the CONT indicator will light up, and the screen will display current humidity. The unit will operate continuously regardless of the ambient humidity level.

Press the button again to deactivate Continuous mode and the unit will automatically operation until set humidity leve is reached.



#### Set Humidity level and Timer:

Press and hold the DECREASE and INCREASE button to set humidity level and timer.



**TIMER:** Press this button to activate and deactivate the Auto On and Auto Off Timer.

**Auto On Timer:** Press this button while the unit is off. The "Timer" indicator will light up. Press the INCREASE and DECREASE button to set the time you want to start the dehumidifier.

**Auto Off Time:** Press this button while the unit is on. The "Timer" indicator will light up. Press the INCREASE and DECREASE button to set the time you want to turn off the dehumidifier.

Press and hold this button along with the POWER button for 5 seconds to display the ambient temperature. After 5 seconds, the display will revert to showing the ambient humidity level.





## Humidity and Temperature Display



Light up when the water tank is full. Drain pump will automatically start drawing for 30 seconds.



Light up when the unit is in defrost mode.



Light up when the unit is in Continuous Drain mode.



Light up when timer is activated.

## DURING OPERATION

- The compressor and the fan will turn off automatically when the ambient temperature is below 41 °F or above 100 °F
- The system features auto memory function that will resume the previous operation mode once the power is restored after outage.
- Drain the water tank manually before storing or moving the unit.



## CLEANING & MAINTENANCE

Before cleaning or maintenance, switch off the appliance and disconnect the power plug from the main socket.



(1) Open the front panel of the dehumidifier

(2) Slide up to remove the filter



(3) Use a clean rag or vacuum cleaner to gently remove the dust on the filter surface.

(4) Wash the filter with water and a mild detergent and dry it thoroughly.

(5) Put the filter back in place and close the front panel of the dehumidifier.

### CLEANING YOUR DEHUMIDIFIER

Clean the appliance exterior with a soft wet cloth. DO NOT use cleanser, steel balls, chemically treated dust-proof cloth, gasoline, benzene, thinners, or other chemical solvents in case of damage or distortion.

#### **Cleaning the Filter:**

It is recommended to follow steps below to clean the filter at least every 2 weeks to optimize the performance of the unit.

### STORAGE REQUIREMENT

If the unit will remain unused for an extended period of time, follow these steps:

- Clean the filter.
- The evaporator inside the appliance must be dried out before the unit is packed to avoid component damage. Unplug the unit and place it in a dry, open area for several days to dry it out.
- Store the power cord on the power cord hooks at the back of the unit.
- Cover the dehumidifier with a plastic bag or a tarp.
- Store the dehumidifier upright in a dry, well-ventilated location.



## TROUBLESHOOTING

You can solve many common problems easily, saving you the cost of a possible service call. Try the suggestion below to see if you can solve the problem before calling the service center.

PROBLEM	POSSIBLE CAUSE
<b>The dehumidifier does not operate.</b>	<ul style="list-style-type: none"> <li>• Not plugged in.</li> <li>• The circuit breaker tripped or a blown fuse.</li> <li>• Ambient temperature is out of range (41°F ~ 100°F)</li> </ul>
<b>The unit is in operation but does not dehumidify.</b>	<ul style="list-style-type: none"> <li>• Reset the humidity to lower level.</li> <li>• Make sure all doors, windows, and other openings in the room are securely closed.</li> <li>• Remove any objects in the room that are emitting water vapor.</li> </ul>
<b>Reduced dehumidifying capacity</b>	<ul style="list-style-type: none"> <li>• Clean the filter.</li> <li>• Make sure there is no blockage from the air inlet and outlet.</li> </ul>
<b>No air inlet</b>	<ul style="list-style-type: none"> <li>• Clean the filter.</li> <li>• Make sure there is no blockage from the air inlet and outlet.</li> </ul>
<b>Loud noise</b>	<ul style="list-style-type: none"> <li>• Clean the filter.</li> <li>• Make sure the unit is placed on a flat ground.</li> </ul>
<b>Error Code 'E1'</b>	<ul style="list-style-type: none"> <li>• Temperature sensor error, replace sensor.</li> </ul>
<b>Error Code 'E2'</b>	<ul style="list-style-type: none"> <li>• Humidity sensor error, replace sensor.</li> </ul>
<b>Error Code 'CL'</b>	<ul style="list-style-type: none"> <li>• Ambient temperature is too low. Increase room temperature.</li> </ul>
<b>Error Code 'CH'</b>	<ul style="list-style-type: none"> <li>• Ambient temperature is too high. Cool down the room temperature.</li> </ul>
<b>Error Code 'OL'</b>	<ul style="list-style-type: none"> <li>• Ambient humidity is under 20%. The unit will turn off.</li> </ul>
<b>Error Code 'HI'</b>	<ul style="list-style-type: none"> <li>• Ambient humidity is over 95%. The unit will continue in operate.</li> </ul>
<b>Error Code 'FL'</b>	<ul style="list-style-type: none"> <li>• Water tank is full or pump error. Drain out the water or contact customer service.</li> </ul>

### WARNING:

- If the Water Full indicator is always on, there may be a malfunction in the machine. Please seek technical support from professionals.
- If anything unexpected happens, please turn off and unplug the machine immediately, and seek technical support from certified electrical engineers.



## LIMITED MANUFACTURER'S WARRANTY

This appliance is covered by a limited manufacturer's warranty. For one year from the original date of purchase, the manufacturer will repair or replace any parts of this appliance that prove to be defective in materials and workmanship, provided the appliance has been used under normal operating conditions as intended by the manufacturer.

### Warranty Terms:

During the first year, any components of this appliance found to be defective due to materials or workmanship will be repaired or replaced, at the manufacturer's discretion, at no charge to the original purchaser. The purchaser will be responsible for any removal or transportation costs.

### Warranty Exclusions:

The warranty will not apply if damage is caused by any of the following:

- Power failure
- Damage in transit or when moving the appliance
- Improper power supply such as low voltage, defective household wiring or inadequate fuses
- Accident, alteration, misuse or abuse of the appliance such as using non-approved accessories, inadequate air circulation in the room or abnormal operating conditions (extreme temperatures)
- Use in commercial or industrial applications
- Fire, water damage, theft, war, riot, hostility or natural disasters as hurricanes, floods, etc.
- Use of force or damage caused by external influences
- Partially or completely dismantled appliances
- Excess wear and tear by the user

### Obtaining Service:

When making a warranty claim, please have the original bill of purchase with the purchase date available. Once confirmed that your appliance is eligible for warranty service, all repairs will be performed by a Newair™ authorized repair facility. The purchaser will be responsible for any removal or transportation costs. Replacement parts and/or units will be new, re-manufactured or refurbished and is subject to the manufacturer's discretion. For technical support and warranty service, please email [support@newair.com](mailto:support@newair.com).