

INSIGNIA™

USER GUIDE

165-Can Beverage Cooler

NS-BC1ZSS9/NS-BC1ZSS9-C

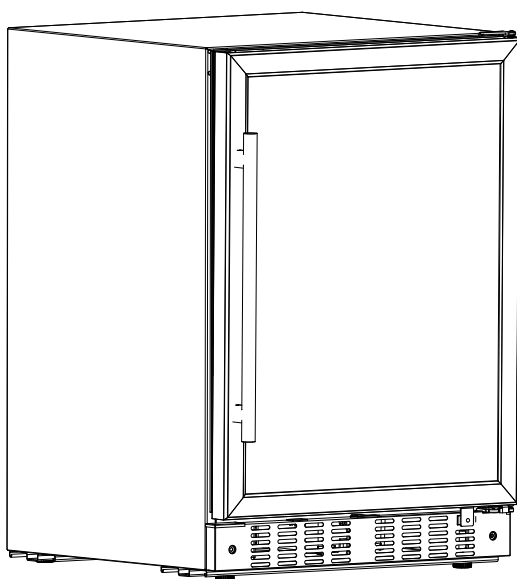

Before using your new product, please read these instructions to prevent any damage.

Contents

Introduction	3
IMPORTANT SAFETY INSTRUCTIONS	3
Features	5
Package contents	5
Components	6
Control and display panel	6
Setting up your beverage cooler	7
Before using your cooler	7
Finding a suitable location	7
Leveling your cooler	8
Installing the handle	8
Reversing the door	9
Connecting to power	15
Using your beverage cooler	16
Turning on your cooler	16
Setting the temperature	16
Memory function	16
Lighting your cooler	16
Arranging your beverages	17
Maintaining your beverage cooler	18
Cleaning the interior of your cooler	18
Defrosting your cooler	18
Storing your cooler	18
Moving your beverage cooler	19
Tips on saving energy	19
Troubleshooting	19
Error codes	19
Problems and solutions	20
Specifications	20
ONE-YEAR LIMITED WARRANTY	21
For Québec Customers Only	23

Introduction

Congratulations on your purchase of a high-quality Insignia product. Your NS-BC1ZSS9/NS-BC1ZSS9-C represents the state of the art in wine cooler design and is designed for reliable and trouble-free performance.

IMPORTANT SAFETY INSTRUCTIONS



This symbol indicates that dangerous voltage constituting a risk of electric shock is present within your cooler.



This symbol indicates that there are important operating and maintenance instructions in the literature accompanying your cooler.

WARNING

- 1 Read these instructions.
- 2 Keep these instructions.
- 3 Heed all warnings.
- 4 Follow all instructions.
- 5 Do not use this appliance near water.
- 6 Clean only with a damp cloth.
- 7 Do not block any ventilation openings. Install in accordance with the manufacturer's instructions.
- 8 Do not install near any heat sources such as radiators, heat registers, stoves, or other apparatuses (including amplifiers) that produce heat.
- 9 Do not defeat the safety purpose of the polarized or grounding-type plug. A polarized plug has two blades with one wider than the other. A grounding type plug has two blades and a third grounding prong. The wide blade or the third prong are provided for your safety. If the provided plug does not fit into your outlet, consult an electrician for replacement of the obsolete outlet.
- 10 Protect the power cord from being walked on or pinched, particularly at plugs, convenience receptacles, and the point where they exit from the appliance.
- 11 Do not use extension cords or ungrounded (two-prong) adapters.

- 12 Unplug this appliance during lightning storms or when it will not be used for long periods of time.
- 13 Make sure that the available AC power matches the voltage requirements of this appliance.
- 14 Do not handle the plug with wet hands. This could result in an electric shock.
- 15 Unplug the power cord by holding the plug, never by pulling the cord.
- 16 Do not turn the appliance on or off by plugging or unplugging the power cord.
- 17 Turn off the appliance before unplugging it.
- 18 Refer all servicing to qualified service personnel. Servicing is required when the appliance has been damaged in any way, such as when the power-supply cord or plug is damaged, when liquid has been spilled or objects have fallen into the appliance, or when the appliance has been exposed to rain or moisture, does not operate normally, or has been dropped.
- 19 To reduce the risk of fire or electric shock, do not expose this appliance to rain, moisture, dripping, or splashing, and do not place objects filled with liquids on top of it.



WARNING

Electric Shock Hazard

Failure to follow these instructions can result in electric shock, fire, or death.

- 1 **WARNING**—Keep ventilation openings in the appliance enclosure or in the built-in structure clear of obstruction.
- 2 **WARNING**—Do not touch the interior of the chiller compartment with wet hands. This could result in frost bite.
- 3 **WARNING**—Do not use mechanical devices or other means to accelerate the defrosting process, other than those recommended by the manufacturer.
- 4 **WARNING**—Do not damage the refrigerant circuit when handling, moving, or using the cooler.
- 5 **WARNING**—Do not use electrical appliances inside the storage compartment of the appliance, unless they are of the type recommended by the manufacturer.
- 6 **WARNING—DANGER**—Never allow children to play with, operate, or crawl inside the cooler.
Risk of child entrapment. Before you throw away your old cooler:
 - 1) Take off the door
 - 2) Leave the shelves in place so that children may not easily climb inside
- 7 Unplug the cooler before carrying out user maintenance on it.
- 8 This appliance is not intended for use by persons (including children) with reduced physical, sensory, or mental capabilities, or lack of experience and knowledge, unless they have been given supervision or instruction concerning use of the appliance by a person responsible for their safety. Children should be supervised to ensure that they do not play with the appliance.



- 9** If a component part is damaged, it must be replaced by the manufacturer, its service agent, or similar qualified persons in order to avoid a hazard.
- 10** Dispose of the cooler according to local regulations as the cooler contains flammable gas and refrigerant.
- 11** Follow local regulations regarding disposal of the cooler due to flammable refrigerant and gas. All refrigeration products contain refrigerants, which under the guidelines of federal law must be removed before disposal. It is the consumer's responsibility to comply with federal and local regulations when disposing of this product.
- 12** This cooler is intended to be used in household and similar environments.
- 13** Do not store or use gasoline or any flammable liquids inside or in the vicinity of this cooler.
- 14** Do not use extension cords or ungrounded (two prong) adapters with this cooler. If the power cord is too short, have a qualified electrician install an outlet near the cooler.
- 15** If the supply cord is damaged, it must be replaced by the manufacturer, its service agent, or a similarly qualified person in order to avoid a hazard.

Features

- 165 12-ounce can capacity
- Temperature range from 34° to 50° F (1° to 10° C)
- Auto-defrosting fan to eliminate ice and condensation build-up
- Touch controls and LED display
- Interior light
- Reversible door
- Removable shelves

Package contents

- Beverage cooler
- Handle
- Door reversal accessories (hex wrench, left hinge, & spare plastic plugs)
- *User Guide*

Components

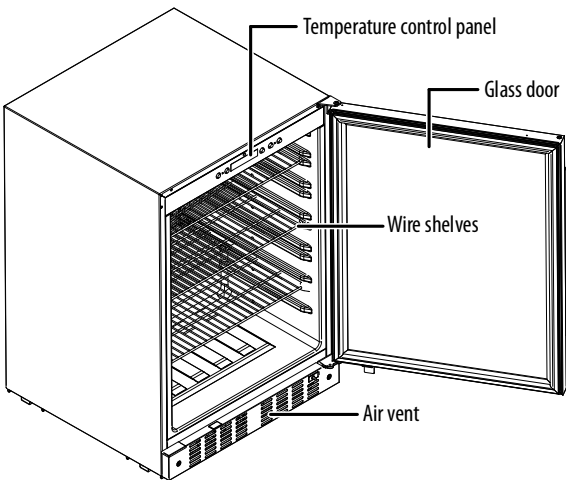

Control and display panel

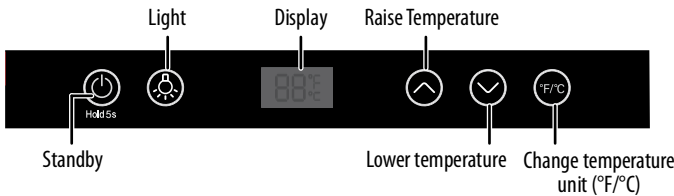

BUTTON	FUNCTION
	Hold for five seconds to set your cooler to “Standby” mode (the cooler stops cooling and light turns off).
	Press to set whether the interior light stays on or off while the door is closed.
	Press to increase the temperature by one degree.
	Press to decrease the temperature by one degree.
	Press to change the display between Fahrenheit and Celsius.

- Notes:**
- Touch the control panel lightly when pressing the keys.
 - To avoid scratching the control panel, do not touch it with sharp objects.

Setting up your beverage cooler

Before using your cooler

- Remove the exterior and interior packaging.
- Let the cooler stand upright for approximately half an hour before connecting it to power. This reduces the possibility of a malfunction in the cooling system from improper handling during transportation.
- Clean the interior surface with a damp, warm cloth.

Finding a suitable location

- This cooler is designed to be built into your cabinets. Place it on a floor, countertop, or cabinet that is strong enough to support the cooler when it is fully loaded.
- If the cooler is not properly ventilated, the compressor will use more power. Make sure that you leave space on all sides:
 - Top: 1/4 in. (.5 cm)
 - Sides: 1/4 in. (.5 cm)
 - Back: 13/16 in. (2.0 cm)

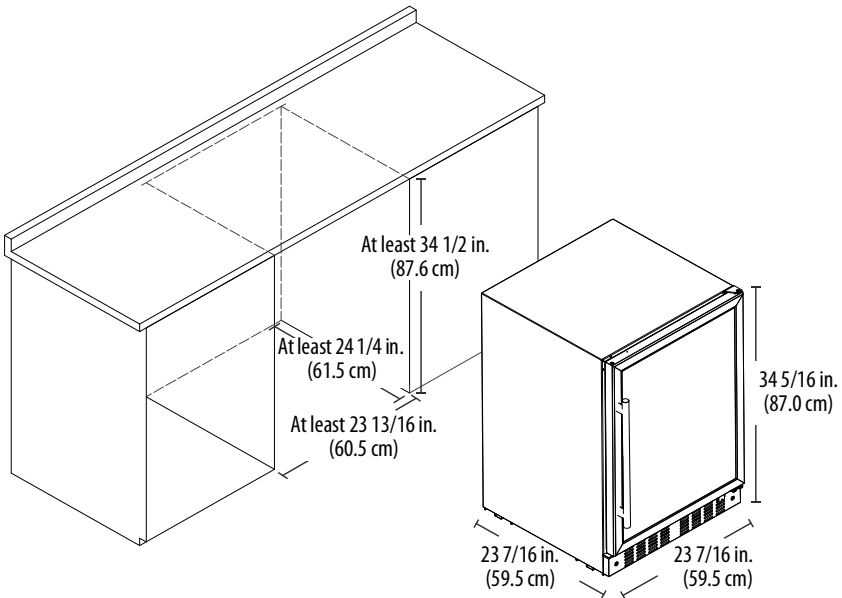

- Leave enough space for the door to open at least 90 degrees.
- Place the cooler away from direct sunlight and sources of heat (stove, heater, radiator, etc.). If the cooler has to be put next to a heat source, use a suitable insulation board. Ambient temperatures below 50° F (10° C) or above 85° F (29.4° C) will hinder the performance of this cooler. This cooler is not designed for use in a garage or any other outside location.
- Avoid placing the cooler in moist areas.
- This unit is not designed to be installed in an RV or used with an inverter.
- Do not stack your cooler.

- For your cooler to operate normally, avoid placing it in areas with high magnetic fields or high humidity.
- Do not block the air vent on the front of your cooler.

Leveling your cooler

- It is very important for the cooler to be level in order to function properly. If the cooler is not leveled during installation, the door may not close or seal properly, causing cooling, frost, or moisture problems.
- To level your cooler, you may either turn the feet clockwise to raise the cooler or turn it counter-clockwise to lower it. The front feet should be adjusted slightly higher than the back feet.

Installing the handle

- 1 Align the handle with the two bolts on the glass door.

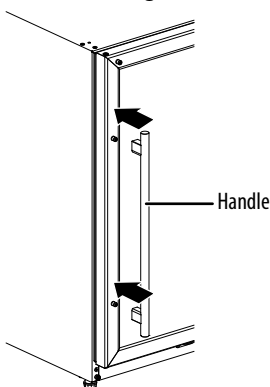

- 2 Secure the handle with the 3 mm hex wrench (included), making sure that the screw holes on the handle are facing downward.

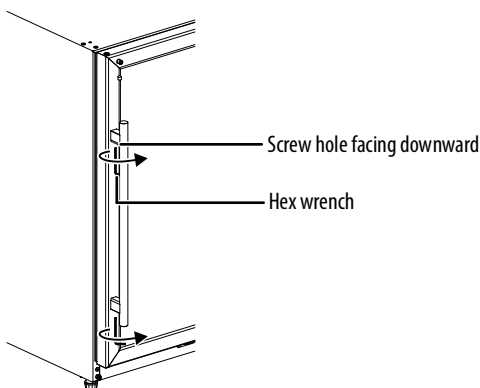

Reversing the door

To reverse the door you will need a Phillips screwdriver. Have someone available to assist you in the process. Make sure that you keep all of the parts you remove to reuse them later.

CAUTION: Do not lay the beverage cooler completely flat as that could damage the coolant system.

- 1 Make sure that your beverage cooler is unplugged and empty.
- 2 Remove the upper hinge bolt (1) and lift the door off the cooler.

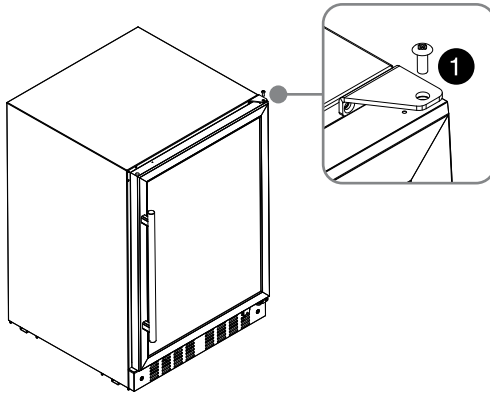

- 3 To reverse the cooler's hinges:

- A Remove the three screws (2) securing the upper hinge (3) and the three plastic caps (4) at the top left side of the cooler. Set the upper hinge aside and save it in case you need to reverse the door again.

Note: If you reverse the door a second time, the hinge will be on the right side of the cooler.

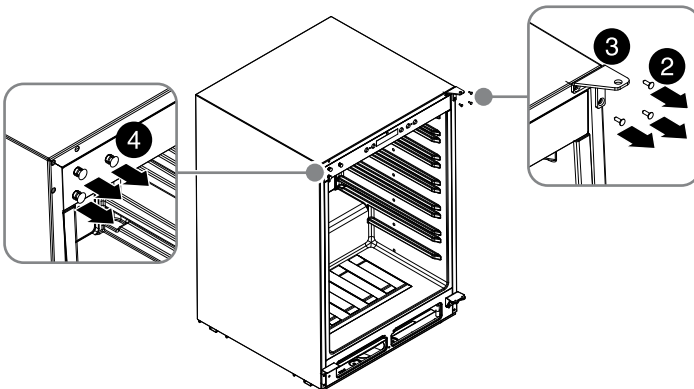

- B** Install the upper hinge from the included accessories bag (3) to the opposite side, then insert the plastic caps (4) into the old screw holes.

Note: The left upper hinge and right upper hinge are not the same. Make sure that you install the extra hinge that was included with your refrigerator.

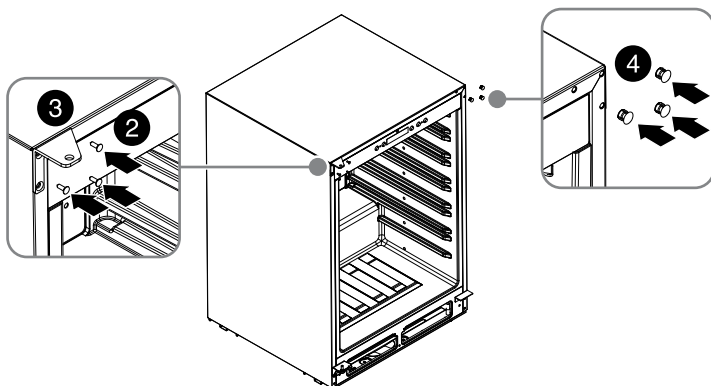

- C** Remove the two screws (5) holding the air cover (7) in place. Set aside.

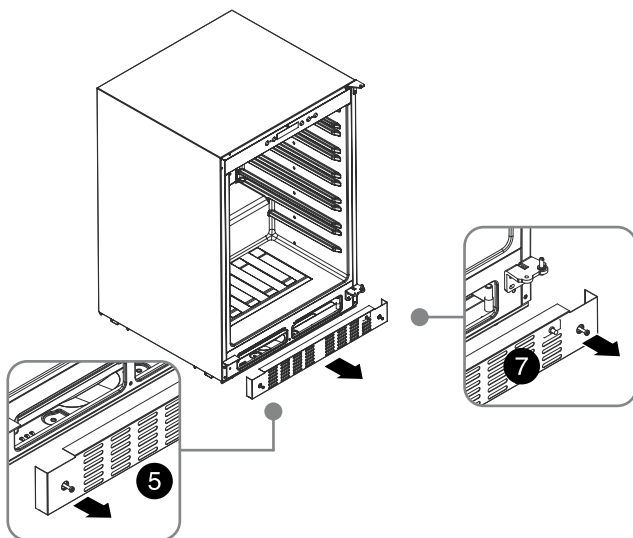

- D** Remove the two screws (8) securing the door support (9), the three screws (10) securing the lower hinge (11), and the lower hinge shaft (12).

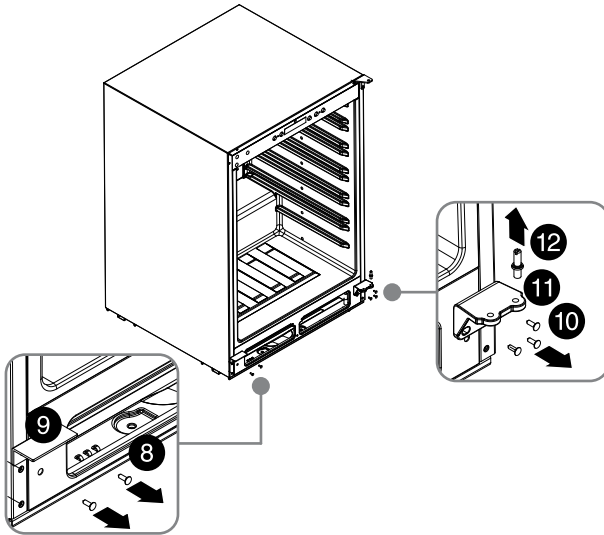

- E** Reinstall the door support (9) and lower hinge (11) on the opposite sides, then place the lower hinge shaft (12) back into the lower hinge.

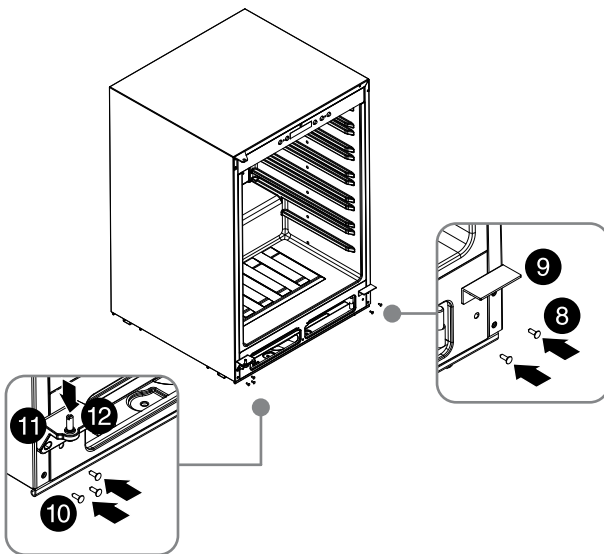

- F** Secure the air cover (7) to the refrigerator with the screws (5).

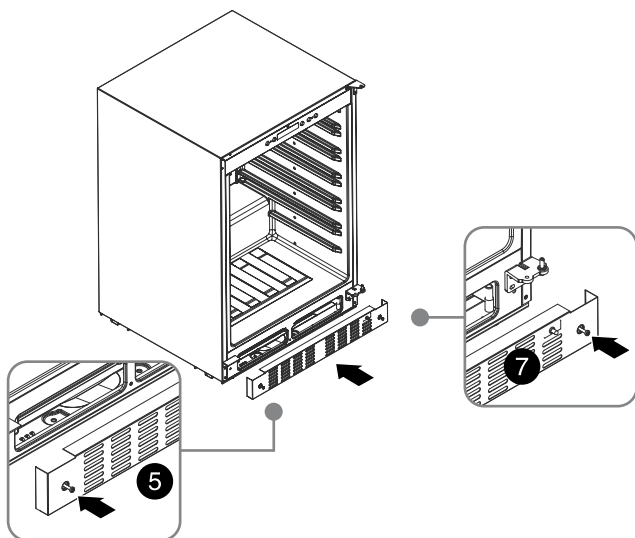

- 4** To prepare the cooler door:

- A** Remove the upper sleeve (2) and hole plugs from the top of the door, and retain them to use in step D.

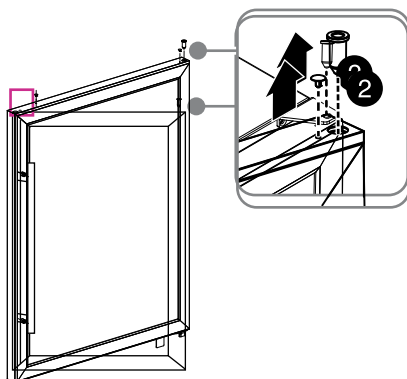

- B** Remove the light switch block (4) and door stopper (5) from the bottom of the door by removing the corresponding screws (3) and sleeve (6).

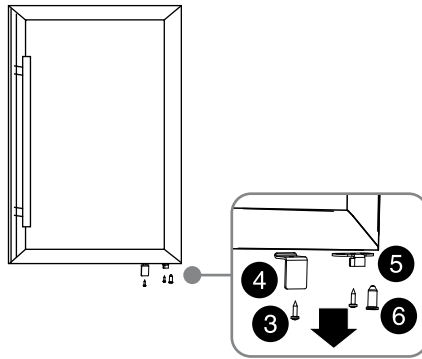

- C** Rotate the door 180°.

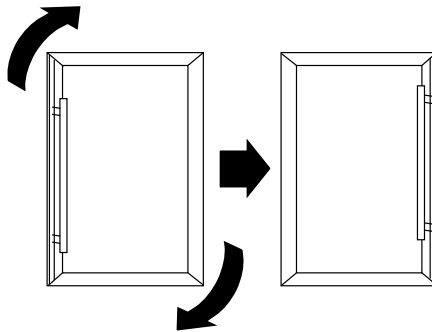

- D** Insert the upper sleeve (2) and hole plugs into the top of the door.

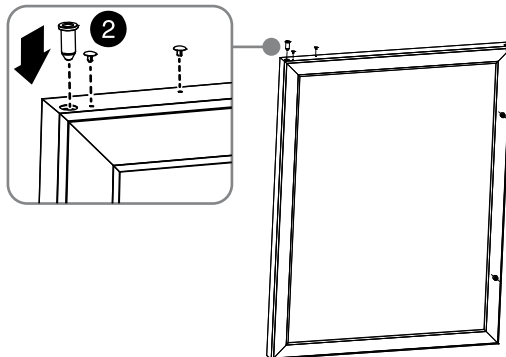

- E** Secure the light switch block (4) and door stopper (5) to the bottom of the door with their corresponding screws (3) and sleeve (6).

Note: Make sure that these parts are installed on the side **WITHOUT** the handle.

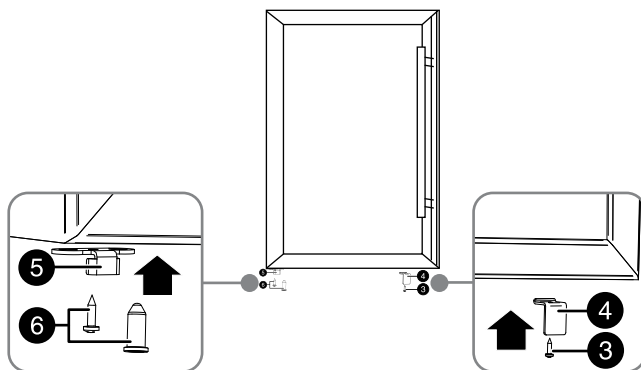

- 5** Place the door on the cooler's lower hinge shaft, then secure with the upper hinge bolt (1).

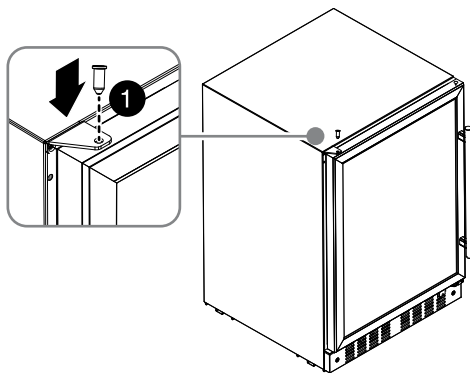

- 6** Adjust the leveling feet to level the cooler.

Connecting to power

- Plug the cooler into a dedicated, properly installed grounded wall outlet. This appliance should be operated on a separate electrical circuit from other operating appliances.

CAUTION: This unit is not designed to be installed in an RV or used with an inverter.

- Plug in and run your cooler for three to four hours before making any temperature adjustments and before adding beverages. This allows your cooler to reach a stable temperature.

Notes:

- Check your local power source. This cooler requires a 115V, 60Hz power supply.
 - Use a receptacle that accepts the grounding prong. The power cord is equipped with a 3-prong (grounding) plug which plugs into a standard 3-prong (grounding) wall outlet to minimize the possibility of electric shock hazard from this cooler.
 - To prolong the service life of the compressor, wait for at least five minutes before restarting the cooler after a power failure.
- Do not use an extension cord with this cooler. If the power cord is too short, have a qualified electrician install an outlet near the cooler. Use of an extension cord can negatively affect the cooler's performance.
 - Do not connect your cooler to an electronic energy-saving plug and converter that converts DC into AC (such as a solar energy system).

Using your beverage cooler

Turning on your cooler



- Plug your cooler in to turn it on for the first time. The display lights up for three seconds, the cooler beeps, then the compressor starts working.

OR

- If in standby mode, press and hold  (power) for five seconds to turn your cooler on. The display lights up and the compressor starts working.

Note: Run your cooler for three to four hours before making any temperature adjustments and before adding beverages to let your cooler reach a stable temperature.

Setting the temperature

- Press the temperature  (up) or  (down) buttons to increase or decrease the temperature by one degree. The temperature range is 34°–50° F (1 ~ 10° C).
- Press  (change temperature unit) to switch between Fahrenheit and Celsius.

Notes:

- A large number of beverages will lower the cooling efficiency of the cooler.
- When you put several beverages in the cooler at one time, the temperature in the cooler may rise temporarily.
- Adjust the thermostat setting by one increment at a time. Allow several hours for the temperature to stabilize between adjustments.
- The screen display always shows the set temperature. When adjusting the temperature, the temperature display blinks to indicate that the temperature is being adjusted.

Memory function

If you experience a power outage, when your cooler is turned on again it resumes the same temperature that was set when the power went off.

Lighting your cooler

- Press the  (light) button to turn the interior light on and off while the door is closed.

Arranging your beverages

In order to maintain good air circulation in the cooler, do not let the beverages touch the back of the cooler. Due to the air circulation, the temperature in the upper area of the cooler will be higher than in the lower area of the cooler.

To maximize your storage space, arrange your drinks as shown:

Top shelf

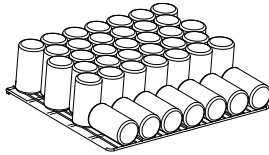

Middle & Bottom Shelves

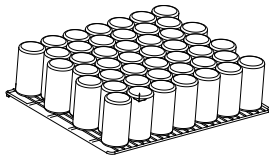

Bottom zone

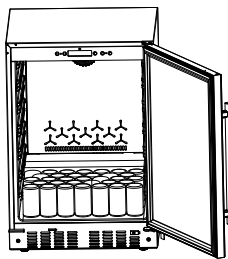

Stores 165 Cans

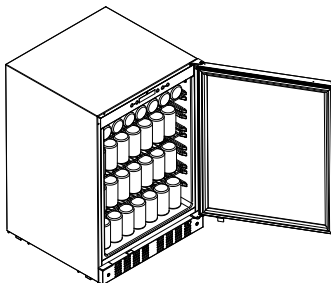

Maintaining your beverage cooler

Your cooler is designed for year-round use with only minimal cleaning and maintenance.

Before using your cooler for the first time, wipe the cabinet with a mild detergent and warm water, then wipe dry with a dry cloth. Do this periodically to keep your cooler looking new.

Cleaning the interior of your cooler

CAUTION:

- Do not use hard brushes, clean steel balls, wire brushes, abrasives (such as toothpaste), organic solvents (such as alcohol, acetone, or banana oil), boiling water, acid, or alkaline items to clean the cooler. They may damage the cooler surface and interior.
- Do not rinse with water to avoid affecting the cooler's electrical insulation properties.
- Do not use detergent and solvent with sand or acid.

- 1 Turn off the cooler and unplug it from the wall outlet.
- 2 Remove all beverages.
- 3 Wash the interior with a damp, warm cloth and dishsoap. Do not let water spill onto the control panel or internal light.
- 4 Clean the door gasket (seal) so the door closes properly.
- 5 Dry the interior and exterior with a soft cloth.
- 6 Plug the power cord back into a wall outlet.

Defrosting your cooler

The ice buildup on the inner back wall of your cooler will defrost on its own—you don't need to wipe it off. The defrosted water drains out of the cooler through the drain outlet and into a drain pan located above the compressor. The water evaporates from the drain pan on its own.

Storing your cooler

- 1 Turn off the cooler and unplug it from the wall outlet.
- 2 Remove all beverages.
- 3 Clean the cooler.
- 4 Leave the door open slightly to avoid possible formation of condensation, mold, or odor.

WARNING: Make sure that children do not have access to your beverage cooler. If the door accidentally closes while a child is inside your cooler, the child may suffocate.

Moving your beverage cooler

Note: Make sure that the cooler stays in the upright position while transporting.

- 1 Turn off the cooler and unplug it from the wall outlet.
- 2 Remove all beverages.
- 3 Securely tape down all loose items inside your cooler.
- 4 Tape the door shut.

Tips on saving energy

- Locate your cooler in the coolest area of the room, away from heat-producing appliances or heating ducts, and out of direct sunlight.
- Do not overload the cooler. It forces the compressor to run longer.
- Do not open the door too often, especially if the weather is very hot. Close the door as soon as possible to prevent cool air from escaping.
- Make sure that the door seals completely to keep your cooler running efficiently.
- Make sure that the appliance is sufficiently ventilated, with adequate air circulation behind it.

Troubleshooting

Error codes

If a fault is detected, the display shows one of the following codes:

ERROR CODE	DESCRIPTION
E1	Chamber temperature sensor fault
E4	Defrosting temperature sensor fault
E6	Communication fault
E9	High temperature alarm

If any of these error codes appears on the display, contact your local dealer or service center. Do not try to repair the cooler yourself.

Problems and solutions

PROBLEM	SOLUTION
The cooler does not operate.	<ul style="list-style-type: none"> • Make sure that the cooler is plugged in and that the plug is pushed completely into the outlet. • Check the house fuse/circuit breaker box and replace the fuse or reset the circuit breaker. • If a power failure occurs, the cooler turns off. Wait until the power is restored, then turn it on again.
The cooler door does not close completely.	<ul style="list-style-type: none"> • Adjust the shelf properly. • Clean the door gaskets. • Level the cooler with the leveling feet.
The cooler is not cold enough.	<ul style="list-style-type: none"> • Make sure that the door is closed properly. • Allow time for new beverages to cool, then check again. • Set the control to a colder setting.
The cooler makes unusual noises or vibrates.	<ul style="list-style-type: none"> • Level the cooler with the leveling feet. • Move the cooler out from the wall. • Refrigerants circulating in the refrigerant lines will produce sounds. This is normal and does not affect cooling. • A buzz is generated by the running compressor, especially when starting up or shutting down. • The solenoid valve or electric switch valve will clatter. This is normal and doesn't affect operation.
Moisture is building up in the interior of the cooler.	<ul style="list-style-type: none"> • Make sure that the door is closed properly. • Move the cooler to a dryer location. • Condensation while in high humidity is normal. Wipe the exterior and door seals with a towel to remove excess moisture.
The cooler turns on and off frequently.	<ul style="list-style-type: none"> • Make sure that your cooler is in a room that is 50 ~ 85° F (10 ~ 29.4° C) or place your cooler in a cooler location. • Make sure that the door is closed properly. • Clean the door gaskets. • Set the control to a colder setting.

Specifications

Dimensions (D × W × H)	25 5/16 × 23 7/16 × 34 5/16 in. (64.2 × 59.5 × 87.0 cm)
Weight	100.3 lbs. (45.5 kg)
Power requirements	115V~60Hz
Current	.86A
Ambient operating temperature	54 ~ 109° F (12 ~ 43° C)
Cooler temperature range	34 ~ 50° F (1 ~ 10° C)
Power cord length	5.4 ft. (1.65 m)
Certifications	UL listed

ONE-YEAR LIMITED WARRANTY

Best Buy, or its Authorized Partner of Insignia branded products, warrants to you, the original purchaser of this new Insignia branded product ("Product"), that the Product shall be free of defects in the original manufacture of the material or workmanship for a period of one (1) year from the date of your purchase of the Product or the date of delivery (if later than the date of purchase) ("Warranty Period").

For this warranty to apply, your Product must be (i) purchased in the United States or Canada from a Best Buy branded retail store, online at www.bestbuy.com or www.bestbuy.ca, or from Best Buy's Authorized Partner, and (ii) packaged or sold with this warranty statement.

The term "Best Buy", as used in this warranty, refers to Best Buy branded retail stores, www.bestbuy.com, www.bestbuy.ca, and Best Buy's Authorized Partner.

Because Insignia cannot control the quality of products sold by unauthorized sellers, this warranty applies only to Products that were purchased from Best Buy or an Insignia Authorized Partner, unless otherwise prohibited by law. Insignia reserves the right to reject warranty claims for Products purchased from unauthorized sellers, including unauthorized websites.

REPAIR OR REPLACEMENT, AS PROVIDED UNDER THIS WARRANTY, IS YOUR EXCLUSIVE REMEDY FOR BREACH OF WARRANTY. INSIGNIA SHALL NOT BE LIABLE FOR ANY INCIDENTAL OR CONSEQUENTIAL DAMAGES FOR THE BREACH OF ANY EXPRESSED OR IMPLIED WARRANTY ON THIS PRODUCT, INCLUDING, BUT NOT LIMITED TO, LOST DATA, LOSS OF USE OF YOUR PRODUCT, LOST BUSINESS, OR LOST PROFITS. INSIGNIA PRODUCTS MAKES NO OTHER EXPRESS WARRANTIES WITH RESPECT TO THE PRODUCT. ALL EXPRESSED AND IMPLIED WARRANTIES FOR THE PRODUCT, INCLUDING BUT NOT LIMITED TO ANY IMPLIED WARRANTIES OF AND CONDITIONS OF MERCHANTABILITY AND FITNESS FOR A PARTICULAR PURPOSE, ARE LIMITED IN DURATION TO THE WARRANTY PERIOD SET FORTH ABOVE AND NO WARRANTIES, WHETHER EXPRESSED OR IMPLIED, WILL APPLY AFTER THE WARRANTY PERIOD. SOME STATES, PROVINCES, AND JURISDICTIONS DO NOT ALLOW LIMITATIONS ON (i) HOW LONG AN IMPLIED WARRANTY LASTS, (ii) EXCLUSION OR LIMITATION OF INCIDENTAL OR CONSEQUENTIAL DAMAGES, or (iii) LIMITATION OF INCIDENTAL OR CONSEQUENTIAL DAMAGES, SO THE ABOVE LIMITATIONS OR EXCLUSIONS MAY NOT APPLY TO YOU. THIS WARRANTY GIVES YOU SPECIFIC LEGAL RIGHTS, AND YOU MAY ALSO HAVE OTHER RIGHTS, WHICH VARY FROM STATE TO STATE OR PROVINCE TO PROVINCE.

How long does the coverage last?

The Warranty Period lasts for 1 year (365 days) from the date you purchased the Product or the date of delivery (if later than the date of purchase). Your purchase date is printed on the receipt you received with the Product. In the event that Authorized Partner ceases to sell the covered Insignia branded product, this warranty shall terminate for that product and there shall be no repair or replacement of the Product.

What does this warranty cover?

During the Warranty Period, if the original manufacture of the material or workmanship of the Product is determined to be defective by an authorized Insignia repair center or store personnel, Insignia will (at its sole option): (1) repair the Product with new or rebuilt parts; or (2) replace the Product at no charge with new or rebuilt comparable products or parts. Products and parts replaced under this warranty become the property of Insignia and are not returned to you. If service of Products or parts are required after the Warranty Period expires, you must pay all labor and parts charges. This warranty lasts as long as you own your Insignia Product during the Warranty Period. Warranty coverage terminates if you sell or otherwise transfer the Product.

How to obtain warranty service?

If you purchased the Product at a Best Buy retail store location or from a Best Buy online website (www.bestbuy.com or www.bestbuy.ca), please take your original receipt and the Product to any Best Buy store. Make sure that you place the Product in its original packaging or packaging that provides the same amount of protection as the original packaging. If you purchased your Product from an Authorized Partner, call Insignia at 1-877-467-4289.

To obtain warranty service, in the United States and Canada call 1-877-467-4289. Call agents may diagnose and correct the issue over the phone.

If you purchased the Product from an Authorized Partner other than Best Buy, please call 1-888-BESTBUY in the United States or 1-866-BESTBUY in Canada. You will be asked to provide proof of purchase and to return your Product to Best Buy. Make sure that you put the Product in its original packaging or packaging that provides the same amount of protection as the original packaging.

Where is the warranty valid?

This warranty is valid only in the United States and Canada to the original purchaser of the product from an Authorized Partner, in the country where the original purchase was made.

What does the warranty not cover?

- Food, beverage, and/or medicine loss/spoilage.
- Damage to other products caused by a power surge or other similar issue while connected to the Product.
- Customer instruction/education.
- Installation.
- Set up adjustments.
- Cosmetic damage.
- Damage due to weather, lightning, and other acts of God, such as power surges.
- Accidental damage.
- Misuse.
- Abuse.
- Negligence.
- Commercial purposes/use, including but not limited to use in a place of business or in communal areas of a multiple dwelling condominium or apartment complex, or otherwise used in a place of other than a private home.
- Modification of any part of the Product, including the antenna.
- Display panel damaged by static (non-moving) images applied for lengthy periods (burn-in).
- Damage due to incorrect operation or maintenance.
- Connection to an incorrect voltage or power supply.
- Damage due to attempted repair by any person not authorized by Insignia to service the Product.
- Products sold "as is" or "with all faults".
- Consumables, including but not limited to batteries (i.e. AA, AAA, C etc.).
- Products where the factory applied serial number has been altered or removed.
- Loss or Theft of this product or any part of the product.
- Display panels containing up to three (3) pixel failures (dots that are dark or incorrectly illuminated) grouped in an area smaller than one tenth (1/10) of the display size or up to five (5) pixel failures throughout the display. (Pixel based displays may contain a limited number of pixels that may not function normally).
- Failures or Damage caused by any contact including but not limited to liquids, gels or pastes.

1-877-467-4289 | www.insigniaproducts.com

INSIGNIA is a trademark of Best Buy and its affiliated companies.

Distributed by Best Buy Purchasing, LLC

7601 Penn Ave South, Richfield, MN 55423 U.S.A

©2025 Best Buy. All rights reserved.

For Québec Customers Only

Availability Guarantee

Notice for Section 39 of the *Consumer Protection Act* Regarding the Availability Guarantee of Replacement Parts, Repair Services, and Maintenance Information

Please be advised that Best Buy Canada Ltd. ("Best Buy"), including its affiliated entities, does not guarantee, within the meaning of Section 39 of the *Consumer Protection Act* and the applicable regulations, the availability of replacement parts, repair services, or maintenance or repair information relating to products sold, manufactured, imported, advertised, or sold by Best Buy or under its Insignia brand, Best Buy Essentials, Rocketfish, or other brands sold or manufactured by Best Buy.

This Notice does not affect Best Buy's One-Year Limited Warranty for Insignia Products.

Please visit www.bestbuy.ca/garantie-disponibilite for additional information.



INSIGNIA™

www.insigniaproducts.com

1-877-467-4289 (U.S. and Canada)



INSIGNIA is a trademark of Best Buy and its affiliated companies.

Distributed by Best Buy Purchasing, LLC

Richfield, MN 55423

©2025 Best Buy. All rights reserved.

V5 ENGLISH
25-0889