

## QUICK SETUP GUIDE

# TV Dock Kit for Nintendo® Switch™ and Switch™ OLED NX-NSDKHU

## PACKAGE CONTENTS

- TV DOCK
- AC adapter

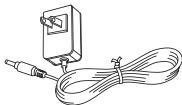
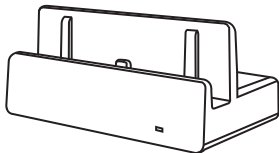

Before using your new product, please read these instructions to prevent any damage.

## FEATURES

- Compatible with Nintendo Switch and Switch OLED
- Compact design for easy portability
- Includes a USB 2.0 output for USB 2.0 connection
- Charges console while in use via the AC adapter (included)
- Weighted base for stability

## SAFETY INFORMATION

- You must use the included AC adapter to power the dock.
- Do not disassemble any of the components. Refer all services to qualified personnel only.
- Do not place or store the product in a humid area and do not expose it to water or rain.
- Use the product only as instructed. Read all instructions before operating the product.
- Failure to follow these directions may void the warranty.
- Do not use voltage transformers or plugs that deliver reduced amounts of electricity.

## USING THE TV DOCK

**1** Connect power.

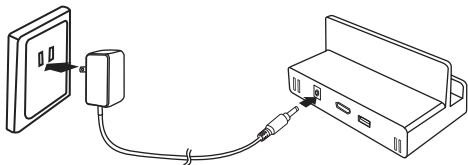

**2** Carefully slide the Switch OLED onto the TV dock. The power LED should turn green and the Switch screen should turn off.

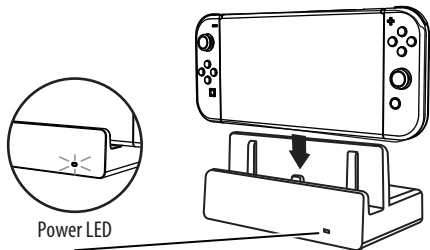

- 3** Plug one end of an HDMI cable into any HDMI port on your TV or monitor. The Switch's screen will appear on your TV or monitor. TV Dock supports 4K, 1080P and 720P video output (Switch only currently supports 1080P).

### Notes:

- Please note that initially it may take a number of seconds to transmit the audio/video signals from the Nintendo Switch OLED to the TV. Transmitting times may vary.
- If the TV is still not getting a signal, power off all components. Unplug the HDMI and AC adapter. Then reconnect using the above methods. Then power on all components.

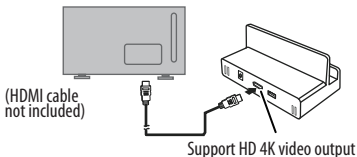

## USING THE USB CHARGING PORT

Plug in a wired controller to play games

**OR** Plug in your Pro controller or other USB device to charge it.

**Note:** The external USB charging port is designed to charge some USB 2.0 devices but might not charge newer devices.

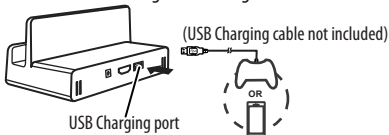

## SPECIFICATIONS

<b>Input:</b>	100-240V, 50-60Hz, 1.0A
<b>Output:</b>	18V 1.66A
<b>External USB Charging Port: Output:</b>	5V 1.0A
<b>External Dimensions: TV DOCK (W×H×D)</b>	5.4 x 3.0 x 2.4 in. (138 x 78 x 60mm)

## TROUBLESHOOTING

### **The TV Dock doesn't work?**

- Make sure you have selected the proper HDMI input on your TV or monitor.
- Make sure you are using a known working HDMI cable.
- Make sure your TV Dock AC adapter is connected and plugged into a working wall outlet.
- Disconnect your Switch Console, wait a few seconds and reconnect it to the Switch TV Dock.
- Unplug the HDMI Cable and plug it back in.
- The Switch console can generate some heat while in use. Please use only in a well ventilated area. Do not obstruct the vents on either side.
- While the NEXT TV Dock supports 4K output, the Switch only currently supports 1080P output..

# LEGAL NOTICES

## FCC Information

This device complies with part 15 of the FCC Rules. Operation is subject to the following two conditions: (1) This device may not cause harmful interference, and (2) this device must accept any interference received, including interference that may cause undesired operation.

**Warning:** Changes or modifications to this unit not expressly approved by the party responsible for compliance could void the user's authority to operate the equipment.

**Note:** This equipment has been tested and found to comply with the limits for a Class B digital device, pursuant to Part 15 of the FCC Rules. These limits are designed to provide reasonable protection against harmful interference in a residential installation. This equipment generates, uses and can radiate radio frequency energy and, if not installed and used in accordance with the instructions, may cause harmful interference to radio communications. However, there is no guarantee that interference will not occur in a particular installation. If this equipment does cause harmful interference to radio or television reception, which can be determined by turning the equipment off and on, the user is encouraged to try to correct the interference by one or more of the following measures:

- Reorient or relocate the receiving antenna.
- Increase the separation between the equipment and receiver.
- Connect the equipment into an outlet on a circuit different from that to which the receiver is connected.
- Consult the dealer or an experienced radio/TV technician for help.

## ICES-003 Statement

This Class B digital apparatus complies with Canadian ICES-3(B) / NMB-3(B) standard.

# ONE-YEAR LIMITED WARRANTY

Visit [www.next-accessories.com](http://www.next-accessories.com) for details.

This product is not approved, endorsed or affiliated with Nintendo.

©2024. All Rights Reserved.

Made in China

English V1-24-0820