

# 4.9 Cu. Ft. Bottom Mount Compact Fridge

**NS-CF49BMSS2/NS-CF49BMSS2-C**

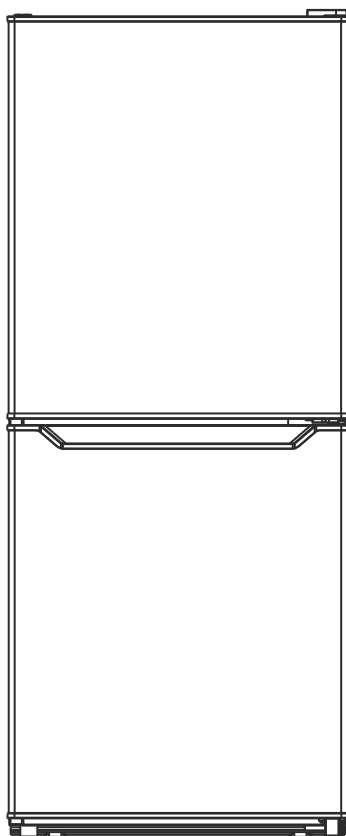

Before using your new product, please read these instructions to prevent any damage.

## Contents

IMPORTANT SAFETY INSTRUCTIONS .....	3
Grounding requirement .....	5
Features .....	6
Package contents .....	6
Dimensions .....	6
Refrigerator parts .....	7
Installing your refrigerator .....	8
Before using your refrigerator .....	8
Finding a suitable location .....	8
Providing correct ventilation .....	9
Connecting power .....	10
Reversing the door .....	11
Leveling your refrigerator .....	14
Using your refrigerator .....	15
Turning on your refrigerator for the first time .....	15
Setting the thermostat .....	15
Adjusting the shelf .....	16
Adjusting the door racks .....	16
Removing the crisper .....	17
Maintaining your refrigerator .....	17
Cleaning your refrigerator .....	17
Defrosting your refrigerator .....	18
Shutting down your refrigerator .....	18
Moving your refrigerator .....	18
Tips on saving energy .....	18
Troubleshooting .....	19
Specifications .....	21
ONE-YEAR LIMITED WARRANTY .....	22
For Québec Customers Only .....	24

# IMPORTANT SAFETY INSTRUCTIONS



**WARNING:** To reduce the risk of fire, explosion, electric shock, or injury when using your refrigerator, follow these basic safety precautions:

- 1 Read all instructions before using the refrigerator.
- 2 **WARNING**--Risk of child entrapment. Never allow children to operate, play with, or crawl inside the refrigerator.
- 3 **WARNING**--Never clean the refrigerator parts with flammable fluids. The fumes can create a fire hazard or explosion.
- 4 **WARNING**--Do not store or use gasoline or any inflammable liquids inside or in the vicinity of the refrigerator.
- 5 **WARNING**--Keep ventilation openings in the appliance or in the built-in structure clear of obstruction.
- 6 **WARNING**--Do not use mechanical devices or other means to accelerate the defrosting process, other than those recommended by the manufacturer.
- 7 **WARNING**--Do not damage the refrigerant circuit.
- 8 **WARNING**--Do not use electrical appliances inside the food storage compartments of the appliance, unless they are of the type recommended by the manufacturer.
- 9 **WARNING**--Do not place heavy objects on top of this refrigerator to avoid injury from falling objects when the door is opened or closed.
- 10 **WARNING--DANGER:** Never allow children to play with, operate, or crawl inside the refrigerator. Risk of child entrapment. Before you throw away your old refrigerator:
  - Take off the door
  - Leave the shelves in place so that children may not easily climb inside.
- 11 This appliance is not intended for use by persons (including children) with reduced physical, sensory, or mental capabilities, or lack of experience and knowledge, unless they have been given supervision or instruction concerning use of the appliance by a person responsible for their safety. Children should be supervised to ensure that they do not play with the appliance. This refrigerator must be properly installed and located in accordance with the Installation Instructions before it is used.
- 12 If the supply cord is damaged, it must be replaced by the manufacturer, its service agent, or a similar qualified person in order to avoid creating a hazard.
- 13 Please dispose of the refrigerator according to local regulations as the unit contains flammable gas and refrigerant.
- 14 Follow local regulations regarding disposal of the appliance due to flammable refrigerant and gas. All refrigeration products contain refrigerants, which under the guidelines of federal law must be removed before disposal. It is the consumer's responsibility to comply with federal and local regulations when disposing of this product.

- 15 Do not use an extension cord or ungrounded, two-prong adapters with this appliance. If the power cord is too short, have a qualified electrician install an outlet near the appliance. Use of an extension cord can negatively affect the unit's performance.
- 16 Firmly grasp the plug and pull it out of the outlet to disconnect this appliance. Do not pull on the cord.
- 17 Use a dedicated power outlet for this appliance and plug it in securely.
- 18 **WARNING:** In order to avoid electric shock, lamp replacement shall be done by the manufacturer's designated service agency or qualified personnel. Before doing any maintenance on this appliance, unplug the power cord and wear personal protection. Please refer to the maintenance instructions for details.
- 19 **WARNING:** When positioning the appliance, make sure that the power cord is not trapped or damaged.
- 20 **WARNING:** Do not locate multiple portable sockets, outlets, or portable power supplies in back of the appliance.
- 21 **WARNING:** To avoid a hazard due to the instability, this appliance must be secured in accordance with the instructions.

## Additional safety instructions

- Disconnect the refrigerator from the main power supply at the rear of the unit, remove the refrigerator circuit fuse, or turn off the circuit breaker before making repairs or cleaning. Wait five minutes before reconnecting to prevent damages to the compressor due to multiple, successive starts.
- **NOTE:** Power to the refrigerator cannot be disconnected by any setting on the control panel.
- **NOTE:** Repairs must be performed by a qualified Service Professional.
- Replace all parts and panels before operating.
- Do not store explosive substances such as aerosol cans with a flammable propellant in this appliance.
- Do not store beer, carbonated beverages, or other fluids contained in bottles or enclosed glass containers in the freezer. The containers could crack due to freezing and cause damage.
- To avoid serious injury or death, children should not stand on, or play in or with the appliance.
- If doors or lids are fitted with locks, the keys must be kept out of the reach of children and not in the vicinity of the appliance, in order to prevent children from being locked inside.
- This appliance is intended to be used in household and similar applications, such as: staff kitchen areas in shops, offices, and other working environments; farm houses; by clients in hotels, motels, bed & breakfasts, and other residential environments, and catering and similar non-retail applications.
- Do not apply harsh cleaners to the refrigerator. Certain cleaners will damage plastic which may cause parts such as the door or door handles to detach unexpectedly. See [Maintaining your refrigerator](#) on page 17 for detailed instructions.



**CAUTION:** To reduce the risk of injury when using your refrigerator, follow these basic safety precautions.

- Do not clean glass shelves or covers with warm water when they are cold. Glass shelves and covers may break if exposed to sudden temperature changes or impact, such as bumping or dropping. Tempered glass is designed to shatter into many small pieces if it breaks.
- Keep fingers out of the "pinch point" areas. Clearances between the door and refrigerator are necessarily small. Be careful closing the door when children are in the area.



**WARNING-DANGER - RISK OF FIRE OR EXPLOSION. FLAMMABLE REFRIGERANT USED.**

- To be repaired only by trained service personnel. Do not puncture refrigerant tubing.
- Consult repair manual/owner's guide before attempting to service this product.
- All safety precautions must be followed.
- Dispose of property in accordance with the applicable federal or local regulations.
- Follow handling instructions carefully.

# READ ALL INSTRUCTIONS BEFORE USING

## PROPER DISPOSAL OF YOUR OLD REFRIGERATOR



**WARNING: SUFFOCATION AND ENTRAPMENT HAZARD**

Failure to follow these disposal instructions can result in death or serious injury.

**IMPORTANT:** Child entrapment and suffocation are not problems of the past. Junked or abandoned refrigerators are still dangerous even if they will sit for "just a few days." If you are getting rid of your old refrigerator, please follow the instructions below to help prevent accidents.

**Before You Throw Away Your Old Appliance**

- Take off the door and remove the door seal.
- Leave the shelves in place so that children may not easily climb inside.

### Refrigerant and Foam Disposal:

Dispose of refrigerator in accordance with Federal and Local Regulations. Flammable insulation material used requires special disposal procedures. Contact your local authorities for the environmentally safe disposal of your refrigerator.

## Grounding requirement

Your refrigerator must be grounded. Your refrigerator is equipped with a cord having a grounding wire with a grounding plug. The plug must be inserted into an outlet that is correctly installed and grounded.

Incorrect use of the grounding plug can result in a risk of electric shock. Consult a qualified electrician or service person if the grounding instructions are not completely understood, or if doubt exists as to whether your refrigerator is correctly grounded. See [Connecting power](#) on page 10.

## Features

- 4.9 cu ft (.13 cu m) storage capacity provides space for all your essentials
- Two shelves (one adjustable) help organize your items
- Separate lower freezer compartment stores frozen snacks, entrees, and more
- Freestanding design, reversible doors, and an adjustable foot allow for versatile placement options
- Stainless steel exterior is easy to clean and looks great in your kitchen

## Package contents

- 4.9 Cu. Ft. Bottom Mount Compact Fridge
- *User Guide*

## Dimensions

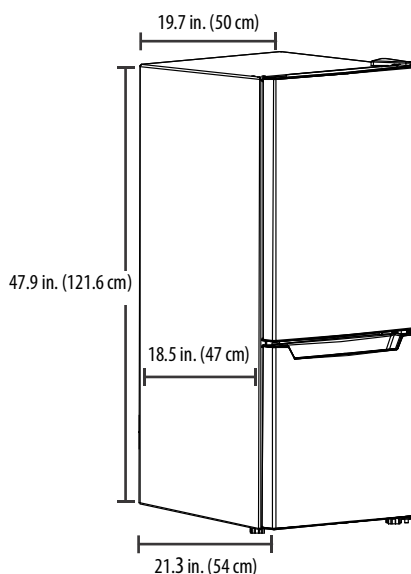

## Refrigerator parts

### Outside

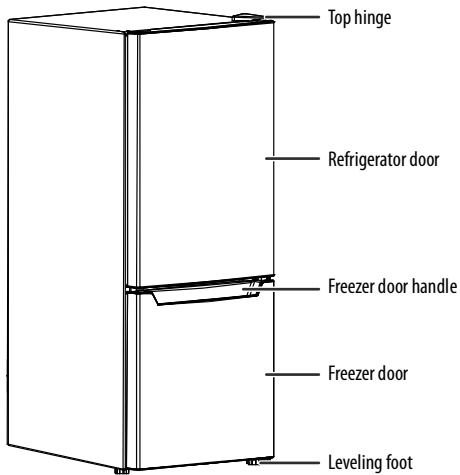

### Inside

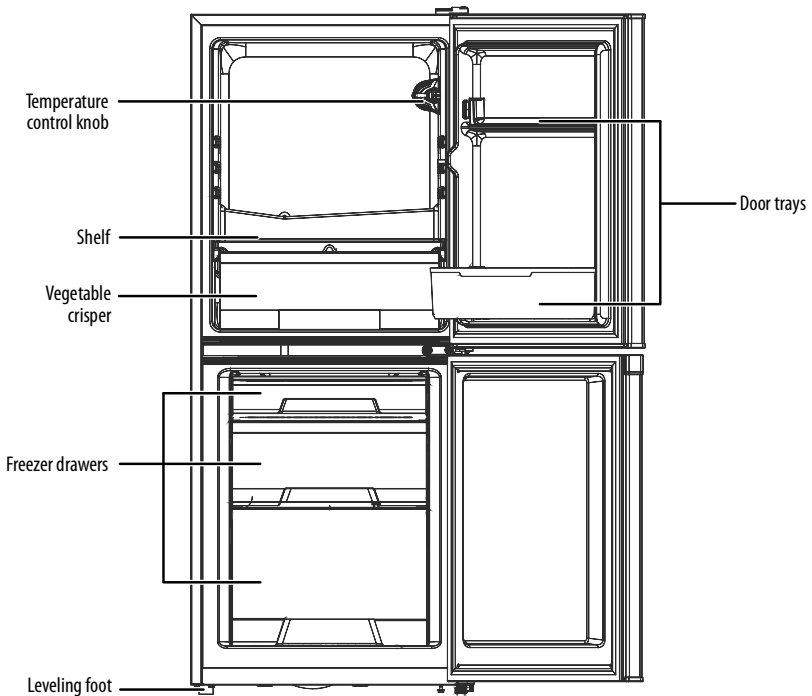

## Installing your refrigerator

### Before using your refrigerator

- Remove the exterior and interior packaging.
- Wash the inside with a damp, warm cloth and a baking soda solution (two tablespoons in a quart of water), then wipe dry with a dry cloth. Do this periodically to keep your refrigerator looking new.

### Finding a suitable location

<b>CAUTION:</b> Your refrigerator is not designed for a recessed installation.
--

- Place your refrigerator on a floor that is strong enough to support it when fully loaded.
- Do not install your refrigerator on carpeting or a rug.
- Your refrigerator is designed to be free standing and should not be recessed or built-in.
- Do not install your refrigerator in a garage or any other outside installation.
- Level your refrigerator using the leveling foot. If you do not level your refrigerator, the door may not close or seal correctly, causing cooling, frost, and moisture problems. Turn the leveling foot clockwise to raise or counterclockwise to lower a side.
- If you locate your refrigerator next to a fixed wall, allow sufficient space on the hinge side for the door to swing open.
- Position your refrigerator away from direct sunlight and sources of heat, such as a stove, heater, or radiator. Direct sunlight may affect the acrylic coating and heat sources may increase electrical consumption. Extremely cold temperatures may also prevent your refrigerator from performing correctly.
- Avoid locating your refrigerator in moist areas.
- Your refrigerator is designed to operate in a temperature range of 50° F (10° C) and 109° F (43° C). If you operate your refrigerator outside this temperature range, your refrigerator may not work correctly.



## Providing correct ventilation

Allow at least 3.9 in. (10 cm) between the left and right sides of your refrigerator and surrounding walls, at least 3.9 in. (10 cm) between the back of your refrigerator and the surrounding wall, and 11.8 in. (30 cm) between the top of your refrigerator and the cabinet above.

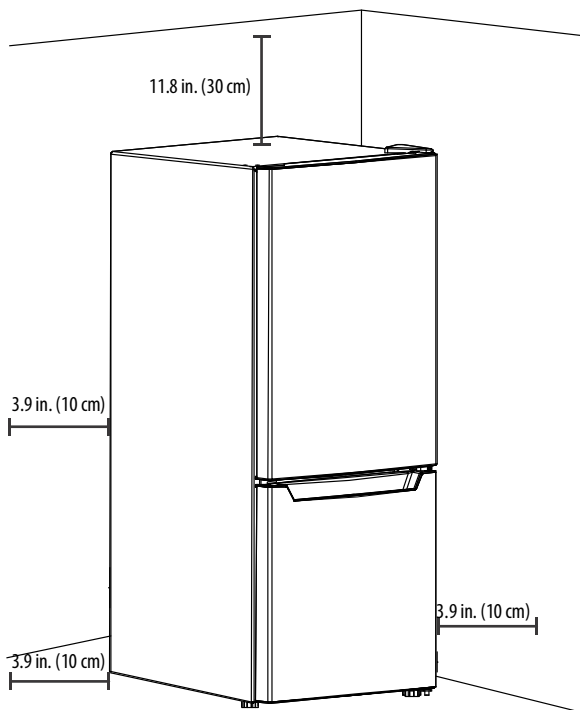

## Connecting power

Check your local power source. Your refrigerator requires a 115 V, 60 Hz power supply.

Use a receptacle that accepts the grounding prong. The power cord is equipped with a 3-prong (grounding) plug which mates with a standard 3-prong (grounding) wall outlet to minimize the possibility of electric shock hazard from your refrigerator.

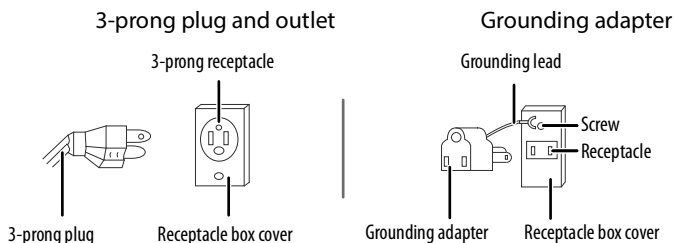

### Notes:

Make sure that:

- The power outlet accepts a 3-prong grounding plug. The third prong on the power cord plug grounds your refrigerator to minimize the possibility of electric shock. Do not modify the power plug.
- You do NOT plug anything else into the same power outlet as your refrigerator. You may overload the circuit which can cause a fire.
- You do NOT use an extension cord. If your refrigerator is too far from the power outlet, move your refrigerator or have a electrician install a plug closer to your refrigerator.
- The power outlet cannot be turned off with a switch or pull string.

## Reversing the door

**CAUTION:** If you lay your refrigerator on its back or side for any length of time, wait for six hours after you stand it up again before you plug it in. Otherwise, you may damage internal components.

You need the following tools to reverse the door:

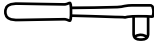

5/16" socket wrench



Flat blade screwdriver



Phillips screwdriver



Masking tape

- 1 Unplug your refrigerator and remove all of the food from the door shelves.
- 2 Tape the door to the refrigerator.

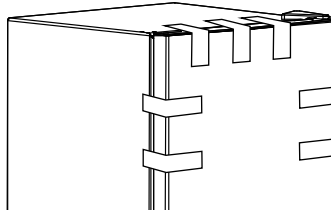

- 3 Remove the upper hinge cover, the upper hinge from the upper right side of your refrigerator, and the hole cover from the upper left side of your refrigerator.

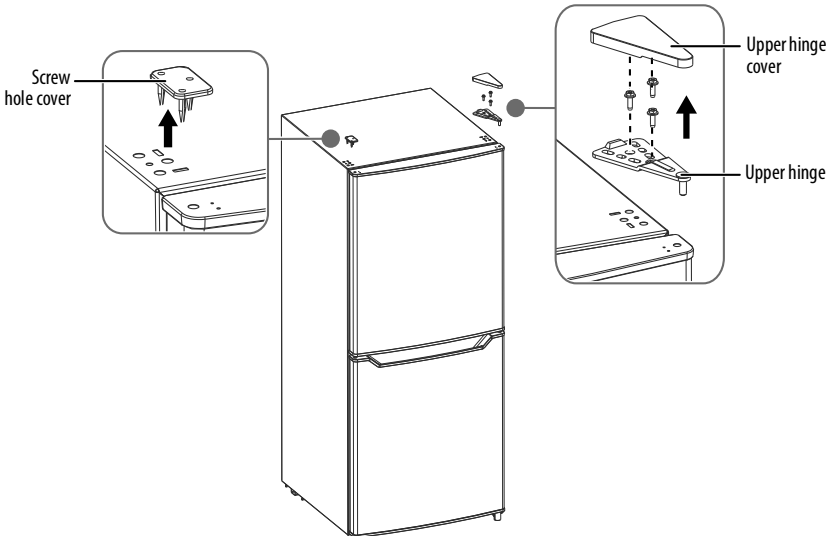

- 4 Remove the tape, then remove the refrigerator door and set it aside.

- 5** Remove the center hinge assembly from the center right side of your refrigerator and the screw hole caps from the center left side of your refrigerator, then remove the freezer door and set it aside. Door bushing

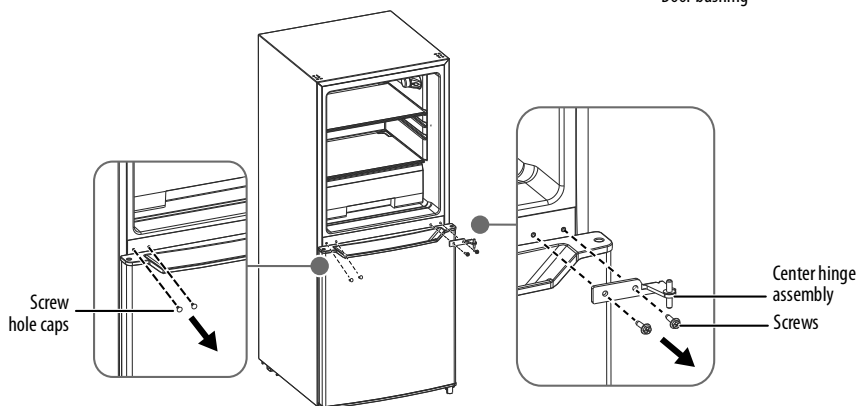

- 6** Remove the bottom hinge assembly from the bottom right side of your refrigerator and the adjustable foot from the bottom left side of your refrigerator.

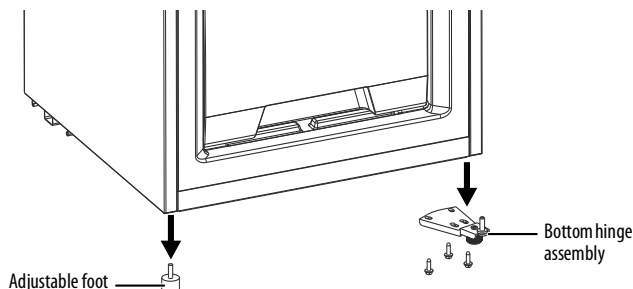

- 7** Install the bottom hinge assembly on the bottom left side of your refrigerator and the adjustable foot on the bottom right side of your refrigerator.

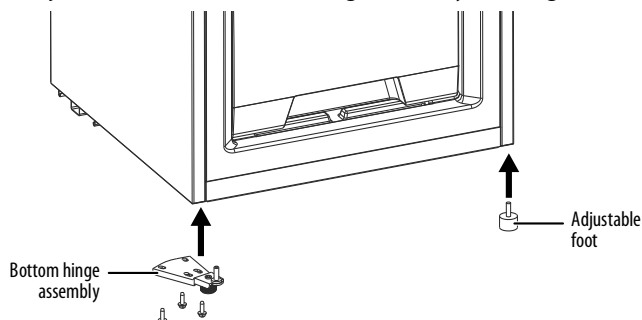

- 8** Remove the door stopper from the bottom right side of the freezer door and install it on the bottom left side of the freezer door.

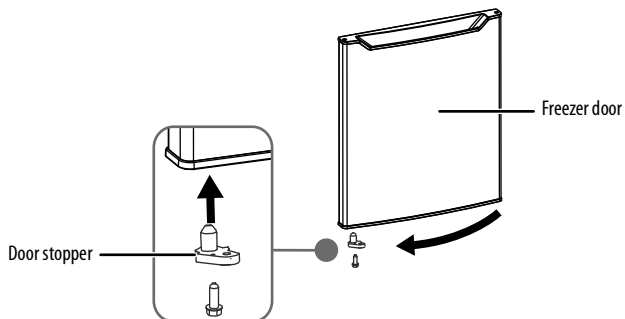

- 9** Put the freezer door on the bottom hinge and tape it into place temporarily.
- 10** Install the center hinge assembly on the center left side of your refrigerator and the screw hole caps on the center right side of your refrigerator.

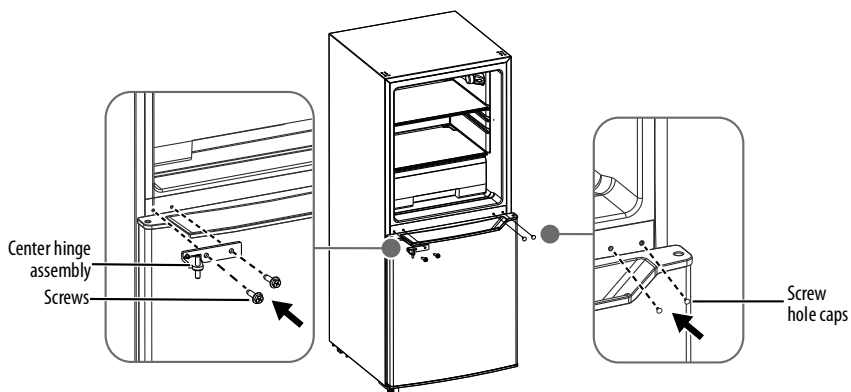

- 11** Remove the door stopper from the bottom right side of the refrigerator door, then remove the left door stopper from the accessory bag and install it on the bottom left side of the refrigerator door. Keep the right door stopper for possible future use.

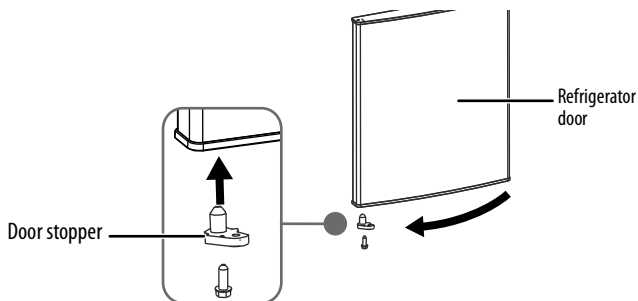

- 12** Place the refrigerator door on the middle hinge and tape it into place, then install the upper hinge and hinge cover on the upper left side of the refrigerator, and the screw hole cover on the upper right side of the refrigerator.

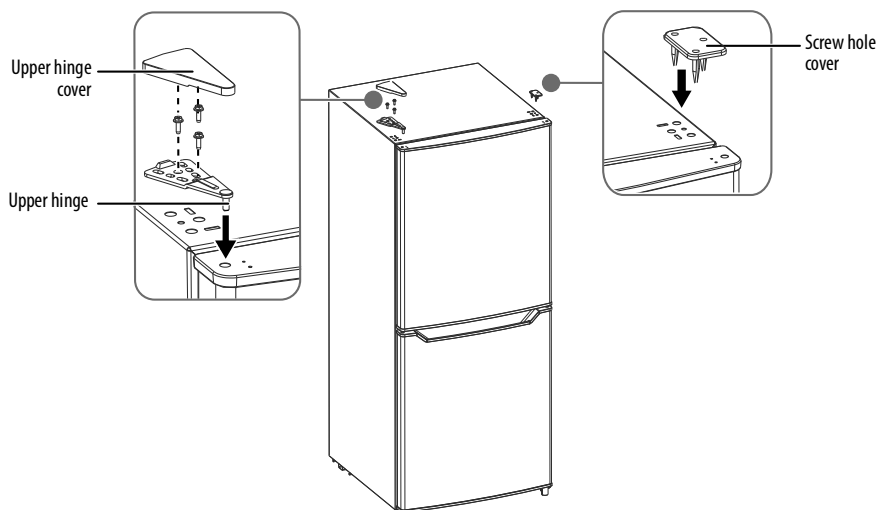

- 13** Untape the doors, then try both doors to make sure that they move freely.

**Note:** Make sure that the rubber gaskets make a good seal with the refrigerator all the way around the doors before tightening the hinge screws.

## Leveling your refrigerator

Your refrigerator must be level in order to function correctly. If your refrigerator is not leveled during installation, the door may not close or seal correctly, causing cooling, frost, or moisture problems.

- Rotate the leveling foot clockwise (to raise) your refrigerator or counterclockwise (to lower).

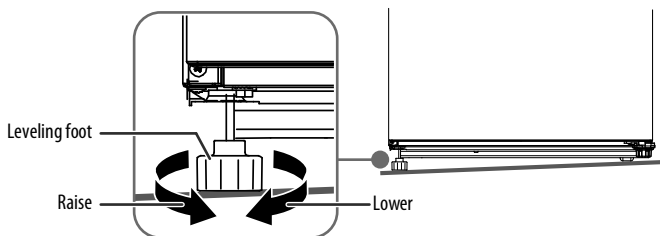

**Note:** To make it easier to adjust the foot, have someone push against the top of your refrigerator to tilt it slightly.

## Using your refrigerator

### Turning on your refrigerator for the first time

#### CAUTIONS:

- If you run your refrigerator below the coldest temperature (if the ambient temperature is below 50° F [10° C]), it may not operate consistently. For example, the freezer temperature may become too warm and the contents may defrost.
- Internal temperatures can vary based on the location of your refrigerator, the ambient room temperature, and how often you open the doors.
- Do not store carbonated drinks in the freezer compartment. They may break and damage your refrigerator.
- Do not exceed the storage times recommended by the food manufacturers for any kind of food.

When you plug in your refrigerator for the first time, the temperature indicator lights solid for two seconds, then your refrigerator runs at the **2** setting by default.

Before storing foods in your refrigerator, turn on the refrigerator and freezer compartments, then wait for two to three hours to make sure that they are working correctly and to let both compartments reach the correct temperatures. In the summer, when ambient temperatures are higher, wait for four hours.

### Setting the thermostat

You can adjust the temperature of your refrigerator by turning the thermostat dial.

- The thermostat can be set between **1** and **3**.

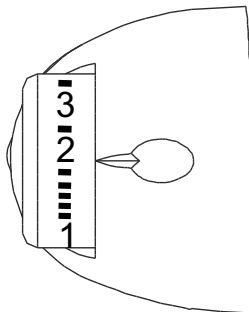

- **1** is the warmest setting.
- **3** is the coldest setting.
- The recommended setting is **2**.
- Set the dial to **0** to turn off the cooling function.

The internal temperature of your refrigerator can vary, based on ambient temperature, the quantity of items stored, and how frequently the door is opened.

## Adjusting the shelf

Your refrigerator has one adjustable shelf.

- 1 Open the refrigerator or freezer compartment door all the way.
- 2 Lift the back of the shelf, then pull it out.

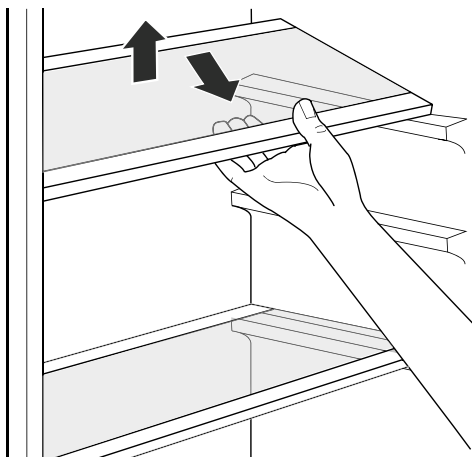

- 3 To reinstall the shelf, align the shelf above the shelf rails with the back of the shelf tilted up. Slide the shelf on to the rails, then lower the back.

## Adjusting the door racks

**CAUTION:** Do not put too many heavy items in the door racks. You may break the racks.

- 1 Remove all items from a refrigerator door racks.
- 2 While holding the rack with one hand, use the other hand to tap the bottom of the rack up several inches.

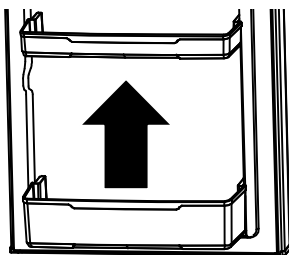

- 3 Remove the rack from the door.
- 4 To reinstall the rack, align the rack in the door, then press down to lock the rack in place. You hear a click when the rack is locked in place.



## Removing the crisper

**Note:** You can remove the freezer drawer in the same way that you remove the crisper drawer.

The crisper is designed to store fruits and vegetables. Putting fruits and vegetables inside the crisper helps avoid losing moisture and prevents flavor from getting into other foods.

- 1 Open the refrigerator compartment door all the way.
- 2 Lift the crisper drawer with its glass cover up, then pull the crisper out.

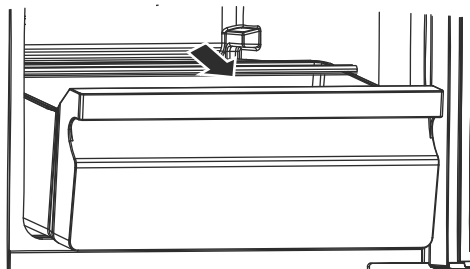

- 3 To replace the crisper, slide it into the compartment, then lower it into place.

## Maintaining your refrigerator

### Cleaning your refrigerator

**CAUTION:**

To prevent damage to the finish:

- Do not use gasoline, benzine, thinner, or other similar solvents.
- Do not use abrasive cleaners.
- Do not use sharp objects because they are likely to scratch the surface.

We recommend that you do the following every time you clean your refrigerator to keep it running odor-free and efficiently:

- 1 Unplug your refrigerator from the power outlet.
- 2 Remove all food.
- 3 If you want to remove the door racks, shelves, crisper, or freezer shelf, see:
  - [Adjusting the shelf](#) on page 16
  - [Adjusting the door racks](#) on page 16
  - [Removing the crisper](#) on page 17
- 4 Clean the doors, handles, and refrigerator surfaces with a mild detergent, then rinse with warm water using a wrung-out sponge or cloth.
- 5 Wash the inside with a damp warm cloth soaked in a solution of one quart of lukewarm water to two tablespoons of baking soda solution, then rinse with warm water using a wrung-out sponge or cloth.
- 6 Clean the baskets, shelves, and drawers with a mild detergent and soft cloth, then rinse with warm water.

- 7 Make sure that you keep the door gaskets (seals) clean so that the door seals tightly. This helps your refrigerator run efficiently.

**CAUTION:** Make sure that the door gaskets are completely dry before you plug your refrigerator into the power outlet.

- 8 Dry all surfaces and removable parts before putting them back into place.
- 9 Plug your refrigerator into the power outlet.

## Defrosting your refrigerator

- 1 Turn off your refrigerator, then remove the food from the refrigerator and and freezer and, if possible, place it where it won't get warm and spoil.
- 2 Let your refrigerator/freezer warm naturally, or you can use hot water to speed up the process, then use a plastic or wooden spoon or spatula to help remove the frost.
- 3 Wash the inside with a damp, warm cloth soaked in a solution of one quart of lukewarm water to two tablespoons of baking soda solution, then rinse with warm water using a wrung-out sponge or cloth.
- 4 Clean the compressor compartment and the water drain tray.
- 5 After defrosting, replace the food in the refrigerator and freezer, then close the doors and turn on the power.

## Shutting down your refrigerator

- 1 Turn off your refrigerator and unplug it from the power outlet.
- 2 Remove all food.
- 3 Clean your refrigerator.
- 4 Leave the door open slightly to avoid possible formation of condensation, mold, or odor.

**CAUTION:** Use extreme caution with children. Your refrigerator shouldn't be accessible to child's play. If a child is trapped inside your refrigerator, the child may suffocate.

## Moving your refrigerator

- 1 Turn off your refrigerator and unplug it from the power outlet.
- 2 Remove all food.
- 3 Securely tape down all loose items inside your refrigerator.
- 4 Tape the doors shut.
- 5 Make sure that your refrigerator stays in the upright position during transportation.

## Tips on saving energy

- Locate your refrigerator in the coolest area of the room, away from heat producing appliances or heating ducts and out of direct sunlight.
- Let hot foods cool before placing them in your refrigerator. Overloading your refrigerator forces the compressor to run longer. Foods that freeze too slowly may lose quality or spoil.

- Wrap foods correctly and wipe containers dry before placing them in your refrigerator. This cuts down on frost build-up inside your refrigerator.
- Organize and label food to reduce door openings and extended searches.
- Do not use aluminum foil, wax paper, or paper toweling to line shelves. Liners interfere with cold air circulation and make your refrigerator less efficient.

## Troubleshooting

**CAUTION:** Don't try to repair your refrigerator yourself. Doing so invalidates the warranty.

PROBLEM	SOLUTION
My refrigerator does not work.	<ul style="list-style-type: none"> <li>• Make sure that your refrigerator is securely plugged into a working outlet.</li> <li>• Make sure that your power source has the correct voltage. Your refrigerator's voltage rating is on a label on the back of your refrigerator.</li> <li>• Check the house fuse or circuit breaker box and replace the fuse or reset the circuit breaker.</li> </ul>
The refrigerator compartment has a bad odor.	<ul style="list-style-type: none"> <li>• Make sure that all food with a strong odor (like onions) is wrapped or stored in airtight packaging.</li> <li>• Certain containers and wrapping materials (such as paper, foil, or plastic) can cause odors. If you think this might be the case, try using different containers or a different brand of wrapping material.</li> <li>• Check for spoiled food and remove it.</li> <li>• Clean the inside of your refrigerator. See <a href="#">Cleaning your refrigerator</a> on page 17.</li> </ul>
The refrigerator doors do not close completely.	<ul style="list-style-type: none"> <li>• Make sure that no food packages are in the way.</li> <li>• Make sure that the door gaskets (seals) are clean. See <a href="#">Cleaning your refrigerator</a> on page 17.</li> <li>• If the door gasket does not seal, try heating then cooling the gasket. You can use an electric hair dryer to heat the gasket.</li> <li>• Make sure that your refrigerator is level. See <a href="#">Leveling your refrigerator</a> on page 14.</li> </ul>
The temperature is too hot.	<ul style="list-style-type: none"> <li>• You may have left the doors open too long or opened them too frequently.</li> <li>• Make sure that no obstacle is keeping the doors from closing correctly.</li> <li>• Adjust the refrigerator or freezer compartment temperature. See <a href="#">Setting the thermostat</a> on page 15.</li> <li>• Your refrigerator may not have enough clearance from walls or the ceiling. See <a href="#">Providing correct ventilation</a> on page 9.</li> </ul>
The temperature is too cold.	<ul style="list-style-type: none"> <li>• Adjust the refrigerator or freezer compartment temperature. See <a href="#">Setting the thermostat</a> on page 15.</li> </ul>

PROBLEM	SOLUTION
A layer of frost occurs in one of the compartments.	<ul style="list-style-type: none"> <li>• If the freezer is opened frequently or kept open too long, a layer of frost may occur on the compartment's interior walls.</li> <li>• Make sure that the air outlets are not blocked by food.</li> <li>• Make sure that the doors are fully closed.</li> </ul>
The refrigerator door is hard to open or close.	<ul style="list-style-type: none"> <li>• When you open the refrigerator door, warm air rushes inside. When you close the door, the warm air rushes to the condenser which causes a vacuum. This causes the door to be hard to open for about 10 to 15 seconds after closing.</li> <li>• If the door is hard to open at other times, try rubbing paraffin wax or petroleum jelly along the edges of the entire gasket. Paraffin wax is used for canning and is safe for use around food.</li> <li>• If the door is hard to close, try slightly loosening the tension on the door hinges.</li> </ul>
The compressor runs for a long time or turns on and off frequently.	<p>The compressor runs longer if:</p> <ul style="list-style-type: none"> <li>• The room temperature is high.</li> <li>• You just added a large amount of food. Wait for the food to freeze, then check again.</li> <li>• You open and close the door frequently.</li> <li>• The door gasket is dirty. Clean the gasket. See <a href="#">Cleaning your refrigerator</a> on page 17.</li> <li>• Your refrigerator has been disconnected for a period of time. Wait for your refrigerator to cool (about four hours) before adding food.</li> <li>• You have the temperature set too low.</li> </ul>
My refrigerator makes unusual noises or vibrations.	<p>The following noises are normal:</p> <ul style="list-style-type: none"> <li>• Compressor running noises.</li> <li>• Air movement noises from the small fan motor in the freezer compartment or other compartments.</li> <li>• Popping noises during automatic defrosting.</li> </ul> <p>Other unusual noises or vibrations may occur:</p> <ul style="list-style-type: none"> <li>• If you have items on the top of your refrigerator. Remove the items.</li> <li>• If your refrigerator is not level. See <a href="#">Leveling your refrigerator</a> on page 14.</li> <li>• If your refrigerator is touching walls. Move it away from the walls.</li> <li>• If the shelves or drawers are installed incorrectly.</li> </ul>
The outside of my refrigerator is hot.	<p>Heat dissipation from the condenser may make the outside feel hot. This is normal and happens if:</p> <ul style="list-style-type: none"> <li>• The room temperature is high.</li> <li>• You have too much food in your refrigerator.</li> <li>• You open and close the doors excessively.</li> </ul>

PROBLEM	SOLUTION
Water condenses on the outside of my refrigerator.	<ul style="list-style-type: none"> <li>• Condensation on the exterior surface and door seal is normal when the room humidity is high.</li> <li>• When you open the door, warm, moist outside air meets the cold dry air inside your refrigerator. This is normal.</li> </ul>

## Specifications

External dimensions (H x W x D)	47.9 x 19.7 x 21.3 in. (121.6 x 50 x 54 cm)
Internal dimensions (H x W x D)	<b>Refrigerator compartment:</b> 20.1 x 16.5 x 16.5 in. (51 x 41.9 x 42 cm) <b>Freezer compartment:</b> 19.2 x 14 x 15.6 in. (48.8 x 35.5 x 39.6 cm)
Weight	<b>Gross Weight:</b> 85.9 lb. (39 kg) <b>Net Weight:</b> 77.2 lb. (35 kg)
Temperature ranges	<b>Refrigerator:</b> 32° F to 50° F (0° C to 10° C) <b>Freezer:</b> -11° F to 10° F (-24° C to -12° C)
Power requirements	AC 115 V ~ 60 Hz
Current	1.5 A
Power cord length	5.4 ft. (1.65 m)
Power consumption (yearly)	335 kwh/year
Certifications	UL approved

## ONE-YEAR LIMITED WARRANTY

Best Buy, or its Authorized Partner of Insignia branded products, warrants to you, the original purchaser of this new Insignia branded product ("Product"), that the Product shall be free of defects in the original manufacture of the material or workmanship for a period of one (1) year from the date of your purchase of the Product or the date of delivery (if later than the date of purchase) ("Warranty Period").

For this warranty to apply, your Product must be (i) purchased in the United States or Canada from a Best Buy branded retail store, online at [www.bestbuy.com](http://www.bestbuy.com) or [www.bestbuy.ca](http://www.bestbuy.ca), or from Best Buy's Authorized Partner, and (ii) packaged or sold with this warranty statement.

The term "Best Buy", as used in this warranty, refers to Best Buy branded retail stores, [www.bestbuy.com](http://www.bestbuy.com), [www.bestbuy.ca](http://www.bestbuy.ca), and Best Buy's Authorized Partner.

Because Insignia cannot control the quality of products sold by unauthorized sellers, this warranty applies only to Products that were purchased from Best Buy or an Insignia Authorized Partner, unless otherwise prohibited by law. Insignia reserves the right to reject warranty claims for Products purchased from unauthorized sellers, including unauthorized websites.

REPAIR OR REPLACEMENT, AS PROVIDED UNDER THIS WARRANTY, IS YOUR EXCLUSIVE REMEDY FOR BREACH OF WARRANTY. INSIGNIA SHALL NOT BE LIABLE FOR ANY INCIDENTAL OR CONSEQUENTIAL DAMAGES FOR THE BREACH OF ANY EXPRESSED OR IMPLIED WARRANTY ON THIS PRODUCT, INCLUDING, BUT NOT LIMITED TO, LOST DATA, LOSS OF USE OF YOUR PRODUCT, LOST BUSINESS, OR LOST PROFITS. INSIGNIA PRODUCTS MAKES NO OTHER EXPRESS WARRANTIES WITH RESPECT TO THE PRODUCT. ALL EXPRESSED AND IMPLIED WARRANTIES FOR THE PRODUCT, INCLUDING BUT NOT LIMITED TO ANY IMPLIED WARRANTIES OF AND CONDITIONS OF MERCHANTABILITY AND FITNESS FOR A PARTICULAR PURPOSE, ARE LIMITED IN DURATION TO THE WARRANTY PERIOD SET FORTH ABOVE AND NO WARRANTIES, WHETHER EXPRESSED OR IMPLIED, WILL APPLY AFTER THE WARRANTY PERIOD. SOME STATES, PROVINCES, AND JURISDICTIONS DO NOT ALLOW LIMITATIONS ON (i) HOW LONG AN IMPLIED WARRANTY LASTS, (ii) EXCLUSION OR LIMITATION OF INCIDENTAL OR CONSEQUENTIAL DAMAGES, or (iii) LIMITATION OF INCIDENTAL OR CONSEQUENTIAL DAMAGES, SO THE ABOVE LIMITATIONS OR EXCLUSIONS MAY NOT APPLY TO YOU. THIS WARRANTY GIVES YOU SPECIFIC LEGAL RIGHTS, AND YOU MAY ALSO HAVE OTHER RIGHTS, WHICH VARY FROM STATE TO STATE OR PROVINCE TO PROVINCE.

### ***How long does the coverage last?***

The Warranty Period lasts for 1 year (365 days) from the date you purchased the Product or the date of delivery (if later than the date of purchase). Your purchase date is printed on the receipt you received with the Product. In the event that Authorized Partner ceases to sell the covered Insignia branded product, this warranty shall terminate for that product and there shall be no repair or replacement of the Product.

### ***What does this warranty cover?***

During the Warranty Period, if the original manufacture of the material or workmanship of the Product is determined to be defective by an authorized Insignia repair center or store personnel, Insignia will (at its sole option): (1) repair the Product with new or rebuilt parts; or (2) replace the Product at no charge with new or rebuilt comparable products or parts. Products and parts replaced under this warranty become the property of Insignia and are not returned to you. If service of Products or parts are required after the Warranty Period expires, you must pay all labor and parts charges. This warranty lasts as long as you own your Insignia Product during the Warranty Period. Warranty coverage terminates if you sell or otherwise transfer the Product.

### ***How to obtain warranty service?***

If you purchased the Product at a Best Buy retail store location or from a Best Buy online website ([www.bestbuy.com](http://www.bestbuy.com) or [www.bestbuy.ca](http://www.bestbuy.ca)), please take your original receipt and the Product to any Best Buy store. Make sure that you place the Product in its original packaging or packaging that provides the same amount of protection as the original packaging. If you purchased your Product from an Authorized Partner, call Insignia at 1-877-467-4289.

To obtain warranty service, in the United States and Canada call 1-877-467-4289. Call agents may diagnose and correct the issue over the phone.

If you purchased the Product from an Authorized Partner other than Best Buy, please call 1-888-BESTBUY in the United States or 1-866-BESTBUY in Canada. You will be asked to provide proof of purchase and to return your Product to Best Buy. Make sure that you put the Product in its original packaging or packaging that provides the same amount of protection as the original packaging.

***Where is the warranty valid?***

This warranty is valid only in the United States and Canada to the original purchaser of the product from an Authorized Partner, in the country where the original purchase was made.

***What does the warranty not cover?***

- Food, beverage, and/or medicine loss/spoilage.
- Damage to other products caused by a power surge or other similar issue while connected to the Product.
- Customer instruction/education.
- Installation.
- Set up adjustments.
- Cosmetic damage.
- Damage due to weather, lightning, and other acts of God, such as power surges.
- Accidental damage.
- Misuse.
- Abuse.
- Negligence.
- Commercial purposes/use, including but not limited to use in a place of business or in communal areas of a multiple dwelling condominium or apartment complex, or otherwise used in a place of other than a private home.
- Modification of any part of the Product, including the antenna.
- Display panel damaged by static (non-moving) images applied for lengthy periods (burn-in).
- Damage due to incorrect operation or maintenance.
- Connection to an incorrect voltage or power supply.
- Damage due to attempted repair by any person not authorized by Insignia to service the Product.
- Products sold "as is" or "with all faults".
- Consumables, including but not limited to batteries (i.e. AA, AAA, C etc.).
- Products where the factory applied serial number has been altered or removed.
- Loss or Theft of this product or any part of the product.
- Display panels containing up to three (3) pixel failures (dots that are dark or incorrectly illuminated) grouped in an area smaller than one tenth (1/10) of the display size or up to five (5) pixel failures throughout the display. (Pixel based displays may contain a limited number of pixels that may not function normally.).
- Failures or Damage caused by any contact including but not limited to liquids, gels or pastes.

1-877-467-4289 | [www.insigniaproducts.com](http://www.insigniaproducts.com)

INSIGNIA is a trademark of Best Buy and its affiliated companies.

Distributed by Best Buy Purchasing, LLC

7601 Penn Ave South, Richfield, MN 55423 U.S.A

©2025 Best Buy. All rights reserved.

# For Québec Customers Only

## Availability Guarantee

### **Notice for Section 39 of the *Consumer Protection Act* Regarding the Availability Guarantee of Replacement Parts, Repair Services, and Maintenance Information**

Please be advised that Best Buy Canada Ltd. ("Best Buy"), including its affiliated entities, does not guarantee, within the meaning of Section 39 of the *Consumer Protection Act* and the applicable regulations, the availability of replacement parts, repair services, or maintenance or repair information relating to products sold, manufactured, imported, advertised, or sold by Best Buy or under its Insignia brand, Best Buy Essentials, Rocketfish, or other brands sold or manufactured by Best Buy.

**This Notice does not affect Best Buy's One-Year Limited Warranty for Insignia Products.**

**Please visit [www.bestbuy.ca/garantie-disponibilite](http://www.bestbuy.ca/garantie-disponibilite) for additional information.**



INSIGNIA™

**[www.insigniaproducts.com](http://www.insigniaproducts.com)**

1-877-467-4289 (U.S. and Canada)



INSIGNIA is a trademark of Best Buy and its affiliated companies.

Distributed by Best Buy Purchasing, LLC

Richfield, MN 55423

©2025 Best Buy. All rights reserved.

V2 ENGLISH  
25-0970