



# UNIVERSAL WIRELESS REAR SPEAKER KIT

RF-WHTIB-A

## USER GUIDE

Before using your new product, please read these instructions to prevent any damage.

# Rocketfish RF-WHTIB-A Universal Wireless Rear Speaker Kit

## Contents

Introduction.....	2
Features.....	5
Setting up your wireless rear speaker kit .....	8
Using your wireless rear speaker kit.....	14
Troubleshooting.....	16
Specifications .....	17
Legal notices.....	18
One-Year Limited Warranty.....	21

## Introduction

Congratulations on your purchase of a Rocketfish RF-WHTIB-A Universal Wireless Rear Speaker Kit. Your Wireless Rear Speaker Kit represents the state of the art in wireless speaker kit design, and is designed for reliable and trouble-free performance.

This manual explains how to correctly install, operate, and get the best performance from your wireless rear speaker kit. Read this user guide carefully before installing your system, then keep it near your system for quick reference.

Your Universal Wireless Rear Speaker Kit uses a proprietary 2.4 GHz wireless communication system to transmit low-latency, high fidelity audio to a stereo amplifier, providing a superior level of audio quality and resistance to interference.

The system accepts speaker-level inputs, and is compatible with a complete range of multichannel home theater receiver systems or home theater receivers.

## Safety information



### WARNING:

**TO REDUCE THE RISK OF FIRE OR ELECTRIC SHOCK,  
DO NOT EXPOSE THIS APPLIANCE TO RAIN OR  
MOISTURE.**

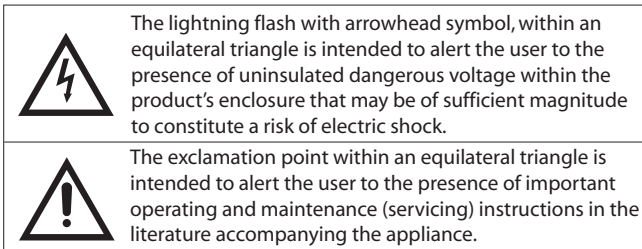

## Important Safety Instructions

- 1) Read these instructions.
- 2) Keep these instructions.



- 3) Heed all warnings.
- 4) Follow all instructions.
- 5) Do not use this apparatus near water.
- 6) Clean only with dry cloth.
- 7) Do not block any ventilation openings. Install in accordance with the manufacturer's instructions.
- 8) Do not install near any heat sources such as radiators, heat registers, stoves, or other apparatus (including amplifiers) that produce heat.
- 9) Do not defeat the safety purpose of the polarized or grounding-type plug. A polarized plug has two blades with one wider than the other. A grounding type plug has two blades and a third grounding prong. The wide blade or the third prong are provided for your safety. If the provided plug does not fit into your outlet, consult an electrician for replacement of the obsolete outlet.
- 10) Protect the power cord from being walked on or pinched particularly at plugs, convenience receptacles, and the point where they exit from the apparatus.
- 11) Only use attachments/accessories specified by the manufacturer.
- 12) Unplug this apparatus during lightning storms or when unused for long periods of time.
- 13) Refer all servicing to qualified service personnel. Servicing is required when the apparatus has been damaged in any way, such as power-supply cord or plug is damaged, liquid has been spilled or objects have fallen into the apparatus, the apparatus has been exposed to rain or moisture, does not operate normally, or has been dropped.

## Additional safety information

- The apparatus shall not be exposed to dripping or splashing and no objects filled with liquids, such as vases, shall be placed on the apparatus.
- The AC power plug or an appliance coupler is used as the disconnect device. This disconnect device shall remain readily operable.
- Read the Rating Labels on the bottom of the sender and receiver for power input and other safety information.

## Features

- 2.4 GHz wireless sender and wireless receiver
- Transmits high quality audio over a radio frequency communication link
- Compact size
- Hidden antennas
- Low power consumption

## Package contents

Examine the contents of the box for your Universal Wireless Rear Speaker Kit. The box should contain:

- Wireless sender
- Wireless receiver
- Power adapter (for the wireless sender)
- Power cord (for the wireless receiver)
- 2-foot speaker wires (2)
- *User Guide*
- *Quick Setup Guide*

# Wireless sender

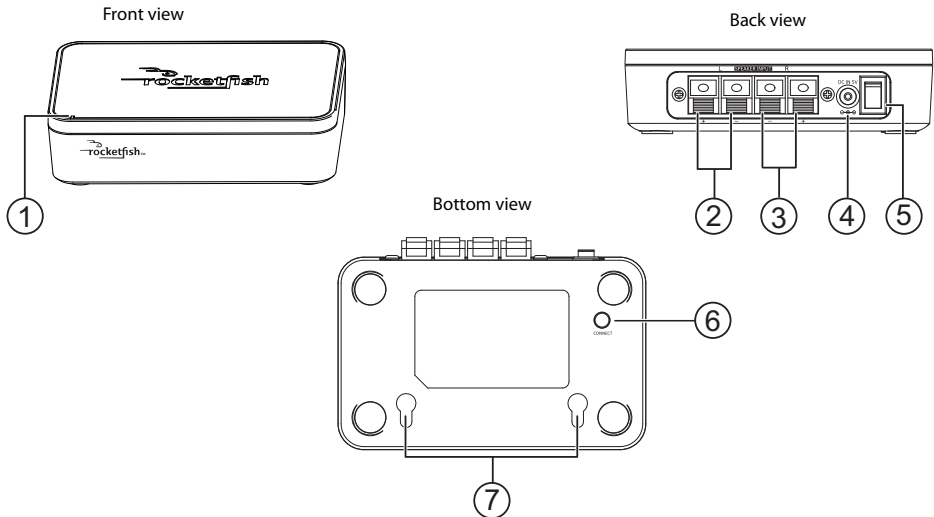

#	Feature
1	Power indicator LED
2	Left speaker input terminals
3	Right speaker input terminals
4	DC IN jack
5	Power switch
6	CONNECT button
7	Hanging holes for wall mounting the wireless sender.

## Wireless receiver

Front view

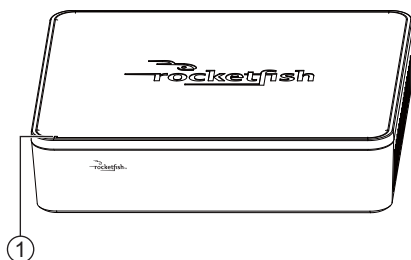

Back view

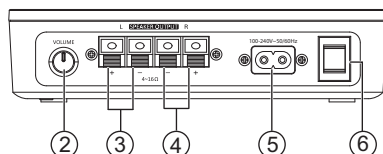

Bottom view

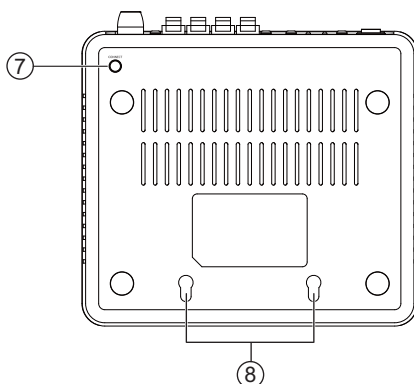

#	Feature
1	Power indicator LED
2	Volume control knob
3	Left speaker output terminals
4	Right speaker output terminals
5	AC IN jack
6	Power switch
7	CONNECT button
8	Hanging holes for wall mounting the wireless receiver.

## Setting up your wireless rear speaker kit

The following diagram shows a typical home theater setup using the Wireless Rear Speaker Kit. The following sections provide further details on how to setup and operate this product.

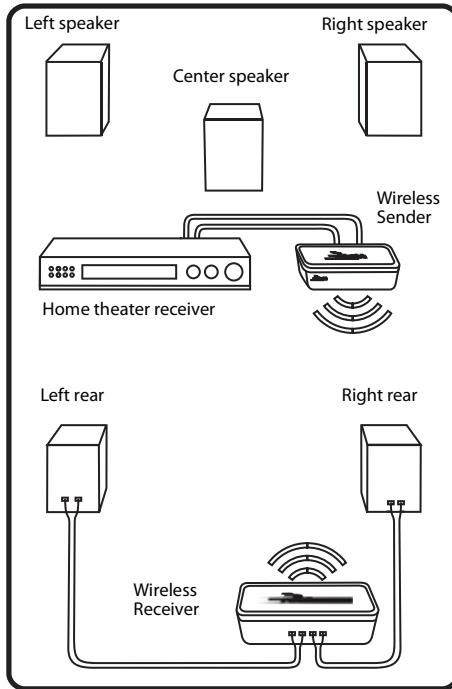



## Connecting the wireless sender

### Connecting the sender to the home theater receiver

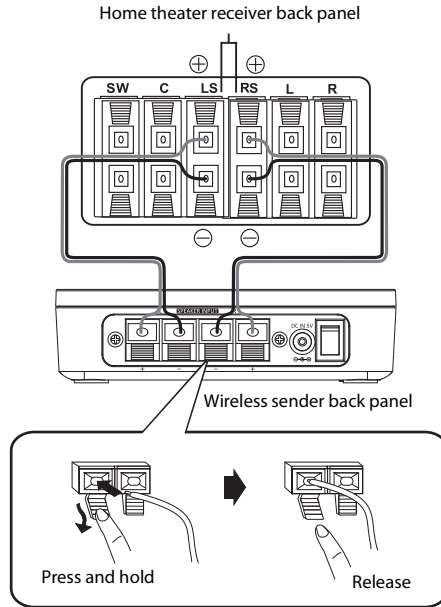

**Caution:** Turn off your home theater receiver while connecting the units.

### **To connect the home theater receiver to the wireless sender:**

- 1 Using the included 2-foot speaker cords, connect the right rear speaker terminals of your home theater receiver to the right speaker terminals of the wireless sender by connecting the red wire to the red (+) terminals, and the black wire to the black (-) terminals.

- 2 Connect the left rear speaker terminals of the home theater receiver the same way.

**Notes:**

*Make sure that the exposed tips of the speaker wire do not touch each other, and that they are fully inserted into the terminals.*

*Speaker wire colors may vary with different speaker systems.*

*Make sure you connect your home theater receiver using the rear speaker terminals only.*

## Connecting the wireless sender to the power adapter

The power adapter can be connected to a power outlet or the SWITCHED AC outlet of your home theater receiver. If you connect it to the SWITCHED AC outlet of your home theater receiver, each time you turn your home theater receiver on or off, the wireless sender is also turned on or off.

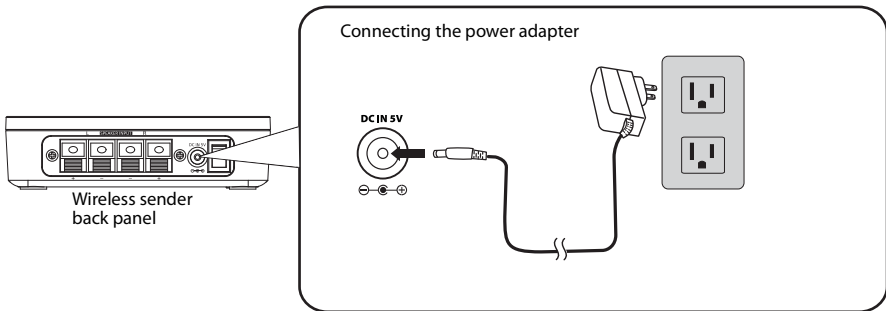

**Caution:** To avoid risk of fire, and to prevent damage, only use the power adapter supplied with your wireless rear speaker kit.

## Connecting the wireless receiver

### Connecting the wireless receiver to your rear speakers

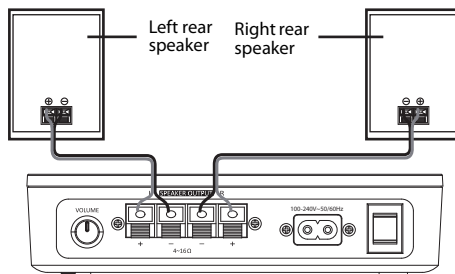

#### ***To connect the rear speakers to the wireless receiver:***

- 1** Connect the right speaker to the right speaker terminals of the wireless receiver, and the left speaker to the left speaker terminals.
- 2** If the speakers have wires instead of terminals, connect the positive (+) wire from the right speaker to the red (+) terminal for the right speaker on the wireless receiver and the negative (-) wire from the right speaker to the black (-) terminal for the right speaker on the wireless receiver.
- 3** Connect the left speaker the same way.

#### ***Notes:***

*For speaker wires that have proprietary connectors, you may strip the end of the wires to allow connection to the wireless receiver. However, check with the speaker manufacturer before doing this, as it may void the warranty.*

*Make sure that the exposed tips of each speaker wire do not touch each other, and that they are fully inserted into the terminals.*

## Connecting the wireless receiver to the power cord

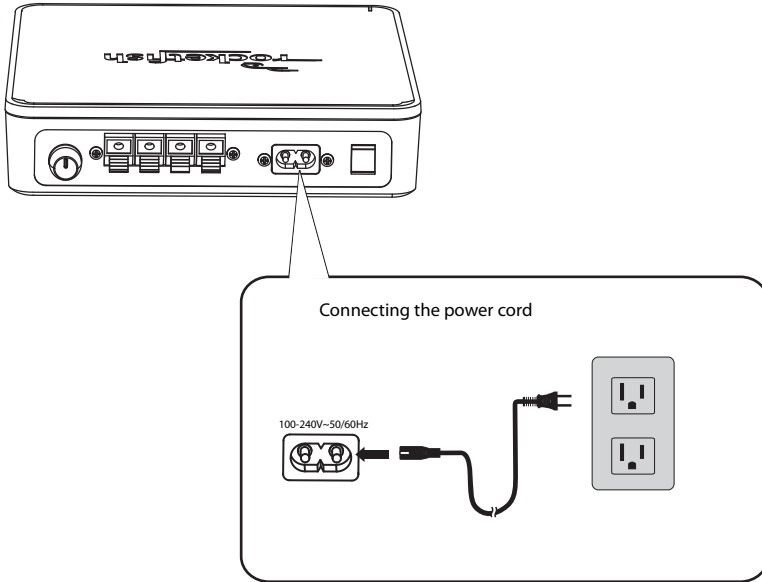

### **To connect the wireless receiver to the power cord:**

**Note:** Plug the power cord in only after all speakers are connected to the wireless receiver.

- 1 Plug the small (female) end of the power cord into the AC 100V-240V~50/60Hz jack on the back of the wireless receiver.
- 2 Plug the large (male) end of the power cord into a power outlet.

## Placing the wireless sender and wireless receiver

The wireless sender and wireless receiver must be separated by at least 12 inches and be within 100 feet of each other for linked operation.

To avoid risk of electric shock and fire, and to prevent damage, locate the wireless sender and wireless receiver units with no obstructions in front.

## Wall mounting the wireless sender and wireless receiver (optional)

The hanging holes for wall mounting both the wireless sender and wireless receiver are 2 5/8" (67 mm) apart.

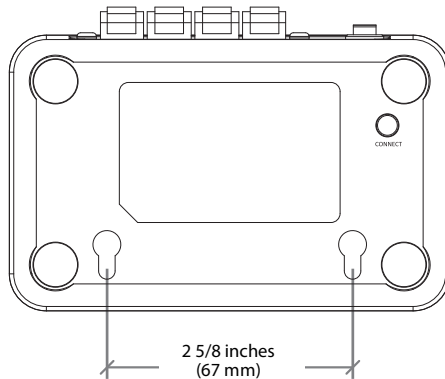

**Note:** If you need to mount the wireless sender or wireless receiver on a wall, install it against the wall so that cool air can travel through the ventilation slots in the unit and come out the top.

# Using your wireless rear speaker kit

## Establishing communications between the wireless sender and wireless receiver

### **To turn on the System:**

- 1 Turn on the power switch on the back panel of the wireless sender. The LED indicator blinks to indicate that the wireless sender is plugged in.

Blinking LED

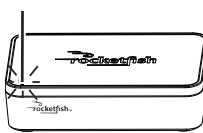

- 2 Turn on the power switch on the back panel of the wireless receiver. The LED indicator blinks to indicate that the wireless receiver is plugged in.

Blinking LED

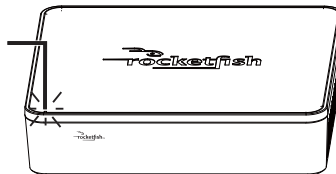

The wireless sender and wireless receiver were pre-paired at the factory. When an active link is established between them, the LED indicators turn solid.

**Note:** In case the indicators continue to blink after 30 seconds, it means there is no active link between the wireless sender and wireless receiver. Try to connect the system manually using the **CONNECT** button. For more information, see "Troubleshooting" on page 16.

## Listening to the system

### ***To listen to the system:***

- 1 Turn on the system. Make sure that there is an active link between the wireless sender and wireless receiver.
- 2 Turn on your home theater receiver, then play the audio or video source through your home theater receiver.

The volume control on the wireless receiver is only used to adjust the balance of the volume between the front and rear speakers. After the system is set up, we recommend that you adjust the volume balance one time.

### ***To adjust the volume balance:***

- 1 Turn on the wireless sender and wireless receiver, then turn on the home theater receiver and adjust it to your normal listening level.
- 2 Adjust the volume on the wireless receiver, using the volume control knob, to balance the front and rear speakers.  
After the volume of the wireless receiver is set up, always adjust the volume using the volume control on your home theater receiver whenever needed.

### ***To turn off the system:***

- 1 Turn off the power switch on the back of the wireless sender. The LED indicator turns off.
- 2 Turn off the power switch on the back of the wireless receiver. The LED indicator turns off.

## Optimizing your surround sound

The Rocketfish Universal Wireless Rear Speaker Kit uses state-of-the-art 2.4 GHz technology to digitally send audio data from the wireless sender to the wireless receiver. Wireless links create a small latency between the wireless sender and wireless receiver, and many home theater receivers let you adjust the

delay between the various speakers in your surround system. To optimize your system when tuning your speaker setup, we suggest that you shorten the delay to the rear speakers by 15-20 ms.

## Troubleshooting

Please read this User Guide carefully before using your wireless rear speaker kit. Check this list for a possible troubleshooting solution before calling for service. Refer to [rocketfishproducts.com](http://rocketfishproducts.com) for additional information.

Problem	Solution
No sound	<ul style="list-style-type: none"> <li>• Check to see if the LEDs illuminate on the front of both the wireless sender and wireless receiver units. If the LEDs are lit solidly, the communication is working correctly and all speaker wires and the home theater receiver operation should be checked. If the LEDs are flashing, refer to the “No communication between the sender and receiver” section below.</li> <li>• Make sure that the speaker wire connections are correct and secure.</li> <li>• Make sure that the wireless sender and wireless receiver are both connected to a working power outlet.</li> <li>• Make sure that the home theater receiver is turned on.</li> <li>• Make sure that the correct input is selected on your home theater receiver.</li> <li>• Turn up the volume on the home theater receiver.</li> <li>• Depending on what you are listening to, audio may not always play from the rear speakers.</li> </ul>
Sound interference	<ul style="list-style-type: none"> <li>• Move the wireless sender and wireless receiver slowly to find the best reception position for your system.</li> <li>• Shorten the distance between your wireless sender and wireless receiver. The maximum distance is 100 feet.</li> <li>• Other devices, such as cordless phones or microwaves, may cause interference with the wireless sender and wireless receiver. Try turning off one device at a time to determine which device is causing interference. Make sure the wireless sender is more than 18 inches away from any Wi-Fi routers.</li> </ul>



Problem	Solution
No communication between the sender and receiver	<ul style="list-style-type: none"> <li>• Make sure that the power cords are connected correctly.</li> <li>• After the power switches have been turned on on both the wireless sender and wireless receiver, the front panel LEDs should light. If they are solidly on, a communication link has been successfully established between the units. If they are flashing on one or both units, press and hold the <b>CONNECT</b> button on either the wireless sender or wireless receiver for two seconds. (Both the wireless sender's and the wireless receiver's <b>CONNECT</b> buttons are on the bottom.) This will put the unit into the "connection mode" for about 30 seconds. During this period the <b>CONNECT</b> button on the other unit must also be pressed for two seconds so that it will also enter "connection mode." The system proceeds with the connection process between the wireless sender and wireless receiver. While in "connection mode," the LED indicators blink at a faster rate. When an active link is established between the wireless sender and wireless receiver, the LED indicators will be solid on and will not blink.</li> </ul> <p><b>Note:</b> Try pressing the <b>CONNECT</b> buttons again if the LED indicators keep blinking after 30 seconds.</p>

## Specifications

### Wireless sender

Audio Input: Stereo, speaker-level	<ul style="list-style-type: none"> <li>• Maximum audio input signal: 11 V RMS into 120 ohms</li> </ul>
Audio Output: Wireless	<ul style="list-style-type: none"> <li>• Stereo, 16-bit, 48 KHz uncompressed</li> </ul>
Supply voltage	<ul style="list-style-type: none"> <li>• 5V</li> </ul>
Transmission Delay	<ul style="list-style-type: none"> <li>• 15-20 ms</li> </ul>

# Wireless receiver

Audio Input: Wireless	<ul style="list-style-type: none"><li>• Stereo, 16-bit, 48 KHz, uncompressed</li><li>• Signal-to-Noise Ratio: 87 dB</li></ul>
Audio Output: High Efficiency Class D, Speaker-level	<ul style="list-style-type: none"><li>• Supports 4 to 16 ohm speakers</li><li>• Audio output power: 2 × 30 W (RMS) into 4 ohms (no more than 10% THD)</li></ul>
Transmission Delay	<ul style="list-style-type: none"><li>• 15-20 ms</li></ul>
Power Supply	<ul style="list-style-type: none"><li>• AC 100-240 V ~ 50/60 Hz</li></ul>

# Legal notices

## FCC

This device complies with Part 15 of the FCC Rules. Operation is subject to the following two conditions: (1) this device may not cause harmful interference, and (2) this device must accept any interference received, including interference that may cause undesired operation.

This equipment has been tested and found to comply with the limits for a Class B digital device, pursuant to Part 15 of the FCC Rules. These limits are designed to provide reasonable protection against harmful interference in a residential installation. This equipment generates, uses and can radiate radio frequency energy and, if not installed and used in accordance with the instructions, may cause harmful interference to radio communications. However, there is no guarantee that interference will not occur in a particular installation. If this equipment does cause harmful interference to radio or television reception, which can be determined by turning the equipment off and on, the user is encouraged to try to correct the interference by one or more of the following measures.

-- Reorient or relocate the receiving antenna.

- Increase the separation between the equipment and receiver.
- Connect the equipment into an outlet on a circuit different from that to which the receiver is connected.
- Consult the dealer or an experienced radio/TV technician for help.

**Warning:** Changes or modifications not expressly approved by the party responsible for compliance could void the user's authority to operate the equipment.

## **RSS-Gen & RSS-247 Statement:**

This device complies with Industry Canada licence-exempt RSS standard(s).

Operation is subject to the following two conditions: (1) this device may not cause interference, and (2) this device must accept any interference, including interference that may cause undesired operation of the device.

Le présent appareil est conforme aux CNR d'Industrie Canada applicables aux appareils radio exempts de licence.

L'exploitation est autorisée aux deux conditions suivantes : (1) l'appareil ne doit pas produire de brouillage, et (2) l'utilisateur de l'appareil doit accepter tout brouillage radioélectrique subi, même si le brouillage est susceptible d'en compromettre le fonctionnement.

## **RSS-102 Statement:**

This equipment complies with Industry Canada radiation exposure limits set forth for an uncontrolled environment.

Cet équipement est conforme aux limitations prévues par IC pour l'exposition aux irradiations dans le cadre d'un environnement d'accès libre.



## Copyright

© 2016 Rocketfish. Rocketfish and the Rocketfish logo are trademarks of Best Buy and its affiliated companies. Other brands and product names are trademarks or registered trademarks of their respective holders. Specifications and features are subject to change without notice or obligation. For service and support call (800) 620-2790.

# One-Year Limited Warranty

## Definitions:

The Distributor\* of Rocketfish branded products warrants to you, the original purchaser of this new Rocketfish-branded product ("Product"), that the Product shall be free of defects in the original manufacture of the material or workmanship for a period of one (1) year from the date of your purchase of the Product ("Warranty Period").

For this warranty to apply, your Product must be purchased in the United States or Canada from a Best Buy branded retail store or online at [www.bestbuy.com](http://www.bestbuy.com) or [www.bestbuy.ca](http://www.bestbuy.ca), and is packaged with this warranty statement.

## How long does the coverage last?

The Warranty Period lasts for 1 year (365 days) from the date you purchased the Product. Your purchase date is printed on the receipt you received with the Product.

## What does this warranty cover?

During the Warranty Period, if the original manufacture of the material or workmanship of the Product is determined to be defective by an authorized Rocketfish repair center or store personnel, Rocketfish will (at its sole option): (1) repair the Product with new or rebuilt parts; or (2) replace the Product at no charge with new or rebuilt comparable products or parts. Products and parts replaced under this warranty become the property of Rocketfish and are not returned to you. If service of Products or parts are required after the Warranty Period expires, you must pay all labor and parts charges. This warranty lasts as long as you own your Rocketfish Product during the Warranty Period. Warranty coverage terminates if you sell or otherwise transfer the Product.

## How to obtain warranty service?

If you purchased the Product at a Best Buy retail store location, please take your original receipt and the Product to any Best Buy store. Make sure that you place the Product in its original packaging or packaging that provides the same amount of protection as the original packaging. If you purchased the Product from a Best Buy online web site ([www.bestbuy.com](http://www.bestbuy.com) or [www.bestbuy.ca](http://www.bestbuy.ca)), mail your original receipt and the Product to the address listed on the web site. Make sure that you put the Product in its original packaging or packaging that provides the same amount of protection as the original packaging.

To obtain warranty service, in the United States call 1-888-BESTBUY, Canada call 1-866-BESTBUY. Call agents may diagnose and correct the issue over the phone.

## Where is the warranty valid?

This warranty is valid only in the United States and Canada at Best Buy branded retail stores or websites to the original purchaser of the product in the county where the original purchase was made.

## What does the warranty not cover?

This warranty does not cover:

- Customer instruction/education
- Installation
- Set up adjustments
- Cosmetic damage
- Damage due to weather, lightning and other acts of God, such as power surges
- Accidental damage
- Misuse
- Abuse
- Negligence
- Commercial purposes/use, including but not limited to use in a place of business or in communal areas of a multiple dwelling condominium or apartment complex, or otherwise used in a place of other than a private home.
- Modification of any part of the Product, including the antenna
- Display panel damaged by static (non-moving) images applied for lengthy periods (burn-in).
- Damage due to incorrect operation or maintenance
- Connection to an incorrect voltage or power supply
- Attempted repair by any person not authorized by Rocketfish to service the Product
- Products sold "as is" or "with all faults"
- Consumables, including but not limited to batteries (i.e. AA, AAA, C etc.)
- Products where the factory applied serial number has been altered or removed
- Loss or Theft of this product or any part of the product
- Display panels containing up to three (3) pixel failures (dots that are dark or incorrectly illuminated) grouped in an area smaller than one tenth (1/10) of the display size or up to five (5) pixel failures throughout the display. (Pixel based displays may contain a limited number of pixels that may not function normally.)
- Failures or Damage caused by any contact including but not limited to liquids, gels or pastes.

REPAIR OR REPLACEMENT AS PROVIDED UNDER THIS WARRANTY IS YOUR EXCLUSIVE REMEDY FOR BREACH OF WARRANTY. ROCKETFISH SHALL NOT BE LIABLE FOR ANY INCIDENTAL OR CONSEQUENTIAL DAMAGES FOR THE BREACH OF ANY EXPRESS OR IMPLIED WARRANTY ON THIS PRODUCT, INCLUDING, BUT NOT LIMITED TO, LOST DATA, LOSS OF USE OF YOUR PRODUCT, LOST BUSINESS OR LOST PROFITS. ROCKETFISH PRODUCTS MAKES NO OTHER EXPRESS WARRANTIES WITH RESPECT TO THE PRODUCT, ALL EXPRESS AND IMPLIED WARRANTIES FOR THE PRODUCT, INCLUDING, BUT NOT LIMITED TO, ANY IMPLIED WARRANTIES OF AND CONDITIONS OF MERCHANTABILITY AND FITNESS FOR A PARTICULAR PURPOSE, ARE LIMITED IN DURATION TO THE WARRANTY PERIOD SET FORTH ABOVE AND NO WARRANTIES, WHETHER EXPRESS OR IMPLIED, WILL APPLY AFTER THE WARRANTY PERIOD. SOME STATES, PROVINCES AND JURISDICTIONS DO NOT ALLOW LIMITATIONS ON HOW LONG AN IMPLIED WARRANTY LASTS, SO THE ABOVE LIMITATION MAY NOT APPLY TO YOU. THIS WARRANTY GIVES YOU SPECIFIC LEGAL RIGHTS, AND YOU MAY ALSO HAVE OTHER RIGHTS, WHICH VARY FROM STATE TO STATE OR PROVINCE TO PROVINCE.

Contact Rocketfish:

For customer service please call 1-800-620-2790

[www.rocketfishproducts.com](http://www.rocketfishproducts.com)

ROCKETFISH is a trademark of Best Buy and its affiliated companies

Distributed by Best Buy Purchasing LLC

7601 Penn Avenue South, Richfield, Minnesota 55423 U.S.A.

© 2016 BBY Solutions, Inc. All rights reserved.

**Made in China**



[www.rocketfishproducts.com](http://www.rocketfishproducts.com)  
(800) 620-2790

ROCKETFISH is a trademark of Best Buy and its affiliated companies.  
Distributed by Best Buy Purchasing, LLC  
7601 Penn Avenue South, Richfield, MN 55423 USA  
© 2016 Best Buy. All rights reserved.  
Made in China