

SNAPTAIN 

# P40 Lite

■ 3-Axis Gimbal 4K Camera Drone

AGES  
**14+**

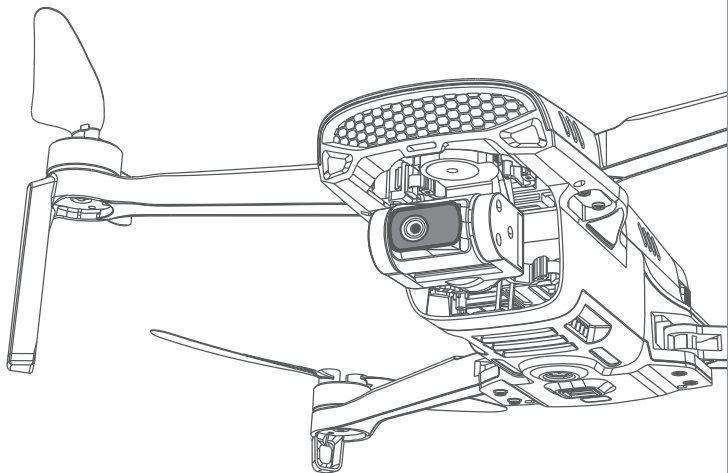

## QUICK START GUIDE

Model No.DR-STP41G

V1.02

## CHARGING THE DRONE BATTERY & REMOTE

Use the provided charging cable to fully charge the drone battery and remote.

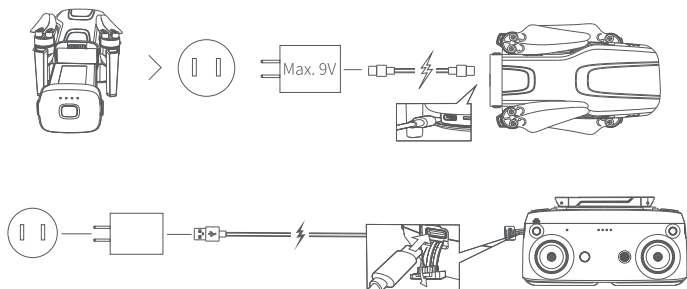

## DOWNLOADING APP

To control your drone, download and install the official **SNAPTAIN GO** app from the Google Play™ or App Store™. You can also scan the QR code below for quick access.



For Android 10.0 and later



For iOS 10.0 and later

# FLIGHT PREPARATION

1. Insert a Micro SD card (purchased separately).

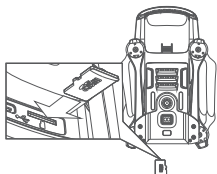

\* Supports up to 256GB

\* Supports FAT32 and exFAT formats

## Note

Photos/videos cannot be saved without a Micro SD card.

2. Remove the gimbal cover.



3. Install the drone battery.



4. Extend the front arms, rear arms, and propellers.

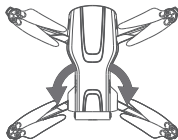

5. Unfold the handles and antennas.

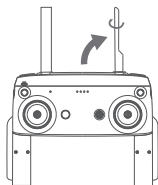
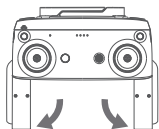

6. Remove the control sticks from their storage slots and mount them to the remote.

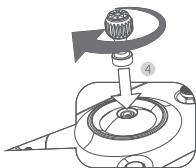
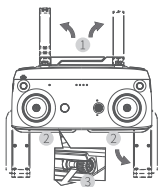

7. Extend the phone holder and insert your phone with its charging port facing right, then connect the phone to the Type-C port on the right side of the remote using the appropriate connection cable (USB-C/ Lightning/Micro-USB) from the package.

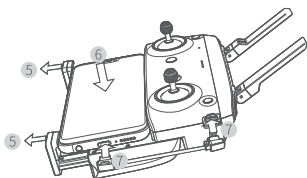

**Tip**

The phone holder can accommodate phones up to 3.54 inches (90 mm) wide.



8. Power on the remote by pressing the **Power** button once, then holding it until all battery indicator lights illuminate.

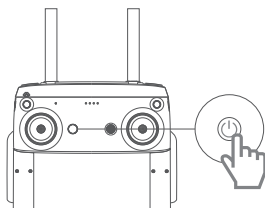

9. Power on the drone by pressing the **Power** button once, then holding it until all battery indicator lights illuminate.

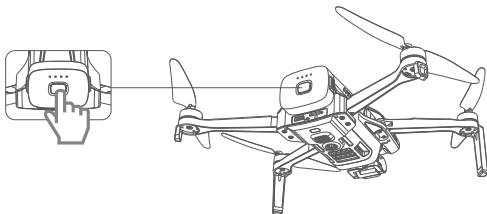

10. Place the drone on a level surface and wait for it to automatically pair with the remote. When **Disconnected** changes to **Connected** on the SNAPTAIN GO app's main screen, tap **START** to proceed. Once GPS satellite search is complete, "Be Ready" will appear in the top-left corner of the app screen, indicating the drone is ready for takeoff.

# OPERATION & FUNCTIONS

## Take-off

### Option 1: Using Remote

Unlock the drone by simultaneously pushing the **Left Control Stick** to the lower right at 45° angle and the **Right Control Stick** to the lower left at 45° angle (or **Left Control Stick** to the lower left and **Right Control Stick** to the lower right) until the propellers start rotating. Then, push the **Left Control Stick** forward.

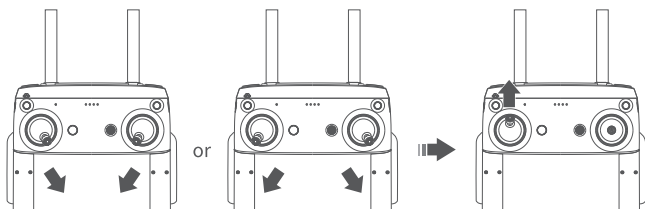

### Option 2: Using One-Key Takeoff

(For detailed instructions, please refer to the app.)

### Option 3: Throwing away

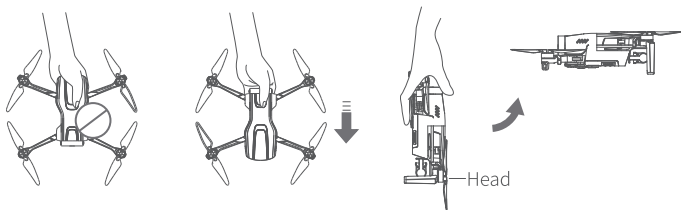

(For detailed instructions, please refer to the user manual.)

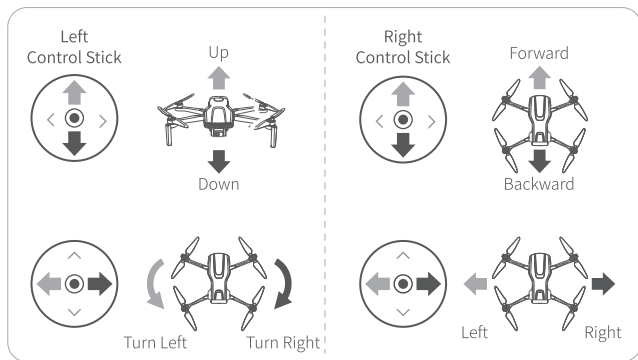

## Flight Directions



## Return to Home (RTH)

To activate RTH, press and hold the **RTH** button  on the remote or tap the **RTH/Landing** icon  on the app screen and select **RTH**.

## Landing

### Option 1: Using Remote

Pull the left control stick fully backward to make the drone descend and land.

### Option 2: Using App

In the app, tap the **RTH/Landing** icon , then select **Land**. The drone will descend and land at its current position.

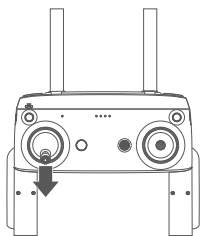

## SNAPTAIN SUPPORT



US support@snaptain.com

TEL (415)991-6646(Mon-Fri)



www.snaptain.com



@snaptainofficial



@snaptain\_official