

• In-ground Pools

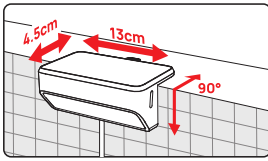

Straight right-angle edge

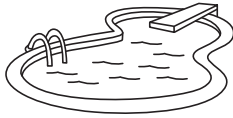
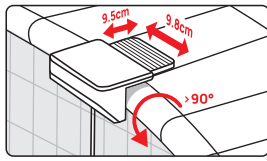

Large rounded edge

• Installation Steps

- 1 Clean the Surface

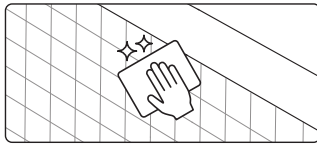

- 2 Apply Underwater Glue or VHB Tape

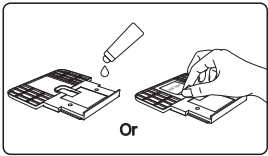

Or

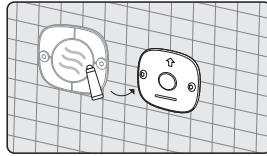

- 3 Install the Bracket and Magnetic Plate

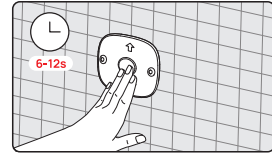
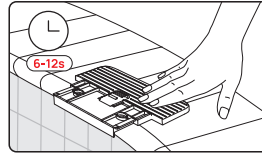

- 4 Install the Light after the Adhesive Cures for 24 Hours

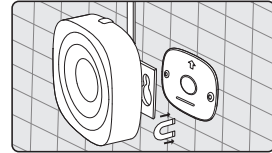
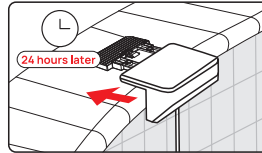

**Step 1:** Use a soft cloth or mild cleaner to wipe the pool wall. Remove all dust, oil, wax, algae, etc., to avoid adhesive failure.

**Step 2:**

A. Underwater Glue

Apply evenly on the mounting plate's adhesive area. Use a moderate amount to avoid overflow.

B. VHB Tape

Only for mounting plates. Make sure the surface is completely dry before sticking.

**Reminder:**  
If your pool water level frequently changes, choose underwater glue. VHB adhesion decreases in humid conditions.

**Step 3:** Press firmly when attaching. Avoid repositioning during installation – this will weaken the adhesive.

**Step 4:** Wait 24 hours before installing the lights. Installing too early may cause the mounting plate to loosen.

• How to Remove the Light

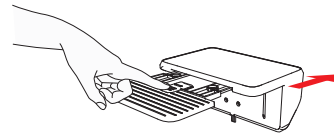

Press the latch on the base and pull the SO5 light out.

• Above-ground Frame Pools

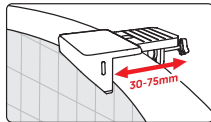
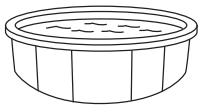

• Installation Steps

- 1 Measure the Pool Frame Size



- 2 Adjust the Mounting Clamp

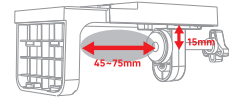
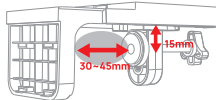
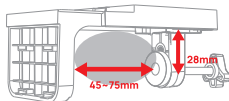
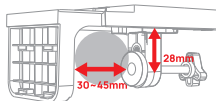

- 3 Attach the Clamp to the Frame

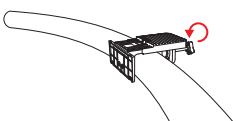

- 4 Install the Upper Water Light onto the Clamp

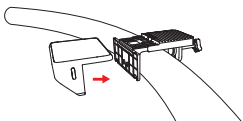

- 5 Install the Underwater Light

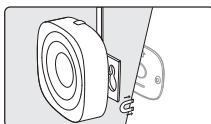

Adjusting the Clamp Size

- Adjust clamp width

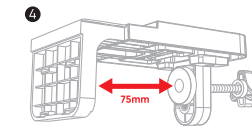
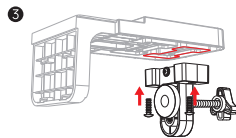
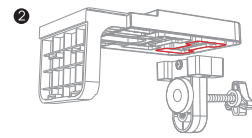
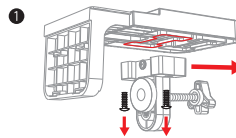

- Adjust clamp height

