



QUICK START GUIDE

ATTENTION

For Returns or Support you MUST contact:

Beta@etinc.ca



TABLE OF CONTENTS

WHAT'S INCLUDED	4
WHAT YOU'LL NEED	5
REGULATORY INFORMATION	5
PRODUCT DETAILS.....	6
LET'S GET STARTED	7
Download the App.....	7
Plug-in your camera to power on.....	7
SETTING UP YOUR CAMERA.....	8
Option 1: Discover your device.....	8
Option 2: Manually add your device	10
Insert a Micro SD Card	13
PROPER CAMERA INSTALLATION AND PLACEMENT	14
RECORDING SETUP	15
SETTING UP MOTION DETECTION	16
SURVEILLANCE AREA SETTING	17
SETTING UP NOTIFICATIONS	18
USING THE APP	19
FREQUENTLY ASKED QUESTIONS.....	19

ACTIVATE YOUR WARRANTY



PROTECT

Covered for the unexpected



SUPPORT

Receive videos, tips & updates for your product



VALUE

Exclusive access to special offers



Open your camera & scan this QR code, or visit: **DefenderCameras.com/Warranty**

EXTEND YOUR WARRANTY

Don't forget to protect your purchase and ease your mind by extending your included 1 year manufacturer warranty to 2 or 3 years. If something goes wrong, our team of Security Experts will get you back up and running fast!

Extended Warranties can be purchased up to 60 days after your product's purchase.



2 YEAR WARRANTY

Extend your peace of mind to two years

- ♦ **Product Defects**
- ♦ **Advanced Replacements**
- ♦ **Free Return Shipping**



3 YEAR WARRANTY

Extend your peace of mind to three years

- ♦ **Product Defects**
- ♦ **Advanced Replacements**
- ♦ **Free Return Shipping**



Open your camera & scan this QR code, or visit: **DefenderCameras.com/pages/extended-warranties**

WHAT'S INCLUDED

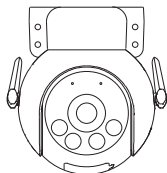

Defender 4K Everwatch
PTZ Camera with Mounting
Bracket

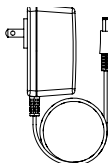

Power supply (10ft)

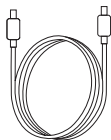

Camera Power Extension
Cable (25ft)



Ethernet Waterproof Cable
Shield



1 x Window Warning Sticker



Drilling Template



Camera Mounting
Hardware



Warranty Registration
Insert



Quick Start Guide



Lifetime Support

IMPORTANT: The Camera Power Supply is NOT waterproof.

WHAT YOU'LL NEED

- Wi-Fi Internet Connection
- Drill and/or a Phillips #2 screwdriver
- 3/32" drill bit for pilot holes
- 7/32" drill bit for wall anchors
- 7/8" long drill bit (Choose the right drill bit based on the surface material)
- A compatible Android or iOS phone

REGULATORY INFORMATION

FCC STATEMENT: This device complies with part 15 of the FCC Rules. Operation is subject to the following two conditions: (1) This device may not cause harmful interference. (2) This device must accept any interference received, including interference that may cause undesired operation. This equipment complies with FCC radiation exposure limits set forth for an uncontrolled environment. This equipment should be installed and operated with a minimum distance of 20cm between the radiator and any part of your body.

FCC WARNING: This equipment has been tested and found to comply with the limits for a Class B digital device, pursuant to Part 15 of the FCC Rules. These limits are designed to provide reasonable protection against harmful interference in a residential installation. This equipment generates, uses and can radiate radio frequency energy and, if not installed and used in accordance with the instructions, may cause harmful interference to radio communications. However, there is no guarantee that interference will not occur in a particular installation. If this equipment does cause harmful interference to radio or television reception, which can be determined by turning the equipment off and on, the user is encouraged to try to correct the interference by one or more of the following measures:

- Reorient or relocate the receiving antenna.
- Increase the separation between the equipment and the receiver.
- Connect the equipment into an outlet different from that to which the receiver is connected.
- Consult the dealer or an experienced radio/TV technician for help.

IC STATEMENT: This device contains licence-exempt transmitter(s)/receiver(s) that comply with Innovation, Science and Economic Development Canada's licence-exempt RSS(s). Operation is subject to the following two conditions: (1) This device may not cause interference. (2) This device must accept any interference, including interference that may cause undesired operation of the device. This equipment complies with IC RSS-102 radiation exposure limits set forth for an uncontrolled environment. This equipment should be installed and operated with minimum distance 20cm between the radiator and your body.

Changes or modifications not expressly approved by the party responsible for compliance could void the user's authority to operate the equipment.

PRODUCT DETAILS

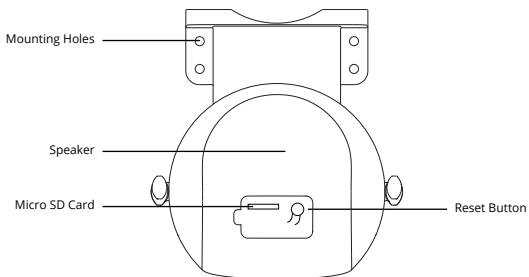
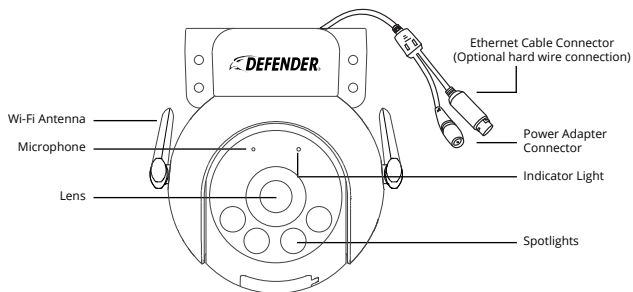

LET'S GET STARTED

STEP 1: DOWNLOAD THE APP

Download the Defender Empower app and follow the steps to create an account. An email account is required for verification.



STEP 2: PLUG-IN YOUR CAMERA TO POWER ON

Your camera will perform a self-range check. Wait up to 60 seconds for the LED indicator light to flash red and chime before connecting your camera to the App.

COLOR	SOLID/FLASHING	STATUS
RED	Solid	Booting
	Flashing Slowly	Updating Firmware
	Flashing Quickly	Ready for device setup
BLUE	Solid	Working properly
	Flashing Slowly	Camera connected to Wi-Fi
	Flashing Quickly	Camera connecting to Wi-Fi

SETTING UP YOUR CAMERA

There are two options for adding your camera to the Empower App.

OPTION 1: DISCOVER YOUR DEVICE.

Step 1: Connect to your Wi-Fi and pair your camera.

IMPORTANT: Ensure you have your Bluetooth enabled on your phone when setting up the camera.



Tap “Add Device” or tap + and select Add Device. The App will scan for any devices in the vicinity. Once the image of the camera appears select Add.



Select Add to add the device.



Select your 2.4 GHz Wi-Fi network and enter your password. Your phone may be connected to a 5 GHz network by default. To switch to a different Wi-Fi network, use the ⇄ button to go to your phone settings and switch to a 2.4 GHz network. Once you are connected, return to the app. Click “Next” to continue.

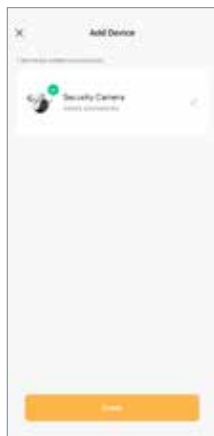
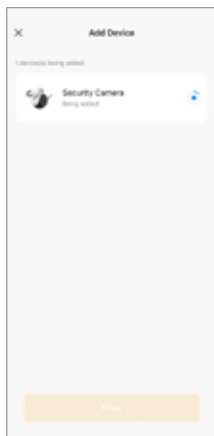

Please wait while the device connects to the app.

We recommend naming your camera if you are adding more than one device. Tap the  to name your camera. Select Finish and Done.

NOTE: Repeat the steps for each additional camera you want to connect.

OPTION 2: MANUALLY ADD YOUR DEVICE.

IMPORTANT: Ensure you have your Bluetooth enabled on your phone when setting up the camera.



Tap “Add Device” or tap + and select Add Device.



Tap your product under Add Manually to enter the pairing process.



Select Next.



Ensure the camera indicator light is flashing red, and click "Next" to continue.

NOTE: If your indicator light is no longer flashing red, press the reset button for 5 seconds to restart the pairing process.

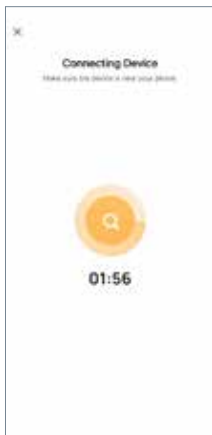



Wait for the device to connect.

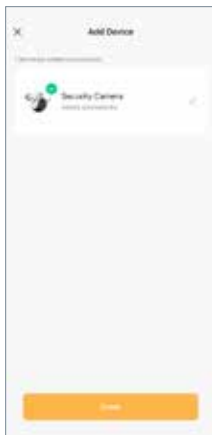

Select your 2.4 GHz Wi-Fi network and enter your password.

Your phone may be connected to a 5 GHz network by default. To switch to a different Wi-Fi network, use the ⇌ button to go to your phone settings and switch to a 2.4 GHz network. Once you are connected, return to the app. Click "Next" to continue.



We recommend naming your camera if you are adding more than one device. Tap the  to name your camera. Select Finish and Done.

NOTE: Repeat the steps for each additional camera you want to connect.

SETTING UP YOUR CAMERA

STEP 3: INSERT A MICRO SD CARD

Recordings can be locally stored on a Micro SD card, to insert or swap out your Micro SD card please follow the steps below. The maximum size Micro SD card is 128GB.

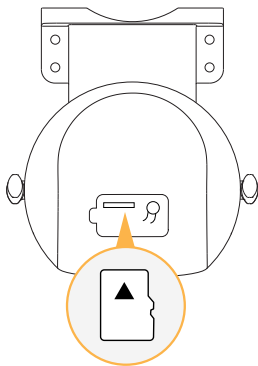

1. Remove the lower cover by pulling up on the tab.
2. If swapping out a current Micro SD card, gently press on the card, it will pop out.
3. When inserting your Micro SD push it in until you hear a click sound.

PROPER CAMERA INSTALLATION AND PLACEMENT

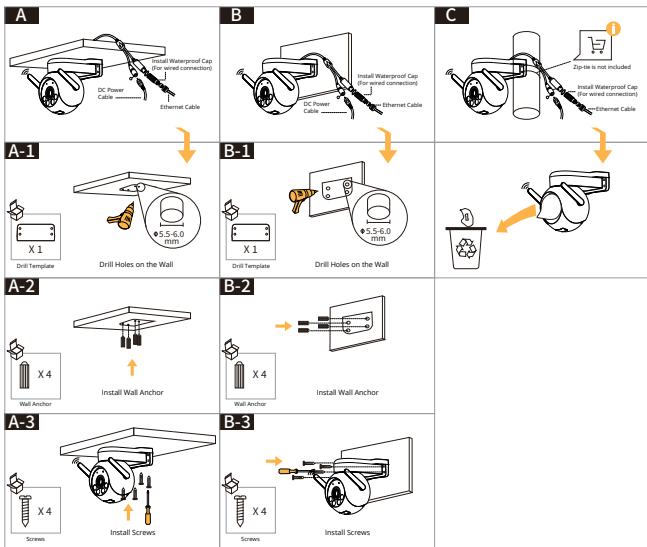

RECORDING SETUP

Your camera(s) default setting is to record when motion is detected. If this is your preferred setting, skip this step.

To set up Continuous Recording, from the home screen select the camera you wish you adjust the settings for. Next select (•••) in the top right. Select Recording Settings, select Recording Mode and select Continuous Recording.

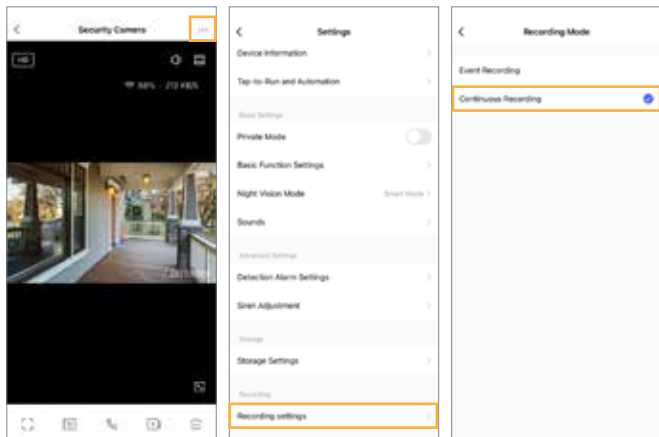

TIP: If you prefer to only record during certain times of the day, select *Schedule* to create a schedule for when the camera will record.

NOTE: Once the SD card is full, the camera will continue to record by overwriting older footage.

SETTING UP MOTION DETECTION

To access Detection Settings, navigate to the live view screen, tap (⋮), and select Detection Alarm Settings. Toggle on/off your preferred notifications.

*Repeat for each camera.

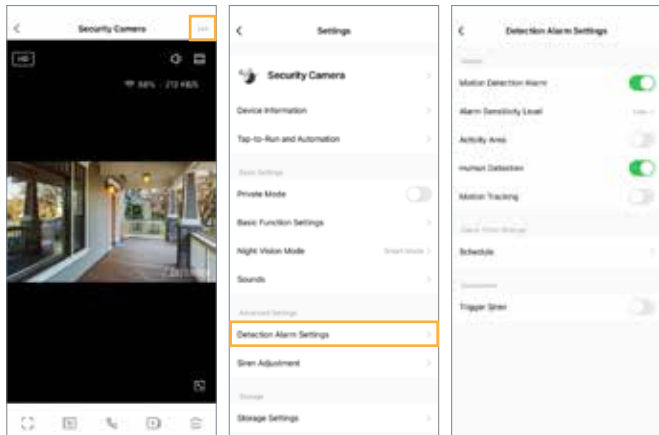

To receive notifications for all types of motion, turn off Human Detection. If both Motion and Human Detection are enabled, you will only receive alerts for human detection.

Once the moving object is no longer detected, your camera will adjust back to your default point of direction.

Human detection may not be 100% accurate. To minimize false notifications, we recommend enabling the Activity Area and selecting Surveillance Area Setting to customize your detection region by masking areas to avoid any trees or larger moving objects.

SURVEILLANCE AREA SETTING

To access the Surveillance Area Setting, navigate to the live view screen, tap (⋮), and select Detection Alarm Settings.

Toggle on Activity Area. Select Edit.

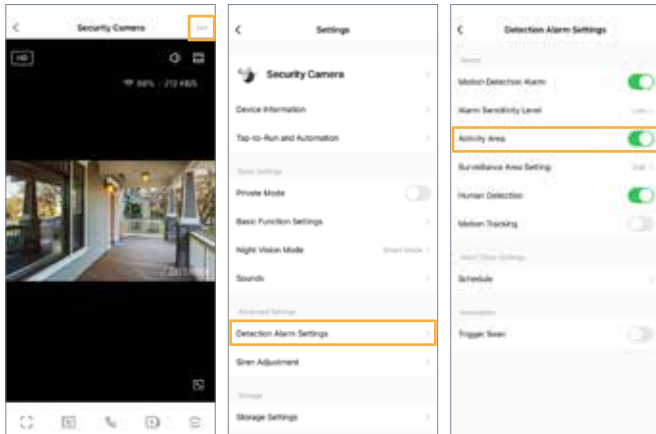

Drag the circles to set your motion detection area. The areas highlighted will detect motion. To add additional areas, tap the + icon. Select Save to confirm your changes.



SETTING UP NOTIFICATIONS

IMPORTANT: Alarm and Message Push with image notifications are on by default. If this is your preferred setting, skip this step.

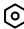
To access Notifications from the home screen, select Me. Select  and select App Notification.

Select your preferred notification settings. Please note this setting is for all devices connected to the app.

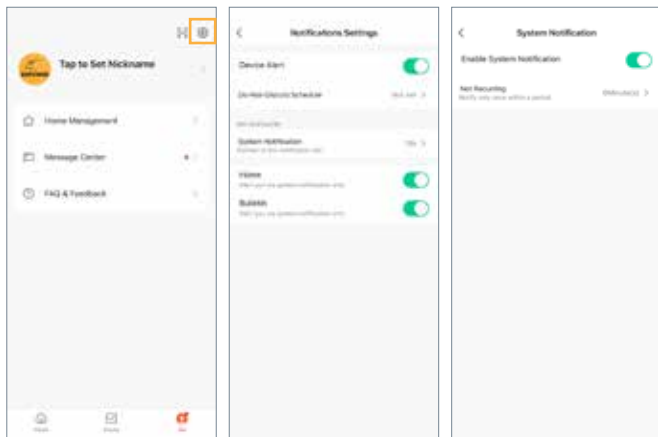

USING THE APP

The Defender Empower App allows you to remotely view live video or playback recorded footage, save and share recordings, and more. Scan the QR Code from your mobile device to access the Defender Empower App Quick Start Guide.

- Navigating the App
- Sharing App Access
- Recording Schedules
- Customized Notifications
- Night Vision Settings
- Motion Detection Settings
- How to use Deterrence



FREQUENTLY ASKED QUESTIONS

CAN I ALLOW OTHER PEOPLE TO VIEW MY CAMERA(S) REMOTELY?

Yes. You can share your Defender Empower App access with up to 20 additional users. Each user must download the Defender Empower App and create their own account before sharing access.

IS DEFENDER 4K EVERWATCH PTZ COMPATIBLE WITH ANY DEFENDER CAMERA SYSTEM?

Defender 4K Everwatch PTZ cameras are only compatible with the Defender Empower App. It cannot be used with any other Defender security systems.

CAN I VIEW MY LIVE OR RECORDED FOOTAGE FROM A WEB BROWSER?

No, we do not offer web viewing. You can view the footage from the free Defender Empower App with compatible iOS/Android smart phones/tablets.

Need Help? Visit:
DefenderCameras.com/Support
Email beta@etinc.ca

IP4KACBPTZ-QSG



Defender is continuously enhancing our products to bring customers the best user experience. For the most up to date Quick Start Guide, please visit DefenderCameras.com.

DEFENDER® does not endorse any DEFENDER® products for illegal activities. DEFENDER® is not responsible or liable in any way for any damage, vandalism, theft or any other action that may occur while a DEFENDER® product is in use by the purchaser. We reserve the right to change models, configuration, or specifications without notice or liability. Product may not be exactly as shown.



REV01 05272024 v2

©2024 DEFENDER®. All rights reserved. DEFENDER®, the DEFENDER® logo and other DEFENDER® marks may be registered. All other Trademarks are the property of their respective owners.